

Wickham, Jerry, Env. Health

From: Wickham, Jerry, Env. Health
Sent: Wednesday, February 24, 2010 1:48 PM
To: 'Erik Appel'
Cc: Bryan Campbell
Subject: RE: 74121 - 10605 Foothill Blvd. Excavation

Erik,

I concur with expanding the excavation. Following expansion of the excavation, please collect confirmation soil samples from the expanded sidewall at the depth where the highest PID readings, odor, or visual contamination were observed during excavation.

Please let me know your schedule for excavation and confirmation sampling as I plan to visit the site.

Regards,

Jerry Wickham

Alameda County Environmental Health
1131 Harbor Bay Parkway
Alameda, CA 94502
510-567-6791
jerry.wickham@acgov.org

From: Erik Appel [mailto:eappel@eticeng.com]
Sent: Wednesday, February 24, 2010 10:26 AM
To: Wickham, Jerry, Env. Health
Cc: Bryan Campbell
Subject: 74121 - 10605 Foothill Blvd. Excavation

Jerry,

Attached is the figure of our present excavation with analytical results at the indicated location. We intend to expand a 5-foot slot on the northeast side of the present excavation.

Please let me know if you concur.

Thank you,

--Erik

Erik Appel, PG

eappel@eticeng.com

ETIC Engineering, Inc.
2285 Morello Ave.
Pleasant Hill, CA 94523
Tel: 925-602-4710 x 21
Fax: 925-602-4720
Cell: 925-642-2545

www.eticeng.com



 Please consider the environment before printing this e-mail.

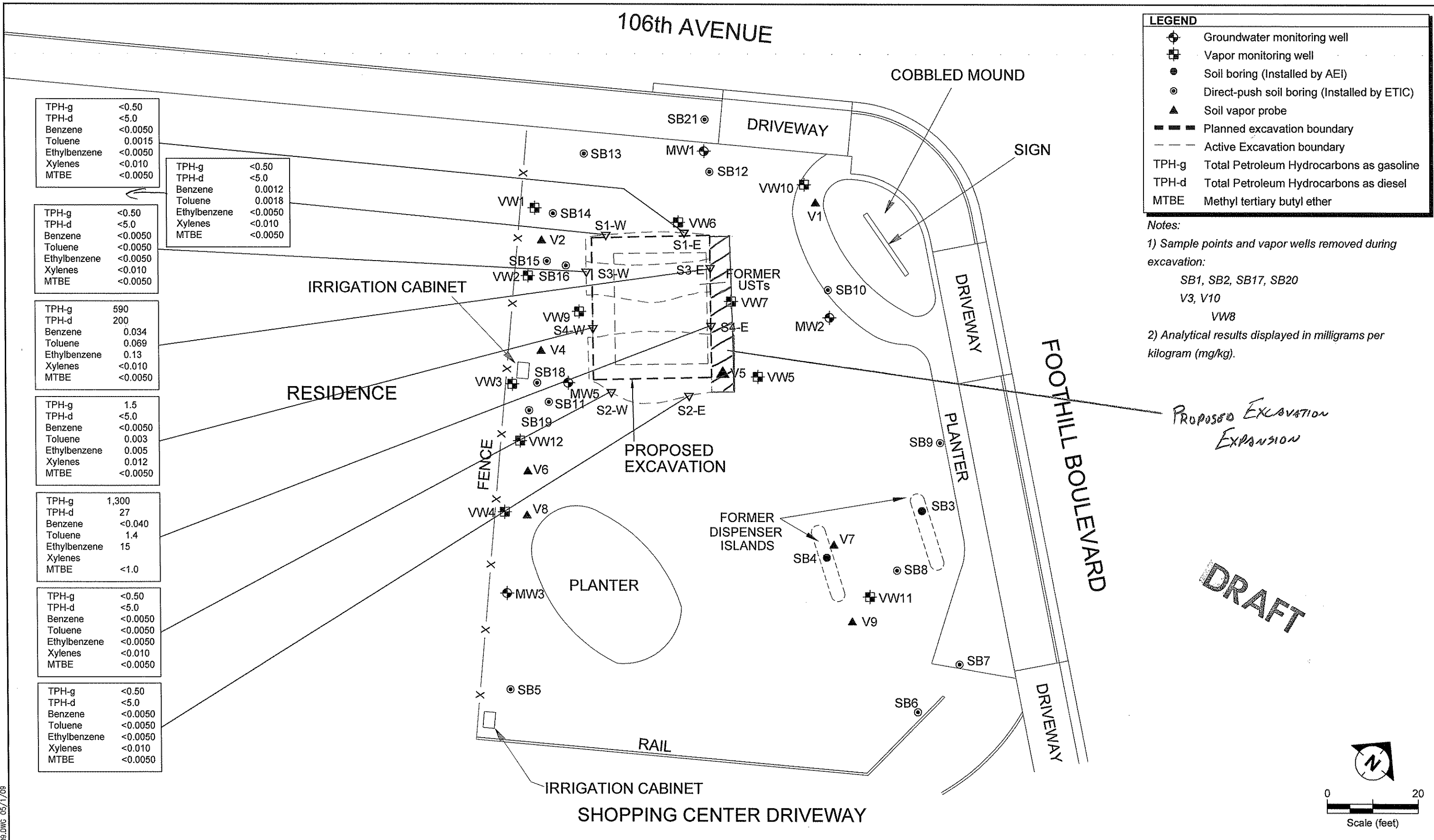

SITE MAP SHOWING EXTENT OF PROPOSED EXCAVATION
 FORMER EXXON RS 74121
 10605 FOOTHILL BOULEVARD, OAKLAND, CALIFORNIA
 27 MARCH AND 23 APRIL 2009

FIGURE:

1