

Initial Site Investigation Report for the 64th and 65th
Street Properties, Emeryville, California

13 June 1995

Sybase, Inc., Emeryville, California
(EKI 940018.00)

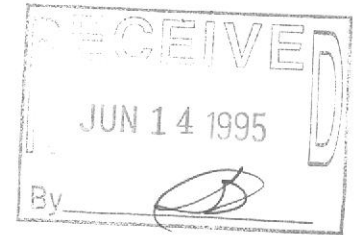

Distribution List

Mr. Sumadhu Arigala 3 copies
Dr. Ravi Arulanantham
California Regional Water Quality Control Board,
San Francisco Bay Region
2101 Webster Street, Suite 500
Oakland, California 94612

Ms. Susan L. Hugo 1 copy
Alameda County Department of Environmental Health
Division of Hazardous Materials
1131 Harbor Bay Parkway
Alameda, California 94502

cc:

Mr. John Bruno 1 copy
Sybase, Inc. 1 partial
6475 Christie Avenue
Emeryville, California 94608

Mr. Thomas Sullivan 1 partial
AMB Corporate Real Estate Advisors, Inc.
505 Montgomery Street
San Francisco, California 94111

Mr. William Wick 1 partial
Crosby, Heafey, Roche & May
1999 Harrison Street
Oakland, California 94612

Ms. Alicia Guerra 1 copy
Michael Brandman & Associates 1 partial
175A Technology Drive, Suite 116
San Jose, California 95110

Ms. Pamela Duffy 1 partial
Coblentz, Cahen, McCabe & Breyer
222 Kearny Street
San Francisco, California 94108

Mr. Nick Sica
Nova Partners
330 Town & Country Village
Palo Alto, California 94301

1 partial

Mr. Glenn Bauer
Robinson Mills + Williams
160 Pine Street
San Francisco, California 94111

1 partial

Mr. Craig Shields
Treadwell and Rollo
555 Montgomery Street, Suite 1300
San Francisco, California 94111

1 copy

Mr. Scott Steinwert
Public Affairs Management
101 Embarcadero, Suite 210
San Francisco, California 94105

1 partial

Note:

copy = complete report (includes Appendices A through G)
partial = partial report (excludes Appendices B through G)

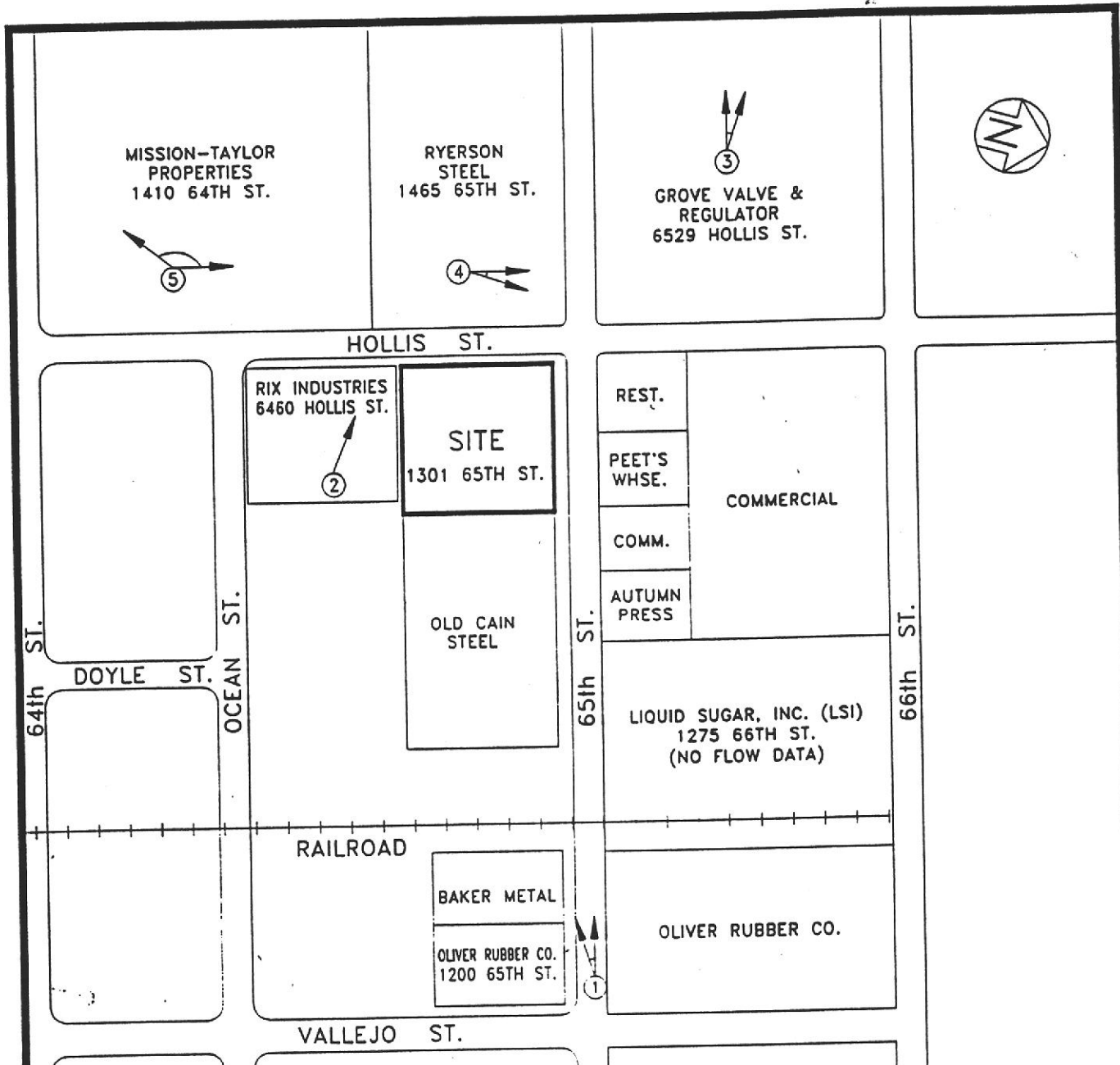

KEY TO GROUNDWATER DATA

- ① OLIVER RUBBER CO. 10/1/92 TO 7/14/93
- ② RIX INDUSTRIES 7/7/92
- ③ GROVE VALVE & REGULATOR 3/2/92 TO 10/15/92
- ④ RYERSON STEEL 8/11/93 TO 11/26/93
- ⑤ MISSION-TAYLOR PROPERTIES 4/13/90 TO 3/4/93



BLYMYER
ENGINEERS, INC.

BEI JOB NO.
89070

DATE
5/26/94

LEGEND



RANGE OF GROUNDWATER
FLOW DIRECTION AT
SITE X

NOT TO SCALE

AREA MAP

1301 65th ST. ASSOCIATION
EMERYVILLE, CA

FIGURE

2