

TABLE 3: Summary of Soil Analytical Data, Collected After the Soil Excavation - St. Francis Pie Co., 1125 67th Street, Oakland, CA

Sample ID	Depth (fbg)	Date	TPH-G	B	T	E	X	MTBE	ETBE	TAME	DIPE	TBA	1,2DCA	1,2EDB	Ethanol	Lead
Concentrations in parts per million (ppm)																
EX-E-7'	East wall at 7 fbg	2/27/2004	4.79	<0.005	0.007	0.186	0.388	0.037	<0.005	<0.005	<0.005	<0.25	<0.005	<0.005	<0.5	---
EX-E-9.5'	East wall at 9.5 fbg	2/27/2004	0.575	<0.005	<0.005	<0.005	<0.025	3.21	<0.005	0.162	<0.005	2.68	<0.005	<0.005	<0.5	---
EX-S-7'	South Wall at 7 bg	2/27/2004	113	0.264	0.695	0.443	1.22	0.166	<0.005	<0.005	<0.005	<0.25	<0.005	<0.005	<0.5	---
EX-S-9'	South Wall at 9 fbg	2/27/2004	3.36	0.009	<0.005	<0.005	0.022	3.25	<0.005	0.147	<0.005	0.445	<0.005	<0.005	<0.5	---
EX-W-4'	West wall at 4 fbg	2/27/2004	3.8	<0.005	0.021	0.025	0.027	0.046	<0.005	<0.005	<0.005	<0.25	<0.005	<0.005	<0.5	---
EX-W-7'	West wall at 7 fbg	2/27/2004	29.9	0.212	0.081	0.847	1.44	2.82	<0.005	<0.005	<0.005	0.794	<0.005	<0.005	<0.5	---
D-8.5'	Under dispenser at 8.5 fbg	3/3/2004	5.12	0.139	0.01	0.097	0.074	4.69	<0.005	0.12	<0.005	0.961	<0.005	<0.005	<0.5	---
P1-8'	Under dispenser piping at 8.5 fl	3/3/2004	1.57	0.073	<0.005	0.043	0.023	6.22	<0.005	0.165	<0.005	1.86	<0.005	<0.005	<0.5	---
F1-4'	Under remote fill at 4 fbg	3/3/2004	2.36	0.033	<0.005	0.064	0.011	12.6	<0.005	0.153	<0.005	12.2	<0.005	<0.005	<0.5	---

Indoor Air impacts for commercial /Industrial Land Use

Groundwater Protection/Soil Leaching

(Potentially impacted groundwater is not a current or potential drinking water resource)

Direct exposure/ Human Health Protection

NV	0.5	420	13	100	5.6	NV
400	2	9.3	32	1.5	8.4	110
5800	0.38	440	19	180	70	950

Notes:

TPH-G = Total petroleum hydrocarbons as gasoline (EPA Method 8015)

BTEX = Benzene, Toluene, Ethylbenzene, Xylenes (EPA Method 8020)

Fuel Additives = Methyl-tert-butyl ether (MTBE), Ethyl tert-butyl ether (ETBE), tert-Amyl methyl ether (TAME), Di-isopropyl ether (DIPE), tert-Butyl alcohol (TBA), 1,2-Dichloroethane, 1,2-Dibromoethane, Ethanol (EtOH) by EPA Method 8260

Lead = Total lead (EPA Method 6010)

<X = Concentration less than laboratory reporting limits

* = Confirmed by EPA Method 8260

--- = Not available

fbg = Feet below grade

3/18/04 Tentative Report - met @ site
w/ Sam Males - met add'l sampling
@ dispenser & remote fill areas
(plus along line).

SIDEWALK

EXCAVATED AREA TO A DEPTH OF TEN FEET

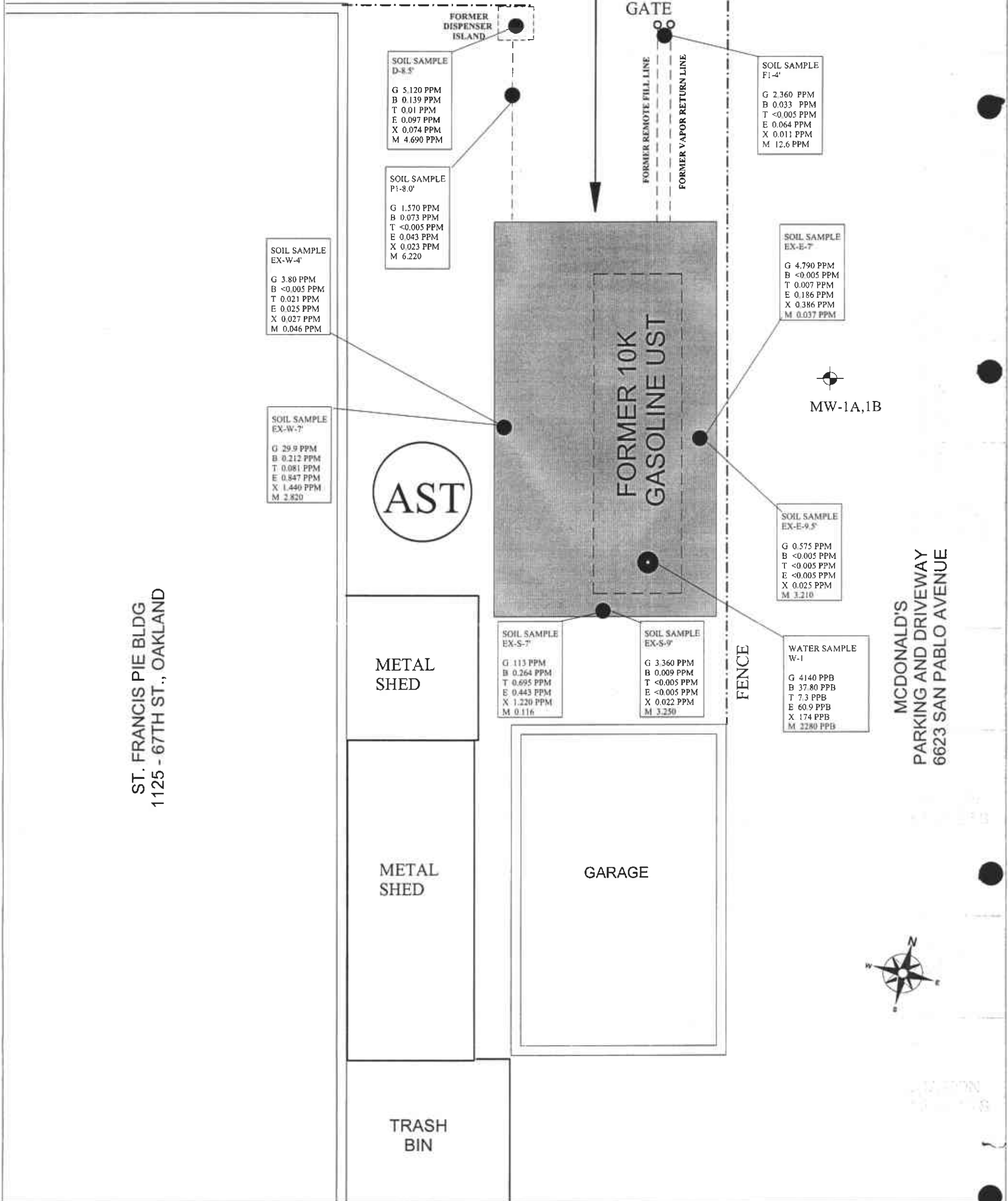

ST. FRANCIS PIE BLDG
1125 - 67TH ST., OAKLAND

MCDONALD'S
PARKING AND DRIVEWAY
6623 SAN PABLO AVENUE

PAGE: 1 OF 1

DATE: 3/12/2004

CAD BY: KA

LEGEND:

MONITORING WELL

UST = UNDERGROUND STORAGE TANK

AST LIQUID SUGAR ABOVEGROUND STORAGE TANK

PPM = PARTS PER MILLION OR MILLIGRAM PER KILOGRAM
PPB = PARTS PER BILLION OR MICROGRAM PER KILOGRAM

G TOTAL PETROLEUM HYDROCARBON AS GASOLINE
B BENZENE
T TOLUENE
E ETHYLBENZENE
X XYLENES
M METHYL TERTIARY BUTYL ETHER

CONSULTANT:

**TEC
ACCUTITE**

35 South Linden Avenue
South San Francisco, CA

Phone: 650-952-5551
Fax: 650-952-7631

ST. FRANCIS PIE SHOP, INC.
1125 - 67TH STREET
OAKLAND, CALIFORNIA

FIGURE 4

FORMER UST LOCATION
AND ANALYTICAL RESULTS

