



March 22, 2016
Project: 624-0908-0043-J0006

Ms. Karel Detterman
Local Oversight Program
Alameda County Environmental Health Services
1131 Harbor Bay Parkway, Suite 250
Alameda, California 94502-6577
(510) 567-6577

Subject: Well Destruction Completion Report

Reference: Bimbo Bakeries USA, Inc.
955 Kennedy Street
Oakland, California 94606

Fund Claim #: 4424
GeoTracker #: T0600177342
ACEH Case #: RO-0002569

Dear Ms. Detterman:

On behalf of Bimbo Bakeries USA, Inc. (BBU), PSC Industrial Outsourcing, LP (PSC) is submitting (via upload to GeoTracker) this *Well Destruction Completion Report* for the above referenced facility. The property and improvements during the well destructions were owned by BBU.

The State Water Resources Control Board (SWRCB) requested the permanent destruction of all four on site groundwater-monitoring wells as the final step in receiving Case Closure for the facility. This *Well Destruction Completion Report* was prepared upon properly completing the destruction of the subject wells. The Department of Water Resources (DWR) Well Completion Report (WCR) (DWR-188 Form)s have been completed and submitted to Mr. Oleg Yakimov of the DWR located in West Sacramento and to Ms. Lindsay Furuyama of the Alameda County Public Works Agency (ACPWA). The DWR WCR Report includes site figures, the original boring and well construction logs, and the original well installation DWR-188 Forms. A copy of the DWR WCR Report is included in Attachment 1. A copy of the ACPWA Well Destruction Permits is included in Attachment 2. A copy of the SWRCB Order WQ 2015-0161-UST is included in Attachment 3. A copy of the well destruction waste disposal manifest is included in Attachment 4.

PSC conducted the well destruction field activities on January 27, 2016. All four wells were destroyed by Gregg Drilling & Testing, Inc., a California C-57 licensed driller. No deviations occurred during the well destructions. Osborne Coring cored out the flush-mounted well vaults prior to well destruction to prevent damaging the existing adjacent

concrete surface. Underground Service Alert (USA) North One Call and SubDynamic Utility Locators marked and cleared all utilities prior to commencement of the well destruction field activities.

The first well (MW-101), was over-drilled to the original boring depth using 8-inch diameter hollow-stem augers. The augers were fitted with stinger rods to total well depth. The well was over-drilled and the entire PVC well casing and screen were removed. Then, with ACPWA inspection approval, the well was grouted with neat Portland cement via tremie pipe from total depth to approximately 23 feet below ground surface (bgs). Then, the grout was tremie fed through the open augers to surface. Approximately, ten 47-pound bags of Portland cement were mixed with ~30-gallons of potable water making a total of approximately 60 gallons of grout. Surface restoration was completed by matching the existing surface with concrete.

For the remaining three wells (MW-102, MW-103, and MW-104), the wells were permanently destroyed by pressure grouting while maintaining 25 psi during the grouting process. Then, an auger was fitted with a short stinger fitted with a wood plug and cutting bit. The cutting bit immediately destroyed the top five feet of well casing as the augers turned and proceeded downward. Then, the resultant top five feet of open borehole was grouted and topped off. Approximately, two 47-pound bags of Portland cement were mixed with ~6-7-gallons of potable water making a total of approximately 12-14 gallons of grout for each well. Surface restoration was completed by matching the existing surface with concrete for each well.

Please call or email any questions concerning this Well Completion Report.

Respectfully,
PSC Industrial Outsourcing, LP



Paul Anderson

Date

Project Manager

2016_03_22 - Well Destruction & DWR Report - ACEHS.doc

c.c. Kacey Fung – Bimbo Bakeries USA, Inc., 8550 W. Bryn Mawr Ave., Suite 1000, Chicago, IL 60631
Christopher Wolfe – Bimbo Bakeries USA, Inc. 350 Kiwanis Blvd., West Hazleton, PA 18202
Pat Cullen – State Water Resources Control Board, UST Clean Up Fund (via GeoTracker)
GeoTracker

ATTACHMENTS:

1. DWR Well Destruction Completion Reports
(Includes: Figures, Field Notes, Original Boring Logs, and DWR Well Installation Completion Reports)
2. ACPHA – Well Destruction Permits
3. SWRCB Order WQ 2015-0161-UST
4. Waste Disposal Manifest

ATTACHMENT 1

DWR – WELL DESTRUCTION COMPLETION REPORTS

**(INCLUDES: FIGURES,
ORIGINAL BORING & WELL CONSTRUCTION LOGS,
AND
ORIGINAL DWR WELL INSTALLATION COMPLETION REPORTS)**



PSC Industrial Outsourcing, LP
 210 West Sand Bank Road
 Columbia, Illinois 62236

Phone: 618-281-1543 FAX: 618-281-7020

- LETTER OF TRANSMITTAL -

TO: Ms. Lindsay Furuyama
 Water Resources Section – WCR-Form
 Alameda County Public Works Agency

 399 Elmhurst Street
 Hayward, California 94544

 (925) 956-2311

DATE: March 22, 2016
PROJECT NUMBER: 624-0908-0043-J0006
PROJECT SITE: Bimbo Bakeries USA, Inc.
 955 Kennedy Street
 Oakland, California 94606

Fund Claim #: 4424
GeoTracker #: T0600177342
ACEH Case #: RO-0002569

Enclosed

NUMBER OF COPIES	DESCRIPTION
1	<i>DWR Well Completion Report (Well Destruction and Closure)</i>

On behalf of Bimbo Bakeries USA, Inc. (BBU), PSC Industrial Outsourcing, LP (PSC) has enclosed a copy of the *Well Completion Report* for the above referenced facility. This report was prepared upon properly destroying the monitoring wells and upon the proper disposal of the three drums of well destruction wastes, as the final step in receiving Case Closure, at the request of the State Water Resources Control Board Order (WQ 2015-0161-UST). Site figures, original geologic/well construction logs, original DWR-188 Well Completion Reports, and the current DWR Well Completion Reports for the well destructions are included. Please call with any questions concerning this report.

ORIGINAL FORWARDED TO:

Ms. Lindsay Furuyama – ACPHA
COPY FORWARDED TO:
Mr. Oleg Yakimov – DWR
Ms. Karel Detterman – ACEHD (GeoTracker)
Mr. Pat Cullen – SWRCB (GeoTracker)
Ms. Kacey Fung – BBU
Mr. Christopher Wolfe – BBU

FROM: Paul Anderson
TITLE: Project Manager

Paul Anderson

File Original with DWR

State of California
Well Completion Report

Refer to Instruction Pamphlet
No. e0301802

Page 1 of 1

Owner's Well Number MW-101

Date Work Began 01/27/2016

Date Work Ended 1/27/2016

Local Permit Agency Alameda County Public Works Agency

Permit Number W2016-0033

Permit Date 1/25/16

DWR Use Only - Do Not Fill In

State Well Number/Site Number _____

Latitude _____ N _____ W _____

Longitude _____

APN/TRS/Other _____

Geologic Log		
Orientation <input checked="" type="radio"/> Vertical <input type="radio"/> Horizontal <input type="radio"/> Angle Specify _____		
Drilling Method <u>Hollow Stem Auger</u> Drilling Fluid <u>None</u>		
Depth from Surface	Description	
Feet to Feet	Describe material, grain size, color, etc	
0 to 28	See Geologic Log / Well Construction Diagram.	
	Original boring to 28.1' bgs with well set at 28.1' bgs. Over-drilled well to boring depth of 28.1' bgs, using 8" (OD) hollow-stem augers and inner stinger rods to depth. Removed / destroyed entire pvc well, consisting of 18' casing and 10' screen.	
	Grout: Mixed batches of approximately ten 47-lb bags of neat portland cement to approximately 30-gallons potable water (approximately 60-gallons Tremmie feed grout through tremmie pipe from approximately 28.1' bgs to 23' bgs. Then, tremmie feed grout through augers from approximately 23' bgs to surface.	
	Surface Restoration: Concrete patch.	
Total Depth of Boring <u>28.1</u> Feet		
Total Depth of Completed Well <u>0</u> Feet		

Well Owner	
Name	<u>Bimbo Bakeries USA, Inc.</u>
Mailing Address	<u>350 Kiwanis Blvd.</u>
City	<u>West Hazleton</u> State <u>PA</u> Zip <u>18202</u>
Well Location	
Address <u>955 Kennedy Street</u>	
City	<u>Oakland</u> County <u>Alameda</u>
Latitude	_____ N _____ W _____
Datum	<u>NAD83</u> Decimal Lat. <u>37.7786814</u> Decimal Long. <u>-122.2400</u>
APN Book	_____ Page _____ Parcel _____
Township	_____ Range _____ Section _____

Location Sketch	Activity
(Sketch must be drawn by hand after form is printed.)	<input type="radio"/> New Well <input type="radio"/> Modification/Repair <input type="radio"/> Deepen <input type="radio"/> Other _____ <input checked="" type="radio"/> Destroy <small>Describe procedures and materials under "GEOLOGIC LOG"</small>
North	Planned Uses <input type="radio"/> Water Supply <input type="checkbox"/> Domestic <input type="checkbox"/> Public <input type="checkbox"/> Irrigation <input type="checkbox"/> Industrial <input type="radio"/> Cathodic Protection <input type="radio"/> Dewatering <input type="radio"/> Heat Exchange <input type="radio"/> Injection <input checked="" type="radio"/> Monitoring <input type="radio"/> Remediation <input type="radio"/> Sparging <input type="radio"/> Test Well <input type="radio"/> Vapor Extraction <input type="radio"/> Other _____
West	
East	
South	
<small>Illustrate or describe distance of well from roads, buildings, fences, rivers, etc. and attach a map. Use additional paper if necessary. Please be accurate and complete.</small>	

Water Level and Yield of Completed Well	
Depth to first water	_____ (Feet below surface)
Depth to Static	_____
Water Level	_____ (Feet) Date Measured _____
Estimated Yield *	_____ (GPM) Test Type _____
Test Length	_____ (Hours) Total Drawdown _____ (Feet)
*May not be representative of a well's long term yield.	

Casings							
Depth from Surface	Borehole Diameter	Type	Material	Wall Thickness	Outside Diameter	Screen Type	Slot Size if Any
Feet to Feet	(Inches)			(Inches)	(Inches)		(Inches)

Annular Material		
Depth from Surface	Fill	Description
Feet to Feet		

Attachments
<input checked="" type="checkbox"/> Geologic Log
<input checked="" type="checkbox"/> Well Construction Diagram
<input type="checkbox"/> Geophysical Log(s)
<input type="checkbox"/> Soil/Water Chemical Analyses
<input checked="" type="checkbox"/> Other <u>Site Well Location Figure</u>
<small>Attach additional information, if it exists.</small>

Certification Statement	
I, the undersigned, certify that this report is complete and accurate to the best of my knowledge and belief	
Name	<u>Chris Pinner, Gregg Drilling & Testing, Inc.</u>
<small>Person, Firm or Corporation</small>	
Address	<u>950 Howe Road</u> <u>Martinez</u> <u>CA</u> <u>94553</u>
City	<u>3/2/16</u> <u>C57-485165</u>
State	Zip
Zip	State
Date Signed	C-57 License Number
C-57 Licensed Water Well Contractor	

File Original with DWR

Page 1 of 1

Owner's Well Number MW-102

Date Work Began 01/27/2016

Date Work Ended 1/27/2016

Local Permit Agency Alameda County Public Works Agency

Permit Number W2016-0034

Permit Date 1/25/16

State of California

Well Completion Report

Refer to Instruction Pamphlet

No. **e0301814**

DWR Use Only - Do Not Fill In			
State Well Number/Site Number			
Latitude		Longitude	
APN/TRS/Other			

Geologic Log		
Orientation <input checked="" type="radio"/> Vertical <input type="radio"/> Horizontal <input type="radio"/> Angle Specify _____		
Drilling Method <u>Hollow Stem Auger</u> Drilling Fluid <u>None</u>		
Depth from Surface	Description	
Feet to Feet	Describe material, grain size, color, etc	
0 to 28	See Geologic Log / Well Construction Diagram.	
	Original boring to 28.4' bgs with well set at 28.4' bgs. Pressure grouted well while maintaining 25 psi. Overdrilled/destroyed top 5' of well casing using 8" (OD) hollow-stem auger and inner plug / cutter. Added additional grout to surface.	
	Grout: Mixed batches of approximately two 47-lb bags of neat portland cement to approximately 7-gallons potable water (approximately 14-gallons). Pressure grout through tremmie pipe from approximately 28.4' bgs to 5' bgs. Then, gravity feed grout from 5' bgs to surface.	
	Surface Restoration: Concrete patch.	
Total Depth of Boring <u>28.4</u> Feet		
Total Depth of Completed Well <u>0</u> Feet		

Well Owner		
Name <u>Bimbo Bakeries USA, Inc.</u>		
Mailing Address <u>350 Kiwanis Blvd.</u>		
City <u>West Hazleton</u>	State <u>PA</u>	Zip <u>18202</u>

Well Location		
Address <u>955 Kennedy Street</u>		
City <u>Oakland</u>	County <u>Alameda</u>	
Latitude _____ N	Longitude _____ W	
Dec. Min. Sec.	Dec. Min. Sec.	Dec. Min. Sec.
Datum <u>NAD83</u>	Decimal Lat. <u>37.7789004</u>	Decimal Long. <u>-122.2400</u>
APN Book _____	Page _____	Parcel _____
Township _____	Range _____	Section _____

Location Sketch	Activity
(Sketch must be drawn by hand after form is printed.)	<input type="radio"/> New Well <input type="radio"/> Modification/Repair <input type="radio"/> Deepen <input type="radio"/> Other <input checked="" type="radio"/> Destroy <small>Describe procedures and materials under "GEOLOGIC LOG"</small>
North	
South	
West	
East	
<small>Illustrate or describe distance of well from roads, buildings, fences, rivers, etc. and attach a map. Use additional paper if necessary. Please be accurate and complete.</small>	Planned Uses <input type="radio"/> Water Supply <input type="checkbox"/> Domestic <input type="checkbox"/> Public <input type="checkbox"/> Irrigation <input type="checkbox"/> Industrial <input type="radio"/> Cathodic Protection <input type="radio"/> Dewatering <input type="radio"/> Heat Exchange <input type="radio"/> Injection <input checked="" type="radio"/> Monitoring <input type="radio"/> Remediation <input type="radio"/> Sparging <input type="radio"/> Test Well <input type="radio"/> Vapor Extraction <input type="radio"/> Other

Water Level and Yield of Completed Well	
Depth to first water _____	(Feet below surface)
Depth to Static _____	
Water Level _____	(Feet) Date Measured _____
Estimated Yield * _____	(GPM) Test Type _____
Test Length _____	(Hours) Total Drawdown _____ (Feet)
*May not be representative of a well's long term yield.	

Casings							
Depth from Surface	Borehole Diameter	Type	Material	Wall Thickness	Outside Diameter	Screen Type	Slot Size if Any
Feet to Feet	(Inches)			(Inches)	(Inches)		(Inches)

Annular Material		
Depth from Surface	Fill	Description
Feet to Feet		

Attachments
<input checked="" type="checkbox"/> Geologic Log <input checked="" type="checkbox"/> Well Construction Diagram <input type="checkbox"/> Geophysical Log(s) <input type="checkbox"/> Soil/Water Chemical Analyses <input checked="" type="checkbox"/> Other <u>Site Well Location Figure</u>
<small>Attach additional information, if it exists.</small>

Certification Statement			
I, the undersigned, certify that this report is complete and accurate to the best of my knowledge and belief			
Name <u>Chris Froner, Gregg Drilling & Testing, Inc.</u>			
<small>Person, Firm or Corporation</small>			
<u>950 Howe Road</u>	<u>Martinez</u>	<u>CA</u>	<u>94553</u>
<small>Address</small>	<small>City</small>	<small>State</small>	<small>Zip</small>
Signed <u>[Signature]</u>	<u>3/2/16</u>	<u>C57-485165</u>	<u>C-57 License Number</u>
<small>C-57 Licensed Water Well Contractor</small>	<small>Date Signed</small>	<small>C-57 License Number</small>	

*The free Adobe Reader may be used to view and complete this form. However, software must be purchased to complete, save, and reuse a saved form.

File Original with DWR

State of California

Well Completion Report

Refer to Instruction Pamphlet

No. e0301811

Page 1 of 1

Owner's Well Number MW-103

Date Work Began 01/27/2016

Date Work Ended 1/27/2016

Local Permit Agency Alameda County Public Works Agency

Permit Number W2016-0035

Permit Date 1/25/16

DWR Use Only - Do Not Fill In

State Well Number/Site Number

Latitude

Longitude

APN/TRS/Other

Geologic Log

Orientation Vertical Horizontal Angle Specify _____

Drilling Method Hollow Stem Auger Drilling Fluid None

Depth from Surface Description
Feet to Feet Describe material, grain size, color, etc

0	25	See Geologic Log / Well Construction Diagram.
		Original boring to 25.0' bgs with well set at 25.0' bgs.
		Pressure grouted well while maintaining 25 psi.
		Overdrilled/destroyed top 5' of well casing using
		8" (OD) hollow-stem auger and inner plug / cutter.
		Added additional grout to surface.
		Grout: Mixed batches of approximately two
		47-lb bags of neat portland cement to approximate
		6-gallons potable water (approximately 12-gallons)
		Pressure grout through tremmie pipe from
		approximately 25.0' bgs to 5' bgs. Then, gravity
		feed grout from 5' bgs to surface.
		Surface Restoration: Concrete patch.

Total Depth of Boring 25.0 Feet

Total Depth of Completed Well 0 Feet

Well Owner

Name Bimbo Bakeries USA, Inc.

Mailing Address 350 Kiwanis Blvd.

City West Hazleton State PA Zip 18202

Well Location

Address 955 Kennedy Street

City Oakland County Alameda

Latitude _____ N Longitude _____ W
Dec. Min. Sec. Dec. Min. Sec.

Datum NAD83 Decimal Lat. 37.7789437 Decimal Long. -122.2399

APN Book _____ Page _____ Parcel _____

Township _____ Range _____ Section _____

Location Sketch

(Sketch must be drawn by hand after form is printed.)

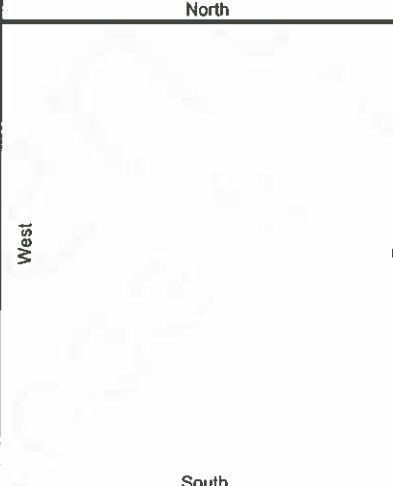

Illustrate or describe distance of well from roads, buildings, fences, rivers, etc. and attach a map. Use additional paper if necessary. Please be accurate and complete.

Activity

- New Well
- Modification/Repair
 - Deepen
 - Other _____
- Destroy

Describe procedures and materials under "GEOLOGIC LOG"

Planned Uses

- Water Supply
 - Domestic Public
 - Irrigation Industrial
- Cathodic Protection
- Dewatering
- Heat Exchange
- Injection
- Monitoring
- Remediation
- Sparging
- Test Well
- Vapor Extraction
- Other _____

Water Level and Yield of Completed Well

Depth to first water _____ (Feet below surface)

Depth to Static _____

Water Level _____ (Feet) Date Measured _____

Estimated Yield * _____ (GPM) Test Type _____

Test Length _____ (Hours) Total Drawdown _____ (Feet)

*May not be representative of a well's long term yield.

Casings

Depth from Surface Feet to Feet	Borehole Diameter (Inches)	Type	Material	Wall Thickness (Inches)	Outside Diameter (Inches)	Screen Type	Slot Size if Any (Inches)

Annular Material

Depth from Surface Feet to Feet	Fill	Description

Attachments

- Geologic Log
- Well Construction Diagram
- Geophysical Log(s)
- Soil/Water Chemical Analyses
- Other Site Well Location Figure

Attach additional information, if it exists.

Certification Statement

I, the undersigned, certify that this report is complete and accurate to the best of my knowledge and belief

Name Chris Pruner, Gregg Drilling & Testing, Inc.

Person, Firm or Corporation

950 Howe Road

Martinez

CA 94553

Signed _____

C-57 Licensed Water Well Contractor

3/2/16

Date Signed

C57-485165

C-57 License Number

File Original with DWR

Well Completion Report

State of California

Refer to Instruction Pamphlet
No. e0301812

DWR Use Only - Do Not Fill In			
State Well Number/Site Number			
Latitude		Longitude	
APN/TRS/Other			

Page 1 of 1

Owner's Well Number MW-104

Date Work Began 01/27/2016 Date Work Ended 1/27/2016

Local Permit Agency Alameda County Public Works Agency

Permit Number W2016-0036 Permit Date 1/25/16

Geologic Log		
Orientation <input checked="" type="radio"/> Vertical <input type="radio"/> Horizontal <input type="radio"/> Angle Specify _____		
Drilling Method <u>Hollow Stem Auger</u>		Drilling Fluid <u>None</u>
Depth from Surface	Description	
Feet to Feet	Describe material, grain size, color, etc	
0	25	See Geologic Log / Well Construction Diagram.
		Original boring to 25.1' bgs with well set at 25.1' bgs.
		Pressure grouted well while maintaining 25 psi.
		Overdrilled/destroyed top 5' of well casing using
		8" (OD) hollow-stem auger and inner plug / cutter.
		Added additional grout to surface.
		Grout: Mixed batches of approximately two
		47-lb bags of neat portland cement to approximate
		6-gallons potable water (approximately 12-gallons)
		Pressure grout through tremmie pipe from
		approximately 25.1' bgs to 5' bgs. Then, gravity
		feed grout from 5' bgs to surface.
		Surface Restoration: Concrete patch.
Total Depth of Boring <u>25.1</u> Feet		
Total Depth of Completed Well <u>0</u> Feet		

Well Owner		
Name <u>Bimbo Bakeries USA, Inc.</u>		
Mailing Address <u>350 Kiwanis Blvd.</u>		
City <u>West Hazleton</u>	State <u>PA</u>	Zip <u>18202</u>
Well Location		
Address <u>955 Kennedy Street</u>		
City <u>Oakland</u>	County <u>Alameda</u>	
Latitude _____ N	Longitude _____ W	
Dec. _____ Min. _____ Sec. _____	Dec. _____ Min. _____ Sec. _____	
Datum <u>NAD83</u> Decimal Lat. <u>37.7788276</u> Decimal Long. <u>-122.2399</u>		
APN Book _____	Page _____	Parcel _____
Township _____	Range _____	Section _____

Location Sketch	
(Sketch must be drawn by hand after form is printed.)	
North	South
West	East
Illustrate or describe distance of well from roads, buildings, fences, rivers, etc. and attach a map. Use additional paper if necessary. Please be accurate and complete.	

Activity	
<input type="radio"/> New Well <input type="radio"/> Modification/Repair <input type="radio"/> Deepen <input type="radio"/> Other _____ <input checked="" type="radio"/> Destroy <small>Describe procedures and materials under "GEOLOGIC LOG"</small>	
Planned Uses	
<input type="radio"/> Water Supply <input type="checkbox"/> Domestic <input type="checkbox"/> Public <input type="checkbox"/> Irrigation <input type="checkbox"/> Industrial <input type="radio"/> Cathodic Protection <input type="radio"/> Dewatering <input type="radio"/> Heat Exchange <input type="radio"/> Injection <input checked="" type="radio"/> Monitoring <input type="radio"/> Remediation <input type="radio"/> Sparging <input type="radio"/> Test Well <input type="radio"/> Vapor Extraction <input type="radio"/> Other _____	

Water Level and Yield of Completed Well	
Depth to first water _____ (Feet below surface)	
Depth to Static _____	
Water Level _____ (Feet)	Date Measured _____
Estimated Yield * _____ (GPM)	Test Type _____
Test Length _____ (Hours)	Total Drawdown _____ (Feet)
*May not be representative of a well's long term yield.	

Casings								Annular Material		
Depth from Surface	Borehole Diameter	Type	Material	Wall Thickness	Outside Diameter	Screen Type	Slot Size if Any	Depth from Surface	Fill	Description
Feet to Feet	(Inches)			(Inches)	(Inches)		(Inches)	Feet to Feet		

Attachments	
<input checked="" type="checkbox"/> Geologic Log	<input checked="" type="checkbox"/> Well Construction Diagram
<input type="checkbox"/> Geophysical Log(s)	<input type="checkbox"/> Soil/Water Chemical Analyses
<input checked="" type="checkbox"/> Other <u>Site Well Location Figure</u>	
Attach additional information, if it exists.	

Certification Statement			
I, the undersigned, certify that this report is complete and accurate to the best of my knowledge and belief			
Name <u>Chris Pruner, Gregg Drilling & Testing, Inc.</u>			
<small>Person, Firm or Corporation</small>			
<u>950 Howe Road</u>	<u>Martinez</u>	<u>CA</u>	<u>94553</u>
<small>Address</small>		<small>City</small>	<small>State Zip</small>
Signed <u>RS MOJ</u>	<u>3/2/16</u>	<u>C57-485165</u>	
<small>C-57 Licensed Water Well Contractor</small>		<small>Date Signed</small>	<small>C-57 License Number</small>

2315944



Stericycle
Environmental Solutions

SHIPPING PAPER

Lading Manifest: 865557-16

WP# 94925

SHIPPER / CUSTOMER EARTH GRAINS BAKING COMPANIES INC		DELIVERY DATE	JOB #2315944
ADDRESS 955 KENNEDY ST.		POINT OF CONTACT	
CITY, STATE, ZIP OAKLAND CA 94605		PHONE #	
CARRIER / TRANSPORTER STERICYCLE SPECIALTY WASTE		PHONE # (612)285-9865	
CONSIGNEE / FACILITY 21ST CENTURY ENVIRONMENTAL		POINT OF CONTACT	
ADDRESS 2095 NEWLANDS DRIVE EAST		PHONE # (775)575-2760	
CITY, STATE, ZIP FERNLEY , NV 89408			

HM	US DOT Description (Including Proper Shipping Name, Hazard Class, and ID Number)	Containers		Total Quantity	UOM
		No.	Type		
A	NON-HAZARDOUS WASTE, SOLID (CONCRETE WASTE)	01	DM	900	P
B	NON-HAZARDOUS WASTE, SOLID (DESTRUCTION DEBRIS)	01	DM	700	P
C	NON-HAZARDOUS WASTE, LIQUID (POTABLE WATER)	01	DM	55	P G
D	<p style="text-align: center;">21st CEM of Nevada has the appropriate permits(s) for, and will accept the waste this generator is shipping.</p>				

Special Handling Instruction and Additional Information:

a) 748802-00 - CONSTRUCTION DEBRIS - LF01 (1) b) 748803-00 - WELL DESTRUCTION DEBRIS - LF01 (2) c) 748804-00 - POTABLE WATER - STABDI (3)

2 NT TRANS, PONDAL SST R. HARTMAN Ref 02/29/16

Placards Provided YES _____ NO _____

SHIPPER'S CERTIFICATION: "I hereby declare that the contents of this consignment are fully and accurately described above by proper shipping name and are classified, packaged, marked and labelled/placarded, and are in all respects in proper condition for transport according to applicable international and national governmental regulations." also certify that all times listed above are true and correct.

SHIPPER) PRINT OR TYPE NAME Diana Merino	SIGNATURE <i>Diana Merino</i>	MONTH 2	DAY 22	YEAR 16
CARRIER/TRANSPORTER) PRINT OR TYPE NAME Jesus Garcia	SIGNATURE <i>Jesus Garcia</i>	MONTH 02	DAY 22	YEAR 16
CONSIGNEE/FACILITY) PRINT OR TYPE NAME RICHARD HARTMAN	SIGNATURE <i>R. Hartman</i>	MONTH 03	DAY 29	YEAR 16

CONSIGNEE MAR 01 2016



WELL DESTRUCTION FIELD NOTES

Today's Date: 1 / 27 / 2016

Project Name: Bimbo Bakeries - Oakland (Well Destruction)

Project #: 624-0908-0043-J0006

Client: Bimbo Bakeries USA, Inc.

Project Mgr.: Paul Anderson

Site Location: Former Earthgrains Baking Companies, Inc.

Geologist: Paul Anderson

Site Address: 955 Kennedy Street, Oakland, CA 94606

Method: Over-Drill & Pressure Grout

Drilling Co.: Gregg Drilling & Testing, Inc.

Drillers Name: Vince Pokrywka

Paving Co.: Gregg Drilling & Testing, Inc.

Pavers Name: Brandon Moses

7:00	Gregg Drilling, SubDynamic Utility Locators, and Osborne Coring arrived on site. Checked in with facility guard.
-7:45	Held LPSA, health and safety, and work plan approach meeting with subcontractors.
7:45 - 9:00	SubDynamic reviewed the USA utility markings and performed the third-party utility locating confirming acceptable clearance to well locations.
7:45 - 14:00	Osborne performed the concrete coring in preparation for surface restoration. 25 gallons of potable water was generated during the coring.
9:00	MW-101: Gregg Drilling setup and start well destruction by over-drilling via hollow-stem augers adapted with "A" rods to well depth.
9:30	Jose Ambritz of the Alameda County Public Works Agency on site for the well destruction grouting procedures, & approved pressure grouting.
	Upon well casing removal, Gregg completed the grouting via gravity feed through the open augers using ten 47lb bags of portland cement in 30-gallons of potable water. Upon grout completion, all augers were removed and the remaining open hole was topped off.
12:30	MW-102: Gregg Drilling setup and started pressure grouting well using tremmie pipe and maintaining ~25 psi.
	The top 5 feet of casing was over-drilled and the open hole was topped off. Two 47 lb bags in 7 gallons of water (14 gallons mixed) was used.
13:15	MW-104: Gregg Drilling setup and started pressure grouting well using tremmie pipe and maintaining ~25 psi.
	The top 5 feet of casing was over-drilled and the open hole was topped off. Two 47 lb bags in 6 gallons of water (12 gallons mixed) was used.
14:00	MW-103: Gregg Drilling setup and started pressure grouting well using tremmie pipe and maintaining ~25 psi.
	The top 5 feet of casing was over-drilled and the open hole was topped off. Two 47 lb bags in 6 gallons of water (12 gallons mixed) was used.
15:00	Upon completion of all well destructions, surface restoration was completed using concrete.

Notes: Generated 1 - 55-gallon drum of solid/slurry over-drill waste; 1 - 55-gallon drum of concrete debris; and 25-gallons of potable water waste from concrete coring.

ft. bgs: feet below ground surface

WL dtw toc: Water Level - depth to water below top of casing

Destruction: Pressure Grout and/or HS Augers over-drill / remove well materials

Grout Type: Portland neat cement (total depth to surface)

Grout Mixture: 47 lbs. Portland to 2-4 gallons potable water (or 94 lb bags to 4.5-6.5 gallons)

Grout Installed: **TF** = Tremmie Feed, **GF** = Gravity Feed, **Through:** **A** = Auger, **TP** = Tremmie Pipe, **OH** = Open Hole

Surface Patch: Surface Core 16" diameter area around vault - replace with concrete

Surface Restoration Method & Type: **OC** = Osborne Coring, **CC** = Concrete



WELL DESTRUCTION SUMMARY TABLE

Dates: 1 / 27 / 2016

Project Name: Bimbo Bakeries - Oakland (Well Destruction)

Project #: 624-0908-0043-J0006

Client: Bimbo Bakeries USA, Inc.

Project Mgr.: Paul Anderson

Site Location: Former Earthgrains Baking Companies, Inc.

On-Site: Paul Anderson

Site Address: 955 Kennedy Street, Oakland, CA 94606

Method: Over-Drill & Pressure Grout

Drilling Co.: Gregg Drilling & Testing, Inc.

Drillers Name: Vince Pokrywka

Paving Co.: Gregg Drilling & Testing, Inc.

Pavers Name: Brandon Moses

Well ID	Well Diameter (inches)	Installed Depth (ft. bgs)	~WL (dtw toc)	Date Destruction Completed	Start Time	End Time	Over-Drill Auger Dia. (inches)	Over-Drill Depth (ft. bgs)	Pressure Grout at Depth	Total Grout Used (bags / gallons)	Destruction, Grouting, Surface Restoration, # Drums & Comments
MW-101	2"	28.1'	~18'	1/27/2016	09:00	11:00	8"	28.1'	na	10 / 30 = 60	SR / TF-A, GF-A / OC / CC
MW-102	2"	28.4'	~18'	1/27/2016	12:30	13:15	8"	5'	28.4'	2 / 7 = 14	PG / TP / SR/ GF-OH / OC / CC
MW-103	2"	25.0'	~18'	1/27/2016	14:00	14:45	8"	5'	25.0'	2 / 6 = 12	PG / TP / SR/ GF-OH / OC / CC
MW-104	2"	25.1'	~18'	1/27/2016	13:15	14:00	8"	5'	25.1'	2 / 6 = 12	PG / TP / SR/ GF-OH / OC / CC
Comments:	Generated 1 - 55-gallon drum of solid/slurry over-drill waste; 1 - 55-gallon drum of concrete debris; and approximately 25-gallons of potable water waste from concrete coring.										

Notes:

ft. bgs: feet below ground surface

WL dtw toc: Water Level - depth to water below top of casing

Destruction: Pressure Grout Or HS Augers over-drill / remove well materials (**PG** - Pressure Grout, **SR** - Stinger Rods, **DS** - Disposable Stinger w/ Wood Plug/Cutter, **OA** - Over-sized Augers / no stinger)

Grout Type: Portland neat cement (total depth to surface)

Grout Mixture: 47 lbs. Portland to 2-4 gallons potable water (or 94 lb bags to 4.5-6.5 gallons)

Grout Installed: Tremmie Feed when >30' - Gravity Feed when <30' **TF** = Tremmie Feed, **GF** = Gravity Feed, **Through:** **A** = Auger, **TP** = Tremmie Pipe, **OH** = Open Hole

Surface Patch: Surface Core 16" diameter area around vault OR Saw Cut - Hot Roll Asphalt, Hot Seal Joints, AND/OR replace with concrete (black or natural)

Sidewalk Patch: NA - Concrete - In sections, perforated edge to edge

Surface Restoration Method & Type: **OC** = Osborne Coring, **SC** = Saw Cut, **AP** = Asphalt, **CC** = Concrete, **SL** = Natural Soil Surface

Comments: Generated 1 - 55-gallon drum of solid/slurry over-drill waste; 1 - 55-gallon drum of concrete debris; and approximately 25-gallons of potable water waste from concrete coring.

CALIFORNIA



ALAMEDA COUNTY

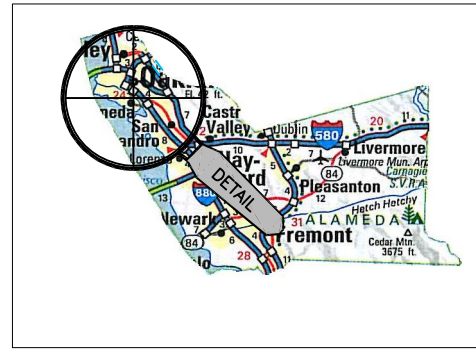

AREA IN DETAIL

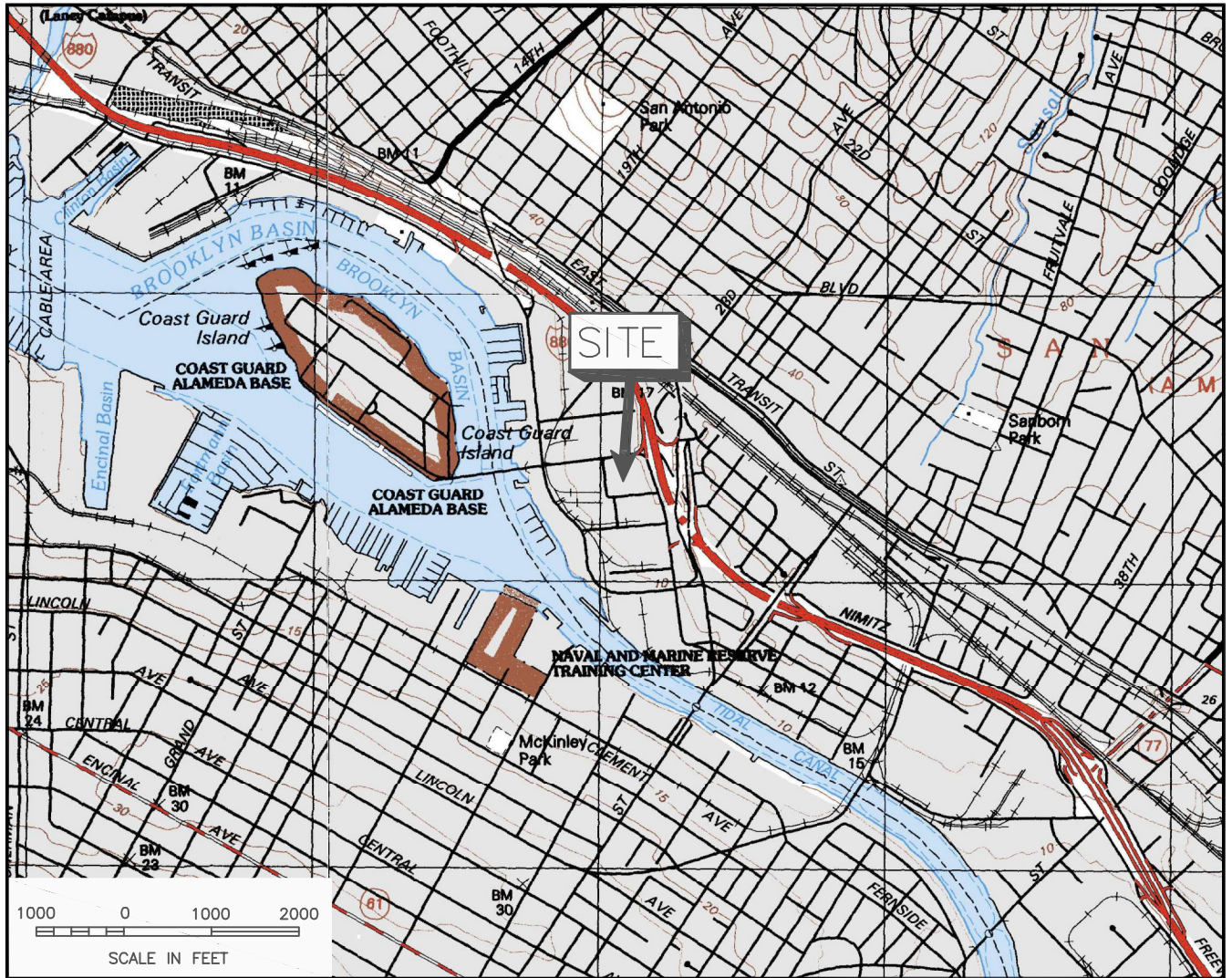

Modified from U.S. Geological Survey, Oakland East & West, California, quadrangle, Photorevised 1997 & 1993.

SCALE IS VARIABLE



COL 624\02797C-002



TITLE:
 SITE LOCATION MAP
 955 KENNEDY STREET
 OAKLAND, CALIFORNIA 94606

DWN: TMM
 DES.: JRC
 CHKD:
 APPD:
 DATE: 11/18/08
 REV.: 0

PROJECT NO.: 62402797
 EARTHGRAINS
 OAKLAND, CALIFORNIA

FIGURE 1

KING STREET

4-INCH
SANITARY
SEWER
CUT AND
CAPPED

ABANDONED
SANITARY SEWER AND
AIR LINE
CUT AND CAPPED

BACKFILLED
SOURCE
AREA
REMOVAL
EXCAVATION

MW-103

MW-102

PLANT

MW-104

MW-101

LEGEND

⊕ MONITORING WELL LOCATION



TITLE:
MONITORING WELL LOCATION MAP
POST SOURCE REMOVAL

DWN: TMM	DES.: JRC
CHKD:	APPD:
DATE: 8/25/11	REV.: 0

PROJECT NO.: 62402797
EARTHGRAINS
OAKLAND, CALIFORNIA

FIGURE 2

ORIGINAL

GEOLOGIC

AND

WELL INSTALLATION CONSTRUCTION

LOGS

File Original with DWR

State of California

Well Completion Report

Refer to Instruction Pamphlet
No. e0086801

Page 1 of 1

Owner's Well Number MW-101

Date Work Began 01/19/2009 Date Work Ended 1/19/2009

Local Permit Agency Alameda County Public Works Agency

Permit Number W2008-0965 Permit Date 12/18/08

DWR Use Only - Do Not Fill In			
State Well Number/Site Number			
Latitude	N	Longitude	W
APN/TRS/Other			

Geologic Log		
Orientation <input checked="" type="radio"/> Vertical <input type="radio"/> Horizontal <input type="radio"/> Angle Specify _____		
Drilling Method <u>Hollow-Stem Auger</u> Drilling Fluid <u>None</u>		
Depth from Surface	Feet to Feet	Description
		Describe material, grain size, color, etc
Total Depth of Boring <u>28.10</u> Feet		
Total Depth of Completed Well <u>28.05</u> Feet		

Well Owner	
Name <u>Earthgrains Baking Companies, Inc.</u>	
Mailing Address <u>955 Kennedy Street</u>	
City <u>Oakland</u> State <u>CA</u> Zip <u>94606</u>	
Well Location	
Address <u>955 Kennedy Street</u>	
City <u>Oakland</u> County <u>Alameda</u>	
Latitude _____ N Longitude _____ W	
Datum <u>NAD83</u> Decimal Lat. <u>37.7786814</u> Decimal Long. <u>-122.2400</u>	
APN Book _____ Page _____ Parcel _____	
Township _____ Range _____ Section _____	
Location Sketch	Activity
(Sketch must be drawn by hand after form is printed.)	<input checked="" type="radio"/> New Well
North	<input type="radio"/> Modification/Repair
<div style="display: flex; justify-content: space-between;"> West East </div>	<input type="radio"/> Deepen
	<input type="radio"/> Other _____
	<input type="radio"/> Destroy
	<small>Describe procedures and materials under "GEOLOGIC LOG"</small>
	Planned Uses
<input type="radio"/> Water Supply	<input type="checkbox"/> Domestic <input type="checkbox"/> Public
<input type="checkbox"/> Cathodic Protection	<input type="checkbox"/> Irrigation <input type="checkbox"/> Industrial
<input type="checkbox"/> Dewatering	<input type="radio"/> Monitoring
<input type="checkbox"/> Heat Exchange	<input type="radio"/> Remediation
<input type="checkbox"/> Injection	<input type="radio"/> Sparging
<input type="checkbox"/> Vapor Extraction	<input type="radio"/> Test Well
<input type="checkbox"/> Other _____	<input type="radio"/> Other _____
Water Level and Yield of Completed Well	
Depth to first water <u>18</u> (Feet below surface)	
Depth to Static _____	
Water Level <u>10</u> (Feet) Date Measured <u>01/22/2009</u>	
Estimated Yield * _____ (GPM) Test Type _____	
Test Length _____ (Hours) Total Drawdown _____ (Feet)	
*May not be representative of a well's long term yield.	

Casings							
Depth from Surface	Borehole Diameter	Type	Material	Wall Thickness	Outside Diameter	Screen Type	Slot Size if Any
Feet to Feet	(Inches)			(Inches)	(Inches)		(Inches)
0	18	8	Riser	PVC Sch. 40	0.154	2.375	
18	28	8	Screen	PVC Sch. 40	0.154	2.375	Milled Slots 0.010

Annular Material			
Depth from Surface	Fill	Description	
Feet to Feet			
0	14	Cement	Grout
14	16	Bentonite	Seal (3/8" Chips)
16	28	Filter Pack	2/12 Sand

Attachments
<input checked="" type="checkbox"/> Geologic Log <input checked="" type="checkbox"/> Well Construction Diagram <input type="checkbox"/> Geophysical Log(s) <input type="checkbox"/> Soil/Water Chemical Analyses <input checked="" type="checkbox"/> Other <u>Site Map</u>

Certification Statement			
I, the undersigned, certify that this report is complete and accurate to the best of my knowledge and belief			
Name <u>Gregg Drilling & Testing, Inc.</u>			
<small>Person, Firm or Corporation</small>			
<u>950 Howe Road</u>		<u>Martinez</u> <u>CA</u> <u>94553</u>	
<small>Address</small>		<small>City State Zip</small>	
Signed <u>[Signature]</u>		City <u>211710</u> State <u>9485165</u> Zip _____	
<small>C-57 Licensed Water Well Contractor</small>		<small>Date Signed C-57 License Number</small>	



Project:	Earthgrains UST Clean-up	Boring No.:	MW-101	Page(s):	1 of 2
Client:	Earthgrains Baking Companies, Inc.	Project #:	62402797 / 024530	Date:	1/19/2009
Location:	Oakland, CA	Coordinates:	LAT 37.7786814 LON -122.2400025	Datum	NAD 83

BORING/WELL CONSTRUCTION LOG

Drilling Company:	Gregg Drilling & Testing, Inc.	Driller:	Jason Weff	Logger:	Brendon J. Wilder
-------------------	--------------------------------	----------	------------	---------	-------------------

Depth (ft)	SAMPLE TYPE	SAMPLE NUMBER				USCS	PID (ppm)	WELL CONSTRUCTION SUMMARY				
		Blow Counts						Depth (ft)	Casing	Depth (ft)	Annulus	Surface Completion
		1ST 6"	2ND 6"	3RD 6"	4TH 6"							

Description
 Modifier and Main Soil; color; impact; consistency/density; odor; moisture; USCS

Depth (ft)	SAMPLE TYPE	1ST 6"	2ND 6"	3RD 6"	4TH 6"	USCS	PID (ppm)	Description	Surface Vault
0-1								Top 1' concrete	
1-2								Air Knifed/ Hand augered to 5' below ground surface in Pea gravel/fill	
2-3								Drilled borehole using 8" hollow stem augers w/ California Modified Split- Spoon Sampling	
5-6	S.S.	3	4	5		CL	0	SILTY-CLAY w/ trace sand <5% dark brown (5YR 2.5/1) mottled dark grey Soft to firm damp sampled @ 10:30	
9-10	S.S.	4	6	6		CL	0	some sand mottled 5YR 5/6 firm and damp sampled @ 10:35	
14-15	S.S.	5	5	6		CL	0	sampled @ 10:40	
18-19	S.S.	4	4	5		CL	0	water @ approximately 18.5 bgs some gravel (3/8"-1") SANDY-CLAY (7.5YR 5/4) moist to wet and soft sampled @ 10:50	

Notes: Brass sample tubes = 6" in length
 Sand #2/12 Monterrey 50# bags:5.5 Type II-IV cement 94# bags:
 Bentonite chips 3/8" 50lbs bag



Project: Earthgrains UST Clean-up	Boring No.: MW-101	Page(s): 2 of 2
Client: Earthgrains Baking Companies, Inc.	Project #: 62402797 / 024530	Date: 1/19/2009
Location: Oakland, CA	Coordinates: LAT 37.7786814 LON -122.2400025	Datum NAD 83

BORING/WELL CONSTRUCTION LOG

Drilling Company: Gregg Drilling & Testing, Inc.	Driller: Jason Weff	Logger: Brendon J. Wilder
--	-------------------------------	-------------------------------------

Depth (ft)	SAMPLE TYPE	SAMPLE NUMBER	Blow Counts				PID (ppm)	WELL CONSTRUCTION SUMMARY				
			1ST 6"	2ND 6"	3RD 6"	4TH 6"		Depth (ft)	Casing	Depth (ft)	Annulus	Surface Completion
							0 to 18	2" PVC Sch. 40	0 to 14	Type II-IV Cement		
							18 to 28	2" PVC 0.01" Sch. 40	14 to 16	3/8" Bentonite Chips		
									16 to 28	#2/12 Sand		

Description
Modifier and Main Soil; color; impact; consistency/density; odor; moisture; USCS

21-											21-	
22-											22-	
23-											23-	
24-	S.S.		5	5	5	CL	0	SILTY-CLAY w/ some sand trace gravel damp and firm to stiff sampled @ 10:55				24-
25-											25-	
26-											26-	
27-	S.S.		4	7	10	CL	0	mottled dark grey sampled @ 11:00				27-
28-											28-	
29-								NOTES: terminate borehole at 28' bgs @ 11:00 10' PVC screen w/ .010 slot 18' PVC riser				29-
30-											30-	
31-											31-	
32-											32-	
33-											33-	
34-											34-	
35-											35-	
36-											36-	
37-											37-	
38-											38-	
39-											39-	
40-											40-	

Notes: Brass sample tubes = 6" in length
 Sand #2/12 Monterrey 50# bags:5.5 Type II-IV cement 94# bags:
 Bentonite chips 3/8" 50lbs bag

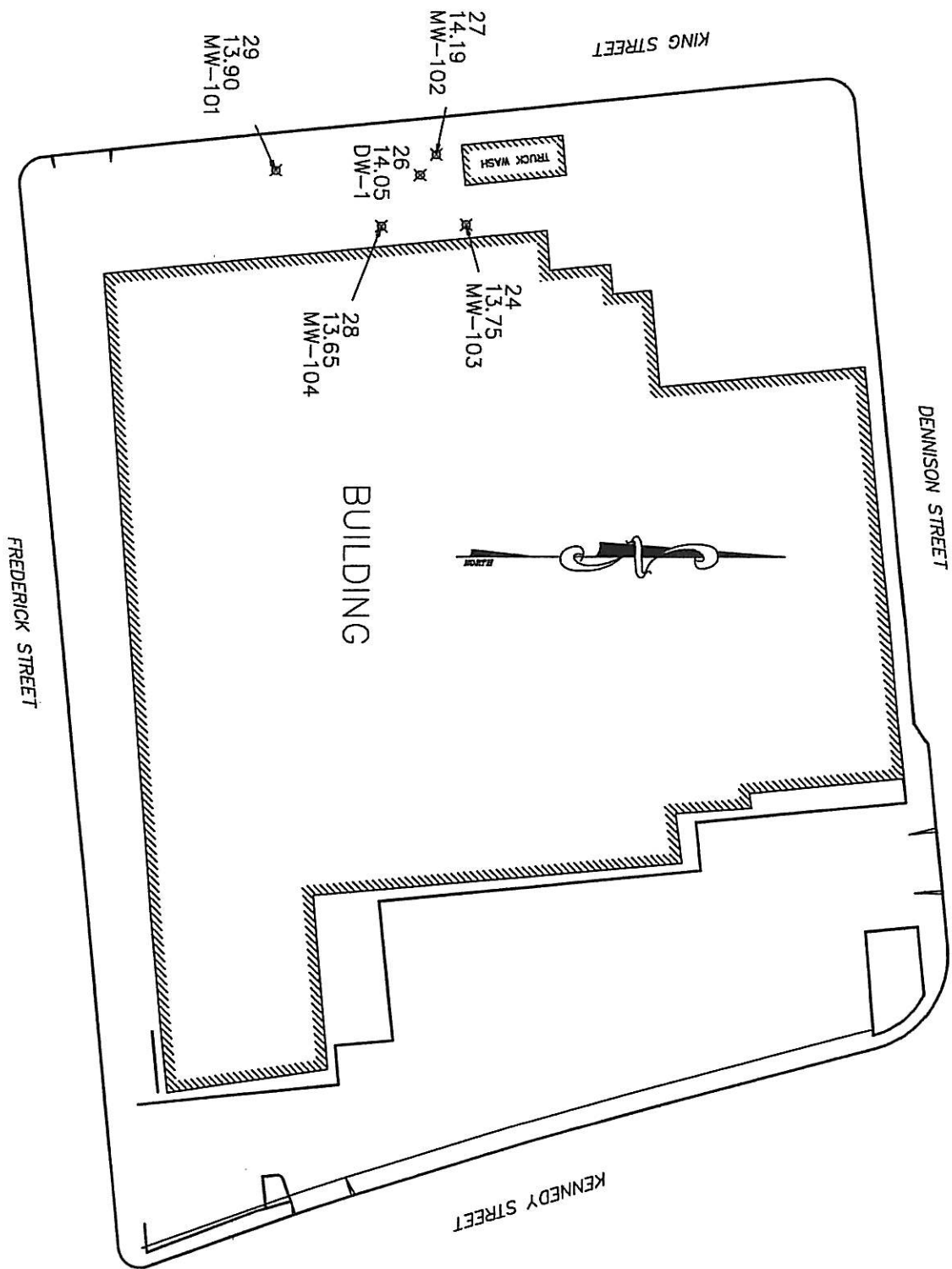

PLS SURVEYS, INC.
 LAND & HYDROGRAPHIC SURVEYORS
 2220 Livingston Street, Suite 202
 Oakland, California 94606-5203
 510.261.0900 FAX 510.261.3303
 e-mail: plssurv@pacbell.net

Earthgrains Site

955 Kennedy St.

OAKLAND

CALIFORNIA

SCALE	1"=80'
DATE	01/28/09
BY	JMB/JTH
JOB NO.	09-001



Project: Earthgrains UST Clean-up	Boring No.: MW-102	Page(s): 1 of 2
Client: Earthgrains Baking Companies, Inc.	Project #: 62402797 / 024530	Date: 1/20/2009
Location: Oakland, CA	Coordinates: LAT 37.7789004 LON -122.2400355	Datum: NAD 83

BORING/WELL CONSTRUCTION LOG

Drilling Company: Gregg Drilling & Testing, Inc.	Driller: Jason Weff	Logger: Brendon J. Wilder
--	-------------------------------	-------------------------------------

Depth (ft)	SAMPLE TYPE	SAMPLE NUMBER	Blow Counts				USCS	PID (ppm)	WELL CONSTRUCTION SUMMARY				Surface Completion
			1ST 6"	2ND 6"	3RD 6"	4TH 6"			Depth (ft)	Casing	Depth (ft)	Annulus	
									0 to 18	2" PVC Sch. 40	0 to 14	Type II-IV Cement	
								18 to 28	2" PVC 0.01" Sch. 40	14 to 16	3/8" Bentonite Chips		
										16 to 28	#2/12 Sand		
Description												Surface Vault	
Modifier and Main Soil; color; impact; consistency/density; odor; moisture; USCS													
0-1													
1-2													
2-3													
3-4													
4-5													
5-6	S.S.		4	5	7		CL	0	SILTY-CLAY very dark greyish-brown (2.5 YR 3/2) mottled dark yellowish brown (10 YR 3/4) Soft to medium stiff damp sampled @ 9:30				
6-7													
7-8													
8-9													
9-10	S.S.		3	4	5		CL	0	5 YR 3/1 with trace coarse-grained angular sand moist and stiff sampled @ 9:35				
10-11													
11-12													
12-13													
13-14													
14-15	S.S.		5	7	7		CL	0	medium stiff w/ less silt% moist to very moist sampled @ 9:40				
15-16													
16-17													
17-18													
18-19	S.S.		3	6	6		CL	0	mottled dark grey sampled @ 9:45				
19-20													

Notes: Brass sample tubes = 6" in length
 Sand #2/12 Monterrey 50# bags:5.5 Type II-IV cement 94# bags:
 Bentonite chips 3/8" 50lbs bag



Project: Earthgrains UST Clean-up		Boring No.: MW-102	Page(s): 2 of 2
Client: Earthgrains Baking Companies, Inc.		Project #: 62402797 / 024530	Date: 1/20/2009
Location: Oakland, CA		Coordinates: LAT 37.7789004 LON -122.2400355	Datum: NAD 83

BORING/WELL CONSTRUCTION LOG

Drilling Company: Gregg Drilling & Testing, Inc.	Driller: Jason Weff	Logger: Brendon J. Wilder
--	-------------------------------	-------------------------------------

WELL CONSTRUCTION SUMMARY

Depth (ft)	Casing	Depth (ft)	Annulus	Surface Completion
0 to 18	2" PVC Sch. 40	0 to 14	Type II-IV Cement	
18 to 28	2" PVC 0.01" Sch. 40	14 to 16	3/8" Bentonite Chips	
		16 to 28	#2/12 Sand	

Description

Modifier and Main Soil; color; impact; consistency/density; odor; moisture; USCS

Depth (ft)	SAMPLE TYPE	SAMPLE NUMBER				PID (ppm)	Description	Surface Completion
		Blow Counts						
		1ST 6"	2ND 6"	3RD 6"	4TH 6"			
21-								
22-								
23-								
24-	S.S.	3	5	6		CL 0	SANDY-CLAY yellowish-brown (7.5 yr 5/6) mottled olive-grey sampled @ 9:50	
25-								
26-								
27-	S.S.	9	7	6		CL 0	Gravelly-Sand w/some clay stiff very moist to wet sampled @ 10:00	
28-								
29-							NOTES: terminate borehole at 28' bgs @ 10:00 10' PVC screen w/ .010 slot 18' PVC riser	
30-								
31-								
32-								
33-								
34-								
35-								
36-								
37-								
38-								
39-								
40-								

Notes: Brass sample tubes = 6" in length
 Sand #2/12 Monterrey 50# bags:5.5 Type II-IV cement 94# bags:
 Bentonite chips 3/8" 50lbs bag

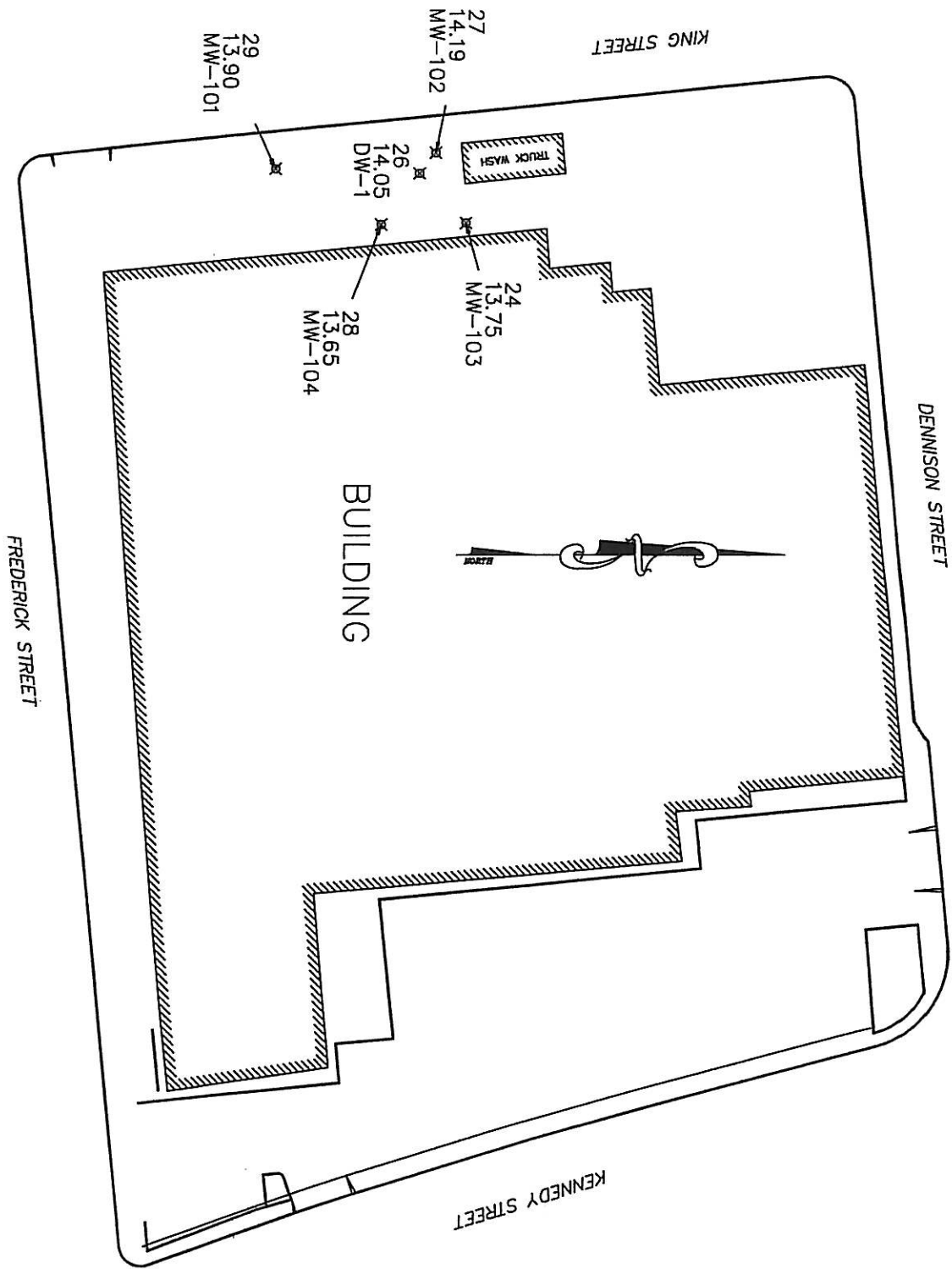

PLS SURVEYS, INC.
 LAND & HYDROGRAPHIC SURVEYORS
 2220 Livingston Street, Suite 202
 Oakland, California 94606-5203
 510.261.0900 FAX 510.261.3303
 e-mail: plssurv@pacbell.net

Earthgrains Site

955 Kennedy St.

OAKLAND

CALIFORNIA

SCALE	1"=80'
DATE	01/28/09
BY	JMB/JTH
JOB NO.	09-001



Project:	Earthgrains UST Clean-up	Boring No.:	MW-103	Page(s):	1 of 2
Client:	Earthgrains Baking Companies, Inc.	Project #:	62402797 / 024530	Date:	1/19/2009
Location:	Oakland, CA	Coordinates:	LAT 37.7789437 LON -122.2399131	Datum:	NAD 83

BORING/WELL CONSTRUCTION LOG

Drilling Company:	Gregg Drilling & Testing, Inc.	Driller:	Jason Weff	Logger:	Brendon J. Wilder
-------------------	--------------------------------	----------	------------	---------	-------------------

Depth (ft)	SAMPLE TYPE	SAMPLE NUMBER				USCS	PID (ppm)	WELL CONSTRUCTION SUMMARY				Surface Completion
		Blow Counts						Depth (ft)	Annulus	Surface		
		1ST 6"	2ND 6"	3RD 6"	4TH 6"					Completion	Vault	
							Description					
							Modifier and Main Soil; color; impact; consistency/density; odor; moisture; USCS					
0-1							Top 1' concrete					
1-2							Air Knifed/ Hand augered to 5' below ground surface					
2-3							Drilled borehole using 8" hollow stem augers w/ California Modified Split- Spoon Sampling					
3-4												
4-5												
5-6	S.S.	4	5	5	CL	0	SILTY-CLAY w/ trace sand dark brown (5YR 2.5/1) mottled grey					
6-7							Soft to firm damp sampled @ 13:15					
7-8												
8-9	S.S.	2	2	3		0	SANDY-CLAY very soft and wet					
9-10							sampled @ 13:20					
10-11							approximately 12' = SILTY-SAND					
11-12												
12-13												
13-14	S.S.	2	1	0		0	NO RECOVERY					
14-15												
15-16												
16-17												
17-18												
18-19	S.S.	5	8	14	CL	0	SANDY-CLAY w/ some sub-angular gravels					
19-20							stiff to hard and wet					
							sampled @ 13:30					

Notes: Brass sample tubes = 6" in length
 Sand #2/12 Monterrey 50# bags:8 Type II-IV cement 94# bags:
 Bentonite chips 3/8" 50lbs bag



Project: Earthgrains UST Clean-up		Boring No.: MW-103	Page(s): 2 of 2
Client: Earthgrains Baking Companies, Inc.		Project #: 62402797 / 024530	Date: 1/19/2009
Location: Oakland, CA		Coordinates: LAT 37.7789437 LON -122.2399131	Datum: NAD 83

BORING/WELL CONSTRUCTION LOG

Drilling Company: Gregg Drilling & Testing, Inc.	Driller: Jason Weff	Logger: Brendon J. Wilder
--	-------------------------------	-------------------------------------

Depth (ft)	SAMPLE TYPE	SAMPLE NUMBER				PID (ppm)	WELL CONSTRUCTION SUMMARY											
		Blow Counts					Depth (ft)	Annulus		Surface Completion								
		1ST 6"	2ND 6"	3RD 6"	4TH 6"			0 to 6	6 to 8		8 to 25							
21-																		
22-																		
23-																		
24-	S.S.	10	15	25	0	changed @ approximately 19.5' bgs to CLAYEY-GRAVEL w/ sand sub-angular gravels up to 1" moist and very stiff												
25-						sampled @ 13:40												
26-						NOTES:												
27-						terminate borehole at 25' bgs @ 13:40												
28-						15' PVC screen w/ .010 slot												
29-						10' PVC riser												
30-																		
31-																		
32-																		
33-																		
34-																		
35-																		
36-																		
37-																		
38-																		
39-																		
40-																		

Notes: Brass sample tubes = 6" in length
 Sand #2/12 Monterrey 50# bags:8 Type II-IV cement 94# bags:
 Bentonite chips 3/8" 50lbs bag

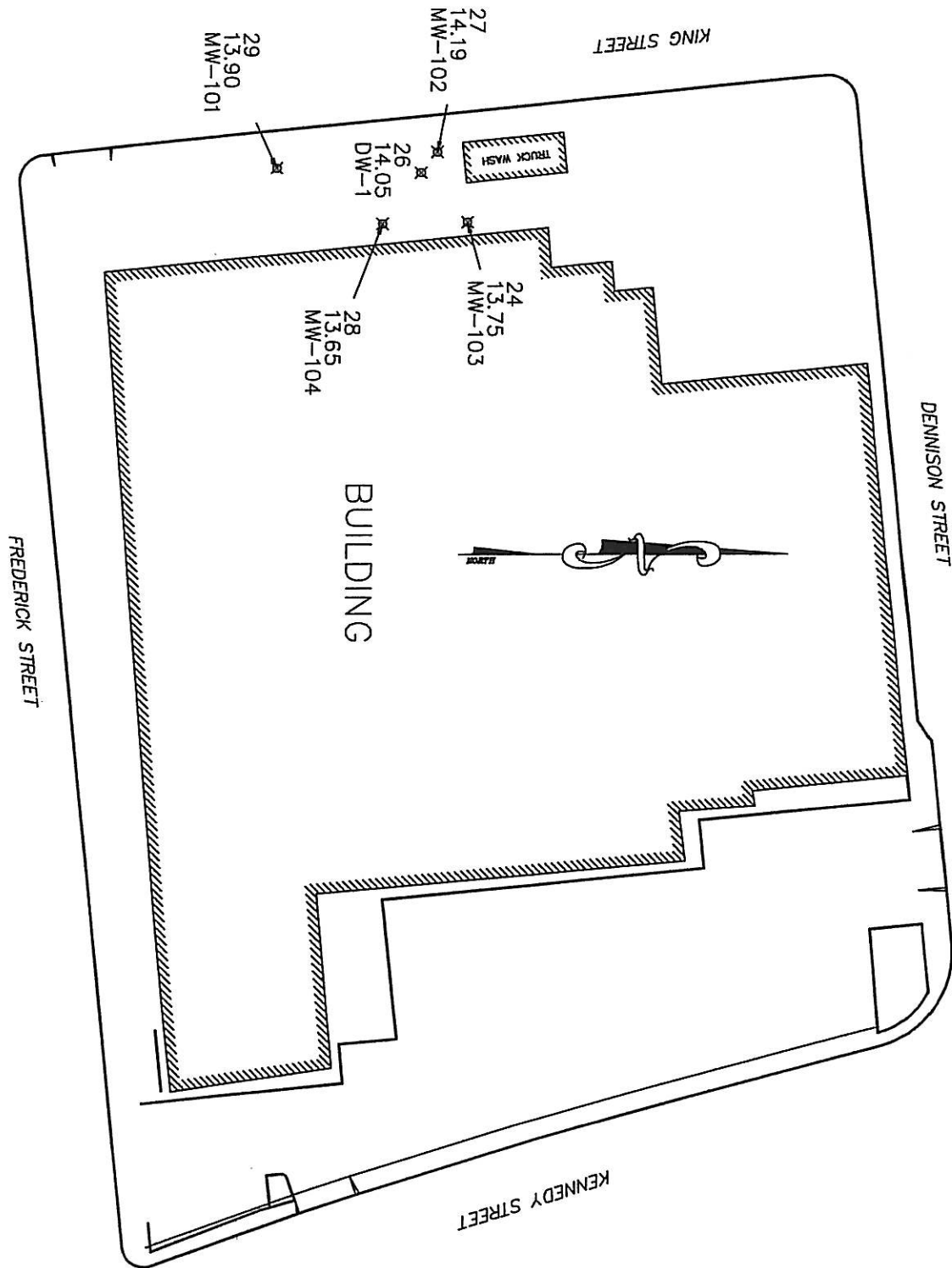

PLS SURVEYS, INC.
 LAND & HYDROGRAPHIC SURVEYORS
 2220 Livingston Street, Suite 202
 Oakland, California 94606-5203
 510.261.0900 FAX 510.261.3303
 e-mail: plssurv@pacbell.net

Earthgrains Site

955 Kennedy St.

OAKLAND

CALIFORNIA

SCALE	1"=80'
DATE	01/28/09
BY	JMB/JTH
JOB NO.	09-001



Project: Earthgrains UST Clean-up Boring No.: MW-104 Page(s): 1 of 2
 Client: Earthgrains Baking Companies, Inc. Project #: 62402797 / 024530 Date: 1/20/2009
 Location: Oakland, CA Coordinates: LAT 37.7788276 LON -122.2399077 Datum: NAD 83

BORING/WELL CONSTRUCTION LOG

Drilling Company: **Gregg Drilling & Testing, Inc.** Driller: **Jason Weff** Logger: **Brendon J. Wilder**

WELL CONSTRUCTION SUMMARY

Depth (ft)	Casing	Depth (ft)	Annulus	Surface Completion
0 to 10	2" PVC Sch. 40	0 to 6	Type II-IV Cement	
10 to 25	2" PVC 0.01" Sch. 40	6 to 8	3/8" Bentonite Chips	
		8 to 25	#2/12 Sand	

Description

Modifier and Main Soil; color; impact; consistency/density; odor; moisture; USCS

Surface Vault

Depth (ft)	SAMPLE TYPE	BLOW COUNTS				USCS	PID (ppm)	Description	Surface Vault
		1ST 6"	2ND 6"	3RD 6"	4TH 6"				
0-1							Top 1' concrete		
1-20							Air Knifed/ Hand augered to 5' below ground surface in remarked native fill Drilled borehole using 8" hollow stem augers w/ California Modified Split- Spoon Sampling		
5-6	s.s.	1	2	5		0	SILTY-CLAY (7.5 YR 3/3) w/ some sand and trace gravel mottled grey (10 YR 4/2) medium stiff moist sampled @ 7:50		
9-10	s.s.	2	2	3		0	no sand no gravel change to very dary greenish-grey (GLEY 1 2.5/1) moist and stiff sampled @ 7:55		
14-15	s.s.	3	4	6		0	change to mottled dark grey (10 YR 4/2) and dark yellowish brown (10 YR 3/4) stiff to hard and moist sampled @ 8:00		
18-19	s.s.	6	11	12		0	SILTY-CLAY w/ some sand and some sub-angular gravels stiff and moist sampled @ 8:10		

Notes: Brass sample tubes = 6" in length
 Sand #2/12 Monterrey 50# bags:8 Type II-IV cement 94# bags:
 Bentonite chips 3/8" 50lbs bag



Project: Earthgrains UST Clean-up	Boring No.: MW-104	Page(s): 2 of 2
Client: Earthgrains Baking Companies, Inc.	Project #: 62402797 / 024530	Date: 1/20/2009
Location: Oakland, CA	Coordinates: LAT 37.7788276 LON -122.2399077	Datum: NAD 83

BORING/WELL CONSTRUCTION LOG

Drilling Company: Gregg Drilling & Testing, Inc.	Driller: Jason Weff	Logger: Brendon J. Wilder
--	-------------------------------	-------------------------------------

WELL CONSTRUCTION SUMMARY

Depth (ft)	Casing	Depth (ft)	Annulus	Surface Completion
0 to 10	2" PVC Sch. 40	0 to 6	Type II-IV Cement	
10 to 25	2" PVC 0.01" Sch. 40	6 to 8	3/8" Bentonite Chips	
		8 to 25	#2/12 Sand	

Description

Modifier and Main Soil; color; impact; consistency/density; odor; moisture; USCS

Depth (ft)	SAMPLE TYPE	Blow Counts				PID (ppm)	Description	Surface Completion
		1ST 6"	2ND 6"	3RD 6"	4TH 6"			
21-								
22-								
23-								
24-	S.S.	3	4	5	0	changed @ approximately 19' bgs to GRAVELLY-CLAY dark greyish-brown (2.5 YR 4/2) w/ some sand some sub-angular gravels up to 1" soft and very moist		
25-								
26-						NOTES: terminate borehole at 25' bgs @ 8:20 15' PVC screen w/ .010 slot 10' PVC riser		
27-								
28-								
29-								
30-								
31-								
32-								
33-								
34-								
35-								
36-								
37-								
38-								
39-								
40-								

Notes: Brass sample tubes = 6" in length
 Sand #2/12 Monterrey 50# bags:8 Type II-IV cement 94# bags:
 Bentonite chips 3/8" 50lbs bag

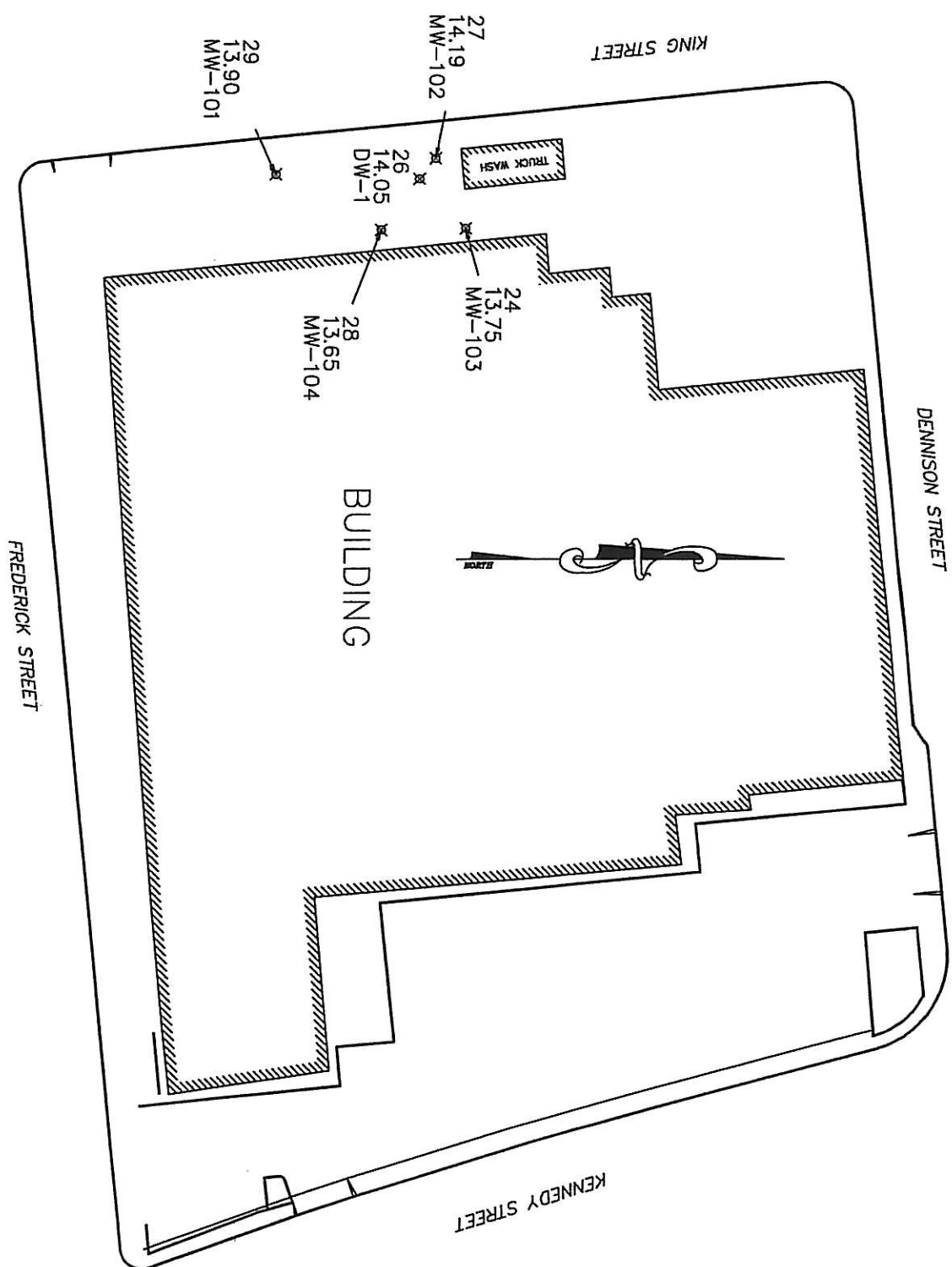

PLS SURVEYS, INC.
 LAND & HYDROGRAPHIC SURVEYORS
 2220 Livingston Street, Suite 202
 Oakland, California 94606-5203
 510.261.0900 FAX 510.261.3303
 e-mail: plssurv@pacbell.net

Earthgrains Site

 955 Kennedy St.

OAKLAND CALIFORNIA

SCALE	1"=80'
DATE	01/28/09
BY	JMB/JTH
JOB NO.	09-001

ATTACHMENT 2

ACPWA – WELL DESTRUCTION PERMITS

Alameda County Public Works Agency - Water Resources Well Permit

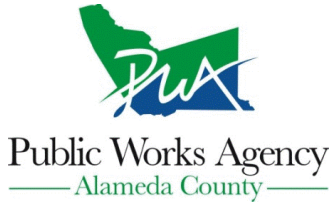

399 Elmhurst Street
Hayward, CA 94544-1395
Telephone: (510)670-6633 Fax:(510)782-1939

Application Approved on: 01/25/2016 By jamesy

Permit Numbers: W2016-0033 to W2016-0036
Permits Valid from 01/27/2016 to 01/28/2016

Application Id: 1452877989292
Site Location: 955 Kennedy Street
Project Start Date: 01/27/2016
Assigned Inspector: Contact Lindsay Furuyama at (925) 956-2311 or Lfuruyama@groundzonees.com

City of Project Site:Oakland

Completion Date:01/28/2016

Applicant: PSC-Industrial Outsourcing, LP - Paul Anderson
210 West Sand Bank Road, Columbia, IL 62236
Property Owner: Mr. Christopher Wolfe Bimbo Bakeries USA, Inc.
350 Kiwanis Blvd., West Hazleton, PA 18202
Client: ** same as Property Owner **
Contact: Paul Anderson

Phone: 618-281-1543
Phone: 570-455-7756 x24
Phone: 618-281-1543
Cell: 618-406-0823

Total Due: \$1588.00
Total Amount Paid: \$1588.00
Receipt Number: WR2016-0023
Payer Name : irvvanzummeren General Paid By: MC **PAID IN FULL**

Purchases

Works Requesting Permits:

Well Destruction-Monitoring - 4 Wells
Driller: Gregg Drilling & Testing - Lic #: 485165 - Method: hstem

Work Total: \$1588.00

Specifications

Permit #	Issued Date	Expire Date	Owner Well Id	Hole Diam.	Casing Diam.	Seal Depth	Max. Depth	State Well #	Orig. Permit #	DWR #
W2016-0033	01/25/2016	04/26/2016	MW-101	8.00 in.	2.00 in.	14.00 ft	28.10 ft	2S/3W7	W2008-0965	e0086801
W2016-0034	01/25/2016	04/26/2016	MW-102	8.00 in.	2.00 in.	14.00 ft	28.40 ft	2S/3W7	W2008-0966	e0086816
W2016-0035	01/25/2016	04/26/2016	MW-103	8.00 in.	2.00 in.	6.00 ft	25.00 ft	2S/3W7	W2008-0967	e0086856
W2016-0036	01/25/2016	04/26/2016	MW-104	8.00 in.	2.00 in.	6.00 ft	25.10 ft	2S/3W7	W2008-0968	e0086874

Specific Work Permit Conditions

1. Drilling Permit(s) can be voided/ cancelled only in writing. It is the applicant's responsibility to notify Alameda County Public Works Agency, Water Resources Section in writing for an extension or to cancel the drilling permit application. No drilling permit application(s) shall be extended beyond ninety (90) days from the original start date. Applicants may not cancel a drilling permit application after the completion date of the permit issued has passed.
2. Prior to any drilling activities, it shall be the applicant's responsibility to contact and coordinate an Underground Service Alert (USA), obtain encroachment permit(s), excavation permit(s) or any other permits or agreements required for that Federal, State, County or City, and follow all City or County Ordinances. No work shall begin until all the permits and requirements have been approved or obtained. It shall also be the applicants responsibilities to provide to the Cities or to Alameda County an Traffic Safety Plan for any lane closures or detours planned. No work shall begin until all the permits and requirements have been approved or obtained.
3. Compliance with the well-sealing specifications shall not exempt the well-sealing contractor from complying with appropriate State reporting-requirements related to well construction or destruction (Sections 13750 through 13755 (Division 7, Chapter 10, Article 3) of the California Water Code). Contractor must complete State DWR Form 188 and

Alameda County Public Works Agency - Water Resources Well Permit

mail original to the Alameda County Public Works Agency, Water Resources Section, within 60 days. Include permit number and site map.

4. Applicant shall submit the copies of the approved encroachment permit to this office within 10 days.
5. Permittee shall assume entire responsibility for all activities and uses under this permit and shall indemnify, defend and save the Alameda County Public Works Agency, its officers, agents, and employees free and harmless from any and all expense, cost and liability in connection with or resulting from the exercise of this Permit including, but not limited to, property damage, personal injury and wrongful death.
6. Applicant shall contact assigned inspector listed on the top of the permit at least five (5) working days prior to starting, once the permit has been approved. Confirm the scheduled date(s) at least 24 hours prior to drilling.
7. Permittee, permittee's contractors, consultants or agents shall be responsible to assure that all material or waters generated during drilling, boring destruction, and/or other activities associated with this Permit will be safely handled, properly managed, and disposed of according to all applicable federal, state, and local statutes regulating such. In no case shall these materials and/or waters be allowed to enter, or potentially enter, on or off-site storm sewers, dry wells, or waterways or be allowed to move off the property where work is being completed.
8. Remove the Christy box or similar structure.

Destroy well by grouting neat cement with a tremie pipe or pressure grouting (25 psi for 5min.) to the bottom of the well and by filling with neat cement to three (3-5) feet below surface grade. Allow the sealing material to spill over the top of the casing to fill any annular space between casing and soil.

After the seal has set, backfill the remaining hole with concrete or compacted material to match existing conditions.

9. Copy of approved drilling permit must be on site at all times. Failure to present or show proof of the approved permit application on site shall result in a fine of \$500.00.
 10. Electronic Reporting Regulations (Chapter 30, Division 3 of Title 23 & Division 3 of Title 27, CCR) require electronic submission of any report or data required by a regulatory agency from a cleanup site. Submission dates are set by a Regional Water Board or by a regulatory agency. Once a report/data is successfully uploaded, as required, you have met the reporting requirement (i.e. the compliance measure for electronic submittals is the actual upload itself). The upload date should be on or prior to the regulatory due date.
-

ATTACHMENT 3

SWRCB ORDER WQ 2015-0161-UST

STATE OF CALIFORNIA
STATE WATER RESOURCES CONTROL BOARD

ORDER WQ 2015-0161 – UST

In the Matter of Underground Storage Tank Case Closure

**Pursuant to Health and Safety Code Section 25296.10 and the Low Threat
Underground Storage Tank Case Closure Policy**

BY THE CHIEF DEPUTY DIRECTOR:¹

By this order, the Chief Deputy Director directs closure of the underground storage tank (UST) case at the site listed below, pursuant to section 25296.10 of the Health and Safety Code². The name of the UST Cleanup Fund (Fund) claimant, the Fund claim number, the site name, the applicable site address, and the lead agency are as follows:

Bimbo Bakeries, USA, Inc., Assignee
Fund Claim No. 4424
Earthgrains Baking Company
955 Kennedy Street, Oakland

Alameda County Environmental Health Department
Agency Case Number RO0002569

I. STATUTORY AND PROCEDURAL BACKGROUND

Upon review of a UST case, the State Water Resources Control Board (State Water Board), or in certain cases the State Water Board Executive Director, or Chief Deputy Director, may close or require closure of a UST case if the State Water Board determines that corrective action at the site is in compliance with the requirements of subdivisions (a) and (b) of section 25296.10. Closure of a UST case is appropriate where the corrective action ensures the protection of human health, safety, and the environment, and where the corrective action is consistent with: 1) Chapter 6.7 of Division 20 of the Health and Safety Code and implementing regulations; 2) Any applicable waste discharge requirements or other orders issued pursuant to

¹ State Water Board Resolution No. 2012-0061 delegates to the Executive Director the authority to close or require the closure of any UST case if the case meets the criteria found in the State Water Board's Low Threat Underground Storage Tank Case Closure Policy adopted by State Water Board Resolution No. 2012-0016. Pursuant to Resolution No. 2012-0061, the Executive Director has delegated this authority to the Chief Deputy Director.

² Unless otherwise noted, all references are to the Health and Safety Code.

Division 7 of the Water Code; 3) All applicable state policies for water quality control; and 4) All applicable water quality control plans.

State Water Board staff has completed a review of the UST case identified above, and recommends that this case be closed. The recommendation is based upon the facts and circumstances of this particular UST case. A UST Case Closure Review Summary Report has been prepared for the case identified above and the bases for determining compliance with the Water Quality Control Policy for Low-Threat Underground Storage Tank Case Closures (Policy) are explained in the Case Closure Review Summary Report.

In State Water Board Resolution No. 2012-0016, the State Water Board adopted the Policy. The Policy became effective on August 17, 2012. The Policy establishes consistent statewide case closure criteria for certain low-threat petroleum UST sites. In the absence of unique attributes or site-specific conditions that demonstrably increase the risk associated with residual petroleum constituents, cases that meet the general and media-specific criteria in the Policy pose a low threat to human health, safety and the environment and are appropriate for closure under Health and Safety Code section 25296.10. The Policy provides that if a regulatory agency determines that a case meets the general and media-specific criteria of the Policy, then the regulatory agency shall notify responsible parties and other specified interested persons that the case is eligible for case closure. Unless the regulatory agency revises its determination based on comments received on the proposed case closure, the Policy provides that the agency shall issue a closure letter as specified in Health and Safety Code section 25296.10. The uniform closure letter may be issued only after the expiration of the 60-day comment period, proper destruction or maintenance of monitoring wells or borings, and removal of waste associated with investigation and remediation of the site.

Health and Safety Code section 25299.57, subdivision (l)(1) provides that claims for reimbursement of corrective action costs that are received by the Fund more than 365 days after the date of a uniform closure letter or a Letter of Commitment, whichever occurs later, shall not be reimbursed unless specified conditions are satisfied.

II. FINDINGS

Based upon the UST Case Closure Review Summary Report prepared for the case and attached hereto, the State Water Board finds that corrective action taken to address the unauthorized release of petroleum at the UST release site identified as:

Claim No. 4424

Earthgrains Baking Company

ensures protection of human health, safety and the environment and is consistent with Chapter 6.7 of Division 20 of the Health and Safety Code and implementing regulations, the Policy, and other applicable water quality control policies and plans.

The unauthorized release from the UST consisted only of petroleum. This order directs closure for the petroleum UST case at the site.³

Pursuant to the Policy, notification has been provided to all entities that are required to receive notice of the proposed case closure, a 60-day comment period has been provided to notified parties, and any comments received have been considered by the Board in determining that the case should be closed.

Pursuant to section 21080.5 of the Public Resources Code, environmental impacts associated with the adoption of this Order were analyzed in the substitute environmental document (SED) the State Water Board approved on May 1, 2012. The SED concludes that all environmental effects of adopting and implementing the Policy are less than significant, and environmental impacts as a result of complying with the Policy are no different from the impacts that are reasonably foreseen as a result of the Policy itself. A Notice of Decision was filed August 17, 2012. No new environmental impacts or any additional reasonably foreseeable impacts beyond those that were not addressed in the SED will result from adopting this Order.

The UST case identified above may be the subject of orders issued by the Regional Water Quality Control Board (Regional Water Board) pursuant to Division 7 of the Water Code. Any orders that have been issued by the Regional Water Board pursuant to Division 7 of the Water Code, or directives issued by a Local Oversight Program agency for this case should be rescinded to the extent they are inconsistent with this Order.

³ This order addresses only the petroleum UST case for the site. This order does not affect any order or directive requiring corrective action for non-petroleum contamination, if non-petroleum contamination is present.

III. ORDER

IT IS THEREFORE ORDERED that:

- A. The UST case identified in Section II of this Order, meeting the general and media-specific criteria established in the Policy, be closed in accordance with the following conditions and after the following actions are complete. Prior to the issuance of a uniform closure letter, the Fund claimant is ordered to:
1. Properly destroy monitoring wells and borings unless the owner of real property on which the well or boring is located certifies that the wells or borings will be maintained in accordance with local or state requirements;
 2. Properly remove from the site and manage all waste piles, drums, debris, and other investigation and remediation derived materials in accordance with local or state requirements; and
 3. Within six months of the date of this Order, submit documentation to the regulatory agency overseeing the UST case identified on page 1 of this Order that the tasks in subparagraphs (1) and (2) have been completed.
- B. The tasks in subparagraphs (1) and (2) of paragraph (A) are ordered pursuant to Health and Safety Code section 25296.10 and failure to comply with these requirements may result in the imposition of civil penalties pursuant to Health and Safety Code section 25299, subdivision (d)(1). Penalties may be imposed administratively by the State Water Board or Regional Water Board.
- C. Within 30 days of receipt of proper documentation from the Fund claimant that requirements in subparagraphs (1) and (2) of paragraph (A) are complete, the regulatory agency that is responsible for oversight of the UST case identified in Section II of this Order shall notify the State Water Board that the tasks have been satisfactorily completed.

- D. Within 30 days of notification from the regulatory agency that the tasks are complete pursuant to paragraph (C), the Deputy Director of the Division of Financial Assistance shall issue a closure letter consistent with Health and Safety Code section 25296.10, subdivision (g) and upload the closure letter and UST Case Closure Review Summary Report to GeoTracker.

- E. Pursuant to section 25299.57, subdivision (l) (1), and except in specified circumstances, all claims for reimbursement of corrective action costs must be received by the Fund within 365 days of issuance of the uniform closure letter in order for the costs to be considered.

- F. Any Regional Water Board or Local Oversight Program Agency directive or order that directs corrective action or other action inconsistent with case closure for the UST case identified in Section II is rescinded, but only to the extent the Regional Water Board order or Local Oversight Program Agency directive is inconsistent with this Order.



Chief Deputy Director

11/16/15

Date

State Water Resources Control Board

REVISED UST CASE CLOSURE REVIEW SUMMARY REPORT

Agency Information

Agency Name: Alameda County Environmental Health Department (County)	Address: 1131 Harbor Bay Parkway Alameda, CA 94502
Agency Caseworker: Karel Detterman	Case No.: RO0002569

Case Information

USTCF Claim No.: 4424	GeoTracker Global ID: T0600177342
Site Name: Earthgrains Baking Company	Site Address: 955 Kennedy Street Oakland, CA 94606
Responsible Party: Earthgrains Baking Co. Attn: Ms. Angela Westbrook	Address: 955 Kennedy Street Oakland, CA 94606
USTCF Expenditures to Date: \$996,250	Number of Years Case Open: 12

To view all public documents for this case available in GeoTracker use the following URL:
http://geotracker.waterboards.ca.gov/profile_report.asp?global_id=T0600177342

Summary

The Low-Threat Underground Storage Tank (UST) Case Closure Policy (Policy) contains general and media-specific criteria, and cases that meet those criteria are appropriate for closure pursuant to the Policy. This case meets all of the required criteria of the Policy. Highlights of the case follow:

This case is an active petroleum fueling facility for a commercial bakery. An unauthorized release was reported in April 2003 following a soil and groundwater investigation. In 1991, eight USTs (six diesel, one gasoline and one waste oil) were removed. Two excavations have been completed where an unknown amount of soil was removed in 1991 and a second event where 775 cubic yards impacted soil and 13,000 gallons of impacted groundwater were removed and disposed offsite in 2010. Since 1992, nine groundwater monitoring wells have been installed and regularly monitored; five wells have been abandoned. According to groundwater data, water quality objectives have been achieved for all constituents.

The petroleum release is limited to the soil and shallow groundwater. According to data available in GeoTracker, there are no supply wells within 250 feet of the defined plume boundary. No other water supply wells have been identified within 250 feet of the defined plume boundary in files reviewed. The site is located within the service area of a public water supply, as defined in the Policy. The affected shallow groundwater is not currently being used as a source of drinking water, and it is highly unlikely that the affected shallow groundwater will be used as a source of drinking water in the foreseeable future. Other designated beneficial uses of impacted shallow groundwater are not threatened, and it is highly unlikely that they will be, considering these factors in the context of the site setting. Remaining petroleum hydrocarbon constituents are limited and stable, and concentrations are decreasing. Corrective actions have been implemented and additional corrective actions are not necessary. Any remaining petroleum hydrocarbon constituents do not pose a significant risk to human health, safety or the environment.

Earthgrains Baking Company
955 Kennedy Street, Oakland
Claim No: 4424

Rationale for Closure under the Policy

- General Criteria: The case meets all eight Policy general criteria.
- Groundwater Risk from Residual Petroleum Hydrocarbons: The case meets Policy Criterion 1 by Class 1. The plume that exceeds water quality objectives is less than 100 feet in length. There is no free product. The nearest water supply well or surface water body is greater than 250 feet from the defined plume boundary.
- Indoor Vapor Risk from Residual Petroleum Hydrocarbons: The case meets Policy Criterion 2a by Scenario 3a. The maximum benzene concentration in groundwater is less than 100 micrograms per liter ($\mu\text{g/L}$). The minimum depth to groundwater is greater than 5 feet, overlain by soil containing less than 100 milligrams per kilogram (mg/kg) of TPH.
- Direct Contact Risk from Residual Petroleum Hydrocarbons: The case meets Policy Criterion 3a. Maximum concentrations in soil are less than those in Policy Table 1 for Commercial/Industrial use, and the concentration limits for a Utility Worker are not exceeded.

Determination

The Fund Manager has determined that corrective action performed at the Site is consistent with the requirements of Health and Safety code section 25296.10, subdivision (a), and that closure of the case is appropriate.

Recommendation for Closure

Based on available information, residual petroleum hydrocarbons at the Site do not pose a significant risk to human health, safety, or the environment, and the case meets the requirements of the Policy. Accordingly, the Fund Manager recommends that the case be closed. The State Water Board staff is conducting public notification as required by the Policy. Alameda County has the regulatory responsibility to supervise the abandonment of monitoring wells.

Lisa Babcock

Lisa Babcock, P.G. 3939, C.E.G. 1235
Fund Manager

10/19/15

Date

Prepared by: Pat G. Cullen, P.G.

ATTACHMENT 4

WASTE DISPOSAL MANIFESTS

2315944



Stericycle
Environmental Solutions

SHIPPING PAPER

Lading Manifest: 865557-16

WP# 94925

SHIPPER / CUSTOMER EARTH GRAINS BAKING COMPANIES INC		DELIVERY DATE	JOB #2315944
ADDRESS 955 KENNEDY ST.		POINT OF CONTACT	
CITY, STATE, ZIP OAKLAND CA 94605		PHONE #	
CARRIER / TRANSPORTER STERICYCLE SPECIALTY WASTE		PHONE # (612)285-9865	
CONSIGNEE / FACILITY 21ST CENTURY ENVIRONMENTAL		POINT OF CONTACT	
ADDRESS 2095 NEWLANDS DRIVE EAST		PHONE # (775)575-2760	
CITY, STATE, ZIP FERNLEY , NV 89408			

HM	US DOT Description (Including Proper Shipping Name, Hazard Class, and ID Number)	Containers		Total Quantity	UOM
		No.	Type		
A	NON-HAZARDOUS WASTE, SOLID (CONCRETE WASTE)	01	DM	900	P
B	NON-HAZARDOUS WASTE, SOLID (DESTRUCTION DEBRIS)	01	DM	700	P
C	NON-HAZARDOUS WASTE, LIQUID (POTABLE WATER)	01	DM	55	P G
D	<p style="text-align: center;">21st CEM of Nevada has the appropriate permits(s) for, and will accept the waste this generator is shipping.</p>				

Special Handling Instruction and Additional Information:

a) 748802-00 - CONSTRUCTION DEBRIS - LF01 (1) b) 748803-00 - WELL DESTRUCTION DEBRIS - LF01 (2) c) 748804-00 - POTABLE WATER - STANDBY (3)

2nd TRANSFERRED SST R. HARTMAN Ref 02/29/16

Placards Provided YES _____ NO _____

SHIPPER'S CERTIFICATION: "I hereby declare that the contents of this consignment are fully and accurately described above by proper shipping name and are classified, packaged, marked and labelled/placarded, and are in all respects in proper condition for transport according to applicable international and national governmental regulations." also certify that all times listed above are true and correct.

SHIPPER) PRINT OR TYPE NAME < Diana Merino	SIGNATURE X Diana Merino	MONTH 2	DAY 22	YEAR 16
CARRIER/TRANSPORTER) PRINT OR TYPE NAME < Jesus Garcia	SIGNATURE X Jesus Garcia	MONTH 02	DAY 22	YEAR 16
CONSIGNEE/FACILITY) PRINT OR TYPE NAME < Hearsten Armstrong	SIGNATURE X [Signature]	MONTH 03	DAY 19	YEAR 16

CONSIGNEE MAR 01 2016