

ASSESSOR'S MAP 19

58

Code Area No. 11-037

SHELL MOUND TRACT (S.K. 5, PG. 1)
Map of the Camden 23rd Avenue Tract. (S.K. 9 PG. 24)

Scale: 1" = 50'

Rev. 3-15-63 VT
S-1-58 12

Printed by the Commission
of Planning & Zoning

Printed by the Commission
of Planning & Zoning

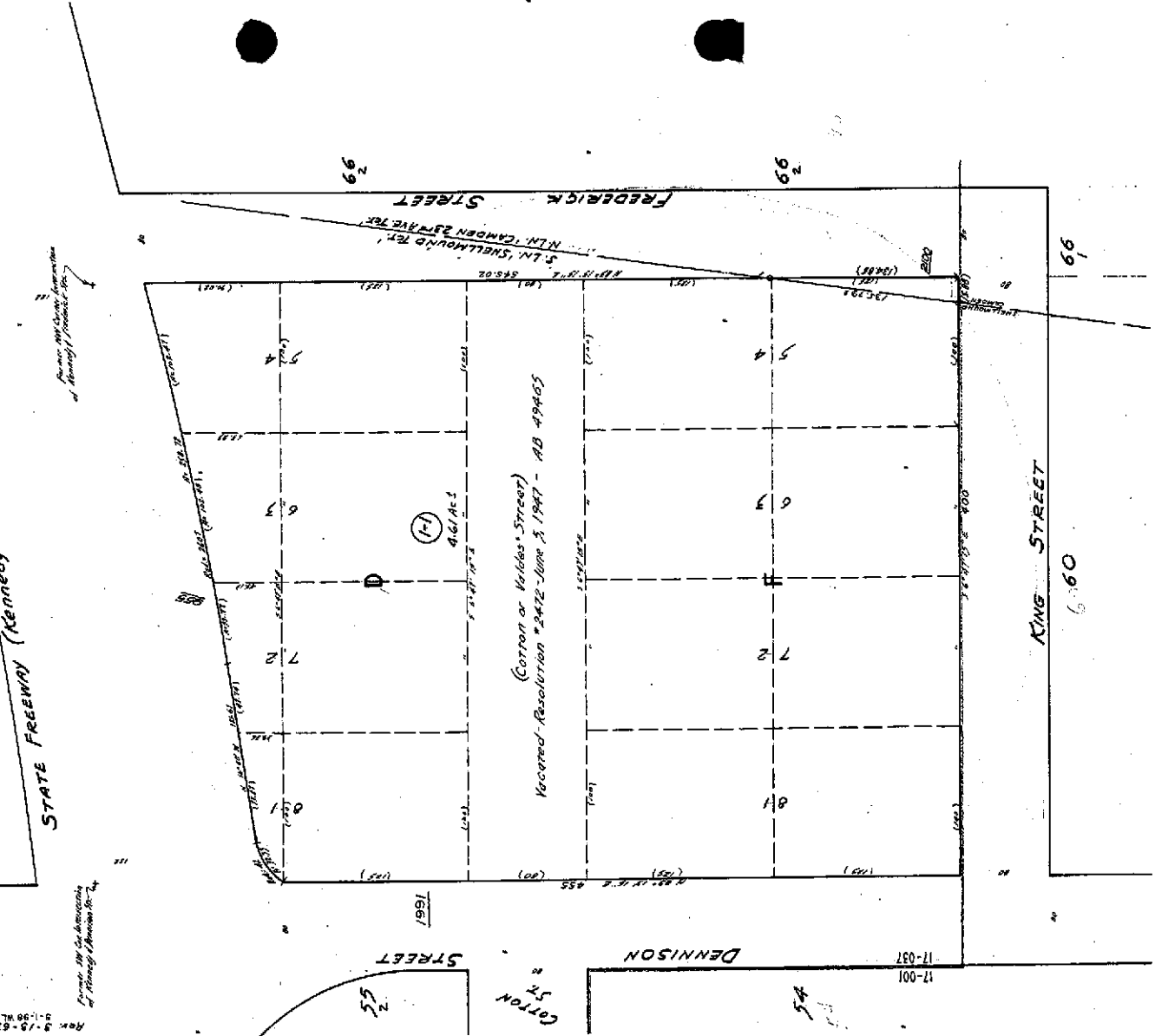

88

66

66

66

660

1566
STREET

DENNISON

17-001
11-037

COTTON
ST



COUNTY OF ALAMEDA
Assessor's Office

Property Value System

History

Value

Transfer

New Query

Parcel Number: 19-58-1-1 Lien Date: 01/01/2006 Owner: KILPATRICKS BAKERIES
 Property Address: 955 KENNEDY ST , OAKLAND, CA 94606-5336

| Mailing Name | Mailing Address | Document Date | Document Number | Value From Trans Tax | Parcel Count | Use |
|--------------------------------------|--|---------------|-----------------|----------------------|--------------|------|
| KILPATRICKS BAKERIES c/o TAX DEPT | 111 CORPORATE OFF DR # 200, EARTH CITY, MO 63045 | 03/01/1969 | TRAN-19486 | | 1 | 4300 |

All information on this site is to be assumed accurate for property assessment purposes only, and is based upon the Assessor's knowledge of each property. Caution is advised for use other than its intended purpose.

The Alameda County Intranet site is best viewed in Internet Explorer Version 5.5 or later.
 Click [here](#) for more information regarding supported browsers.

Copyright © 2001 Alameda County

Property Detail

Alameda, CA Ron Thomsen, Assessor

Parcel # (APN): 019 -0058-001-01 Use Description:

Parcel Status:

Owner Name: KILPATRICKS BAKERIES

Mailing Address: 8400 MARYLAND AV, ST LOUIS MO 63105C/O CORPORATE TAX

Situs Address: 955 KENNEDY ST, OAKLAND CA 94606

Legal
Description:**ASSESSMENT**

| | | |
|---------------------------|----------------------|---------------|
| Total Value: \$16,190,930 | Use Code: 430 | Zoning: |
| Land Value: \$2,415,000 | Tax Rate Area: 17037 | |
| Impr Value: \$4,710,000 | Year Assd: 2002 | Improve Type: |
| Other Value: \$9,065,930 | Property Tax: | Price/SqFt: |
| % Improved: 66% | Delinquent Yr: | |
| Exempt Amt: | Exempt Codes: | |

SALES HISTORY

| | <u>Sale 1</u> | <u>Sale 2</u> | <u>Sale 3</u> | <u>Transfer</u> |
|--------------------------|---------------|------------------|---------------|-----------------|
| Recording Date: | 11/02/1982 | | | |
| Recorded Doc #: | 82 999999 | | | 000 |
| Recorded Doc Type: | | | | |
| Transfer Amount: | | | | |
| Sale 1 Seller (Grantor): | | | | |
| 1st Trst Dd Amt: | Code1: | 2nd Trst Dd Amt: | Code2: | |

PROPERTY CHARACTERISTICS

| | | |
|------------------------|--------------------|------------------|
| Lot Acres: 4.620A | Year Built: | Fireplace: |
| Lot SqFt: 201,400 | Effective Yr: 1968 | A/C: |
| Bldg/Liv Area: 107,629 | | Heating: |
| Units: 1 | Total Rooms: | Pool: |
| Buildings: 3 | Bedrooms: | Flooring: |
| Stories: 1.00 | Baths (Full): | Park Type: |
| Style: | Baths (Half): | Spaces: |
| Construct: | Bsmt SqFt: | Site Infnce: |
| Quality: | Garage SqFt: | |
| Building Class: | | Timber Preserve: |
| Condition: | | Ag Preserve: |
| Other: | | |
| Other Rooms: | | |