

Underground Storage Tank Removal

770 El Charro Road
Pleasanton, California

Alameda County
APR 11 2003
Environmental Health

SS R02539

This report has been prepared for:

Pleasanton Gravel Company

P.O. Box 850, Pleasanton, California 94566

April 9, 2003

Project No. 1888-1



Mark J. Arnola, R.G., R.E.A.
Senior Project Geologist
Report Author



Peter M. Langtry, R.G., C.E.G.
Principal Environmental Geologist
Reviewer



Mountain View

Oakland

Fullerton

San Ramon

April 9, 2003
1888-1

Mr. Don Kahler
PLEASANTON GRAVEL COMPANY
P.O. Box 850
Pleasanton, California 94566

**RE: UNDERGROUND STORAGE
TANK REMOVAL
770 EL CHARRO ROAD
PLEASANTON, CALIFORNIA**

Dear Mr. Kahler:

As requested, we have completed the attached report that summarizes underground storage tank removal activities at the referenced site. This report was prepared in accordance with our proposal dated December 19, 2002.

We refer you to the text of the report for details regarding this study. Thank you for choosing us to assist you. If you have any questions, please call and we will be glad to discuss them with you.

Very truly yours,

LOWNEY ASSOCIATES



Mark J. Arniola, R.G., R.E.A.
Senior Project Geologist



Peter M. Langtry, R.G., C.E.G.
Principal Environmental Geologist

PML:MJA:CCM

Copies: Addressee (2)
Alameda County Department of Environmental Health (1)
Attn: Ms. Eva Chu
Superior Underground Tank Service (1)
Attn: Mr. John Sutfin

OK, P:/ Project/1800/1888-1 El Charro UST rpt

Alameda County
APR 11 2003
Environmental Health

TABLE OF CONTENTS

1.0	INTRODUCTION	1
1.1	Purpose	1
1.2	Site Description and Background	1
1.3	Scope of Work	1
1.4	Project Personnel	1
2.0	UNDERGROUND STORAGE TANK REMOVAL	2
2.1	Pre-Removal Activities	2
	TABLE 1. LEL and Oxygen Concentrations	2
2.2	Tank Removal	2
2.3	Soil Sampling	2
	2.3.1 Laboratory Analyses	3
	TABLE 2. Analytical Results of Selected Soil Samples	3
2.4	Excavation Backfilling	3
3.0	CONCLUSIONS AND RECOMMENDATIONS	4
4.0	LIMITATIONS	4

FIGURE 1 — VICINITY MAP

FIGURE 2 — SITE PLAN

FIGURE 3 — SOIL STOCKPILE SAMPLE LOCATION MAP

APPENDIX A — PERMIT, MANIFESTS, AND DISPOSAL CERTIFICATES

APPENDIX B — SAMPLING PROTOCOL AND ANALYTICAL RESULTS

**UNDERGROUND STORAGE TANK REMOVAL
770 EL CHARRO ROAD
PLEASANTON, CALIFORNIA**

1.0 INTRODUCTION

1.1 Purpose

In accordance with your request, we have provided environmental consulting and verification sampling services during the removal of three underground storage tanks (USTs) at the referenced site. The purpose of this investigation was to evaluate potential impacts of the USTs on underlying soil quality and to observe contractor activities on a part-time basis. This report presents our findings, conclusions, and recommendations.

1.2 Site Description and Background

The site is located at 770 El Charro Road in Pleasanton, California, as shown in Figures 1 and 2. The site currently is used for horse stables. Three 1,000-gallon USTs were reportedly installed in the 1950's and were used to store diesel and gasoline fuel for agricultural use. Depth to ground water is expected to be at a depth of approximately 15 to 20 feet.

1.3 Scope of Work

As requested, the scope of work for this study was performed as outlined in our agreement dated December 19, 2002, and included the following tasks:

- ▼ Part-time observation of tank removal activities performed by the contractor.
- ▼ Collection and laboratory analysis of confirmation soil samples from beneath the tank and soil stockpile.
- ▼ Preparation of this report.

1.4 Project Personnel

Tank removal work was conducted at the site by Superior Underground Tank Services (SUTS). SUTS is a licensed hazardous waste contractor operating out of Danville, California. Site activities were coordinated with Mr. Robert Weston of the Alameda County Department of Environmental Health (ACDEH).

2.0 UNDERGROUND STORAGE TANK REMOVAL

2.1 Pre-Removal Activities

A permit (see Appendix A) to remove the USTs was obtained by the contractor from the ACDEH. Prior to excavation, the contents of the tanks were removed and the tanks were rinsed. Approximately 100-gallons of rinsate were transported to the Asbury Environmental facility in Richmond, California. The manifest for this material is included in Appendix A. Following rinsing, the tanks were inerted with the addition of approximately 100 pounds of dry ice per tank. Prior to removal, the lower explosive limit (LEL) and oxygen concentration in the tanks were measured. Measurement results are presented in Table 1 below.

TABLE 1. LEL and Oxygen Concentrations

Tank Number	Time	LEL %	Oxygen %
T-1	10:30	2	10
T-2	10:40	10	9
T-3	10:50	0	9
T-2	11:20	2	9

2.2 Tank Removal

The three 1,000-gallon, single-walled steel tanks were removed on February 21, 2003 in the presence of the ACDEH inspector. Prior to removal of the tank, backfill consisting of pea gravel and dark brown fat clay was excavated from around the tank and stockpiled on-site. Weak petroleum odors and minor staining were noted in the backfill and native soil below tank #3. No ground water was encountered in the excavation.

The tanks were approximately 4 feet in diameter and 10 feet in length. Tank #1 was installed approximately 6 feet below grade (to base of tank). Tanks #2, and #3 were installed approximately 10 feet below grade (to base of tanks). Observation of the tanks indicated that tank #1 and #2 were in relatively good condition. No holes, significant deterioration, nor other signs of leakage were observed. Tank #3, however, revealed several up to 1/2-inch holes in the upper half of the tank, and a 2 1/2-inch hole at the bottom of the tank. The tanks were transported by Ecology Control Industries to their facility in Richmond, California for disposal. Copies of the waste manifests and disposal certificates for the tanks are included in Appendix A.

2.3 Soil Sampling

To evaluate soil quality, two verification soil samples were collected from the native soil beneath each end of the tanks. Native soil at the site consisted of a dark-brown fat clay. Sampling locations are presented on Figure 2.

At the request of the ACDEH four 4-point composite soil samples were additionally collected from the stockpiled soil.

2.3.1 Laboratory Analyses

As requested by the ACDEH inspector and because the former tanks previously contained gasoline and diesel fuel, the soil samples were analyzed for total petroleum hydrocarbons as gasoline (TPHg) and diesel (TPHd) with an additional scan for benzene, toluene, ethylbenzene, and xylenes (BTEX), and methyl tertiary butyl ether (MTBE) (EPA Test Method 8015/8020); fuel oxygenates, including 1,1-DCA (EPA Test Method 8260); and total lead. Sampling protocol, and copies of the laboratory reports and chain of custody form are presented in Appendix B.

**TABLE 2. Analytical Results of Selected Soil Samples
(concentrations in parts per million)**

Sample Number	Depth (feet)	Location	TPHd	TPHg	Benzene	Toluene	Ethylbenzene	Xylenes
T-1-1	7 ½	Tank#1 non-fill	1.0	<1.0	<0.005	<0.005	<0.005	<0.005
T-1-2	7 ½	Tank#1 fill-end	1.4	<1.0	<0.005	<0.005	<0.005	<0.005
T-2-1	10 ½	Tank#2 non-fill	<1.0	<1.0	<0.005	<0.005	<0.005	<0.005
T-2-2	10 ½	Tank#2 fill-end	<1.0	<1.0	<0.005	<0.005	<0.005	<0.005
T-3-1	11 ½	Tank#3 fill-end	59	<1.0	<0.005	<0.005	<0.005	<0.005
T-3-2	11 ½	Tank#3 non-fill	150	<1.0	<0.005	<0.005	<0.005	<0.005
SP-1,2,3,4	NA	Stockpile	5.0	<1.0	<0.005	0.0051	<0.005	<0.005
SP-5,6,7,8	NA	Stockpile	12	<1.0	<0.005	0.006	<0.005	<0.005
SP-9,10,11,12	NA	Stockpile	6.2	<1.0	<0.005	0.0087	<0.005	0.034
SP-13,14,15,16	NA	Stockpile	6.7	8,800	<0.000	0.0081	0.020	0.140

Sample Number	EDB	1,2 DCA	TBA	MTBE	DIPE	ETBE	TAME	Lead
T-1-1	<0.005	<0.005	<0.005	<0.005	<0.005	<0.005	<0.005	5.4
T-1-2	<0.005	<0.005	<0.005	<0.005	<0.010	<0.005	<0.005	4.5
T-2-1	<0.005	<0.005	<0.005	<0.005	<0.010	<0.005	<0.005	6.5
T-2-2	<0.005	<0.005	<0.005	<0.005	<0.010	<0.005	<0.005	7.3
T-3-1	<0.005	<0.005	<0.005	<0.005	<0.010	<0.005	<0.005	8.3
T-3-2	<0.005	<0.005	<0.005	<0.005	<0.010	<0.005	<0.005	8.3
SP-1,2,3,4	<0.005	<0.005	<0.005	<0.005	<0.010	<0.005	<0.005	5.8
SP-5,6,7,8	<0.005	<0.005	<0.005	<0.005	<0.010	<0.005	<0.005	7.0
SP-9,10,11,12	<0.005	<0.005	<0.005	<0.005	<0.010	<0.005	<0.005	8.8
SP-13,14,15,16	<0.005	<0.005	<0.005	<0.005	<0.010	<0.005	<0.005	9.6

< Indicates that the compound was not detected at or above the stated laboratory reporting limit

2.4 Excavation Backfilling

Since petroleum hydrocarbons were detected in the excavated soil, imported material was used to backfill the UST excavation. Approximately 55 tons of ¾-inch diameter crushed rock and approximately 155 tons of ¾-inch maximum diameter Class 2 aggregate base were imported to backfill the excavation.

3.0 CONCLUSIONS AND RECOMMENDATIONS

Upon removal, two of the three tanks appeared to be in good condition. No holes, deteriorated areas, or other signs of leakage were observed. Tank #3, however, had several holes, 1/2-inch diameter or less, in upper half of the tank, and a 2 1/2-inch hole at the bottom of the tank. Laboratory analysis of soil samples collected from beneath the tanks did not detect gasoline-range petroleum hydrocarbons, BTEX compounds, MTBE or other fuel oxygenates. In addition, lead was not detected above typical background concentrations. Minor (up to 1.4 ppm) concentrations of diesel were detected beneath tank #1. Concentrations of up to 150 ppm of diesel-range petroleum hydrocarbons were detected under tank #3. The low concentrations of diesel-range hydrocarbons detected do not appear to be a significant threat to human health or the environment.

Laboratory analysis of the four 4-point composite samples from the stockpiled soil detected diesel range petroleum hydrocarbons (up to 12 ppm), toluene (up to 0.0087 ppm), ethylbenzene (up to 0.02 ppm), and xylenes (up to 0.14 ppm). Analysis of composite sample SP-13,14,15,16, collected at the south-end of the stockpile, additionally detected a significant concentration (8,800 ppm) of gasoline range petroleum hydrocarbons. We understand that the stockpiled soil was appropriately disposed off-site at the Newby Island Sanitary Landfill in Milpitas, California.

Based on the laboratory data and field observations, the former tank does not appear to have significantly impacted soil quality at the site. No further work appears to be required at this time. A copy of this report will be sent to the ACDEH for their review.

4.0 LIMITATIONS

This report was prepared for the use of Pleasanton Gravel Company to summarize UST removal activities at the referenced site. The information contained herein is based on intermittent observation of construction activities and information supplied by and others. We make no warranty, expressed or implied, except that our services have been performed in accordance with environmental principles generally accepted at this time and location. The scope of work performed by Lowney Associates included only part time observation of UST removal activities. Thus, we make no guarantees regarding the quality or completeness of work performed by others.

.

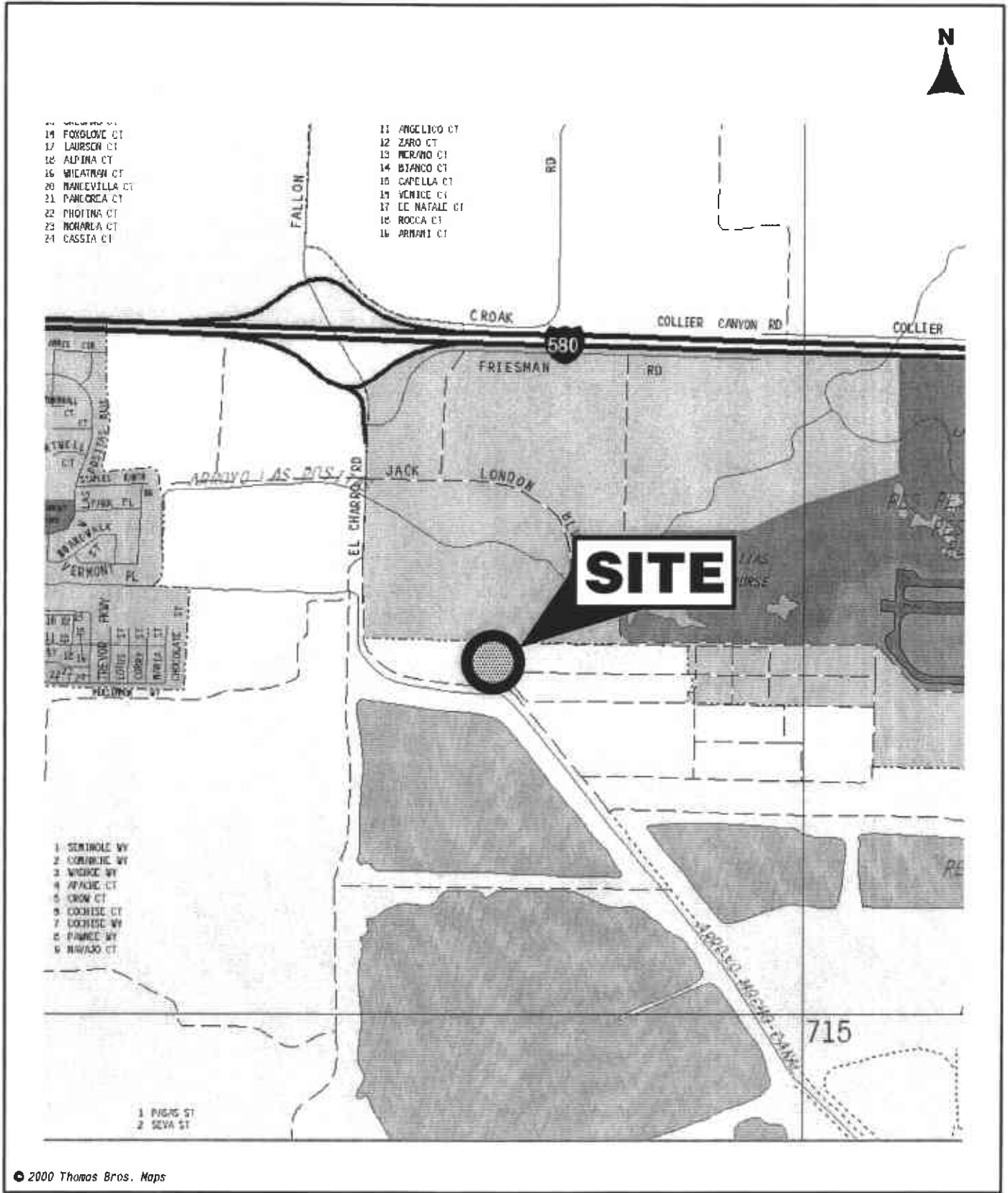

© 2000 Thomas Bros. Maps

303*EB

VICINITY MAP
 770 EL CHARRO ROAD
 Pleasanton, California

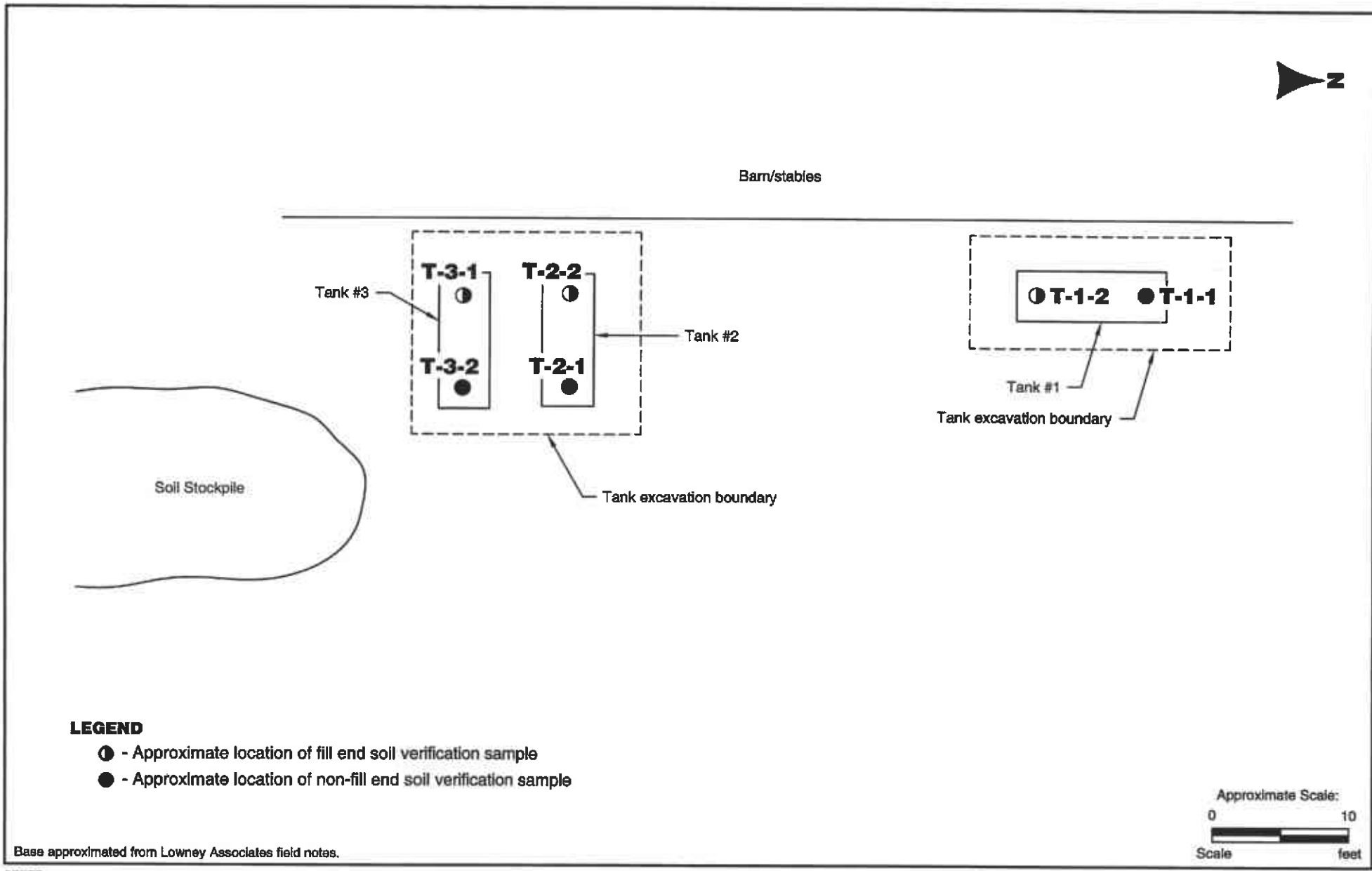

Base approximated from Lowney Associates field notes.

SITE PLAN
770 EL CHARRO ROAD
Pleasanton, California

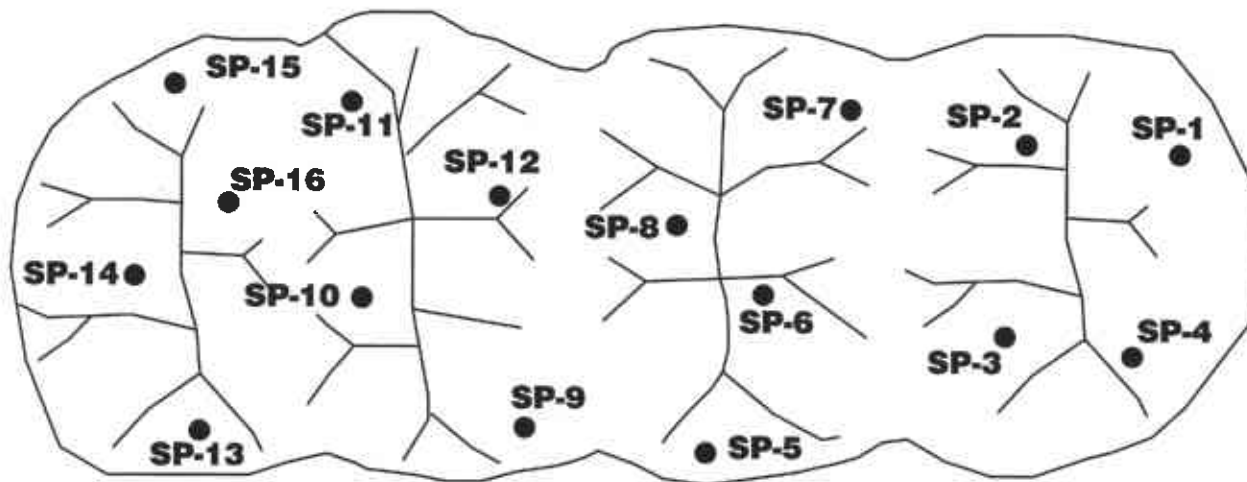

LEGEND

● - Approximate location of soil stockpile sample



Base approximated from Lowney Associates field notes.

SOIL STOCKPILE SAMPLE LOCATION MAP

770 EL CHARRO ROAD
Pleasanton, California

APPENDIX A
PERMIT, MANIFESTS, AND DISPOSAL CERTIFICATES

ALAMEDA COUNTY HEALTH CARE SERVICES AGENCY
 ENVIRONMENTAL HEALTH SERVICES
 1131 HARBOR BAY PARKWAY, RM 250
 ALAMEDA, CA 94502-6577
 PHONE # 510/567-6700

ACCEPTED

Underground Storage Tank Closure Permit Application
 Alameda County Division of Hazardous Materials
 1131 Harbor Bay Parkway, Suite 250
 Alameda, CA 94502-6577

These closure/removal plans have been received and found to be acceptable and essentially meet the requirements of State and Local Health Laws. Changes to your closure plans indicated by this Department are to assure compliance with State and local laws. The project proposed herein is now released for issuance of any required building permits for construction/reconstruction.

One copy of the accepted plans must be on the job and available to all contractors and craftsmen involved with the removal.

Any changes or alterations of these plans and specifications must be submitted to this Department and to the Fire and Building Inspections Department to determine if such changes meet the requirements of State and local laws. Notify this Department at least 72 hours prior to the following required inspections:

- Removal of Tank(s) and Piping
- Sampling
- Final Inspection

Issuance of a) permit to operate, b) permanent site closure, is dependent on compliance with accepted plans and all applicable laws and regulations.

THERE IS A FINANCIAL PENALTY FOR NOT OBTAINING THESE INSPECTIONS

Contact Specialist

ROBERT WESTON
 1-9-03

SEE ATTACHED
 TABLE 2 FOR

REQUIRED ANALYSES

UNDERGROUND TANK CLOSURE PLAN

* * * Complete plan according to attached instructions * * *

1. Name of Business Pleasanton Gravel Co.
 Business Owner or Contact Person (PRINT) Don Kuhler
2. Site Address 770 El Chazo
 City Pleasanton Ca. Zip 94566 Phone 925-447-8543
3. Mailing Address P.O. Box 850
 City Pleasanton Ca Zip 94566-0850 Phone 925-447-8543
4. Property Owner Same
 Business Name (if applicable) _____
 Address _____
 City, State _____ Zip _____
5. Generator name under which tank will be manifested
Pleasanton Gravel Co.
 EPA ID# under which tank will be manifested CA 0002559996



UNIFORM HAZARDOUS WASTE MANIFEST

1. Generator's US EPA ID No.

Manifest Document No.

2. Page 1 of 1

Information in the shaded areas is not required by Federal law.

CACOP2559996 95767

A. State Manifest Document Number
22095767

3. Generator's Name and Mailing Address

PLEASANTON GRAVEL CO
P.O. BOX 850 PLEASANTON CA 94566-0850

4. Generator's Phone

925, 447, 8543

B. State Generator's ID

5. Transporter 1 Company Name

6. US EPA ID Number

Ecology Control Industries

CAD982030173

C. State Transporter's ID (Reserved)

D. Transporter's Phone

(510) 235-1393

7. Transporter 2 Company Name

8. US EPA ID Number

E. State Transporter's ID (Reserved)

F. Transporter's Phone

9. Designated Facility Name and Site Address

ECOLOGICAL CONTROL INDUSTRIES
255 PARR BLVD
RICHMOND CA 94801

10. US EPA ID Number

CAD009466392

G. State Facility's ID

H. Facility's Phone

(510) 235-1393

11. US DOT Description (including Proper Shipping Name, Hazard Class, and ID Number)

NON RCRA HAZARDOUS WASTE SOLID
WASTE EMPTY STORAGE TANK

12. Containers

No.

Type

13. Total Quantity

14. Unit Wt/Vol

I. Waste Number

003 TP 03000 P

State 512

EPA/Other NONE

State

EPA/Other

State

EPA/Other

State

EPA/Other

14. Additional Description (including Material Name)

30413

Special Handling Instructions for Wastes Listed Above

WITH 15 LBS DRY ICE PER 1000 GALLONS

15. Special Handling Instructions and Additional Information

WEAR PROPER PROTECTIVE EQUIPMENT WHILE HANDLING. WEIGHTS OR VOLUMES ARE APPROXIMATE.
24 HOUR EMERGENCY CONTACT: DON KAHLER (520363)
24 HOUR EMERGENCY TELEPHONE NUMBER: 925.447.8543 - 925 458 9000

16. GENERATOR'S CERTIFICATION: I hereby declare that the contents of this consignment are fully and accurately described above by proper shipping name and are classified, packed, marked, and labeled, and are in all respects in proper condition for transport by highway according to applicable international and national government regulations.

If I am a large quantity generator, I certify that I have a program in place to reduce the volume and toxicity of waste generated to the degree I have determined to be economically practicable and that I have selected the practicable method of treatment, storage, or disposal currently available to me which minimizes the present and future threat to human health and the environment; OR, if I am a small quantity generator, I have made a good faith effort to minimize my waste generation and select the best waste management method that is available to me and that I can afford.

Printed/Typed Name

DONALD S KAHLER

Signature

[Signature]

Month Day Year

01 21 03

17. Transporter 1 Acknowledgement of Receipt of Materials

Printed/Typed Name

Ray Webster

Signature

[Signature]

Month Day Year

01 21 03

18. Transporter 2 Acknowledgement of Receipt of Materials

Printed/Typed Name

Signature

30471

Month Day Year

30472

30473

19. Discrepancy Indication Space

20. Facility Owner or Operator Certification of receipt of hazardous materials covered by this manifest except as noted in Item 19.

Printed/Typed Name

Signature

Month Day Year

DO NOT WRITE BELOW THIS LINE.

IN CASE OF EMERGENCY OR NATIONAL RESERVE CALL 1-800-486-8800 WITHIN 30 DAYS OF RECEIVING THIS FORM, CALL 1-800-852-7350

DAY OR NIGHT
TELEPHONE
(510) 235-1393

CERTIFICATE CERTIFIED SERVICES COMPANY

255 Parr Boulevard • Richmond, California 94801

NO. 37819

CUSTOMER
JOB NO. 52T0363
SUPERIOR

Site: 470 EL CHARAL
Pleasanton, CA

FOR: ECOLOGY CONTROL TANK NO. 30471

LOCATION: RICHMOND, CA DATE: 3/17/2003 TIME: 8:05:57

VISUAL GASTECH/1314 SMPN. UNLEADED GAS

TEST METHOD LAST PRODUCT

This is to certify that I have personally determined that this tank is in accordance with the American Petroleum Institute and have found the condition to be in accordance with its assigned designation. This certificate is based on conditions existing at the time the inspection herein set forth was completed and is issued subject to compliance with all qualifications and instructions.

TANK SIZE 1,000 GAL CONDITION SAFE FOR FIRE

REMARKS: OXYGEN 20.9% LOWER EXPLOSIVE LIMIT LESS THAN 0.1% ECOLOGY CONTROL INDUSTRIES
HERBY CERTIFIES THAT THE ABOVE NUMBERED TANK HAS BEEN CUT OPEN, PROCESSED,
AND THEREFORE DESTROYED AT OUR PERMITTED HAZARDOUS WASTE FACILITY.
ECOLOGY CONTROL INDUSTRIES HAS THE APROPRIATE PERMITS FOR, AND HAS ACCEPTED
THE TANK SHIPPED TO US FOR PROCESSING.

In the event of any physical or atmospheric changes affecting the gas-free conditions of the above tanks, or if in any doubt, immediately stop all hot work and contact the undersigned. This permit is valid for 24 hours if no physical or atmospheric changes occur.

STANDARD SAFETY DESIGNATION

SAFE FOR MEN: Means that in the compartment or space so designated (a) The oxygen content of the atmosphere is at least 19.5 percent by volume; and that (b) Toxic materials in the atmosphere are within permissible concentrations; and (c) In the judgment of the Inspector, the residues are not capable of producing toxic materials under existing atmospheric conditions while maintained as directed on the Inspector's certificate.

SAFE FOR FIRE: Means that in the compartment so designated (a) The concentration of flammable materials in the atmosphere is below 10 percent of the lower explosive limit; and that (b) In the judgment of the Inspector, the residues are not capable of producing a higher concentration that permitted under existing atmospheric conditions in the presence of fire and while maintained as directed on the Inspector's certificate, and further, (c) All adjacent spaces have either been cleaned sufficiently to prevent the spread of fire, are satisfactorily inerted, or in the case of fuel tanks, have been treated as deemed necessary by the Inspector.

The undersigned representative acknowledges receipt of this certificate and understands the conditions and limitations under which it was issued.

James Wilcox
REPRESENTATIVE

TITLE

Chiwish
INSPECTOR

DAY OR NIGHT
TELEPHONE
(510) 235-1393

CERTIFICATE
CERTIFIED SERVICES COMPANY

255 Parr Boulevard • Richmond, California 94801

NO. 37818

CUSTOMER
JOB NO. 52T0363
SUPERIOR

Site: 770 EL CHAERO R.
Pleasanton, CA

FOR: _____ TANK NO. _____ 30472
ECOLOGY CONTROL IND.

LOCATION: _____ RICHMOND, CA _____ DATE: _____ 3/18/2003 _____ TIME: _____ 8:09:52 _____

TEST METHOD _____ VISUAL GASTECH/1314 SMPN _____ LAST PRODUCT _____ DIESEL _____

This is to certify that I have personally determined that this tank is in accordance with the American Petroleum Institute and have found the condition to be in accordance with its assigned designation. This certificate is based on conditions existing at the time the inspection herein set forth was completed and is issued subject to compliance with all qualifications and instructions.

TANK SIZE _____ 1,000 GAL _____ CONDITION _____ SAFE FOR FIRE _____

REMARKS: _____ OXYGEN 20.9% LOWER EXPLOSIVE LIMIT LESS THAN 0.1% ECOLOGY CONTROL INDUSTRIES
HERBY CERTIFIES THAT THE ABOVE NUMBERED TANK HAS BEEN CUT OPEN, PROCESSED,
_____ AND THEREFORE DESTROYED AT OUR PERMITTED HAZARDOUS WASTE FACILITY.
_____ ECOLOGY CONTROL INDUSTRIES HAS THE APROPRIATE PERMITS FOR, AND HAS ACCEPTED
_____ THE TANK SHIPPED TO US FOR PROCESSING.

In the event of any physical or atmospheric changes affecting the gas-free conditions of the above tanks, or if in any doubt, immediately stop all hot work and contact the undersigned. This permit is valid for 24 hours if no physical or atmospheric changes occur.

STANDARD SAFETY DESIGNATION

SAFE FOR MEN: Means that in the compartment or space so designated (a) The oxygen content of the atmosphere is at least 19.5 percent by volume; and that (b) Toxic materials in the atmosphere are within permissable concentrations; and (c) In the judgment of the Inspector, the residues are not capable of producing toxic materials under existing atmospheric conditions while maintained as directed on the Inspector's certificate.

SAFE FOR FIRE: Means that in the compartment so designated (a) The concentration of flammable materials in the atmosphere is below 10 percent of the lower explosive limit; and that (b) In the judgment of the Inspector, the residues are not capable of producing a higher concentration that permitted under existing atmospheric conditions in the presence of fire and while maintained as directed on the Inspector's certificate, and further, (c) All adjacent spaces have either been cleaned sufficiently to prevent the spread of fire, are satisfactorily inerted, or in the case of fuel tanks, have been treated as deemed necessary by the Inspector.

The undersigned representative acknowledges receipt of this certificate and understands the conditions and limitations under which it was issued.

James Wilcox
REPRESENTATIVE

TITLE

Chris Wisin
INSPECTOR

DAY OR NIGHT
TELEPHONE
(510) 235-1393

CERTIFICATE CERTIFIED SERVICES COMPANY

255 Parr Boulevard • Richmond, California 94801

NO. 37817

CUSTOMER
JOB NO. 52T0363
SUPERIOR

Site: 770 ELCHARD RD.
PLEASANTON, CA

FOR: _____ ECOLOGY CONTROL IND. TANK NO. _____ 30473

LOCATION: _____ RICHMOND CA _____ DATE: _____ 3/18/2003 _____ TIME: _____ 8:18:19 _____

TEST METHOD _____ VISUAL GASTECH/1314 SMPN _____ LAST PRODUCT _____ DIESEL _____

This is to certify that I have personally determined that this tank is in accordance with the American Petroleum Institute and have found the condition to be in accordance with its assigned designation. This certificate is based on conditions existing at the time the inspection herein set forth was completed and is issued subject to compliance with all qualifications and instructions.

TANK SIZE _____ 1,000 GAL _____ CONDITION _____ SAFE FOR FIRE _____

REMARKS: _____ OXYGEN 20.9% LOWER EXPLOSIVE LIMIT LESS THAN 0.1% ECOLOGY CONTROL INDUSTRIES
_____ HERBY CERTIFIES THAT THE ABOVE NUMBERED TANK HAS BEEN CUT OPEN, PROCESSED,
_____ AND THEREFORE DESTROYED AT OUR PERMITTED HAZARDOUS WASTE FACILITY.
_____ ECOLOGY CONTROL INDUSTRIES HAS THE APPROPRIATE PERMITS FOR, AND HAS ACCEPTED
_____ THE TANK SHIPPED TO US FOR PROCESSING.

In the event of any physical or atmospheric changes affecting the gas-free conditions of the above tanks, or if in any doubt, immediately stop all hot work and contact the undersigned. This permit is valid for 24 hours if no physical or atmospheric changes occur.

STANDARD SAFETY DESIGNATION

SAFE FOR MEN: Means that in the compartment or space so designated (a) The oxygen content of the atmosphere is at least 19.5 percent by volume; and that (b) Toxic materials in the atmosphere are within permissible concentrations; and (c) In the judgment of the Inspector, the residues are not capable of producing toxic materials under existing atmospheric conditions while maintained as directed on the Inspector's certificate.

SAFE FOR FIRE: Means that in the compartment so designated (a) The concentration of flammable materials in the atmosphere is below 10 percent of the lower explosive limit; and that (b) In the judgment of the Inspector, the residues are not capable of producing a higher concentration that permitted under existing atmospheric conditions in the presence of fire and while maintained as directed on the Inspector's certificate, and further, (c) All adjacent spaces have either been cleaned sufficiently to prevent the spread of fire, are satisfactorily inerted, or in the case of fuel tanks, have been treated as deemed necessary by the Inspector.

The undersigned representative acknowledges receipt of this certificate and understands the conditions and limitations under which it was issued.

James Wilcox
REPRESENTATIVE

TITLE

[Signature]
INSPECTOR

DeMenno / Kerdoon

DEMENNO / KERDOON'S LABORATORY IS CERTIFIED BY THE CALIFORNIA DEPARTMENT OF HEALTH SERVICES ENVIRONMENTAL LABORATORY ACCREDITATION PROGRAM (ELAP) CERT. # 2037

224780

GENERATOR'S WASTE PROFILE WORKSHEET

GENERATOR'S INFORMATION

* A. GENERATOR'S NAME Pleasanton Gravel * B. EPA ID# CAC002559996

C. GENERATOR'S ADDRESS 770 El Charro D. PHONE (925) 551-7487

E. CITY, STATE, ZIP Pleasanton, CA

F. GENERATOR CONTACT John Sutfin ^{superior underground tank} G. TITLE _____

H. CUSTOMER NAME Asbury Env. Services I. PHONE (800) 727-2879

J. TRANSPORTER NAME Asbury Env. Services K. PHONE (800) 727-2879

L. TRANSPORTER EPA ID# CAD 028 277 036 M. CONTACT Dave Sato

A. NAME OF WASTE Non-blet Hazardous Waste, Liquid (Water, trace solids)

B. CALIFORNIA HAZARDOUS WASTE CODE NO. 343

C. EPA HAZARDOUS WASTE CODE NO. AD45

D. DESCRIBE PROCESS GENERATING WASTE Tank pump & flush
(formerly gasoline tank)

E. DOES THIS WASTE CONTAIN PCB'S? _____ yes no

F. DOES THIS WASTE CONTAIN DIOXIN? (F020-F028) _____ yes no

G. DOES THIS WASTE CONTAIN SULFIDES OR CYANIDES? _____ yes no

H. DOES THIS WASTE CONTAIN PESTICIDES OR HERBICIDES? _____ yes no
(IF YES, IDENTIFY IN ITEMS A OR D ABOVE.)

I. DOES THIS WASTE CONTAIN SOLVENTS? _____ yes no
(IF YES, IDENTIFY IN ITEMS A OR D ABOVE.)

J. DOES THIS WASTE CONTAIN PLATING WASTE? _____ yes no

K. HAS THIS WASTE BEEN MIXED WITH RCRA LISTED WASTE? _____ yes no
(F, K, U OR P EPA WASTE CODES)

L. IF YOU HAVE MSDS FOR COMPONENTS IN THIS WASTE, PLEASE ATTACH MSDS ATTACHED

M. IF YOU HAVE CURRENT ANALYSIS OF THIS WASTE, PLEASE ATTACH CHEMICAL ANALYSIS ATTACHED

GENERATOR'S CERTIFICATION

I HEREBY CERTIFY THAT THE INFORMATION PROVIDED ON THIS DOCUMENT, IS TRUE AND ACCURATE, AND NO INTENTIONAL MISREPRESENTATION HAS BEEN COMMITTED BY ANYONE. I FURTHER CERTIFY THAT ANY SAMPLE(S) PROVIDED WITH THIS WASTE PROFILE WERE TAKEN AND PRESERVED IN ACCORDANCE WITH 40 CFR 261, APPENDIX 1 AND ARE ACCURATE AND REPRESENTATIVE OF MY ACTUAL WASTE STREAM. I HEREBY AGREE TO NOTIFY DEMENNO / KERDOON SHOULD THIS WASTE STREAM CHANGE IN ANY WAY.

AUTHORIZED SIGNATURE [Signature] DATE 03/21/03

PRINT NAME AND TITLE DAVID G. KROGER, PRESIDENT

UNIFORM HAZARDOUS WASTE MANIFEST		1. Generator's US EPA ID No. CA1C000255999662389			Manifest Document No. 62389			2. Page 1 of 1			Information in the shaded areas is not required by Federal law.				
3. Generator's Name and Mailing Address Pleasanton Gravel 770, El Charro Road Pleasanton, CA 94550							A. State Manifest Document Number 22462389								
4. Generator's Phone (925) 551-7887							B. State Generator's ID								
5. Transporter 1 Company Name ASBURY ENVIRONMENTAL SERVICES				6. US EPA ID Number CA0028277036				C. State Transporter's ID [Reserved]			D. Transporter's Phone (800) 974-4495				
7. Transporter 2 Company Name							8. US EPA ID Number			E. State Transporter's ID [Reserved]			F. Transporter's Phone		
9. Designated Facility Name and Site Address DEMENNO / KERDOON 2000 NORTH ALAMEDA STREET COMPTON CA 90222							10. US EPA ID Number FAPPPPPPPPP			G. State Facility's ID			H. Facility's Phone (310) 537-7100		
11. US DOT Description (including Proper Shipping Name, Hazard Class, and ID Number)					12. Containers		13. Total Quantity		14. Unit Wt/Vol		I. Waste Number				
a. NON-RCRA HAZARDOUS WASTE, LIQUID (WATER, TRACE GASOLINE)					0102 DIM		6101100 G				State 343 EPA/Other NONE				
b.											State EPA/Other				
c.											State EPA/Other				
d.											State EPA/Other				
J. Additional Descriptions for Materials Listed Above 11A) 224780 2 x 55 G							K. Handling Codes for Wastes Listed Above								
15. Special Handling Instructions and Additional Information USE PPE NAERG #: 11A. 171 Project # EMERGENCY CONTACT: CHEMTREC 1-800-424-9300															
16. GENERATOR'S CERTIFICATION: I hereby declare that the contents of this consignment are fully and accurately described above by proper shipping name and are classified, packed, marked, and labeled, and are in all respects in proper condition for transport by highway according to applicable international and national government regulations. If I am a large quantity generator, I certify that I have a program in place to reduce the volume and toxicity of waste generated to the degree I have determined to be economically practicable and that I have selected the practicable method of treatment, storage, or disposal currently available to me which minimizes the present and future threat to human health and the environment; OR, if I am a small quantity generator, I have made a good faith effort to minimize my waste generation and select the best waste management method that is available to me and that I can afford.															
Printed/Typed Name				Signature				Month Day Year							
[Signature]				[Signature]				04/01/03							
17. Transporter 1 Acknowledgement of Receipt of Materials															
Printed/Typed Name				Signature				Month Day Year							
Carlos Barajas				[Signature]				04/01/03							
18. Transporter 2 Acknowledgement of Receipt of Materials															
Printed/Typed Name				Signature				Month Day Year							
19. Discrepancy Indication Space															
20. Facility Owner or Operator Certification of receipt of hazardous materials covered by this manifest except as noted in Item 19.															
Printed/Typed Name				Signature				Month Day Year							

DO NOT WRITE BELOW THIS LINE.

406620
 1-800-880-8800
 THIN
 1-800-880-8800
 RES
 CE
 DR S
 ERGE
 E O
 RGE
 FAC
 ILI
 TY

APPENDIX B
SAMPLING PROTOCOL AND ANALYTICAL RESULTS

Soil samples for laboratory analysis were collected in brass liners. The ends of the liners were covered in aluminum foil or Teflon film, fitted with plastic end caps, taped, and labeled with a unique identification number. The samples were then placed in an ice-chilled cooler, and transported to a state-certified analytical laboratory with chain of custody documentation. All sampling equipment was cleaned in a solution of laboratory grade detergent and distilled water or steam cleaned before use at each sampling point.

The chilled samples were delivered to a state-certified analytical laboratory for analysis. Attached are copies of the analytical results and the chain of custody forms.

Lowney & Associates Oakland

February 28, 2003

167 Filbert Street
Oakland, Ca 94607
Attn.: Mark Arniola
Project#: P12197
Project: 770 El Carro

Dear Mr. Arniola,

Attached is our report for your samples received on 02/21/2003 15:15
This report has been reviewed and approved for release. Reproduction of this report
is permitted only in its entirety.

Please note that any unused portion of the samples will be discarded after
04/07/2003 unless you have requested otherwise.

We appreciate the opportunity to be of service to you. If you have any questions,
please call me at (925) 484-1919.

You can also contact me via email. My email address is: vvancil@stl-inc.com

Sincerely,



Vincent Vancil
Project Manager

Fuel Oxygenates by 8260B

Lowney & Associates Oakland

Attn.: Mark Arniola

167 Filbert Street

Oakland, Ca 94607

Phone: (510) 267-1970 Fax: (510) 267-1972

Project: P12197

770 El Carro

Received: 02/21/2003 15:15

Samples Reported

Sample Name	Date Sampled	Matrix	Lab #
T-1-1	02/21/2003	Soil	1
T-1-2	02/21/2003	Soil	2
T-2-1	02/21/2003	Soil	3
T-2-2	02/21/2003	Soil	4
T-3-1	02/21/2003	Soil	5
T-3-2	02/21/2003	Soil	6
SP-(1-4)	02/21/2003	Soil	7
SP-(5-8)	02/21/2003	Soil	8
SP-(9-12)	02/21/2003	Soil	9
SP-(13-16)	02/21/2003	Soil	10

Severn Trent Laboratories, Inc.

STL San Francisco * 1220 Quarry Lane, Pleasanton, CA 94566

Tel 925 484 1919 Fax 925 484 1096 * www.stl-inc.com * CA DHS ELAP# 2496

02/27/2003 14:39

Fuel Oxygenates by 8260B

Lowney & Associates Oakland

Attn.: Mark Arniola

167 Filbert Street

Oakland, Ca 94607

Phone: (510) 267-1970 Fax: (510) 267-1972

Project: P12197

770 El Carro

Received: 02/21/2003 15:15

Prep(s):	5030B	Test(s):	8260B
Sample ID:	T-1-1	Lab ID:	2003-02-0416 - 1
Sampled:	02/21/2003	Extracted:	2/26/2003 14:08
Matrix:	Soil	QC Batch#:	2003/02/26-01.62

Compound	Conc.	RL	Unit	Dilution	Analyzed	Flag
Gasoline	ND	1000	ug/Kg	1.00	02/26/2003 14:08	
tert-Butyl alcohol (TBA)	ND	5.0	ug/Kg	1.00	02/26/2003 14:08	
Methyl tert-butyl ether (MTBE)	ND	5.0	ug/Kg	1.00	02/26/2003 14:08	
Di-isopropyl Ether (DIPE)	ND	10	ug/Kg	1.00	02/26/2003 14:08	
Ethyl tert-butyl ether (ETBE)	ND	5.0	ug/Kg	1.00	02/26/2003 14:08	
tert-Amyl methyl ether (TAME)	ND	5.0	ug/Kg	1.00	02/26/2003 14:08	
1,2-DCA	ND	5.0	ug/Kg	1.00	02/26/2003 14:08	
EDB	ND	5.0	ug/Kg	1.00	02/26/2003 14:08	
Benzene	ND	5.0	ug/Kg	1.00	02/26/2003 14:08	
Toluene	ND	5.0	ug/Kg	1.00	02/26/2003 14:08	
Ethyl benzene	ND	5.0	ug/Kg	1.00	02/26/2003 14:08	
Total xylenes	ND	5.0	ug/Kg	1.00	02/26/2003 14:08	
Surrogates(s)						
1,2-Dichloroethane-d4	102.9	70-121	%	1.00	02/26/2003 14:08	
Toluene-d8	94.8	81-117	%	1.00	02/26/2003 14:08	

Severn Trent Laboratories, Inc.

STL San Francisco * 1220 Quarry Lane, Pleasanton, CA 94566

Tel 925 484 1919 Fax 925 484 1096 * www.stl-inc.com * CA DHS ELAP# 2496

02/27/2003 14:39

Fuel Oxygenates by 8260B

Lowney & Associates Oakland

Attn.: Mark Arniola

167 Filbert Street

Oakland, Ca 94607

Phone: (510) 267-1970 Fax: (510) 267-1972

Project: P12197

770 El Carro

Received: 02/21/2003 15:15

Prep(s):	5030B	Test(s):	8260B
Sample ID:	T-1-2	Lab ID:	2003-02-0416 - 2
Sampled:	02/21/2003	Extracted:	2/26/2003 14:30
Matrix:	Soil	QC Batch#:	2003/02/26-01.62

Compound	Conc.	RL	Unit	Dilution	Analyzed	Flag
Gasoline	ND	1000	ug/Kg	1.00	02/26/2003 14:30	
tert-Butyl alcohol (TBA)	ND	5.0	ug/Kg	1.00	02/26/2003 14:30	
Methyl tert-butyl ether (MTBE)	ND	5.0	ug/Kg	1.00	02/26/2003 14:30	
Di-isopropyl Ether (DIPE)	ND	10	ug/Kg	1.00	02/26/2003 14:30	
Ethyl tert-butyl ether (ETBE)	ND	5.0	ug/Kg	1.00	02/26/2003 14:30	
tert-Amyl methyl ether (TAME)	ND	5.0	ug/Kg	1.00	02/26/2003 14:30	
1,2-DCA	ND	5.0	ug/Kg	1.00	02/26/2003 14:30	
EDB	ND	5.0	ug/Kg	1.00	02/26/2003 14:30	
Benzene	ND	5.0	ug/Kg	1.00	02/26/2003 14:30	
Toluene	ND	5.0	ug/Kg	1.00	02/26/2003 14:30	
Ethyl benzene	ND	5.0	ug/Kg	1.00	02/26/2003 14:30	
Total xylenes	ND	5.0	ug/Kg	1.00	02/26/2003 14:30	
Surrogates(s)						
1,2-Dichloroethane-d4	103.1	70-121	%	1.00	02/26/2003 14:30	
Toluene-d8	95.2	81-117	%	1.00	02/26/2003 14:30	

Severn Trent Laboratories, Inc.

STL San Francisco * 1220 Quarry Lane, Pleasanton, CA 94566

Tel 925 484 1919 Fax 925 484 1096 * www.stl-inc.com * CA DHS ELAP# 2496

02/27/2003 14:39

Fuel Oxygenates by 8260B

Lowney & Associates Oakland

Attn.: Mark Arniola

167 Filbert Street
Oakland, Ca 94607
Phone: (510) 267-1970 Fax: (510) 267-1972

Project: P12197
770 El Carro

Received: 02/21/2003 15:15

Prep(s): 5030B	Test(s): 8260B
Sample ID: T-2-1	Lab ID: 2003-02-0416 - 3
Sampled: 02/21/2003	Extracted: 2/26/2003 14:52
Matrix: Soil	QC Batch#: 2003/02/26-01.62

Compound	Conc.	RL	Unit	Dilution	Analyzed	Flag
Gasoline	ND	1000	ug/Kg	1.00	02/26/2003 14:52	
tert-Butyl alcohol (TBA)	ND	5.0	ug/Kg	1.00	02/26/2003 14:52	
Methyl tert-butyl ether (MTBE)	ND	5.0	ug/Kg	1.00	02/26/2003 14:52	
Di-isopropyl Ether (DIPE)	ND	10	ug/Kg	1.00	02/26/2003 14:52	
Ethyl tert-butyl ether (ETBE)	ND	5.0	ug/Kg	1.00	02/26/2003 14:52	
tert-Amyl methyl ether (TAME)	ND	5.0	ug/Kg	1.00	02/26/2003 14:52	
1,2-DCA	ND	5.0	ug/Kg	1.00	02/26/2003 14:52	
EDB	ND	5.0	ug/Kg	1.00	02/26/2003 14:52	
Benzene	ND	5.0	ug/Kg	1.00	02/26/2003 14:52	
Toluene	ND	5.0	ug/Kg	1.00	02/26/2003 14:52	
Ethyl benzene	ND	5.0	ug/Kg	1.00	02/26/2003 14:52	
Total xylenes	ND	5.0	ug/Kg	1.00	02/26/2003 14:52	
Surrogates(s)						
1,2-Dichloroethane-d4	104.4	70-121	%	1.00	02/26/2003 14:52	
Toluene-d8	92.6	81-117	%	1.00	02/26/2003 14:52	

Fuel Oxygenates by 8260B

Lowney & Associates Oakland

Attn.: Mark Arniola

167 Filbert Street

Oakland, Ca 94607

Phone: (510) 267-1970 Fax: (510) 267-1972

Project: P12197

770 El Carro

Received: 02/21/2003 15:15

Prep(s):	5030B	Test(s):	8260B
Sample ID:	T-2-2	Lab ID:	2003-02-0416 - 4
Sampled:	02/21/2003	Extracted:	2/26/2003 15:15
Matrix:	Soil	QC Batch#:	2003/02/26-01.62

Compound	Conc.	RL	Unit	Dilution	Analyzed	Flag
Gasoline	ND	1000	ug/Kg	1.00	02/26/2003 15:15	
tert-Butyl alcohol (TBA)	ND	5.0	ug/Kg	1.00	02/26/2003 15:15	
Methyl tert-butyl ether (MTBE)	ND	5.0	ug/Kg	1.00	02/26/2003 15:15	
Di-isopropyl Ether (DIPE)	ND	10	ug/Kg	1.00	02/26/2003 15:15	
Ethyl tert-butyl ether (ETBE)	ND	5.0	ug/Kg	1.00	02/26/2003 15:15	
tert-Amyl methyl ether (TAME)	ND	5.0	ug/Kg	1.00	02/26/2003 15:15	
1,2-DCA	ND	5.0	ug/Kg	1.00	02/26/2003 15:15	
EDB	ND	5.0	ug/Kg	1.00	02/26/2003 15:15	
Benzene	ND	5.0	ug/Kg	1.00	02/26/2003 15:15	
Toluene	ND	5.0	ug/Kg	1.00	02/26/2003 15:15	
Ethyl benzene	ND	5.0	ug/Kg	1.00	02/26/2003 15:15	
Total xylenes	ND	5.0	ug/Kg	1.00	02/26/2003 15:15	
Surrogates(s)						
1,2-Dichloroethane-d4	105.6	70-121	%	1.00	02/26/2003 15:15	
Toluene-d8	93.0	81-117	%	1.00	02/26/2003 15:15	

Severn Trent Laboratories, Inc.

STL San Francisco * 1220 Quarry Lane, Pleasanton, CA 94566

Tel 925 484 1919 Fax 925 484 1096 * www.stl-inc.com * CA DHS ELAP# 2496

02/27/2003 14:39

Fuel Oxygenates by 8260B

Lowney & Associates Oakland

Attn.: Mark Arniola

167 Filbert Street

Oakland, Ca 94607

Phone: (510) 267-1970 Fax: (510) 267-1972

Project: P12197

770 El Carro

Received: 02/21/2003 15:15

Prep(s):	5030B	Test(s):	8260B
Sample ID:	T-3-1	Lab ID:	2003-02-0416 - 5
Sampled:	02/21/2003	Extracted:	2/26/2003 15:59
Matrix:	Soil	QC Batch#:	2003/02/26-01.62

Compound	Conc.	RL	Unit	Dilution	Analyzed	Flag
Gasoline	ND	1000	ug/Kg	1.00	02/26/2003 15:59	
tert-Butyl alcohol (TBA)	ND	5.0	ug/Kg	1.00	02/26/2003 15:59	
Methyl tert-butyl ether (MTBE)	ND	5.0	ug/Kg	1.00	02/26/2003 15:59	
Di-isopropyl Ether (DIPE)	ND	10	ug/Kg	1.00	02/26/2003 15:59	
Ethyl tert-butyl ether (ETBE)	ND	5.0	ug/Kg	1.00	02/26/2003 15:59	
tert-Amyl methyl ether (TAME)	ND	5.0	ug/Kg	1.00	02/26/2003 15:59	
1,2-DCA	ND	5.0	ug/Kg	1.00	02/26/2003 15:59	
EDB	ND	5.0	ug/Kg	1.00	02/26/2003 15:59	
Benzene	ND	5.0	ug/Kg	1.00	02/26/2003 15:59	
Toluene	ND	5.0	ug/Kg	1.00	02/26/2003 15:59	
Ethyl benzene	ND	5.0	ug/Kg	1.00	02/26/2003 15:59	
Total xylenes	ND	5.0	ug/Kg	1.00	02/26/2003 15:59	
Surrogates(s)						
1,2-Dichloroethane-d4	108.6	70-121	%	1.00	02/26/2003 15:59	
Toluene-d8	93.5	81-117	%	1.00	02/26/2003 15:59	

Severn Trent Laboratories, Inc.

STL San Francisco * 1220 Quarry Lane, Pleasanton, CA 94566

Tel 925 484 1919 Fax 925 484 1096 * www.stl-inc.com * CA DHS ELAP# 2496

02/27/2003 14:39

Fuel Oxygenates by 8260B

Lowney & Associates Oakland

Attn.: Mark Arniola

167 Filbert Street

Oakland, Ca 94607

Phone: (510) 267-1970 Fax: (510) 267-1972

Project: P12197

770 El Carro

Received: 02/21/2003 15:15

Prep(s):	5030B	Test(s):	8260B
Sample ID:	T-3-2	Lab ID:	2003-02-0416 - 6
Sampled:	02/21/2003	Extracted:	2/26/2003 16:22
Matrix:	Soil	QC Batch#:	2003/02/26-01.62

Compound	Conc.	RL	Unit	Dilution	Analyzed	Flag
Gasoline	ND	1000	ug/Kg	1.00	02/26/2003 16:22	
tert-Butyl alcohol (TBA)	ND	5.0	ug/Kg	1.00	02/26/2003 16:22	
Methyl tert-butyl ether (MTBE)	ND	5.0	ug/Kg	1.00	02/26/2003 16:22	
Di-isopropyl Ether (DIPE)	ND	10	ug/Kg	1.00	02/26/2003 16:22	
Ethyl tert-butyl ether (ETBE)	ND	5.0	ug/Kg	1.00	02/26/2003 16:22	
tert-Amyl methyl ether (TAME)	ND	5.0	ug/Kg	1.00	02/26/2003 16:22	
1,2-DCA	ND	5.0	ug/Kg	1.00	02/26/2003 16:22	
EDB	ND	5.0	ug/Kg	1.00	02/26/2003 16:22	
Benzene	ND	5.0	ug/Kg	1.00	02/26/2003 16:22	
Toluene	ND	5.0	ug/Kg	1.00	02/26/2003 16:22	
Ethyl benzene	ND	5.0	ug/Kg	1.00	02/26/2003 16:22	
Total xylenes	ND	5.0	ug/Kg	1.00	02/26/2003 16:22	
Surrogates(s)						
1,2-Dichloroethane-d4	106.5	70-121	%	1.00	02/26/2003 16:22	
Toluene-d8	92.2	81-117	%	1.00	02/26/2003 16:22	

Severn Trent Laboratories, Inc.

STL San Francisco * 1220 Quarry Lane, Pleasanton, CA 94566

Tel 925 484 1919 Fax 925 484 1096 * www.stl-inc.com * CA DHS ELAP# 2496

02/27/2003 14:39

Fuel Oxygenates by 8260B

Lowney & Associates Oakland

Attn.: Mark Arniola

167 Filbert Street

Oakland, Ca 94607

Phone: (510) 267-1970 Fax: (510) 267-1972

Project: P12197

770 El Carro

Received: 02/21/2003 15:15

Prep(s):	5030B	Test(s):	8260B
Sample ID:	SP-(1-4)	Lab ID:	2003-02-0416 - 7
Sampled:	02/21/2003	Extracted:	2/26/2003 16:44
Matrix:	Soil	QC Batch#:	2003/02/26-01.62

Compound	Conc.	RL	Unit	Dilution	Analyzed	Flag
Gasoline	ND	1000	ug/Kg	1.00	02/26/2003 16:44	
tert-Butyl alcohol (TBA)	ND	5.0	ug/Kg	1.00	02/26/2003 16:44	
Methyl tert-butyl ether (MTBE)	ND	5.0	ug/Kg	1.00	02/26/2003 16:44	
Di-isopropyl Ether (DIPE)	ND	10	ug/Kg	1.00	02/26/2003 16:44	
Ethyl tert-butyl ether (ETBE)	ND	5.0	ug/Kg	1.00	02/26/2003 16:44	
tert-Amyl methyl ether (TAME)	ND	5.0	ug/Kg	1.00	02/26/2003 16:44	
1,2-DCA	ND	5.0	ug/Kg	1.00	02/26/2003 16:44	
EDB	ND	5.0	ug/Kg	1.00	02/26/2003 16:44	
Benzene	ND	5.0	ug/Kg	1.00	02/26/2003 16:44	
Toluene	5.1	5.0	ug/Kg	1.00	02/26/2003 16:44	
Ethyl benzene	ND	5.0	ug/Kg	1.00	02/26/2003 16:44	
Total xylenes	ND	5.0	ug/Kg	1.00	02/26/2003 16:44	
Surrogates(s)						
1,2-Dichloroethane-d4	105.1	70-121	%	1.00	02/26/2003 16:44	
Toluene-d8	95.7	81-117	%	1.00	02/26/2003 16:44	

Severn Trent Laboratories, Inc.

STL San Francisco * 1220 Quarry Lane, Pleasanton, CA 94566

Tel 925 484 1919 Fax 925 484 1096 * www.stl-inc.com * CA DHS ELAP# 2496

02/27/2003 14:39

Fuel Oxygenates by 8260B

Lowney & Associates Oakland

Attn.: Mark Arniola

167 Filbert Street

Oakland, Ca 94607

Phone: (510) 267-1970 Fax: (510) 267-1972

Project: P12197

770 El Carro

Received: 02/21/2003 15:15

Prep(s):	5030B	Test(s):	8260B
Sample ID:	SP-(5-8)	Lab ID:	2003-02-0416 - 8
Sampled:	02/21/2003	Extracted:	2/26/2003 17:06
Matrix:	Soil	QC Batch#:	2003/02/26-01.62

Compound	Conc.	RL	Unit	Dilution	Analyzed	Flag
Gasoline	ND	1000	ug/Kg	1.00	02/26/2003 17:06	
tert-Butyl alcohol (TBA)	ND	5.0	ug/Kg	1.00	02/26/2003 17:06	
Methyl tert-butyl ether (MTBE)	ND	5.0	ug/Kg	1.00	02/26/2003 17:06	
Di-isopropyl Ether (DIPE)	ND	10	ug/Kg	1.00	02/26/2003 17:06	
Ethyl tert-butyl ether (ETBE)	ND	5.0	ug/Kg	1.00	02/26/2003 17:06	
tert-Amyl methyl ether (TAME)	ND	5.0	ug/Kg	1.00	02/26/2003 17:06	
1,2-DCA	ND	5.0	ug/Kg	1.00	02/26/2003 17:06	
EDB	ND	5.0	ug/Kg	1.00	02/26/2003 17:06	
Benzene	ND	5.0	ug/Kg	1.00	02/26/2003 17:06	
Toluene	6.0	5.0	ug/Kg	1.00	02/26/2003 17:06	
Ethyl benzene	ND	5.0	ug/Kg	1.00	02/26/2003 17:06	
Total xylenes	ND	5.0	ug/Kg	1.00	02/26/2003 17:06	
Surrogates(s)						
1,2-Dichloroethane-d4	102.8	70-121	%	1.00	02/26/2003 17:06	
Toluene-d8	92.0	81-117	%	1.00	02/26/2003 17:06	

Severn Trent Laboratories, Inc.

STL San Francisco * 1220 Quarry Lane, Pleasanton, CA 94566

Tel 925 484 1919 Fax 925 484 1096 * www.stl-inc.com * CA DHS ELAP# 2496

02/27/2003 14:39

Fuel Oxygenates by 8260B

Lowney & Associates Oakland

Attn.: Mark Arniola

167 Filbert Street
Oakland, Ca 94607
Phone: (510) 267-1970 Fax: (510) 267-1972

Project: P12197
770 El Carro

Received: 02/21/2003 15:15

Prep(s): 5030B	Test(s): 8260B
Sample ID: SP-(9-12)	Lab ID: 2003-02-0416 - 9
Sampled: 02/21/2003	Extracted: 2/26/2003 17:28
Matrix: Soil	QC Batch#: 2003/02/26-01.62

Compound	Conc.	RL	Unit	Dilution	Analyzed	Flag
Gasoline	ND	1000	ug/Kg	1.00	02/26/2003 17:28	
tert-Butyl alcohol (TBA)	ND	5.0	ug/Kg	1.00	02/26/2003 17:28	
Methyl tert-butyl ether (MTBE)	ND	5.0	ug/Kg	1.00	02/26/2003 17:28	
Di-isopropyl Ether (DIPE)	ND	10	ug/Kg	1.00	02/26/2003 17:28	
Ethyl tert-butyl ether (ETBE)	ND	5.0	ug/Kg	1.00	02/26/2003 17:28	
tert-Amyl methyl ether (TAME)	ND	5.0	ug/Kg	1.00	02/26/2003 17:28	
1,2-DCA	ND	5.0	ug/Kg	1.00	02/26/2003 17:28	
EDB	ND	5.0	ug/Kg	1.00	02/26/2003 17:28	
Benzene	ND	5.0	ug/Kg	1.00	02/26/2003 17:28	
Toluene	8.7	5.0	ug/Kg	1.00	02/26/2003 17:28	
Ethyl benzene	ND	5.0	ug/Kg	1.00	02/26/2003 17:28	
Total xylenes	34	5.0	ug/Kg	1.00	02/26/2003 17:28	
Surrogates(s)						
1,2-Dichloroethane-d4	105.1	70-121	%	1.00	02/26/2003 17:28	
Toluene-d8	89.6	81-117	%	1.00	02/26/2003 17:28	

Fuel Oxygenates by 8260B

Lowney & Associates Oakland

Attn.: Mark Arniola

167 Filbert Street

Oakland, Ca 94607

Phone: (510) 267-1970 Fax: (510) 267-1972

Project: P12197

770 El Carro

Received: 02/21/2003 15:15

Prep(s): 5030B Test(s): 8260B
 Sample ID: SP-(13-16) Lab ID: 2003-02-0416 - 10
 Sampled: 02/21/2003 Extracted: 2/26/2003 17:51
 Matrix: Soil QC Batch#: 2003/02/26-01.62

Compound	Conc.	RL	Unit	Dilution	Analyzed	Flag
Gasoline	8800	1000	ug/Kg	1.00	02/26/2003 17:51	
tert-Butyl alcohol (TBA)	ND	5.0	ug/Kg	1.00	02/26/2003 17:51	
Methyl tert-butyl ether (MTBE)	ND	5.0	ug/Kg	1.00	02/26/2003 17:51	
Di-isopropyl Ether (DIPE)	ND	10	ug/Kg	1.00	02/26/2003 17:51	
Ethyl tert-butyl ether (ETBE)	ND	5.0	ug/Kg	1.00	02/26/2003 17:51	
tert-Amyl methyl ether (TAME)	ND	5.0	ug/Kg	1.00	02/26/2003 17:51	
1,2-DCA	ND	5.0	ug/Kg	1.00	02/26/2003 17:51	
EDB	ND	5.0	ug/Kg	1.00	02/26/2003 17:51	
Benzene	ND	5.0	ug/Kg	1.00	02/26/2003 17:51	
Toluene	8.1	5.0	ug/Kg	1.00	02/26/2003 17:51	
Ethyl benzene	20	5.0	ug/Kg	1.00	02/26/2003 17:51	
Total xylenes	140	5.0	ug/Kg	1.00	02/26/2003 17:51	
Surrogates(s)						
1,2-Dichloroethane-d4	107.2	70-121	%	1.00	02/26/2003 17:51	
Toluene-d8	88.3	81-117	%	1.00	02/26/2003 17:51	

Severn Trent Laboratories, Inc.

STL San Francisco * 1220 Quarry Lane, Pleasanton, CA 94566

Tel 925 484 1919 Fax 925 484 1096 * www.stl-inc.com * CA DHS ELAP# 2496

02/27/2003 14:39

Fuel Oxygenates by 8260B

Lowney & Associates Oakland

Attn.: Mark Arniola

167 Filbert Street

Oakland, Ca 94607

Phone: (510) 267-1970 Fax: (510) 267-1972

Project: P12197

770 El Carro

Received: 02/21/2003 15:15

Batch QC Report

Prep(s): 5030B

Method Blank

MB: 2003/02/26-01.62-037

Soil

Test(s): 8260B

QC Batch # 2003/02/26-01.62

Date Extracted: 02/26/2003 15:37

Compound	Conc.	RL	Unit	Analyzed	Flag
Gasoline	ND	1000	ug/Kg	02/26/2003 15:37	
tert-Butyl alcohol (TBA)	15.7	5.0	ug/Kg	02/26/2003 15:37	b
Methyl tert-butyl ether (MTBE)	ND	5.0	ug/Kg	02/26/2003 15:37	
Di-isopropyl Ether (DIPE)	ND	10.0	ug/Kg	02/26/2003 15:37	
Ethyl tert-butyl ether (ETBE)	ND	5.0	ug/Kg	02/26/2003 15:37	
tert-Amyl methyl ether (TAME)	ND	5.0	ug/Kg	02/26/2003 15:37	
1,2-DCA	ND	5.0	ug/Kg	02/26/2003 15:37	
EDB	ND	5.0	ug/Kg	02/26/2003 15:37	
Benzene	ND	5.0	ug/Kg	02/26/2003 15:37	
Toluene	ND	5.0	ug/Kg	02/26/2003 15:37	
Ethyl benzene	ND	5.0	ug/Kg	02/26/2003 15:37	
Total xylenes	ND	5.0	ug/Kg	02/26/2003 15:37	
Surrogates(s)					
1,2-Dichloroethane-d4	97.5	70-121	%	02/26/2003 15:37	
Toluene-d8	93.4	81-117	%	02/26/2003 15:37	

Severn Trent Laboratories, Inc.

STL San Francisco * 1220 Quarry Lane, Pleasanton, CA 94566

Tel 925 484 1919 Fax 925 484 1096 * www.stl-inc.com * CA DHS ELAP# 2496

02/27/2003 14:39

Fuel Oxygenates by 8260B

Lowney & Associates Oakland

Attn.: Mark Arniola

167 Filbert Street

Oakland, Ca 94607

Phone: (510) 267-1970 Fax: (510) 267-1972

Project: P12197

770 El Carro

Received: 02/21/2003 15:15

Batch QC Report

Prep(s): 5030B

Test(s): 8260B

Laboratory Control Spike

Soil

QC Batch # 2003/02/26-01.62

LCS 2003/02/26-01.62-001

Extracted: 02/26/2003

Analyzed: 02/26/2003 13:01

LCSD 2003/02/26-01.62-023

Extracted: 02/26/2003

Analyzed: 02/26/2003 13:23

Compound	Conc. ug/Kg		Exp. Conc.	Recovery		RPD	Ctrl. Limits %		Flags	
	LCS	LCSD		LCS	LCSD		%	Rec.	RPD	LCS
Methyl tert-butyl ether (MTBE)	46.4	47.2	50.0	92.8	94.4	1.7	65-165	20		
Benzene	46.9	47.1	50.0	93.8	94.2	0.4	69-129	20		
Toluene	46.5	47.0	50.0	93.0	94.0	1.1	70-130	20		
Surrogates(s)										
1,2-Dichloroethane-d4	524	531	500	104.8	106.2		70-121			
Toluene-d8	474	470	500	94.8	94.0		81-117			

Severn Trent Laboratories, Inc.

STL San Francisco * 1220 Quarry Lane, Pleasanton, CA 94566

Tel 925 484 1919 Fax 925 484 1096 * www.stl-inc.com * CA DHS ELAP# 2496

02/27/2003 14:39

Total Lead

Lowney & Associates Oakland

Attn.: Mark Arniola

167 Filbert Street

Oakland, Ca 94607

Phone: (510) 267-1970 Fax: (510) 267-1972

Project: P12197

770 El Carro

Received: 02/21/2003 15:15

Samples Reported

Sample Name	Date Sampled	Matrix	Lab #
T-1-1	02/21/2003	Soil	1
T-1-2	02/21/2003	Soil	2
T-2-1	02/21/2003	Soil	3
T-2-2	02/21/2003	Soil	4
T-3-1	02/21/2003	Soil	5
T-3-2	02/21/2003	Soil	6
SP-(1-4)	02/21/2003	Soil	7
SP-(5-8)	02/21/2003	Soil	8
SP-(9-12)	02/21/2003	Soil	9
SP-(13-16)	02/21/2003	Soil	10

Severn Trent Laboratories, Inc.

STL San Francisco * 1220 Quarry Lane, Pleasanton, CA 94566

Tel 925 484 1919 Fax 925 484 1096 * www.stl-inc.com * CA DHS ELAP# 2496

02/26/2003 08:45

Total Lead

Lowney & Associates Oakland

Attn.: Mark Arniola

167 Filbert Street

Oakland, Ca 94607

Phone: (510) 267-1970 Fax: (510) 267-1972

Project: P12197

770 El Carro

Received: 02/21/2003 15:15

Prep(s): 3050B	Test(s): 6010B
Sample ID: T-1-1	Lab ID: 2003-02-0416 - 1
Sampled: 02/21/2003	Extracted: 2/24/2003 14:39
Matrix: Soil	QC Batch#: 2003/02/24-07:15

Compound	Conc.	RL	Unit	Dilution	Analyzed	Flag
Lead	5.4	1.0	mg/Kg	1.00	02/24/2003 20:46	

Severn Trent Laboratories, Inc.

STL San Francisco * 1220 Quarry Lane, Pleasanton, CA 94566

Tel 925 484 1919 Fax 925 484 1096 * www.stl-inc.com * CA DHS ELAP# 2496

02/26/2003 08:45

Total Lead

Lowney & Associates Oakland

Attn.: Mark Arniola

167 Filbert Street

Oakland, Ca 94607

Phone: (510) 267-1970 Fax: (510) 267-1972

Project: P12197

770 El Carro

Received: 02/21/2003 15:15

Prep(s):	3050B	Test(s):	6010B
Sample ID:	T-1-2	Lab ID:	2003-02-0416 - 2
Sampled:	02/21/2003	Extracted:	2/24/2003 14:39
Matrix:	Soil	QC Batch#:	2003/02/24-07.15

Compound	Conc.	RL	Unit	Dilution	Analyzed	Flag
Lead	4.5	1.0	mg/Kg	1.00	02/24/2003 20:56	

Severn Trent Laboratories, Inc.

STL San Francisco * 1220 Quarry Lane, Pleasanton, CA 94566

Tel 925 484 1919 Fax 925 484 1096 * www.stl-inc.com * CA DHS ELAP# 2496

02/26/2003 08:45

Total Lead

Lowney & Associates Oakland

Attn.: Mark Arniola

167 Filbert Street

Oakland, Ca 94607

Phone: (510) 267-1970 Fax: (510) 267-1972

Project: P12197

770 El Carro

Received: 02/21/2003 15:15

Prep(s): 3050B	Test(s): 6010B
Sample ID: T-2-1	Lab ID: 2003-02-0416 - 3
Sampled: 02/21/2003	Extracted: 2/24/2003 14:39
Matrix: Soil	QC Batch#: 2003/02/24-07.15

Compound	Conc.	RL	Unit	Dilution	Analyzed	Flag
Lead	6.5	1.0	mg/Kg	1.00	02/24/2003 20:59	

Severn Trent Laboratories, Inc.

STL San Francisco * 1220 Quarry Lane, Pleasanton, CA 94566

Tel 925 484 1919 Fax 925 484 1096 * www.stl-inc.com * CA DHS ELAP# 2496

02/26/2003 08:45

Total Lead

Lowney & Associates Oakland

Attn.: Mark Arniola

167 Filbert Street

Oakland, Ca 94607

Phone: (510) 267-1970 Fax: (510) 267-1972

Project: P12197

770 El Carro

Received: 02/21/2003 15:15

Prep(s):	3050B	Test(s):	6010B
Sample ID:	T-2-2	Lab ID:	2003-02-0416 - 4
Sampled:	02/21/2003	Extracted:	2/24/2003 14:39
Matrix:	Soil	QC Batch#:	2003/02/24-07.15

Compound	Conc.	RL	Unit	Dilution	Analyzed	Flag
Lead	7.3	1.0	mg/Kg	1.00	02/24/2003 21:03	

Severn Trent Laboratories, Inc.

STL San Francisco * 1220 Quarry Lane, Pleasanton, CA 94566

Tel 925 484 1919 Fax 925 484 1096 * www.stl-inc.com * CA DHS ELAP# 2496

02/26/2003 08:45

Total Lead

Lowney & Associates Oakland

Attn.: Mark Arniola

167 Filbert Street

Oakland, Ca 94607

Phone: (510) 267-1970 Fax: (510) 267-1972

Project: P12197

770 El Carro

Received: 02/21/2003 15:15

Prep(s):	3050B	Test(s):	6010B
Sample ID:	T-3-1	Lab ID:	2003-02-0416 - 5
Sampled:	02/21/2003	Extracted:	2/24/2003 14:39
Matrix:	Soil	QC Batch#:	2003/02/24-07-15

Compound	Conc.	RL	Unit	Dilution	Analyzed	Flag
Lead	8.3	1.0	mg/Kg	1.00	02/24/2003 21:06	

Severn Trent Laboratories, Inc.

STL San Francisco * 1220 Quarry Lane, Pleasanton, CA 94566

Tel 925 484 1919 Fax 925 484 1096 * www.stl-inc.com * CA DHS ELAP# 2496

02/26/2003 08:45

Total Lead

Lowney & Associates Oakland

Attn.: Mark Arniola

167 Filbert Street

Oakland, Ca 94607

Phone: (510) 267-1970 Fax: (510) 267-1972

Project: P12197

770 El Carro

Received: 02/21/2003 15:15

Prep(s):	3050B	Test(s):	6010B
Sample ID:	T-3-2	Lab ID:	2003-02-0416 - 6
Sampled:	02/21/2003	Extracted:	2/24/2003 14:39
Matrix:	Soil	QC Batch#:	2003/02/24-07.15

Compound	Conc.	RL	Unit	Dilution	Analyzed	Flag
Lead	8.3	1.0	mg/Kg	1.00	02/24/2003 21:09	

Severn Trent Laboratories, Inc.

STL San Francisco * 1220 Quarry Lane, Pleasanton, CA 94566

Tel 925 484 1919 Fax 925 484 1096 * www.stl-inc.com * CA DHS ELAP# 2496

02/26/2003 08:45

Total Lead

Lowney & Associates Oakland

Attn.: Mark Arniola

167 Filbert Street

Oakland, Ca 94607

Phone: (510) 267-1970 Fax: (510) 267-1972

Project: P12197

770 El Carro

Received: 02/21/2003 15:15

Prep(s):	3050B	Test(s):	6010B
Sample ID:	SP-(1-4)	Lab ID:	2003-02-0416 - 7
Sampled:	02/21/2003	Extracted:	2/24/2003 14:39
Matrix:	Soil	QC Batch#:	2003/02/24-07.15

Compound	Conc.	RL	Unit	Dilution	Analyzed	Flag
Lead	5.8	1.0	mg/Kg	1.00	02/24/2003 21:13	

Severn Trent Laboratories, Inc.

STL San Francisco * 1220 Quarry Lane, Pleasanton, CA 94566

Tel 925 484 1919 Fax 925 484 1096 * www.stl-inc.com * CA DHS ELAP# 2496

02/26/2003 08:45

Total Lead

Lowney & Associates Oakland

Attn.: Mark Arniola

167 Filbert Street

Oakland, Ca 94607

Phone: (510) 267-1970 Fax: (510) 267-1972

Project: P12197

770 El Carro

Received: 02/21/2003 15:15

Prep(s):	3050B	Test(s):	6010B
Sample ID:	SP-(5-8)	Lab ID:	2003-02-0416 - 8
Sampled:	02/21/2003	Extracted:	2/24/2003 14:39
Matrix:	Soil	QC Batch#:	2003/02/24-07.15

Compound	Conc.	RL	Unit	Dilution	Analyzed	Flag
Lead	7.0	1.0	mg/Kg	1.00	02/24/2003 21:35	

Severn Trent Laboratories, Inc.

STL San Francisco * 1220 Quarry Lane, Pleasanton, CA 94566

Tel 925 484 1919 Fax 925 484 1096 * www.stl-inc.com * CA DHS ELAP# 2496

02/26/2003 08:45

Total Lead

Lowney & Associates Oakland

Attn.: Mark Arniola

167 Filbert Street

Oakland, Ca 94607

Phone: (510) 267-1970 Fax: (510) 267-1972

Project: P12197

770 El Carro

Received: 02/21/2003 15:15

Prep(s):	3050B	Test(s):	6010B
Sample ID:	SP-(9-12)	Lab ID:	2003-02-0416 - 9
Sampled:	02/21/2003	Extracted:	2/24/2003 14:39
Matrix:	Soil	QC Batch#:	2003/02/24-07.15

Compound	Conc.	RL	Unit	Dilution	Analyzed	Flag
Lead	8.8	1.0	mg/Kg	1.00	02/24/2003 21:38	

Severn Trent Laboratories, Inc.

STL San Francisco * 1220 Quarry Lane, Pleasanton, CA 94566

Tel 925 484 1919 Fax 925 484 1096 * www.stl-inc.com * CA DHS ELAP# 2496

02/26/2003 08:45

Total Lead

Lowney & Associates Oakland

Attn.: Mark Arniola

167 Filbert Street

Oakland, Ca 94607

Phone: (510) 267-1970 Fax: (510) 267-1972

Project: P12197

770 El Carro

Received: 02/21/2003 15:15

Prep(s):	3050B	Test(s):	6010B
Sample ID:	SP-(13-16)	Lab ID:	2003-02-0416 - 10
Sampled:	02/21/2003	Extracted:	2/24/2003 14:39
Matrix:	Soil	QC Batch#:	2003/02/24-07.15

Compound	Conc.	RL	Unit	Dilution	Analyzed	Flag
Lead	9.6	1.0	mg/Kg	1.00	02/24/2003 21:42	

Severn Trent Laboratories, Inc.

STL San Francisco * 1220 Quarry Lane, Pleasanton, CA 94566

Tel 925 484 1919 Fax 925 484 1096 * www.stl-inc.com * CA DHS ELAP# 2496

02/26/2003 08:45

Total Lead

Lowney & Associates Oakland

Attn.: Mark Arniola

167 Filbert Street

Oakland, Ca 94607

Phone: (510) 267-1970 Fax: (510) 267-1972

Project: P12197

770 El Carro

Received: 02/21/2003 15:15

Batch QC Report

Prep(s): 3050B

Method Blank

MB: 2003/02/24-07.15-049

Soil

Test(s): 6010B

QC Batch # 2003/02/24-07.15

Date Extracted: 02/24/2003 14:39

Compound	Conc.	RL	Unit	Analyzed	Flag
Lead	ND	1.0	mg/Kg	02/24/2003 20:24	

Total Lead

Lowney & Associates Oakland

Attn.: Mark Arniola

167 Filbert Street

Oakland, Ca 94607

Phone: (510) 267-1970 Fax: (510) 267-1972

Project: P12197

770 El Carro

Received: 02/21/2003 15:15

Batch QC Report

Prep(s): 3050B

Test(s): 6010B

Laboratory Control Spike

Soil

QC Batch # 2003/02/24-07.15

LCS 2003/02/24-07.15-050

Extracted: 02/24/2003

Analyzed: 02/24/2003 20:29

LCSD 2003/02/24-07.15-053

Extracted: 02/24/2003

Analyzed: 02/24/2003 20:42

Compound	Conc. mg/Kg		Exp.Conc.	Recovery		RPD	Ctrl.Limits %		Flags	
	LCS	LCSD		LCS	LCSD		%	Rec.	RPD	LCS
Lead	98.6	95.9	100.0	98.6	95.9	2.8	80-120	20		

Severn Trent Laboratories, Inc.

STL San Francisco * 1220 Quarry Lane, Pleasanton, CA 94566

Tel 925 484 1919 Fax 925 484 1096 * www.stl-inc.com * CA DHS ELAP# 2496

02/26/2003 08:45

Total Lead

Lowney & Associates Oakland

Attn.: Mark Arniola

167 Filbert Street

Oakland, Ca 94607

Phone: (510) 267-1970 Fax: (510) 267-1972

Project: P12197

770 El Carro

Received: 02/21/2003 15:15

Batch QC Report

Prep(s): 3050B

Test(s): 6010B

Matrix Spike (MS / MSD)

Soil

QC Batch # 2003/02/24-07.15

T-1-1 >> MS

Lab ID: 2003-02-0416 - 001

MS: 2003/02/24-07.15-055

Extracted: 02/24/2003

Analyzed: 02/24/2003 20:49

Dilution: 1.00

MSD: 2003/02/24-07.15-056

Extracted: 02/24/2003

Analyzed: 02/24/2003 20:52

Dilution: 1.00

Compound	Conc. mg/Kg			Spk.Level	Recovery			Limits %		Flags	
	MS	MSD	Sample	mg/Kg	MS	MSD	RPD	Rec.	RPD	MS	MSD
Lead	81.4	79.8	5.35	100.0	76.1	76.7	0.8	75-125	20		

Severn Trent Laboratories, Inc.

STL San Francisco * 1220 Quarry Lane, Pleasanton, CA 94566

Tel 925 484 1919 Fax 925 484 1096 * www.stl-inc.com * CA DHS ELAP# 2496

02/26/2003 08:45

Diesel with Silica Gel Clean-up

Lowney & Associates Oakland

Attn.: Mark Arniola

167 Filbert Street

Oakland, Ca 94607

Phone: (510) 267-1970 Fax: (510) 267-1972

Project: P12197

770 El Carro

Received: 02/21/2003 15:15

Samples Reported

Sample Name	Date Sampled	Matrix	Lab #
T-1-1	02/21/2003	Soil	1
T-1-2	02/21/2003	Soil	2
T-2-1	02/21/2003	Soil	3
T-2-2	02/21/2003	Soil	4
T-3-1	02/21/2003	Soil	5
T-3-2	02/21/2003	Soil	6
SP-(1-4)	02/21/2003	Soil	7
SP-(5-8)	02/21/2003	Soil	8
SP-(9-12)	02/21/2003	Soil	9
SP-(13-16)	02/21/2003	Soil	10

Severn Trent Laboratories, Inc.

STL San Francisco * 1220 Quarry Lane, Pleasanton, CA 94566

Tel 925 484 1919 Fax 925 484 1096 * www.stl-inc.com * CA DHS ELAP# 2496

02/28/2003 15:23

Diesel with Silica Gel Clean-up

Lowney & Associates Oakland

Attn.: Mark Amiola

167 Filbert Street

Oakland, Ca 94607

Phone: (510) 267-1970 Fax: (510) 267-1972

Project: P12197

770 El Carro

Received: 02/21/2003 15:15

Prep(s):	3550/8015M	Test(s):	8015M
Sample ID:	T-1-1	Lab ID:	2003-02-0416 - 1
Sampled:	02/21/2003	Extracted:	2/24/2003 07:18
Matrix:	Soil	QC Batch#:	2003/02/24-01.10

Compound	Conc.	RL	Unit	Dilution	Analyzed	Flag
Diesel	1.0	1.0	mg/Kg	1.00	02/25/2003 06:30	
Surrogates(s) o-Terphenyl	78.2	60-130	%	1.00	02/25/2003 06:30	

Severn Trent Laboratories, Inc.

STL San Francisco * 1220 Quarry Lane, Pleasanton, CA 94566

Tel 925 484 1919 Fax 925 484 1096 * www.stl-inc.com * CA DHS ELAP# 2496

02/28/2003 15:23

Diesel with Silica Gel Clean-up

Lowney & Associates Oakland

Attn.: Mark Amiola

167 Filbert Street

Oakland, Ca 94607

Phone: (510) 267-1970 Fax: (510) 267-1972

Project: P12197

770 El Carro

Received: 02/21/2003 15:15

Prep(s):	3550/8015M	Test(s):	8015M
Sample ID:	T-1-2	Lab ID:	2003-02-0416 - 2
Sampled:	02/21/2003	Extracted:	2/24/2003 07:18
Matrix:	Soil	QC Batch#:	2003/02/24-01.10

Compound	Conc.	RL	Unit	Dilution	Analyzed	Flag
Diesel	1.4	1.0	mg/Kg	1.00	02/25/2003 07:10	ndp
<i>Surrogates(s)</i> o-Terphenyl	76.4	60-130	%	1.00	02/25/2003 07:10	

Severn Trent Laboratories, Inc.

STL San Francisco * 1220 Quarry Lane, Pleasanton, CA 94566

Tel 925 484 1919 Fax 925 484 1096 * www.stl-inc.com * CA DHS ELAP# 2496

02/28/2003 15:23

Diesel with Silica Gel Clean-up

Lowney & Associates Oakland

Attn.: Mark Arniola

167 Filbert Street

Oakland, Ca 94607

Phone: (510) 267-1970 Fax: (510) 267-1972

Project: P12197

770 El Carro

Received: 02/21/2003 15:15

Prep(s):	3550/8015M	Test(s):	8015M
Sample ID:	T-2-1	Lab ID:	2003-02-0416 - 3
Sampled:	02/21/2003	Extracted:	2/26/2003 18:58
Matrix:	Soil	QC Batch#:	2003/02/26-03.10

Compound	Conc.	RL	Unit	Dilution	Analyzed	Flag
Diesel	ND	1.0	mg/Kg	1.00	02/27/2003 19:36	
Surrogates(s) o-Terphenyl	75.8	60-130	%	1.00	02/27/2003 19:36	

Severn Trent Laboratories, Inc.

STL San Francisco * 1220 Quarry Lane, Pleasanton, CA 94566

Tel 925 484 1919 Fax 925 484 1096 * www.stl-inc.com * CA DHS ELAP# 2496

02/28/2003 15:23

Diesel with Silica Gel Clean-up

Lowney & Associates Oakland

Attn.: Mark Arniola

167 Filbert Street

Oakland, Ca 94607

Phone: (510) 267-1970 Fax: (510) 267-1972

Project: P12197

770 El Carro

Received: 02/21/2003 15:15

Prep(s):	3550/8015M	Test(s):	8015M
Sample ID:	T-2-2	Lab ID:	2003-02-0416 - 4
Sampled:	02/21/2003	Extracted:	2/24/2003 07:18
Matrix:	Soil	QC Batch#:	2003/02/24-01.10

Compound	Conc.	RL	Unit	Dilution	Analyzed	Flag
Diesel	ND	1.0	mg/Kg	1.00	02/26/2003 16:08	
<i>Surrogates(s)</i> o-Terphenyl	57.8	60-130	%	1.00	02/26/2003 16:08	sl

Severn Trent Laboratories, Inc.

STL San Francisco * 1220 Quarry Lane, Pleasanton, CA 94566

Tel 925 484 1919 Fax 925 484 1096 * www.stl-inc.com * CA DHS ELAP# 2496

02/28/2003 15:23

Diesel with Silica Gel Clean-up

Lowney & Associates Oakland

Attn.: Mark Arniola

167 Filbert Street

Oakland, Ca 94607

Phone: (510) 267-1970 Fax: (510) 267-1972

Project: P12197

770 El Carro

Received: 02/21/2003 15:15

Prep(s):	3550/8015M	Test(s):	8015M
Sample ID:	T-3-1	Lab ID:	2003-02-0416 - 5
Sampled:	02/21/2003	Extracted:	2/24/2003 07:18
Matrix:	Soil	QC Batch#:	2003/02/24-01.10

Compound	Conc.	RL	Unit	Dilution	Analyzed	Flag
Diesel	59	1.0	mg/Kg	1.00	02/25/2003 09:12	ndp
Surrogates(s)						
o-Terphenyl	89.5	60-130	%	1.00	02/25/2003 09:12	

Severn Trent Laboratories, Inc.

STL San Francisco * 1220 Quarry Lane, Pleasanton, CA 94566

Tel 925 484 1919 Fax 925 484 1096 * www.stl-inc.com * CA DHS ELAP# 2496

02/28/2003 15:23

Diesel with Silica Gel Clean-up

Lowney & Associates Oakland

Attn.: Mark Arniola

167 Filbert Street
Oakland, Ca 94607

Phone: (510) 267-1970 Fax: (510) 267-1972

Project: P12197
770 El Carro

Received: 02/21/2003 15:15

Prep(s):	3550/8015M	Test(s):	8015M
Sample ID:	T-3-2	Lab ID:	2003-02-0416 - 6
Sampled:	02/21/2003	Extracted:	2/24/2003 07:18
Matrix:	Soil	QC Batch#:	2003/02/24-01.10

Compound	Conc.	RL	Unit	Dilution	Analyzed	Flag
Diesel	150	1.0	mg/Kg	1.00	02/25/2003 12:28	ndp
Surrogates(s) o-Terphenyl	91.4	60-130	%	1.00	02/25/2003 12:28	

Severn Trent Laboratories, Inc.

STL San Francisco * 1220 Quarry Lane, Pleasanton, CA 94566

Tel 925 484 1919 Fax 925 484 1096 * www.stl-inc.com * CA DHS ELAP# 2496

02/28/2003 15:23

Diesel with Silica Gel Clean-up

Lowney & Associates Oakland

Attn.: Mark Arniola

167 Filbert Street

Oakland, Ca 94607

Phone: (510) 267-1970 Fax: (510) 267-1972

Project: P12197

770 El Carro

Received: 02/21/2003 15:15

Prep(s):	3550/8015M	Test(s):	8015M
Sample ID:	SP-(1-4)	Lab ID:	2003-02-0416 - 7
Sampled:	02/21/2003	Extracted:	2/24/2003 07:18
Matrix:	Soil	QC Batch#:	2003/02/24-01:10

Compound	Conc.	RL	Unit	Dilution	Analyzed	Flag
Diesel	5.0	1.0	mg/Kg	1.00	02/26/2003 07:45	ndp
<i>Surrogates(s)</i> o-Terphenyl	75.3	60-130	%	1.00	02/26/2003 07:45	

Diesel with Silica Gel Clean-up

Lowney & Associates Oakland

Attn.: Mark Arniola

167 Filbert Street

Oakland, Ca 94607

Phone: (510) 267-1970 Fax: (510) 267-1972

Project: P12197

770 El Carro

Received: 02/21/2003 15:15

Prep(s):	3550/8015M	Test(s):	8015M
Sample ID:	SP-(5-8)	Lab ID:	2003-02-0416 - 8
Sampled:	02/21/2003	Extracted:	2/24/2003 07:18
Matrix:	Soil	QC Batch#:	2003/02/24-01 10

Compound	Conc.	RL	Unit	Dilution	Analyzed	Flag
Diesel	12	1.0	mg/Kg	1.00	02/25/2003 09:58	ndp
Surrogates(s) o-Terphenyl	91.7	60-130	%	1.00	02/25/2003 09:58	

Severn Trent Laboratories, Inc.

STL San Francisco * 1220 Quarry Lane, Pleasanton, CA 94566

Tel 925 484 1919 Fax 925 484 1096 * www.stl-inc.com * CA DHS ELAP# 2496

02/28/2003 15:23

Diesel with Silica Gel Clean-up

Lowney & Associates Oakland

Attn.: Mark Arniola

167 Filbert Street

Oakland, Ca 94607

Phone: (510) 267-1970 Fax: (510) 267-1972

Project: P12197

770 El Carro

Received: 02/21/2003 15:15

Prep(s):	3550/8015M	Test(s):	8015M
Sample ID:	SP-(9-12)	Lab ID:	2003-02-0416 - 9
Sampled:	02/21/2003	Extracted:	2/24/2003 07:18
Matrix:	Soil	QC Batch#:	2003/02/24-01.10

Compound	Conc.	RL	Unit	Dilution	Analyzed	Flag
Diesel	6.2	1.0	mg/Kg	1.00	02/25/2003 13:05	ndp
Surrogates(s) o-Terphenyl	64.7	60-130	%	1.00	02/25/2003 13:05	

Severn Trent Laboratories, Inc.

STL San Francisco * 1220 Quarry Lane, Pleasanton, CA 94566

Tel 925 484 1919 Fax 925 484 1096 * www.stl-inc.com * CA DHS ELAP# 2496

02/28/2003 15:23

Diesel with Silica Gel Clean-up

Lowney & Associates Oakland

Attn.: Mark Arniola

167 Filbert Street

Oakland, Ca 94607

Phone: (510) 267-1970 Fax: (510) 267-1972

Project: P12197

770 El Carro

Received: 02/21/2003 15:15

Prep(s):	3550/8015M	Test(s):	8015M
Sample ID:	SP-(13-16)	Lab ID:	2003-02-0416 - 10
Sampled:	02/21/2003	Extracted:	2/24/2003 07:18
Matrix:	Soil	QC Batch#:	2003/02/24-01.10

Compound	Conc.	RL	Unit	Dilution	Analyzed	Flag
Diesel	6.7	1.0	mg/Kg	1.00	02/25/2003 10:36	ndp
Surrogates(s) o-Terphenyl	82.7	60-130	%	1.00	02/25/2003 10:36	

Severn Trent Laboratories, Inc.

STL San Francisco * 1220 Quarry Lane, Pleasanton, CA 94566

Tel 925 484 1919 Fax 925 484 1096 * www.stl-inc.com * CA DHS ELAP# 2496

02/28/2003 15:23

Diesel with Silica Gel Clean-up

Lowney & Associates Oakland

Attn.: Mark Arniola

167 Filbert Street

Oakland, Ca 94607

Phone: (510) 267-1970 Fax: (510) 267-1972

Project: P12197

770 El Carro

Received: 02/21/2003 15:15

Batch QC Report

Prep(s): 3550/8015M

Method Blank

MB: 2003/02/24-01:10-001

Soil

Test(s): 8015M

QC Batch # 2003/02/24-01.10

Date Extracted: 02/24/2003 07:18

Compound	Conc.	RL	Unit	Analyzed	Flag
Diesel	ND	1	mg/Kg	02/24/2003 16:48	
Surrogates(s) o-Terphenyl	82.1	60-130	%	02/24/2003 16:48	

Severn Trent Laboratories, Inc.

STL San Francisco * 1220 Quarry Lane, Pleasanton, CA 94566

Tel 925 484 1919 Fax 925 484 1096 * www.stl-inc.com * CA DHS ELAP# 2496

02/28/2003 15:23

Diesel with Silica Gel Clean-up

Lowney & Associates Oakland

Attn.: Mark Arniola

167 Filbert Street

Oakland, Ca 94607

Phone: (510) 267-1970 Fax: (510) 267-1972

Project: P12197

770 El Carro

Received: 02/21/2003 15:15

Batch QC Report

Prep(s): 3550/8015M

Method Blank

MB: 2003/02/26-03.10-003

Soil

Test(s): 8015M

QC Batch # 2003/02/26-03.10

Date Extracted: 02/26/2003 18:58

Compound	Conc.	RL	Unit	Analyzed	Flag
Diesel	ND	1	mg/Kg	02/27/2003 16:37	
Surrogates(s) o-Terphenyl	70.3	60-130	%	02/27/2003 16:37	

Severn Trent Laboratories, Inc.

STL San Francisco * 1220 Quarry Lane, Pleasanton, CA 94566

Tel 925 484 1919 Fax 925 484 1096 * www.stl-inc.com * CA DHS ELAP# 2496

02/28/2003 15:23

Page 13 of 17

Diesel with Silica Gel Clean-up

Lowney & Associates Oakland

Attn.: Mark Arniola

167 Filbert Street

Oakland, Ca 94607

Phone: (510) 267-1970 Fax: (510) 267-1972

Project: P12197

770 El Carro

Received: 02/21/2003 15:15

Batch QC Report

Prep(s): 3550/8015M

Test(s): 8015M

Laboratory Control Spike

Soil

QC Batch # 2003/02/24-01.10

LCS 2003/02/24-01.10-002

Extracted: 02/24/2003

Analyzed: 02/25/2003 06:41

LCSD 2003/02/24-01.10-003

Extracted: 02/24/2003

Analyzed: 02/25/2003 07:18

Compound	Conc. mg/Kg		Exp.Conc.	Recovery		RPD	Ctrl.Limits %		Flags	
	LCS	LCSD		LCS	LCSD		%	Rec.	RPD	LCS
Diesel	34.8	34.3	41.7	83.5	82.3	1.4	60-130	25		
Surrogates(s) o-Terphenyl	19.8	19.5	20.0	98.8	97.4		60-130	0		

Severn Trent Laboratories, Inc.

STL San Francisco * 1220 Quarry Lane, Pleasanton, CA 94566

Tel 925 484 1919 Fax 925 484 1096 * www.stl-inc.com * CA DHS ELAP# 2496

02/28/2003 15:23

Diesel with Silica Gel Clean-up

Lowney & Associates Oakland

Attn.: Mark Arniola

167 Filbert Street

Oakland, Ca 94607

Phone: (510) 267-1970 Fax: (510) 267-1972

Project: P12197

770 El Carro

Received: 02/21/2003 15:15

Batch QC Report

Prep(s): 3550/8015M

Test(s): 8015M

Laboratory Control Spike

Soil

QC Batch # 2003/02/26-03.10

LCS 2003/02/26-03.10-001

Extracted: 02/26/2003

Analyzed: 02/27/2003 15:17

LCSD 2003/02/26-03.10-002

Extracted: 02/26/2003

Analyzed: 02/27/2003 15:57

Compound	Conc. mg/Kg		Exp.Conc.	Recovery		RPD	Ctrl.Limits %		Flags	
	LCS	LCSD		LCS	LCSD		%	Rec.	RPD	LCS
Diesel	35.7	37.0	41.6	85.8	88.9	3.5	60-130	25		
Surrogates(s) o-Terphenyl	17.6	18.1	20.0	87.8	90.7		60-130	0		

Severn Trent Laboratories, Inc.

STL San Francisco * 1220 Quarry Lane, Pleasanton, CA 94566

Tel 925 484 1919 Fax 925 484 1096 * www.stl-inc.com * CA DHS ELAP# 2496

02/26/2003 15:23

Diesel with Silica Gel Clean-up

Lowney & Associates Oakland

Attn.: Mark Arniola

167 Filbert Street
Oakland, Ca 94607
Phone: (510) 267-1970 Fax: (510) 267-1972

Project: P12197
770 El Carro

Received: 02/21/2003 15:15

Batch QC Report

Prep(s): 3550/8015M

Test(s): 8015M

Matrix Spike (MS / MSD)

Soil

QC Batch # 2003/02/24-01.10

SP-(13-16) >> MS

Lab ID: 2003-02-0416 - 010

MS: 2003/02/24-01.10-004

Extracted: 02/24/2003

Analyzed: 02/25/2003 11:55

Dilution: 1.00

MSD: 2003/02/24-01.10-005

Extracted: 02/24/2003

Analyzed: 02/25/2003 12:36

Dilution: 1.00

Compound	Conc. mg/Kg			Spk.Level	Recovery			Limits %		Flags	
	MS	MSD	Sample	mg/Kg	MS	MSD	RPD	Rec.	RPD	MS	MSD
Diesel	29.5	26.6	6.72	41.5	54.9	47.9	13.6	60-130	25	mso	mso
<i>Surrogate(s)</i> o-Terphenyl	19.0	15.6		20.0	95.2	78.2		60-130	0		

Severn Trent Laboratories, Inc.

STL San Francisco * 1220 Quarry Lane, Pleasanton, CA 94566

Tel 925 484 1919 Fax 925 484 1096 * www.stl-inc.com * CA DHS ELAP# 2496

02/28/2003 15:23

Diesel with Silica Gel Clean-up

Lowney & Associates Oakland

Attn.: Mark Arniola

167 Filbert Street

Oakland, Ca 94607

Phone: (510) 267-1970 Fax: (510) 267-1972

Project: P12197

770 El Carro

Received: 02/21/2003 15:15

Legend and Notes

Result Flag

mso

MS/MSD spike recoveries were out of QC limits due to matrix interference.
Precision and Accuracy were verified by LCS/LCSD.

ndp

Hydrocarbon reported does not match the pattern of our Diesel standard

sl

Surrogate recoveries were lower than QC limit due to matrix interference,
confirmed by reanalysis.

Severn Trent Laboratories, Inc.

STL San Francisco * 1220 Quany Lane, Pleasanton, CA 94566

Tel 925 484 1919 Fax 925 484 1096 * www.stl-inc.com * CA DHS ELAP# 2496

CHAIN OF CUSTODY RECORD

2003-02-04/16

Project Name: 770 EL CARRO

Job No.: P12197

Report To: Mark Arniola

Sampler (print): Charles Mettler

Sampler (signature): CL Mettler

Electronic Deliverable Format Required: YES NO

EDF LOGCODE: LAMV LAO LAF

Global ID #:

Turnaround Requirements

5 Working Days

48 Hours

24 Hours

2-3 Hours RUSH

QC Requirement:

Level A (standard)

ANALYSES REQUESTED

TPH as ~~gas~~ ~~BTEX~~ ~~(MTBE)~~
Method: 8015/8021 8260

TPH as diesel (8015M)
 add silica gel column add Oil Range

TRPH (418.1) with silica gel column

Halogenated VOCs (former 8010 list)
Method: 8021 8260 add BTEX

Organochlorine Pesticides (8081)

Metals: As, Pb, Hg 17 CAM
Please filter water samples before preserve

Fuel Oxygenates (MTBE, ETBE, TAME, DIPE, TBA, 1,2-DCA, and EDB) by 8260

PAHs (8310)

PCBs (8082)

Total Pb

Sample I.D. (Field Point Name)	Date	Time	Lab I.D.	Sample Matrix	No. of Cont.	TPH as gas BTEX (MTBE) Method: <input checked="" type="checkbox"/> 8015/8021 <input checked="" type="checkbox"/> 8260	TPH as diesel (8015M) <input checked="" type="checkbox"/> add silica gel column <input type="checkbox"/> add Oil Range	TRPH (418.1) with silica gel column	Halogenated VOCs (former 8010 list) Method: <input type="checkbox"/> 8021 <input type="checkbox"/> 8260 <input type="checkbox"/> add BTEX	Organochlorine Pesticides (8081)	Metals: <input type="checkbox"/> As, Pb, Hg <input type="checkbox"/> 17 CAM <i>Please filter water samples before preserve</i>	Fuel Oxygenates (MTBE, ETBE, TAME, DIPE, TBA, 1,2-DCA, and EDB) by 8260	PAHs (8310)	PCBs (8082)	Total Pb	Remarks
T-1-1	2-21-03			soil	1	✓	✓					✓				
T-1-2	↓			↓	↓	✓	✓					✓				
T-2-1	↓			↓	↓	✓	✓					✓				
T-2-2	↓			↓	↓	✓	✓					✓				
T-3-1	↓			↓	↓	✓	✓					✓				
T-3-2	↓			↓	↓	✓	✓					✓				
SP-1,2,3,4	↓			↓	↓	✓	✓					✓				
SP-5,6,7,8	↓			↓	↓	✓	✓					✓				CO in gas
SP-9,10,11,12	↓			↓	↓	✓	✓					✓				
SP-13,14,15,16	↓			↓	↓	✓	✓					✓				

Relinquished By: CL Mettler Date: 2-21-03 Time: 15:15

Relinquished By: _____ Date: _____ Time: _____

Relinquished By: _____ Date: _____ Time: _____

Received By: _____ Date: _____ Time: _____

Received By: _____ Date: _____ Time: _____

Lab of Record: STL-SF

Received by Lab: D. Narver Date: 2/21/03 Time: 1515 Temp: 6.0°C

PM Initial: _____

Temp: _____

STL San Francisco

Sample Receipt Checklist

Submission #: 2003- 02 - 0416

Checklist completed by: (initials) DSH Date: 02, 21 /03

Courier name: STL San Francisco Client _____

Custody seals intact on shipping container/samples

Yes ___ No ___ Not Present

Chain of custody present?

Yes No ___

Chain of custody signed when relinquished and received?

Yes No ___

Chain of custody agrees with sample labels?

Yes No ___

Samples in proper container/bottle?

Yes No ___

Sample containers intact?

Yes No ___

Sufficient sample volume for indicated test?

Yes No ___

All samples received within holding time?

Yes No ___

Container/Temp Blank temperature in compliance ($4^{\circ}C \pm 2$)?

Temp: 6.0 °C Yes No ___

Water - VOA vials have zero headspace?

No VOA vials submitted Yes ___ No ___

(if bubble is present, refer to approximate bubble size and itemize in comments as S (small ~O), M (medium ~ O) or L (large ~ O))

Water - pH acceptable upon receipt? Yes No

pH adjusted- Preservative used: HNO₃ HCl H₂SO₄ NaOH ZnOAc

For any item check-listed "No", provided detail of discrepancy in comment section below:

Comments:

Project Management [Routing for instruction of indicated discrepancy(ies)]

Project Manager: (initials) _____ Date: ____/____/03

Client contacted: Yes No

Summary of discussion:

Corrective Action (per PM/Client):