



Earth Systems Consultants
Northern California

47853 Warm Springs Blvd.
Fremont, CA 94539-7400
(510) 353-0320
Fax (510) 353-0344

File No. FRE-4948-03
April 14, 2003

Doc. No. 0304-043

Mirabito, Mooney, and Associates, Inc.
1615 Bonanza Street, Suite 208
Walnut Creek, California 94597-0459

Alameda County

APR 18 2003

Environmental Health

Attention: Mr. Stephen Mirabito

Subject: 8855 San Leandro Street
Oakland, California

SPUR SOIL DELINEATION INVESTIGATION REPORT

Dear Mr. Mirabito:

As requested, Earth Systems Consultants Northern California (ESCNC) has prepared the following report for submittal to the Alameda County Health Care Services Agency (ACHSCA) and the City of Oakland. The purpose of the report is to summarize the delineation soil sampling activity associated with the railroad track spur at the subject site (Figure 1).

A workplan was submitted via email to the ACHSCA for review. In an email dated April 4, 2003, the ACHSCA requested additional delineation sampling for the railroad track spur located on the western end of the subject site.

Scope of Work

The scope of work as based upon the ACHSCA letter is as follows:

1. Prepare a workplan showing location of the delineation sample.
2. Sample the soil within ten feet of the spur to provide background and extent of the lead, arsenic and PCBs present in the spur soil. The soil samples will be analyzed for arsenic and lead by EPA method 6010B and the PCBs by EPA method 8082A.
3. Preparation of a follow-up report covering observation and further recommendations.

Spur Soil Delineation Sampling Results and Discussion

Soil samples were collected on April 8, 2003 from locations 10 feet from the railroad spur located on the southern portion of the subject site. The samples from locations B1, B2 and B3 were collected at a depth of one and one-half feet and two to two and one-half feet. The six total samples were analyzed for PCBs by EPA Method 8082A, and Arsenic and Lead by EPA method 6010B.

The laboratory results for the six samples indicated that lead was reported at concentrations ranging from 7.2 parts per million (ppm) (B1-B) to 26 ppm (B2-A). Arsenic was reported as

non-detectable at the method limits. The PCB Aroclor 1260 was reported as non-detectable at the method limits. The summary of analytical results is shown in Table 1.

The sample results were compared to County action levels and EPA Preliminary Remediation Goals (PRGs) for industrial sites. None of the samples exceed the regulatory limits for industrial sites.

Recommendation

As discussed in the December 5, 2002 letter report, ESCNC recommends encapsulation of the soil on the spur rather than removal of the soil along the ties and rails along the spur.

ESCNC appreciates this opportunity to be of service.

Very truly yours,

**EARTH SYSTEMS CONSULTANTS
Northern California**



Gary Pischke
Senior Geologist
Certified Engineering Geologist 1501
Registered Environmental Assessor 04365

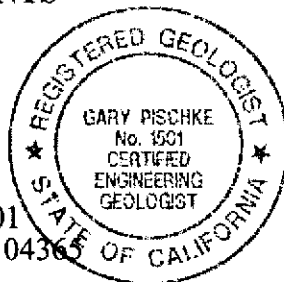

Carl W. Greenlee
Senior Engineer
Geotechnical Engineer 355

GP/CWG: gwDisk004.94

Distribution: 4 to addressee
2 to Alameda County Health Care Services Agency: Attn. Eva Chu

Attachments: Figure 1: Site Location Map
Figure 2: Site Plan showing sample locations.
Table 1
Laboratory Report

**TABLE 1
SOIL SAMPLE ANALYTICAL RESULTS**

8855 San Leandro Street
Railroad Spur
Oakland, California
(mg/Kg, parts per million)

Sample	Date	TPHmo	8082A (Aroclor 1260)	8081A (4,4 DDD)	8081A (4,4 DDT)	Arsenic	Lead
S1	11/27/02	2300 (a)	1.20	0.13	0.64	46	820.0
S2	11/27/02	340	0.38	ND	ND	35	740.0
B1-A (1.5')	04/08/03	N/A	ND<0.1	N/A	N/A	ND	8.8
B1-B (2.5')	04/08/03	N/A	ND<0.1	N/A	N/A	ND	7.2
B2-A (1.5')	04/08/03	N/A	ND<0.1	N/A	N/A	ND	26.0
B2-B (2.0')	04/08/03	N/A	ND<0.1	N/A	N/A	ND	12.0
B3-A (1.5')	04/08/03	N/A	ND<0.1	N/A	N/A	ND	9.6
B3-B (2.0')	04/08/03	N/A	ND<0.1	N/A	N/A	ND	13.0
CCRs						500.0	1000.0
PRGs			1.0	17.0	12.0	440.0	750.0
Background						16-65	30-300
RBSL			1.000	17.000	4.000	2.7	750
RBSL:Okld			.18/10			15/250	
Action Level		1000					

Notes:

- S1 Railroad Track Spur Sample
- B1 Railroad Track Spur Delineation Sample
- TPHmo Total Petroleum Hydrocarbons as Motor Oil
- 8082A PCBs: All other compounds were non-detectable
- 8081A Pesticides: All other compounds were non-detectable
- < Analyte less than indicated detection limit.
- (a) Results within quantitation range; chromatographic pattern not typical of fuel
- ND Not Detected as method detection limits
- PRG Preliminary Remediation Goals "risk-based concentrations" for industrial sites.
- RBSL Risk Based Screening Level- Industrial: RWQCB
- RBSL:Okld Risk Based Screening Level- Industrial: Oakland Tier 1 Levels
- N/A Not Analyzed.

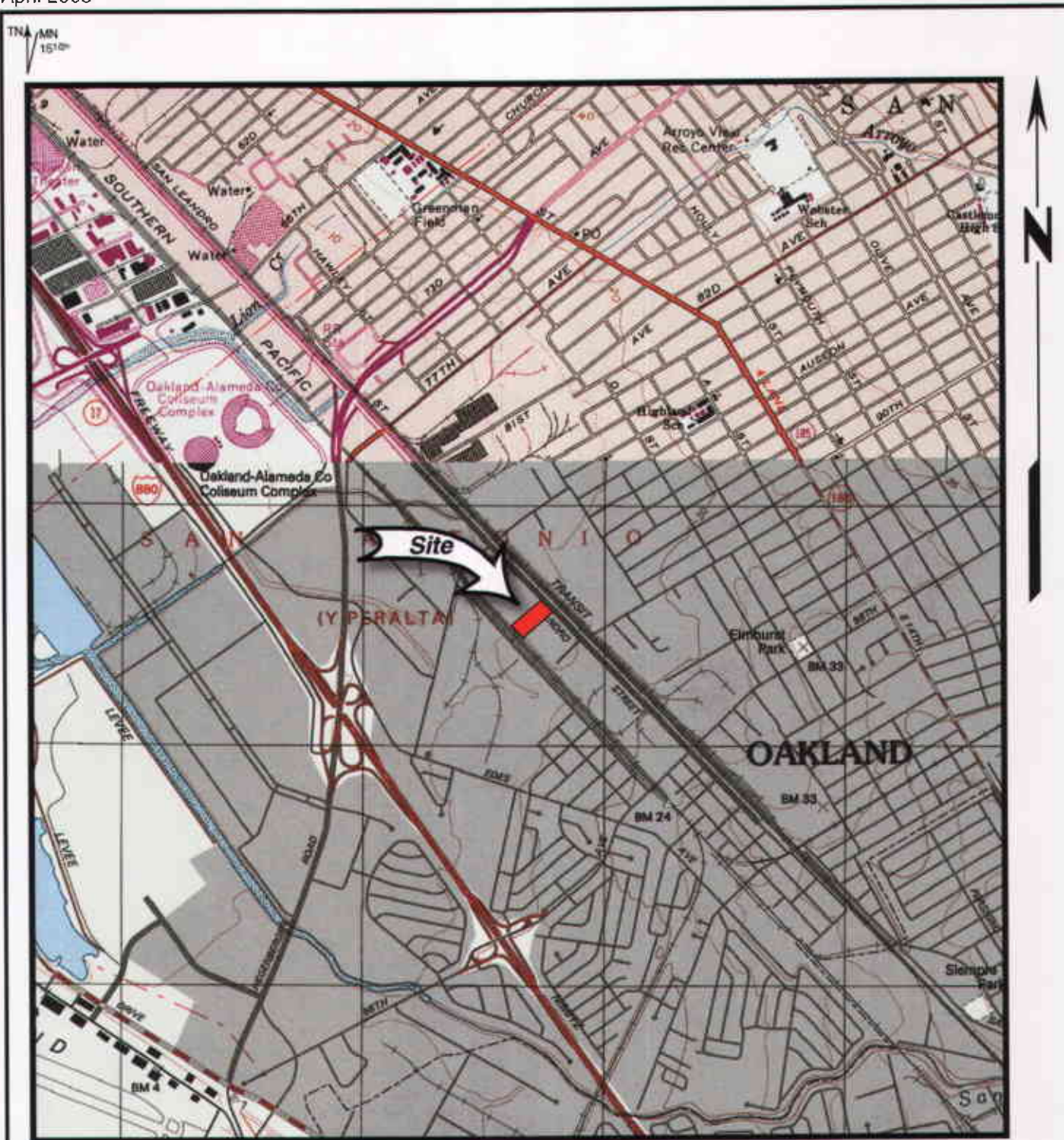

Approximate Scale 1: 24,000

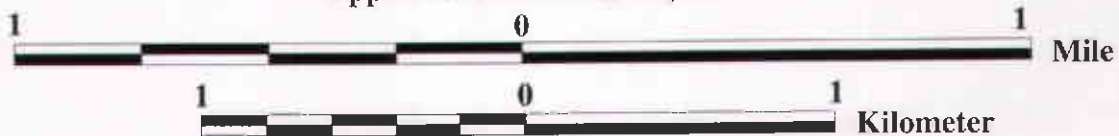

Base: USGS 7.5 minute San Leandro (1993) & Oakland East (1980) Quadangles
 Printed from TOPO!™ ©1997 Wildflower Productions (415) 558-8700, www.topo.com



Earth Systems Consultants
 Northern California

Self Storage Building
 8855 San Leandro Street
 Oakland, California

SITE LOCATION

Figure 1

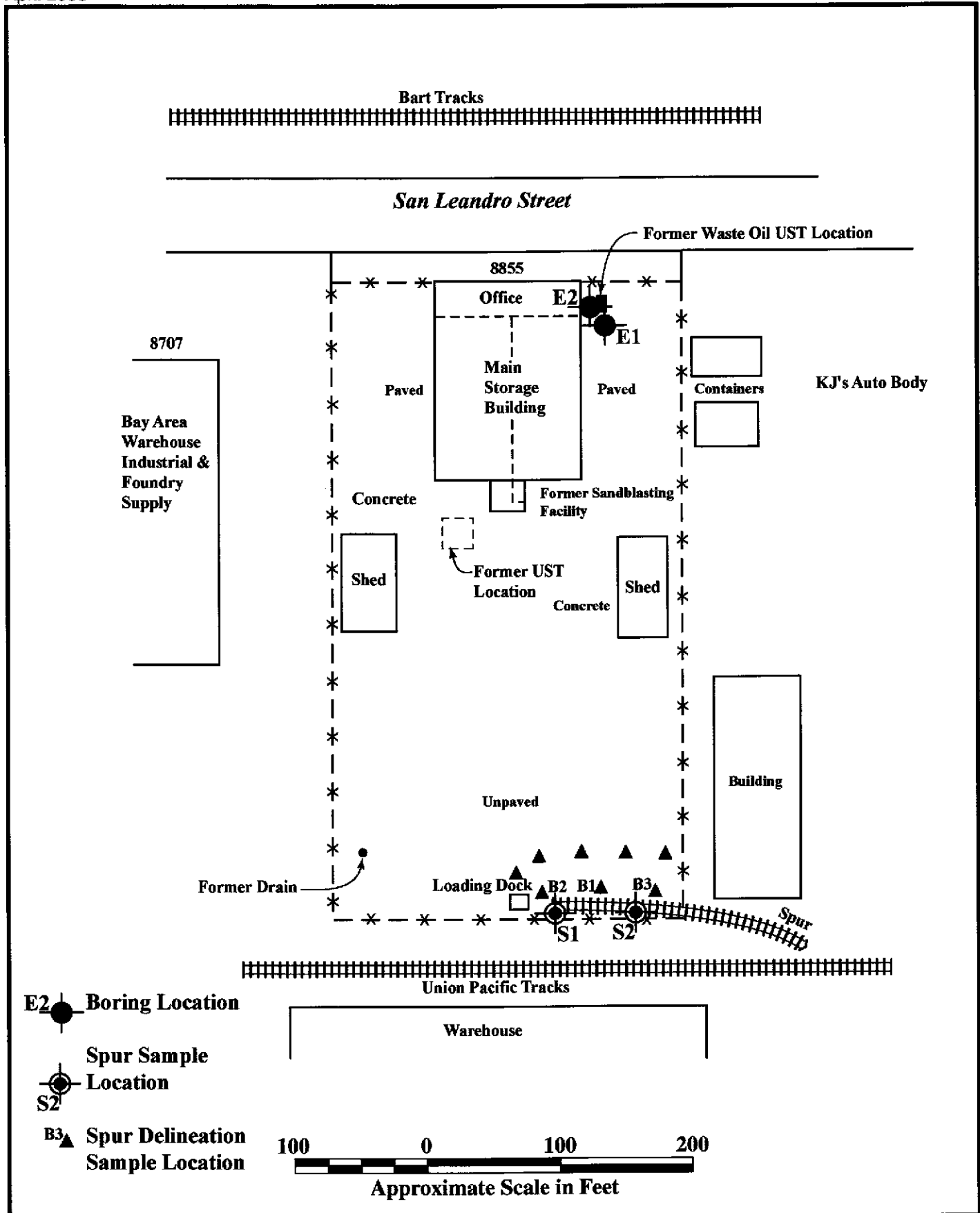

- E2** ● Boring Location
- S2** ● Spur Sample Location
- B3** ▲ Spur Delineation Sample Location



Entech Analytical Labs, Inc.

3334 Victor Court • Santa Clara, CA 95054 • (408) 588-0200 • Fax (408) 588-0201

April 10, 2003

Gary Pischke
Earth Systems Consultants
47853 Warm Springs Boulevard
Fremont, CA 94539-7400

Order: 33974
Project Name: Self Storage Bldg.
Project Number: FRS-4948-03
Project Notes:

Date Collected: 4/8/2003
Date Received: 4/8/2003
P.O. Number: FRS-4948-03

On April 08, 2003, samples were received under documented chain of custody. Results for the following analyses are attached:

<u>Matrix</u>	<u>Test</u>	<u>Method</u>
Solid	Arsenic	EPA 6010B
	EPA 8082A	EPA 8082A
	Lead	EPA 6010B

Chemical analysis of these samples has been completed. Summaries of the data are contained on the following pages. USEPA protocols for sample storage and preservation were followed.

Entech Analytical Labs, Inc. is certified by the State of California (#2346). If you have any questions regarding procedures or results, please call me at 408-588-0200.

Sincerely,



Patti Sandrock
QA/QC Manager

Entech Analytical Labs, Inc.

3334 Victor Court • Santa Clara, CA 95054 • (408) 588-0200 • Fax (408) 588-0201

Earth Systems Consultants
47853 Warm Springs Boulevard
Fremont, CA 94539-7400
Attn: Gary Pischke

Date: 4/10/03
Date Received: 4/8/2003
Project Name: Self Storage Bldg.
Project Number: FRS-4948-03
P.O. Number: FRS-4948-03
Sampled By: N.E.Berube

Certified Analytical Report

Order ID: 33974 Lab Sample ID: 33974-001 Client Sample ID: B1-A (1.5')
Sample Time: 8:20 AM Sample Date: 4/8/2003 Matrix: Solid

Parameter	Result	DF	PQL	DLR	Units	PrepDate	Analysis Date	QC Batch ID	Method
Arsenic	ND	1	1	1	mg/Kg	4/9/2003	4/10/2003	SM8300	EPA 6010B
Lead	8.8	1	1	1	mg/Kg	4/9/2003	4/10/2003	SM8300	EPA 6010B

Order ID: 33974 Lab Sample ID: 33974-002 Client Sample ID: B1-B(2.5')
Sample Time: 8:26 AM Sample Date: 4/8/2003 Matrix: Solid

Parameter	Result	DF	PQL	DLR	Units	PrepDate	Analysis Date	QC Batch ID	Method
Arsenic	ND	1	1	1	mg/Kg	4/9/2003	4/10/2003	SM8300	EPA 6010B
Lead	7.2	1	1	1	mg/Kg	4/9/2003	4/10/2003	SM8300	EPA 6010B

Order ID: 33974 Lab Sample ID: 33974-003 Client Sample ID: B2-A(1.5')
Sample Time: 8:45 AM Sample Date: 4/8/2003 Matrix: Solid

Parameter	Result	DF	PQL	DLR	Units	PrepDate	Analysis Date	QC Batch ID	Method
Arsenic	ND	1	1	1	mg/Kg	4/9/2003	4/10/2003	SM8300	EPA 6010B
Lead	26	1	1	1	mg/Kg	4/9/2003	4/10/2003	SM8300	EPA 6010B

Order ID: 33974 Lab Sample ID: 33974-004 Client Sample ID: B2-B(2.0')
Sample Time: 8:50 AM Sample Date: 4/8/2003 Matrix: Solid

Parameter	Result	DF	PQL	DLR	Units	PrepDate	Analysis Date	QC Batch ID	Method
Arsenic	ND	1	1	1	mg/Kg	4/9/2003	4/10/2003	SM8300	EPA 6010B
Lead	12	1	1	1	mg/Kg	4/9/2003	4/10/2003	SM8300	EPA 6010B

Order ID: 33974 Lab Sample ID: 33974-005 Client Sample ID: B3-A(1.5')
Sample Time: 9:00 AM Sample Date: 4/8/2003 Matrix: Solid

Parameter	Result	DF	PQL	DLR	Units	PrepDate	Analysis Date	QC Batch ID	Method
Arsenic	ND	1	1	1	mg/Kg	4/9/2003	4/10/2003	SM8300	EPA 6010B
Lead	9.6	1	1	1	mg/Kg	4/9/2003	4/10/2003	SM8300	EPA 6010B

DF = Dilution Factor ND = Not Detected DLR = Detection Limit Reported PQL = Practical Quantitation Limit

Analysis performed by Entech Analytical Labs, Inc. (CA ELAP #2346)



Patti Sandrock, QA/QC Manager

Environmental Analysis Since 1983

Entech Analytical Labs, Inc.

3334 Victor Court • Santa Clara, CA 95054 • (408) 588-0200 • Fax (408) 588-0201

Earth Systems Consultants
47853 Warm Springs Boulevard
Fremont, CA 94539-7400
Attn: Gary Pischke

Date: 4/10/03
Date Received: 4/8/2003
Project Name: Self Storage Bldg.
Project Number: FRS-4948-03
P.O. Number: FRS-4948-03
Sampled By: N.E.Berube

Certified Analytical Report

Order ID: 33974

Lab Sample ID: 33974-006

Client Sample ID: B3-B(2.0')

Sample Time: 9:10 AM

Sample Date: 4/8/2003

Matrix: Solid

Parameter	Result	DF	PQL	DLR	Units	PrepDate	Analysis Date	QC Batch ID	Method
Arsenic	ND	1	1	1	mg/Kg	4/9/2003	4/10/2003	SM8300	EPA 6010B
Lead	13	1	1	1	mg/Kg	4/9/2003	4/10/2003	SM8300	EPA 6010B

DF = Dilution Factor

ND = Not Detected

DLR = Detection Limit Reported

PQL = Practical Quantitation Limit

Analysis performed by Entech Analytical Labs, Inc. (CA ELAP #2346)

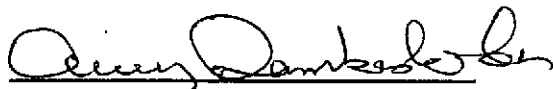

Patti Sandrock, QA/QC Manager

Environmental Analysis Since 1983

Entech Analytical Labs, Inc.

3334 Victor Court • Santa Clara, CA 95054 • (408) 588-0200 • Fax (408) 588-0201

Earth Systems Consultants
47853 Warm Springs Boulevard
Fremont, CA 94539-7400
Attn: Gary Pischke

Date: 4/10/03
Date Received: 4/8/2003
Project Name: Self Storage Bldg.
Project Number: FRS-4948-03
P.O. Number: FRS-4948-03
Sampled By: N.E.Berube

Certified Analytical Report

Order ID: 33974	Lab Sample ID: 33974-001	Client Sample ID: B1-A (1.5')								
Sample Time: 8:20 AM	Sample Date: 4/8/2003	Matrix: Solid								
Parameter	Result	Flag	DF	PQL	DLR	Units	Extraction Date	Analysis Date	QC Batch ID	Method
Aroclor 1016	ND		1	0.1	0.1	mg/Kg	4/8/2003	4/8/2003	PS7230B	EPA 8082A
Aroclor 1221	ND		1	0.1	0.1	mg/Kg	4/8/2003	4/8/2003	PS7230B	EPA 8082A
Aroclor 1232	ND		1	0.1	0.1	mg/Kg	4/8/2003	4/8/2003	PS7230B	EPA 8082A
Aroclor 1242	ND		1	0.1	0.1	mg/Kg	4/8/2003	4/8/2003	PS7230B	EPA 8082A
Aroclor 1248	ND		1	0.1	0.1	mg/Kg	4/8/2003	4/8/2003	PS7230B	EPA 8082A
Aroclor 1254	ND		1	0.1	0.1	mg/Kg	4/8/2003	4/8/2003	PS7230B	EPA 8082A
Aroclor 1260	ND		1	0.1	0.1	mg/Kg	4/8/2003	4/8/2003	PS7230B	EPA 8082A
Aroclor 1262	ND		1	0.1	0.1	mg/Kg	4/8/2003	4/8/2003	PS7230B	EPA 8082A
Aroclor 1268	ND		1	0.1	0.1	mg/Kg	4/8/2003	4/8/2003	PS7230B	EPA 8082A
Surrogate						Surrogate Recovery			Control Limits (%)	
Decachlorobiphenyl						124.8			42 - 127	

Order ID: 33974	Lab Sample ID: 33974-002	Client Sample ID: B1-B(2.5')								
Sample Time: 8:26 AM	Sample Date: 4/8/2003	Matrix: Solid								
Parameter	Result	Flag	DF	PQL	DLR	Units	Extraction Date	Analysis Date	QC Batch ID	Method
Aroclor 1016	ND		1	0.1	0.1	mg/Kg	4/8/2003	4/9/2003	PS7230B	EPA 8082A
Aroclor 1221	ND		1	0.1	0.1	mg/Kg	4/8/2003	4/9/2003	PS7230B	EPA 8082A
Aroclor 1232	ND		1	0.1	0.1	mg/Kg	4/8/2003	4/9/2003	PS7230B	EPA 8082A
Aroclor 1242	ND		1	0.1	0.1	mg/Kg	4/8/2003	4/9/2003	PS7230B	EPA 8082A
Aroclor 1248	ND		1	0.1	0.1	mg/Kg	4/8/2003	4/9/2003	PS7230B	EPA 8082A
Aroclor 1254	ND		1	0.1	0.1	mg/Kg	4/8/2003	4/9/2003	PS7230B	EPA 8082A
Aroclor 1260	ND		1	0.1	0.1	mg/Kg	4/8/2003	4/9/2003	PS7230B	EPA 8082A
Aroclor 1262	ND		1	0.1	0.1	mg/Kg	4/8/2003	4/9/2003	PS7230B	EPA 8082A
Aroclor 1268	ND		1	0.1	0.1	mg/Kg	4/8/2003	4/9/2003	PS7230B	EPA 8082A
Surrogate						Surrogate Recovery			Control Limits (%)	
Decachlorobiphenyl						124.3			42 - 127	

DF = Dilution Factor

ND = Not Detected

DLR = Detection Limit Reported

PQL = Practical Quantitation Limit

Analysis performed by Entech Analytical Labs, Inc. (CA ELAP #2346)



Patti Sandrock, QA/QC Manager

Environmental Analysis Since 1983

Entech Analytical Labs, Inc.

3334 Victor Court • Santa Clara, CA 95054 • (408) 588-0200 • Fax (408) 588-0201

Earth Systems Consultants
47853 Warm Springs Boulevard
Fremont, CA 94539-7400
Attn: Gary Pischke

Date: 4/10/03
Date Received: 4/8/2003
Project Name: Self Storage Bldg.
Project Number: FRS-4948-03
P.O. Number: FRS-4948-03
Sampled By: N.E.Berube

Certified Analytical Report

Order ID: 33974

Lab Sample ID: 33974-003

Client Sample ID: B2-A(1.5')

Sample Time: 8:45 AM

Sample Date: 4/8/2003

Matrix: Solid

Parameter	Result	Flag	DF	PQL	DLR	Units	Extraction Date	Analysis Date	QC Batch ID	Method
Aroclor 1016	ND		1	0.1	0.1	mg/Kg	4/8/2003	4/9/2003	PS7230B	EPA 8082A
Aroclor 1221	ND		1	0.1	0.1	mg/Kg	4/8/2003	4/9/2003	PS7230B	EPA 8082A
Aroclor 1232	ND		1	0.1	0.1	mg/Kg	4/8/2003	4/9/2003	PS7230B	EPA 8082A
Aroclor 1242	ND		1	0.1	0.1	mg/Kg	4/8/2003	4/9/2003	PS7230B	EPA 8082A
Aroclor 1248	ND		1	0.1	0.1	mg/Kg	4/8/2003	4/9/2003	PS7230B	EPA 8082A
Aroclor 1254	ND		1	0.1	0.1	mg/Kg	4/8/2003	4/9/2003	PS7230B	EPA 8082A
Aroclor 1260	ND		1	0.1	0.1	mg/Kg	4/8/2003	4/9/2003	PS7230B	EPA 8082A
Aroclor 1262	ND		1	0.1	0.1	mg/Kg	4/8/2003	4/9/2003	PS7230B	EPA 8082A
Aroclor 1268	ND		1	0.1	0.1	mg/Kg	4/8/2003	4/9/2003	PS7230B	EPA 8082A

Surrogate Surrogate Recovery Control Limits (%)
Decachlorobiphenyl 117.6 42 - 127

Order ID: 33974

Lab Sample ID: 33974-004

Client Sample ID: B2-B(2.0')

Sample Time: 8:50 AM

Sample Date: 4/8/2003

Matrix: Solid

Parameter	Result	Flag	DF	PQL	DLR	Units	Extraction Date	Analysis Date	QC Batch ID	Method
Aroclor 1016	ND		1	0.1	0.1	mg/Kg	4/8/2003	4/9/2003	PS7230B	EPA 8082A
Aroclor 1221	ND		1	0.1	0.1	mg/Kg	4/8/2003	4/9/2003	PS7230B	EPA 8082A
Aroclor 1232	ND		1	0.1	0.1	mg/Kg	4/8/2003	4/9/2003	PS7230B	EPA 8082A
Aroclor 1242	ND		1	0.1	0.1	mg/Kg	4/8/2003	4/9/2003	PS7230B	EPA 8082A
Aroclor 1248	ND		1	0.1	0.1	mg/Kg	4/8/2003	4/9/2003	PS7230B	EPA 8082A
Aroclor 1254	ND		1	0.1	0.1	mg/Kg	4/8/2003	4/9/2003	PS7230B	EPA 8082A
Aroclor 1260	ND		1	0.1	0.1	mg/Kg	4/8/2003	4/9/2003	PS7230B	EPA 8082A
Aroclor 1262	ND		1	0.1	0.1	mg/Kg	4/8/2003	4/9/2003	PS7230B	EPA 8082A
Aroclor 1268	ND		1	0.1	0.1	mg/Kg	4/8/2003	4/9/2003	PS7230B	EPA 8082A

Surrogate Surrogate Recovery Control Limits (%)
Decachlorobiphenyl 118.8 42 - 127

DF = Dilution Factor

ND = Not Detected

DLR = Detection Limit Reported

PQL = Practical Quantitation Limit

Analysis performed by Entech Analytical Labs, Inc. (CA ELAP #2346)

Patti Sandrock, QA/QC Manager

Environmental Analysis Since 1983

Entech Analytical Labs, Inc.

3334 Victor Court • Santa Clara, CA 95054 • (408) 588-0200 • Fax (408) 588-0201

Earth Systems Consultants
47853 Warm Springs Boulevard
Fremont, CA 94539-7400
Attn: Gary Pischke

Date: 4/10/03
Date Received: 4/8/2003
Project Name: Self Storage Bldg.
Project Number: FRS-4948-03
P.O. Number: FRS-4948-03
Sampled By: N.E.Berube

Certified Analytical Report

Order ID: 33974

Lab Sample ID: 33974-005

Client Sample ID: B3-A(1.5')

Sample Time: 9:00 AM

Sample Date: 4/8/2003

Matrix: Solid

Parameter	Result	Flag	DF	PQL	DLR	Units	Extraction Date	Analysis Date	QC Batch ID	Method
Aroclor 1016	ND		1	0.1	0.1	mg/Kg	4/8/2003	4/9/2003	PS7230B	EPA 8082A
Aroclor 1221	ND		1	0.1	0.1	mg/Kg	4/8/2003	4/9/2003	PS7230B	EPA 8082A
Aroclor 1232	ND		1	0.1	0.1	mg/Kg	4/8/2003	4/9/2003	PS7230B	EPA 8082A
Aroclor 1242	ND		1	0.1	0.1	mg/Kg	4/8/2003	4/9/2003	PS7230B	EPA 8082A
Aroclor 1248	ND		1	0.1	0.1	mg/Kg	4/8/2003	4/9/2003	PS7230B	EPA 8082A
Aroclor 1254	ND		1	0.1	0.1	mg/Kg	4/8/2003	4/9/2003	PS7230B	EPA 8082A
Aroclor 1260	ND		1	0.1	0.1	mg/Kg	4/8/2003	4/9/2003	PS7230B	EPA 8082A
Aroclor 1262	ND		1	0.1	0.1	mg/Kg	4/8/2003	4/9/2003	PS7230B	EPA 8082A
Aroclor 1268	ND		1	0.1	0.1	mg/Kg	4/8/2003	4/9/2003	PS7230B	EPA 8082A

Surrogate Surrogate Recovery Control Limits (%)
Decachlorobiphenyl 119.6 42 - 127

Order ID: 33974

Lab Sample ID: 33974-006

Client Sample ID: B3-B(2.0')

Sample Time: 9:10 AM

Sample Date: 4/8/2003

Matrix: Solid

Parameter	Result	Flag	DF	PQL	DLR	Units	Extraction Date	Analysis Date	QC Batch ID	Method
Aroclor 1016	ND		1	0.1	0.1	mg/Kg	4/8/2003	4/9/2003	PS7230B	EPA 8082A
Aroclor 1221	ND		1	0.1	0.1	mg/Kg	4/8/2003	4/9/2003	PS7230B	EPA 8082A
Aroclor 1232	ND		1	0.1	0.1	mg/Kg	4/8/2003	4/9/2003	PS7230B	EPA 8082A
Aroclor 1242	ND		1	0.1	0.1	mg/Kg	4/8/2003	4/9/2003	PS7230B	EPA 8082A
Aroclor 1248	ND		1	0.1	0.1	mg/Kg	4/8/2003	4/9/2003	PS7230B	EPA 8082A
Aroclor 1254	ND		1	0.1	0.1	mg/Kg	4/8/2003	4/9/2003	PS7230B	EPA 8082A
Aroclor 1260	ND		1	0.1	0.1	mg/Kg	4/8/2003	4/9/2003	PS7230B	EPA 8082A
Aroclor 1262	ND		1	0.1	0.1	mg/Kg	4/8/2003	4/9/2003	PS7230B	EPA 8082A
Aroclor 1268	ND		1	0.1	0.1	mg/Kg	4/8/2003	4/9/2003	PS7230B	EPA 8082A

Surrogate Surrogate Recovery Control Limits (%)
Decachlorobiphenyl 113.7 42 - 127

DF = Dilution Factor

ND = Not Detected

DLR = Detection Limit Reported

PQL = Practical Quantitation Limit

Analysis performed by Entech Analytical Labs, Inc. (CA ELAP #2346)

Patti Sandrock, QA/QC Manager

Environmental Analysis Since 1983

Entech Analytical Labs, Inc.

3334 Victor Court • Santa Clara, CA 95054 • (408) 588-0200 • Fax (408) 588-0201

Quality Control Results Summary

QC Batch #: PS7230B
Matrix: Solid

Units: mg/Kg
Date Analyzed: 4/8/2003

Parameter	Method	Blank Result	Spike Sample ID	Spike Amount	Sample Result	Spike Result	QC Type	% Recovery	RPD	RPD Limits	Recovery Limits
Test: EPA 8082A											
Aroclor 1260	EPA 8082A	ND		0.2		0.2363	LCS	118.1			71.0 - 135.0
	Surrogate Decachlorobiphenyl			Surrogate Recovery 123.6			Control Limits (%) 42 - 127				
Test: EPA 8082A											
Aroclor 1260	EPA 8082A	ND		0.2		0.2411	LCSD	120.6	2.01	30.00	71.0 - 135.0
	Surrogate Decachlorobiphenyl			Surrogate Recovery 122.6			Control Limits (%) 42 - 127				

Entech Analytical Labs, Inc.

3334 Victor Court • Santa Clara, CA 95054 • (408) 588-0200 • Fax (408) 588-0201

Quality Control Results Summary

QC Batch #: SM8300
Matrix: Solid

Units: mg/Kg
Date Analyzed: 4/9/2003

Parameter	Method	Blank Result	Spike Sample ID	Spike Amount	Sample Result	Spike Result	QC Type	% Recovery	RPD	RPD Limits	Recovery Limits
Arsenic	EPA 6010B	ND		50		50.66	LCS	101.3			61.4 - 115.2
Lead	EPA 6010B	ND		50		48.06	LCS	96.1			61.2 - 120.0
Arsenic	EPA 6010B	ND		50		50.13	LCSD	100.3	1.05	30.00	61.4 - 115.2
Lead	EPA 6010B	ND		50		47.13	LCSD	94.3	1.95	30.00	61.2 - 120.0

CHAIN OF CUSTODY RECORD

PROJECT NO.		PROJECT NAME					NO. OF CONTAINERS	SAMPLE TYPE	ANALYSES REQUESTED										COMMENTS/REMARKS			
SAMPLER (SIGN)		SAMPLER (PRINT)							PCB501g	As	Pb											
SAMPLE ID	DATE	TIME	COMP	GRAB	PRES. USED	ICED																
EPA (1.5')	4-8-03	0820				X	1		X	X	X										53974-001	48 hr
EPA (3.5')		0826					1		X	X	X											002
EPA (1.5')		0845					1		X	X	X											003
EPA (2.0')		0850					1		X	X	X											004
EPA (1.5')		0900					1		X	X	X											005
EPA (1.0')		0910					1		X	X	X											006
48 HR RUSH																						
Relinquished by: <i>N.E. Beube</i>		Date: 4-8-03	Time: 1200	Received by: <i>Gay Pische</i>			Date: 4/8/03	Time: 1200	Send Report To: <i>Gay Pische</i>													
Relinquished by: <i>Gay Pische</i>		Date: 4/8/03	Time: 1200	Received by: <i>CR Shaw</i>			Date: 4/8/03	Time: 1200														
Laboratory: <i>Entech</i>		Turnaround Time: <i>48 hour.</i>			Receipt Condition:																	



Earth Systems Consultants

Northern California

47853 Warm Springs Blvd.
Fremont, CA 94539-7400
(510) 353-0320 • Fax (510) 353-0344