



Atlantic Richfield Company
(a BP affiliated company)

P.O. Box 1257
San Ramon, California 94583
Phone: (925) 275-3801
Fax: (925) 275-3815

10 October 2008

Re: Third Quarter 2008 Status Report
Atlantic Richfield Company Service Station #2107
3310 Park Boulevard
Oakland, California
ACEH Case #RO0002526

RECEIVED

10:35 am, Oct 29, 2008

Alameda County
Environmental Health



"I declare, that to the best of my knowledge at the present time, that the information and/or recommendations contained in the attached document are true and correct."

Submitted by:

Paul Supple
Environmental Business Manager

10 October 2008

Project No. 06-08-614

Atlantic Richfield Company
P.O. Box 1257
San Ramon, California 94583
Submitted via ENFOS

Attn.: Mr. Paul Supple

Re: Third Quarter 2008 Status Report, Atlantic Richfield Company (a BP affiliated company)
Station #2107, 3310 Park Boulevard, Oakland, California; ACEH Case #RO0002526

Dear Mr. Supple:

Provided herein is the *Third Quarter 2008 Status Report* for Atlantic Richfield Company Station #2107 located at 3310 Park Boulevard, Oakland, Alameda County, California. This report presents a summary of current developments at the Site through the Third Quarter 2008.

Should you have questions regarding this submission, please do not hesitate to contact us at (530) 566-1400.

Sincerely,

BROADBENT & ASSOCIATES, INC.



Thomas A. Venus, P.E.
Senior Engineer



Robert H. Miller, P.G., C.HG.
Principal Hydrogeologist

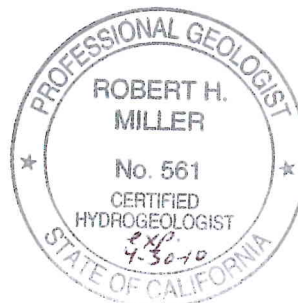

Enclosure

cc: Mr. Paresh Khatri, Alameda County Environmental Health (Submitted via ACEH ftp site)
Electronic copy uploaded to GeoTracker

STATION #2107 QUARTERLY GROUND-WATER STATUS REPORT

Facility: #2107	Address:	3310 Park Boulevard, Oakland, California
Environmental Business Manager:		Mr. Paul Supple
Consulting Company/Contact Person:		Broadbent & Associates, Inc.(BAI)/Rob Miller & Tom Venus (530) 566-1400
Consultant Project No.:		06-08-614
Primary Agency/Regulatory ID No.:		Alameda County Environmental Health (ACEH) ACEH Case # RO0002526

WORK PERFORMED THIS QUARTER (Third Quarter 2008):

1. Prepared and submitted the Second Quarter 2008 Status Report.
2. Prepared and submitted the Work Plan for Ground-Water Investigation (BAI, 9/2/2008).
3. No environmental field work was conducted at the Site during the Third Quarter of 2008.

WORK PROPOSED FOR NEXT QUARTER (Fourth Quarter 2008):

1. Prepared and submitted this Third Quarter 2008 Status Report (contained herein).
2. Work with the City of Oakland on an encroachment permit to facilitate installation of off-site wells proposed in the Work Plan for Ground-Water Investigation. Once permit is issued, field activities associated with the investigation will be completed.

DISCUSSION:

On 2 September 2008, BP submitted a Work Plan for Ground-Water Investigation in accordance with a directive request from ACEH dated 7 July 2008. Mr. Paresh Khatri of ACEH approved the aforementioned work plan in a response letter dated 17 September 2008. A site map displaying the proposed drilling/monitoring well locations from the approved work plan is provided as Drawing 1.

Communication with the City of Oakland on approval of a permit for installation of proposed off-site wells within the sidewalk to the north and across Park Boulevard has been initiated. The City of Oakland indicated a formal permit application would be considered; however, that it may take up to eight weeks to review the application. Accordingly, deadlines originally specified in the ACEH 17 September 2008 letter are not achievable. Because of uncertainty in timing for installation of off-site wells, BAI requested in an email dated 13 October 2008 that project deadlines not be specified at this time. The ACEH approved this request in their 14 October 2008 email. Per ACEH's request, all correspondence with the City of Oakland regarding off-site access will be copied to the ACEH.

ATTACHMENTS:

Drawing 1 Site Map with Proposed Monitoring Well Locations, Station #2107, 3310 Park Boulevard, Oakland, California

Oakland High School

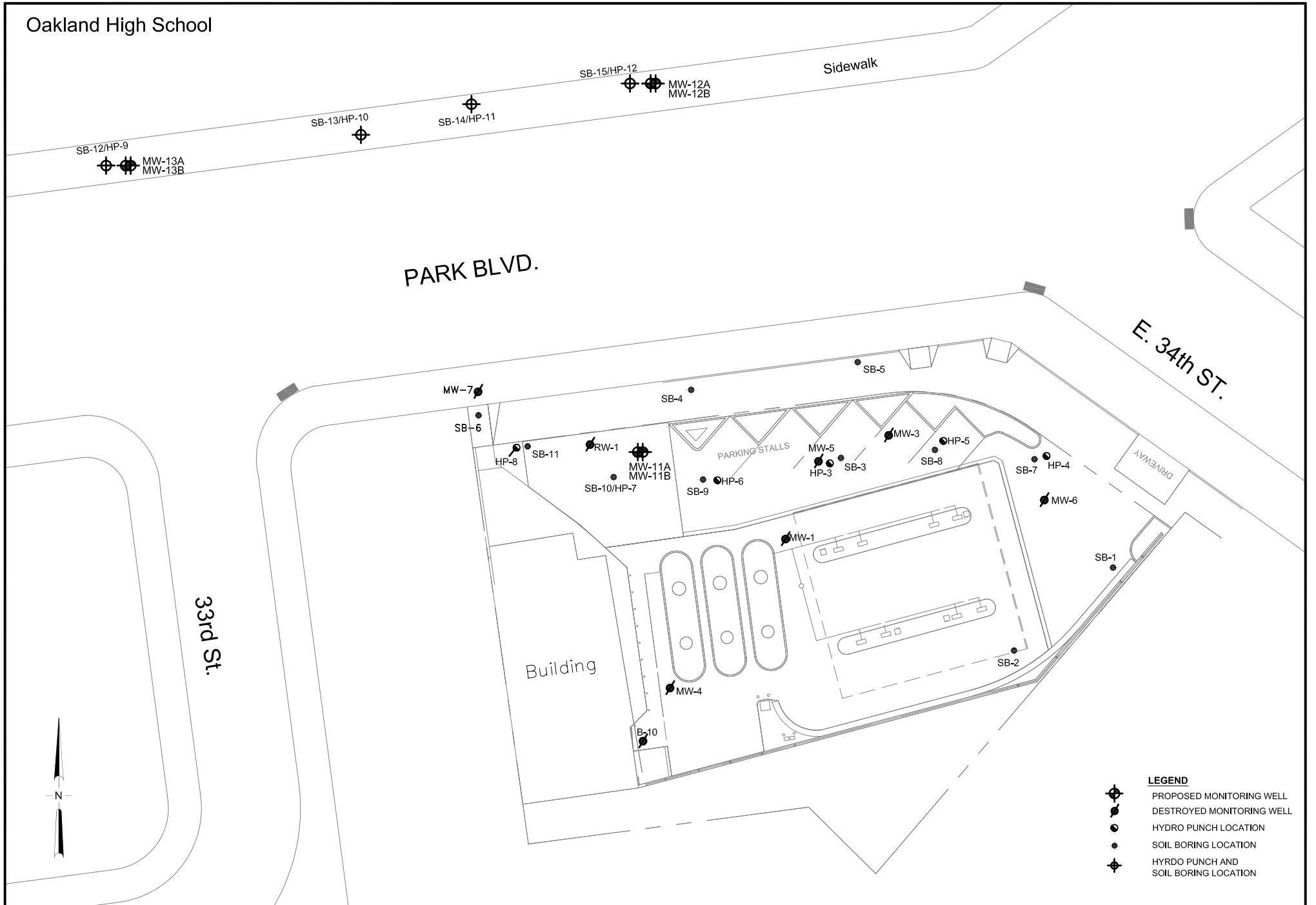

- LEGEND**
- PROPOSED MONITORING WELL
 - DESTROYED MONITORING WELL
 - HYDRO PUNCH LOCATION
 - SOIL BORING LOCATION
 - HYDRO PUNCH AND SOIL BORING LOCATION

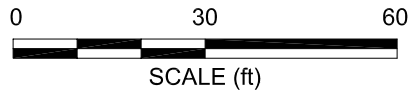

BROADBENT & ASSOCIATES, INC.
 ENGINEERING, WATER RESOURCES & ENVIRONMENTAL
 1324 Mangrove Ave. Suite 212, Chico, California
 Project No.: 06-08-614 Date: 8/25/08

Station #2107
 3310 Park Boulevard
 Oakland, California

Site Map with Proposed
 Monitoring Well Locations

Drawing
1