



ENVIRONMENTAL  
MANAGEMENT, INC.

...COMBINING OUR  
RESOURCES TO  
ENHANCE OUR  
SERVICES...



**Delta**  
Environmental  
Consultants, Inc.

May 15, 2003  
Project No. C85-6750 Santa Rita

Mr. Scott O. Seery  
Alameda County Health Care Services Agency  
Environmental Health Services  
1131 Harbor Bay Parkway, Suite 250  
Alameda, CA 94502-6577

Alameda County  
MAY 15 2003  
Environmental Health

Re: **Quarterly Monitoring and Sampling Report**  
**First Quarter 2003**  
**Shell Service Station**  
**6750 Santa Rita Road**  
**Pleasanton, California**  
**Incident No. 97464711**

Dear Mr. Seery:

KHM Environmental Management, Inc. (KHM), on behalf of Shell Oil Products US (Shell), has prepared the following first quarter 2003 groundwater monitoring and sampling report for the above referenced site. Groundwater sampling was performed by Blaine Tech Services (Blaine), at the direction of KHM, on March 28, 2003. A site location map is included as Figure 1.

### **QUARTERLY GROUND WATER MONITORING PROGRAM**

Groundwater monitoring wells were gauged and sampled by Blaine on March 28, 2003. Depth to groundwater was measured in Wells MW-1 through MW-4. Groundwater elevation data and contours are presented on Figure 2.

Groundwater samples were submitted by Blaine to Severn Trent Laboratories, Inc. (STL-San Francisco) in Pleasanton, California for analysis for total purgeable petroleum hydrocarbons as gasoline (TPH-g); benzene, toluene, ethylbenzene, and total xylenes (BTEX); and methyl tert-butyl ether (MTBE) using EPA Method 8260B and total purgeable petroleum hydrocarbons as diesel (TPH-d) by EPA Method 8015. Benzene and MTBE concentrations are presented on Figure 3.

May 15, 2003

Page 2

Blaine's groundwater monitoring and sampling report, which includes historical and current groundwater elevation data, historical and current analytical results, and field data records for the current monitoring event, is included as Attachment A.

## REMEDIATION SUMMARY

KHM/Shell will initiate groundwater batch extraction in the second quarter 2003. This remedial action is taken to address the presence of MTBE in groundwater along the downgradient boundary of the site while the soil and water investigation (SWI) proceeds. Batch extraction will be initiated at wells MW-2 and MW-3. Groundwater will be removed through the use of a vacuum truck. The purged groundwater will be transported to the Shell refinery in Martinez, California for recycling.

## DISCUSSION

Previous site data has indicated a groundwater flow direction to the south-southwest. The groundwater gradient on March 28, 2003 was toward the south-southwest at a magnitude of 0.01 feet/feet.

In the second quarter 2003 Blaine will gauge and sample selected site wells and tabulate the data. KHM will prepare a second quarter 2003 monitoring, sampling and remediation status report. Shell will begin immediate site groundwater remediation by instituting batch extraction beginning in May 2003.

A work plan for additional SWI was is being submitted May 23, 2003 and will be carried out upon Alameda County Health Care Services Agency (ACHCSA) approval.

Please call if you have any questions regarding the contents of this report.

Sincerely,

**KHM Environmental Management, Inc.**



Garrett Haertel  
Staff Engineer



R. Lee Dooley  
Senior Hydrogeologist  
CHG 0183

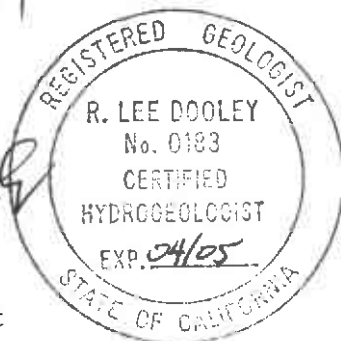

May 15, 2003  
Page 3

Attachments: Figure 1 – Site Location Map  
Figure 2 – Groundwater Elevation Contour Map  
Figure 3 – Benzene and MTBE Concentration Map

Attachment A – Groundwater Monitoring and Sampling Report, May 2,  
2003

cc: Ms. Karen Petryna, P.E., Shell Oil Products US, P.O. Box 7869, Burbank, CA 91501-7869

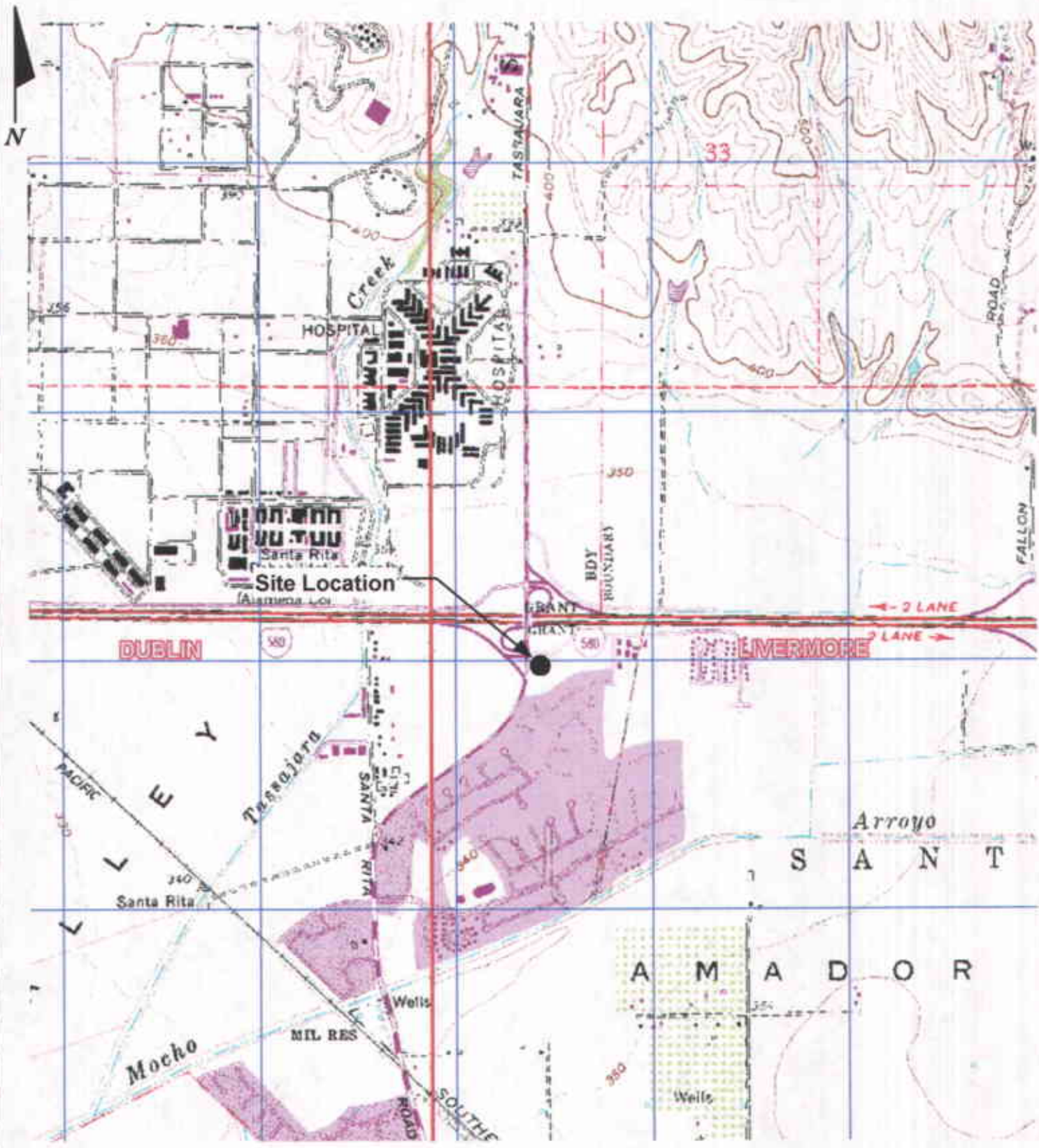

Map Source: DeLorme, Yarmouth, ME 04096, USGA Topo Map

**KHM**  
 ENVIRONMENTAL  
 MANAGEMENT,  
 INC.

**SITE LOCATION MAP**

**Shell Service Station**  
 6750 Santa Rita Road  
 Pleasanton, California

DATE	5/15/03	PROJECT	C85-6750 Santa Rita	FIGURE	1
------	---------	---------	---------------------	--------	---

Pimlico Drive

Concrete Block Retaining Wall



N

Wooden Step (typ)

Trees and Shrubs (typ)

Santa Rita Road

Nearest LUFT 2,100 feet East BayBMW

Entrance to Shopping Center

Planter

Dispenser (typ)

Grass

Canopy

MW-1 (311.89)

Store

Restrooms

MW-4 (311.37)

Nearest Water Supply Well 2,500 feet Zone 7 Water Agency Stoneridge Well 01

Air/Water Dispenser

USTs

Vacuum

MW-2 (311.56)

Trash Compound

Entrance to Shopping Center

Storage

Carwash



**LEGEND**

MW-4 ● GROUNDWATER MONITORING WELL

(311.89) GROUNDWATER ELEVATION (FEET - MSL), 3/28/03

311.50 — GROUNDWATER ELEVATION CONTOUR

0.01 ft/ft APPROXIMATE GROUNDWATER FLOW DIRECTION AND GRADIENT

**GROUNDWATER ELEVATION CONTOUR MAP, MARCH 28, 2003**

**Shell-branded Service Station**  
6750 Santa Rita Road  
Pleasanton, California

**KHM**  
ENVIRONMENTAL  
MANAGEMENT,  
INC.

DATE 5/15/03

PROJECT C85-6750 Santa Rita

FIGURE 2

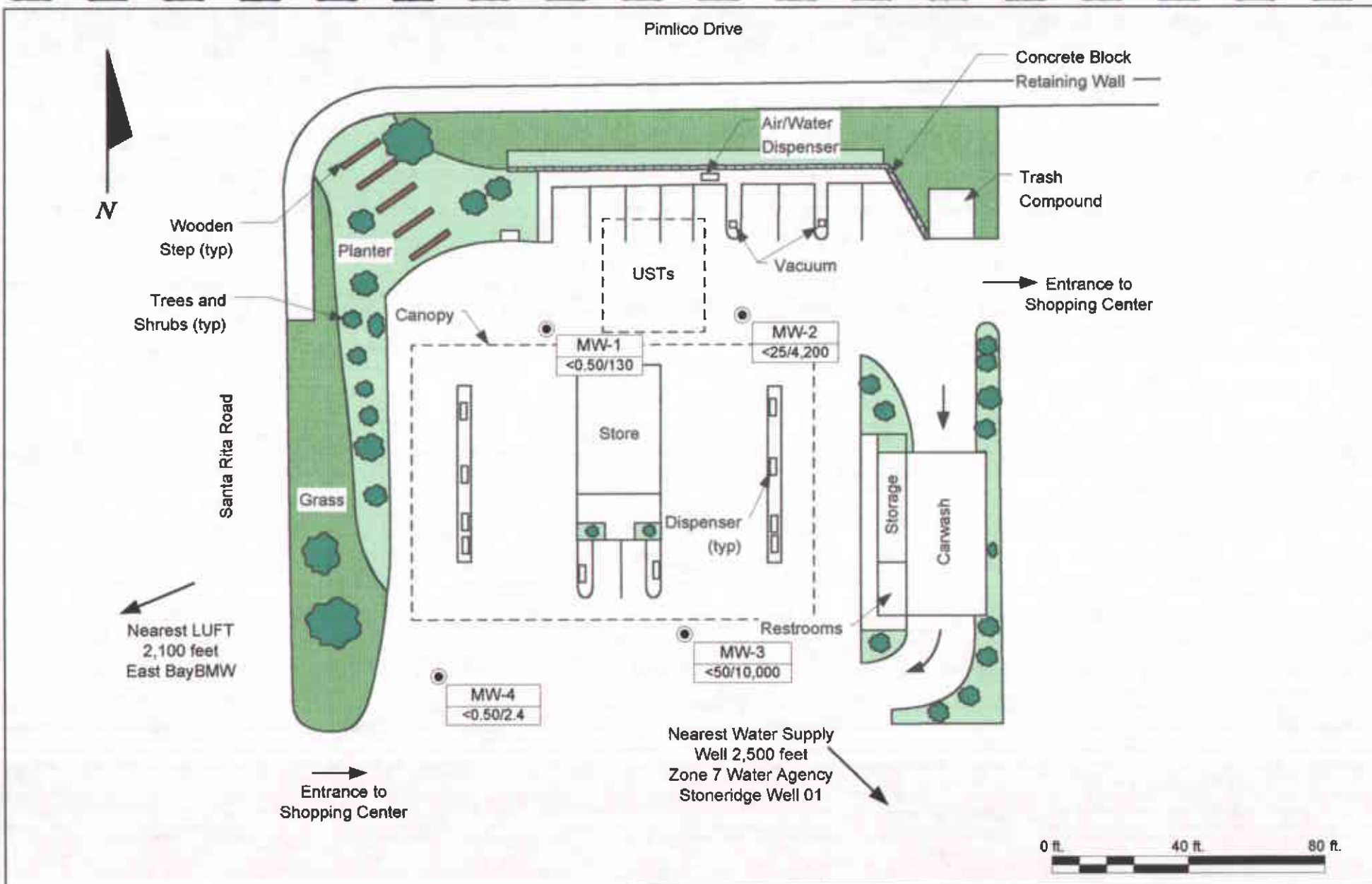

**LEGEND**

MW-4 ● GROUNDWATER MONITORING WELL

MW-4	WELL ID
83 / 2.4	BENZENE/MTBE CONCENTRATIONS (UG/L), 3/28/03

**KHM**  
ENVIRONMENTAL  
MANAGEMENT,  
INC.

**BENZENE AND MTBE CONCENTRATIONS  
MAP, MARCH 28, 2003**

**Shell-branded Service Station**  
6750 Santa Rita Road  
Pleasanton, California

DATE 5/15/03

PROJECT C85-6750 Santa Rita

FIGURE 3

**ATTACHMENT A**

---

**GROUNDWATER MONITORING AND SAMPLING REPORT**

**BLAINE**  
TECH SERVICES, INC.



1680 ROGERS AVENUE  
SAN JOSE, CA 95112-1105  
(408) 573-7771 FAX  
(408) 573-0555 PHONE  
CONTRACTOR'S LICENSE #746684  
www.blainetech.com

May 2, 2003

Karen Petryna  
Shell Oil Products US  
P.O. Box 7869  
Burbank, CA 91510-7869

First Quarter 2003 Groundwater Monitoring at  
Shell-branded Service Station  
6750 Santa Rita Road  
Pleasanton, CA

Monitoring performed on March 28, 2003

---

Groundwater Monitoring Report **030328-BA-2**

This report covers the routine monitoring of groundwater wells at this Shell-branded facility. In accordance with standard procedures that conform to Regional Water Quality Control Board requirements, routine field data collection includes depth to water, total well depth, thickness of any separate immiscible layer, water column volume, calculated purge volume (if applicable), elapsed evacuation time (if applicable), total volume of water removed (if applicable), and standard water parameter instrument readings. Sample material is collected, contained, stored, and transported to the laboratory in conformance with EPA standards. Purgewater (if applicable) is, likewise, collected and transported to the Martinez Refining Company.

Basic field information is presented alongside analytical values excerpted from the laboratory report in the cumulative table of **WELL CONCENTRATIONS**. The full analytical report for the most recent samples and the field data sheets are attached to this report.

At a minimum, Blaine Tech Services, Inc. field personnel are certified on completion of a forty-hour Hazardous Materials and Emergency Response training course per 29 CFR 1910.120. Field personnel are also enrolled in annual eight-hour refresher courses.



Blaine Tech Services, Inc. conducts sampling and documentation assignments of this type as an independent third party. Our activities at this site consisted of objective data and sample collection only. No interpretation of analytical results, defining of hydrological conditions or formulation of recommendations was performed.

Please call if you have any questions.

Yours truly,

Leon Gearhart  
Project Coordinator

LG/jt

attachments: Cumulative Table of WELL CONCENTRATIONS  
Certified Analytical Report  
Field Data Sheets

cc: Debbie Arnold  
KHM Environmental  
6234 San Ignacio Avenue, Suite E  
San Jose, CA 95119

**WELL CONCENTRATIONS**  
**Shell-branded Service Station**  
**6750 Santa Rita Road**  
**Pleasanton, CA**

Well ID	Date	TPPH (ug/L)	TEPH (ug/L)	B (ug/L)	T (ug/L)	E (ug/L)	X (ug/L)	MTBE 8260 (ug/L)	TOC (MSL)	Depth to Water (ft.)	GW Elevation (MSL)
MW-1	12/04/2002	NA	NA	NA	NA	NA	NA	NA	NA	31.75	NA
MW-1	12/22/2002	<50	81	<0.50	<0.50	<0.50	<0.50	62	NA	31.93	NA
MW-1	03/28/2003	<50	70	<0.50	<0.50	<0.50	<1.0	130	343.48	31.59	311.89
MW-2	12/04/2002	NA	NA	NA	NA	NA	NA	NA	NA	31.25	NA
MW-2	12/22/2002	<200	120	<2.0	<2.0	<2.0	<2.0	660	NA	30.70	NA
MW-2	03/28/2003	<2,500	60	<25	<25	<25	<50	4,200	342.86	30.30	312.56
MW-3	12/04/2002	NA	NA	NA	NA	NA	NA	NA	NA	31.65	NA
MW-3	12/22/2002	<2,000	72	<20	<20	<20	<20	8,000	NA	31.10	NA
MW-3	03/28/2003	<5,000	89	<50	<50	<50	<100	10,000	342.23	30.76	311.47
MW-4	12/04/2002	NA	NA	NA	NA	NA	NA	NA	NA	32.92	NA
MW-4	12/22/2002	<50	<50	<0.50	<0.50	<0.50	<0.50	93	NA	32.20	NA
MW-4	03/28/2003	<50	67	<0.50	<0.50	<0.50	<1.0	2.4	343.44	32.07	311.37

**WELL CONCENTRATIONS**  
**Shell-branded Service Station**  
**6750 Santa Rita Road**  
**Pleasanton, CA**

Well ID	Date	TPPH (ug/L)	TEPH (ug/L)	B (ug/L)	T (ug/L)	E (ug/L)	X (ug/L)	MTBE 8260 (ug/L)	TOC (MSL)	Depth to Water (ft.)	GW Elevation (MSL)
---------	------	----------------	----------------	-------------	-------------	-------------	-------------	------------------------	--------------	----------------------------	--------------------------

Abbreviations:

TPPH = Total petroleum hydrocarbons as gasoline by EPA Method 8260B.

TEPH = Total petroleum hydrocarbons as diesel by modified EPA Method 8015.

BTEX = Benzene, toluene, ethylbenzene, xylenes by EPA Method 8260B.

MTBE = Methyl-tertiary-butyl ether

TOC = Top of Casing Elevation

GW = Groundwater

ug/L = Parts per billion

MSL = Mean sea level

ft = Feet

<n = Below detection limit

NA = Not applicable

Notes:

Site surveyed November 22, 2002, by Mid Coast Engineers.

**Blaine Tech Services, Inc.**

April 13, 2003

1680 Rogers Avenue  
San Jose, CA 95112-1105  
Attn.: Leon Gearhart  
Project#: 03028-BA2  
Project: 97402156  
Site: 6750 Santa Rita Rd.  
Pleasanton, CA

Dear Mr. Gearhart,

Attached is our report for your samples received on 03/28/2003 15:29  
This report has been reviewed and approved for release. Reproduction of this report  
is permitted only in its entirety.

Please note that any unused portion of the samples will be discarded after  
05/12/2003 unless you have requested otherwise.

We appreciate the opportunity to be of service to you. If you have any questions,  
please call me at (925) 484-1919.

You can also contact me via email. My email address is: [tgranicher@stl-inc.com](mailto:tgranicher@stl-inc.com)

Sincerely,



Tod Granicher  
Project Manager

**Diesel (C10-C24) by 8015m**

Blaine Tech Services, Inc.

Attn.: Leon Gearhart

1680 Rogers Avenue

San Jose, CA 95112-1105

Phone: (408) 573-0555 Fax: (408) 573-7771

Project: 03028-BA2

97402156

Received: 03/28/2003 15:29

Site: 6750 Santa Rita Rd.

Pleasanton, CA

**Samples Reported**

Sample Name	Date Sampled	Matrix	Lab #
MW-1	03/28/2003 10:03	Water	1
MW-2	03/28/2003 10:16	Water	2
MW-3	03/28/2003 10:29	Water	3
MW-4	03/28/2003 09:49	Water	4

Severn Trent Laboratories, Inc.

STL San Francisco \* 1220 Quarry Lane, Pleasanton, CA 94566

Tel 925 484 1919 Fax 925 484 1096 \* www.stl-inc.com \* CA DHS ELAP# 2496

04/07/2003 15:10

**Diesel (C10-C24) by 8015m**

Blaine Tech Services, Inc.

Attn.: Leon Gearhart

1680 Rogers Avenue

San Jose, CA 95112-1105

Phone: (408) 573-0555 Fax: (408) 573-7771

Project: 03028-BA2

97402156

Received: 03/28/2003 15:29

Site: 6750 Santa Rita Rd.

Pleasanton, CA

Prep(s):	3510/8015M	Test(s):	8015M
Sample ID:	MW-1	Lab ID:	2003-03-0679 - 1
Sampled:	03/28/2003 10:03	Extracted:	4/3/2003 07:53
Matrix:	Water	QC Batch#:	2003/04/03-02.10

Compound	Conc.	RL	Unit	Dilution	Analyzed	Flag
Diesel	70	50	ug/L	1.00	04/04/2003 08:30	ndp
<i>Surrogates(s)</i>						
o-Terphenyl	85.5	60-130	%	1.00	04/04/2003 08:30	

Severn Trent Laboratories, Inc.

STL San Francisco \* 1220 Quarry Lane, Pleasanton, CA 94566

Tel 925 484 1919 Fax 925 484 1096 \* www.stl-inc.com \* CA DHS ELAP# 2496

04/07/2003 15:10

**Diesel (C10-C24) by 8015m**

Blaine Tech Services, Inc.

Attn.: Leon Gearhart

1680 Rogers Avenue  
San Jose, CA 95112-1105  
Phone: (408) 573-0555 Fax: (408) 573-7771

Project: 03028-BA2  
97402156

Received: 03/28/2003 15:29

Site: 6750 Santa Rita Rd.  
Pleasanton, CA

Prep(s):	3510/8015M	Test(s):	8015M
Sample ID:	MW-2	Lab ID:	2003-03-0679-2
Sampled:	03/28/2003 10:16	Extracted:	4/3/2003 07:53
Matrix:	Water	QC Batch#:	2003/04/03-02-10

Compound	Conc.	RL	Unit	Dilution	Analyzed	Flag
Diesel	60	50	ug/L	1.00	04/04/2003 07:52	ndp
<i>Surrogates(s)</i>						
o-Terphenyl	80.6	60-130	%	1.00	04/04/2003 07:52	

**Diesel (C10-C24) by 8015m**

Blaine Tech Services, Inc.

Attn.: Leon Gearhart

1680 Rogers Avenue

San Jose, CA 95112-1105

Phone: (408) 573-0555 Fax: (408) 573-7771

Project: 03028-BA2

97402156

Received: 03/28/2003 15:29

Site: 6750 Santa Rita Rd.

Pleasanton, CA

Prep(s): 3510/8015M	Test(s): 8015M
Sample ID: MW-3	Lab ID: 2003-03-0679 - 3
Sampled: 03/28/2003 10:29	Extracted: 4/3/2003 07:53
Matrix: Water	QC Batch#: 2003/04/03-02.10

Compound	Conc.	RL	Unit	Dilution	Analyzed	Flag
Diesel	89	50	ug/L	1.00	04/04/2003 07:15	ndp
<b>Surrogates(s)</b>						
o-Terphenyl	82.5	60-130	%	1.00	04/04/2003 07:15	

Severn Trent Laboratories, Inc.

STL San Francisco \* 1220 Quarry Lane, Pleasanton, CA 94566

Tel 925 484 1919 Fax 925 484 1096 \* www.stl-inc.com \* CA DHS ELAP# 2496

04/07/2003 15:10



**Diesel (C10-C24) by 8015m**

Blaine Tech Services, Inc.

Attn.: Leon Gearhart

1680 Rogers Avenue

San Jose, CA 95112-1105

Phone: (408) 573-0555 Fax: (408) 573-7771

Project: 03028-BA2

97402156

Received: 03/28/2003 15:29

Site: 6750 Santa Rita Rd.

Pleasanton, CA

Prep(s):	3510/8015M	Test(s):	8015M
Sample ID:	MW-4	Lab ID:	2003-03-0679 - 4
Sampled:	03/28/2003 09:49	Extracted:	4/3/2003 07:53
Matrix:	Water	QC Batch#:	2003/04/03-02.10

Compound	Conc.	RL	Unit	Dilution	Analyzed	Flag
Diesel	67	50	ug/L	1.00	04/04/2003 06:38	ndp
<b>Surrogates(s)</b>						
o-Terphenyl	89.2	60-130	%	1.00	04/04/2003 06:38	

Sewern Trent Laboratories, Inc.

STL San Francisco \* 1220 Quarry Lane, Pleasanton, CA 94566

Tel 925 484 1919 Fax 925 484 1096 \* www.stl-inc.com \* CA DHS ELAP# 2496

04/07/2003 15:10

**Diesel (C10-C24) by 8015m**

Blaine Tech Services, Inc.

Attn.: Leon Gearhart

1680 Rogers Avenue  
San Jose, CA 95112-1105  
Phone: (408) 573-0555 Fax: (408) 573-7771

Project: 03028-BA2  
97402156

Received: 03/28/2003 15:29

Site: 6750 Santa Rita Rd.  
Pleasanton, CA

Batch QC Report					
Prep(s): 3510/8015M				Test(s): 8015M	
Method Blank		Water		QC Batch # 2003/04/03-02.10	
MB: 2003/04/03-02.10-001				Date Extracted: 04/03/2003 07:53	

Compound	Conc.	RL	Unit	Analyzed	Flag
Diesel	ND	50	ug/L	04/03/2003 11:58	
<b>Surrogates(s)</b> o-Terphenyl	93.1	60-130	%	04/03/2003 11:58	

**Diesel (C10-C24) by 8015m**

Blaine Tech Services, Inc.

Attn.: Leon Gearhart

1680 Rogers Avenue

San Jose, CA 95112-1105

Phone: (408) 573-0555 Fax: (408) 573-7771

Project: 03028-BA2

97402156

Received: 03/28/2003 15:29

Site: 6750 Santa Rita Rd.

Pleasanton, CA

Batch QC Report										
Prep(s): 3510/8015M					Test(s): 8015M					
Laboratory Control Spike			Water			QC Batch # 2003/04/03-02-10				
LCS	2003/04/03-02-10-002		Extracted: 04/03/2003			Analyzed: 04/03/2003 13:12				
LCSD	2003/04/03-02-10-003		Extracted: 04/03/2003			Analyzed: 04/03/2003 13:48				
Compound	Conc. ug/L		Exp.Conc.	Recovery		RPD	Ctrl.Limits %		Flags	
	LCS	LCSD		LCS	LCSD		%	Rec.	RPD	LCS
Diesel	948	947	1000	94.8	94.7	0.1	60-130	25		
<i>Surrogates(s)</i> o-Terphenyl	18.9	18.5	20.0	94.4	92.4		60-130	0		

Severn Trent Laboratories, Inc.

STL San Francisco \* 1220 Quarry Lane, Pleasanton, CA 94566

Tel 925 484 1919 Fax 925 484 1096 \* www.stl-inc.com \* CA DHS ELAP# 2496

04/07/2003 15:10

Diesel (C10-C24) by 8015m

Blaine Tech Services, Inc.

Attn.: Leon Gearhart

1680 Rogers Avenue

San Jose, CA 95112-1105

Phone: (408) 573-0555 Fax: (408) 573-7771

Project: 03028-BA2

97402156

Received: 03/28/2003 15:29

Site: 6750 Santa Rita Rd.

Pleasanton, CA

Legend and Notes

Result Flag

ndp

Hydrocarbon reported does not match the pattern of our Diesel standard

Severn Trent Laboratories, Inc.

STL San Francisco \* 1220 Quarry Lane, Pleasanton, CA 94566

Tel 925 484 1919 Fax 925 484 1096 \* www.stl-inc.com \* CA DHS ELAP# 2496

Gas/BTEX Fuel Oxygenates by 8260B

Blaine Tech Services, Inc.

Attn.: Leon Gearhart

1680 Rogers Avenue  
San Jose, CA 95112-1105  
Phone: (408) 573-0555 Fax: (408) 573-7771

Project: 03028-BA2  
97402156

Received: 03/28/2003 15:29

Site: 6750 Santa Rita Rd.  
Pleasanton, CA

Samples Reported

Sample Name	Date Sampled	Matrix	Lab #
MW-1	03/28/2003 10:03	Water	1
MW-2	03/28/2003 10:16	Water	2
MW-3	03/28/2003 10:29	Water	3
MW-4	03/28/2003 09:49	Water	4

Severn Trent Laboratories, Inc.

STL San Francisco \* 1220 Quarry Lane, Pleasanton, CA 94566

Tel 925 484 1919 Fax 925 484 1096 \* www.stl-inc.com \* CA DHS ELAP# 2496

04/30/2003 15:40

**Gas/BTEX Fuel Oxygenates by 8260B**

Blaine Tech Services, Inc.

Attn.: Leon Gearhart

1680 Rogers Avenue  
San Jose, CA 95112-1105  
Phone: (408) 573-0555 Fax: (408) 573-7771

Project: 03028-BA2  
97402156

Received: 03/28/2003 15:29

Site: 6750 Santa Rita Rd.  
Pleasanton, CA

Prep(s):	5030B	Test(s):	8260FAB
Sample ID:	MW-1	Lab ID:	2003-03-0679 - 1
Sampled:	03/28/2003 10:03	Extracted:	4/9/2003 18:39
Matrix:	Water	QC Batch#:	2003/04/09-V1.62

Compound	Conc.	RL	Unit	Dilution	Analyzed	Flag
Gasoline	ND	50	ug/L	1.00	04/09/2003 18:39	
Benzene	ND	0.50	ug/L	1.00	04/09/2003 18:39	
Toluene	ND	0.50	ug/L	1.00	04/09/2003 18:39	
Ethylbenzene	ND	0.50	ug/L	1.00	04/09/2003 18:39	
Total xylenes	ND	1.0	ug/L	1.00	04/09/2003 18:39	
tert-Butyl alcohol (TBA)	43	5.0	ug/L	1.00	04/09/2003 18:39	
Methyl tert-butyl ether (MTBE)	130	0.50	ug/L	1.00	04/09/2003 18:39	
Di-isopropyl Ether (DIPE)	ND	2.0	ug/L	1.00	04/09/2003 18:39	
Ethyl tert-butyl ether (ETBE)	ND	2.0	ug/L	1.00	04/09/2003 18:39	
tert-Amyl methyl ether (TAME)	ND	2.0	ug/L	1.00	04/09/2003 18:39	
<b>Surrogates(s)</b>						
1,2-Dichloroethane-d4	102.7	76-114	%	1.00	04/09/2003 18:39	
Toluene-d8	93.8	88-110	%	1.00	04/09/2003 18:39	

Severn Trent Laboratories, Inc.

STL San Francisco \* 1220 Quarry Lane, Pleasanton, CA 94566

Tel 925 484 1919 Fax 925 484 1096 \* www.stl-inc.com \* CA DHS ELAP# 2496

04/30/2003 15:40

**Gas/BTEX Fuel Oxygenates by 8260B**

Blaine Tech Services, Inc.

Attn.: Leon Gearhart

1680 Rogers Avenue  
San Jose, CA 95112-1105  
Phone: (408) 573-0555 Fax: (408) 573-7771

Project: 03028-BA2  
97402156

Received: 03/28/2003 15:29

Site: 6750 Santa Rita Rd.  
Pleasanton, CA

Prep(s):	5030B	Test(s):	8260FAB
Sample ID:	MW-2	Lab ID:	2003-03-0679 - 2
Sampled:	03/28/2003 10:16	Extracted:	4/10/2003 14:14
Matrix:	Water	QC Batch#:	2003/04/10-1A.62
Analysis Flag: 0 ( See Legend and Note Section )			

Compound	Conc.	RL	Unit	Dilution	Analyzed	Flag
Gasoline	ND	2500	ug/L	50.00	04/10/2003 14:14	
Benzene	ND	25	ug/L	50.00	04/10/2003 14:14	
Toluene	ND	25	ug/L	50.00	04/10/2003 14:14	
Ethylbenzene	ND	25	ug/L	50.00	04/10/2003 14:14	
Total xylenes	ND	50	ug/L	50.00	04/10/2003 14:14	
tert-Butyl alcohol (TBA)	2500	250	ug/L	50.00	04/10/2003 14:14	
Methyl tert-butyl ether (MTBE)	4200	25	ug/L	50.00	04/10/2003 14:14	
Di-isopropyl Ether (DIPE)	ND	100	ug/L	50.00	04/10/2003 14:14	
Ethyl tert-butyl ether (ETBE)	ND	100	ug/L	50.00	04/10/2003 14:14	
tert-Amyl methyl ether (TAME)	ND	100	ug/L	50.00	04/10/2003 14:14	
<b>Surrogates(s)</b>						
1,2-Dichloroethane-d4	102.2	76-114	%	50.00	04/10/2003 14:14	
Toluene-d8	101.6	88-110	%	50.00	04/10/2003 14:14	

Severn Trent Laboratories, Inc.

STL San Francisco \* 1220 Quarry Lane, Pleasanton, CA 94566

Tel 925 484 1919 Fax 925 484 1096 \* www.stl-inc.com \* CA DHS ELAP# 2496

04/30/2003 15:40

**Gas/BTEX Fuel Oxygenates by 8260B**

Blaine Tech Services, Inc.

Attn.: Leon Gearhart

1680 Rogers Avenue

San Jose, CA 95112-1105

Phone: (408) 573-0555 Fax: (408) 573-7771

Project: 03028-BA2

97402156

Received: 03/28/2003 15:29

Site: 6750 Santa Rita Rd.  
Pleasanton, CA

Prep(s):	5030B	Test(s):	8260FAB
Sample ID:	MW-3	Lab ID:	2003-03-0679 - 3
Sampled:	03/28/2003 10:29	Extracted:	4/10/2003 15:20
Matrix:	Water	QC Batch#:	2003/04/10-1A.62
Analysis Flag: 0 ( See Legend and Note Section )			

Compound	Conc.	RL	Unit	Dilution	Analyzed	Flag
Gasoline	ND	5000	ug/L	100.00	04/10/2003 15:20	
Benzene	ND	50	ug/L	100.00	04/10/2003 15:20	
Toluene	ND	50	ug/L	100.00	04/10/2003 15:20	
Ethylbenzene	ND	50	ug/L	100.00	04/10/2003 15:20	
Total xylenes	ND	100	ug/L	100.00	04/10/2003 15:20	
tert-Butyl alcohol (TBA)	6100	500	ug/L	100.00	04/10/2003 15:20	
Methyl tert-butyl ether (MTBE)	10000	50	ug/L	100.00	04/10/2003 15:20	
Di-isopropyl Ether (DIPE)	ND	200	ug/L	100.00	04/10/2003 15:20	
Ethyl tert-butyl ether (ETBE)	ND	200	ug/L	100.00	04/10/2003 15:20	
tert-Amyl methyl ether (TAME)	ND	200	ug/L	100.00	04/10/2003 15:20	
<b>Surrogates(s)</b>						
1,2-Dichloroethane-d4	101.7	76-114	%	100.00	04/10/2003 15:20	
Toluene-d8	95.2	88-110	%	100.00	04/10/2003 15:20	

Severn Trent Laboratories, Inc.

STL San Francisco \* 1220 Quarry Lane, Pleasanton, CA 94566

Tel 925 484 1919 Fax 925 484 1096 \* www.stl-inc.com \* CA DHS ELAP# 2496

04/30/2003 15:40



**Gas/BTEX Fuel Oxygenates by 8260B**

Blaine Tech Services, Inc.

Attn.: Leon Gearhart

1680 Rogers Avenue  
San Jose, CA 95112-1105  
Phone: (408) 573-0555 Fax: (408) 573-7771

Project: 03028-BA2  
97402156

Received: 03/28/2003 15:29

Site: 6750 Santa Rita Rd.  
Pleasanton, CA

Prep(s): 5030B	Test(s): 8260FAB
Sample ID: MW-4	Lab ID: 2003-03-0679-4
Sampled: 03/28/2003 09:49	Extracted: 4/10/2003 15:42
Matrix: Water	QC Batch#: 2003/04/10-1A-62

Compound	Conc.	RL	Unit	Dilution	Analyzed	Flag
Gasoline	ND	50	ug/L	1.00	04/10/2003 15:42	
Benzene	ND	0.50	ug/L	1.00	04/10/2003 15:42	
Toluene	ND	0.50	ug/L	1.00	04/10/2003 15:42	
Ethylbenzene	ND	0.50	ug/L	1.00	04/10/2003 15:42	
Total xylenes	ND	1.0	ug/L	1.00	04/10/2003 15:42	
tert-Butyl alcohol (TBA)	ND	5.0	ug/L	1.00	04/10/2003 15:42	
Methyl tert-butyl ether (MTBE)	2.4	0.50	ug/L	1.00	04/10/2003 15:42	
Di-isopropyl Ether (DIPE)	ND	2.0	ug/L	1.00	04/10/2003 15:42	
Ethyl tert-butyl ether (ETBE)	ND	2.0	ug/L	1.00	04/10/2003 15:42	
tert-Amyl methyl ether (TAME)	ND	2.0	ug/L	1.00	04/10/2003 15:42	
<b>Surrogates(s)</b>						
1,2-Dichloroethane-d4	103.8	76-114	%	1.00	04/10/2003 15:42	
Toluene-d8	97.7	88-110	%	1.00	04/10/2003 15:42	

Severn Trent Laboratories, Inc.

STL San Francisco \* 1220 Quarry Lane, Pleasanton, CA 94566

Tel 925 484 1919 Fax 925 484 1096 \* www.stl-inc.com \* CA DHS ELAP# 2496

04/30/2003 15:40

**Gas/BTEX Fuel Oxygenates by 8260B**

Blaine Tech Services, Inc.

Attn.: Leon Gearhart

1680 Rogers Avenue  
San Jose, CA 95112-1105  
Phone: (408) 573-0555 Fax: (408) 573-7771

Project: 03028-BA2  
97402156

Received: 03/28/2003 15:29

Site: 6750 Santa Rita Rd.  
Pleasanton, CA

Batch QC Report			
Prep(s): 5030B			Test(s): 8260FAB
Method Blank	Water		QC Batch # 2003/04/09-V1.62
MB: 2003/04/09-V1.62-035			Date Extracted: 04/09/2003 11:35

Compound	Conc.	RL	Unit	Analyzed	Flag
Gasoline	ND	50	ug/L	04/09/2003 11:35	
tert-Butyl alcohol (TBA)	ND	5.0	ug/L	04/09/2003 11:35	
Methyl tert-butyl ether (MTBE)	ND	0.5	ug/L	04/09/2003 11:35	
Di-isopropyl Ether (DIPE)	ND	2.0	ug/L	04/09/2003 11:35	
Ethyl tert-butyl ether (ETBE)	ND	2.0	ug/L	04/09/2003 11:35	
tert-Amyl methyl ether (TAME)	ND	2.0	ug/L	04/09/2003 11:35	
Benzene	ND	0.5	ug/L	04/09/2003 11:35	
Toluene	ND	0.5	ug/L	04/09/2003 11:35	
Ethylbenzene	ND	0.5	ug/L	04/09/2003 11:35	
Total xylenes	ND	1.0	ug/L	04/09/2003 11:35	
<b>Surrogates(s)</b>					
1,2-Dichloroethane-d4	98.8	76-114	%	04/09/2003 11:35	
Toluene-d8	95.1	88-110	%	04/09/2003 11:35	

Severn Trent Laboratories, Inc.

STL San Francisco \* 1220 Quarry Lane, Pleasanton, CA 94566

Tel 925 484 1919 Fax 925 484 1096 \* www.stl-inc.com \* CA DHS ELAP# 2496

04/30/2003 15:40

**Gas/BTEX Fuel Oxygenates by 8260B**

Blaine Tech Services, Inc.

Attn.: Leon Gearhart

1680 Rogers Avenue  
San Jose, CA 95112-1105  
Phone: (408) 573-0555 Fax: (408) 573-7771

Project: 03028-BA2  
97402156

Received: 03/28/2003 15:29

Site: 6750 Santa Rita Rd.  
Pleasanton, CA

Batch QC Report		
Prep(s): 5030B Method Blank MB: 2003/04/10-1A.62-057	Water	Test(s): 8260FAB QC Batch # 2003/04/10-1A.62 Date Extracted: 04/10/2003 10:56

Compound	Conc.	RL	Unit	Analyzed	Flag
Gasoline	ND	50	ug/L	04/10/2003 10:56	
Benzene	ND	0.5	ug/L	04/10/2003 10:56	
Toluene	ND	0.5	ug/L	04/10/2003 10:56	
Ethylbenzene	ND	0.5	ug/L	04/10/2003 10:56	
Total xylenes	ND	1.0	ug/L	04/10/2003 10:56	
tert-Butyl alcohol (TBA)	ND	5.0	ug/L	04/10/2003 10:56	
Methyl tert-butyl ether (MTBE)	ND	0.5	ug/L	04/10/2003 10:56	
Di-isopropyl Ether (DIPE)	ND	2.0	ug/L	04/10/2003 10:56	
Ethyl tert-butyl ether (ETBE)	ND	2.0	ug/L	04/10/2003 10:56	
tert-Amyl methyl ether (TAME)	ND	2.0	ug/L	04/10/2003 10:56	
<b>Surrogates(s)</b>					
1,2-Dichloroethane-d4	101.4	76-114	%	04/10/2003 10:56	
Toluene-d8	96.8	88-110	%	04/10/2003 10:56	

**Gas/BTEX Fuel Oxygenates by 8260B**

Blaine Tech Services, Inc.

Attn.: Leon Gearhart

1680 Rogers Avenue  
San Jose, CA 95112-1105  
Phone: (408) 573-0555 Fax: (408) 573-7771

Project: 03028-BA2  
97402156

Received: 03/28/2003 15:29

Site: 6750 Santa Rita Rd.  
Pleasanton, CA

Batch QC Report			
Prep(s): 5030B		Test(s): 8260FAB	
Laboratory Control Spike		Water	QC Batch # 2003/04/09-V1.62
LCS	2003/04/09-V1.62-050	Extracted: 04/09/2003	Analyzed: 04/09/2003 10:50
LCSD	2003/04/09-V1.62-012	Extracted: 04/09/2003	Analyzed: 04/09/2003 11:12

Compound	Conc. ug/L		Exp.Conc.	Recovery		RPD	Ctrl.Limits %		Flags	
	LCS	LCSD		LCS	LCSD		%	Rec.	RPD	LCS
Methyl tert-butyl ether (MTBE)	30.2	29.4	25	120.8	117.6	2.7	65-165	20		
Benzene	25.0	26.1	25	100.0	104.4	4.3	69-129	20		
Toluene	24.5	25.6	25	98.0	102.4	4.4	70-130	20		
<b>Surrogates(s)</b>										
1,2-Dichloroethane-d4	521	489	500	104.2	97.8		76-114			
Toluene-d8	520	485	500	104.0	97.0		88-110			

Severn Trent Laboratories, Inc.

STL San Francisco \* 1220 Quarry Lane, Pleasanton, CA 94566

Tel 925 484 1919 Fax 925 484 1096 \* www.stl-inc.com \* CA DHS ELAP# 2496

04/30/2003 15:40

**Gas/BTEX Fuel Oxygenates by 8260B**

Blaine Tech Services, Inc.

Attn.: Leon Gearhart

1680 Rogers Avenue  
San Jose, CA 95112-1105  
Phone: (408) 573-0555 Fax: (408) 573-7771

Project: 03028-BA2  
97402156

Received: 03/28/2003 15:29

Site: 6750 Santa Rita Rd.  
Pleasanton, CA

Batch QC Report										
Prep(s): 5030B						Test(s): 8260FAB				
Laboratory Control Spike				Water			QC Batch # 2003/04/10-1A.62			
LCS	2003/04/10-1A.62-011			Extracted: 04/10/2003			Analyzed: 04/10/2003 10:11			
LCSD	2003/04/10-1A.62-034			Extracted: 04/10/2003			Analyzed: 04/10/2003 10:34			
Compound	Conc. ug/L		Exp.Conc.	Recovery		RPD	Ctr.Limits %		Flags	
	LCS	LCSD		LCS	LCSD		%	Rec.	RPD	LCS
Methyl tert-butyl ether (MTBE)	32.2	30.1	25	128.8	120.4	6.7	65-165	20		
Benzene	27.3	26.2	25	109.2	104.8	4.1	69-129	20		
Toluene	27.9	25.5	25	111.6	102.0	9.0	70-130	20		
<b>Surrogates(s)</b>										
1,2-Dichloroethane-d4	527	516	500	105.4	103.2		76-114			
Toluene-d8	533	512	500	106.6	102.4		88-110			

**Gas/BTEX Fuel Oxygenates by 8260B**

Blaine Tech Services, Inc.

Attn.: Leon Gearhart

1680 Rogers Avenue

San Jose, CA 95112-1105

Phone: (408) 573-0555 Fax: (408) 573-7771

Project: 03028-BA2

97402156

Received: 03/28/2003 15:29

Site: 6750 Santa Rita Rd.  
Pleasanton, CA

**Legend and Notes**

**Analysis Flag**

o

Reporting limits were raised due to high level of analyte present in the sample.

Severn Trent Laboratories, Inc.

STL San Francisco \* 1220 Quarry Lane, Pleasanton, CA 94566

Tel 925 484 1919 Fax 925 484 1096 \* www.stl-inc.com \* CA DHS ELAP# 2496

04/30/2003 15:40

LAB: STL SAN FRANCISCO

SHELL Chain Of Custody Record

73015

Lab Identification (if necessary):

Address:

City, State, Zip:

Shell Project Manager to be Involved:

SCIENCE & ENGINEERING  
 TECHNICAL SERVICES  
 CRUISE INDUSTRIES

Lynn Walker

2003-03-0679

INCIDENT NUMBER (S&E ONLY)

9 7 4 0 2 1 5 6

S&E PROJECT NUMBER (S&E/CRMT)

DATE: 3/28/03

PAGE: 1 of 1

SAMPLING COMPANY: **Blair Tech Services** ADDRESS: **1680 Rogers Avenue, San Jose, CA 95112** PHONE: **408-573-0555** FAX: **408-573-7771** EMAIL: **gearhart@blairtech.com**

LOG CODE: **BTSS** SITE ADDRESS (Street and City): **6750 Santa Rita Rd., Pleasanton** GLOBAL ID NO.: **pending**

USE (DELIVERABLE TO (Responsible Party or Designer): **Debbie Arnold** PHONE NO.: **(408)224-4724** EMAIL: **darnold@khmi.com** CONSULTANT PROJECT NO.: **030528-3A2**

PROJECT CONTACT (Responsible Party or Designer): **Leon Gearhart** (BARKER NAME(S) (Print): **Brian Alcorn** LAB USE ONLY

TURNAROUND TIME (BUSINESS DAYS):  
 30 DAYS  5 DAYS  72 HOURS  48 HOURS  24 HOURS  LESS THAN 24 HOURS

LA - RWQCB REPORT FORMAT  LIST AGENCY:  
 GC/MS MTBE CONFIRMATION (HIGHEST \_\_\_\_\_ HIGHEST per BORING \_\_\_\_\_ ALL \_\_\_\_\_)  
 SPECIAL INSTRUCTIONS OR NOTES: CHECK BOX IF EDC IS NOT NEEDED:

REQUESTED ANALYSIS

Field Sample Identification	SAMPLING DATE	TIME	MATRIX	NO. OF CONT.	TPH - Gas, Purgeable	STEX	MTBE (M&T B - Spill RL)	MTBE (M&T B - 0.5ppb RL)	Oxyaromatics (O) by (M&T B)	TPH - Diesel, Extractable
MW-1	3/28	1003	W	5	X	X			X	X
MW-2	1	1016	1	1	X	X			X	X
MW-3	1	1029	1	1	X	X			X	X
MW-4	7	0949	7	7	X	X			X	X

FIELD NOTES:  
 Contains Preservative  
 or PID Readings  
 or Laboratory Notes

3.8°C

TEMPERATURE ON RECEIPT (°C)

Requested by: (Signature) *[Signature]* Received by: (Signature) *[Signature]* Date: 3/28/03 Time: 1529

Requested by: (Signature) *[Signature]* Received by: (Signature) *[Signature]* Date: 3-28-03 Time: 1823

STL San Francisco

Sample Receipt Checklist

Submission # 2003-03-0679

Checklist completed by (Initials) ASH Date 03/31/03

Courier name: [x] STL San Francisco [ ] Client

Custody seals intact on shipping container/samples Yes No Not Present [x]

Chain of custody present? Yes [x] No

Chain of custody signed when relinquished and received? Yes [x] No

Chain of custody agrees with sample labels? Yes [x] No

Samples in proper container/bottle? Yes [x] No

Sample containers intact? Yes [x] No

Sufficient sample volume for indicated test? Yes [x] No

All samples received within holding time? Yes [x] No

Container/Temp Blank temperature in compliance (4°C ± 2)? Yes [x] No

Temp: 38°C

Water - VOA vials have zero headspace? No VOA vials submitted Yes [x] No

(if bubble is present, refer to approximate bubble size and itemize in comments as S (small - O), M (medium - O) or L (large - O))

Water - pH acceptable upon receipt? [x] Yes [ ] No checked all ambient 3/28/03

[ ] pH adjusted - Preservative used: [ ] HNO3 [ ] HCl [ ] H2SO4 [ ] NaOH [ ] ZnOAc

For any item check-listed "No", provided detail of discrepancy in comment section below:

Comments:

Project Management [Routing for instruction of indicated discrepancy(ies)]

Project Manager: (Initials) Date: 1/03

Client contacted: [ ] Yes [ ] No

Summary of discussion:

Corrective Action (per PM/Client):



REPAIR DATA SHEET

Client shell Date 4-16-03

Site Address 6750 Santa Rita Road Pleasanton

Job Number ~~A311~~ 030416 T.01 Technician Travis

Repair Location MW-2

Deficiencies Corrected well Rim cracked  
Replaced well Box, Replaced  
lock

Materials Used 4 1/2 Bgs concrete 1 Lock  
1 WB

Repair Location MW-1

Deficiencies Corrected well Box Rim cracked  
Broken tabs Replaced well  
Box

Materials Used 1 W.B - 4 Bgs concrete

Repair Location MW-3

Deficiencies Corrected Broken tabs, Lid  
Replaced WB

Materials Used 1 WB 4 1/2 Bgs concrete

Repair Location MW-4

Deficiencies Corrected Retap Bolt holes

Materials Used 2 Bolts

Repair Location \_\_\_\_\_

Deficiencies Corrected \_\_\_\_\_

Materials Used \_\_\_\_\_

Repair Location \_\_\_\_\_

Deficiencies Corrected \_\_\_\_\_

Materials Used \_\_\_\_\_

## WELLHEAD INSPECTION CHECKLIST

Page 1 of 1

Client SHELL Date 3/28/03

Site Address 6750 SANTA RITA RD, PLASANTON

Job Number 030328-BA.2 Technician BRIAN ALCOX

Well ID	Well Inspected - No Corrective Action Required	Water Bailed From Wellbox	Wellbox Components Cleaned	Cap Replaced	Lock Replaced	Other Action Taken (explain below)	Well Not Inspected (explain below)	Repair Order Submitted
MW-1								X
MW-2								X
MW-3								X
MW-4								X

NOTES:

---



---



---



---



---



---

# WELL GAUGING DATA

Project # 030328-BA2 Date 3/28/03 Client SHELL

Site 6750 SANTA RITA RD, PLEASANTON

Well ID	Well Size (in.)	Sheen / Odor	Depth to Immiscible Liquid (ft.)	Thickness of Immiscible Liquid (ft.)	Volume of Immiscibles Removed (ml)	Depth to water (ft.)	Depth to well bottom (ft.)	Survey Point: TOB or TOC
MW-1	2					31.59	41.75	TOC
MW-2	2					30.30	41.90	↓
MW-3	2					30.76	44.00	
MW-4	2					32.07	44.05	

## SHELL WELL MONITORING DATA SHEET

BTS #: <u>030328-BA2</u>	Site: <u>6750 SANTA RITA RD, PLEASANTON</u>
Sampler: <u>Brian Alford</u>	Date: <u>3/28/03</u>
Well I.D.: <u>MW-1</u>	Well Diameter: <u>(2)</u> 3 4 6 8
Total Well Depth (TD): <u>41.75</u>	Depth to Water (DTW): <u>31.59</u>
Depth to Free Product:	Thickness of Free Product (feet):
Referenced to: <u>(PVC)</u> Grade	D.O. Meter (if req'd): YSI HACH
DTW with 80% Recharge [(Height of Water Column x 0.20) + DTW]:	

Purge Method: <del>Bailer</del> <del>Disposable Bailer</del> <del>Middleburg</del> <del>Electric Submersible</del>	<del>Water</del> <del>Peristaltic</del> <del>Extraction Pump</del> <del>Other</del>	Sampling Method: <u>(Bailer)</u> Disposable Bailer Extraction Port Dedicated Tubing Other:
---	--	--

Well Diameter	Multiplier	Well Diameter	Multiplier
1"	0.04	4"	0.65
2"	0.16	6"	1.47
3"	0.37	Other	radius <sup>2</sup> * 0.163

(Gals.) X No Purge = \_\_\_\_\_ Gals.  
 Case Volume      Specified Volumes      Calculated Volume

Time	Temp (°F)	pH	Cond. (mS or <u>µS</u> )	Turbidity (NTUs)	Gals. Removed	Observations
<u>1003</u>	<u>65.0</u>	<u>7.4</u>	<u>2741</u>	<u>7,000</u>	<u>—</u>	<u>very cloudy brown</u>

Did well dewater?    Yes    No    Gallons actually evacuated:    —  
 Sampling Date: 3/28/03    Sampling Time: 1003    Depth to Water: 31.59

Sample I.D.: MW-1    Laboratory:    Kiff    SPL    Other STL <sup>SAN</sup> FRANCISCO

Analyzed for: (TPH-G BTEX) (MTBE) (TPH-D) Other: OXYS

I.D. (if applicable): \_\_\_\_\_ @ \_\_\_\_\_    Duplicate I.D. (if applicable): \_\_\_\_\_

Analyzed for: TPH-G BTEX MTBE TPH-D Other:

D.O. (if req'd):	Pre-purge:	mg/L	Post-purge:	mg/L
	D.R.P. (if req'd):	Pre-purge:	mV	Post-purge:

## SHELL WELL MONITORING DATA SHEET

BTS #: <u>030328-BA2</u>	Site: <u>6750 SANTA RITA RD, PLEASANTON</u>
Sampler: <u>Brian Alford</u>	Date: <u>3/28/03</u>
Well I.D.: <u>MW-2</u>	Well Diameter: <u>(2)</u> 3 4 6 8
Total Well Depth (TD): <u>41.90</u>	Depth to Water (DTW): <u>30.30</u>
Depth to Free Product:	Thickness of Free Product (feet):
Referenced to: <u>PVC</u> Grade	D.O. Meter (if req'd): YSI HACH
DTW with 80% Recharge [(Height of Water Column x 0.20) + DTW]:	

Purge Method: <u>Bailer</u> <del>Disposable Bailer</del> <del>Middleburg</del> <del>Electric Submersible</del>	Water: <del>Peristaltic</del> <del>Extraction Pump</del> Other:	Sampling Method: <u>Bailer</u> <del>Disposable Bailer</del> <del>Extraction Port</del> <del>Dedicated Tubing</del> Other:
---	---	---

Well Diameter	Multiplier	Well Diameter	Multiplier
1"	0.04	4"	0.65
2"	0.16	6"	1.47
3"	0.37	Other	radius <sup>2</sup> * 0.163

(Gals.) X No Purge = \_\_\_\_\_ Gals.  
 Case Volume      Specified Volumes      Calculated Volume

Time	Temp (°F)	pH	Cond. (mS or <u>µS</u> )	Turbidity (NTUs)	Gals. Removed	Observations
<u>1016</u>	<u>65.0</u>	<u>7.3</u>	<u>3.060</u>	<u>7,000</u>	—	<u>Very cloudy brown</u>

Did well dewater?    Yes    No      Gallons actually evacuated:    —

Sampling Date: 3/28/03    Sampling Time: 1016    Depth to Water: 30.30

Sample I.D.: MW-2      Laboratory:    Kiff    SPL    Other: SAN FRANCISCO

Analyzed for: TPH-G BTEX MTBE TPH-D Other: Oxys

EB I.D. (if applicable): \_\_\_\_\_ @ \_\_\_\_\_ This      Duplicate I.D. (if applicable): \_\_\_\_\_

Analyzed for:    TPH-G    BTEX    MTBE    TPH-D    Other:

D.O. (if req'd):    Pre-purge: \_\_\_\_\_ mg/L      Post-purge: \_\_\_\_\_ mg/L

D.R.P. (if req'd):    Pre-purge: \_\_\_\_\_ mV      Post-purge: \_\_\_\_\_ mV

## SHELL WELL MONITORING DATA SHEET

BTS #: <u>030328-BA2</u>	Site: <u>6750 SANTA RITA RD, PLEASANTON</u>
Sampler: <u>Brian Alford</u>	Date: <u>3/28/03</u>
Well I.D.: <u>MW-3</u>	Well Diameter: <u>(2)</u> 3 4 6 8
Total Well Depth (TD): <u>44.00</u>	Depth to Water (DTW): <u>30.76</u>
Depth to Free Product:	Thickness of Free Product (feet):
Referenced to: <u>PVC</u> Grnde	D.O. Meter (if req'd): YSI HACH
DTW with 80% Recharge [(Height of Water Column x 0.20) + DTW]:	

Bailer Method: ~~Bailer~~ ~~Disposable Bailer~~ ~~Middleburg~~ ~~Electric Submersible~~     
 Waterma ~~Peristaltic~~ ~~Extraction Pump~~ ~~Other~~     
 Sampling Method: Bailer ~~Disposable Bailer~~ ~~Extraction Port~~ ~~Dedicated Tubing~~

(Gals.) X No Purge = \_\_\_\_\_ Gals.  
 Case Volume      Specified Volumes      Calculated Volume

Well Diameter	Multiplier	Well Diameter	Multiplier
1"	0.04	4"	0.65
2"	0.16	6"	1.47
3"	0.37	Other	radius <sup>2</sup> * 0.163

Time	Temp (°F)	pH	Cond. (mS or <u>(S)</u> )	Turbidity (NTUs)	Gals. Removed	Observations
1029	68.3	8.0	2,539	>1,000	—	Very cloudy brown

Did well dewater? Yes No      Gallons actually evacuated: —  
 Sampling Date: 3/28/03      Sampling Time: 1029      Depth to Water: 30.76

Sample I.D.: MW-3      Laboratory: Kiff SPL Other SAN FRANCISCO

Analyzed for: TPH-G BTEX MTBE TPH-D Other: Others

EB I.D. (if applicable): \_\_\_\_\_ @ \_\_\_\_\_ Time      Duplicate I.D. (if applicable): \_\_\_\_\_

Analyzed for: TPH-G BTEX MTBE TPH-D Other: \_\_\_\_\_

D.O. (if req'd):	Pre-purge:	me/L	Post-purge:	me/L
D.R.P. (if req'd):	Pre-purge:	mV	Post-purge:	mV

## SHELL WELL MONITORING DATA SHEET

3TS #: <u>030328-BA2</u>	Site: <u>6750 SANTA RITA RD, PLEASANTON</u>
Sampler: <u>BRIAN ALLEN</u>	Date: <u>3/28/03</u>
Well I.D.: <u>MW-4</u>	Well Diameter: <u>(2)</u> 3 4 6 8
Total Well Depth (TD): <u>44.05</u>	Depth to Water (DTW): <u>32.07</u>
Depth to Free Product:	Thickness of Free Product (feet):
Referenced to: <u>PVC</u> Grade	D.O. Meter (if req'd): YSI HACH
DTW with 80% Recharge [(Height of Water Column x 0.20) + DTW]:	

Purge Method: <del>Bailer</del> <del>Disposable Bailer</del> <del>Middleburg</del> <del>Electric Submersible</del>	<del>Water</del> Peristaltic Extraction Pump Other	Sampling Method: <u>Bailer</u> Disposable Bailer Extraction Port Dedicated Tubing Other:
---	---	--

(Gals.) X No Purge = \_\_\_\_\_ Gals.  
 Case Volume Specified Volume Calculated Volume

Well Diameter	Multiplier	Well Diameter	Multiplier
1"	0.04	4"	0.65
2"	0.16	6"	1.47
3"	0.37	Other	radius <sup>2</sup> * 0.163

Time	Temp (°F)	pH	Cond. (mS or <u>µS</u> )	Turbidity (NTUs)	Gals. Removed	Observations
<u>0949</u>	<u>66.0</u>	<u>7.4</u>	<u>2,453</u>	<u>71,000</u>	—	<u>Very cloudy brown</u>

Did well dewater? Yes No Gallons actually evacuated: —

Sampling Date: 3/28/03 Sampling Time: 0949 Depth to Water: 32.07

Sample I.D.: MW-4 Laboratory: Kiff SPL Other: STL SAN FRANCISCO

Analyzed for: TPH-G BTEX MTBE TPH-D Other: OKYS

3B I.D. (if applicable): @ Time Duplicate I.D. (if applicable):

Analyzed for: TPH-G BTEX MTBE TPH-D Other:

D.O. (if req'd):	Pre-purge:	mg/L	Post-purge:	mg/L
D.R.P. (if req'd):	Pre-purge:	mV	Post-purge:	mV