

*For Mr. Shaw*

202509

August 6, 2002

Mr. Daniel Shaw  
D&D Ventures LLC  
15700 Winchester Boulevard  
Los Gatos, CA 95030

**Subject: Final Report**  
901 77<sup>th</sup> Avenue  
Oakland, California  
AEI Project No. 5388

Dear Mr. Shaw:

Enclosed is the final report for the tank removal at the above referenced site.

Please call me at (925) 283-6000 if you have any questions.

Sincerely,



Nathan Garfield  
Project Manager

02 AUG 19 PM 9 30  
OAKLAND FIRE  
O.E.S.

CC: Inspector Keith Matthews, Oakland Fire Services Agency, 1605 Martin Luther King Jr. Way, Oakland, CA 94612

OAKLAND FIRE  
DEPT.

AUG 28 2002

02 AUG 19 09 30

August 6, 2002

**UNDERGROUND STORAGE TANK REMOVAL  
FINAL REPORT**

901 77th Avenue  
Oakland, California 94621

Project No. 5388

Prepared For

**D&D Ventures LLC**  
15700 Winchester Boulevard  
Los Gatos, CA 95030

Prepared By

**AEI Consultants**  
3210 Old Tunnel Road, Suite B  
Lafayette, CA 94549  
(800) 801-3224

**AEI**

## TABLE OF CONTENTS

<b>1.0 INTRODUCTION</b> .....	<b>1</b>
<b>2.0 PERMITS</b> .....	<b>1</b>
<b>3.0 MOBILIZATION, EXCAVATION AND REMOVAL</b> .....	<b>1</b>
<b>4.0 SAMPLING AND ANALYSES</b> .....	<b>2</b>
TABLE 1 - Soil Sample Analyses .....	2
<b>5.0 SUMMARY AND CONCLUSIONS</b> .....	<b>3</b>
<b>6.0 REPORT LIMITATIONS AND SIGNATURES</b> .....	<b>4</b>

### LIST OF FIGURES

- 1 SITE LOCATION PLAN
- 2 SITE PLAN
- 3 SAMPLE LOCATION MAP

### APPENDICES

- A PERMITS AND NOTIFICATION DOCUMENTS
- B SITE HEALTH AND SAFETY PLAN
- C TRANSPORT AND DISPOSAL DOCUMENTS
- D ANALYTICAL DOCUMENTATION

## **1.0 INTRODUCTION**

AEI Consultants (AEI) has prepared this final report to document the underground storage tank closure activities performed at 901 77th Avenue in Oakland, California (Figure 1: Site Location Map). One (1) 1,000-gallon gasoline underground storage tank (UST) was removed. The tank was located at the southwest corner of the building (Figure 2: Site Plan).

AEI was contracted to obtain all necessary permits, excavate to expose the tank, remove and dispose of residual liquids, remove and dispose the tank, perform soil sampling and analysis, backfill and resurface the excavation.

## **2.0 PERMITS**

The City of Oakland Fire Prevention Bureau (FPB) issued a permit for the removal of the tank on July 22, 2002. Inspector Keith Matthews was assigned to represent the FPB, and observed the tank closure activities at the site. On July 18, 2002, Cal OSHA and the Bay Area Air Quality Management District (BAAQMD) were notified of the tank removal activities. The excavation areas were marked and the property representative was notified of the specific time plan.

Copies of the permit and notification documents are located in Appendix A: Permits and Notification Documents.

## **3.0 MOBILIZATION, EXCAVATION AND REMOVAL**

On July 25, 2002, the AEI field staff was briefed and the Site Health and Safety Plan reviewed prior to the initiation of work. The Site Health and Safety Plan is located in Appendix B. Ground cover was broken and the soil above the tank was excavated. A single stockpile of the excavated soil was created adjacent to the excavation. Refer to Figure 2 for the locations of the excavation and stockpile.

Excel Environmental Services, Inc. removed 85 gallons of waste liquid from the tank prior to removal. Dry ice was introduced into the tank until the Lower Explosive Limit (LEL) and oxygen content reached acceptable levels.

The tank was removed on July 25, 2002, and was visually inspected prior to loading for transport. No obvious holes or cracks were observed in the tank. The tank was covered with an asphalt and tar wrapping which may have obscured any holes present.

The tank was loaded onto a Ecology Control Industries (ECI) truck and transported under non-hazardous waste manifest to the ECI disposal facility at 255 Parr Boulevard in Richmond, California, where the tank was triple rinsed, cut, and scrapped.

Soil samples were collected prior to backfilling. The excavation was lined with Visqueen, then backfilled with stockpiled soil and five (5) cubic yards of clean fill material to replace the volume of the tank.

The non-hazardous waste manifests for the waste liquid and tank are located in Appendix C: Transport and Disposal Documents.

#### 4.0 SAMPLING AND ANALYSES

All samples were collected under the direction of Keith Matthews of the Oakland Fire Department. A total of six (6) soil samples were collected from the tank removal activities. One sample was collected 2 feet under either end of the tank at a total depth of eight (8) feet below ground surface (bgs). These sample were labeled EB-W-8' and EB-E-8' respectively. A total of four (4) discrete soil samples were collected from the stockpile and composited into a single sample (STKP 1-4) for analysis. Please refer to Figure 3: Sample Location Plan for the sample locations.

Native material consisted of brown sandy clay with approximately 5% gravel sized clasts. Grey-green soil staining was noted in the bottom third of the excavation. Groundwater was not encountered during the removal activities.

All soil samples were collected in brass tubes that were driven into the soil until completely full, then sealed with Teflon tape and plastic caps. The secured sample tubes were immediately placed into a cooler with ice. Chain of Custody documentation was initiated. The cooler and samples were brought to McCampbell Analytical, Inc. (State Certification #1644) of Pacheco, California on July 25, 2002 for analysis.

The samples were analyzed for Total Petroleum Hydrocarbons as gasoline (EPA 8015), Total Lead (EPA Method 6010/200), methyl-tert-butyl ether (MTBE), and benzene, toluene, ethylbenzene, and xylenes (BTEX) (EPA Method 602/8020). The analytical results are summarized in the following table:

**TABLE 1 - Soil Sample Analyses**

	EB-W-8'	EB-E-8'	STKP 1-4
TPH-GASOLINE (mg/kg)	4,600	310	40
MTBE (mg/kg)	<25	<2.5	<0.05
BENZENE (mg/kg)	4.5	<0.2	0.026
TOLUENE (mg/kg)	23	0.29	0.022
ETHYL BENZENE (mg/kg)	63	8.9	0.012
TOTAL XYLENES (mg/kg)	180	7.2	0.022
TOTAL LEAD (mg/kg)	16	9.1	12

mg/kg = milligrams per kilogram (ppm)

Copies of all analytical results and Chain of Custody documentation are located in Appendix D: Analytical Documentation.

## 5.0 SUMMARY AND CONCLUSIONS

On July 25, 2002, a 1,000-gallon gasoline UST was removed from the property located at 901 77th Avenue in Oakland, California. Prior to removal, 85 gallons of waste liquid were removed, transported and disposed off-site. The tank was transported under non-hazardous waste manifest to the Ecology Control Industries' disposal facility in Richmond, California where the tank was cleaned and disposed of as scrap metal.

A total of six (6) soil samples were collected during the tank removal activities. Concentrations of TPH-g ranged from 40 to 4,600 mg/kg. BTEX concentrations were elevated in all samples, and showed the highest concentrations in sample EB-W-8' (benzene 4.5 mg/kg). Due to the elevated concentrations of petroleum hydrocarbons detected in the soil, the Oakland Fire Department may require further investigation at the site.

## **6.0 REPORT LIMITATIONS AND SIGNATURES**

This report presents a summary of work completed by AEI Consultants, including observations and descriptions of site conditions encountered. Where appropriate, it includes analytical results for samples taken during the course of the work. The number and location of samples are chosen to provide required information, but it cannot be assumed that they are representative of areas not sampled. All conclusions and/or recommendations are based on these analyses and observations, and the governing regulations. Conclusions beyond those stated and reported herein should not be inferred from this document.

All services were performed in accordance with generally accepted practices, in the environmental engineering and construction field, which existed at the time and location of the work.

### **AEI Consultants**

Nathan Garfield  
Staff Geologist



**901 77th Avenue**

Oakland-Alameda County  
Coliseum Complex

Oakland-Alameda Co  
Coliseum Complex

TN  
MN  
15°

0 5 1 MILE  
0 1000 FEET 0 500 1000 METERS

Printed from TOPO! ©2001 National Geographic Holdings (www.topo.com)

<p><b>AEI CONSULTANTS</b> 3210 OLD TUNNEL RD, STE B, LAFAYETTE, CA</p>	
<p><b>SITE LOCATION MAP</b></p>	
<p>901 77<sup>th</sup> AVENUE OAKLAND, CALIFORNIA</p>	<p><b>FIGURE 1</b> PROJECT No. 5388</p>



901 77TH AVENUE

PUBLIC RIGHT OF WAY

77TH AVENUE

VENT PIPES

FORMER LOCATION OF  
1,000-GALLON UST

PUBLIC RIGHT OF WAY

HAWLEY STREET



**AEI Consultants**

3210 OLD TUNNEL ROAD, SUITE B, LAFAYETTE, CA

NOT TO SCALE

DRAWN BY: NATHAN GARFIELD

DATE: 8/5/02

**SITE PLAN**

901 77TH AVENUE  
OAKLAND, CALIFORNIA

DRAWING NUMBER:  
**FIGURE 2**

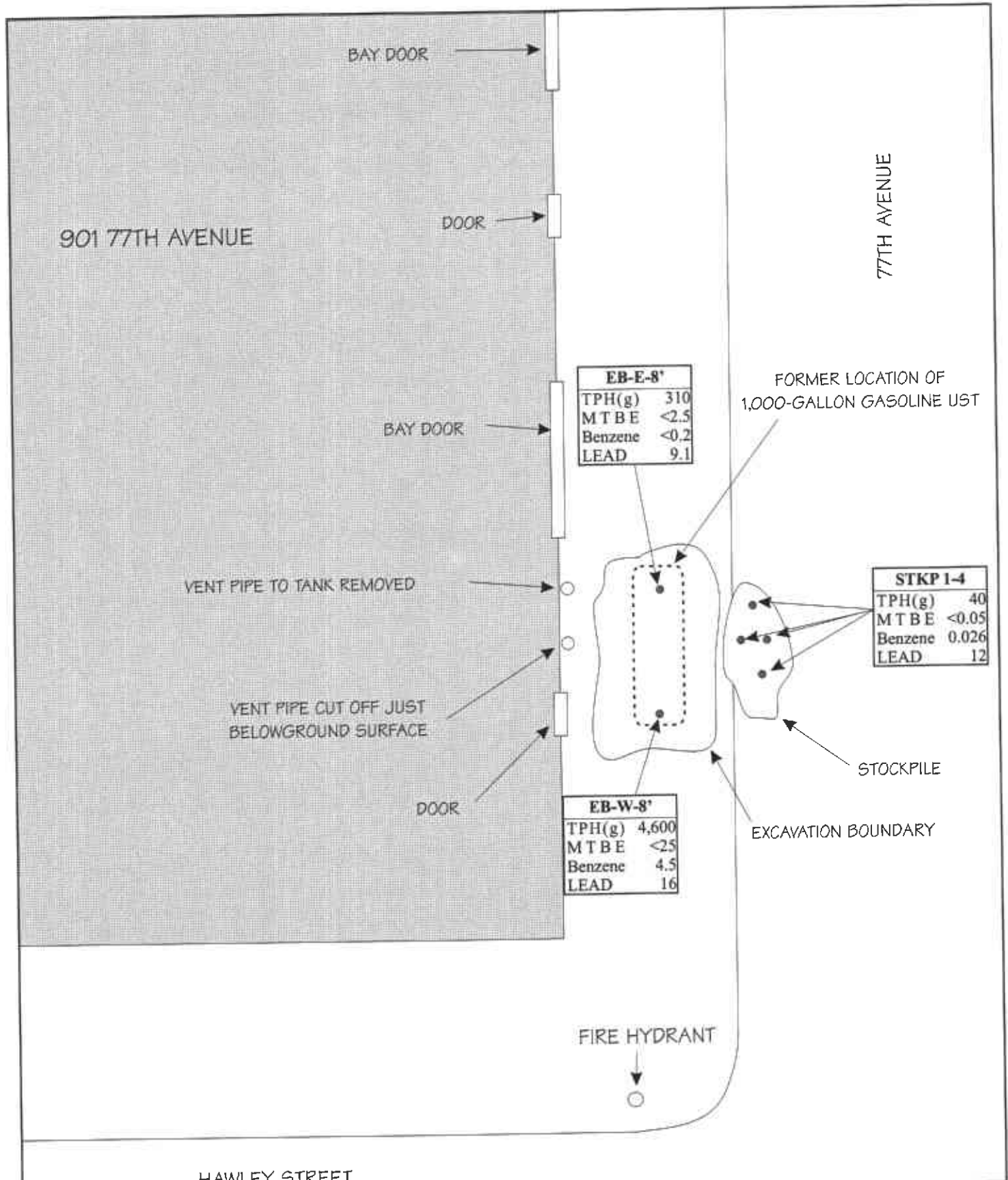

EB-E-8'	
TPH(g)	310
MTBE	<2.5
Benzene	<0.2
LEAD	9.1

STKP 1-4	
TPH(g)	40
MTBE	<0.05
Benzene	0.026
LEAD	12

EB-W-8'	
TPH(g)	4,600
MTBE	<25
Benzene	4.5
LEAD	16

**LEGEND**

- SOIL SAMPLE LOCATION
- TPH(g) TOTAL PETROLEUM HYDROCARBON AS GASOLINE
- MTBE METHYL TERTIARY BUTYL ETHER
- LEAD TOTAL LEAD



**AEI Consultants**  
 3210 OLD TUNNEL ROAD, SUITE B, LAFAYETTE, CA

1" = 10'      DRAWN BY: NATHAN GARFIELD      DATE: 8/5/02

**SAMPLE LOCATION MAP**

901 77TH AVENUE      DRAWING NUMBER:  
 OAKLAND, CALIFORNIA      **FIGURE 3**

**APPENDIX A**

**PERMITS AND NOTIFICATION DOCUMENTS**

**City Of Oakland**  
**FIRE PREVENTION BUREAU**  
250 Frank Ogawa Plaza, Ste. 3341  
Oakland California 94612-2032  
510-238-3851



*Permit To Excavate And Install, Repair,  
Or Remove Inflammable Liquid Tanks*

Oakland, California July 22, 2002

Tank Permit Number: 42-02

Permission Is Hereby Granted To:

Remove Gasoline Tank And Excavate Commencing: 4 Feet Inside: Curb Line.

On The: N side of 77th Avenue, 50 feet E of Hawley Street

Site Address: 901 77th Avenue Present Storage: Gasoline

Owner: D&D Ventures LLC Address: 15700 Winchester Bl., Los Gatos, CA, 95030 Phone: (408) 354-9777

Applicant: AEI Consultants Address: 3210 Old Tunnel Rd., #B., Lafayette, 94549 Phone: (925) 283-6000

Dimensions Of Street (sidewalk) Surface To Be Disturbed: X No. Of Tanks 1 Capacity 1,000 Gallons, Each

Remarks

This Permit Is Granted In Accordance With Existing City Ordinances. Owner Hereby Agrees To Remove Tanks On Discontinuance Of Use Or When Notified By The City Authorities When Installing, Removing Or Repairing Tanks, No Open Flame To Be On Or Near Premises.

### CERTIFICATE OF TANK AND EQUIPMENT INSPECTION

Type Of Inspection: UST Removal

Inspected And Passed On: 25 July 02

Approved: *Sandra K. McLean*  
Fire Marshal

UST/AST Installations/modifications: By: *[Signature]*

Inspection Fee Paid: \$ 540.00

Pressure Test: Inspected By: \_\_\_\_\_ Date: \_\_\_\_\_

Primary Piping Test: Inspected By: \_\_\_\_\_ Date: \_\_\_\_\_

Received By: ck#4687 rec#841246 MoC

Secondary Containment & Sump Testing:

Inspected By: \_\_\_\_\_ Date: \_\_\_\_\_

Final: Inspected By: \_\_\_\_\_ Date: \_\_\_\_\_

*Before Covering Tanks, Above Certification Must Be Signed When Ready For Inspection Notify Fire Prevention Bureau 238-3851*

**THIS PERMIT MUST BE LEFT ON THE WORK SITE AS AUTHORITY THEREFORE**

FROM EMERGENCY\_SERVICES 5102387761 8-06-2002 8:40AM

**OAKLAND FIRE DEPARTMENT, OES  
UNDERGROUND STORAGE TANK CLOSURE/REMOVAL FIELD INSPECTION REPORT**

Site Address: <u>901 77th Ave</u>	Name of Facility: <u>Thomas Auto Repair</u>
Inspector: <u>J. Markham</u>	Contact on site: <u>Nathan Garfield</u>
Date and Time of Arrival: <u>11:00 25 Jul 02</u>	Contractor/Consultant: <u>AEI Consultants</u> <u>925 283-6000</u>

General Requirements	Yes	No	N/A
Approved closure plan on site.	✓		
Changes to approved plan noted.			✓
Residuals properly stored/transported.	✓		
Receipt for adequate dry ice noted.	✓		

General Requirements	Yes	No	N/A
Site Safety Plan properly signed.	✓		
40B:C fire extinguisher on site.	✓		
"No Smoking" signs posted.	✓		
Gas detector challenged by inspector.	✓		

Tank Observations	T #1	T #2	T #3	T #4
Tank Capacity (gallons)	1500			
Material last stored	Fuel			
Dry ice used (pounds)	150			
Combustible gas concentration as %LEL. (Note time & sampling point)				
(1)	2			
(2)				
(3)				
Oxygen concentration as % volume. (Note time & sampling point)				
(1)	4			
(2)				
(3)				
Tank Material				
Wrapping/Coating, if any				
Obvious holes?				

Tank Observations	T #1	T #2	T #3	T #4
Obvious corrosion?	No			
Obvious odors from tank?	No			
Seams intact?	Yes			
Tank bed backfill material	Yes			
Obvious discoloration?	Yes			
Obvious odors ex-tank bed?	Yes			
Water in excavation?	No			
Sheen/product on water?	N/A			
Tank tagged by transporter?	Yes			
Tank wrapped for transport?	No			
Tank plugged w/ vent cap?	Yes			
Date/time tank hauled off?	11:50	25 Jul 02		
No. of soil samples taken?	2			
Depth of soil samples ( ft. bgs)	8			

Piping Removal	Yes	No	N/A
All piping removed hauled off w/ tanks?	✓		
Obvious holes on pipes?		✓	
Obvious odors from pipes?		✓	✓
Obvious soil discoloration in piping trench?			✓
Obvious odors from piping trench?			✓
Water in piping trench?			✓
Number & depth of soil samples from piping trench?		0	
Number & depth of water samples from piping trench?		0	

General Observations	Yes	No	N/A
Leak from any tank suspected?	✓		
"Leak Report" form given to the operator?		✓	
Obviously contaminated soil excavated?	✓		
Soil stockpile sampled?	✓		4 point
Stockpile lined AND covered?			com. p. 25
Water in excavation sampled?			
Number/depth of water samples taken?		0	
All samples properly preserved for transport?	✓		

Additional Observations	Yes	No	N/A
Soil/water sampling protocols acceptable?	✓		
Sampling "chain of custody" noted?	✓		
Tank pit filled in or covered?	✓		
Tank pit fenced or barricaded?		✓	
Transporter a registered HW hauler?	✓		
Uniform HW Manifest completed?	✓		
Contractor/Consultant reminded of complete UST Removal Report due within 30 days?	✓		
Date/Time removal/closure operations completed?	25 Jul 02 11:50		
OT hours or additional charges due from contractor?		NA	

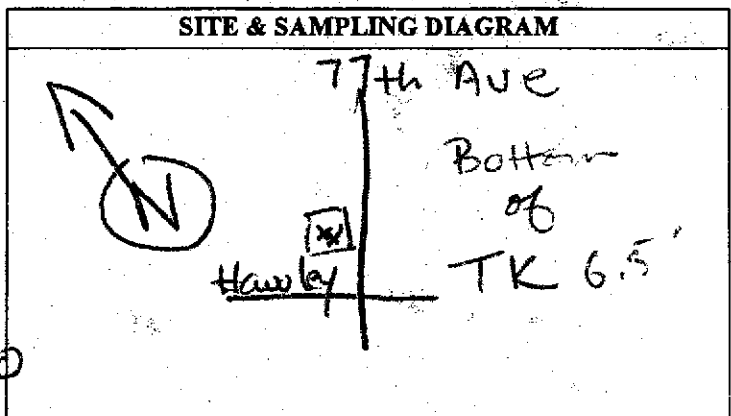

**Notes/Comments:** From 2176140 UST - ECLB; 14; 85 Gallon Water/Fuel  
MIXTURE; Tank pit lined and covered w/ clean 1/2" soil  
after placement of overburden back in pit  
Soil samples taken just above  
water line



# EXCAVATION PERMIT

TO EXCAVATE IN STREETS OR OTHER SPECIFIED WORK

CIVIL ENGINEERING

PAGE 2 of 2

PERMIT NUMBER <b>X0200680</b>		SITE ADDRESS/LOCATION <b>901 77<sup>th</sup> Ave</b>
APPROX. START DATE <b>7/17</b>	APPROX. END DATE <b>7/20</b>	24-HOUR EMERGENCY PHONE NUMBER (Permit not valid without 24-Hour number) <b>925-283-6000</b>
CONTRACTOR'S LICENSE # AND CLASS <b>654919 A/H4Z</b>		CITY BUSINESS TAX # <b>567167</b>

**ATTENTION:**

- 1- State law requires that the contractor/owner call Underground Service Alert (USA) two working days before excavating. This permit is not valid unless applicant has secured an inquiry identification number issued by USA. The USA telephone number is 1-800-642-2444. Underground Service Alert (USA) # **300330**
- 2- 48 hours prior to starting work, you **MUST CALL** (510) 238-3651 to schedule an inspection.
- 3- 48 hours prior to re-paving, a compaction certificate is required (waived for approved slurry backfill).

**OWNER/BUILDER**

I hereby affirm that I am exempt from the Contractor's License Law for the following reason (Sec. 7031.5 Business and Professions Code: Any city or county which requires a permit to construct, alter, improve, demolish, or repair any structure, prior to its issuance, also requires the applicant for such permit to file a signed statement that he is licensed pursuant to the provisions of the Contractor's License law Chapter 9 (commencing with Sec. 7000) of Division 3 of the Business and Professions Code, or that he is exempt therefrom and the basis for the alleged exemption. Any violation of Section 7031.5 by any applicant for a permit subjects the applicant to a civil penalty of not more than \$500):

I, as an owner of the property, or my employees with wages as their sole compensation, will do the work, and the structure is not intended or offered for sale (Sec. 7044, Business Professions Code: The Contractor's License Law does not apply to an owner of property who builds or improves thereon, and who does such work himself or through his own employees, provided that such improvements are not intended or offered for sale. If however, the building or improvement is sold within one year of completion, the owner-builder will have the burden of proving that he did not build or improve for the purpose of sale).

I, as owner of the property, am exempt from the sale requirements of the above due to: (1) I am improving my principal place of residence or appurtenances thereto, (2) the work will be performed prior to sale, (3) I have resided in the residence for the 12 months prior to completion of the work, and (4) I have not claimed exemption on this subdivision on more than two structures more than once during any three-year period. (Sec. 7044 Business and Professions Code).

I, as owner of the property, am exclusively contracting with licensed contractors to construct the project, (Sec. 7044, Business and Professions Code: The Contractor's License Law does not apply to an owner of property who builds or improves thereon, and who contracts for such projects with a contractor(s) licensed pursuant to the Contractor's License law).

I am exempt under Sec. \_\_\_\_\_, B&PC for this reason \_\_\_\_\_

**WORKER'S COMPENSATION**



I hereby affirm that I have a certificate of consent to self-insure, or a certificate of Worker's Compensation Insurance, or a certified copy thereof (Sec. 3700, Labor Code).

Policy # **1492513-98** Company Name **Phoenix Assurance**

I certify that in the performance of the work for which this permit is issued, I shall not employ any person in any manner so as to become subject to the Worker's Compensation Laws of California (not required for work valued at one hundred dollars (\$100) or less).

**NOTICE TO APPLICANT:** If, after making this Certificate of Exemption, you should become subject to the Worker's Compensation provisions of the Labor Code, you must forthwith comply with such provisions or this permit shall be deemed revoked. This permit is issued pursuant to all provisions of Title 12 Chapter 12.12 of the Oakland Municipal Code. It is granted upon the express condition that the permittee shall be responsible for all claims and liabilities arising out of work performed under the permit or arising out of permittee's failure to perform the obligations with respect to street maintenance. The permittee shall, and by acceptance of the permit agrees to defend, indemnify, save and hold harmless the City, its officers and employees, from and against any and all suits, claims, or actions brought by any person for or on account of any bodily injuries, disease or illness or damage to persons and/or property sustained or arising in the construction of the work performed under the permit or in consequence of permittee's failure to perform the obligations with respect to street maintenance. This permit is void 90 days from the date of issuance unless an extension is granted by the Director of the Office of Planning and Building.

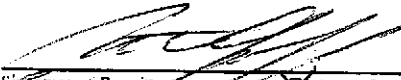
I hereby affirm that I am licensed under provisions of Chapter 9 of Division 3 of the Business and Professions Code and my license is in full force and effect (if contractor), that I have read this permit and agree to its requirements, and that the above information is true and correct under penalty of law.

Signature of Permittee 		Agent for <input checked="" type="checkbox"/> Contractor <input type="checkbox"/> Owner		Date <b>7/8/02</b>
VTE STREET LAST <b>RESURFACED 1/96</b>	SPECIAL PAVING DETAIL REQUIRED? <input checked="" type="checkbox"/> YES <input type="checkbox"/> NO	HOLIDAY RESTRICTION? (NOV 1 - JAN 1) <input type="checkbox"/> YES <input checked="" type="checkbox"/> NO	LIMITED OPERATION AREA? (7AM-9AM & 4PM-6PM) <input type="checkbox"/> YES <input checked="" type="checkbox"/> NO	
ISSUED BY 		DATE ISSUED <b>4</b>		



**BAY AREA AIR QUALITY MANAGEMENT DISTRICT**

939 ELLIS STREET  
SAN FRANCISCO, CALIFORNIA 94109  
(415) 771-6000

**REGULATION 8, RULE 40 NOTIFICATION FORM**

- Check  Removal or Replacement of Tanks  
 Excavation of Contaminated Soil

**SEEK INFORMATION**

Site Address 901 77<sup>th</sup> Avenue

City, State Oakland, CA

Zip 94621

Owner Name D & D Ventures

Specific location of project north west corner of property

Tank Removal

Scheduled startup date 7/25/02

Vapors removed by:

- Water wash  
 Vapor freeing (CO<sup>2</sup>)  
 Ventilation

Indicate below if an A/C was obtained for tank replacement:

Yes \_\_\_\_\_ No X If yes, A/C or P/O # \_\_\_\_\_

Contaminated Soil Excavation

Scheduled Startup Date \_\_\_\_\_

Stockpiles will be covered? Yes \_\_\_\_\_ No \_\_\_\_\_

Indicate below the method used to comply with Regulation 8, Rule 40, Section 402.4:

Check () 8-40-301  8-40-302  (permit required)

A/C or P/O # \_\_\_\_\_

A/C = Authority to Construct P/O = Permit to Operate

What other public agency have you notified (e.g., Fire District, Hazardous Materials Department, City or County)?

Agency Oakland Fire Contact Leroy Griffin Phone # (510) 238-7759

**CONTRACTOR INFORMATION**

Name AEI Consultants

Contact \_\_\_\_\_

Address 3210 Old Tunnel Road, Suite B

Phone (925) 283-6000

City, State, Zip Lafayette, CA 94549

**CONSULTANT INFORMATION (if applicable)**

Name same as contractor

Contact \_\_\_\_\_

Address \_\_\_\_\_

Phone ( ) \_\_\_\_\_

City, State, Zip \_\_\_\_\_

**FOR OFFICE USE ONLY**

Date Received Fax: \_\_\_\_\_

Date Postmarked: \_\_\_\_\_

Inspector No.: \_\_\_\_\_

Date: \_\_\_\_\_

By \_\_\_\_\_

Update: Contact Name \_\_\_\_\_

Date: \_\_\_\_\_

By \_\_\_\_\_

Update: Contact Name \_\_\_\_\_

Date: \_\_\_\_\_

By \_\_\_\_\_

# ACTIVITY NOTIFICATION FORM

## Buildings Structures Scaffolding Falsework Demolition Trenches/Excavations

Company Name: All Environmental Inc. Field Phone: (925) 283-6000  
Annual Permit Number: 99-900632 Office Phone: (925) 283-6000  
Specific Activity Location: 901 77<sup>th</sup> Avenue Number of Employees: 3  
Nearest Major Cross Street: Hawley Starting Date: 7/25/02  
City: Oakland Anticipated Completion Date: 7/25/02  
County: Alameda High Voltage Lines in Proximity? No  Yes

**INSTRUCTIONS:** The appropriate item(s) must be completed and signed by a person knowledgeable about the project for each activity covered by a permit. Please fill in or check off the blanks where appropriate.

**Construction:** Building  Structure  Type: Steel Frame  Tiered  Concrete   
Tilt-up  Wood Frame  Liftslab  Precast  Slip Form  Depth  No. of Stories   
Description: \_\_\_\_\_

(See 8 CCR 1709-30: Appendix A Plate A-2a & b)

**Scaffolding:** Height  Metal  Wood  Wood over 60 Feet  Metal over 125 Feet

Metal > 125 Feet or Wood > 60 Feet requires design by California Registered Civil Engineer & Plans at Site. (See 8 CCR 1644(c)(7))

Description: \_\_\_\_\_

**Falsework/Vertical Shoring:** Maximum Height \_\_\_\_\_ Maximum Span \_\_\_\_\_ Material \_\_\_\_\_

Description: \_\_\_\_\_

(See 8 CCR 1717)

**Demolition Of:** Building  Structure  Height \_\_\_\_\_ No. of Stories \_\_\_\_\_ Type: Steel Frame

Wood Frame  Concrete  Demolition Ball  Clam  Explosives

Loader/Tractors  Other

(See 8 CCR 1734 - 37)

**Trenches/Excavations:** Depth Range (Min/Max) \* 5/9 Width Range (Min/Max) 15-20 Total Length 12

Ground Protection Method: Shoring  Sloping  Trench Shield  Professional Engineer

Underground Services Alert (USA) Number 300530 (NORTH 1-800-642-2444/SOUTH 1-800-422-4133)

Soil Analysis to be done? Yes  No  If No, You Must Slope 1.5 to 1.

Description: removal of 1,000-gallon gasoline UST  
analyzed for TPH-g, Lead, BTEX, MTBE

\* Ground protection methods for excavations deeper than 20 feet must be designed by a Registered Professional Engineer. See 8 CCR 1541.1, Appendix F.



**APPENDIX B**

**SITE HEALTH & SAFETY PLAN**

**HEALTH AND SAFETY PLAN**

Prepared for:

UST Removal  
at  
901 77th Avenue  
Oakland, California



## D. HAZARD EVALUATION

Potential chemical hazards include skin and eye contact or inhalation exposure to potentially toxic concentrations of hydrocarbon vapors. The potential toxic compounds that may exist at the site are listed below with descriptions of specific health effects of each. The list includes the primary potential toxic constituents that may be found at sites which previously handled petroleum hydrocarbons, including home heating diesel fuel.

### 1. Benzene

- a. Colorless to light yellow, flammable liquid with an aromatic odor.
- b. Toxic hazard by **inhalation, adsorption, ingestion and skin and/or eye contact.**
- c. Exposure may irritate eyes, nose and respiratory system and may cause acute restlessness, convulsions, nausea, or depression. Benzene is carcinogenic.\*
- d. Permissible exposure level (PEL) for a time weighted average (TWA) over an eight hour period is 1.0 ppm.

### 2. Toluene

- a. Colorless liquid with a sweet, pungent, benzene like odor.
- b. Toxic hazard by **inhalation, adsorption, ingestion and skin and/or eye contact.**
- c. Exposure may cause fatigue, weakness, confusion, euphoria, dizziness, headaches, dilated pupils, lacrimation, nervousness, insomnia, paresthesia, and dermatitis.
- d. Permissible exposure level for a time weighted average over an eight hour period is 100 ppm.

### 3. Xylene

- a. Colorless liquid with an aromatic odor.
- b. Toxic hazard by **inhalation, adsorption, ingestion and skin and/or eye contact.**
- c. Exposure may irritate eyes nose and throat and may cause dizziness, excitement, drowsiness, incoordination, corneal vacuolization, anorexia, nausea, vomiting, and dermatitis.
- d. Permissible exposure level for a time weighted average over an eight hour period is 100 ppm.

### 4. Ethylbenzene

- a. Colorless liquid with an aromatic odor.
- b. Toxic hazard by **inhalation, ingestion, and skin and/or eye contact.**  
Ethylbenzene is carcinogenic.\*
- c. Exposure may irritate eyes and mucous membrane and may cause headaches, dermatitis, narcosis and loss of consciousness.
- d. Permissible exposure level for a time weighted average over an eight hour period is 100 ppm.

\* **Known to the State of California to cause cancer.**

5. Lead

- a. A heavy ductile soft grey metal.
- b. Toxic hazard by **inhalation, ingestion, and skin and/or eye contact**.
- c. Exposure may cause weakness, nausea, lassitude, diarrhea, insomnia, anorexia, inflamed mucous membranes and abdominal pains. Lead is carcinogenic.\*
- d. Permissible exposure level for a time weighted average over an eight hour period is .05 ppb (in vapor).

6. Diesel

- a. Colorless to dark brown, combustible liquid with an aromatic odor
- b. Toxic hazard by **inhalation, ingestion, skin and/or eye contact**.
- c. Inhalation of vapors may depress the central nervous system, increasing reaction times, and decreasing pulse rate and blood pressure. Skin irritant.
- d. Occupational exposure limit 5.0 ppm (in vapor).

7. Gasoline

- a. Colorless liquid with a strong aromatic odor. Highly volatile and extremely flammable.
- b. Toxic hazard by **inhalation, adsorption, ingestion and skin and/or eye contact**.
- c. Inhalation of vapors can cause depression of the central nervous system with symptoms such as headache, dizziness, nausea and loss of coordination. Skin contact can cause defatting of the skin, skin irritation and dermatitis. Benzene is a major constituent of gasoline.
- d. Permissible exposure level for a time weighted average over an eight hour period is 300 ppm.

8. Waste Oil

- a. Toxic hazard by **ingestion** and possibly **inhalation**.
- b. Prolonged contact may cause skin irritation and dermatitis. Waste oil may be carcinogenic.\*
- c. Waste oil may contain metals or toxic organics from thermal breakdown of the oil. In some cases, chlorinated solvents may be present.
- d. Permissible exposure level for a time weighted average over an eight hour period is 5 ppm (in vapor).

\* **Known to the State of California to cause cancer.**

Dusty Roy has been designated to coordinate access control and security on site. All work will strictly follow OSHA guidelines. A safe perimeter has been established at a three foot radius surrounding the site. These boundaries are identified by yellow caution tape and orange safety cones. Personnel shall maintain the maximum distance from the pit while performing their duties. No one shall enter an excavation pit that is greater than five feet in depth unless the excavation is shored or sloped and no one shall climb on the stockpiled material except to cover it with plastic. Additional hazards on site include heavy equipment and overhead lifting equipment. Heavy equipment used for performing the tank removal project may include a backhoe, an excavator, or a crane for lifting the tank out of the excavation. Only 40 hour trained personnel will operate equipment or perform any duty associated with this project. A hard hat and steel toed boots are mandatory for all personnel associated with the tank removal.

A FIRST AID KIT AND A 40 POUND BC FIRE EXTINGUISHER WILL BE AVAILABLE ON SITE.

EMERGENCY SERVICES ARE AVAILABLE BY DIALING 911 ON THE TELEPHONE LOCATED IN THE SITE MANAGER'S VEHICLE. THIS VEHICLE WILL BE ON SITE AT ALL TIMES.

#### E. PERSONAL PROTECTIVE CLOTHING

Based on evaluation of potential hazards, level "D" protective clothing has been designated as the appropriate protection for this project. The level of protective clothing will be upgraded if the organic vapor levels in the operator's breathing zone exceeds 5 ppm above background levels continuously for more than five minutes, or if any single reading exceeds 25 ppm. If this occurs then level C protection will be used. If the organic concentration in the operator's breathing zone exceed's 200 ppm for 5 minutes and/or the organic vapor concentration two feet above the excavation exceeds 1,000 ppm or 10% of the lower explosive limit, then the equipment will be shut down and the site evacuated. If organic vapor concentrations exceed 200 ppm and work continues then level B protection will be required.

"EPA Standard Operating Safety Guidelines" defines the levels of protective clothing as follows:

##### LEVEL A:

Fully encapsulating suit / SCBA / Hard hat / Steel toe boots / Safety gloves.

##### LEVEL B:

Splash resistant suit / SCBA / Hard Hat / Steel toe boots / Safety gloves.

##### LEVEL C:

Half face respirator / Hard hat / Safety glasses / Steel toe boots / Coveralls / Gloves.

##### LEVEL D:

Coveralls / Hardhat / Safety Glasses / Steel toe boots / Gloves.

If air purifying respirators are authorized, organic vapor w-filter is the appropriate canister for use with the involved substances and concentrations. A competent individual has determined that all criteria for using this type of respiratory protection have been met.

NO CHANGES TO THE SPECIFIED LEVELS OF PROTECTION SHALL BE MADE WITHOUT THE APPROVAL OF THE COMPANY SAFETY OFFICER, JOHN ORMEROD.

F. MONITORING INSTRUMENTS

The following environmental monitoring instruments shall be used on site at specified intervals.

Lower Explosive Limit (LEL) Meter that will also check the tank for Oxygen levels will be used to check the tank for removal and transportation.

G. EMERGENCY HOSPITAL

The closest hospital with an emergency room is:

<b>Alameda County Medical Center- Highland Campus</b>	<b>(510) 437-4701</b>
<b>Emergency</b>	<b>911</b>

DIRECTIONS FROM THE JOB SITE:

EXIT JOBSITE AND GO:

RIGHT (NORTH) ON HAWLEY ST.  
CONTINUE ONTO HEGENBERGER ROAD  
CONTINUE ONTO 73RD AVENUE  
TURN LEFT (NORTH) ON BANCROFT  
TURN RIGHT (NORTH) ON CAMDEN  
CONTINUE ON MACARTHUR BLVD  
TURN LEFT ONTO I-580 WEST  
EXIT 14<sup>TH</sup> AVENUE  
TURN LEFT ON 14<sup>th</sup>  
TURN RIGHT ON E 31<sup>st</sup>  
HOSPITAL IS ON LEFT AT 1411 E 31<sup>st</sup> STREET

**APPENDIX C**

**TRANSPORT AND DISPOSAL DOCUMENTS**



**UNIFORM HAZARDOUS WASTE MANIFEST**

1. Generator's US EPA ID No. CA0000553792000021 Manifest Document No. 1 of 1 2. Page 1  
 Information in the shaded areas is not required by Federal law.

3. Generator's Name and Mailing Address 13700 Via del Mar Blvd, Bldg 100, Duventures, Los Gatos, Ca. 95030 A. State Manifest Document Number **21183385**

4. Generator's Phone 408 354-9777 B. State Generator's ID

5. Transporter 1 Company Name Excel Environmental Serv 6. US EPA ID Number CA000009350 C. State Transporter's ID [Reserved.]

7. Transporter 2 Company Name D. Transporter's Phone

9. Designated Facility Name and Site Address Rurbank Oil Transfer 700 Alameda St. Rurbank Ca. 95367 10. US EPA ID Number CA0000190716 G. State Facility's ID 0092637121

11. US DOT Description (including Proper Shipping Name, Hazard Class, and ID Number)

11. US DOT Description	12. Containers		13. Total Quantity	14. Unit Wt/Val	15. Waste Number
	No.	Type			
a. <u>Non-Hazardous waste liquid used oil/water</u>	<u>001</u>	<u>TT</u>	<u>00085</u>	<u>G</u>	State <u>001</u> EPA/Other <u>None</u>
b.					State EPA/Other
c.					State EPA/Other
d.					State EPA/Other

J. Additional Descriptions for Materials Listed Above K. Handling Codes for Wastes Listed Above

15. Special Handling Instructions and Additional Information  
Emergency Phone 700 376-6008 Gloves

16. GENERATOR'S CERTIFICATION: I hereby declare that the contents of this consignment are fully and accurately described above by proper shipping name and are classified, packed, marked, and labeled, and are in all respects in proper condition for transport by highway according to applicable international and national government regulations.

If I am a large quantity generator, I certify that I have a program in place to reduce the volume and toxicity of waste generated to the degree I have determined to be economically practicable and that I have selected the practicable method of treatment, storage, or disposal currently available to me which minimizes the present and future threat to human health and the environment; OR, if I am a small quantity generator, I have made a good faith effort to minimize my waste generation and select the best waste management method that is available to me and that I can afford.

Printed/Typed Name Dusty Row Signature [Signature] Month 07 Day 05 Year 00

17. Transporter 1 Acknowledgement of Receipt of Materials  
 Printed/Typed Name Car Mazzoni Signature [Signature] Month 07 Day 05 Year 00

18. Transporter 2 Acknowledgement of Receipt of Materials  
 Printed/Typed Name Signature Month Day Year

19. Discrepancy Indication Space

20. Facility Owner or Operator Certification of receipt of hazardous materials covered by this manifest except as noted in Item 19.  
 Printed/Typed Name Signature Month Day Year

DO NOT WRITE BELOW THIS LINE.

IN CASE OF EMERGENCY OR SPILL, CALL THE NATIONAL RESPONSE CENTER 1-800-424-8802; WITHIN CALIFORNIA, CALL 1-800-852-7550

GENERATOR

TRANSPORTER

FACILITY

IN CASE OF EMERGENCY OR SPILL, CALL THE NATIONAL RESPONSE CENTER 1-800-424-8802. WITHIN CALIFORNIA, CALL 1-800-852-7550  
 GENERATOR FACILITY

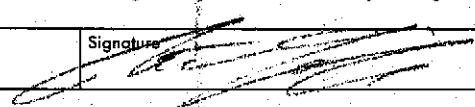
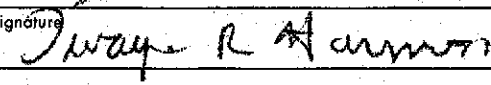
<b>UNIFORM HAZARDOUS WASTE MANIFEST</b>		1. Generator's US EPA ID No. <b>CAC00255379296448</b>		Manifest Document No.		2. Page 1 of 1		Information in the shaded areas is not required by Federal law.				
3. Generator's Name and Mailing Address <b>DEVELOPMENT 15700 WINGHESTER DRVP LOS GATOS, CA 95030</b>						A. State Manifest Document Number <b>21996448</b>						
4. Generator's Phone <b>(408) 354-9777</b>						B. State Generator's ID						
5. Transporter 1 Company Name <b>Ecology Control Industries</b>			6. US EPA ID Number <b>CAD982030173</b>			C. State Transporter's ID [Reserved]						
7. Transporter 2 Company Name						D. Transporter's Phone <b>510-235-1393</b>						
8. US EPA ID Number						E. State Transporter's ID [Reserved]						
9. Designated Facility Name and Site Address <b>ECOLOGY CONTROL INDUSTRIES 255 PARR BLVD. RICHMOND CA 94801</b>						F. Transporter's Phone						
10. US EPA ID Number <b>CAD009466392</b>						G. State Facility's ID						
11. US DOT Description (including Proper Shipping Name, Hazard Class, and ID Number) <b>NON RCRA HAZARDOUS WASTE SOLID (EMPTY STORAGE TANK)</b>						12. Containers No. Type <b>001 TP 01000</b>		13. Total Quantity <b>P</b>		14. Unit Wt/Vol.		
b.										Waste Number		
c.												
d.												
15. Special Handling Instructions and Additional Information <b>Wear proper protective equipment while handling. Weights or volumes are approximate. 24 hour emergency number: 24 hour emergency contact: 700 376 6009</b>						K. Facility's Phone <b>510-235-1393</b>						
16. GENERATOR'S CERTIFICATION: I hereby declare that the contents of this consignment are fully and accurately described above by proper shipping name and are classified, packed, marked, and labeled, and are in all respects in proper condition for transport by highway according to applicable international and national government regulations.  If I am a large quantity generator, I certify that I have a program in place to reduce the volume and toxicity of waste generated to the degree I have determined to be economically practicable and that I have selected the practicable method of treatment, storage, or disposal currently available to me which minimizes the present and future threat to human health and the environment; OR, if I am a small quantity generator, I have made a good faith effort to minimize my waste generation and select the best waste management method that is available to me and that I can afford.												
Printed/Typed Name <b>Mathew Garfield</b>				Signature 				Month <b>07</b>	Day <b>23</b>	Year <b>1998</b>		
17. Transporter 1 Acknowledgement of Receipt of Materials						Printed/Typed Name <b>DWAYNE R HARMON</b>		Signature 		Month <b>07</b>	Day <b>25</b>	Year <b>1998</b>
18. Transporter 2 Acknowledgement of Receipt of Materials						Printed/Typed Name		Signature		Month	Day	Year
19. Discrepancy Indication Space												
20. Facility Owner or Operator Certification of receipt of hazardous materials covered by this manifest except as noted in Item 19.						Printed/Typed Name		Signature		Month	Day	Year

DO NOT WRITE BELOW THIS LINE.

**APPENDIX D**

**ANALYTICAL DOCUMENTATION**

McCampbell Analytical Inc.			110 2nd Avenue South, #D7, Pacheco, CA 94553-5560 Telephone : 925-798-1620 Fax : 925-798-1622 http://www.mccampbell.com E-mail: main@mccampbell.com							
All Environmental, Inc. 3210 Old Tunnel Rd., Ste. B Lafayette, CA 94549-4157			Client Project ID: #5388; D&D				Date Sampled: 07/25/02			
							Date Received: 07/25/02			
			Client Contact: Nathan				Date Extracted: 07/25/02			
			Client P.O.:				Date Analyzed: 07/27/02			
<b>Gasoline Range (C6-C12) Volatile Hydrocarbons as Gasoline with BTEX and MTBE*</b>										
Extraction method: SW5030B			Analytical methods: SW8021B/8015Cm					Work Order: 0207373		
Lab ID	Client ID	Matrix	TPH(g)	MTBE	Benzene	Toluene	Ethylbenzene	Xylenes	DF	% SS
001A	EB-W-8'	S	4600,b,m	ND<25	4.5	23	63	180	500	---#
002A	STUP1-4	S	40,b,m	ND	0.026	0.022	0.012	0.022	1	---#
003A	EB-E-8'	S	310,b,m	ND<2.5	ND<0.2	0.29	8.9	7.2	50	116
Reporting Limit for DF =1; ND means not detected at or above the reporting limit			W S	50 1.0	5.0 0.05	0.5 0.005	0.5 0.005	0.5 0.005	0.5 0.005	ug/L mg/Kg
*water and vapor samples are reported in ug/L, soil and sludge samples in mg/kg, wipe samples in ug/wipe, and TCLP extracts in ug/l.										
# cluttered chromatogram; sample peak coelutes with surrogate peak.										
+The following descriptions of the TPH chromatogram are cursory in nature and McCampbell Analytical is not responsible for their interpretation: a) unmodified or weakly modified gasoline is significant; b) heavier gasoline range compounds are significant(aged gasoline?); c) lighter gasoline range compounds (the most mobile fraction) are significant; d) gasoline range compounds having broad chromatographic peaks are significant; biologically altered gasoline?; e) TPH pattern that does not appear to be derived from gasoline (stoddard solvent); f) one to a few isolated non-target peaks present; g) strongly aged gasoline or diesel range compounds are significant; h) lighter than water immiscible sheen/product is present; i) liquid sample that contains greater than ~2 vol. % sediment; j) reporting limit raised due to high MTBE content; k) TPH pattern that does not appear to be derived from gasoline (aviation gas). m) no recognizable pattern.										

DHS Certification No. 1644

Edward Hamilton, Lab Director

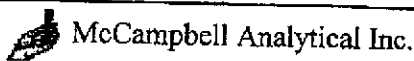

110 2nd Avenue South, #D7, Pacheco, CA 94533-5560  
 Telephone : 925-798-1620 Fax : 925-798-1622  
 http://www.mccampbell.com E-mail: main@mccampbell.com

All Environmental, Inc.  
 3210 Old Tunnel Rd., Ste. B  
 Lafayette, CA 94549-4157

Client Project ID: #5388; D&D

Date Sampled: 07/25/02

Date Received: 07/25/02

Client Contact: Nathan

Date Extracted: 07/25/02

Client P.O.:

Date Analyzed: 07/26/02

**Lead by ICP\***

Extraction method: SW3050B

Analytical methods: 6010C

Work Order: 0207373

Lab ID	Client ID	Matrix	Extraction	Lead	DF	% SS
0207373-001A	EB-W-8'	S	TTLIC	16	1	116
0207373-002A	STUPI-4	S	TTLIC	12	1	117
0207373-003A	EB-E-8'	S	TTLIC	9.1	1	118

Reporting Limit for DF =1; ND means not detected at or above the reporting limit	W S	TTLIC TTLIC	NA 3.0	mg/L mg/Kg
--	--------	----------------	-----------	---------------

\* water samples are reported in mg/L, soil/sludge/solid/product samples in mg/kg, wipes in ug/wipe and all TCLP / STLC / DISTLC / SPLP extracts in mg/L.

ND means not detected above the reporting limit; N/A means not applicable to this sample or instrument.

Analytical Methods: EPA 6010C/200.7 for all elements except: 200.9 (water- Sb, As, Pb, Se, Tl); 245.1 (Hg); 7010 (sludge/soil/solid/oil/product/wipes - As, Se, Tl); 7471B (Hg).

DISTLC extractions are performed using STLC methodology except that deionized water is substituted for citric acid buffer as the extraction fluid. DISTLC results are not applicable to STLC regulatory limits.

i) liquid sample that contains greater than ~2 vol. % sediment; this sediment is extracted with the liquid, in accordance with EPA methodologies and can significantly effect reported metal concentrations; z) reporting limit raised due to matrix interference.

DHS Certification No. 1644

 Edward Hamilton, Lab Director

# McCampbell Analytical Inc.

110 Second Avenue South, #D7  
Pacheco, CA 94553-5560  
(925) 798-1620

# CHAIN-OF-CUSTODY RECORD

WorkOrder: 0207373

**Client:**

All Environmental, Inc.  
3210 Old Tunnel Rd., Ste. B  
Lafayette, CA 94549-4157

TEL: (925) 283-6000  
FAX: (925) 283-6121  
ProjectNo: #5388; D&D  
PO:

25-Jul-02

Sample ID	ClientSampID	Matrix	Collection Date	Bottle	Requested Tests	
					6010C	8021B/8015
0207373-001	EB-W-8'	Soil	7/25/02		A	A
0207373-002	STUP1-4	Soil	7/25/02		A	A
0207373-003	EB-E-8'	Soil	7/25/02		A	A

**Comments:**

Date/Time

Date/Time

Relinquished by: \_\_\_\_\_

Received by: \_\_\_\_\_

Relinquished by: \_\_\_\_\_

Received by: \_\_\_\_\_

Relinquished by: \_\_\_\_\_

Received by: \_\_\_\_\_

NOTE: Samples are discarded 60 days after results are reported unless other arrangements are made. Hazardous samples will be returned to client or disposed of at client expense.

Bottle Type: L-Liter V-Voa S-Soil Jar O-Orbo T-Tedlar B-Brass P-Plastic OT-Other



AEI Consultants / All Environmental, Inc.  
3210 Old Tunnel Road, Suite B  
Lafayette, CA 94549  
(925) 283-6000 Fax: (925) 283-6121

CHAIN OF CUSTODY

PAGE 1 OF 1

0201373

TAT: RUSH / 24 hr / 48 hr / 5 day other

Page 2

Aug-1-02 10:48AM;

1 925 798 4612;

Sent By: McCampbell Analytical, Inc.;

AEI PROJECT MANAGER Nathan  
PROJECT NAME D&D  
PROJECT NUMBER 5388  
TOTAL # OF CONTAINERS 6  
CVD. GOOD CONDITION/COLD  Y  N

SAMPLE ID	DATE	TIME	MATRIX	TPH(g), BTEX, MTBE SOIL: EPA 303/8015M, 8020 WATER: EPA 320/8015M, 8020	TPH(g) SOIL: EPA 303/8015M WATER: EPA 303/8015M	BTEX, MTBE SOIL: EPA 8014 WATER: EPA 802	TOTAL OIL & GREASE SOIL: EPA 9131, 9131 STD, 530 D9&F WATER: STD, 530 B&F	VOLATILE HALOCARBONS SOIL: EPA 8010 WATER: EPA 801	VOC'S SOIL: EPA 8140 WATER: EPA 824	SEMI-VOLATILE ORGANICS SOIL: EPA 8210/8150 WATER: EPA 8150/8150	TOTAL LEAD (TLIC) SOIL: 8010 (CP) WATER: DISSOLVED 239.2 (AM)	LUFT 5 METALS SOIL: EPA 7130, 7190, 7490, 7510, 7950 WATER:	HOLD	# OF CONTAINERS
EB-W-8'				✓	✓	✓	✓	✓	✓	✓	✓			1
STUP 1-4				↓	↓	↓								4
EB-E-8'				↓	↓									1

COMMENTS / INSTRUCTIONS

ANALYTICAL LABORATORY McCampbell Analytical, Inc.  
ADDRESS 110 2nd Avenue S, #D7  
Pacheco, CA 94553

PHONE 925/798.1620 FAX 925/798.1622

RELINQUISHED BY <u>Nathan</u> SIGNATURE <u>Nathan</u> PRINTED NAME <u>AEI</u> COMPANY DATE <u>7/25/02</u> TIME <u>5:43</u>	RECEIVED BY <u>Marie Volles</u> SIGNATURE <u>Marie Volles</u> PRINTED NAME <u>M A I</u> COMPANY DATE <u>7/25/02</u> TIME <u>5:51</u>	RELINQUISHED BY SIGNATURE PRINTED NAME COMPANY DATE TIME	RECEIVED BY SIGNATURE PRINTED NAME COMPANY DATE TIME
---	---	---	---

lg. Moller