

Source: Thomas Bros. Maps, Alameda County, 1999

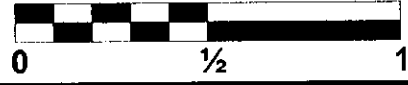

Approximate Scale 1" = 1/2 Mile



## SITE VICINITY MAP



GEO TECHNICAL ENGINEERS AND GEOLOGISTS  
**TERRASEARCH INC.**

11840 DUBLIN BLVD., DUBLIN, CALIFORNIA 94568. (925) 833-9297

CANTERBURY RESIDENTIAL DEVELOPMENT  
 OLYMPIC AVENUE  
 HAYWARD, CALIFORNIA

JOB NUMBER  
 7618.01

DATE  
 3/00

BY  
 CEW

FIGURE

**1**

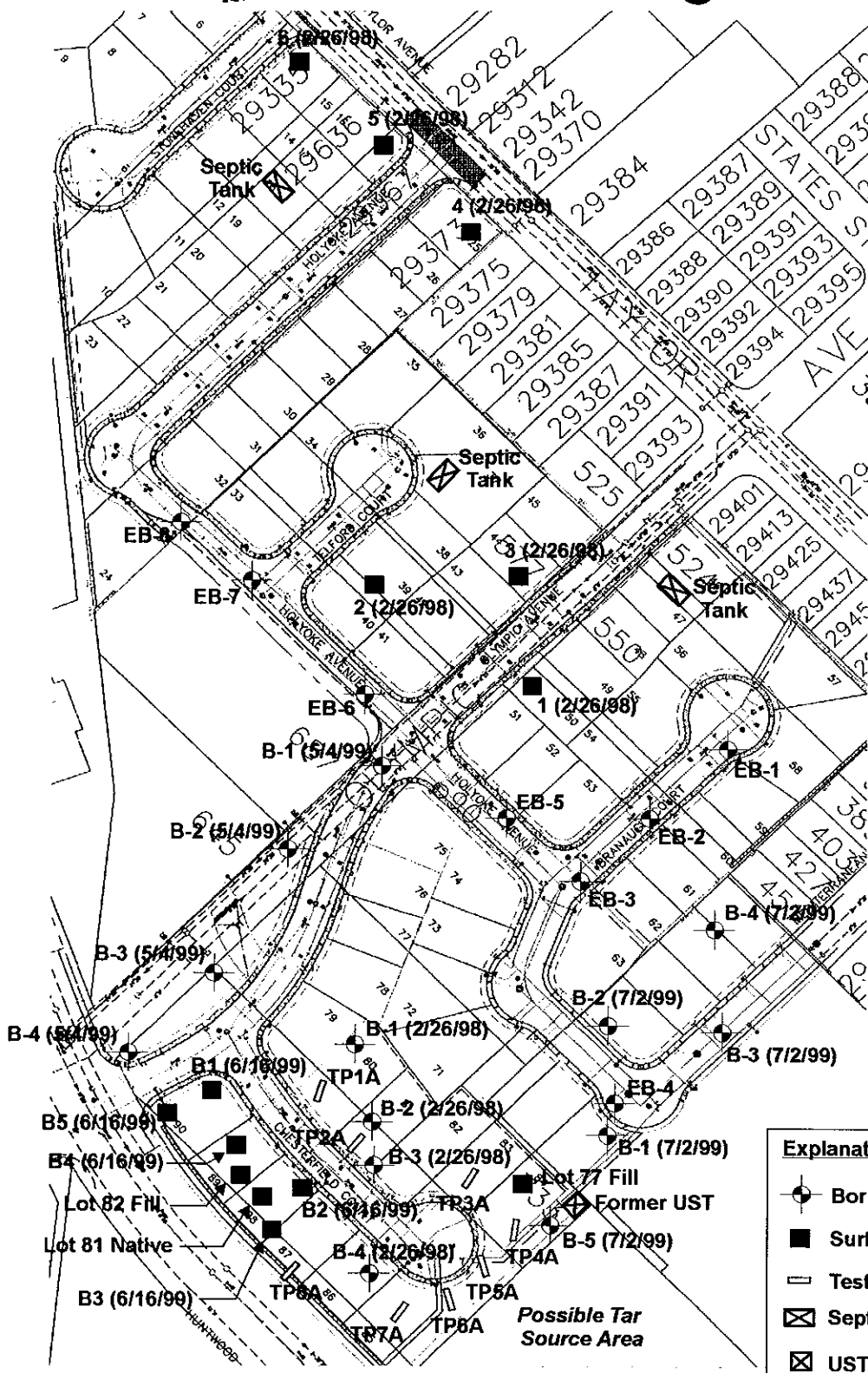

Explanation:	
	Boring
	Surficial sample
	Test pit
	Septic tank
	UST

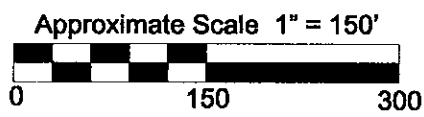

# SITE PLAN

**GEO TECHNICAL ENGINEERS AND GEOLOGISTS**  
**TERRASEARCH inc.**  
11840 DUBLIN BLVD., DUBLIN, CALIFORNIA 94568. (925) 833-9297

ENVIRONMENTAL INVESTIGATIONS CANTERBURY DEVELOPMENT - OLYMPIC AVENUE HAYWARD, CALIFORNIA		
JOB NUMBER	DATE	BY
7618.01	3/00	CEW

FIGURE  
**2**

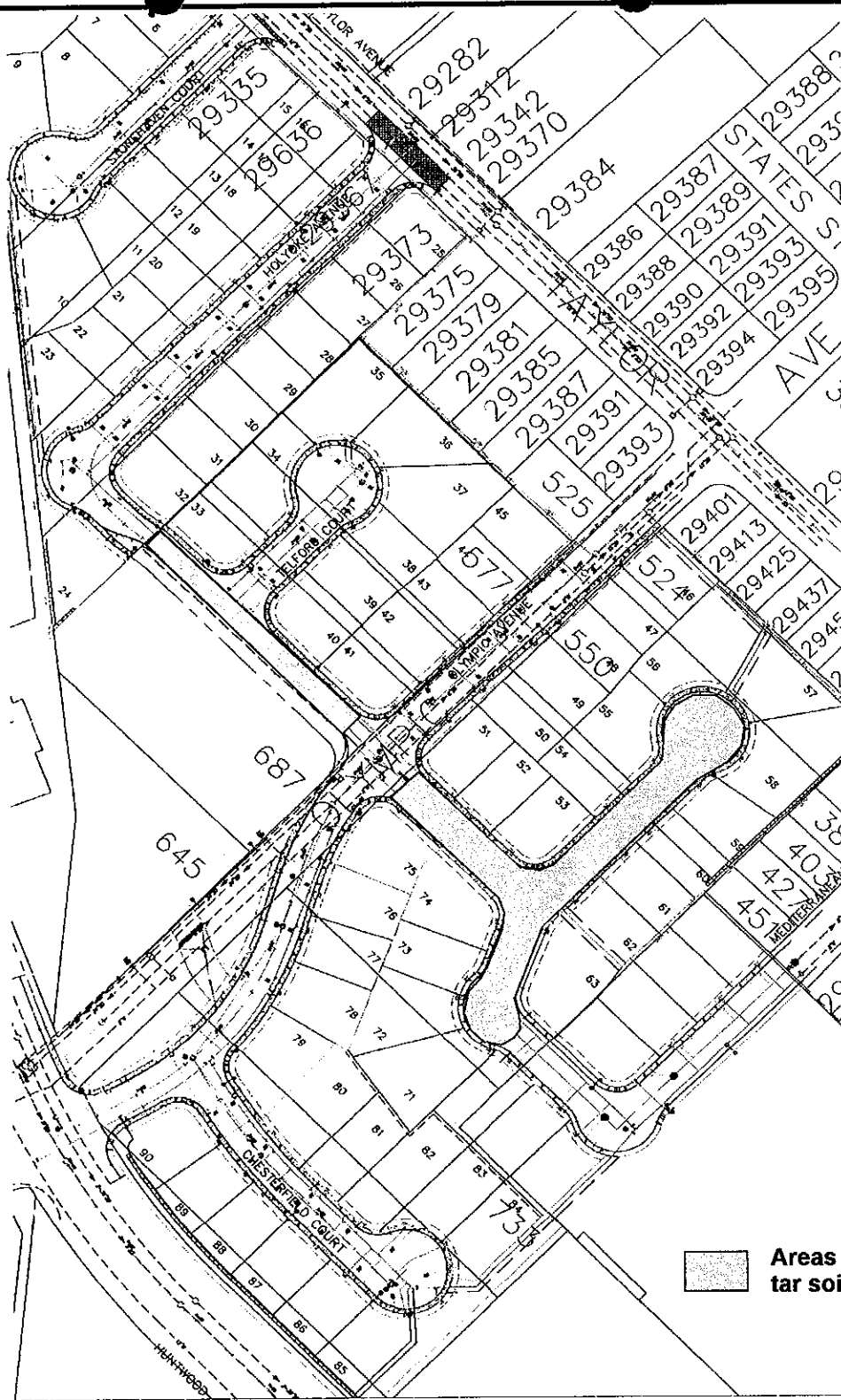

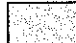
 Areas of encapsulated tar soil.



Approximate Scale 1" = 150'

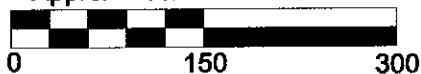

### ENCAPSULATED TAR SOIL AREAS



GEOTECHNICAL ENGINEERS AND GEOLOGISTS

**TERRASEARCH** INC.

11840 DUBLIN BLVD., DUBLIN, CALIFORNIA 94568. (925) 833-9297

ENVIRONMENTAL INVESTIGATIONS  
CANTERBURY DEVELOPMENT - OLYMPIC AVENUE  
HAYWARD, CALIFORNIA

JOB NUMBER  
7618.01

DATE  
3/00

BY  
CEW

FIGURE

**3**