



Fax Transmittal

Mountain View Office
405 Clyde Avenue
Mountain View, CA 94043
Tel: 650.967.2365
Fax: 650.967.2785

Oakland Office
167 Filbert Street
Oakland, CA 94607
Tel: 510.267.1970
Fax: 510.267.1972

Fullerton Office
251 E. Imperial Hwy., #470
Fullerton, CA 92835
Tel: 714.441-3090
Fax: 714.441-3091

San Ramon Office
2258 Camino Ramon
San Ramon, CA 94583
Tel: 925.275.2550
Fax: 925.275.2555

To: Alameda County Dept. of Environmental Health

From: Mark Arniola

Attn: Eva Chu

Date: October 11, 2002

Fax: (510) 337-9335

Pages: 2 (Including Cover)

CC:

Project: 1300 Powell Street

Job #: 1424-9C

Please notify us if you received this fax in error by calling the office indicated above.

Remarks:

Urgent

For your review

Reply ASAP

Please comment

Eva,

The attached figure shows the data from the confirmation samples for the shallow soil excavations at 1300 Powell Street.

Sincerely,

Lowney Associates

Mark Arniola
Senior Project Geologist

Mail copy to follow:

Yes

No

Time Sent: _____

Sent By: _____

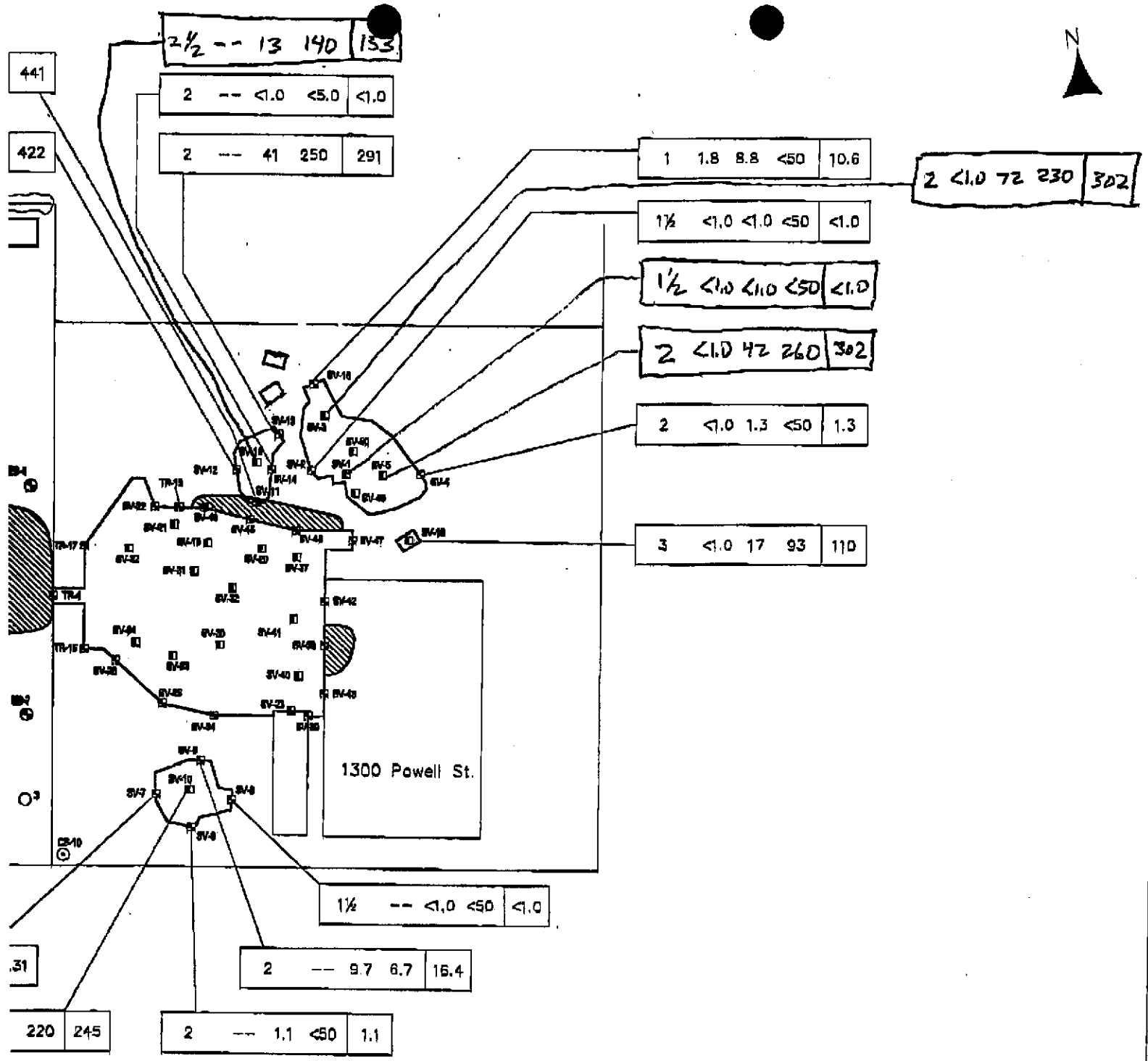

Approximate Scale:
 0 50
 Scale feet

TPHg, TPHd, AND TPHmo
 IN SHALLOW SOIL
 1300 AND 1350 POWELL STREET
 Emeryville, California

LOWNEY ASSOCIATES
 FIGURE 3
 1424-9B

Base by Lush Geosciences, dated 4/95.