



Fax Transmittal

Mountain View Office
405 Clyde Avenue
Mountain View, CA 94043
Tel: 650.967.2365
Fax: 650.967.2785

Oakland Office
167 Filbert Street
Oakland, CA 94607
Tel: 510.267.1970
Fax: 510.267.1972

Fullerton Office
251 E. Imperial Hwy., #470
Fullerton, CA 92835
Tel: 714.441-3090
Fax: 714 441-3091

San Ramon Office
2258 Camino Ramon
San Ramon, CA 94583
Tel: 925.275.2550
Fax: 925.275.2555

To: Alameda County Dept. of Environmental Health
Attn: Eva Chu
Fax : (510) 337-9335
CC: Pulte Home Corporation
Attn: Mike Kim
(925) 485-0391
Cambria Environmental Technology, Inc.
Attn: Robert Schultz
(510) 420-9170

From: Mark Arniola
Date: October 17, 2002
Pages: 5 (Including Cover)
Project: 1300 Powell Street
Job #: 1424-9C

Please notify us if you received this fax in error by calling the office indicated above.

Remarks: Urgent For your review Reply ASAP Please comment

Eva,

A map showing the locations of our test pits north of the excavation and the geoprobe boring locations in the building is attached. Also attached are tables summarizing the analyses from the test pits, borings, and excavation.

Thank you,

Lowney Associates

Mark Arniola
Senior Project Geologist

Mail copy to follow: Yes No Time Sent: _____ Sent By: _____



Scale in Feet
0 30 TR-4

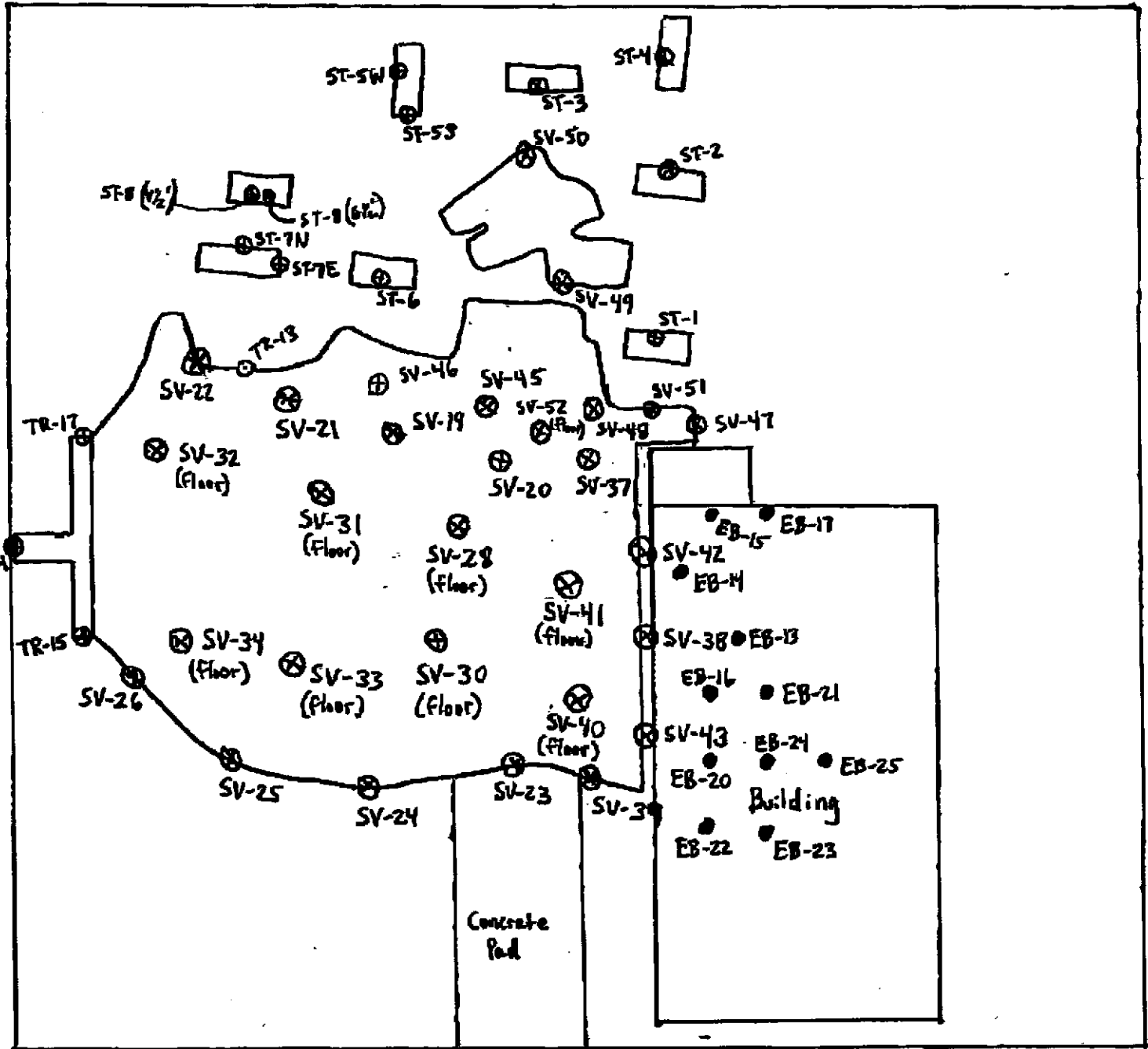

Powell Street

Doyle Avenue

Table 1. Analytical Results of Selected Soil Samples – Petroleum Hydrocarbons
(concentrations in parts per million)

Boring Number	Depth (feet)	TPHg	TPHd	TPHmo	Benzene	Toluene	Ethylbenzene	Xylenes	O&G
SV-1	2	<1.0	42	260	<0.005	<0.005	<0.005	<0.005	NA
SV-2	1½	<1.0	<1.0	<50	<0.005	<0.005	<0.005	<0.005	<50
SV-3	2	<1.0	72	230	<0.005	<0.005	<0.005	<0.005	640
SV-4	2	<1.0	1.3	<50	<0.005	<0.005	<0.005	<0.005	NA
SV-5	2½	<1.0	100	740	<0.005	<0.005	<0.005	<0.005	NA
SV-6	2	NA	1.1	<50	NA	NA	NA	NA	<50
SV-7	1½	NA	61	270	NA	NA	NA	NA	330
SV-8	2	NA	9.7	6.7	NA	NA	NA	NA	370
SV-9	1½	NA	<1.0	<50	NA	NA	NA	NA	<50
SV-10	2½	NA	25	220	NA	NA	NA	NA	350
SV-11	1½	NA	81	360	NA	NA	NA	NA	NA
SV-12	2	NA	42	380	NA	NA	NA	NA	NA
SV-13	2	NA	41	250	NA	NA	NA	NA	NA
SV-14	2	NA	<1.0	<50	NA	NA	NA	NA	NA
SV-15	2½	NA	13	140	NA	NA	NA	NA	NA
SV-16	3	<1.0	17	93	<0.005	0.005	<0.005	<0.005	NA
SV-18	1	1.8	8.8	<50	<0.005	0.005	<0.005	<0.005	120
TR-1	6	78	310	<500	<0.62	<0.62	<0.62	<0.62	NA
TR-2	6	NA	1,900	<1,000	NA	NA	NA	NA	NA
TR-4	6½	NA	700	<500	NA	NA	NA	NA	NA
TR-6	7½	NA	2,100	14,000	NA	NA	NA	NA	NA
TR-8	7½	NA	2,900	7,800	NA	NA	NA	NA	NA
TR-13	7	NA	140	750	NA	NA	NA	NA	NA
TR-15	7½	NA	18	<50	NA	NA	NA	NA	NA
TR-16	7½	NA	2,100	<1,000	NA	NA	NA	NA	NA
TR-17	7½	NA	820	<500	NA	NA	NA	NA	NA
ST-1	7½	NA	170	1,200	NA	NA	NA	NA	NA
ST-2	5½	NA	<1.0	<50	NA	NA	NA	NA	NA
ST-3	7½	NA	470	380	NA	NA	NA	NA	NA
ST-4	7½	NA	<1.0	<50	NA	NA	NA	NA	NA
ST-5W	7½	NA	<1.0	<50	NA	NA	NA	NA	NA
ST-5S	7½	NA	59	<50	NA	NA	NA	NA	NA
ST-6	7½	NA	580	1,300	NA	NA	NA	NA	NA
ST-7E	6½	NA	500	2,100	NA	NA	NA	NA	NA
ST-7N	7½	NA	15	100	NA	NA	NA	NA	NA
ST-8	4½	NA	1.2	<50	NA	NA	NA	NA	NA
ST-8	6½	NA	<1.0	<50	NA	NA	NA	NA	NA
Residential PRG*		NE	NR	NE	0.65	520	230	210	-
Residential RBSL**		100	100	500	0.045	2.6	2.5	1.0	-

- < Indicates that the compound was not detected at or above the stated laboratory reporting limit
 * Preliminary Remediation Goal (PRG)—EPA Region 9, 2000
 ** Risk Based Screening Level (RBSL), CRW/QCB, December 2001
 NA Not Analyzed
 NR Not established

Table 3. Analytical Results of Selected Soil Samples – Petroleum Hydrocarbons
(concentrations in parts per million)

Boring Number	Depth (feet)	TPHd	TPHmo	PAHs
SV-19	8½	580	4,400	NA
SV-20	8½	570	4,400	NA
SV-21	8½	290	2,400	NA
SV-22	8½	7.8	<50	NA
SV-23	8½	<1.0	<50	NA
SV-24	8½	<1.0	<50	NA
SV-25	8½	<1.0	<50	NA
SV-26	8	<1.0	<50	NA
SV-28	9½	<1.0	<50	NA
SV-30	9½	<1.0	<50	NA
SV-31	9½	<1.0	<50	NA
SV-32	9½	<1.0	<50	NA
SV-33	9½	<1.0	<50	NA
SV-34	9½	<1.0	<50	NA
SV-37	8½	1,700	14,000	NA
SV-38	8½	3,400	9,300	NA
SV-39	8½	3.8	<50	ND
SV-40	9½	36	120	NA
SV-41	9½	56	450	NA
SV-42	8½	35	260	NA
SV-43	8½	<1.0	<50	ND
SV-45	8	510	3,400	NA
SV-46	8	340	2,300	NA
SV-47	7	24	<50	NA
SV-48	8	700	4,300	NA
SV-49	6½	<1.0	<50	NA
SV-50	6½	2,100	2,500	NA
SV-51	8	4.4	<50	NA
SV-52	10	<1.0	<50	NA
Residential PRG*		NE	NE	--
Residential RBSL**		100	500	--

- < Indicates that the compound was not detected at or above the stated laboratory reporting limit
 * Preliminary Remediation Goal (PRG)-EPA Region 9, 2000
 ** Risk Based Screening Level (RBSL), CRWQCB, December 2001
 NA Not Analyzed
 NE Not established
 ND Not detected

Table 5. Analytical Results of Selected Soil Samples - Petroleum Hydrocarbons
(concentrations in parts per million)

Boring Number	Depth (feet)	TPHd	TPHmo
EB-13	4½ - 5	<1.0	<50
EB-14	6½ - 7	18	<50
EB-15	5½ - 6	1.4	<50
EB-16	6 - 6½	4.1	<50
EB-17	6 - 6½	<1.0	<50
EB-20	9½ - 10	1,700	<1,300
EB-21	9 - 9½	750	1,200
EB-22	10½ - 11	190	180
EB-23	9½ - 10	<1.0	<50
EB-24	9½ - 10	1,500	1,300
EB-25	9 - 9½	1.2	<50
Residential PRG*		NE	NE
Residential RBSL**		100	500

- < Indicates that the compound was not detected at or above the stated laboratory reporting limit
 * Preliminary Remediation Goal (PRG)-EPA Region 9, 2000
 ** Risk Based Screening Level (RBSL), CRWQCB, December 2001
 NE Not established