

The Law Office of
DAVID EARL JACOBS

David Earl Jacobs, Esq.

225 SOUTH CIVIC DRIVE, SUITE 1-3
PALM SPRINGS, CA 92262
760-327-4232
FAX 760-327-0161

Dee Dean, Paralegal
(In Memoriam)
Tara Anne Hazher, Paralegal

December 15, 2011

Mr. Jerry Wickham
Alameda County Department of Environmental Health
1131 Harbor Bay Parkway, Suite 250
Alameda, CA 94502

SUBJECT: WELL SURVEY REPORT CERTIFICATION
County Case # RO 2500
Former El Monte RV Service Center
4341 Howard Street
Oakland, CA

RECEIVED

2:34 pm, Dec 19, 2011

Alameda County
Environmental Health

Dear Mr. Wickham:

You will find enclosed one copy of the following document prepared by P&D Environmental, Inc.

1. Well Survey Report dated November 29, 2011 (document 0547.R1).

I declare, under penalty of perjury, that the information and/or recommendations contained in the above-mentioned document for the subject site is true and correct to the best of my knowledge.

Should you have any questions, please do not hesitate to contact me at 760-327-4232.

Sincerely,

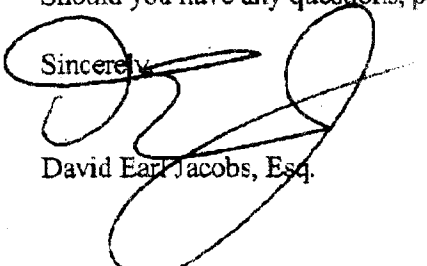

David Earl Jacobs, Esq.

Enclosure

P&D ENVIRONMENTAL, INC.

55 Santa Clara Avenue, Suite 240

Oakland, CA 94610

(510) 658-6916

November 29, 2011

Report 0547.R1

Mr. David E. Jacobs
The Law Offices of David Earl Jacobs
225 South Civic Drive, Suite 1-3
Palm Springs, CA 92262

SUBJECT: WELL SURVEY REPORT
County File # RO 2500
Former El Monte RV Service Center
4341 Howard Street
Oakland, CA

Dear Mr. Jacobs:

P&D Environmental, Inc. (P&D) is pleased to present this well survey report that identifies wells that are present in regulatory agency data bases within 2,000 feet of the subject site. This report was prepared in accordance with a May 12, 2011 letter from Mr. Jerry Wickham of the Alameda County Department of Environmental Health (ACDEH). All work was performed under the direct supervision of a California professional geologist. A Site Location Map consisting of a U.S. Geological Survey topographic map showing the location of the subject site is attached as Figure 1. A Well Location Map consisting of an enlarged portion of Figure 1 that includes a circle around the site with a 2,000-foot radius and showing the locations of wells with depths of 50 feet or greater that were identified during the well survey within 2,000 feet of the subject site is attached with this report as Figure 2. A Site vicinity map showing the location of the former underground storage tank (UST) at the subject site, cis-1,2-Dichloroethene concentrations in groundwater, and features at the adjacent property at 500 High Street is attached as Figure 3.

BACKGROUND

The subject site is the former El Monte RV Service Center. A 1,000 gallon gasoline UST was removed from the southeastern half of the site on November 15, 1991 and petroleum was detected in soil samples collected at the time of UST removal. On June 24, 1993 110 cubic yards of impacted soil was removed resulting in a pit measuring approximately 15 feet by 20 feet by 10 feet deep. On August 19, 1993 the pit was backfilled with clean imported backfill material, and on August 31, 1993 the stockpiled soil that had been excavated was removed from the site.

On June 25, 1993 groundwater monitoring well MW-1 was installed at the subject site using 2-inch diameter PVC pipe to a total depth of 20 feet below the ground surface. The screened interval of the well was from 5 to 20 feet bgs. Well MW-1 was sampled a total of seven times between June 25, 1993 and October 16, 1995 and the samples were analyzed for TPH-G and BTEX. In March and October 1995 the groundwater samples collected from well MW-1 were also analyzed for

November 29, 2011
Report 0547.R1

halogenated volatile organic compounds (HVOCs) using EPA Method 8010 associated with investigation of the extent of HVOCs detected in groundwater at the adjacent 500 High Street property (also referred to as the Bank of America site and also referred to as the Cobbletick-Kibbe site). Based on the results of investigation in 1995 associated with the 500 High Street site, it was suggested that the detected elevated HVOC concentrations could be originating from the El Monte RV Service Center.

An ACDEH Fuel Leak Site Case Closure letter dated February 4, 1998 states that the ACDEH concurred that the TPH releases from both the 500 High Street and the 4341 Howard Street sites had been adequately investigated, and analysis for petroleum hydrocarbons was discontinued for all wells beginning in 1996. Additionally, sampling would continue on a semi-annual basis for HVOCs. Following completion of an April 8, 1997 human health risk assessment using ASTM RBCA for the 500 High Street property, the ACDEH concluded that no further action was recommended for both the petroleum and HVOC releases for the 500 High Street site.

A more detailed site history is provided in P&D's July 22, 2011 Soil Gas and Groundwater Sampling and Well Survey Work Plan (document 0547.W1).

WELL SURVEY

Documentation regarding the locations of wells within 2,000 feet of the subject site was obtained from the Alameda County Public Works Agency (ACPWA) and from the California Department of Water Resources (DWR).

ACPWA Well Survey Results

P&D submitted a request to Ms. Victoria Hamlin of the ACPWA for available well information within a 2,000-foot radius of the subject site. On July 15, 2011 ACPWA provided tables via e-mail to P&D of the findings of the ACPWA database search. The search area is in Township T2S, Range R3W, and included all or part of Section 7 Tracts A, B, G, H, J, K, L, P, Q and R; Section 8 Tracts B, C, D, E, F, G, H, J, K, L, M, N, P, Q, and R; Section 17 Tracts A, B, C, D, E, F, G, H, K, L, and M; and Section 18 Tracts A, B, C, F, G, H, J, and K. Wells were not identified in the tracts that are underlined.

A total of 600 well records were included in the spreadsheet provided by ACPWA. A total of 310 of the 600 well records were identified within the 2,000 foot radius of the subject site (including destroyed wells and abandoned but not destroyed wells). Information for the 310 wells located within the 2,000 foot radius of the subject site is summarized in Table 1. A legend provided by ACPWA for the well search that defines the various well search result abbreviations is also attached with Table 1. The majority of the wells were groundwater monitoring wells that extend to a maximum depth of 45 feet. A total of 17 wells in Table 1 that are located within 2,000 feet of the subject site are 50 or more feet deep and are identified with bold print in Table 1. The distance and direction from the subject site for these wells are also provided in Table 1. An Assigned ACPWA

November 29, 2011
Report 0547.R1

Number is provided in the first column of Table 1 for convenience in referencing the information in the table.

Review of Table 1 shows that seven of these 17 wells were identified as having been destroyed. Two of the remaining 10 wells are cathodic wells located at distances of 700 feet to the northeast and 1,900 feet to the east-southeast of the subject site, and the depths of the cathodic wells are 65 and 120 feet, respectively. Five of the remaining 10 wells are monitoring wells that range in depth from 50 to 98 feet. Of the three remaining wells, one of the wells is an industrial well reported to be 610 feet deep located at 499 High Street (directly across High Street from the subject site, a distance of approximately 400 feet from the subject site former UST), one of the wells is an irrigation well reported to be 180 feet deep located approximately 1,100 feet north-northwest of the site, and one well is a domestic well reported to be 127 feet deep located at the adjacent 500 High Street property (also referred to as the Bank of America site and also referred to as the Cobble-dick-Kibbe site). The distance from the subject site former UST to the 500 High Street site property line is approximately 70 feet. These three remaining wells are highlighted on Table 1 and the approximate locations of these three remaining wells are shown on Figure 2 (the well designations on Figure 2 are provided in Table 3). The specific locations of the wells at these nearby properties are unknown. The locations of the wells identified from the ACPWA database that are shown on Figure 2 were located on Figure 2 at the approximate center of the property by using the site address provided by ACPWA and the internet service Google Earth.

DWR Well Survey Results

P&D submitted a request to Mr. Oleg Yakimov of the DWR for available well information within a 2,000-foot radius of the subject site. On July 14, 2011 Mr. Dean Crippen of the DWR provided a total of 744 tif files on a compact disk, some of which consisted of multiple images. Review of these images showed that a total of 231 of the tif files were for locations identified within a 2,000-foot radius of the subject site. Information regarding the wells from the DWR is summarized in Table 2. The majority of the wells located within a 2,000 foot radius of the subject site are groundwater monitoring wells that extend to a maximum depth of 40 feet. A total of 16 wells in Table 2 that are located within 2,000 feet of the subject site are 50 or more feet deep and are identified with bold print in Table 2. The distance and direction from the subject site for these wells are also provided in Table 2. An Assigned DWR Number is provided in the first column of Table 2 for convenience in referencing the information in the table.

The tif files provide information for the same well at two locations (Assigned DWR Well Numbers 18 and 19 document installation and destruction of monitoring well 20A, and Assigned DWR Well Numbers 230 and 231 document installation and pump removal for an unnamed industrial well). The tif files also provide information regarding installation and destruction of wells at 499 High Street, with Assigned DWR Well Number 173 documenting installation of a 6-inch diameter industrial well to a depth of 610 feet on December 3, 1985 for Integrated Env Syst, and Assigned DWR Well Number 174 documenting destruction of a 6-inch diameter well to a depth of 300 feet (described as filled with pea gravel from 300 to 22 feet, and filled with neat cement from 22 to 0

feet) on December 9, 1987 for IES. The property owner at the time of well installation and well destruction is presumed to be the same owner. Insufficient information is available to determine if these tif files describe the same well, and the wells are conservatively identified as two different wells until additional information becomes available. The borders for these three pairs of tif files are bolded in Table 2.

Review of Table 2 shows that eight of the 16 wells identified within a 2,000 foot radius of the subject site and with depths of 50 feet or greater are identified as belonging to the Clorox Company. These eight wells are also identified in the ACPWA database, with seven of the eight being described as destroyed in the ACPWA database and the eighth Clorox well not being identified as destroyed in either database. The same two cathodic protection wells identified in the ACPWA database were also identified as two of the 16 wells identified in the DWR database. Three of the 16 wells in the DWR database also match records in the ACPWA database as monitoring wells owned by Unocal. Of the remaining three wells of the 16, one is the industrial well reported to be 610 feet deep and located directly across High Street from the subject site at 499 High Street (this well is also identified in the ACPWA database); one well is identified as a 6-inch diameter well destroyed to a depth of 300 feet at 499 High Street; and the remaining well is located approximately 1,900 feet east-northeast of the subject site and is constructed to a depth of 776 feet deep. These three remaining wells are highlighted on Table 2 and the approximate locations of these three remaining wells are shown on Figure 2 (the well designations on Figure 2 are provided in Table 3). The locations of the wells identified from the DWR database that are shown on Figure 2 were located on Figure 2 at the approximate center of the property by using the site address obtained from the DWR tif files and the internet service Google Earth.

HYDROGEOLOGY

Based on review of regional geologic maps from U. S. Geological Survey Professional Paper 943, "Flatland Deposits - Their Geology and Engineering Properties and Their Importance to Comprehensive Planning," by E. J. Helley and K. R. Lajoie, 1979, the subject site is underlain by Holocene Deposits, Bay mud (Qhbm), which is described as unconsolidated water-saturated dark plastic carbonaceous clay and silty clay. It may contain a few lenses of well-sorted fine sand and silt and a few shelly and peaty layers.

Review of the Geologic map and map database of the Oakland metropolitan area, Alameda, Contra Costa, and San Francisco Counties, California: A Digital Database that was compiled by R.W. Graymer (U. S. Geological Survey Miscellaneous Field Studies, MF-2342, Version 1.0 in 2000), shows the subject site as being underlain by artificial fill (af) which is described as consisting of Man-made deposits of various materials and ages. The materials are further described as some being compacted and quite firm, but fills made before 1965 are nearly everywhere not compacted and consist simply of dumped materials.

Based on the materials encountered in the borehole cores at drilling locations B4 and B5 to a depth of 10.0 feet bgs, the subsurface materials encountered at the site consisted predominantly of fill

November 29, 2011
Report 0547.R1

from 0 to 3.0 feet bgs, fine sand from 3.0 to 6.5 and 7.0 feet bgs, respectively, and clay to the total depth explored of 10.0 feet bgs at each location. Groundwater was encountered during drilling in boreholes B4 and B5 at 5.5 and 6.0 feet bgs, respectively, and was subsequently measured at depths of depth of 8.3 and 8.6 feet bgs, respectively.

There is no historical information regarding water level measurements in groundwater monitoring well MW1 at the subject site, other than the depth to water from the top of the well casing on March 23, 1995 was 2.85 feet below the top of the well casing. Historical information for depth to water and groundwater flow direction for groundwater monitoring wells located at the adjacent property located to the northeast of the subject site (500 High Street) was obtained from the ACDEH Fuel Leak Site Case Closure letter dated February 4, 1998 for the 500 High Street site. The historical groundwater flow direction at 500 High Street has ranged from west to southwest and the measured depth to water in the wells has historically ranged from 1.57 to 8.79 feet. The nearest surface water body to the subject site is a tidal canal located approximately 1,000 feet to the southwest of the site that is connected to the San Leandro Bay estuary.

DISCUSSION AND RECOMMENDATIONS

Review of Figure 1 shows that the nearest surface water body to the subject site is a tidal canal located approximately 1,000 feet to the southwest of the site that is connected to the San Leandro Bay estuary. The historical westerly to southwesterly groundwater flow direction obtained from water level measurements in groundwater monitoring wells at the adjacent 500 High Street property is consistent with groundwater flow towards the tidal canal.

Table 3 summarizes the available information for the four wells identified within a 2,000 foot radius of the subject site with depths of 50 feet or greater and that are not groundwater monitoring wells, cathodic protection wells, or that have been destroyed. The locations of the wells summarized in Table 3 are shown on Figure 2.

Review of historical water quality data for groundwater samples collected from boreholes and wells in the vicinity of the subject site has identified the presence of trichloroethene (TCE) and cis-1,2-dichloroethene (cis-1,2-DCE), with the highest detected concentrations consisting of cis-1,2-DCE as shown in Figure 3. No petroleum hydrocarbons (TPH-G, TPH-D, TPH-BO or BTEX) were detected in a water sample collected from subject site well MW1 in 2011, with the exception of 5.7 ug/L MTBE. Based on the historical westerly to southwesterly groundwater flow direction identified at the 500 High Street site, the well identified at the 499 High Street property is transgradient from the subject site and the well identified at the 500 High Street property is upgradient from the subject site. The remaining two wells identified on Figure 2 are also upgradient of the subject site.

Review of the historical cis-1,2-DCE groundwater concentrations in the vicinity of the subject site suggest that historical pumping at either of the 499 and 500 High Street sites could have impacted the distribution of cis-1,2-DCE in groundwater that has been detected in the vicinity of the subject

November 29, 2011
Report 0547.R1

site. P&D recommends that the property owners for each of these two properties be contacted to determine the status and location of the wells identified at these properties during this well survey.

DISTRIBUTION

A copy of this report will be uploaded to the ACDEH website, in accordance with ACDEH requirements. In addition, a copy of this report will be uploaded to the GeoTracker database.

LIMITATIONS

This report was prepared solely for the use of The Law Offices of David Earl Jacobs. The content and conclusions provided by P&D in this assessment are based on information collected during our investigation, which may include, but not be limited to, visual site inspections; interviews with the site owner, regulatory agencies and other pertinent individuals; review of available public documents; subsurface exploration and our professional judgment based on said information at the time of preparation of this document. Any subsurface sample results and observations presented herein are considered to be representative of the area of investigation; however, geological conditions may vary between borings and may not necessarily apply to the general site as a whole. If future subsurface or other conditions are revealed which vary from these findings, the newly revealed conditions must be evaluated and may invalidate the findings of this report.

This report is issued with the understanding that it is the responsibility of the owner, or his representative, to ensure that the information contained herein is brought to the attention of the appropriate regulatory agencies, where required by law. Additionally, it is the sole responsibility of the owner to properly dispose of any hazardous materials or hazardous wastes left onsite, in accordance with existing laws and regulations.

This report has been prepared in accordance with generally accepted practices using standards of care and diligence normally practiced by recognized consulting firms performing services of a similar nature. P&D is not responsible for the accuracy or completeness of information provided by other individuals or entities that is used in this report. This report presents our professional judgment based upon data and findings identified in this report and interpretation of such data based upon our experience and background, and no warranty, either express or implied, is made. The conclusions presented are based upon the current regulatory climate and may require revision if future regulatory changes occur.

November 29, 2011
Report 0547.R1

Should you have any questions, please do not hesitate to contact us at (510) 547-7771.

Sincerely,

P&D Environmental, Inc.

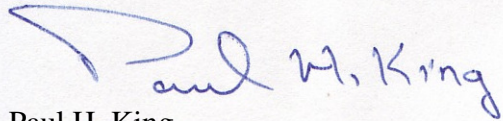

Paul H. King
Professional Geologist # 5901
Expires: 12/31/11

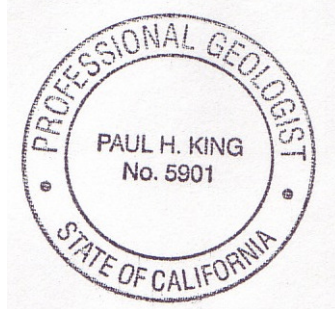

Attachments:

Table 1 - Alameda County Public Works Agency Well Summary Information

Table 2 - Department of Water Resources Well Summary Information

Table 3 - All Database Well Summary Information

Figure 1 - Site Location Map

Figure 2 - Well Location Map

Figure 3 - Site Vicinity Map Showing cis-1,2-DCE in Groundwater

PHK/sjc/mld/hd
0547.R1

TABLES

Alameda County Public Works Agency Well Summary Information

Assigned ACPWA Well Number	Permit Number	Township and Range	Section and Tract	Address	City	Owner	Drill Date	Total Depth (Feet)	Water Depth (Feet)	Diameter (Inches)	Use	WCR #	Comments
1		2S/3W	7J 1	3600 ALAMEDA AVE	Oakland	OWENS-ILLINOIS	Sep-86	30	11	2	MON		
2		2S/3W	7J 2	3600 ALAMEDA AVE	Oakland	OWENS-ILLINOIS	Sep-86	30	18	2	MON		
3		2S/3W	7J 3	3600 ALAMEDA AVE	Oakland	OWENS-ILLINOIS	Sep-86	31	14	2	MON		
4		2S/3W	7J 4	3600 ALAMEDA AVE	Oakland	OWENS-ILLINOIS	Sep-86	30	13	2	MON		
5		2S/3W	7J 5	3600 ALAMEDA AVE	Oakland	OWENS-ILLINOIS	Sep-86	30	18	2	MON		
6		2S/3W	7J 6	3600 ALAMEDA AVE	Oakland	OWENS-ILLINOIS	Sep-86	30	19	2	MON		
7		2S/3W	7J 7	3600 ALAMEDA AVE	Oakland	OWENS-ILLINOIS	Sep-86	25	18	2	MON		
8		2S/3W	7J 8	3600 ALAMEDA AVE	Oakland	OWENS-ILLINOIS	Oct-86	30	18	2	MON		
9		2S/3W	7J 9	3600 ALAMEDA AVE	Oakland	OWENS-ILLINOIS	Oct-86	25	15	2	MON		
10		2S/3W	7J 18	3600 ALAMEDA AVE	Oakland	OWENS ILLINOIS GLASS	Jul-86	16	0	2	MON		
11		2S/3W	7J 20	3600 ALAMEDA AVE	Oakland	OWENS ILLINOIS GLASS	Nov-86	32	17	2	MON		
12		2S/3W	7J 21	3600 ALAMEDA AVE	Oakland	OWENS ILLINOIS GLASS	Nov-86	27	19	2	MON		
13		2S/3W	7J 22	3600 ALAMEDA AVE	Oakland	OWENS ILLINOIS GLASS	Dec-86	27	14	2	MON		
14		2S/3W	7J 23	3600 ALAMEDA AVE	Oakland	OWENS ILLINOIS GLASS	Nov-86	27	14	2	MON		
15		2S/3W	7J 24	3600 ALAMEDA AVE	Oakland	OWENS ILLINOIS GLASS	Dec-86	30	13	2	MON		
16		2S/3W	7J 25	3600 ALAMEDA AVE	Oakland	OWENS ILLINOIS GLASS	Dec-86	25	13	2	MON		
17		2S/3W	7J 26	3600 ALAMEDA AVE	Oakland	OWENS ILLINOIS GLASS	Dec-86	25	12	2	MON		
18		2S/3W	7J 27	3600 ALAMEDA AVE	Oakland	OWENS ILLINOIS GLASS	Dec-86	25	10	2	MON		
19		2S/3W	7J 28	3675 Alameda Ave	Oakland	Unocal Corp VMW1	Dec-91	10	0	2	MON		
20		2S/3W	7J 29	3675 Alameda Ave	Oakland	Unocal Corp VMW2	Dec-91	10	0	2	MON		
21		2S/3W	7J 30	3675 Alameda Ave	Oakland	Unocal Corp VMW3	Dec-91	10	0	2	MON		
22		2S/3W	7J 31	3675 Alameda Ave	Oakland	Unocal Corp VMW4	Dec-91	10	0	2	MON		
23		2S/3W	7J 32	3675 Alameda Ave	Oakland	Unocal Corp VMW5	Dec-91	9	0	2	MON		
24		2S/3W	7J 33	3675 Alameda Ave	Oakland	Unocal Corp VMW7	Dec-91	11	0	2	MON		
25		2S/3W	7J 34	3675 Alameda Ave	Oakland	Unocal Corp VMW-8	Dec-91	11	0	2	MON		
26		2S/3W	7J 35	3675 Alameda Ave	Oakland	Lerner Props	691	0	0	0	DES		
27		2S/3W	7J 36	3675 Alameda Ave	Oakland	Lerner Props	691	0	0	0	DES		
28		2S/3W	7J 37	3675 Alameda Ave	Oakland	Lerner Props	691	0	0	0	DES		
29		2S/3W	7J 38	3675 Alameda Ave	Oakland	Lerner Props	691	0	0	0	DES		
30		2S/3W	7J 39	3675 Alameda Ave	Oakland	Lerner Props	691	0	0	0	DES		
31		2S/3W	7J 40	3675 Alameda Ave	Oakland	Lerner Props	691	0	0	0	DES		
32		2S/3W	7J 41	3675 Alameda Ave	Oakland	Lerner Props	691	0	0	0	DES		
33		2S/3W	7J 42	3675 Alameda Ave	Oakland	Lerner Props	691	0	0	0	DES		
34		2S/3W	7J 43	3675 Alameda Ave	Oakland	Lerner Props	691	0	0	0	DES		
35		2S/3W	7J 44	3675 Alameda Ave	Oakland	Lerner Props	691	0	0	0	DES		
36		2S/3W	7J 45	3675 Alameda Ave	Oakland	Lerner Props	691	0	0	0	DES		
37		2S/3W	7J 46	3675 Alameda Ave	Oakland	Lerner Props	691	0	0	0	DES		
38		2S/3W	7J 47	3675 Alameda Ave	Oakland	Lerner Props	691	0	0	0	DES		
39		2S/3W	7J 48	3675 Alameda Ave	Oakland	Lerner Props	691	0	0	0	DES		
40		2S/3W	7J 49	3675 Alameda Ave	Oakland	Lerner Props	691	0	0	0	DES		
41		2S/3W	7J 50	3675 Alameda Ave	Oakland	Lerner Props	691	0	0	0	DES		
42		2S/3W	7J 51	3675 Alameda Ave	Oakland	Lerner Props	691	0	0	0	DES		
43		2S/3W	7R 1	3925 Alameda Av	Oakland	Smooke & Sons Investment	595	21	11	4	MON		
44		2S/3W	7R 2	3925 Alameda Av	Oakland	Smooke & Sons Investment	595	21	10	4	MON		
45		2S/3W	7R 3	3925 Alameda Av	Oakland	Smooke & Sons Investment	595	20	12	4	MON		
46	96583	2S/3W	7R 4	3925 Alameda Av	Oakland	Smooke and Sons Investmen	996	20	12	4	MON		
47	85203	2S/3W	8G 1	499 HIGH ST	Oakland	INTEGRATED ENV. SYSTEMS	Dec-85	610	30	6	IND		Approx 400 Feet NW to Property Line From Subject Site UST
48		2S/3W	8L	4301 SAN LEANDRO ST	Oakland	COMMERCIAL FUELING SYS	Oct-86	37	0	0	BOR		
49		2S/3W	8L	720 High St.	Oakland	Exxon #7-3006	293	10	10	0	BOR	209099	
50		2S/3W	8L 2	860 42ND AVE	Oakland	CLOROX CO.	782	235	40	2	DES		Approx 1,400 Feet NNE of Subject Site (DESTROYED)
51		2S/3W	8L 3	860 42ND AVE	Oakland	CLOROX CO.	982	244	40	2	DES		Approx 1,400 Feet NNE of Subject Site (DESTROYED)
52		2S/3W	8L 4	860 42ND AVE	Oakland	CLOROX CO.	Oct-82	20	12	2	DES		
53		2S/3W	8L 5	860 42ND AVE	Oakland	CLOROX CO.	982	25	21	2	DES		
54		2S/3W	8L 6	860 42ND AVE	Oakland	CLOROX CO.	882	22	16	2	MON		
55		2S/3W	8L 7	860 42ND AVE	Oakland	CLOROX CO.	Oct-82	22	13	2	DES		
56		2S/3W	8L 8	860 42ND AVE	Oakland	CLOROX CO.	882	22	10	2	DES		
57		2S/3W	8L 9	860 42ND AVE	Oakland	CLOROX CO.	782	87	0	2	DES		Approx 1,400 Feet NNE of Subject Site (DESTROYED)
58		2S/3W	8L 10	860 42ND AVE	Oakland	CLOROX CO.	782	87	39	2	DES		Approx 1,400 Feet NNE of Subject Site (DESTROYED)
59		2S/3W	8L 11	860 42ND AVE	Oakland	CLOROX CO.	882	77	41	2	DES		Approx 1,400 Feet NNE of Subject Site (DESTROYED)
60		2S/3W	8L 12	860 42ND AVE	Oakland	CLOROX CO.	882	40	15	2	DES		
61		2S/3W	8L 13	HIGH & WATTLING STREETS	Oakland	CLOROX (850 42ND AV)	882	77	40	2	DES		Approx 1,400 Feet NNE of Subject Site (DESTROYED)
62		2S/3W	8L 14	860 42ND AVE	Oakland	CLOROX CO.	882	87	40	2	DES		Approx 1,400 Feet NNE of Subject Site (DESTROYED)
63		2S/3W	8L 15	860 42ND AVE	Oakland	CLOROX CO.	Nov-83	32	16	0	MON		
64		2S/3W	8L 16	860 42ND AVE	Oakland	CLOROX CO.	Oct-83	31	11	0	DES		
65		2S/3W	8L 17	860 42ND AVE	Oakland	CLOROX CO.	Nov-83	32	12	0	DES		
66		2S/3W	8L 18	860 42ND AVE	Oakland	CLOROX CO.	Nov-83	34	15	0	MON		
67		2S/3W	8L 19	860 42ND AVE	Oakland	CLOROX CO.	Nov-83	31	11	0	MON		
68		2S/3W	8L 20	860 42ND AVE	Oakland	CLOROX CO.	Nov-83	34	11	0	MON		
69		2S/3W	8L 21	860 42ND AVE	Oakland	CLOROX CO.	Nov-83	32	6	0	MON		
70		2S/3W	8L 22	4301 SAN LEANDRO ST	Oakland	COMMERCIAL FUELING SYS	Oct-86	12	0	2	MON		
71		2S/3W	8L 23	4301 SAN LEANDRO ST	Oakland	COMMERCIAL FUELING SYS	Oct-86	12	0	2	MON		
72		2S/3W	8L 24	4301 SAN LEANDRO ST	Oakland	COMMERCIAL FUELING SYS	Oct-86	12	0	2	MON		
73		2S/3W	8L 25	4301 SAN LEANDRO ST	Oakland	COMMERCIAL FUELING SYS	Oct-86	12	0	2	MON		
74		2S/3W	8L 26	850-42ND AVE	Oakland	CLOROX	Oct-86	55	0	2	MON		Approx 1,400 Feet NNE of Subject Site
75		2S/3W	8L 27	850-42ND AVE	Oakland	CLOROX	Sep-86	29	0	4	MON		
76		2S/3W	8L 28	850-42ND AVE	Oakland	CLOROX	Sep-86	28	0	4	MON		
77		2S/3W	8L 29	850-42ND AVE	Oakland	CLOROX	Sep-86	25	0	4	MON		
78		2S/3W	8L 30	850-42ND AVE	Oakland	CLOROX	Sep-86	27	0	4	MON		
79		2S/3W	8L 31	850-42ND AVE	Oakland	CLOROX	Sep-86	25	0	2	MON		
80		2S/3W	8L 32	850-42ND AVE	Oakland	CLOROX	Sep-86	30	0	4	MON		
81		2S/3W	8L 33	720 HIGH STREET	Oakland	EXXON STATION #7-3006	Sep-87	35	16	4	MON		
82		2S/3W	8L 34	720 HIGH STREET	Oakland	EXXON STATION #7-3006	Sep-87	35	16	4	MON		
83		2S/3W	8L 35	720 HIGH STREET	Oakland	EXXON STATION #7-3006	Sep-87	35	16	4	MON		

Alameda County Public Works Agency Well Summary Information

Assigned ACPWA Well Number	Permit Number	Township and Range	Section and Tract	Address	City	Owner	Drill Date	Total Depth (Feet)	Water Depth (Feet)	Diameter (Inches)	Use	WCR #	Comments
84	89407	2S/3W	8L36	720 HIGH STREET	Oakland	EXXON STATION #7-3006	Sep-87	33	16	4	MON		
85		2S/3W	8L37	720 HIGH STREET	Oakland	EXXON STATION #7-3006	Sep-87	35	16	4	MON		
86		2S/3W	8L38	720 HIGH STREET	Oakland	EXXON STATION #7-3006	Sep-87	35	16	4	MON		
87		2S/3W	8L39	720 HIGH STREET	Oakland	EXXON STATION #7-3006	Sep-87	35	16	4	MON		
88		2S/3W	8L40	720 HIGH ST	Oakland	EXXON STA # 7-3006	May-88	29	11	4	MON	318004	
89		2S/3W	8L41	720 HIGH ST	Oakland	EXXON STA # 7-3006	May-88	33	0	4	MON		
90		2S/3W	8L42	720 HIGH ST	Oakland	EXXON CORP.	May-88	33	10	4	MON		
91		2S/3W	8L43	720 High St.	Oakland	Exxon #7-3006 VW1	2/93	7	0	4	MON		
92		2S/3W	8L44	720 High St.	Oakland	Exxon #7-3006 VW2	2/93	10	0	4	MON		
93		2S/3W	8L45	720 High St.	Oakland	Exxon #7-3006 VW3	2/93	8	0	4	MON		
94	94652	2S/3W	8L46	900 High St	Oakland	Oakland Unified School Di	Oct-94	24	16	2	MON		
95	94652	2S/3W	8L47	900 High St	Oakland	Oakland Unified School Di	Oct-94	23	17	2	MON		
96	94652	2S/3W	8L48	900 High St	Oakland	Oakland Unified School Di	Oct-94	24	18	2	MON		
97		2S/3W	8M	3801 EAST 8TH AVE	Oakland	AMERICAN CAN CO	Jan-86	30	13	2	BOR		
98		2S/3W	8M	3801 East 8th Street	Oakland	American National Can Co.	8/89	0	0	12	BOR*		
99		2S/3W	8M	3801 East 8th Street	Oakland	American National Can Co.	3/91	7	5	8	BOR*		
100		2S/3W	8M	3801 E. 8th St.	Oakland	American Nat'l Can Co. TB	Dec-94	24	0	0	GEO		
101		2S/3W	8M 1	EAST 8TH ST	Oakland	AMERICAN CAN CO	Jun-86	22	13	2	MON		
102		2S/3W	8M 2	3801 East 8th Street	Oakland	American National Can Co.	8/89	24	0	4	MON		
103		2S/3W	8M 3	3801 East 8th Street	Oakland	American National Can Co.	8/89	25	0	4	ON		
104		2S/3W	8M 4	3801 East 8th Street	Oakland	American National Can Co.	8/89	20	0	4	MON		
105		2S/3W	8M 5	3801 East 8th Street	Oakland	American National Can Co.	8/89	22	0	4	MON		
106		2S/3W	8M 6	3801 East 8th Street	Oakland	American National Can Co.	8/89	18	0	4	MON		
107		2S/3W	8M 7	3801 East 8th Street	Oakland	American National Can Co.	4/91	180	41	7	IRR		Approx 1,100 Feet NNW of Subject Site
108		2S/3W	8M 8	3801 East 8th Street	Oakland	American National Can Co.	3/91	25	11	0	MON		
109		2S/3W	8M 9	3801 East 8th Street	Oakland	American National Can Co.	4/91	20	12	4	MON		
110		2S/3W	8M10	3801 East 8th Street	Oakland	American National Can Co.	3/91	20	12	4	MON		
111		2S/3W	8M11	3801 East 8th Street	Oakland	American National Can Co.	3/91	19	9	4	MON		
112		2S/3W	8M12	3801 East 8th Street	Oakland	American National Can Co.	3/91	19	13	4	MON		
113		2S/3W	8M13	3801 East 8th Street	Oakland	American National Can Co.	3/91	19	12	4	MON		
114		2S/3W	8M14	3801 East 8th Street	Oakland	American National Can Co.	3/91	22	10	4	MON		
115		2S/3W	8M15	3801 East 8th Street	Oakland	American National Can Co.	3/91	18	13	4	MON		
116		2S/3W	8M16	3801 East 8th Street	Oakland	American National Can Co.	3/91	18	10	4	MON		
117		2S/3W	8M17	3801 East 8th Street	Oakland	American National Can Co.	3/91	23	10	4	MON		
118		2S/3W	8M18	3801 East 8th Street	Oakland	American National Can Co.	3/91	18	10	4	MON		
119		2S/3W	8M19	3801 East 8th Street	Oakland	American National Can Co.	3/91	19	11	4	MON		
120		2S/3W	8M20	3801 E 8th St	Oakland	American National CanMW17	1/92	15	4	2	MON		
121		2S/3W	8M21	3801 E 8th ST	Oakland	American National CanMW18	1/92	19	4	2	MON		
122		2S/3W	8M22	3801 E 8th ST	Oakland	American National CanMW19	1/92	20	4	2	MON		
123		2S/3W	8M23	3801 E 8th ST	Oakland	American National CanMW20	1/92	19	4	2	MON		
124		2S/3W	8M24	3801 E 8th ST	Oakland	American National CanMW21	1/92	19	4	2	MON		
125		2S/3W	8M25	3801 East 8th St	Oakland	American National Can TW1	Oct-91	23	5	6	TES		
126		2S/3W	8M26	3801 East 8th St	Oakland	American Nat Can MW14	Oct-91	19	2	4	MON		
127		2S/3W	8M27	3801 East 8th St	Oakland	American Natl Can MW15	Oct-91	21	5	4	MON		
128		2S/3W	8M28	3801 East 8th St	Oakland	American Natl Can MW16	Oct-91	19	2	4	MON		
129		2S/3W	8M29	3801 E 8th St	Oakland	American National Can Com	3/94	19	0	4	MON		
130		2S/3W	8M30	3801 E 8th St	Oakland	American National Can Com	3/94	19	0	4	MON		
131	95628	2S/3W	8M31	3801 E. 8th St	Oakland	American National Can	9/95	23	10	2	MON		
132	95628	2S/3W	8M32	3801 E. 8th St	Oakland	American National Can	9/95	25	12	2	MON		
133	95628	2S/3W	8M33	3801 E. 8th St	Oakland	American National Can	9/95	20	12	2	MON		
134	95628	2S/3W	8M34	3801 E. 8th St	Oakland	American National Can	9/95	22	11	2	MON		
135	95628	2S/3W	8M35	3801 E. 8th St	Oakland	American National Can	9/95	25	14	2	MON		
136	95628	2S/3W	8M36	3801 E. 8th St	Oakland	American National Can	9/95	25	11	2	MON		
137	95628	2S/3W	8M37	3801 E. 8th St	Oakland	American National Can	9/95	25	12	2	MON		
138	95628	2S/3W	8M38	3801 E. 8th St	Oakland	American National Can	9/95	24	11	2	MON		
139		2S/3W	8N	301 - 411 High Street	Oakland	Arco Products Co	1/91	6	2	2	BOR		
140		2S/3W	8N	630 HIGH ST	Oakland	SHELL OIL	Apr-89	10	0	8	BOR*		
141		2S/3W	8N	630 High Street	Oakland	Shell Oil Company	8/89	10	0	8	BOR		
142		2S/3W	8N	630 High Street	Oakland	Shell Oil Company	Nov-89	9	0	8	BOR		
143		2S/3W	8N	401 HIGH STREET	Oakland	UNOCAL CHEMICAL	Aug-88	18	0	6	BOR		
144		2S/3W	8N	410 High Street	Oakland	Unocal Corporation	9/89	25	15	2	MON		
145		2S/3W	8N	410 High Street	Oakland	Unocal Corporation	8/89	0	8	4	BOR*		
146		2S/3W	8N 1	ALAMEDA AVE	Oakland	AMERICAN CAN CO	7/87	31	9	2	DES		
147		2S/3W	8N 2	ALAMEDA AVE	Oakland	AMERICAN CAN CO	7/87	31	9	2	DES		
148		2S/3W	8N 3	ALAMEDA AVE	Oakland	AMERICAN CAN CO	7/87	31	9	2	DES		
149		2S/3W	8N 4	ALAMEDA AVE	Oakland	AMERICAN CAN CO	7/87	31	9	2	DES		
150		2S/3W	8N 5	630 HIGH ST	Oakland	SHELL OIL	Apr-89	14	10	4	MON		
151		2S/3W	8N 6	630 HIGH ST	Oakland	SHELL OIL	Apr-89	20	14	4	MON		
152		2S/3W	8N 7	630 HIGH ST	Oakland	SHELL OIL	Apr-89	17	14	4	MON		
153		2S/3W	8N 8	630 HIGH ST	Oakland	SHELL OIL	Apr-89	17	10	4	MON		
154		2S/3W	8N 9	630 High Street	Oakland	Shell Oil Company	8/89	18	12	4	MON		
155		2S/3W	8N10	630 High Street	Oakland	Shell Oil Company	8/89	20	15	4	MON		
156		2S/3W	8N11	630 High Street	Oakland	Shell Oil Company	8/89	20	18	4	MON		
157		2S/3W	8N12	630 High Street	Oakland	Shell Oil Company	8/89	21	9	4	MON		
158		2S/3W	8N13	630 High Street	Oakland	Shell Oil Company	Nov-89	12	10	2	MON		
159		2S/3W	8N14	630 High Street	Oakland	Shell Oil Company	Nov-89	13	11	2	MON		
160		2S/3W	8N15	410 High Street	Oakland	Unocal Corporation	9/90	98	19	4	MON		Approx 620 Feet WSW of Subject Site
161		2S/3W	8N16	410 High Street	Oakland	Unocal Corporation	9/89	0	10	4	BOR*		
162		2S/3W	8N17	410 High Street	Oakland	Unocal Corporation	9/89	25	15	2	MON		
163		2S/3W	8N18	410 High Street	Oakland	Unocal Corporation	9/89	25	15	2	MON		
164		2S/3W	8N19	410 High Street	Oakland	Unocal Corporation	9/89	27	15	2	MON		
165		2S/3W	8N20	410 High Street	Oakland	Unocal Corporation	9/89	30	15	2	MON		
166		2S/3W	8N21	410 High Street	Oakland	Unocal Corporation	9/89	26	15	2	MON		

Alameda County Public Works Agency Well Summary Information

Assigned ACPWA Well Number	Permit Number	Township and Range	Section and Tract	Address	City	Owner	Drill Date	Total Depth (Feet)	Water Depth (Feet)	Diameter (Inches)	Use	WCR #	Comments	
167		2S/3W	8N22	410 High Street	Oakland	Unocal Corporation	9/89	23	15	2	MON			
168		2S/3W	8N23	410 High Street	Oakland	Unocal Corporation	9/89	26	15	2	MON			
169		2S/3W	8N24	410 High Street	Oakland	Unocal Corporation	9/89	26	15	2	MON			
170		2S/3W	8N25	410 High Street	Oakland	Unocal Corporation	9/89	24	15	2	MON			
171		2S/3W	8N26	410 High Street	Oakland	Unocal Corporation	9/89	26	15	2	MON			
172		2S/3W	8N27	410 High Street	Oakland	Unocal Corporation	9/89	25	15	2	MON			
173		2S/3W	8N28	410 High Street	Oakland	Unocal Corporation	9/89	22	15	2	MON			
174		2S/3W	8N29	410 High Street	Oakland	Unocal Corporation	9/89	24	15	2	MON			
175		2S/3W	8N30	410 High Street	Oakland	Unocal Corporation	9/89	22	15	2	MON			
176		2S/3W	8N31	410 High Street	Oakland	Unocal Corporation	9/89	24	15	2	MON			
177		2S/3W	8N32	410 High Street	Oakland	Unocal Corporation	9/89	29	15	2	MON			
178		2S/3W	8N33	410 High Street	Oakland	Unocal Corporation	9/89	27	15	2	MON			
179		2S/3W	8N34	301 - 411 High Street	Oakland	Arco Products Co	Oct-90	14	0	1	MON			
180		2S/3W	8N35	301 - 411 High Street	Oakland	Arco Products Co	Nov-89	0	8	6	BOR*			
181		2S/3W	8N36	301 - 411 High Street	Oakland	Arco Products Co	MW1B	1.91	23	10	2	MON		
182		2S/3W	8N37	301 - 411 High Street	Oakland	Arco Products Co	MW2B	1.91	23	10	2	MON		
183		2S/3W	8N38	301 - 411 High Street	Oakland	Arco Products Co	MW3B	1.91	23	10	2	MON		
184		2S/3W	8N39	301 - 411 High Street	Oakland	Arco Products Co	MW4B	1.91	23	10	2	MON		
185		2S/3W	8N40	301 - 411 High Street	Oakland	Arco Products Co	MW5B	1.91	23	10	2	MON		
186		2S/3W	8N41	301 - 411 High Street	Oakland	Arco Products Co	MW6B	1.91	25	9	2	MON		
187		2S/3W	8N42	301 - 411 High Street	Oakland	Arco Products Co	MW1A	1.91	8	4	2	MON		
188		2S/3W	8N43	301 - 411 High Street	Oakland	Arco Products Co	MW2A	1.91	8	4	2	MON		
189		2S/3W	8N44	301 - 411 High Street	Oakland	Arco Products Co	MW3A	1.91	8	0	2	MON		
190		2S/3W	8N45	301 - 411 High Street	Oakland	Arco Products Co	MW4A	1.91	7	4	2	MON		
191		2S/3W	8N46	411 High Street	Oakland	Unocal Chemicals Division		4.91	15	5	2	MON		
192		2S/3W	8N47	411 High Street	Oakland	Unocal Chemicals Division		3.91	16	15	8	BOR*		
193		2S/3W	8N48	411 High Street	Oakland	Unocal Chemicals Division		4.91	8	4	2	MON		
194		2S/3W	8N49	411 High Street	Oakland	Unocal Chemicals Division		4.91	29	10	2	MON		
195		2S/3W	8N50	411 High Street	Oakland	Unocal Chemicals Division		4.91	9	4	2	MON		
196		2S/3W	8N51	411 High Street	Oakland	Unocal Chemicals Division		4.91	29	10	2	MON		
197		2S/3W	8N52	500 High St	Oakland	Uecker and Associates		3.91	18	5	4	MON		
198		2S/3W	8N53	500 High St	Oakland	Uecker and Associates	3.91	127	70	5	DOM		Approx 70 Feet NE to Property Line From Subject Site UST	
199		2S/3W	8N54	500 High St	Oakland	Uecker and Associates		3.91	24	5	4	MON		
200		2S/3W	8N55	500 High St	Oakland	Uecker and Associates		3.91	25	4	4	MON		
201		2S/3W	8N56	401 High St	Oakland	Unocal Chem	MW3C	9.91	50	12	2	MON	Approx 620 Feet WSW of Subject Site	
202		2S/3W	8N57	401 High St	Oakland	Unocal Chem	MW1C	9.91	50	11	2	MON	Approx 620 Feet WSW of Subject Site	
203		2S/3W	8N58	401 High St	Oakland	Unocal Chem	MW3C	9.91	50	12	2	MON	Approx 620 Feet WSW of Subject Site	
204		2S/3W	8N59	411 High St	Oakland	Former Arco Prod.	11B	7.91	24	9	2	MON		
205		2S/3W	8N60	411 High St	Oakland	Former Arco Prod.	10B	7.91	27	9	2	MON		
206		2S/3W	8N61	411 High St	Oakland	Former Arco Prod.	9B	7.91	24	7	2	MON		
207		2S/3W	8N62	411 High St	Oakland	Former Arco Prod.	7B	7.91	24	11	2	MON		
208		2S/3W	8N63	411 High St	Oakland	Former Arco Prod.	1B	7.91	32	9	4	MON		
209		2S/3W	8N64	500 High St	Oakland	Sectras Corp	MW-6	3.92	25	6	4	MON		
210		2S/3W	8N65	401 High St	Oakland	Unocal Chem	MW4C	3.92	47	8	2	MON		
211		2S/3W	8N66	401 High St	Oakland	Unocal Chem	MW5C	3.92	45	8	2	MON		
212		2S/3W	8N67	500 High St	Oakland	Security Pacific	MW-4	Nov-91	20	0	0	DES		
213		2S/3W	8N68	500 High St	Oakland	Security Pacific	MW-5	Nov-91	22	10	4	MON		
214		2S/3W	8N69	301 - 411 High St	Oakland	ARCO Products Co	MW5A	1.91	5	0	2	MON		
215		2S/3W	8N70	301 - 411 High St	Oakland	ARCO Products Co	MW6A	1.91	8	0	2	MON		
216		2S/3W	8N71	301 - 411 High St	Oakland	ARCO Products Co	MW12B	7.91	24	0	2	MON		
217		2S/3W	8N72	301 - 411 High St	Oakland	ARCO Products Co	ARW1B	7.91	32	9	4	OTH		
218		2S/3W	8N73	401 High St.	Oakland	Unocal Chem.	RW2	3.93	31	0	5	EXT		
219		2S/3W	8N74	401 High St.	Oakland	Unocal Chem.	RW3	3.93	29	0	5	EXT		
220		2S/3W	8N75	401 High St.	Oakland	Unocal Chem.	RW4	3.93	31	0	5	EXT		
221		2S/3W	8N76	401 High St.	Oakland	Unocal Chem.	RW5	3.93	29	0	5	EXT		
222		2S/3W	8N77	401 High St.	Oakland	Unocal Chem.	RW6	3.93	29	0	5	EXT		
223		2S/3W	8N78	401 High St.	Oakland	Unocal Chem.	RW7	3.93	31	0	5	EXT		
224		2S/3W	8N79	401 High St.	Oakland	Unocal Chem.	RW8	3.93	30	0	5	EXT		
225		2S/3W	8N80	401 High St.	Oakland	Unocal Chem.	RW9	3.93	33	0	5	EXT		
226		2S/3W	8N81	401 High St.	Oakland	Unocal Chem.	RW10	3.93	31	0	5	EXT		
227		2S/3W	8N82	4341 Howard St	Oakland	Jim Minor		6.93	20	11	2	MON		
228		2S/3W	8N83	500 High St	Oakland	Bank of America		9.95	17	0	4	MON		
229	95545	2S/3W	8P	720 High Street	Oakland	Exxon		Dec-90	22	0	12	DES		
230		2S/3W	8P	720 High Street	Oakland	Exxon Corporation		Nov-89	13	10	8	BOR*		
231		2S/3W	8P	744 High Street	Oakland	Southern Pacific Railroad		Nov-89	7	0	6	BOR*		
232		2S/3W	8P 1	720 High Street	Oakland	Exxon Corporation		5.88	29	10	4	MON		
233	90717	2S/3W	8P 19	Coliseum Wy & 45th Ave	Oakland	PG&E	Dec-90	120	0	2	CAT		Approx 700 Feet NE of Subject Site	
234		2S/3W	8P 2	720 High Street	Oakland	Exxon Corporation		9.88	35	13	4	MON		
235		2S/3W	8P 3	720 High Street	Oakland	Exxon Corporation		9.88	35	11	4	MON		
236		2S/3W	8P 4	720 High Street	Oakland	Exxon Corporation		9.88	35	12	4	MON		
237		2S/3W	8P 5	720 High Street	Oakland	Exxon Corporation		9.88	33	13	4	MON		
238		2S/3W	8P 6	720 High Street	Oakland	Exxon Corporation		9.88	35	13	4	MON		
239		2S/3W	8P 7	720 High Street	Oakland	Exxon Corporation		9.88	35	13	4	MON		
240		2S/3W	8P 8	720 High Street	Oakland	Exxon Corporation		9.88	35	12	4	MON		
241		2S/3W	8P 9	720 High Street	Oakland	Exxon Corporation		5.89	32	10	4	MON		
242		2S/3W	8P10	720 High Street	Oakland	Exxon Corporation		Nov-89	25	9	4	MON		
243		2S/3W	8P11	720 High Street	Oakland	Exxon Corporation		Nov-89	15	8	4	MON		
244		2S/3W	8P12	720 High Street	Oakland	Exxon Corporation		Nov-89	30	11	4	MON		
245		2S/3W	8P13	720 High Street	Oakland	Exxon Corporation		Nov-89	15	9	4	MON		
246		2S/3W	8P14	744 High Street	Oakland	Southern Pacific Railroad		Nov-89	25	9	2	MON		
247		2S/3W	8P15	744 High Street	Oakland	Southern Pacific Railroad		Nov-89	19	9	2	MON		
248		2S/3W	8P16	744 High Street	Oakland	Southern Pacific Railroad		Nov-89	24	9	2	MON	391242	
249		2S/3W	8P17	720 High St.	Oakland	Exxon		Dec-90	45	19	2	MON		

Alameda County Public Works Agency Well Summary Information

Assigned ACPWA Well Number	Permit Number	Township and Range	Section and Tract	Address	City	Owner	Drill Date	Total Depth (Feet)	Water Depth (Feet)	Diameter (Inches)	Use	WCR #	Comments
250		2S/3W	8P18	720 High St.	Oakland	Exxon	Oct-90	17	9	4	TES		
251		2S/3W	8P19	4800 Coliseum Way	Oakland	Superior Plaster Cast. 1A	Dec-92	19	6	2	MON		
252	93641	2S/3W	8P20	715 46th Av	Oakland	Pacific Galvanizing	Dec-93	20	17	2	MON		
253	94067	2S/3W	8P21	768 46th Ave	Oakland	Lerner Investment Co.	2/94	14	6	2	TES		
254	94067	2S/3W	8P22	768 46th Ave	Oakland	Lerner Investment Co.	2/94	15	5	2	TES		
255	94067	2S/3W	8P23	768 46th Ave	Oakland	Lerner Investment Co.	2/94	13	7	2	TES		
256		2S/3W	8Q	4930 COLISEUM WAY	Oakland	PG&E	May-89	12	0	0	BOR		
257		2S/3W	8Q	744 HIGH ST.	Oakland	SOUTHERN PACIFIC TRANS.	Sep-89	15	7	8	BOR		
258		2S/3W	8Q 2	4930 COLISEUM WAY	Oakland	PG&E	Mar-88	18	5	2	MON		
259		2S/3W	8Q 3	4930 COLISEUM WAY	Oakland	PG&E	Mar-88	19	4	2	MON		
260		2S/3W	8Q 4	4930 COLISEUM WAY	Oakland	PG&E	Mar-88	19	5	2	MON		
261		2S/3W	8Q 5	4930 COLISEUM WAY	Oakland	PG&E	May-89	27	11	2	MON		
262		2S/3W	8Q 8	4930 Coliseum Way	Oakland	Pacific Gas & Elec OW-6	Dec-91	19	7	2	MON		
263		2S/3W	8Q 9	4930 Coliseum Way	Oakland	Pacific Gas & Elec OW-7	Dec-91	18	8	2	MON		
264		2S/3W	17B	750 50th Avenue	Oakland	Volvo-GM/White	9/90	29	17	2	MON		
265		2S/3W	17B 1	COLISEUM WY & 50TH AVE	Oakland	EBMUD	Oct-86	65	0	0	CAT		Approx 1,900 Feet ESE of Subject Site
266		2S/3W	17B 2	750 50th Avenue	Oakland	Volvo-GM/White	Oct-90	20	11	2	MON		
267		2S/3W	17B 3	750 50th Avenue	Oakland	Volvo-GM/White	9/90	28	16	2	MON		
268		2S/3W	17B 4	750 50th Avenue	Oakland	Volvo-GM/White	9/90	27	11	2	MON		
269		2S/3W	17B 5	750 50th Avenue	Oakland	Volvo-GM/White	9/90	27	10	2	MON		
270		2S/3W	17B 6	4930 Coliseum Way	Oakland	PG&E	2/91	15	4	2	MON		
271		2S/3W	17B14	4930 Coliseum Way	Oakland	PG&E OW-3	Nov-91	19	0	0	ABN		
272		2S/3W	17B15	4930 COLISEUM WAY	Oakland	PG&E OW-8	2/93	18	8	2	MON		
273		2S/3W	17B28	750 50th Av	Oakland	Volvo GM Heavy Truck Corp	Oct-93	15	7	4	MON		
274		2S/3W	17B29	750 50th Av	Oakland	Volvo GM Heavy Truck Corp	Oct-93	20	5	4	MON		
275	95709	2S/3W	17B38	5051 Coliseum Way	Oakland	Pacific Gas & Electric	Dec-95	19	9	2	MON		
276	95709	2S/3W	17B39	5051 Coliseum Way	Oakland	Pacific Gas & Electric	Dec-95	19	9	2	MON		
277	95709	2S/3W	17B40	5051 Coliseum Way	Oakland	Pacific Gas & Electric	Dec-95	19	9	2	MON		
278	95709	2S/3W	17B41	5051 Coliseum Way	Oakland	Pacific Gas & Electric	Dec-95	19	13	2	MON		
279	95709	2S/3W	17B42	5051 Coliseum Way	Oakland	Pacific Gas & Electric	Dec-95	19	9	2	MON		
280		2S/3W	17C 1	4801 OAKPORT STREET	Oakland	PG&E OAKLAND SVCE CTR	Nov-87	7	5	2	PIE		
281		2S/3W	17C 2	4801 OAKPORT STREET	Oakland	PG&E OAKLAND SVCE CTR	Nov-87	7	0	2	PIE		
282		2S/3W	17C 3	4801 OAKPORT STREET	Oakland	PG&E OAKLAND SVCE CTR	Nov-87	7	0	2	PIE		
283		2S/3W	17C 4	4801 Oakport St.	Oakland	PG&E (Service Station)	Oct-90	27	12	4	MON		
284		2S/3W	17C 5	4801 Oakport St.	Oakland	PG&E (Service Station)	Oct-90	9	5	2	MON		
285		2S/3W	17C 6	4801 Oakport St.	Oakland	PG&E (Service Station)	Oct-90	9	7	2	MON		
286		2S/3W	17C 7	4801 Oakport St	Oakland	Pacific Gas & Elec P7	9/91	10	7	2	MON		
287		2S/3W	17C 8	4801 Oakport St	Oakland	Pacific Gas & Elec P8	9/91	10	5	2	MON		
288		2S/3W	17C 9	488 Lesser Ave	Oakland	Clarklift GA-5	8/91	27	11	4	MON		
289		2S/3W	17C10	488 Lesser Ave	Oakland	Clarklift GA-6	8/91	22	11	4	MON		
290		2S/3W	17C11	488 Lesser Ave	Oakland	Clarklift GA-7	8/91	22	8	4	MON		
291		2S/3W	17C12	488 Lesser Ave	Oakland	Clarklift GA-8	8/91	22	11	4	MON		
292		2S/3W	17C13	4905 Tidewater Ave	Oakland	Bob Swinford (MW-1)	8/93	20	13	2	MON		
293		2S/3W	17C14	4919 Tidewater Av	Oakland	DiSalvo Trucking	4/94	8	5	2	MON		
294		2S/3W	17C15	4919 Tidewater Av	Oakland	DiSalvo Trucking	4/94	8	5	2	MON		
295		2S/3W	17C16	4701 Oakport St	Oakland	East Bay Clarklift	Dec-95	25	0	2	MON		
296		2S/3W	17C17	4701 Oakport St	Oakland	East Bay Clarklift	Dec-95	25	0	4	MON		
297		2S/3W	17C18	4701 Oakport St	Oakland	East Bay Clarklift	Dec-95	25	0	2	MON		
298		2S/3W	17C19	4701 Oakport St	Oakland	East Bay Clarklift	Dec-95	25	0	2	MON		
299	95702	2S/3W	17C20	4801 Oakport Rd	Oakland	PG & E	Oct-95	10	7	2	MON		
300	95702	2S/3W	17C21	4801 Oakport Rd	Oakland	PG & E	Oct-95	10	6	2	MON		
301		2S/3W	18A 1	3126 FERNSIDE BL/GIBBON D	Alameda	CHEVRON SERVICE STA	Aug-86	23	3	3	MON		
302		2S/3W	18A 2	3126 FERNSIDE BL/GIBBON D	Alameda	CHEVRON SERVICE STA	Aug-86	22	3	3	MON		
303		2S/3W	18A 3	3126 FERNSIDE BL/GIBBON D	Alameda	CHEVRON SERVICE STA	Aug-86	22	3	3	MON		
304		2S/3W	18A 4	3126 FERNSIDE BLVD	Alameda	CHEVRON USA	9/90	30	13	6	MON		
305		2S/3W	18A 5	3126 Fernside Blvd.	Alameda	Chevron USA Inc. MW-4	5/92	17	4	2	MON		
306		2S/3W	18A 6	3126 Fernside Blvd.	Alameda	Chevron USA Inc. MW-5	5/92	17	3	2	MON		
307		2S/3W	18A 7	3126 Fernside Blvd.	Alameda	Chevron USA Inc. MW-6	5/92	17	4	2	MON		
308		2S/3W	18A 8	3126 Fernside Blvd	Alameda	Chevron USA, Inc	Nov-93	15	7	2	MON		
309	95663	2S/3W	18A 9	3126 Fernside	Alameda	Chevron USA	Oct-95	9	4	2	MON		
310	95663	2S/3W	18A10	3126 Fernside	Alameda	Chevron USA	Oct-95	9	4	2	MON		

Well Legend

DOM=Domestic well

IRR=Irrigation well

MUN= Municipal well

IND=Industrial well

CAT=Cathodic well

DES=well destroyed (through permit)

ABN=Abandoned and not being used (but has not been destroyed through permit process)

TES=Test well

BOR= Geotechnical investigation

MON= Monitoring well

EXT=Extraction/ Vapor wells

PIE=Piezometers

REC=Recovery well (extraction/ vapor)

? = Unknown or no information found or given

Department of Water Resources Well Summary Information

Assigned DWR Well Number	Township and Range	Section	Tract	Log Number	Image Filename	Owner Name	City	Completion Date	Use	Casing Diameter (Inches)	Total Depth (Feet)	Comments
1	02S03W	8		01-237A	51297031.tif	CLOROX COMPANY	OAKLAND	10/03/1986	Monitoring	2	55	boring log for well 23R; Approx 1,400 Feet NNE of Subject Site
2	02S03W	8		01-237B	51297032.tif	CLOROX COMPANY	OAKLAND	09/22/1986	Monitoring	2	29	boring log for well 45R
3	02S03W	8		01-237C	51297033.tif	CLOROX COMPANY	OAKLAND	09/17/1986	Monitoring	2	28	boring log for well 49
4	02S03W	8		01-237D	51297034.tif	CLOROX COMPANY	OAKLAND	09/17/1986	Monitoring	2	25	boring log for well 50
5	02S03W	8		01-237G	51297035.tif	CLOROX COMPANY	OAKLAND	09/23/1986	Monitoring	2	30	boring log for well 51
6	02S03W	8		01-237F	51297036.tif	CLOROX COMPANY	OAKLAND	09/11/1986	Monitoring	2	25	boring log for well 52
7	02S03W	8		107435	51297002.tif	CLOROX CORPORATION	OAKLAND	07/25/1982	Monitoring	2	236	DWR report for well B-40; Approx 1,400 Feet NNE of Subject Site
8	02S03W	8		209080	51297003.tif	CLOROX CORPORATION	OAKLAND	08/05/1982	Monitoring	2	20	DWR report for well 23-A
9	02S03W	8		209082	51297004.tif	CLOROX CORPORATION	OAKLAND	09/21/1982	Monitoring	2	25	DWR report for well B-24B
10	02S03W	8		209083	51297005.tif	CLOROX CORPORATION	OAKLAND	08/06/1982	Monitoring	2	21	DWR report for well B-26
11	02S03W	8		209084	51297006.tif	CLOROX CORPORATION	OAKLAND	10/18/1982	Monitoring	2	21	DWR report for well 30
12	02S03W	8		209097	51297007.tif	CLOROX CORPORATION	OAKLAND	08/09/1982	Monitoring	2	21	DWR report for well B-20
13	02S03W	8		209078	51297008.tif	CLOROX CORPORATION	OAKLAND	07/28/1982	Monitoring	2	86	DWR report for well B-22; Approx 1,400 Feet NNE of Subject Site
14	02S03W	8		209079	51297009.tif	CLOROX CORPORATION	OAKLAND	07/30/1982	Monitoring	2	86	DWR report for well B-23; Approx 1,400 Feet NNE of Subject Site
15	02S03W	8		107436	51297010.tif	CLOROX CORPORATION	OAKLAND	09/21/1982	Monitoring	2	244	DWR report for well B-41; Approx 1,400 Feet NNE of Subject Site
16	02S03W	8		209081	51297011.tif	CLOROX CORPORATION	OAKLAND	08/05/1982	Monitoring	2	76	DWR report for well B-24A; Approx 1,400 Feet NNE of Subject Site
17	02S03W	8		209099	51297012.tif	CLOROX CORPORATION	OAKLAND		Monitoring	2	40	DWR report for well B-21
18	02S03W	8		209098	51297013.tif	CLOROX CORPORATION	OAKLAND	08/10/1982	Monitoring	2	76	DWR report for well B-20A ; Approx 1,400 Feet NNE of Subject Site
19	02S03W	8		210098A	51297014.tif	CLOROX CORPORATION	OAKLAND	05/20/1987	DESTROYED	2	76	Letter re: destruction of well 20A (see above)
20	02S03W	8		209100	51297015.tif	CLOROX CORPORATION	OAKLAND	08/04/1982	Monitoring	2	86	DWR report for well B-21A; Approx 1,400 Feet NNE of Subject Site
21	02S03W	8		01-226A	51297024.tif	COMMERCIAL FUELING	OAKLAND	10/24/1986	Monitoring	2	12	figure - site location map
22	02S03W	8	L	256936	51297037.tif	EXXON COMPANY	OAKLAND	09/16/1987	Monitoring	4	36	DWR report for well B-7/MW-7
23	02S03W	8	L	256937	51297038.tif	EXXON COMPANY	OAKLAND	09/16/1987	Monitoring	4	36	DWR report for well B-8/MW-8
24	02S03W	8	L	256930	51297042.tif	EXXON COMPANY	OAKLAND	09/16/1987	Monitoring	4	36	DWR report for well B-2/MW-2
25	02S03W	8	L	256931	51297044.tif	EXXON COMPANY	OAKLAND	09/16/1987	Monitoring	4	36	DWR report for well B-3/MW-3
26	02S03W	8	L	256932	51297045.tif	EXXON COMPANY	OAKLAND	09/16/1987	Monitoring	4	36	DWR report for well B-4/MW-4
27	02S03W	8	L	256934	51297046.tif	EXXON COMPANY	OAKLAND	09/16/1987	Monitoring	4	36	DWR report for well B-5/MW-5
28	02S03W	8	L	256935	51297047.tif	EXXON COMPANY	OAKLAND	09/16/1987	Monitoring	4	36	DWR report for well B-6/MW-6
29	02S03W	8	L	256930	51297043.tif	EXXON COMPANY	OAKLAND	09/16/1987	Monitoring	4	36	figure - site plan
30	02S03W	8	L	01-406P	51297040.tif	EXXON COMPANY 7-3006	OAKLAND	05/21/1988	Monitoring	4	29	boring log for B-1/MW-1
31	02S03W	8	L	01-406P	51297039.tif	EXXON COMPANY 7-3006	OAKLAND	05/21/1988	Monitoring	4	29	figure - site plan
32	02S03W	8	L	01-406Q	51297041.tif	EXXON COMPANY 7-3006	OAKLAND	Unknown	Monitoring	Unknown	32	Page 2 only of boring log for B-9/MW-9 (see site plan directly above)
33	02S03W	8	L	818004	51297048.tif	EXXON COMPANY 7-3006	OAKLAND	7/18/1989	DESTROYED	Unknown	Unknown	DWR report for well MW-5 destruction
34	02S03W	17		01-531Q	51327052.tif	CLARKLIFT	OAKLAND	08/26/1991	Monitoring	4	27	boring log for well GA-5
35	02S03W	17		01-531R	51327053.tif	CLARKLIFT	OAKLAND	08/26/1991	Monitoring	4	22	figure - well & borehole location map
36	02S03W	17		01-531S	51327054.tif	CLARKLIFT	OAKLAND	08/26/1991	Monitoring	4	22	figure - well & borehole location map
37	02S03W	17		01-531T	51327055.tif	CLARKLIFT	OAKLAND	08/26/1991	Monitoring	4	22	figure - well & borehole location map
38	02S03W	17		197036	51327031.tif	EAST BAY M U D	OAKLAND	10/20/1986	Cathodic Protection	0	65	DWR report for CP well 5; Approx 1,900 Feet ESE of Subject Site
39	02S03W	17		316537	51327077.tif	GALLAGHER BANK	OAKLAND	07/15/1991	Monitoring	0	29	DWR report for well MW-1
40	02S03W	17		01-279B	51327056.tif	PACIFIC GAS & ELECT	OAKLAND	11/24/1987	Monitoring	2	8	site sketch - piezometer locations
41	02S03W	17		01-279A	51327057.tif	PACIFIC GAS & ELECT	OAKLAND	11/24/1987	Monitoring	2	8	site sketch - piezometer locations
42	02S03W	17		01-279C	51327058.tif	PACIFIC GAS & ELECT	OAKLAND	11/24/1987	Monitoring	2	8	site sketch - piezometer locations
43	02S03W	17		281048	51327059.tif	PACIFIC GAS & ELECT	OAKLAND	10/29/1990	Monitoring	2	11	DWR report for piezometer P4
44	02S03W	17		281049	51327060.tif	PACIFIC GAS & ELECT	OAKLAND	10/23/1990	Monitoring	2	15	DWR report for piezometer P5
45	02S03W	17		281050	51327061.tif	PACIFIC GAS & ELECT	OAKLAND	10/22/1990	Monitoring	2	15	DWR report for piezometer P6
46	02S03W	17		585399	51327062.tif	SWINFORD, BOB	OAKLAND	08/18/1993	Monitoring	2	21	DWR report for well MW-1
47	02S03W	17		303286	51327066.tif	TIDEWATER BUS PARK	OAKLAND	04/12/1990	DESTROYED	0	6	DWR report for well MW-TBP1 destruction
48	02S03W	17		303287	51327068.tif	TIDEWATER BUS PARK	OAKLAND	04/12/1990	DESTROYED	0	10	DWR report for well MW-TBP2 destruction
49	02S03W	17		303288	51327070.tif	TIDEWATER BUS PARK	OAKLAND	04/12/1990	DESTROYED	0	6	DWR report for well MW-TBP3 destruction
50	02S03W	17		303289	51327072.tif	TIDEWATER BUS PARK	OAKLAND	04/12/1990	DESTROYED	0	7	DWR report for well MW-TBP4 destruction
51	02S03W	17		303290	51327074.tif	TIDEWATER BUS PARK	OAKLAND	04/12/1990	DESTROYED	0	5	DWR report for well MW-TBP5 destruction
52	02S03W	17		303291	51327076.tif	TIDEWATER BUS PARK	OAKLAND	04/12/1990	DESTROYED	0	5	DWR report for well MW-TBP6 destruction
53	02S03W	17		303276	51327065.tif	TIDEWATER BUSINESS	OAKLAND	02/05/1990	Monitoring	2	9	DWR report for well MW-TBP1
54	02S03W	17		303279	51327067.tif	TIDEWATER BUSINESS	OAKLAND	02/06/1990	Monitoring	2	12	DWR report for well MW-TBP2
55	02S03W	17		303280	51327069.tif	TIDEWATER BUSINESS	OAKLAND	02/06/1990	Monitoring	2	8	DWR report for well MW-TBP3
56	02S03W	17		303281	51327071.tif	TIDEWATER BUSINESS	OAKLAND	02/06/1990	Monitoring	2	8	DWR report for well MW-TBP4
57	02S03W	17		303282	51327073.tif	TIDEWATER BUSINESS	OAKLAND	02/06/1990	Monitoring	2	5	DWR report for well MW-TBP5
58	02S03W	17		303278	51327075.tif	TIDEWATER BUSINESS	OAKLAND	02/06/1990	Monitoring	2	6	DWR report for well MW-TBP6
59	02S03W	17		362184	51327042.tif	VOLVO-GM HEAVY TRUCK	OAKLAND	10/03/1991	Monitoring	2	21	DWR report for well LF-1
60	02S03W	17		362185	51327043.tif	VOLVO-GM HEAVY TRUCK	OAKLAND	10/29/1991	Monitoring	2	16	DWR report for well LF-2
61	02S03W	17		362186	51327044.tif	VOLVO-GM HEAVY TRUCK	OAKLAND	10/30/1991	Monitoring	2	16	DWR report for well LF-3
62	02S03W	17		362189	51327045.tif	VOLVO-GM HEAVY TRUCK	OAKLAND	10/29/1991	Monitoring	2	21	DWR report for well LF-4
63	02S03W	17		362190	51327046.tif	VOLVO-GM HEAVY TRUCK	OAKLAND	10/29/1991	Monitoring	2	24	DWR report for well LF-5
64	02S03W	17		107248	51327047.tif	VOLVO-GM HEAVY TRUCK	OAKLAND	10/28/1991	Monitoring	2	21	DWR report for well LF-6
65	02S03W	17		107249	51327048.tif	VOLVO-GM HEAVY TRUCK	OAKLAND	10/28/1991	Monitoring	2	25	DWR report for well LF-7

Department of Water Resources Well Summary Information

Assigned DWR Well Number	Township and Range	Section	Tract	Log Number	Image Filename	Owner Name	City	Completion Date	Use	Casing Diameter (Inches)	Total Depth (Feet)	Comments
66	02S03W	17		01-479A	51327032.tif	VOLVO-GM/WHITE	OAKLAND	09/05/1990	Monitoring	2	28	figure - well & borehole location map
67	02S03W	17		01-479B	51327033.tif	VOLVO-GM/WHITE	OAKLAND	09/05/1990	Monitoring	2	27	Boring Log for well MW-2
68	02S03W	17		01-479C	51327034.tif	VOLVO-GM/WHITE	OAKLAND	09/05/1990	Monitoring	2	27	Boring Log for well MW-3
69	02S03W	17		01-479D	51327035.tif	VOLVO-GM/WHITE	OAKLAND	09/05/1990	Monitoring	2	29	Boring Log for well MW-4
70	02S03W	17		396088	51327078.tif	WHITE, DON	OAKLAND	04/02/1993	Monitoring	2	13	DWR report for unspecified well
71	02S03W	18		261762	51327131.tif	CHEVRON U S A	ALAMEDA	12/07/1990	Extraction	6	9.5	DWR report for well RW1 TD of 9.5 Feet; incorrect TD given by DWR
72	02S03W	18		01-179A	51327132.tif	CHEVRON U S A	ALAMEDA	08/18/1986	Monitoring	3	23	transmittal letter
73	02S03W	18		01-179B	51327134.tif	CHEVRON U S A	ALAMEDA	08/18/1986	Monitoring	3	22	transmittal letter
74	02S03W	18		01-179C	51327135.tif	CHEVRON U S A	ALAMEDA	08/18/1986	Monitoring	3	22	transmittal letter
75	02S03W	18		01-526D	51327137.tif	CHEVRON U S A	ALAMEDA	5/15/1992	Monitoring	2	12	Boring Log for well MW-4
76	02S03W	18		01-526F	51327140.tif	CHEVRON U S A	ALAMEDA	5/15/1992	Monitoring	2		Boring Log for well MW-6
77	02S03W	07A-J		01-222A	51256056.tif	OWENS-ILLINOIS	OAKLAND	09/12/1986	Monitoring	2	30	Boring Log for well MW-1
78	02S03W	07A-J		01-222B	51256057.tif	OWENS-ILLINOIS	OAKLAND	09/12/1986	Monitoring	2	30	figure - survey map
79	02S03W	07A-J		01-222C	51256059.tif	OWENS-ILLINOIS	OAKLAND	09/12/1986	Monitoring	2	31	figure - survey map
80	02S03W	07A-J		01-222D	51256060.tif	OWENS-ILLINOIS	OAKLAND	09/29/1986	Monitoring	2	30	figure - survey map
81	02S03W	07A-J		01-222E	51256061.tif	OWENS-ILLINOIS	OAKLAND	09/29/1986	Monitoring	2	30	figure - survey map
82	02S03W	07A-J		01-222F	51256062.tif	OWENS-ILLINOIS	OAKLAND	09/29/1986	Monitoring	2	30	figure - survey map
83	02S03W	07A-J		01-222G	51256063.tif	OWENS-ILLINOIS	OAKLAND	09/30/1986	Monitoring	2	25	figure - survey map
84	02S03W	07A-J		01-222H	51256064.tif	OWENS-ILLINOIS	OAKLAND	10/22/1986	Monitoring	2	30	figure - survey map
85	02S03W	07A-J		01-222I	51256065.tif	OWENS-ILLINOIS	OAKLAND	10/22/1986	Monitoring	2	25	figure - survey map
86	02S03W	07A-J		01-273C	51256067.tif	OWENS-ILLINOIS GLASS	OAKLAND	09/12/1986	Monitoring	2	31	figure - wells
87	02S03W	07A-J		01-273B	51256068.tif	OWENS-ILLINOIS GLASS	OAKLAND	09/12/1986	Monitoring	2	30	figure - wells
88	02S03W	07A-J		01-273D	51256069.tif	OWENS-ILLINOIS GLASS	OAKLAND	09/29/1986	Monitoring	2	30	figure - wells
89	02S03W	07A-J		01-273E	51256070.tif	OWENS-ILLINOIS GLASS	OAKLAND	09/29/1986	Monitoring	2	30	figure - wells
90	02S03W	07A-J		01-273F	51256071.tif	OWENS-ILLINOIS GLASS	OAKLAND	09/29/1986	Monitoring	2	30	figure - wells
91	02S03W	07A-J		01-273G	51256072.tif	OWENS-ILLINOIS GLASS	OAKLAND	09/30/1986	Monitoring	2	25	figure - wells
92	02S03W	07A-J		01-273H	51256073.tif	OWENS-ILLINOIS GLASS	OAKLAND	10/22/1986	Monitoring	2	30	figure - wells
93	02S03W	07A-J		01-273I	51256074.tif	OWENS-ILLINOIS GLASS	OAKLAND	07/23/1986	Monitoring	2	26	figure - wells
94	02S03W	07A-J		01-273J	51256075.tif	OWENS-ILLINOIS GLASS	OAKLAND	10/22/1986	Monitoring	2	25	figure - wells
95	02S03W	07A-J		01-273K	51256076.tif	OWENS-ILLINOIS GLASS	OAKLAND	11/24/1986	Monitoring	2	32	figure - wells
96	02S03W	07A-J		01-273L	51256077.tif	OWENS-ILLINOIS GLASS	OAKLAND	11/24/1986	Monitoring	2	27	figure - wells
97	02S03W	07A-J		01-273M	51256078.tif	OWENS-ILLINOIS GLASS	OAKLAND	12/11/1986	Monitoring	2	27	figure - wells
98	02S03W	07A-J		01-273N	51256079.tif	OWENS-ILLINOIS GLASS	OAKLAND	11/25/1986	Monitoring	2	27	figure - wells
99	02S03W	07A-J		01-273P	51256081.tif	OWENS-ILLINOIS GLASS	OAKLAND	12/12/1986	Monitoring	2	25	figure - wells
100	02S03W	07A-J		01-273Q	51256082.tif	OWENS-ILLINOIS GLASS	OAKLAND	12/15/1986	Monitoring	2	25	figure - wells
101	02S03W	07A-J		01-273R	51256083.tif	OWENS-ILLINOIS GLASS	OAKLAND	12/15/1986	Extraction	2	25	figure - wells
102	02S03W	07A-J		405236A	51256084.tif	UNOCAL	OAKLAND	12/06/1991	Monitoring	3	10	DWR report for wells VMW1-VMW5, VMW7-VMW8
103	02S03W	07A-J		405236B	51256085.tif	UNOCAL	OAKLAND	12/06/1991	Monitoring	3	10	DWR report for wells VMW1-VMW5, VMW7-VMW8
104	02S03W	07A-J		405236C	51256087.tif	UNOCAL	OAKLAND	12/06/1991	Monitoring	3	10	boring log for well VMW3
105	02S03W	07A-J		405236D	51256088.tif	UNOCAL	OAKLAND	12/06/1991	Monitoring	3	10	boring log for well VMW4
106	02S03W	07A-J		405236E	51256089.tif	UNOCAL	OAKLAND	12/06/1991	Monitoring	3	9	boring log for well VMW5
107	02S03W	07A-J		405236F	51256090.tif	UNOCAL	OAKLAND	12/02/1991	Monitoring	3	11	boring log for well VMW7
108	02S03W	07A-J		405236G	51256091.tif	UNOCAL	OAKLAND	12/02/1991	Monitoring	3	11	DWR report for wells VMW1-VMW5, VMW7-VMW8
109	02S03W	07A-J		405236	51256086.tif	UNOCAL	OAKLAND	12/02/1991	Monitoring	3	11	DWR report for wells VMW1-VMW5, VMW7-VMW8
110	02S03W	08N-08P		01-506I	51277037.tif	ARCO PRODUCTS CO	OAKLAND	07/26/1991	Monitoring	2	24	Site location map
111	02S03W	08N-08P		01-506J	51277038.tif	ARCO PRODUCTS CO	OAKLAND	07/25/1991	Monitoring	2	27	Site location map
112	02S03W	08N-08P		01-506K	51277039.tif	ARCO PRODUCTS CO	OAKLAND	07/29/1991	Monitoring	2	24	Site location map
113	02S03W	08N-08P		01-506L	51277040.tif	ARCO PRODUCTS CO	OAKLAND	07/29/1991	Monitoring	2	24	Site location map
114	02S03W	08N-08P		01-506M	51277041.tif	ARCO PRODUCTS CO	OAKLAND	07/30/1991	Monitoring	2	32	Site location map
115	02S03W	08N-08P		316524	51277030.tif	COBBLEDICK-KIBBE	OAKLAND	02/26/1991	Monitoring	4	24	DWR report for well MW-1
116	02S03W	08N-08P		316526	51277031.tif	COBBLEDICK-KIBBE	OAKLAND	02/26/1991	Monitoring	4	25	DWR report for well MW-2
117	02S03W	08N-08P		316525	51277032.tif	COBBLEDICK-KIBBE	OAKLAND	02/26/1991	Monitoring	4	25	DWR report for well MW-3
118	02S03W	08N-08P		316529	51277033.tif	COBBLEDICK-KIBBE	OAKLAND	03/25/1991	Monitoring	4	25	DWR report for well MW-4
119	02S03W	08N-08P		346810	51277101.tif	EXXON COMPANY	OAKLAND	10/31/1990	Monitoring	4	19	DWR report for well MW-15
120	02S03W	08N-08P		346811	51277102.tif	EXXON COMPANY	OAKLAND	10/31/1990	Monitoring	4	18	DWR report for well MW-14
121	02S03W	08N-08P		318051	51277085.tif	EXXON COMPANY 7-3006	OAKLAND	05/01/1988	Monitoring	4	29	DWR report for well MW-1
122	02S03W	08N-08P		318052	51277086.tif	EXXON COMPANY 7-3006	OAKLAND	09/01/1988	Monitoring	4	36	DWR report for well MW-2
123	02S03W	08N-08P		318053	51277087.tif	EXXON COMPANY 7-3006	OAKLAND	09/01/1988	Monitoring	4	36	DWR report for well MW-3
124	02S03W	08N-08P		318054	51277088.tif	EXXON COMPANY 7-3006	OAKLAND	09/01/1988	Monitoring	4	36	DWR report for well MW-4
125	02S03W	08N-08P		318055	51277089.tif	EXXON COMPANY 7-3006	OAKLAND	09/01/1988	Monitoring	4	36	DWR report for well MW-5
126	02S03W	08N-08P		318056	51277090.tif	EXXON COMPANY 7-3006	OAKLAND	09/01/1988	Monitoring	4	36	DWR report for well MW-6
127	02S03W	08N-08P		318058	51277091.tif	EXXON COMPANY 7-3006	OAKLAND	09/01/1988	Monitoring	4	36	DWR report for well MW-7
128	02S03W	08N-08P		318057	51277092.tif	EXXON COMPANY 7-3006	OAKLAND	09/01/1988	Monitoring	4	36	DWR report for well MW-8
129	02S03W	08N-08P		318031	51277093.tif	EXXON COMPANY 7-3006	OAKLAND	05/12/1988	Monitoring	4	33	DWR report for well MW-9
130	02S03W	08N-08P		318032	51277094.tif	EXXON COMPANY 7-3006	OAKLAND	11/27/1989	Monitoring	4	25	DWR report for well MW-10

Department of Water Resources Well Summary Information

Assigned DWR Well Number	Township and Range	Section	Tract	Log Number	Image Filename	Owner Name	City	Completion Date	Use	Casing Diameter (Inches)	Total Depth (Feet)	Comments
131	02S03W	08N-08P		318034	51277095.tif	EXXON COMPANY 7-3006	OAKLAND	11/28/1989	Monitoring	4	15	DWR report for well MW-12
132	02S03W	08N-08P		318033	51277096.tif	EXXON COMPANY 7-3006	OAKLAND	11/27/1989	Monitoring	4	30	DWR report for well MW-11
133	02S03W	08N-08P		318035	51277097.tif	EXXON COMPANY 7-3006	OAKLAND	11/28/1989	Monitoring	4	15	DWR report for well MW-13
134	02S03W	08N-08P		391242	51277056.tif	PACIFIC GAS & ELECT	OAKLAND	12/21/1990	Cathodic Protection	2	120	Approx 700 Feet NE of Subject Site
135	02S03W	08N-08P		316548	51277042.tif	SECTRAS CORPORATION	OAKLAND	03/16/1992	Monitoring	4	25	DWR report for well MW-6
136	02S03W	08N-08P		316574	51277054.tif	SECURITY PACIFIC BAN	OAKLAND	11/21/1991	DESTROYED	0	20	DWR report for well MW-4 destruction
137	02S03W	08N-08P		316543	51277055.tif	SECURITY PACIFIC BAN	OAKLAND	11/21/1991	Monitoring	4	22	DWR report for well MW-5
138	02S03W	08N-08P		01-446R	51277002.tif	SHELL OIL COMPANY	OAKLAND	08/15/1989	Monitoring	4	24	figure-site plan
139	02S03W	08N-08P		01-446S	51277003.tif	SHELL OIL COMPANY	OAKLAND	08/15/1989	Monitoring	4	24	figure-site plan
140	02S03W	08N-08P		01-452H	51277004.tif	SHELL OIL COMPANY	OAKLAND	11/15/1989	Monitoring	2	16	boring log for well MW-9
141	02S03W	08N-08P		01-452I	51277005.tif	SHELL OIL COMPANY	OAKLAND	11/15/1989	Monitoring	2	17	boring log for well MW-10
142	02S03W	08N-08P		01-436J	51277062.tif	SHELL OIL COMPANY	OAKLAND	04/25/1989	Monitoring	0	20	figure-site plan
143	02S03W	08N-08P		01-436K	51277063.tif	SHELL OIL COMPANY	OAKLAND	04/25/1989	Monitoring	0	25	figure-site plan
144	02S03W	08N-08P		01-436L	51277064.tif	SHELL OIL COMPANY	OAKLAND	04/25/1989	Monitoring	0	20	figure-site plan
145	02S03W	08N-08P		01-436M	51277065.tif	SHELL OIL COMPANY	OAKLAND	04/25/1989	Monitoring	0	22	figure-site plan
146	02S03W	08N-08P		01-436R	51277066.tif	SOUTHERN PACIFIC TRA	OAKLAND	05/24/1989	Monitoring	2	25	table-well const. details for 3 wells 25FeetTD
147	02S03W	08N-08P		01-436P	51277067.tif	SOUTHERN PACIFIC TRA	OAKLAND	05/23/1989	Monitoring	2	12	figure-site plan
148	02S03W	08N-08P		01-436Q	51277068.tif	SOUTHERN PACIFIC TRA	OAKLAND	05/23/1989	Monitoring	2	27	figure-site plan
149	02S03W	08N-08P		01-453A	51277098.tif	SOUTHERN PACIFIC TRA	OAKLAND	11/22/1989	Monitoring	2	26	figure-site plan
150	02S03W	08N-08P		01-453B	51277099.tif	SOUTHERN PACIFIC TRA	OAKLAND	11/21/1989	Monitoring	2	21	figure-site plan
151	02S03W	08N-08P		01-453C	51277100.tif	SOUTHERN PACIFIC TRA	OAKLAND	11/22/1989	Monitoring	2	26	figure-site plan
152	02S03W	08N-08P		01-535V	51277057.tif	SUPERIOR PLASTER CAS	OAKLAND	12/08/1992	Monitoring	2	19	transmittal-well const.
153	02S03W	08N-08P		362183	51277034.tif	UNOCAL CHEMICALS	OAKLAND	09/11/1991	Monitoring	2	50	DWR report for well MW3C; Approx 620 Feet WSW of Subject Site
154	02S03W	08N-08P		362181	51277035.tif	UNOCAL CHEMICALS	OAKLAND	09/12/1991	Monitoring	2	50	DWR report for well MW1C; Approx 620 Feet WSW of Subject Site
155	02S03W	08N-08P		362182	51277036.tif	UNOCAL CHEMICALS	OAKLAND	09/12/1991	Monitoring	2	50	DWR report for well MW2C; Approx 620 Feet WSW of Subject Site
156	02S03W	08N-08P		405238A	51277043.tif	UNOCAL CHEMICALS	OAKLAND	03/18/1992	Monitoring	2	47	DWR report for well MW4C & MW5C
157	02S03W	08N-08P		405238B	51277044.tif	UNOCAL CHEMICALS	OAKLAND	03/17/1992	Monitoring	2	45	DWR report for well MW4C & MW5C
158	02S03W	08N-08P		01-536M	51277045.tif	UNOCAL CHEMICALS	OAKLAND	03/30/1990	Extraction	5	31	WCD for well RW-2
159	02S03W	08N-08P		01-536N	51277046.tif	UNOCAL CHEMICALS	OAKLAND	03/29/1990	Extraction	5	29	WCD for well RW-3
160	02S03W	08N-08P		01-536O	51277047.tif	UNOCAL CHEMICALS	OAKLAND	03/29/1990	Extraction	5	31	WCD for well RW-4
161	02S03W	08N-08P		01-536P	51277048.tif	UNOCAL CHEMICALS	OAKLAND	03/30/1990	Extraction	5	29	WCD for well RW-5
162	02S03W	08N-08P		01-536Q	51277049.tif	UNOCAL CHEMICALS	OAKLAND	03/31/1990	Extraction	5	29	WCD for well RW-6
163	02S03W	08N-08P		01-536R	51277050.tif	UNOCAL CHEMICALS	OAKLAND	03/31/1990	Extraction	5	31	WCD for well RW-7
164	02S03W	08N-08P		01-536S	51277051.tif	UNOCAL CHEMICALS	OAKLAND	03/25/1990	Extraction	5	30	WCD for well RW-8
165	02S03W	08N-08P		01-536T	51277052.tif	UNOCAL CHEMICALS	OAKLAND	03/26/1990	Extraction	5	33	WCD for well RW-9
166	02S03W	08N-08P		01-536U	51277053.tif	UNOCAL CHEMICALS	OAKLAND	03/26/1990	Extraction	5	31	WCD for well RW-10
167	02S03W	08N-08P		01-496A	51277024.tif	UNOCAL CHEMICALS DIV	OAKLAND	04/08/1991	Monitoring	2	8	figure-site plan
168	02S03W	08N-08P		01-496B	51277025.tif	UNOCAL CHEMICALS DIV	OAKLAND	04/09/1991	Monitoring	2	31	figure-site plan
169	02S03W	08N-08P		01-496C	51277026.tif	UNOCAL CHEMICALS DIV	OAKLAND	04/08/1991	Monitoring	2	9	figure-site plan
170	02S03W	08N-08P		01-496D	51277027.tif	UNOCAL CHEMICALS DIV	OAKLAND	04/08/1991	Monitoring	2	30	figure-site plan
171	02S03W	08N-08P		01-496E	51277028.tif	UNOCAL CHEMICALS DIV	OAKLAND	04/08/1991	Monitoring	2	9	figure-site plan
172	02S03W	08N-08P		01-496F	51277029.tif	UNOCAL CHEMICALS DIV	OAKLAND	04/10/1991	Monitoring	2	36	figure-site plan
173	02S03W	8A-8K		237649	51292021.tif	INTEGRATED ENV SYST	OAKLAND	12/03/1985	Industrial	6	610	DWR report 237649 for unnamed well at 499 High Street (same well as directly above?), approx 400 feet NW to property line from subject site UST
174	02S03W	8A-8K		299116	51292022.tif	I E S	OAKLAND	12/09/1987	DESTROYED	6	300	DWR report for unnamed well destruction at 499 High Street (pea gravel 300 to 22 ft, 22 to 0 ft neat cement), approx 400 feet NW to property line from subject site UST
175	02S03W	8M-8N		01-178	51352002.tif	AMERICAN CAN COMPANY	OAKLAND	06/20/1986	Monitoring	2	25	site plan
176	02S03W	8M-8N		01-119A	51352085.tif	AMERICAN CAN COMPANY	OAKLAND	02/26/1986	Monitoring	2	31	boring log of test boring MW1
177	02S03W	8M-8N		01-119B	51352086.tif	AMERICAN CAN COMPANY	OAKLAND	02/26/1986	DESTROYED	2	31	transmittal - well destruction
178	02S03W	8M-8N		01-119C	51352088.tif	AMERICAN CAN COMPANY	OAKLAND	02/26/1986	DESTROYED	2	31	transmittal - well destruction
179	02S03W	8M-8N		01-119D	51352090.tif	AMERICAN CAN COMPANY	OAKLAND	02/26/1986	DESTROYED	2	31	transmittal - well destruction
180	02S03W	8M-8N		01-119E	51352092.tif	AMERICAN CAN COMPANY	OAKLAND	07/07/1987	DESTROYED	2	32	transmittal - well destruction
181	02S03W	8M-8N		01-119F	51352094.tif	AMERICAN CAN COMPANY	OAKLAND	07/07/1987	DESTROYED	2	32	transmittal - well destruction
182	02S03W	8M-8N		01-119G	51352096.tif	AMERICAN CAN COMPANY	OAKLAND	07/07/1987	DESTROYED	2	32	transmittal - well destruction
183	02S03W	8M-8N		01-119H	51352098.tif	AMERICAN CAN COMPANY	OAKLAND	07/07/1987	DESTROYED	2	32	transmittal - well destruction
184	02S03W	8M-8N		01-119E	51352083.tif	AMERICAN CAN COMPANY	OAKLAND	07/07/1987	DESTROYED	2	32	transmittal - well destruction
185	02S03W	8M-8N		01-450G	51352015.tif	AMERICAN NATIONAL	OAKLAND	08/22/1989	Monitoring	4	26	figure-site plan
186	02S03W	8M-8N		01-450H	51352016.tif	AMERICAN NATIONAL	OAKLAND	08/24/1989	Monitoring	4	26	figure-site plan
187	02S03W	8M-8N		01-450I	51352017.tif	AMERICAN NATIONAL	OAKLAND	08/22/1989	Monitoring	4	26	figure-site plan
188	02S03W	8M-8N		01-450J	51352018.tif	AMERICAN NATIONAL	OAKLAND	08/23/1989	Monitoring	4	21	figure-site plan
189	02S03W	8M-8N		01-450K	51352019.tif	AMERICAN NATIONAL	OAKLAND	08/21/1989	Monitoring	4	18	figure-site plan
190	02S03W	8M-8N		01-495D	51352020.tif	AMERICAN NAT'L CAN	OAKLAND	03/12/1991	Monitoring	4	20	figure-site plan
191	02S03W	8M-8N		01-495E	51352022.tif	AMERICAN NAT'L CAN	OAKLAND	03/14/1991	Monitoring	4	19	summary of borings converted to mws
192	02S03W	8M-8N		01-495F	51352023.tif	AMERICAN NAT'L CAN	OAKLAND	03/14/1991	Monitoring	4	19	summary of borings converted to mws
193	02S03W	8M-8N		01-495G	51352024.tif	AMERICAN NAT'L CAN	OAKLAND	03/15/1991	Monitoring	4	25	summary of borings converted to mws

Department of Water Resources Well Summary Information

Assigned DWR Well Number	Township and Range	Section	Tract	Log Number	Image Filename	Owner Name	City	Completion Date	Use	Casing Diameter (Inches)	Total Depth (Feet)	Comments
194	02S03W	8M-8N		01-495H	51352025.tif	AMERICAN NAT'L CAN	OAKLAND	03/16/1991	Monitoring	4	19	summary of borings converted to mws
195	02S03W	8M-8N		01-495I	51352026.tif	AMERICAN NAT'L CAN	OAKLAND	03/18/1991	Monitoring	4	26	summary of borings converted to mws
196	02S03W	8M-8N		01-495J	51352027.tif	AMERICAN NAT'L CAN	OAKLAND	03/19/1991	Monitoring	4	19	summary of borings converted to mws
197	02S03W	8M-8N		01-495K	51352028.tif	AMERICAN NAT'L CAN	OAKLAND	03/19/1991	Monitoring	4	19	summary of borings converted to mws
198	02S03W	8M-8N		01-495L	51352029.tif	AMERICAN NAT'L CAN	OAKLAND	03/20/1991	Monitoring	4	24	summary of borings converted to mws
199	02S03W	8M-8N		01-495M	51352030.tif	AMERICAN NAT'L CAN	OAKLAND	03/20/1991	Monitoring	4	18	summary of borings converted to mws
200	02S03W	8M-8N		01-495N	51352031.tif	AMERICAN NAT'L CAN	OAKLAND	03/21/1991	Monitoring	4	19	summary of borings converted to mws
201	02S03W	8M-8N		01-495O	51352032.tif	AMERICAN NAT'L CAN	OAKLAND	03/21/1991	Monitoring	4	18	summary of borings converted to mws
202	02S03W	8M-8N		01-495P	51352033.tif	AMERICAN NAT'L CAN	OAKLAND	03/26/1991	Monitoring	2	19	summary of borings converted to mws
203	02S03W	8M-8N		01-511M	51352044.tif	AMERICAN NAT'L CAN	OAKLAND	01/31/1992	Monitoring	2	15	boring log for well MW-17
204	02S03W	8M-8N		01-511N	51352046.tif	AMERICAN NAT'L CAN	OAKLAND	02/03/1992	Monitoring	2	19	boring log for well MW-18
205	02S03W	8M-8N		01-511O	51352047.tif	AMERICAN NAT'L CAN	OAKLAND	02/04/1992	Monitoring	2	18	boring log for well MW-19
206	02S03W	8M-8N		01-511P	51352048.tif	AMERICAN NAT'L CAN	OAKLAND	02/04/1992	Monitoring	2	18	boring log for well MW-20
207	02S03W	8M-8N		01-511Q	51352049.tif	AMERICAN NAT'L CAN	OAKLAND	02/05/1992	Monitoring	2	18	boring log for well MW-21
208	02S03W	8M-8N		01-531D	51352051.tif	AMERICAN NAT'L CAN	OAKLAND	09/26/1991	Monitoring	6	23	boring log for well TW-1
209	02S03W	8M-8N		01-531F	51352054.tif	AMERICAN NAT'L CAN	OAKLAND	09/25/1991	Monitoring	4	22	figure
210	02S03W	8M-8N		01-531G	51352055.tif	AMERICAN NAT'L CAN	OAKLAND	09/27/1991	Monitoring	2	19	figure
211	02S03W	8M-8N		01-495D	51352021.tif	AMERICAN NAT'L CAN	OAKLAND	03/12/1991	Monitoring	4	20	summary of borings converted to mws
212	02S03W	8M-8N		01-511M	51352045.tif	AMERICAN NAT'L CAN	OAKLAND	01/31/1992	Monitoring	2	15	figure
213	02S03W	8M-8N		01-531D	51352052.tif	AMERICAN NAT'L CAN	OAKLAND	09/26/1991	Monitoring	6	23	figure
214	02S03W	8M-8N		256937A	51352006.tif	EXXON STATION 7-3006	OAKLAND	02/11/1993	Monitoring	4	8	boring log for boring B-35A/well VW-1
215	02S03W	8M-8N		256937B	51352007.tif	EXXON STATION 7-3006	OAKLAND	02/11/1993	Monitoring	4	10	zone7 permit
216	02S03W	8M-8N		256937C	51352008.tif	EXXON STATION 7-3006	OAKLAND	02/11/1993	Monitoring	4	8	zone7 permit
217	02S03W	8M-8N		256937A	51352005.tif	EXXON STATION 7-3006	OAKLAND	02/11/1993	Monitoring	4	8	zone7 permit
218	02S03W	8Q		329017	51252019.tif	A A A EQUIPMENT CO	OAKLAND	10/23/1989	Monitoring	4	25	DWR report for well MW-1
219	02S03W	8Q		281006	51252017.tif	PACIFIC GAS & ELECT	OAKLAND	03/17/1988	Monitoring	2	18	DWR report for well OW-1
220	02S03W	8Q		281007	51252018.tif	PACIFIC GAS & ELECT	OAKLAND	03/21/1988	Monitoring	2	19	DWR report for well OW-2
221	02S03W	8Q		281008	51252022.tif	PACIFIC GAS & ELECT	OAKLAND	03/16/1988	Monitoring	2	18	DWR report for well OW-3
222	02S03W	8Q		281009A	51252023.tif	PACIFIC GAS & ELECT	OAKLAND	03/16/1988	Exploratory borehole	8	16	DWR report for well OW-4
223	02S03W	8Q		281009	51252026.tif	PACIFIC GAS & ELECT	OAKLAND	05/18/1988	Monitoring	2	22	WCD
224	02S03W	8Q		428875	51252041.tif	PACIFIC GAS & ELECT	OAKLAND	12/19/1991	Monitoring	2	19	DWR report for well OW-6
225	02S03W	8Q		428876	51252042.tif	PACIFIC GAS & ELECT	OAKLAND	12/19/1991	Monitoring	2	18	DWR report for well OW-7
226	02S03W	8Q		01-429A	51252002.tif	SOUTHERN PACIFIC TRA	OAKLAND	05/23/1989	Monitoring	2	12	Site Location Map
227	02S03W	8Q		01-429F	51252008.tif	SOUTHERN PACIFIC TRA	OAKLAND	05/23/1989	Monitoring	2	27	Site Location Map
228	02S03W	8Q		01-429I	51252011.tif	SOUTHERN PACIFIC TRA	OAKLAND	05/24/1989	Monitoring	2	25	Site Location Map
229	02S03W	8Q		01-429A	51252003.tif	SOUTHERN PACIFIC TRA	OAKLAND	05/23/1989	Monitoring	2	12	Site Map
230	02S03W	8Q		01-1299	51252016.tif	National Lead Company	OAKLAND	Undated	Industrial	10	776	DWR report w. boring log for unnamed well; Approx 1,900 Feet ENE of Subject Site (at 4701 San Leandro Blvd.)
231	02S03W	8Q		01-1298	51252015.tif	National Lead Company	OAKLAND	5/30/1962	Industrial	10	776	DWR report re: pump for unnamed well; Approx 1,900 Feet ENE of Subject Site (at 4701 San Leandro Blvd.)

All Database Well Summary Information

Figure 2 Designation	Assigned ACPWA Well Number	Assigned DWR Well Number	Permit Number	Township and Range	Section and Tract	Address	City	Owner	Drill Date	Total Depth (Feet)	Water Depth (Feet)	Diameter (Inches)	Use	WCR #	Comments
1	47	173	85203	2S/3W	8G 1	499 HIGH ST	Oakland	INTEGRATED ENV. SYSTEMS	Dec-85	610	30	6	IND	237649	Approx 400 Feet NW to Property Line From Subject Site UST
2	107			2S/3W	8M 7	3801 East 8th Street	Oakland	American National Can Co.	4/91	180	41	7	IRR		Approx 1,100 Feet NNW of Subject Site
3	198			2S/3W	8N53	500 High St	Oakland	Uecker and Associates	3/91	127	70	5	DOM		Approx 70 Feet NE to Property Line From Subject Site UST
4		230		2S/3W	8Q	4701 San Leandro Blvd	Oakland	National Lead Company	Undated	776	Unknown	10	IND		DWR report w. boring log for unnamed well; Approx 1,900 Feet ENE of Subject Site

FIGURES

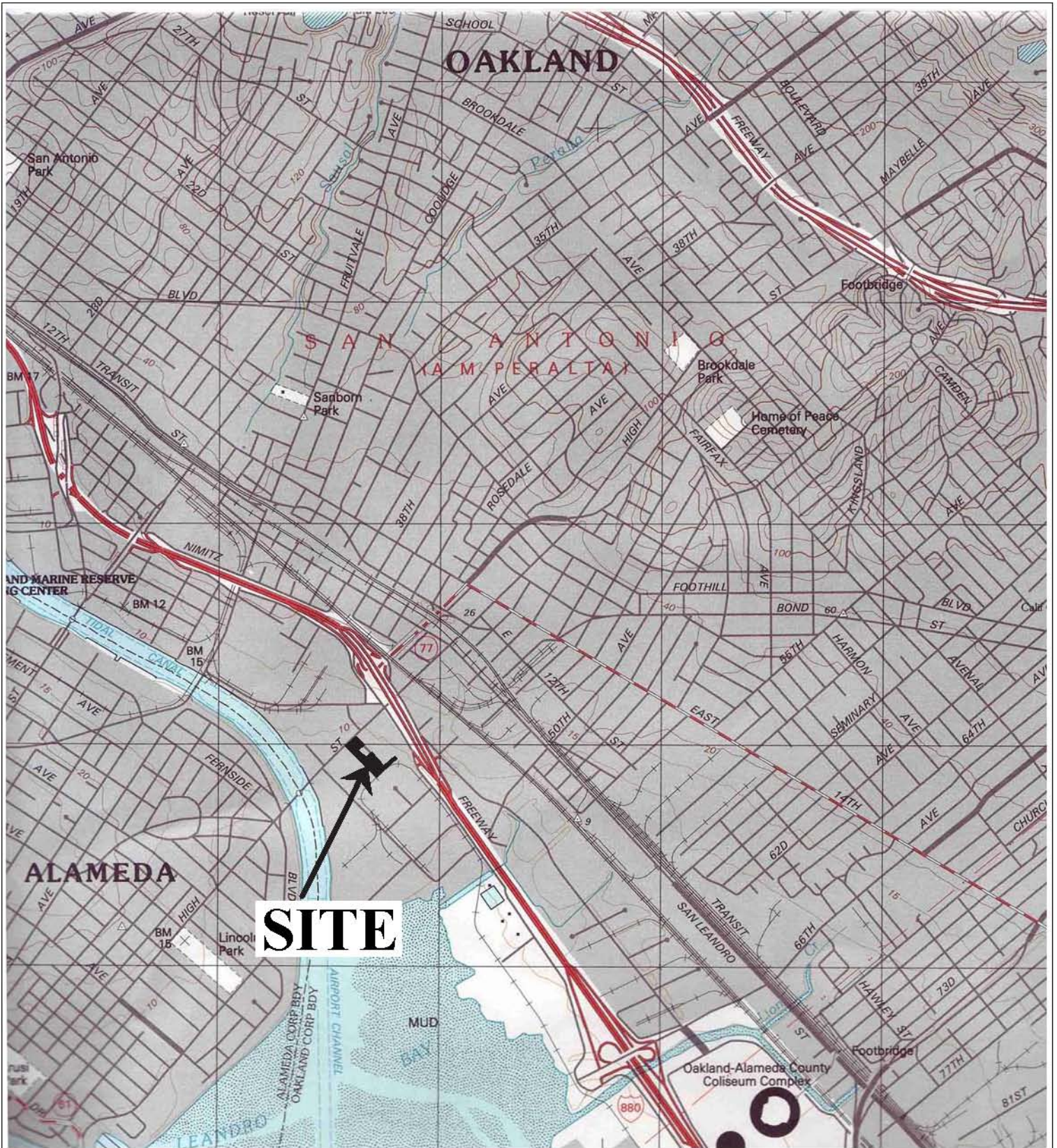
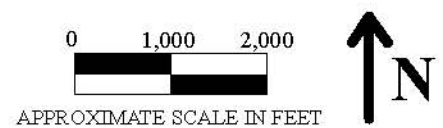

Figure 1
 Site Location Map
 Former El Monte RV Service Center
 4341 Howard Street
 Oakland, California

Base Map From:
 U.S. Geological Survey
 Oakland East, California
 7.5 Minute Quadrangle
 Map edited 1996

P&D Environmental, Inc.
 55 Santa Clara Ave., Suite 240
 Oakland, CA 94610



LEGEND

Table 3 Designation	Well Use, Depth, and Address
①	= Industrial Well 610 Feet Deep; 499 High St.
②	= Irrigation Well 180 Feet Deep; 3801 E. 8th St.
③	= Domestic Well 127 Feet Deep; 500 High St.
④	= Unclassified Well 776 Feet Deep; 4701 San Leandro St.

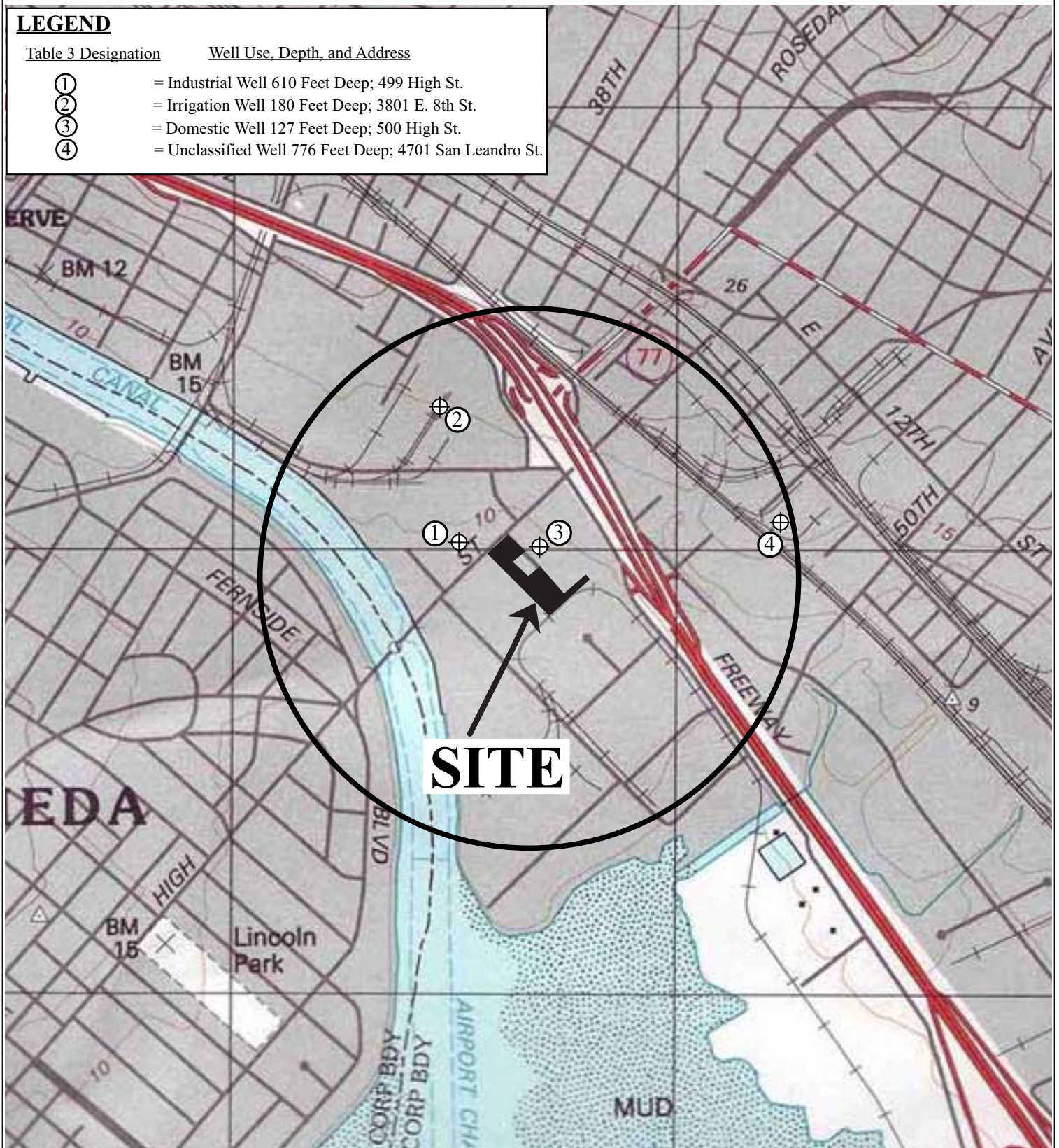
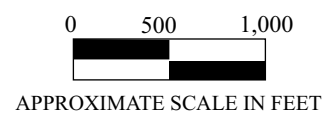

Figure 2
Well Location Map
Former El Monte RV Service Center
4341 Howard Street
Oakland, California

Base Map From:
U.S. Geological Survey
Oakland East, California
7.5 Minute Quadrangle
Map edited 1996

P&D Environmental, Inc.
55 Santa Clara Ave., Suite 240
Oakland, CA 94610



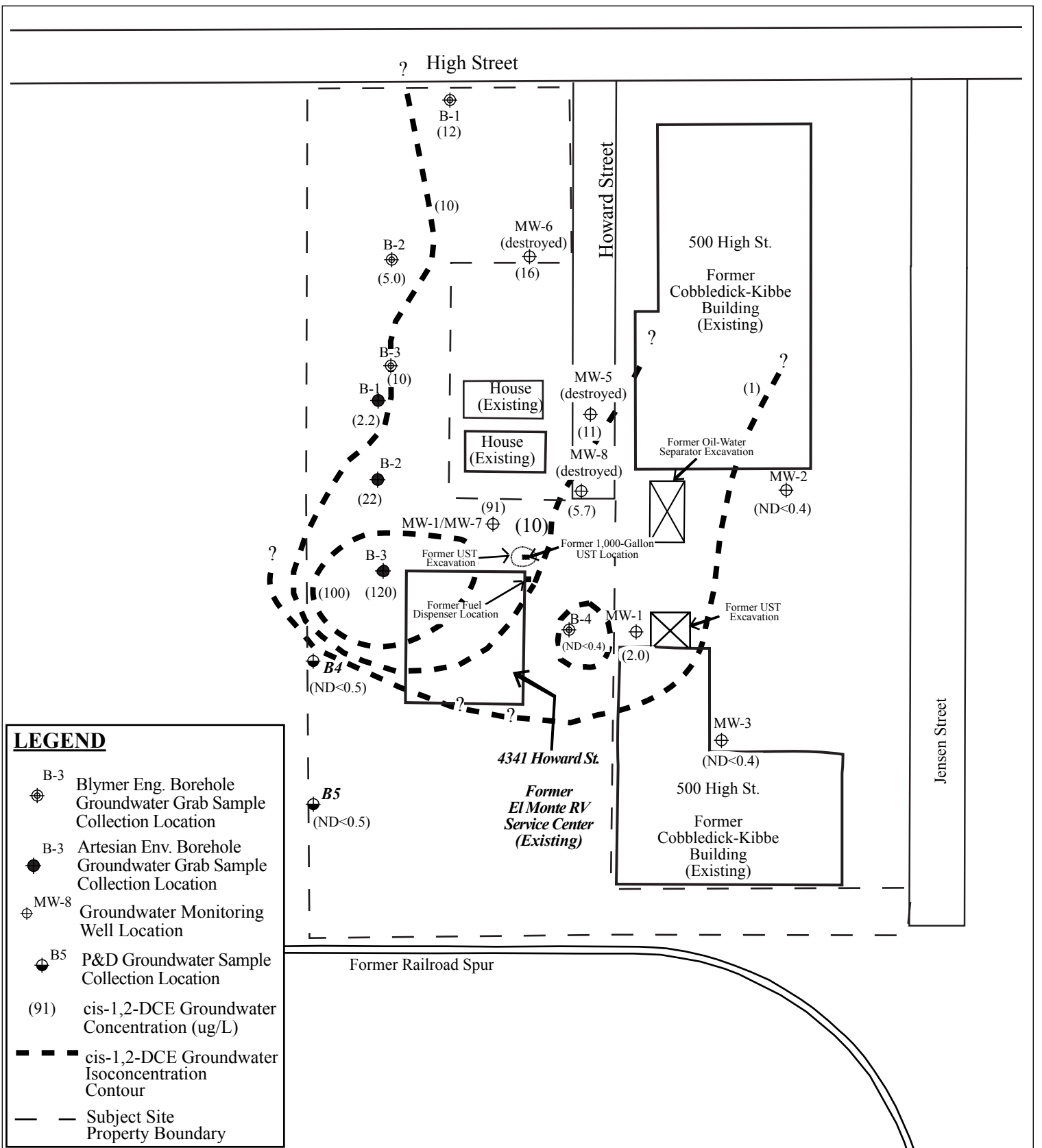

Figure 3
 Site Vicinity Map Showing cis-1,2-DCE In Groundwater
 Former El Monte RV Service Center
 4341 Howard Street
 Oakland, California

Base Map From:
 Artesian Environmental, July 2000

P&D Environmental, Inc.
 55 Santa Clara Ave., Suite 240
 Oakland, CA 94610

