

5117 334



ENVIRONMENTAL  
PROTECTION

93 NOV 16 PM 4:28

Croley and Herring Investment Company

November 13, 1998

Alameda County Health Care Services  
Hazardous Materials Division  
1131 Harbor Bay Parkway  
Alameda, CA. 94502

Attn: Susan Stego

Enclosed is our report covering the monitoring  
of our wells at 5800 Christie, Emeryville,  
on October 19, 1998.

I am advised by Joe Heisen of Cambria  
Environmental that the Lathrop results  
will be forwarded to you early the week of  
November 15.

As soon as you have had a chance to review  
these reports, we would like to set up a meet-  
ing with you to discuss your findings and  
review our strategy for putting together a  
closure request to the Water Board. If  
possible, we would like to meet with the Water  
Board during the first week in December.

Hopefully, we will hear from you by Nov. 23.

Sincerely,

R. D. Herring, Partner

353 Beacon Ridge Lane, Walnut Creek, California 94596

Telephone: 510-939-1118

**GROUNDWATER MONITORING REPORT**

**5800 CHRISTIE AVENUE,  
EMERYVILLE, CALIFORNIA**

**NOVEMBER 3, 1998**

**SUBMITTED TO:**

**MS. SUSAN HUGO  
ALAMEDA COUNTY HEALTH CARE SERVICES  
HAZARDOUS MATERIALS DIVISION  
1131 HARBOUR BAY PARKWAY,  
ALAMEDA, CALIFORNIA 94502**

**PREPARED FOR :**

**CROLEY & HERRING INVESTMENT COMPANY  
353 BEACON RIDGE LANE,  
WALNUT CREEK, CALIFORNIA 94596**

**PREPARED BY:**

***ETS* ENVIRONMENT & TECHNOLOGY SERVICES  
4690 TOMPKINS AVENUE,  
OAKLAND, CALIFORNIA 94619  
TELEPHONE: 510-482-6230  
FACIMILE: 510-482-5551**

***ETS ENVIRONMENT & TECHNOLOGY SERVICES***

**4690 TOMPKINS AVENUE, OAKLAND, CALIFORNIA 94619**  
**PHONE 510-482-6230 FAX 510-482-5551**

November 3, 1998

Mr. Dick Herring  
President  
Croley & Herring Investment Company  
353 Beacon Ridge Lane,  
Walnut Creek, California 94596  
Phone/Fax: 510-939-1118

Subject: Groundwater Monitoring Report October 1998  
5800 Christie Avenue, Emeryville, California

Dear Mr. Herring:

Enclosed please find a copy of the special groundwater monitoring report as requested ACHCS done in conjunction with Lathrop Corporation preparatory to the submission of a joint closure request with Lathrop. The monitoring was done on October 19, 1998.

Please contact me if you have any question about this report.

Sincerely,

Walter W. Loo, CEG 1207  
President

CC: Ms. Susan Hugo, ACHCS  
Mr. Derek Lee, BA RWQCB

## **TABLE OF CONTENTS**

**1.0 INTRODUCTION**

**2.0 GROUNDWATER MOVEMENT ANALYSIS**

**3.0 GROUNDWATER QUALITY**

**4.0 SUMMARY OF FINDINGS**

**APPENDIX A GROUNDWATER ANALYSIS(ENVIRO-CHEM,  
INC.) LABORATORY REPORTS**

## 1.0 INTRODUCTION

Environment & Technology Services(ETS) was retained by Croley & Herring Investment Company to perform the groundwater monitoring for the facility located at 5800 Christie Street in Emeryville, California. The subject facility is currently leased to The Good Guys Store, an electronic merchandise retailer. Prior to leasing, soil contamination was identified at the subject facility. The contaminated soil was removed with the exception of that which was underlying the building because of structural concerns. The removed soil was remediated on-site and properly disposed of with the approval of ACHCS (7/28/89). A vapor extraction system(VES) was installed immediately adjacent to the northeastern side of the building to mitigate the residual volatile hydrocarbons contained in the soil. The residual volatile organic chemicals(VOCs) were remediated from an average VOCs concentration of about 660 ppm to a satisfactory level at an average of 0.82 ppm in soil. A soil closure plan was submitted(11/15/91) and approval of closure was received on 1/21/92 after submittal of confirming soil sampling results. The soil vapor extraction system was decommissioned and the Bay Area Air Quality Management District was notified on 12/16/91. The final VES closure report was completed on August 29, 1992. An indoor vapor monitoring system Sierra Monitor Model 5000 was installed by The Good Guys electronic store in 1989 through March, 1993. No significant level of methane was detected for the monitoring period. The vapor monitoring system was disconnected in March, 1993 with the concurrence of Mr. Brian Oliva of Alameda County Health Care Services, March 15,1993 correspondence. The groundwater closure letter for the chlorinated solvents was issued by Susan Hugo of ACHCS (9/30/96), and Stephen Morse of Bay Area RWQCB (11/15/96).

As part of the site activities, a groundwater monitoring program has been implemented. Previous groundwater monitoring events were conducted on November 6, 1989, February 20, 1990, May 31, 1990, September 7, 1990, December 4, 1990, April 16, 1991, July 3,1991, October 12, 1991, January 26, 1992, April 8, 1992, July 15,1992, October 19, 1992, January 11, 1993, March 29, 1993, July 7, 1993, October 8, 1993, January 19, 1994, January 25, 1995, September 18, 1995, January 29, 1996, March 25, 1996, July 11, 1996, January 21, 1997, July 18, 1997, January 14, 1998 and on July 21, 1998 respectively.

This groundwater level monitoring event was conducted on October 19, 1998. Groundwater samples were taken from the monitoring wells and sent to a State-certified laboratory for analysis under proper chain-of-custody procedures. This report presents the results of this groundwater monitoring event on well EW-1 and MW-4 including laboratory analytical results, groundwater movement analysis, summary of findings, and conclusions and discussions.

## 2.0 GROUNDWATER MOVEMENT ANALYSIS

Prior to sample collection, depth-to-water table in each of all existing monitoring wells was measured for the analysis of groundwater movement. Table 1 presents a summary of the water levels in the four wells (EW-1, MW-2, MW-3 and MW-4) from the groundwater monitoring events prepared by ETS.

From the water level measurements on October 19, 1998, elevation of water levels were somewhat the same, as compared to the data collected on July 22, 1998. The groundwater flow direction was flowing towards the southeast (Figure 2). The hydraulic gradient was 0.0398 feet per horizontal foot.

Data on flow direction and hydraulic gradient are summarized in Table 2.

### 3.0 GROUNDWATER QUALITY

On October 19, 1998, ETS field personnel visited the facility and collected water samples from monitoring well EW-1 and MW-4 for laboratory analysis. These groundwater samples were sent to a state-certified laboratory for analysis of total petroleum hydrocarbons, (TPH) as gasoline, using EPA method 8015M, gasoline constituents benzene, toluene, ethylbenzene, and total xylenes (BTEX) and MTBE, using EPA method 8020, and Polycyclic Aromatic Hydrocarbons (PAHs) using EPA method 8270.

From the results of the laboratory analysis (Appendix A), Tables 3 and 4 present the results of each well on TPH gas, BTEX and MtBE. Table 5 outlines PAHs values. Comparisons below are based on July 1998 vs. October 1998 data.

With regards to EW-1, TPH gas rose from 3.6 to 4.24 ppm. Toluene rose from 0.38 to 1.97 ppm. Other BTEX constituents and MtBE were all ND. PAHs were all ND in EW-1. Oxygen Release Compound(ORC) in sock form were removed in this well on July 20, 1998.

MW-4 results are also changed with TPH gas rising from 3.3 to 3.78 ppm. BTEX constituents fluctuated within the natural range with all values below 1 ppm as follows:

	July 1998	October 1998
Benzene(B)	0.680 ppm	0.808 ppm
Toluene(T)	0.080 ppm	0.085 ppm
Ethyl Benzene(E)	0.140 ppm	0.297 ppm
Total Xylenes(X)	0.220 ppm	0.174 ppm

MtBE was ND in both monitoring episodes.

PAHs have also fluctuated naturally with minor increases(see Table 5 for PAHs comparison).

#### 4.0 SUMMARY OF FINDINGS

In summary, July 1998 and October 1998 readings are all within the natural fluctuation range. The minor increase in BTEX and PAHs levels most likely is associated with the rise in water levels. Considering the groundwater in this area is not a drinking water source, this site poses very low risk to the environment. In addition, the entire area is covered and sealed by 4 to 6 inches of concrete which provides minimum exposure to any vapors which may escape from the soil and groundwater.

Based on the Tier 2 Risk Based Corrective Action(RBCA) evaluation prepared by Cambria Environmental in a report dated April 14, 1998 for Goldsmith & Lathrop, the upgradient neighboring property with higher TPH gas(4.9 to 15 ppm) and PAHs values(August 7, 1997), ETS concludes that the subject property poses no significant danger and minimum risk to human health.

Therefore, ETS recommends that our request for full closure contained in our February 28, 1997 monitoring report be considered by ACHCS and the BA RWQCB.





0 1900

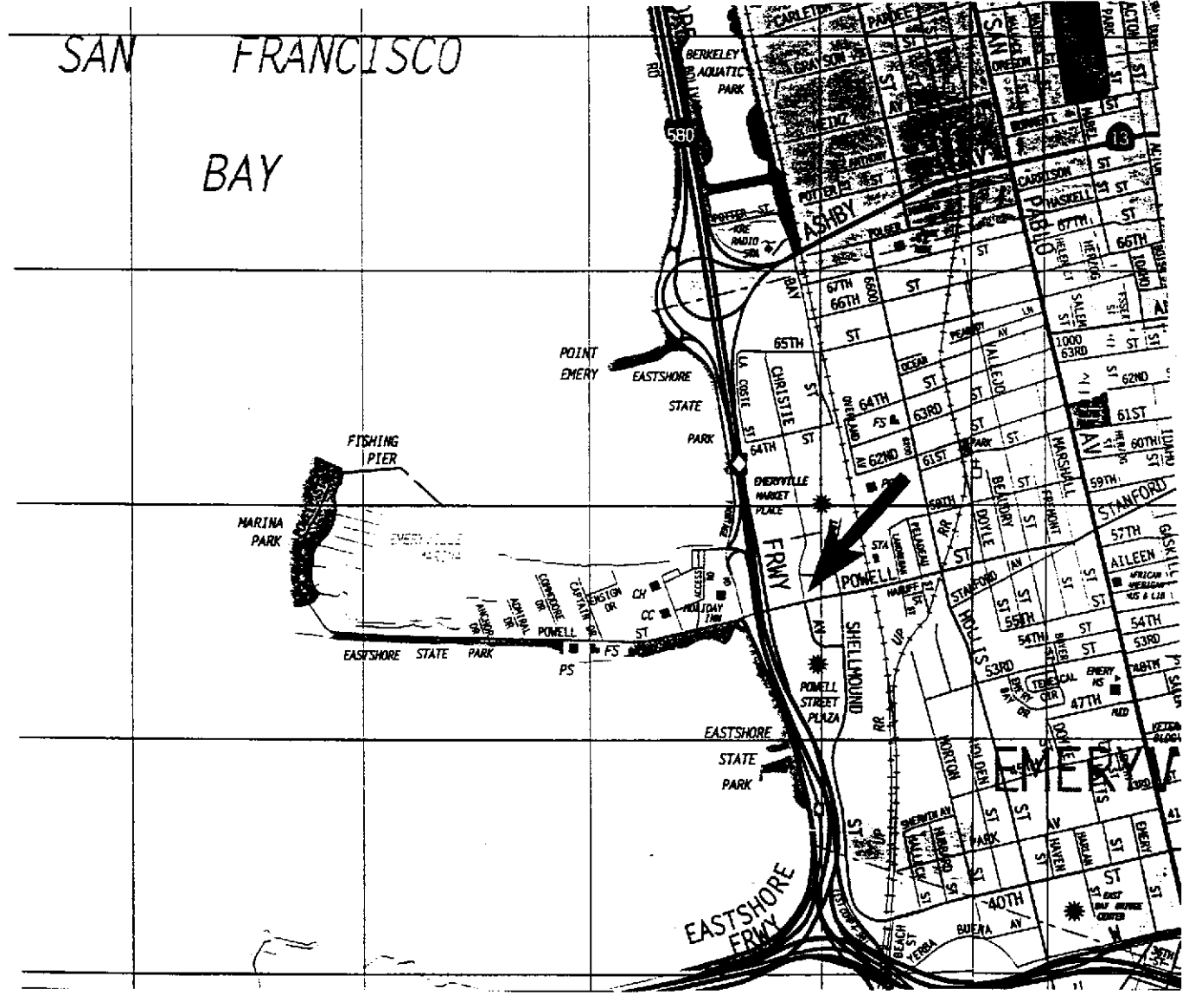

# ETS

ENVIRONMENT & TECHNOLOGY SERVICES

CROLEY & HERRING INVESTMENT CO.  
5800 CHRISTIE AVENUE,  
EMERYVILLE, CALIFORNIA

## FIGURE 1

### SITE VICINITY MAP

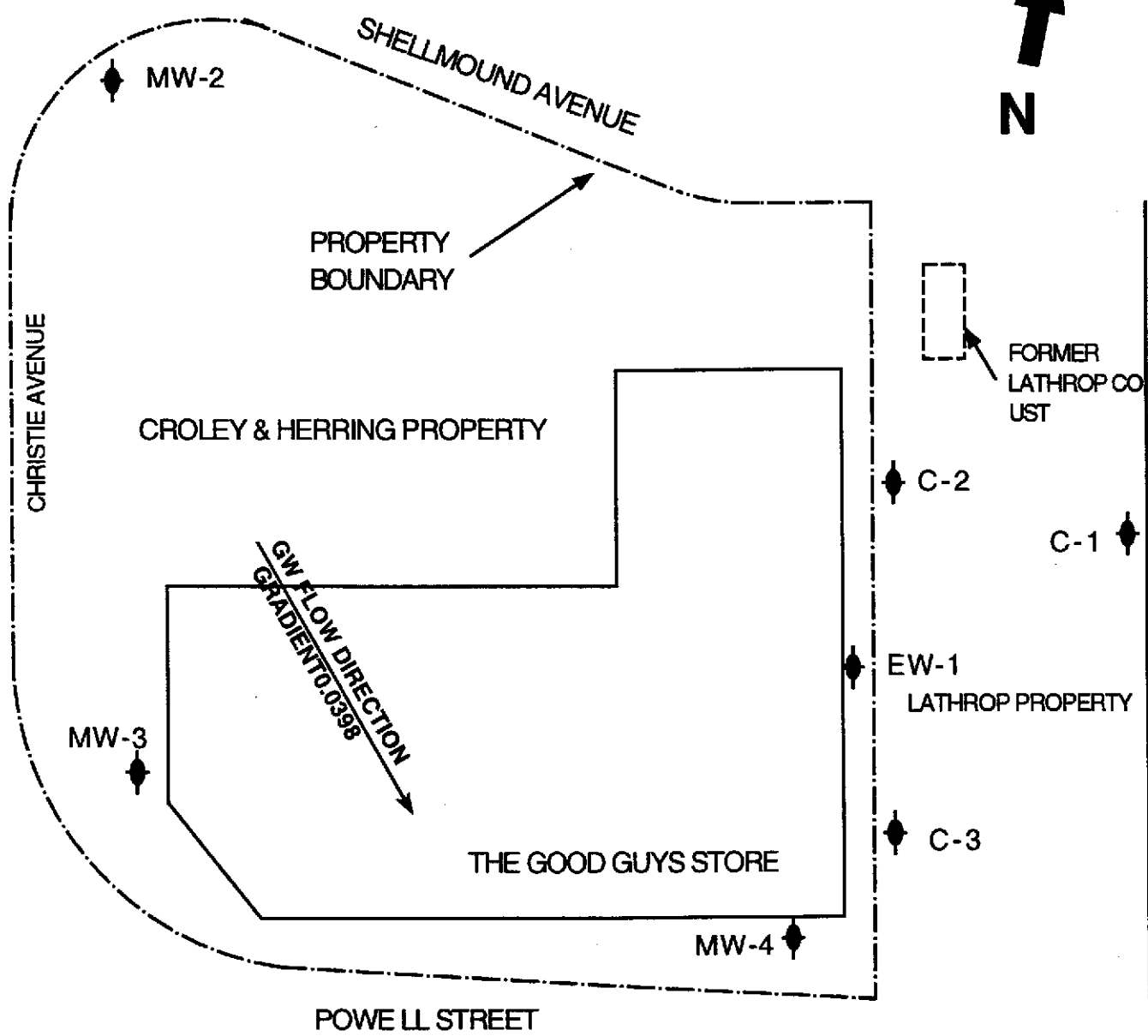

◆ GROUNDWATER MONITORING WELL

CROLEY & HERRING INVESTMENT COMPANY  
5800 CHRISTIE AVENUE  
EMERYVILLE, CALIFORNIA

0 20 40  
SCALE (FEET)

**ETS**

ENVIRONMENT & TECHNOLOGY SERVICES

**FIGURE 2**  
**OCTOBER 19, 1998**  
**GROUNDWATER FLOW MAP**

**TABLE 1  
SUMMARY OF GROUNDWATER LEVEL DATA**

WELL	ELEVATION OF TOC	5/31/90		9/7/90		12/4/90		4/16/91		7/3/91		10/14/91	
		DTW	SWL	DTW	SWL	DTW	SWL	DTW	SWL	DTW	SWL	DTW	SWL
EW-1	8.62	5.86	2.76	6.30	2.32	7.39	1.23	6.02	2.60	6.20	2.42	6.50	2.12
MW-2	7.42	4.26	3.16	4.60	2.82	4.67	2.75	4.31	3.11	4.52	2.90	3.92	3.50
MW-3	6.42	4.93	1.49	5.15	1.27	5.96	0.46	5.25	1.17	5.33	1.09	4.63	1.79
WELL	ELEVATION OF TOC	1/9/92		7/15/92		10/19/92		1/11/93		4/19/93		7/13/93	
		DTW	SWL	DTW	SWL	DTW	SWL	DTW	SWL	DTW	SWL	DTW	SWL
EW-1	8.62	6.20	2.42	6.10	2.52	6.10	2.52	5.50	3.12	5.95	2.67	6.20	2.42
MW-2	7.42	4.43	2.99	4.42	3.00	4.77	2.65	2.90	4.52	4.35	3.07	4.70	2.72
MW-3	6.42	6.50	-0.08	5.23	1.19	5.37	1.05	3.60	2.82	5.10	1.32	5.35	1.07
MW-4	7.07(a)											5.75	1.32
WELL	ELEVATION OF TOC	10/15/93		1/19/94		1/4/95		9/18/95		3/25/96		3/25/96	
		DTW	SWL	DTW	SWL	DTW	SWL	DTW	SWL	DTW	SWL	DTW	SWL
EW-1	8.62	6.25	2.37	6.30	2.32	4.75	3.87	6.30	2.32	4.95	3.67	4.95	4.21
MW-2	7.42	4.25	3.17	4.90	2.52	3.57	3.85	4.70	2.72	3.50	3.92	3.50	3.91
MW-3	6.42	5.35	1.07	5.30	1.12	5.10	1.32	5.10	1.32	4.60	1.82	4.60	3.93
MW-4	7.07 (a)	5.80	1.27	5.75	1.32	6.10	0.97	6.90	0.17	6.40	0.67	6.40	1.22
WELL	NEWLY SURVEYED ELEVATION OF TOC	7/30/96		1/21/97		9/2/97		1/14/98		7/22/98		10/19/98	
		DTW	SWL	DTW	SWL	DTW	SWL	DTW	SWL	DTW	SWL	DTW	SWL
EW-1	9.16	6.30	2.86	7.10	2.06	5.8	3.36	5.5	3.66	7.2	1.96	6.1	3.06
MW-2	7.41	4.74	2.67	2.99	4.42	4.8	2.61	4.49	2.92	4.7	2.71	4.4	3.01
MW-3 *	8.53	5.60	2.93	2.95	5.58	4.7	3.83	NS	NS	5.65	2.88	4.65	3.88
MW-4	7.62 (a)	6.71	0.91	5.05	2.57	6.8	0.82	6.5	1.12	6.6	1.02	6.9	0.72

\*DTW : Depth to water table \*SWL : Static water level above MSL \*MSL : Mean sea level \*TOC : Top of casing \*NS : Not Sampled \*(a) : Adjusted elevation

\* Note MW-3 well closed per our letter of October 4, 1996.

## TABLE 2

### SUMMARY OF GROUNDWATER MOVEMENT ANALYSIS

DATE	FLOW DIRECTION	GRADIENT
2/20/90	SOUTH	0.0160
5/31/90	SOUTH	0.0125
9/7/90	SOUTH	0.0115
12/4/90	SOUTH	0.0450
4/16/91	SOUTH	0.0140
7/3/91	SOUTH	0.0130
10/14/91	SOUTH	0.0110
1/9/92	SOUTHWEST	0.0238
7/15/92	SOUTH	0.0130
10/19/92	SOUTH	0.0127
1/11/93	SOUTH	0.0110
4/19/93	SOUTHWEST	0.0130
7/7/93	SOUTHWEST	0.0130
10/15/93	SOUTH	0.0153
1/19/94	SOUTH	0.0105
1/4/95	SOUTH	0.0280
9/18/95	SOUTHWEST	0.0176
3/25/96	SOUTHWEST	0.0177
7/30/96	SOUTH	0.0288
1/21/97	SOUTH	0.0094
9/2/97	SOUTH	0.0423
1/14/98	SOUTH	0.0207
7/22/98	SOUTHEAST	0.0188
10/19/98	SOUTHEAST	0.0398

**TABLE 3****SUMMARY OF GROUNDWATER QUALITY WELL EW-1 (mg/L)**

COMPOUND	1/19/94	1/25/95	9/18/95	1/6/96	1/29/96	3/25/96	7/11/96	1/21/97	7/18/97	1/14/98	7/22/98	10/19/98
TPH as gas	5	13	3.2	1.7	1.8	1.3	NA	30	2.39	10.2	3.6	4.24
BENZENE	0.022	0.026	ND	ND	ND	ND	ND	0.007	ND	0.006	ND	ND
TOLUENE	4.3	5	0.62	1.2	1.1	0.55	5.87	3.22	1.21	3.58	0.38	1.97
TOTAL XYLENES	0.07	0.048	0.015	0.033	0.043	0.011	0.055	0.055	0.017	0.111	ND	0.098
ETHYLBENZENE	0.012	0.009	ND	ND	ND	ND	0.013	0.012	ND	0.013	ND	ND
MTBE	NA	NA	NA	NA	NA	NA	ND	ND	ND	0.024	ND	ND

\*NA : Not analysed

\*ND : Non-Detected

**TABLE 4****SUMMARY OF GROUNDWATER QUALITY WELL MW-4 (mg/L)**

COMPOUND	1/19/94	1/25/95	9/18/95	1/29/96	3/25/96	7/11/96	1/21/97	7/18/97	1/14/98	7/22/98	10/19/98
TPH as gas	0.35	26	5.3	11	14	NA	2.48	2.49	7.25	3.3	3.78
BENZENE	0.21	1.4	0.57	0.75	1	0.86	0.659	0.583	0.727	0.6	0.808
TOLUENE	0.025	0.27	0.11	0.11	0.15	0.076	0.095	0.079	0.136	0.08	0.085
TOTAL XYLENES	0.037	0.28	0.096	0.14	0.22	0.24	0.104	0.169	0.173	0.22	0.174
ETHYLBENZENE	0.035	0.56	0.16	0.24	0.38	0.13	0.058	0.029	0.341	0.14	0.297
MTBE	NA	NA	NA	NA	NA	ND	ND	ND	ND	ND	ND

**\*NA : Not analysed****\*ND : Non-Detected**

# TABLE 5

## SUMMARY OF GROUNDWATER QUALITY ANALYSIS (PAH IN mg/L)

PARAMETER	EW-1		MW-4	
	7/22/98	10/19/98	7/22/98	10/19/98
ACENAPHTHENE	ND	ND	0.23	0.45
ACENAPHTHYLENE	ND	ND	0.06	0.07
ANTHRACENE	ND	ND	ND	ND
BENZO (a) ANTHRACENE	ND	ND	ND	ND
BENZO (a) PYRENE	ND	ND	ND	ND
BENZO (b) FLUORANTHENE	ND	ND	ND	ND
BENZO (K) FLUORANTHENE	ND	ND	ND	ND
BENZO (g,h,i) PERYLENE	ND	ND	ND	ND
CHRYSENE	ND	ND	ND	ND
DIBENZO (a,h) ANTHRACENE	ND	ND	ND	ND
DIBENZO (a,e) PYRENE	ND	ND	ND	ND
DIBENZO (a,h) PYRENE	ND	ND	ND	ND
DIBENZO (a,i) PYRENE	ND	ND	ND	ND
FLUORANTHENE	ND	ND	ND	0.032
FLUORENE	ND	ND	ND	ND
INDENO (1,2,3-cd) PYRENE	ND	ND	ND	ND
NAPHTHALENE	ND	ND	9	11
PHENANTHRENE	ND	ND	0.08	0.20
PYRENE	ND	ND	ND	0.04

ND : NON-DETECT

**APPENDIX A**

**GROUNDWATER LABORATORY ANALYSIS**

**ENVIRO-CHEM, INC. REPORT**

**NOVEMBER 2, 1998**



Enviro - Chem, Inc.

1214 E. Lexington Avenue, Pomona, CA 91766 Tel (909) 590-5905 Fax (909) 590-5907

Date: November 2, 1998

Mr. Dick Herring/Walter Loo  
Croley & Herring Co.  
353 Beacon Ridge Lane  
Walnut Creek, CA 94596

Project: CHIC

Dear Mr. Herring:

The analytical results for the liquid samples (Project: CHIC), received by our Lab on October 23, 1998, are attached. The report has also been faxed to Mr. Walter Loo at (562)498-2479.

Enviro-Chem appreciates the opportunity to provide you and your company this and other services. Please do not hesitate to call Mr. John Ackerman, our Customer Service Specialist, or myself, if you have any questions.

Sincerely,

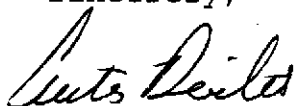

Curtis Desilets  
Lab Director



Compton Persaud  
Lab Manager

Hon Su  
Program Manager

Enviro - Chem, Inc.

1214 E. Lexington Avenue, Pomona, CA 91766 Tel (909) 590-5905 Fax (909) 590-5907

LABORATORY REPORT

CUSTOMER: CROLEY & HERRING CO., 353 BEACON RIDGE LANE,  
WALNUT CREEK, CA 94596 TEL(510)939-1118

PROJECT: CHIC

MATRIX: WATER DATE SAMPLE REC'D: 10/23/98 (ETS)  
DATE SAMPLED: 10/19/98 DATE ANALYZED: 10/27-11/02/98  
REPORTED TO: MR. DICK HERRING DATE REPORTED: 11/02/98  
MR. WALTER LOO/ETS (FAX: 562-498-2479) (510) 482-6230

SAMPLE I.D.: EW-1 LAB I.D.: 981023-10

ANALYSIS: POLYNUCLEAR AROMATIC HYDROCARBONS, EPA METHOD 8270B

UNIT: ug/L (PPB)

PARAMETER	SAMPLE RESULT	D.L.	X5
ACENAPHTHENE	ND	5	
ACENAPHTHYLENE	ND	5	
ANTHRACENE	ND	5	
BENZO (a) ANTHRACENE	ND	5	
BENZO (a) PYRENE	ND	5	
BENZO (b) FLUORANTHENE	ND	5	
BENZO (k) FLUORANTHENE	ND	5	
BENZO (g, h, i) PERYLENE	ND	5	
CHRYSENE	ND	5	
DIBENZO (a, h) ANTHRACENE	ND	5	
FLUORANTHENE	ND	5	
FLUORENE	ND	5	
INDENO (1, 2, 3-cd) PYRENE	ND	5	
NAPHTHALENE	ND	5	
PHENANTHRENE	ND	5	
PYRENE	ND	5	

COMMENTS

D.L. = DETECTION LIMIT

ND = NON-DETECTED OR BELOW THE DETECTION LIMIT

Data Reviewed and Approved by: *[Signature]*  
CAL-DHS ELAP#1555

Enviro - Chem, Inc.

1214 E. Lexington Avenue, Pomona, CA 91766 Tel (909) 590-5905 Fax (909) 590-5907

LABORATORY REPORT

CUSTOMER: CROLEY & HERRING CO., 353 BEACON RIDGE LANE,  
WALNUT CREEK, CA 94596 TEL (510) 939-1118

PROJECT: CHIC

MATRIX: WATER DATE SAMPLE REC'D: 10/23/98 (ETS)  
DATE SAMPLED: 10/19/98 DATE ANALYZED: 10/28/98  
REPORTED TO: MR. DICK HERRING DATE REPORTED: 11/02/98  
MR. WALTER LOO/ETS (FAX: 562-498-2479) (510) 482-6230

SAMPLE I.D.: EW-1

LAB I.D.: 981023-10

PARAMETER	UNIT	SAMPLE RESULT	D.L. (X20)	EPA METHOD
TPH as GASOLINE (C4-C10)	uG/L	4,240	50	5030/8015M
BENZENE	uG/L	ND	1	5030/8020A
TOLUENE	uG/L	1,970	1	5030/8020A
ETHYLBENZENE	uG/L	ND	1	5030/8020A
TOTAL XYLENES	uG/L	98.4	2	5030/8020A
MTBE	uG/L	ND	5	5030/8020A

COMMENTS

uG/L = PPB

D.L. = DETECTION LIMIT

ND = BELOW THE DETECTION LIMIT OR NON-DETECTED

TPH = TOTAL PETROLEUM HYDROCARBONS

MTBE = METHYL tert-BUTYL ETHER

DATA REVIEWED AND APPROVED BY: *Kent Darter*

CAL-DHS ELAP CERTIFICATE No.: 1555

Enviro - Chem, Inc.

1214 E. Lexington Avenue, Pomona, CA 91766 Tel (909) 590-5905 Fax (909) 590-5907

LABORATORY REPORT

CUSTOMER: CROLEY & HERRING CO., 353 BEACON RIDGE LANE,  
WALNUT CREEK, CA 94596 TEL (510) 939-1118

PROJECT: **CHIC**

MATRIX: WATER DATE SAMPLE REC'D: 10/23/98 (ETS)  
DATE SAMPLED: 10/19/98 DATE ANALYZED: 10/28/98  
REPORTED TO: MR. DICK HERRING DATE REPORTED: 11/02/98  
MR. WALTER LOO/ETS (FAX: 562-498-2479) (510) 482-6230

-----  
SAMPLE I.D.: **MW-4** LAB I.D.: 981023-11  
-----

PARAMETER	UNIT	SAMPLE RESULT	D.L. (X20)	EPA METHOD
TPH as GASOLINE (C4-C10)	uG/L	3,780	50	5030/8015M
BENZENE	uG/L	808	1	5030/8020A
TOLUENE	uG/L	85.5	1	5030/8020A
ETHYLBENZENE	uG/L	297	1	5030/8020A
TOTAL XYLENES	uG/L	174	2	5030/8020A
MTBE	uG/L	ND	5	5030/8020A

-----  
COMMENTS

uG/L = PPB  
D.L. = DETECTION LIMIT  
ND = BELOW THE DETECTION LIMIT OR NON-DETECTED  
TPH = TOTAL PETROLEUM HYDROCARBONS  
MTBE = METHYL tert-BUTYL ETHER  
-----

DATA REVIEWED AND APPROVED BY: *Chris Dentler*

CAL-DHS ELAP CERTIFICATE No.: 1555

Enviro - Chem, Inc.

1214 E. Lexington Avenue, Pomona, CA 91766 Tel (909) 590-5905 Fax (909) 590-5907

METHOD BLANK REPORT

CUSTOMER: CROLEY & HERRING CO., 353 BEACON RIDGE LANE,  
WALNUT CREEK, CA 94596 TEL(510)939-1118

PROJECT: **CHIC**

MATRIX: WATER DATE SAMPLE REC'D: 10/23/98 (ETS)  
DATE SAMPLED: 10/19/98 DATE ANALYZED: 10/27-11/02/98  
REPORTED TO: MR. DICK HERRING DATE REPORTED: 11/02/98  
MR. WALTER LOO/ETS (FAX: 562-498-2479) (510) 482-6230

METHOD BLANK FOR LAB I.D.: 981023-10 TO -11

PARAMETER	UNIT	SAMPLE RESULT	D.L. (X1)	EPA METHOD
TPH as GASOLINE (C4-C10)	uG/L	ND	50	5030/8015M
BENZENE	uG/L	ND	1	5030/8020A
TOLUENE	uG/L	ND	1	5030/8020A
ETHYLBENZENE	uG/L	ND	1	5030/8020A
TOTAL XYLENES	uG/L	ND	2	5030/8020A
MTBE	uG/L	ND	5	5030/8020A

COMMENTS

uG/L = PPB

D.L. = DETECTION LIMIT

ND = BELOW THE DETECTION LIMIT OR NON-DETECTED

TPH = TOTAL PETROLEUM HYDROCARBONS

MTBE = METHYL tert-BUTYL ETHER

DATA REVIEWED AND APPROVED BY: *Walter Loo*

CAL-DHS ELAP CERTIFICATE No.: 1555

Enviro - Chem, Inc.

1214 E. Lexington Avenue, Pomona, CA 91766 Tel (909) 590-5905 Fax (909) 590-5907

LABORATORY REPORT

CUSTOMER: CROLEY & HERRING CO., 353 BEACON RIDGE LANE,  
WALNUT CREEK, CA 94596 TEL(510)939-1118

PROJECT: CHIC

MATRIX: WATER DATE SAMPLE REC'D: 10/23/98 (ETS)  
 DATE SAMPLED: 10/19/98 DATE ANALYZED: 10/27-11/02/98  
 REPORTED TO: MR. DICK HERRING DATE REPORTED: 11/02/98  
MR. WALTER LOO/ETS (FAX: 562-498-2479) (510) 482-6230

SAMPLE I.D.: MW-4 LAB I.D.: 981023-11

ANALYSIS: POLYNUCLEAR AROMATIC HYDROCARBONS, EPA METHOD 8270B

UNIT: ug/L (PPB)

PARAMETER	SAMPLE RESULT	D.L.	X5
ACENAPHTHENE	446	5	
ACENAPHTHYLENE	70	5	
ANTHRACENE	ND	5	
BENZO (a) ANTHRACENE	ND	5	
BENZO (a) PYRENE	ND	5	
BENZO (b) FLUORANTHENE	ND	5	
BENZO (k) FLUORANTHENE	ND	5	
BENZO (g, h, i) PERYLENE	ND	5	
CHRYSENE	ND	5	
DIBENZO (a, h) ANTHRACENE	ND	5	
FLUORANTHENE	32	5	
FLUORENE	ND	5	
INDENO (1, 2, 3-cd) PYRENE	ND	5	
NAPHTHALENE	11,200	5	(X100)
PHENANTHRENE	198	5	
PYRENE	41	5	

COMMENTS

D.L. = DETECTION LIMIT

ND = NON-DETECTED OR BELOW THE DETECTION LIMIT

Data Reviewed and Approved by: *Leeta Davis*  
 CAL-DHS ELAP#1555

Enviro - Chem, Inc.

1214 E. Lexington Avenue, Pomona, CA 91766 Tel (909) 590-5905 Fax (909) 590-5907

METHOD BLANK REPORT

CUSTOMER: CROLEY & HERRING CO., 353 BEACON RIDGE LANE,  
WALNUT CREEK, CA 94596 TEL(510)939-1118

PROJECT: CHIC

MATRIX: WATER DATE SAMPLE REC'D: 10/23/98 (ETS)  
DATE SAMPLED: 10/19/98 DATE ANALYZED: 10/27-11/02/98  
REPORTED TO: MR. DICK HERRING DATE REPORTED: 11/02/98  
MR. WALTER LOO/ETS (FAX:562-498-2479) (510)482-6230

METHOD BLANK FOR LAB I.D.: 981023-10 TO -11

ANALYSIS: POLYNUCLEAR AROMATIC HYDROCARBONS, EPA METHOD 8270B

UNIT: ug/L (PPB)

PARAMETER	SAMPLE RESULT	D.L.	X1
ACENAPHTHENE	ND	5	
ACENAPHTHYLENE	ND	5	
ANTHRACENE	ND	5	
BENZO (a) ANTHRACENE	ND	5	
BENZO (a) PYRENE	ND	5	
BENZO (b) FLUORANTHENE	ND	5	
BENZO (k) FLUORANTHENE	ND	5	
BENZO (g, h, i) PERYLENE	ND	5	
CHRYSENE	ND	5	
DIBENZO (a, h) ANTHRACENE	ND	5	
FLUORANTHENE	ND	5	
FLUORENE	ND	5	
INDENO (1, 2, 3-cd) PYRENE	ND	5	
NAPHTHALENE	ND	5	
PHENANTHRENE	ND	5	
PYRENE	ND	5	

COMMENTS

D.L. = DETECTION LIMIT

ND = NON-DETECTED OR BELOW THE DETECTION LIMIT

Data Reviewed and Approved by: *Luca Deiter*  
CAL-DHS ELAP#1555

**ENVIRO-CHEM, INC.  
LABORATORIES**

1214 E. Lexington Ave.

Pomona, CA 91766

(909) 590-5905 • Fax: (909) 590-5907

# CHAIN of CUSTODY RECORD

Lab Project # \_\_\_\_\_

CA-DHS ELAP CERTIFICATE # 1555

DATE: 10/  
PAGE: 1 of 1

REPORT TO: <u>DICK HERRING</u>			PROJECT NAME: <u>CHIC</u>			TURN AROUND TIME DESIRED			
STREET: <u>353 BEACON RIDGE LANE</u>			PROJECT CONTACT: <u>WALTER LOO</u>			<input type="checkbox"/> Same Day <input checked="" type="checkbox"/> 24 Hour <input type="checkbox"/> 48 Hour <input type="checkbox"/> 72 Hour <input checked="" type="checkbox"/> 1 Week <input type="checkbox"/> Standard (2 Weeks)			
CITY: <u>WALNUT CREEK</u>		STATE: <u>CA</u>	ZIP: <u>94596</u>		SAMPLER(S) SIGNATURE: <u>[Signature]</u>			Confirmed	
TEL: ( )		FAX: <u>(562) 498 2479</u>				By: _____			
SHIPPING INFORMATION:					AFTER ANALYSES, SAMPLES ARE TO BE:		<input type="checkbox"/> DISPOSED OF <input type="checkbox"/> STORED (30 days) <input type="checkbox"/> RETURNED TO CLIENT <input type="checkbox"/> OTHER:		
RELINQUISHED BY: (Signature) <u>[Signature]</u>				RECEIVED BY: (Signature) <u>[Signature]</u>			DATE: <u>10/23/98</u> TIME: <u>0830</u>		
RELINQUISHED BY: (Signature)				RECEIVED BY: (Signature)			DATE:    TIME:		
RELINQUISHED BY: (Signature)				RECEIVED BY: (Signature)			DATE:    TIME:		
SAMPLE I.D.	LAB I.D.	SAMPLING DATE/TIME	MATRIX	No of Containers	ANALYSIS REQUESTED	COMMENTS	Sample Stored Location		
<u>EW-1</u>	<u>787023-10</u>	<u>10/19/98</u> <u>11:00AM</u>	<u>H<sub>2</sub>O</u>	<u>4</u>	<u>EPA 8020 BTEX</u> <u>EPA 8020 MTBE</u> <u>TPH GAS 8015M</u> <u>PAHs</u>		<u>R1</u>		
<u>MW-4</u>	<u>-1</u>	<u>10/19/98</u> <u>11:00AM</u>	<u>H<sub>2</sub>O</u>	<u>4</u>	<u>SAME AS</u> <u>ABOVE</u>		<u>R1</u>		



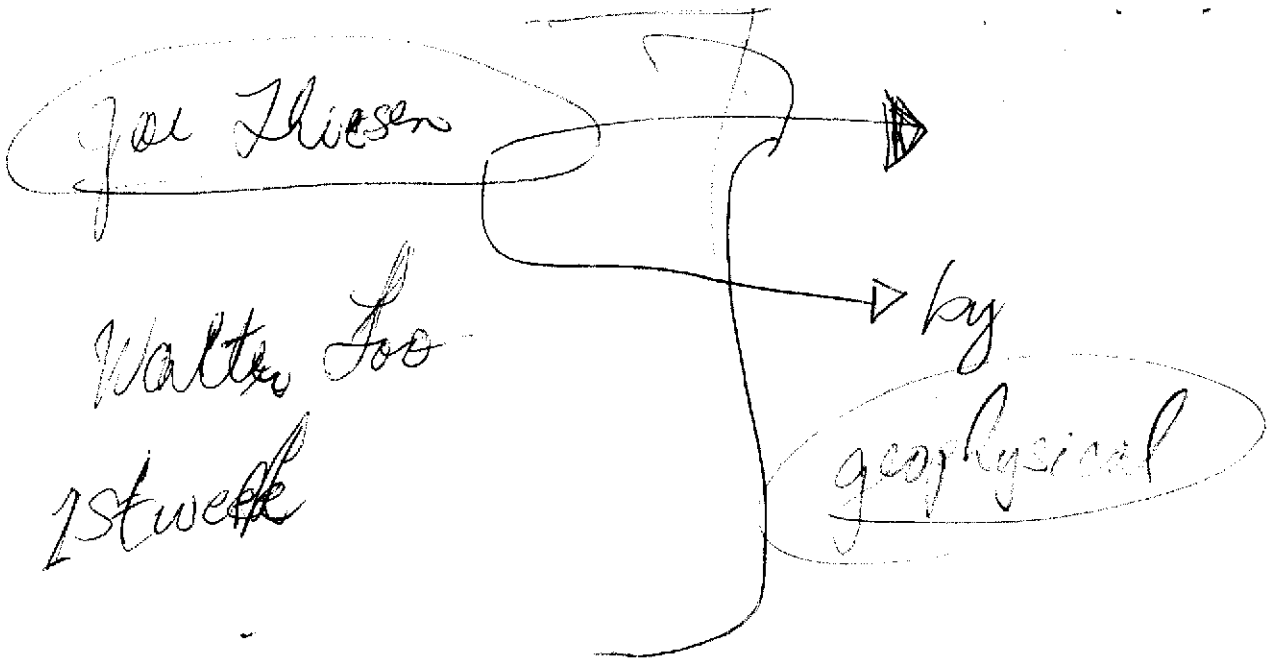

consultants  
Squid

BENNY KWON  
GATEWAY HOUSING CORP.  
405 14th St. Suite 400  
Oakland 94612

up \$800.<sup>00</sup>

new monitoring program  
for new