

ASSESSOR'S MAP 74

Code Area Nos. 21-000 21-002 21-004

Map of Alameda Marsh Land (Bk. 25 Pg. 76)

- P.M. 314 (Bk. 54 Pg. 99) P.M. 7150 232/89
- P.M. 318 (Bk. 58 Pg. 6)
- P.M. 155 (Bk. 58 Pg. 83)
- P.M. 3231 138/11
- P.M. 5767 187/33

ZWP

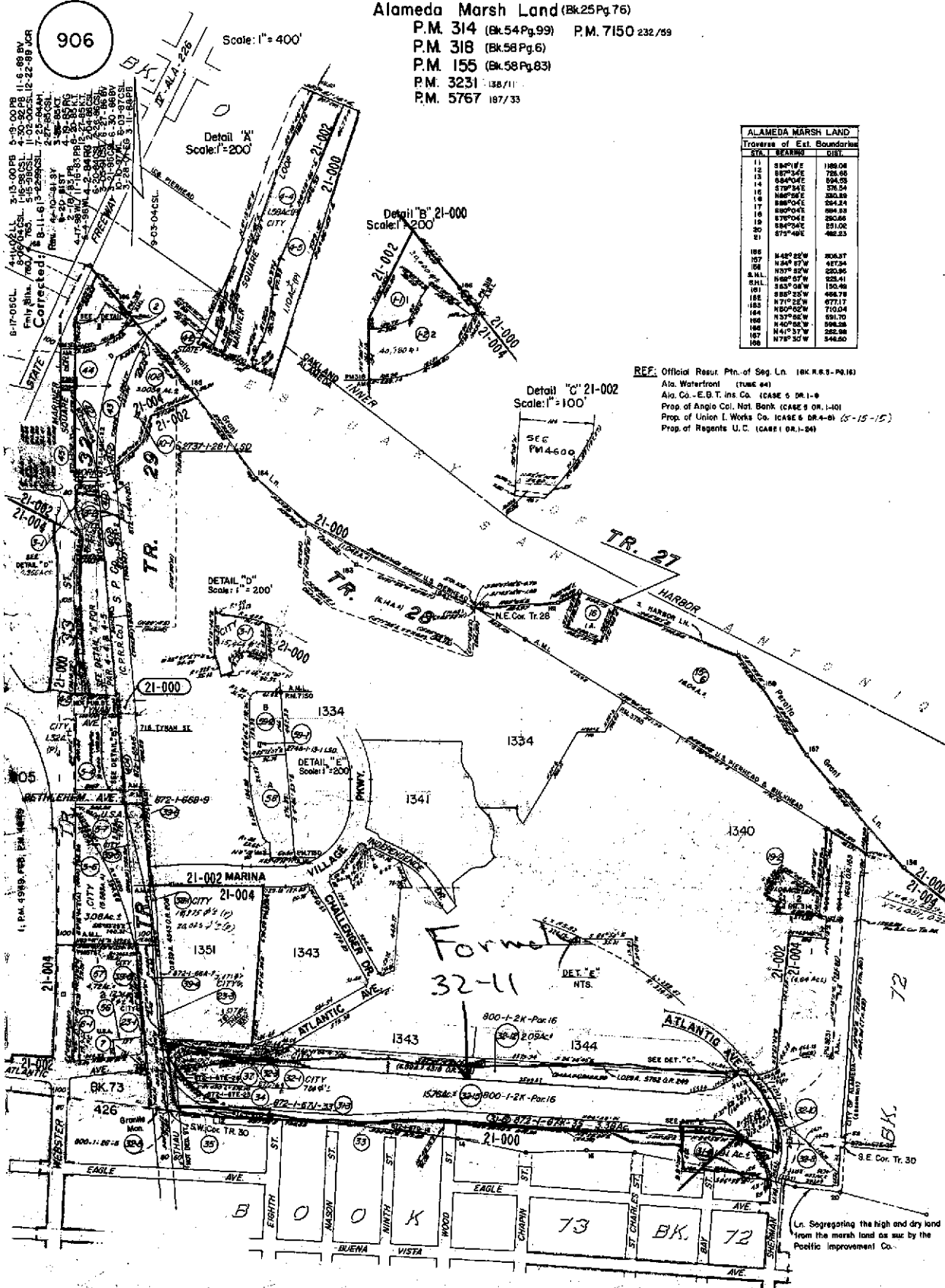

TRAVERSE	BEARING	DIST.
11	S89°12'W	188.04
12	S89°34'E	758.05
13	S89°04'E	504.05
14	S70°54'E	375.54
15	N89°24'E	332.55
16	N89°04'E	284.24
17	N89°04'E	289.82
18	S89°04'E	250.86
19	S89°04'E	251.02
20	S73°48'E	482.23
21		
185	S48°25'W	806.37
187	N24°07'W	477.54
188	N57°22'W	225.95
189	N89°07'W	323.41
190	S89°04'W	150.40
191	S89°25'W	468.78
192	N71°22'W	877.17
193	N89°04'W	710.04
194	N37°02'W	631.70
195	N89°04'W	598.25
196	N41°37'W	252.98
197	N78°30'W	548.50
198		

REF: Official Resur. Ptn. of Seg. Ln. (Bk. R.S. Pg. 18)
 Ala. Waterfront (T.M.C. 44)
 Ala. Co. - E.B.T. Ins. Co. (CASE 5 DR. 1-8)
 Prop. of Anglo Cal. Nat. Bank (CASE 9 DR. 1-40)
 Prop. of Union L. Works Co. (CASE 5 DR. 4-6) (5-15-15)
 Prop. of Regents U.C. (CASE 1 DR. 1-24)



COUNTY OF ALAMEDA
Assessor's Office

Property Value System

History

Value

Transfer

[New Query](#)

Parcel Number: **74-906-32-11** Inactive: Y Lien Date: **01/01/2006** Owner: **ALAMEDA BELT LINE 800-1-2J-POR 14**

Property Address: **SHERMAN ST , ALAMEDA, CA 94501**

[Parcel History](#)

Mailing Name	Historical Mailing Address	Document Date	Document Number	Value From Trans Tax	Parcel Count	Use
ALAMEDA BELT LINE 800-1-2J-POR 14	2001 ENGINEER RD , OAKLAND, CA 94607-5122	01/01/1999	TRAN-96354		1	0500
ALAMEDA BELT LINE	2001 ENGINEER RD , OAKLAND, CA 94607-5122	10/24/1997	1997-282542		5	0500
ALAMEDA BELT LINE 800-1-2H-POR 11	2001 ENGINEER RD , OAKLAND, CA 94607-5122	01/01/1997	TRAN-96353		1	0500

All information on this site is to be assumed accurate for property assessment purposes only, and is based upon the Assessor's knowledge of each property. Caution is advised for use other than its intended purpose.

The Alameda County Intranet site is best viewed in Internet Explorer Version 5.5 or later.
Click [here](#) for more information regarding supported browsers.

Copyright © 2001 Alameda County

Formerly 74-906-32-6

Now 74-906-32-13

74-906-32-14

74-906-32-15