

PACCAR Inc

CORPORATE ENVIRONMENTAL

October 1, 2004

Bob Schultz
Alameda County
Environmental Health Services
1131 Harbor Bay Parkway, Suite 250
Alameda, CA 94502-6577

Re: 2004 Groundwater Monitoring Results
4240 East 14th Street (High Street), Oakland, CA

Alameda County
OCT 08 2004
Environmental Health

Dear Bob:

Enclosed please find one (1) paper copy of the 2004 Annual Groundwater Monitoring Report dated September 17, 2004 which was prepared by AllWest Environmental.

I would like to draw your attention to Section II - Site Setting which outlines the completed site investigations and remedial activities. At this time, we are submitting this report and requesting site closure based on decreasing concentrations and no active sources at the property.

If you have any questions, please contact me at vicki.zumbrunnen@paccar.com or 425-468-7055.

Sincerely,



V. L. ZumBrunnen
Project Manager

Enclosure

Cc: B. N. Holliday
L. C. Robbins
Randi Val Morrison – CSK Auto Inc



AllWest Environmental, Inc.

Specialists in Physical Due
Diligence and Remedial Services

530 Howard Street, Suite 300
San Francisco, CA 94105
Tel 415.391.2510
Fax 415.391.2008

Alameda County
OCT 08 2004
Environmental Health

2004 ANNUAL GROUNDWATER MONITORING REPORT

*Grand Auto #43
4240 East 14th Street
Oakland, California*

PREPARED FOR:

*PACCAR, Inc.
Corporate Environmental Department
P.O. Box 1518
Bellevue, WA 98009*

**ALLWEST PROJECT No. 24070.28
September 17, 2004**

PREPARED BY:

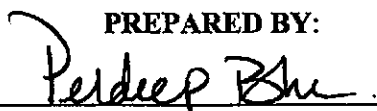

Perdeep Bhui
Site Manager

REVIEWED BY:

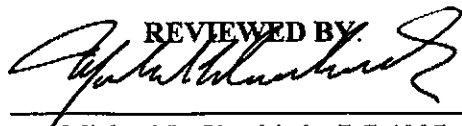

Michael L. Siembieda, RG 4007
Senior Project Manager



TABLE OF CONTENTS

I. INTRODUCTION Page 1

II. PROJECT BACKGROUND Page 1

A. Site Setting Page 1

III. GROUNDWATER SAMPLING AND FIELD OBSERVATIONS Page 2

A. Sampling Protocols Page 2

B. Well Sampling Purge Characteristics Page 3

C. Groundwater Depth and Gradient Page 3

IV. LABORATORY ANALYSES Page 3

A. Halogenated Volatile Organic Compounds Results Page 3

B. Laboratory QA/QC Page 4

V. DISCUSSION AND CONCLUSIONS Page 4

A. Spatial Distribution of Chemical Contaminants Page 4

B. Contaminant Trend Analyses Page 4

VI. CONCLUSION AND RECOMMENDATIONS Page 5

VII. REPORT LIMITATIONS Page 6

TABLES

- Table 1 - Well Construction Details**
- Table 2 - Groundwater Elevation Measurements**
- Table 3 - Summary of Groundwater Analytical Results**

FIGURES

- Figure 1 - Site Location Map**
- Figure 2 - Site Plan with Well Locations**
- Figure 3 - Groundwater Contour Elevation Map**
- Figure 4 - Groundwater Results, 2004**

LABORATORY RESULTS

- Analytical Reports and Chain-of-Custody Documents**

APPENDICES

- Appendix A - Solvent Concentrations versus Time (MW-1, MW-2, MW-3A, W-4, HCL)**
- Appendix B - Groundwater Sampling Logs and Protocols**
- Appendix C - Request for Reliance and General Conditions**



2004 Annual Groundwater Monitoring Report

*Grand Auto #43
4240 East 14th Street
Oakland, California*

I. INTRODUCTION

This report presents the results of the 2004 annual groundwater monitoring event conducted by AllWest Environmental at the former Grand Auto Retail Store #43, Oakland, California, on July 23, 2004. The sampling event involved the monitoring of the four on-site groundwater wells, MW-1, MW-2, MW-3A and MW-4. Included in this report is an abbreviated site setting, a description of field activities, a summary of analytical results, our interpretation of the data and conclusions. Supporting information such as site figures, sampling logs, and laboratory reports are included as attachments or appendices to this report.

The purpose of this report is to present findings from the recent groundwater sampling of the four on-site groundwater monitoring wells, to demonstrate the stability of the plume and that the residual chemicals in the site groundwater are naturally attenuating over time, and to present the findings of the investigation to the Alameda County Health Care Services (ACHCS) and Regional Water Quality Control Board (RWQCB) for their review and to petition the ACHCS and the RWQCB to grant Site Soil and Groundwater Closure status for the subject property.

II. PROJECT BACKGROUND

A. Site Setting

The approximately 1.2 acre former Grand Auto retail facility is located at the northwest corner of High Street and International Boulevard (formerly 14th Street) in Oakland, California. The site currently is used as a Kragen Auto retail merchandise facility. Previously the site was used for retail gasoline sales and had underground storage tanks (USTs) and a car wash with an associated drainage sump. The underground fuel tanks were removed in 1986. The car wash drainage sump was removed in August 1992. During October 1993, the remaining fuel conveyance piping associated with the former underground fuel storage tanks was excavated and removed from the site.

When environmental activities were initiated at the subject property, the former Super Tire store at 4256 East 14th Street (currently All Mufflers Discounted) located southeast of the subject property was included as part of the Grand Auto site. Subsequently, the former Super Tire store was considered by both PACCAR and ACHCS as a separate site. In a letter to PACCAR dated December 27, 1993, the ACHCS indicated that no further action was

required for soil-related issues at the former Super Tire store. In a second letter dated November 20, 2000, ACEHS approved the destruction of a single groundwater well, HC-1, located on the former Super Tire facility.

Review of previous work indicated that the site is underlain by an irregularly layered sequence of silty to gravelly sand lenses separated by clayey silt to depths of 46 feet. The groundwater gradient in this area is very flat, thus the determination of the groundwater flow direction is difficult to assess. Regionally, groundwater is typically reported to flow from the east to the west from the Oakland Hills towards the San Francisco Bay. Groundwater flow in the vicinity of the site has been calculated to be to the east, at a very flat gradient. Groundwater levels continued to show a gradual increase since the California drought years of the late 1980s and early 1990s. Groundwater levels have risen approximately 10 feet at the site since 1993. Groundwater levels measured in 2004 have increased from their 2003 levels and are currently at their highest level since monitoring began in 1983.

Several series of site investigations and remedial activities have been performed at the property since the USTs were removed in 1986. They include drilling of borings at the former location of the USTs, collection of soil samples during removal of the car wash sump, installation and periodic sampling of monitoring wells, removal of conveyance piping, preparation of a closure report, completion of a risk assessment, an issuance of a closure letter for soil by the ACHS in 1996, the reestablishing of groundwater monitoring in 1999, an issuance of a no further remedial action letter by the ACHS in 2000, and the abandonment of two wells and replacement of one well in 2001. A summary of this work was presented in AllWest's "Annual Groundwater Monitoring and Well Destruction Report" dated August 27, 2001.

III. GROUNDWATER SAMPLING AND FIELD OBSERVATIONS

This groundwater monitoring event included gauging the depth to groundwater to calculate the groundwater flow direction and gradient, and sampling of the wells to demonstrate the stability of the groundwater plume and that the chlorinated constituents are naturally attenuating over time. The sampling of the four wells, MW-1 through MW-4 occurred July 23, 2004.

A. Sampling Protocols

AllWest's standard groundwater sampling protocol, as presented in Appendix A, was generally followed. As per these protocols, an electronic sounder was utilized to measure the depth to groundwater in each well. Each well was then purged a minimum of three well volumes using a downhole submersible pump. During purging, groundwater field parameters (temperature, pH, and conductivity) were monitored and recorded on a field log. After purging, samples from each well were collected using a disposable Teflon bailer for chemical analysis. Copies of the groundwater sampling field logs are presented in Appendix A. The purged groundwater was temporarily stored on site in 55-gallon drums and are scheduled to be removed from the site by North State Environmental, a state licensed

hazardous waste transporter. The purge water will be transported under appropriate state and local regulations.

B. Well Sampling Purge Characteristics

The groundwater observed during purging varied from clear to slightly cloudy. Field parameters measured were all within normal ranges for shallow groundwater in this portion of Oakland and similar to the 2003 measurements. pH measured in the samples ranged from 4.1 to 6.13. Conductivity levels were measured between 569 μ S to 870 μ S. Temperatures were measured between 68.2° F to 75.2° F.

C. Groundwater Depth and Gradient

The depth to groundwater ranged between 23.30 feet below ground surface (bgs) in MW-4 to 24.90 feet bgs in MW-3A. As compared to 2003 groundwater levels, the measurements conducted during this investigation show a slight increase averaging approximately 0.5. The current groundwater levels are approximately 10 feet higher than those measure in 1993 at the end of the California drought years of the late 1980s and early 1990s. Groundwater levels are currently at their highest levels since monitoring began in 1993. For detailed information of groundwater elevations with time, please see Table 2.

Groundwater elevations between the wells varied only slightly (0.03 feet). As shown on Figure 3, groundwater elevations ranged from a low of 5.77 feet MSL from MW-1 to a high of 5.80 feet MSL from MW-3A. The groundwater gradient calculated in the vicinity of MW-1, MW3A and MW-4 is approximately 0.001 feet/foot. As noted during previous investigations, groundwater gradients have historically been very flat.

The local groundwater flow direction measured during this and recent sampling events is towards the east. The regional groundwater is to the west towards San Francisco Bay, concurrent with the topography.

IV. LABORATORY ANALYSES

The collected groundwater samples were forwarded to STL of Pleasanton, California, a state certified analytical laboratory, for chemical analyses. The samples were analyzed to detect the presence of halogenated volatile organic compounds (HVOCs) including chlorinated solvents by EPA Method 8260B.

A. Halogenated Volatile Organic Compounds Results (HVOCs)

PCE and its common degradation product, TCE were detected in all four groundwater samples collected during the 2004 investigation. Cis-1,2-DCE was detected in all four groundwater samples collected during the 2004 investigation. Concentrations of PCE ranged from a high of 140 parts per billion (ppb) from MW-1 to a low of 3.7 ppb from

MW-2. TCE followed similar trends as PCE but at lower concentrations. The maximum concentration of TCE was reported from MW-1 at 19 ppb. The maximum concentration of cis-1,2-DCE was reported from MW-1 at 5.9 ppb.

The only other HVOCs detected above their respective laboratory detection limits during the 2004 sampling event included dichlorodifluoromethane (Freon 12) and 1,2-DCA. Freon 12 was reported in all four groundwater wells. The maximum concentration of Freon 12 was reported from MW-1 at 69 ppb which is slightly higher than the 2003 sampling event of 56 ppb. 1,2-DCA was only reported in one groundwater sample collected from MW-2 at 0.53 ppb. Carbon Tetrachloride was detected at 0.50 ppb in MW4. Other HVOCs, including 1,1,1-TCA, vinyl chloride and chloroform previously detected in groundwater samples collected from the wells were not detected above their respective laboratory detection limits during the 2004 sampling event.

B. Laboratory QA/QC

A review of laboratory internal quality assurance/quality control (QA/QC) report indicates the method blank and sample spike data are within the laboratory recovery limits. The laboratory QA/QC report indicated that the groundwater samples were analyzed within the acceptable EPA holding time. Based on the laboratory QA/QC report, the analysis data from STL are considered to be of good quality. A copy of the laboratory analytical reports and chain-of-custody records are presented in the LABORATORY RESULTS section of this report. A summary of the analytical results is presented on Table 3.

V. DISCUSSION AND CONCLUSIONS

A. Spatial Distribution of Chemical Constituents

Chlorinated solvents are being detected in all wells at the property. The highest concentrations of PCE has historically been detected in MW-1. Slightly lower concentration have been detected in MW-3A and MW-4. Significantly lower concentrations of PCE have been detected in MW-2 though this well has detected the highest concentrations of TCE. Based on the spatial distribution of the chemicals detected in onsite monitoring wells, a single, a well defined single source for the chemicals being detected does not exist. Several sources are suspected to have caused the distribution of chemicals being detected in the four monitoring wells, though no specific source has been identified.

B. Contaminant Trend Analyses

Concentrations of chlorinated solvents have varied slightly and have remained relatively stable since the last sampling period though and overall trend of lower concentration is noted. The maximum concentration of PCE detected in the 2004 sampling event was 140 ppb in well MW-1 which is well below the historic maximum concentration of 340 ppb

reported from a 1994 sampling event. Historic lows of PCE and TCE were detected in samples collected from MW-3A and MW-4.

Ratios of the chlorinated solvents are commonly used to assess the age of contaminant releases. This is based on the assumption that most PCE plumes originate as a pure product of PCE as the result of leakage or spillage from dry cleaning facilities, and through time, the PCE will naturally biodegrade to TCE, cis-1,2-DCE, vinyl chloride and ultimately to carbon dioxide and water as the plume disperses in the down gradient flow direction.

With the exception of the MW-2, the ratios of PCE to TCE from this investigation were from approximately 4:1 to 15:1. This ratio indicates that PCE is breaking down due to the biodegradation process of reductive dechlorination. Concentrations of TCE in MW-2 during the 2004 sampling event and historically have exceeded those of PCE. From 1993 to 1996, TCE has been reported to be more than 7 times higher than PCE indicating that the source of the TCE at this location is not exclusively a degradational product of PCE and other sources are likely responsible for the concentrations of TCE being detected at this location. Since sampling was reinstated in 1999, the levels of TCE in this well have significantly decreased from a high of 130 ppb in September 1994 to 11 ppb in July 2004. Concentrations of cis-1,2-DCE in MW-2 have also shown similar trends with a high of 36 ppb detected in September 1994 decreasing to 3 ppb detected in July 2004. This trend supports the presupposition that natural attenuation, through the processes of biodegradation along with dispersion and volatilization are reducing the mass of PCE, TCE and their breakdown products. No onsite source of PCE has been identified at the subject property.

VI. CONCLUSIONS AND RECOMMENDATIONS

The results of the 2004 groundwater sampling event indicate that the shallow groundwater of the subject property is impacted with chlorinated solvents. The spatial distribution of the volatile organics indicates that more than one source or individual release is responsible for the concentrations of the chemicals at the site. Based on the industrial nature of the surrounding area various nearby sources are likely contributing chemicals to those being detected at the property.

Based on the historical decrease in the concentration of the organic chemicals at the site over time, which is attributed to the processes of natural attenuation, and that there are no known active sources at the property, it is highly likely that the concentrations of PCE, TCE and their breakdown products will continue to decrease over time.

Based on site specific results and current health risk based action levels, it is unlikely that the residual contamination in the site groundwater poses as an unacceptable risk to human health environment. See "AllWest Environmental, Site Closure and Groundwater Monitoring Report, Grand Auto Store No. 43, 4240 East 14th Street, Oakland California, August 15, 2000." Based on the above, AllWest recommends Site Closure status be granted for the subject property by the ACHCS and the RWQCB.

VII. REPORT LIMITATIONS

The work described in this report is performed in accordance with the Environmental Consulting Agreement between PACCAR and AllWest Environmental, dated June 20, 2004. AllWest has prepared this report for the exclusive use of PACCAR for this particular project and in accordance with generally accepted practices at the time of the work. No other warranties, certifications or representation, either expressed or implied are made as to the professional advice offered. The services provided for PACCAR were limited to their specific requirements; the limited scope allows for AllWest to form no more than an opinion of the actual site conditions.

The conclusions and recommendations contained in this report are made based on observed conditions existing at the site, laboratory test results of the submitted samples, and interpretation of a limited data set. It must be recognized that changes can occur in subsurface conditions due to site use or other reasons. Furthermore, the distribution of chemical concentrations in the subsurface can vary spatially and over time. The results of chemical analysis are valid as of the date and at the sampling location only. AllWest cannot be held accountable for the accuracy of the test data from independent laboratories nor for any analyte quantities falling below the recognized standard detection limits for the method utilized by the independent laboratories.

TABLES

Table 1 - Well Construction Details

**Grand Auto #43
4240 East 14th Street Oakland, California
Oakland, California**

AllWest Project Number 24070.28

Well Number	Surface Elevation (ft MSL)	Top of Casing (ft MSL)	Total Depth (ft bgs)	Top of Screen (ft bgs)	Bottom of Screen (ft bgs)	Well Diameter (Inches)
MW-1	30.8	30.53	43	33	43	4
MW-2	30.7	30.41	45	31	45	4
MW-3	30.7	30.31	45	30	45	4
MW-3A	30.9	30.70	41	20	41	4
MW-4	29.5	29.08	45	30	45	4
HC-1	28.7	28.33	42	30	42	4

Notes: MW-3 was replaced by MW-3A on May 25, 2000
HC-1 was abandoned on June 18, 2001
bgs = below ground surface
MSL = mean sea level
NM = not measured
Elevations relative to City of Oakland datum

TABLE 2 - Groundwater Elevation Measurements
4240 East 14th Street
Oakland, California
Groundwater Elevations

Project Number 24070.28

Well Number	Top of Well Casing Feet Above MSL	Depth to Groundwater Feet bgs	Groundwater Elevation Feet Above MSL	Date Collected
	30.53	24.76	5.77	23-Jul-04
	30.53	25.29	5.24	15-May-03
	30.53	24.91	5.62	21-May-02
	30.53	25.67	4.86	19-Jun-01
	30.53	27.40	3.13	4-Nov-99
	30.53	28.18	2.35	10-May-96
	30.53	29.34	1.19	15-Sep-95
	30.53	30.83	-0.30	31-Jan-95
	30.53	32.44	-1.91	20-Sep-94
	30.53	33.04	-2.51	7-Jun-94
	30.53	34.60	-4.07	18-Feb-94
	30.53	35.30	-4.77	17-Nov-93
	30.53	34.93	-4.40	4-Aug-93
	30.53	35.45	-4.92	5-May-93
	30.41	24.62	5.79	23-Jul-04
	30.41	25.16	5.25	15-May-03
	30.41	24.78	5.63	21-May-02
	30.41	25.54	4.87	19-Jun-01
	30.41	27.28	3.13	4-Nov-99
	30.41	28.06	2.35	10-May-96
	30.41	29.19	1.22	15-Sep-95
	30.41	30.71	-0.30	31-Jan-95
	30.41	32.40	-1.99	20-Sep-94
	30.41	32.92	-2.51	7-Jun-94
	30.41	34.46	-4.05	18-Feb-94
	30.41	35.18	-4.77	17-Nov-93
	30.41	34.79	-4.38	4-Aug-93
	30.41	35.32	-4.91	5-May-93
	30.70	24.90	5.80	23-Jul-04
	30.70	25.43	5.27	15-May-03
	30.70	25.04	5.66	21-May-02
	30.70	25.81	4.89	19-Jun-01
	30.31	27.22	3.09	4-Nov-99
	30.31	27.96	2.35	10-May-96
	30.31	29.11	1.20	15-Sep-95
	30.31	30.62	-0.31	31-Jan-95
	30.31	32.30	-1.99	20-Sep-94
	30.31	32.83	-2.52	7-Jun-94
	30.31	34.38	-4.07	18-Feb-94
	30.31	35.13	-4.82	17-Nov-93
	30.31	34.70	-4.39	4-Aug-93
	30.31	35.22	-4.91	5-May-93
	29.08	23.30	5.78	23-Jul-04
	29.08	23.82	5.26	15-May-03
	29.08	23.46	5.62	21-May-02
	29.08	24.20	4.88	19-Jun-01
	29.08	25.92	3.16	4-Nov-99
	29.08	26.70	2.38	10-May-96
	29.08	27.86	1.22	15-Sep-95
	29.08	29.38	-0.30	31-Jan-95
	29.08	31.07	-1.99	20-Sep-94
	29.08	31.60	-2.52	7-Jun-94
	29.08	33.14	-4.06	18-Feb-94
	29.08	33.90	-4.82	17-Nov-93

TABLE 3 - Summary of Groundwater Analytical Results

4240 East 14th Street, Oakland, California

Project Number 24070.28

All results in parts per billion (ppb)

Location	PCE	TCE	cis-1,2 DCE	FREON 12	Chloro- form	1,1,1-TCA	1,2-DCA	Vinyl Chloride	Carbon Tetrachloride	TPH-S	All others	Date Collected
MW-1	140	19	5.9	89	ND	ND	ND	ND	ND	NA	ND	23-Jul-04
	120	15	5.8	50	ND	ND	ND	ND	ND	NA	ND	15-May-03
	140	15	ND	ND	ND	ND	ND	ND	ND	NA	ND	21-May-02
	130	17	5.3	35	ND	ND	ND	ND	ND	NA	ND	19-Jun-01
	120	17	6.6	62	ND	ND	ND	ND	ND	ND	ND	4-Nov-99
	270	24	4.3	NR	2.6	ND 1.3	ND 1.3	ND 1.3	ND	NR	ND	10-May-96
	200	25	6.8	NR	1.4	ND 0.5	ND 0.5	ND 0.5	ND	ND	ND	15-Sep-95
	54	13	9.7	NR	ND 1	ND 1	ND 1	ND 2	ND	ND	ND	31-Jan-95
	54	13	9.3	NR	ND 1	ND 1	ND 1	ND 2	ND	ND	ND	31-Jan-95
	270	37	19	NR	ND 5	ND 5	ND 5	ND 5	ND	ND	ND	20-Sep-94
	270	38	18	NR	ND 5	ND 5	ND 5	ND 5	ND	ND	ND	20-Sep-94
	200	28	25	NR	1.8	ND 0.5	ND 0.5	ND 0.5	ND	ND	ND	7-Jun-94
	340	35	22	NR	1.5	ND 0.5	ND 0.5	ND 0.5	ND	ND	ND	7-Jun-94
	200	25	12	NR	1	ND 0.5	ND 0.5	ND 0.5	ND	ND	ND	18-Feb-94
	230	28	15	NR	1.8	ND 0.5	ND 0.5	ND 1	ND	ND	ND	17-Nov-93
	290	23	10	NR	ND 5	ND 5	ND 5	ND 10	ND	ND	ND	4-Aug-93
	300	22	8.7	37	1	ND 0.5	ND 0.5	ND 1	ND	ND	ND	26-Apr-93
	300	22	8.7	110	1.1	0.6	ND 0.5	ND 1	ND	ND	ND	26-Apr-93
	220	28	14	NR	ND 3	ND 3	ND 1	-	ND	ND	ND	19-Jan-93
	310	26	11	NR	1.1	ND 0.5	ND 0.6	-	ND	ND	ND	10-Sep-92
MW-2	3.7	11	3	60	ND	ND	0.53	ND	ND	NA	ND	23-Jul-04
	3.9	12	2.9	56	ND	ND	0.63	ND	ND	NA	ND	15-May-03
	6.3	4.7	0.84	44	ND	ND	ND	ND	0.61	NA	ND	21-May-02
	9.1	5.3	1	38	ND	ND	ND	ND	0.83	NA	ND	19-Jun-01
	7.8	8.1	1.9	55	ND	ND	ND	ND	2	ND	ND	4-Nov-99
	7.2	51	13	NR	ND 1	ND 1	ND 1	ND 1	ND	NR	ND	10-May-96
	6.3	52	17	NR	ND 0.5	ND 0.5	ND 0.5	0.8	ND	ND	ND	15-Sep-95
	6.5	69	17	NR	ND 0.5	ND 0.5	0.9	0.9	ND	ND	ND	15-Sep-95
	3	60	17	NR	ND 1	ND 1	ND 1	ND 2	ND	ND	ND	31-Jan-95
	6	130	36	NR	ND 5	ND 5	ND 5	ND 5	ND	ND	ND	20-Sep-94
	6.9	120	31	NR	ND 0.5	ND 0.5	1.8	ND 0.5	ND	ND	ND	7-Jun-94
	4.8	75	25	NR	ND 0.5	ND 0.5	1.5	ND 0.5	ND	ND	ND	18-Feb-94
	6.1	32	8.7	NR	ND 0.5	ND 0.5	ND 0.5	ND 1	ND	ND	ND	17-Nov-93
	7.2	110	22	NR	ND 1.2	ND 1.2	ND 1.2	ND 2.4	ND	ND	ND	4-Aug-93
	7.5	32	8.5	31	0.9	0.6	0.6	ND 1	ND	ND	ND	26-Apr-93
MW-3A	85	12	2.4	8.3	ND	ND	ND	ND	ND	NA	ND	23-Jul-04
	130	16	ND	21	ND	ND	ND	ND	ND	NA	ND	15-May-03
	120	16	ND	7.1	ND	ND	ND	ND	ND	NA	ND	2-May-02
	120	21	ND	ND	ND	ND	ND	ND	ND	NA	ND	19-Jun-01
	150	24	14	14	ND	ND	ND	ND	ND	61	ND	4-Nov-99
	160	25	7.2	NR	ND 1	ND 1	ND 1	ND 1	ND	NR	ND	10-May-96
	170	25	6.2	NR	ND 0.5	ND 0.5	ND 0.5	ND 0.5	ND	ND	ND	15-Sep-95
	160	34	6.2	NR	ND 1	ND 1	ND 1	ND 5	ND	ND	ND	31-Jan-95
	240	37	11	NR	ND 5	ND 5	ND 5	ND 5	ND	ND	ND	20-Sep-94
	160	34	8.3	NR	0.6	0.6	ND 0.5	ND 0.5	ND	ND	ND	7-Jun-94
	85	19	5	NR	0.7	ND 0.5	ND 0.5	ND 0.5	ND	ND	ND	18-Feb-94
	170	29	12	NR	1.3	0.8	ND 0.5	ND 1	ND	ND	ND	17-Nov-93
	170	28	ND 5	NR	ND 5	ND 5	ND 5	ND 10	ND	ND	ND	4-Aug-93
79	21	9.7	35	ND 0.5	0.8	ND 0.5	ND 1	ND	ND	ND	26-Apr-93	
MW-4	23	3.7	1	26	ND	ND	ND	ND	0.5	NA	ND	23-Jul-04
	120	7.7	0.75	16	ND	ND	ND	ND	ND	NA	ND	15-May-03
	70	7.7	ND	18	ND	ND	ND	ND	ND	NA	ND	21-May-02
	47	7	1.2	19	ND	ND	ND	ND	ND	NA	ND	19-Jun-01
	61	10	2.2	41	ND	ND	ND	ND	ND	ND	ND	4-Nov-99
	190	22	2.5	NR	ND 1.3	ND 1.3	ND 1.3	ND 1.3	ND	NR	ND	10-May-96
	160	24	4.4	NR	ND 0.5	ND 0.5	ND 0.5	ND 0.5	ND	ND	ND	15-Sep-95
	140	20	4.7	NR	ND 1	ND 1	ND 1	ND 5	ND	ND	ND	31-Jan-95
	220	32	5	NR	ND 5	ND 5	ND 5	ND 5	ND	ND	ND	20-Sep-94
	140	28	7.1	NR	0.9	0.9	ND 0.5	ND 0.5	ND	ND	ND	7-Jun-94
	120	31	6	NR	1.9	0.7	ND 0.5	ND 0.5	ND	ND	ND	18-Feb-94
	87	20	6.6	NR	1	ND 0.5	ND 0.5	ND 1	ND	ND	ND	17-Nov-93
	110	16	ND 5	NR	ND 5	ND 5	ND 5	ND 10	ND	ND	ND	4-Aug-93
78	17	3.9	28	0.6	ND 0.5	ND 0.5	ND 1	ND	ND	ND	26-Apr-93	
HC-1	100	17	8.7	43	ND	ND	ND	ND	ND	ND	ND	4-Nov-99
	200	27	13	NR	ND 5	ND 5	ND 5	ND 5	ND	NR	ND	10-May-96
	170	27	14	NR	ND 0.5	ND 0.5	ND 0.5	ND 0.5	ND	ND	ND	15-Sep-95
	120	27	11	NR	ND 1	ND 1	ND 1	ND 5	ND	ND	ND	31-Jan-95
	190	37	15	NR	ND 5	ND 5	ND 5	ND 5	ND	ND	ND	20-Sep-94
	180	42	22	NR	1	ND 0.5	ND 0.5	ND 0.5	ND	ND	ND	7-Jun-94
	140	30	13	NR	0.7	ND 0.5	ND 0.5	ND 0.5	ND	ND	ND	18-Feb-94
	150	22	11	NR	0.6	ND 0.5	ND 0.5	ND 0.5	ND	ND	ND	18-Feb-94
	130	27	18	NR	1.1	0.7	ND 0.6	ND 2	ND	ND	ND	17-Nov-93
	83	27	15	NR	ND 0.5	ND 0.5	ND 0.5	ND 1	ND	ND	ND	4-Aug-93
46	22	13	47	ND 0.5	ND 0.5	ND 0.5	ND 1	ND	ND	ND	26-Apr-93	

FIGURES

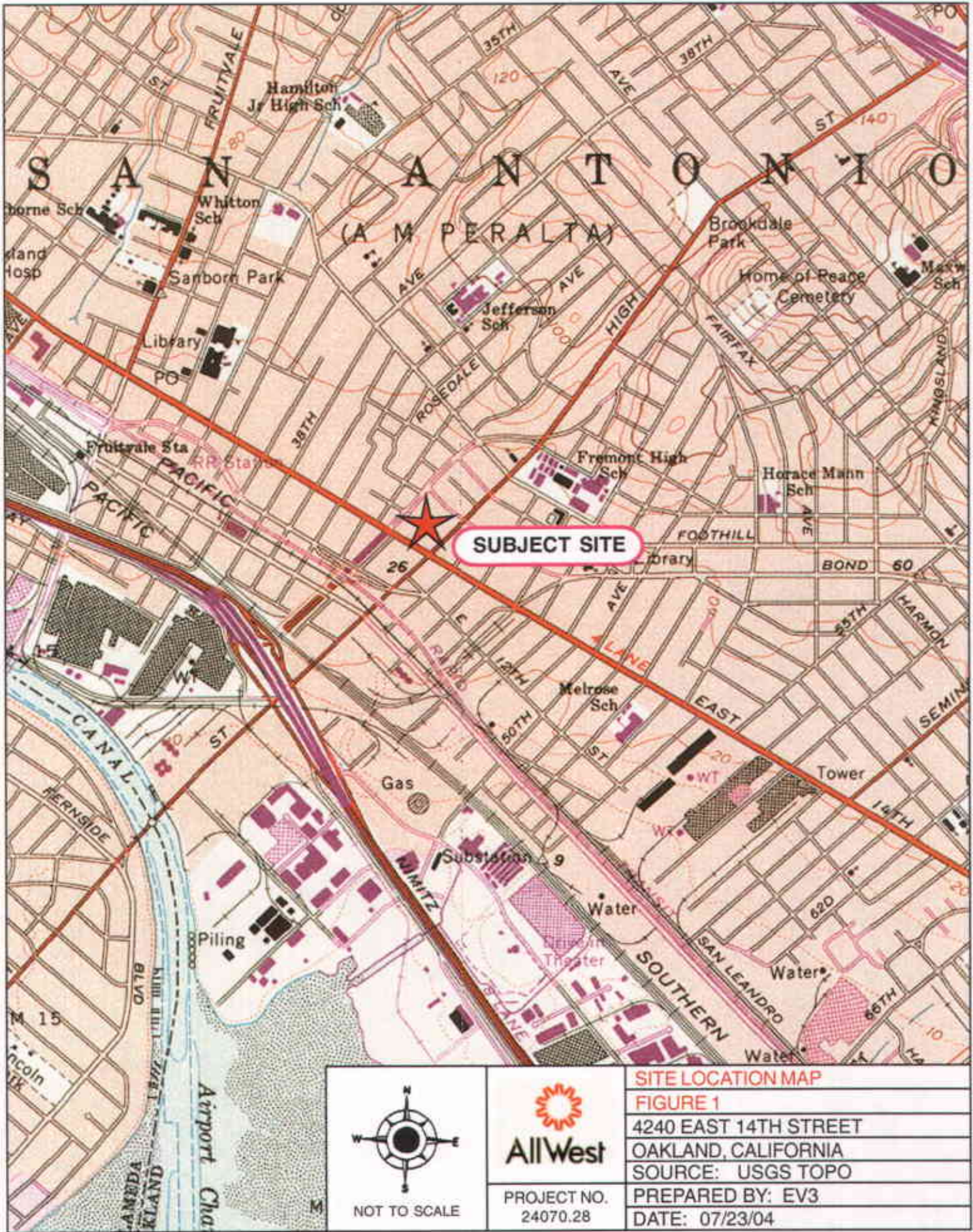

SUBJECT SITE

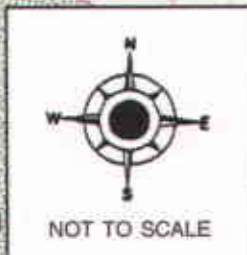

AllWest

PROJECT NO.
24070.28

SITE LOCATION MAP	
FIGURE 1	
4240 EAST 14TH STREET	
OAKLAND, CALIFORNIA	
SOURCE: USGS TOPO	
PREPARED BY: EV3	
DATE: 07/23/04	

MISSION AUTOMOTIVE

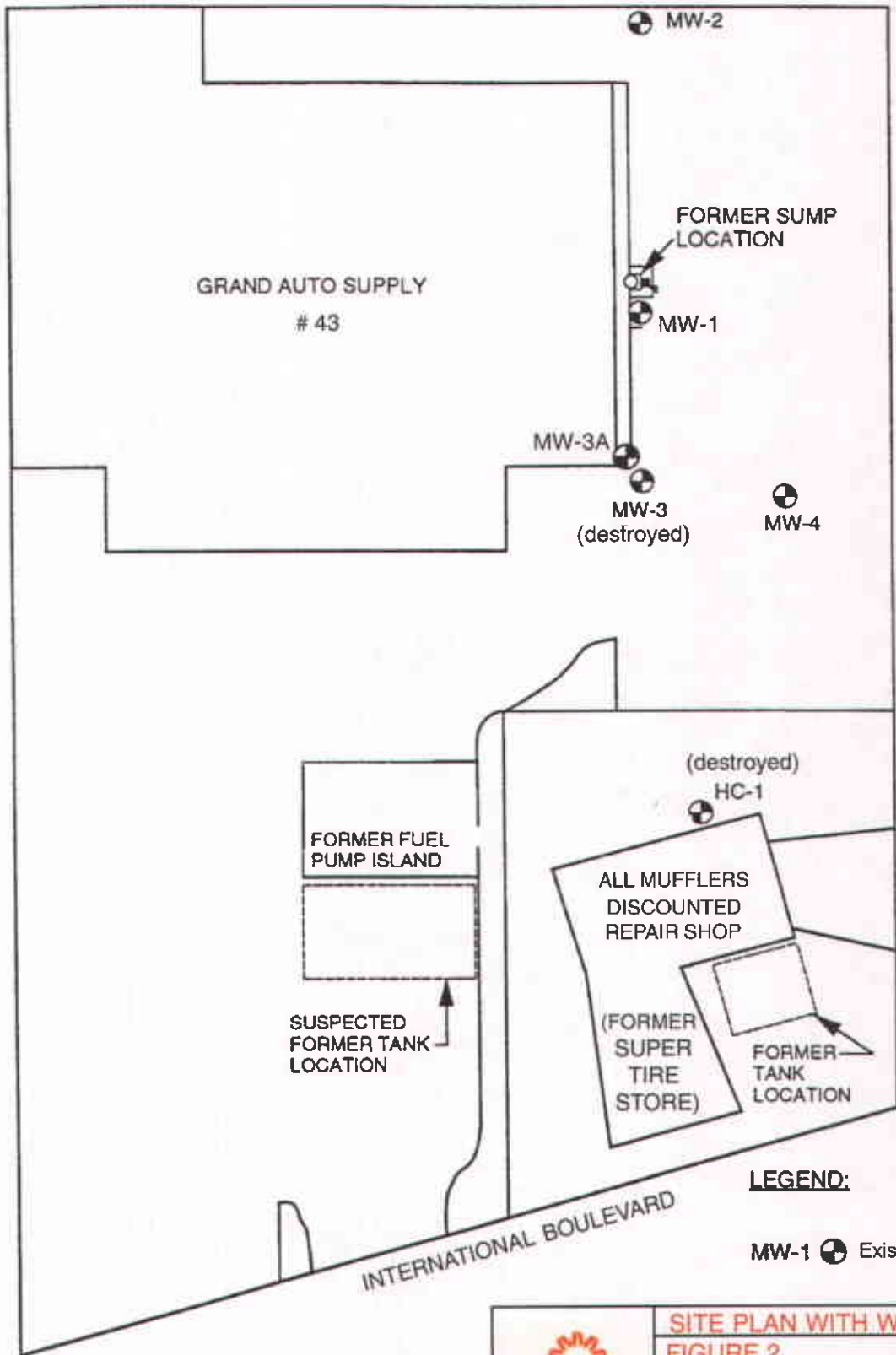

HIGH STREET
 FORMER DRY CLEANERS
 EXISTING DRY CLEANERS

LEGEND:

MW-1 Existing Well Location

Note:
 MW-3A replaced MW-3 on 05/25/00 and HC-1 abandoned on 06/18/01.

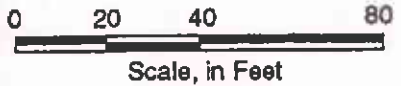

	<p>SITE PLAN WITH WELL LOCATIONS</p> <p>FIGURE 2</p>
	<p>4240 EAST 14TH STREET</p> <p>OAKLAND, CALIFORNIA</p> <p>SOURCE: ALLWEST</p>
<p>PROJECT NO. 24070.28</p>	<p>PREPARED BY: EV3</p> <p>DATE: 07/23/04</p>

MISSION AUTOMOTIVE

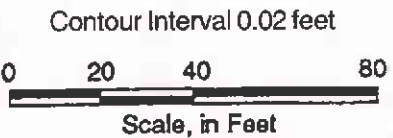
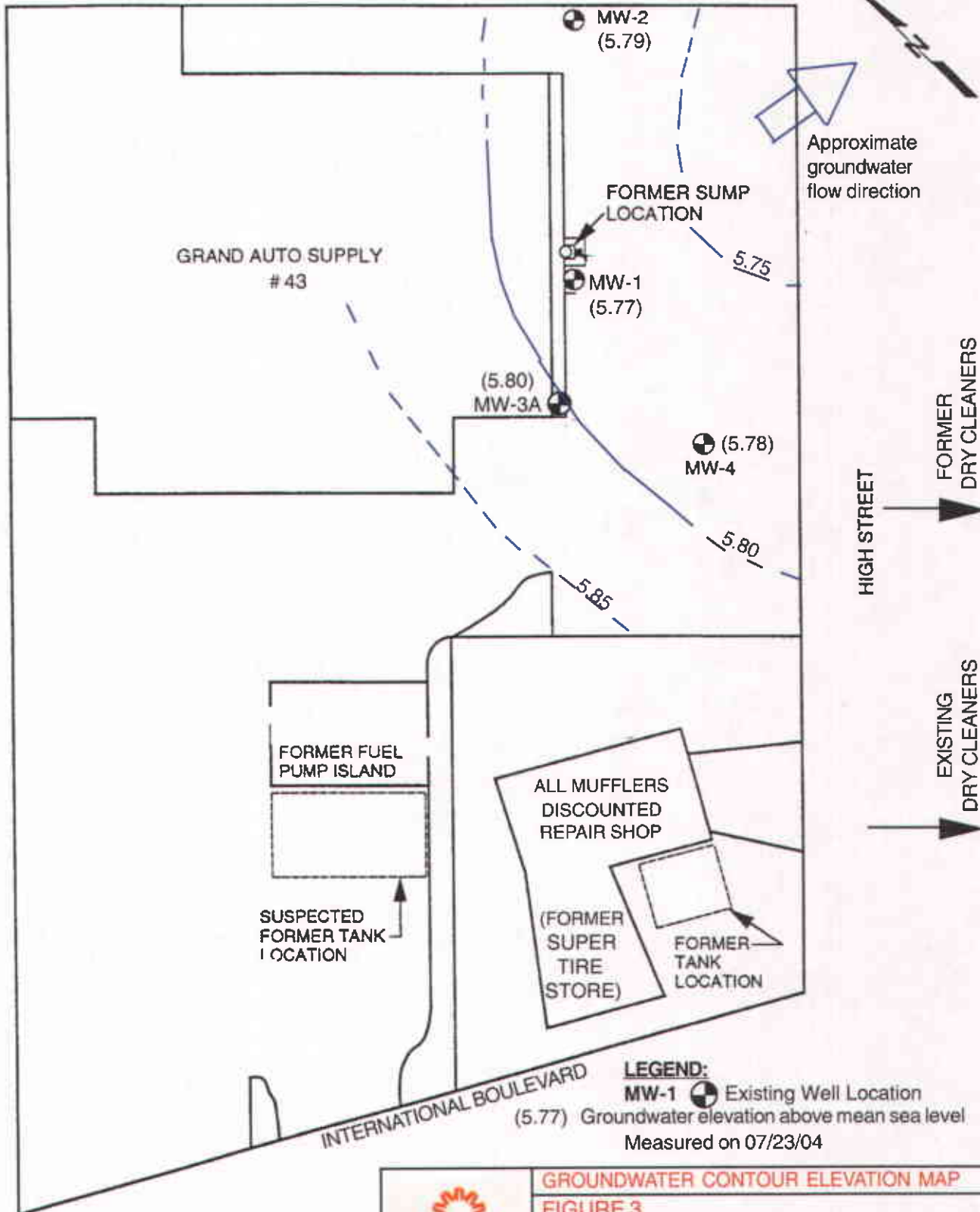

	GROUNDWATER CONTOUR ELEVATION MAP	
	FIGURE 3	
	4240 EAST 14TH STREET	
	OAKLAND, CALIFORNIA	
	SOURCE: ALLWEST	
PROJECT NO.	PREPARED BY: J.K.M. TINGIN	
24070.28	DATE: 07/23/04	

MISSION AUTOMOTIVE

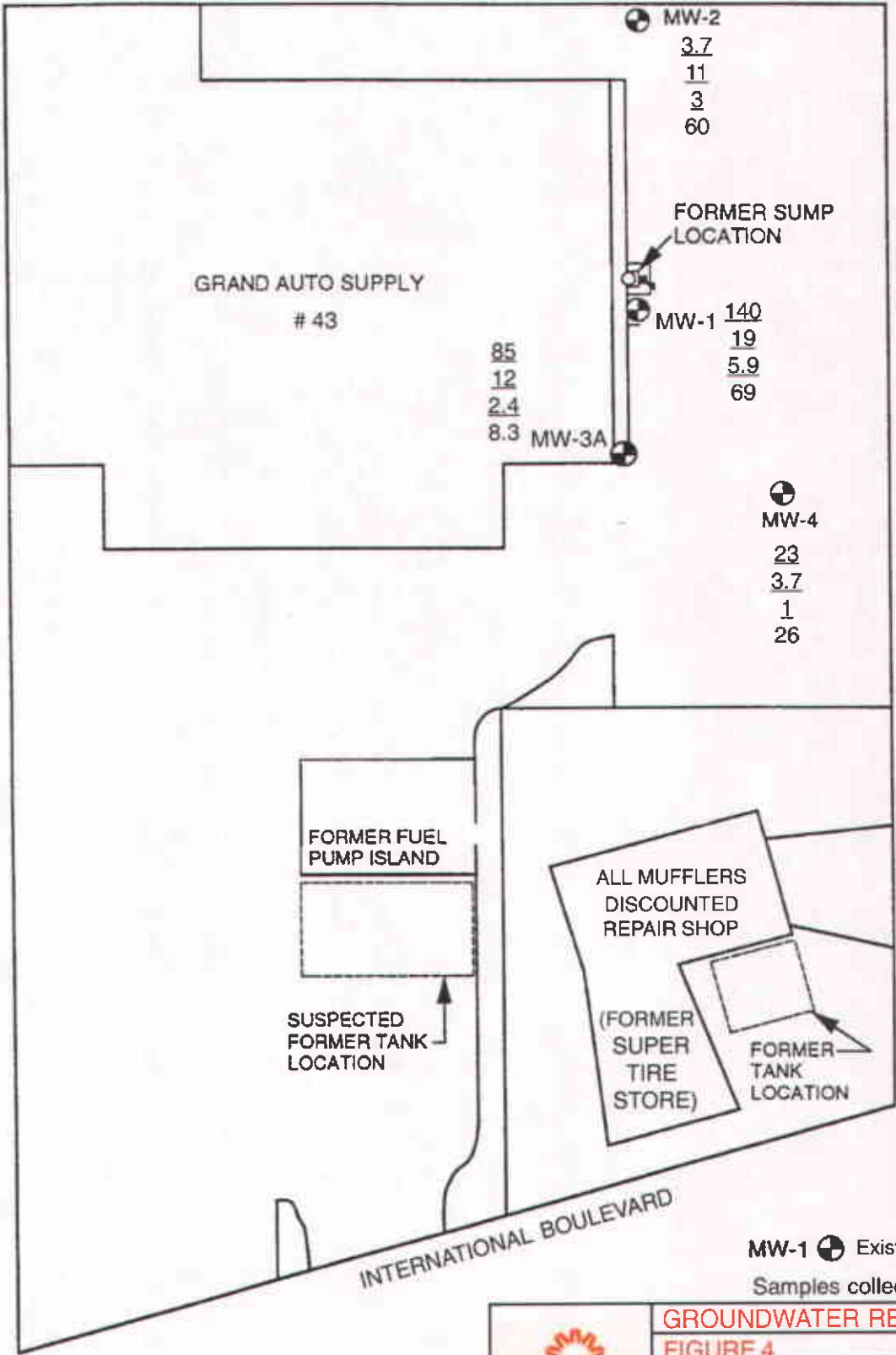

HIGH STREET
 FORMER DRY CLEANERS
 EXISTING DRY CLEANERS

LEGEND:
 140 PCE
 19 TCE
 5.9 cis-1,2 DCE
 69 Dichlorodifluoromethane (freon 12)
 (Results in ppb)

MW-1 Existing Well Location
 Samples collected on 07/23/04

 AllWest	GROUNDWATER RESULTS - 2004
	FIGURE 4
	4240 EAST 14TH STREET
	OAKLAND, CALIFORNIA
	SOURCE: ALLWEST
PROJECT NO. 24070.28	PREPARED BY: J.K.M. TINGIN
	DATE: 07/23/04

0 20 40 80
 Scale, in Feet

LABORATORY RESULTS

Allwest Environmental

July 30, 2004

530 Howard Street, Suite #300
San Francisco, CA 94105

Attn.: Michael Siembieda

Project#: 24070.28

Project: Paccar GW 04

Dear Mr. Siembieda,

Attached is our report for your samples received on 07/23/2004 15:35

This report has been reviewed and approved for release. Reproduction of this report is permitted only in its entirety.

Please note that any unused portion of the samples will be discarded after 09/06/2004 unless you have requested otherwise.

We appreciate the opportunity to be of service to you. If you have any questions, please call me at (925) 484-1919.

You can also contact me via email. My email address is: ssidhu@stl-inc.com

Sincerely,

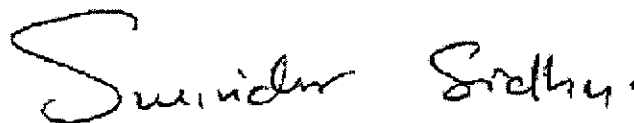

Surinder Sidhu
Project Manager

Severn Trent Laboratories, Inc.

STL San Francisco * 1220 Quarry Lane, Pleasanton, CA 94566

Tel 925 484 1919 Fax 925 484 1096 * www.stl-inc.com * CA DHS ELAP# 2496

Halogenated Volatile Organic Compounds by 8021B/8260B

Allwest Environmental

Attn.: Michael Siembieda

530 Howard Street, Suite #300

San Francisco, CA 94105

Phone: (415) 391-2510 Fax: (415) 391-2008

Project: 24070.28

Paccar GW 04

Received: 07/23/2004 15:35

Samples Reported

Sample Name	Date Sampled	Matrix	Lab #
MW-1	07/23/2004	Water	1
MW-2	07/23/2004	Water	2
MW-3A	07/23/2004	Water	3
MW-4	07/23/2004	Water	4

Severn Trent Laboratories, Inc.

STL San Francisco * 1220 Quarry Lane, Pleasanton, CA 94566

Tel 925 484 1919 Fax 925 484 1096 * www.stl-inc.com * CA DHS ELAP# 2496

07/30/2004 15:08

Halogenated Volatile Organic Compounds by 8021B/8260B

Allwest Environmental

Attn.: Michael Siembieda

530 Howard Street, Suite #300
San Francisco, CA 94105
Phone: (415) 391-2510 Fax: (415) 391-2008Project: 24070.28
Paccar GW 04

Received: 07/23/2004 15:35

Prep(s): 5030B Test(s): 8260B
Sample ID: MW-1 Lab ID: 2004-07-0729 - 1
Sampled: 07/23/2004 Extracted: 7/30/2004 11:24
Matrix: Water QC Batch#: 2004/07/30-01.09
Analysis Flag: o (See Legend and Note Section)

Compound	Conc.	RL	Unit	Dilution	Analyzed	Flag
Dichlorodifluoromethane	69	4.0	ug/L	4.00	07/30/2004 11:24	
Vinyl chloride	ND	2.0	ug/L	4.00	07/30/2004 11:24	
Chloroethane	ND	4.0	ug/L	4.00	07/30/2004 11:24	
Trichlorofluoromethane	ND	4.0	ug/L	4.00	07/30/2004 11:24	
1,1-Dichloroethene	ND	2.0	ug/L	4.00	07/30/2004 11:24	
Methylene chloride	ND	20	ug/L	4.00	07/30/2004 11:24	
trans-1,2-Dichloroethene	ND	2.0	ug/L	4.00	07/30/2004 11:24	
cis-1,2-Dichloroethene	5.9	2.0	ug/L	4.00	07/30/2004 11:24	
1,1-Dichloroethane	ND	2.0	ug/L	4.00	07/30/2004 11:24	
Chloroform	ND	2.0	ug/L	4.00	07/30/2004 11:24	
1,1,1-Trichloroethane	ND	2.0	ug/L	4.00	07/30/2004 11:24	
Carbon tetrachloride	ND	2.0	ug/L	4.00	07/30/2004 11:24	
1,2-Dichloroethane	ND	2.0	ug/L	4.00	07/30/2004 11:24	
Trichloroethene	19	2.0	ug/L	4.00	07/30/2004 11:24	
1,2-Dichloropropane	ND	2.0	ug/L	4.00	07/30/2004 11:24	
Bromodichloromethane	ND	2.0	ug/L	4.00	07/30/2004 11:24	
2-Chloroethylvinyl ether	ND	2.0	ug/L	4.00	07/30/2004 11:24	
trans-1,3-Dichloropropene	ND	2.0	ug/L	4.00	07/30/2004 11:24	
cis-1,3-Dichloropropene	ND	2.0	ug/L	4.00	07/30/2004 11:24	
1,1,2-Trichloroethane	ND	2.0	ug/L	4.00	07/30/2004 11:24	
Tetrachloroethene	140	2.0	ug/L	4.00	07/30/2004 11:24	
Dibromochloromethane	ND	2.0	ug/L	4.00	07/30/2004 11:24	
Chlorobenzene	ND	2.0	ug/L	4.00	07/30/2004 11:24	
Bromoform	ND	8.0	ug/L	4.00	07/30/2004 11:24	
1,1,2,2-Tetrachloroethane	ND	2.0	ug/L	4.00	07/30/2004 11:24	
1,3-Dichlorobenzene	ND	2.0	ug/L	4.00	07/30/2004 11:24	
1,4-Dichlorobenzene	ND	2.0	ug/L	4.00	07/30/2004 11:24	
1,2-Dichlorobenzene	ND	2.0	ug/L	4.00	07/30/2004 11:24	
Trichlorotrifluoroethane	ND	2.0	ug/L	4.00	07/30/2004 11:24	

Severn Trent Laboratories, Inc.

STL San Francisco * 1220 Quarry Lane, Pleasanton, CA 94566

Tel 925 484 1919 Fax 925 484 1096 * www.stl-inc.com * CA DHS ELAP# 2496

07/30/2004 15:08

Halogenated Volatile Organic Compounds by 8021B/8260B

Allwest Environmental
Attn.: Michael Siembieda

530 Howard Street, Suite #300
San Francisco, CA 94105
Phone: (415) 391-2510 Fax: (415) 391-2008

Project: 24070.28
Paccar GW 04

Received: 07/23/2004 15:35

Prep(s): 5030B Test(s): 8260B
Sample ID: MW-1 Lab ID: 2004-07-0729 - 1
Sampled: 07/23/2004 Extracted: 7/30/2004 11:24
Matrix: Water QC Batch#: 2004/07/30-01.09
Analysis Flag: o (See Legend and Note Section)

Compound	Conc.	RL	Unit	Dilution	Analyzed	Flag
Chloromethane	ND	4.0	ug/L	4.00	07/30/2004 11:24	
Bromomethane	ND	4.0	ug/L	4.00	07/30/2004 11:24	
Surrogate(s)						
4-Bromofluorobenzene	81.8	79-118	%	4.00	07/30/2004 11:24	
1,2-Dichloroethane-d4	92.5	78-117	%	4.00	07/30/2004 11:24	
Toluene-d8	88.4	77-121	%	4.00	07/30/2004 11:24	

Halogenated Volatile Organic Compounds by 8021B/8260B

 Allwest Environmental
 Attn.: Michael Siembieda

 530 Howard Street, Suite #300
 San Francisco, CA 94105
 Phone: (415) 391-2510 Fax: (415) 391-2008

 Project: 24070.28
 Paccar GW 04

Received: 07/23/2004 15:35

Prep(s):	5030B	Test(s):	8260B
Sample ID:	MW-2	Lab ID:	2004-07-0729 - 2
Sampled:	07/23/2004	Extracted:	7/30/2004 11:53
Matrix:	Water	QC Batch#:	2004/07/30-01.09

Compound	Conc.	RL	Unit	Dilution	Analyzed	Flag
Dichlorodifluoromethane	60	1.0	ug/L	1.00	07/30/2004 11:53	
Vinyl chloride	ND	0.50	ug/L	1.00	07/30/2004 11:53	
Chloroethane	ND	1.0	ug/L	1.00	07/30/2004 11:53	
Trichlorofluoromethane	ND	1.0	ug/L	1.00	07/30/2004 11:53	
1,1-Dichloroethene	ND	0.50	ug/L	1.00	07/30/2004 11:53	
Methylene chloride	ND	5.0	ug/L	1.00	07/30/2004 11:53	
trans-1,2-Dichloroethene	ND	0.50	ug/L	1.00	07/30/2004 11:53	
cis-1,2-Dichloroethene	3.0	0.50	ug/L	1.00	07/30/2004 11:53	
1,1-Dichloroethane	ND	0.50	ug/L	1.00	07/30/2004 11:53	
Chloroform	ND	0.50	ug/L	1.00	07/30/2004 11:53	
1,1,1-Trichloroethane	ND	0.50	ug/L	1.00	07/30/2004 11:53	
Carbon tetrachloride	ND	0.50	ug/L	1.00	07/30/2004 11:53	
1,2-Dichloroethane	0.53	0.50	ug/L	1.00	07/30/2004 11:53	
Trichloroethene	11	0.50	ug/L	1.00	07/30/2004 11:53	
1,2-Dichloropropane	ND	0.50	ug/L	1.00	07/30/2004 11:53	
Bromodichloromethane	ND	0.50	ug/L	1.00	07/30/2004 11:53	
2-Chloroethylvinyl ether	ND	0.50	ug/L	1.00	07/30/2004 11:53	
trans-1,3-Dichloropropene	ND	0.50	ug/L	1.00	07/30/2004 11:53	
cis-1,3-Dichloropropene	ND	0.50	ug/L	1.00	07/30/2004 11:53	
1,1,2-Trichloroethane	ND	0.50	ug/L	1.00	07/30/2004 11:53	
Tetrachloroethene	3.7	0.50	ug/L	1.00	07/30/2004 11:53	
Dibromochloromethane	ND	0.50	ug/L	1.00	07/30/2004 11:53	
Chlorobenzene	ND	0.50	ug/L	1.00	07/30/2004 11:53	
Bromoform	ND	2.0	ug/L	1.00	07/30/2004 11:53	
1,1,2,2-Tetrachloroethane	ND	0.50	ug/L	1.00	07/30/2004 11:53	
1,3-Dichlorobenzene	ND	0.50	ug/L	1.00	07/30/2004 11:53	
1,4-Dichlorobenzene	ND	0.50	ug/L	1.00	07/30/2004 11:53	
1,2-Dichlorobenzene	ND	0.50	ug/L	1.00	07/30/2004 11:53	
Trichlorotrifluoroethane	ND	0.50	ug/L	1.00	07/30/2004 11:53	
Chloromethane	ND	1.0	ug/L	1.00	07/30/2004 11:53	

Severn Trent Laboratories, Inc.

STL San Francisco * 1220 Quarry Lane, Pleasanton, CA 94566

Tel 925 484 1919 Fax 925 484 1096 * www.stl-inc.com * CA DHS ELAP# 2496

07/30/2004 15:08

Halogenated Volatile Organic Compounds by 8021B/8260B

Allwest Environmental
Attn.: Michael Siembieda

530 Howard Street, Suite #300
San Francisco, CA 94105
Phone: (415) 391-2510 Fax: (415) 391-2008

Project: 24070.28
Paccar GW 04

Received: 07/23/2004 15:35

Prep(s): 5030B	Test(s): 8260B
Sample ID: MW-2	Lab ID: 2004-07-0729 - 2
Sampled: 07/23/2004	Extracted: 7/30/2004 11:53
Matrix: Water	QC Batch#: 2004/07/30-01.09

Compound	Conc.	RL	Unit	Dilution	Analyzed	Flag
Bromomethane	ND	1.0	ug/L	1.00	07/30/2004 11:53	
<i>Surrogate(s)</i>						
4-Bromofluorobenzene	83.8	79-118	%	1.00	07/30/2004 11:53	
1,2-Dichloroethane-d4	96.4	78-117	%	1.00	07/30/2004 11:53	
Toluene-d8	89.2	77-121	%	1.00	07/30/2004 11:53	

Halogenated Volatile Organic Compounds by 8021B/8260B

Allwest Environmental
Attn.: Michael Siembieda

530 Howard Street, Suite #300
San Francisco, CA 94105
Phone: (415) 391-2510 Fax: (415) 391-2008

Project: 24070.28
Paccar GW 04

Received: 07/23/2004 15:35

Prep(s): 5030B	Test(s): 8260B
Sample ID: MW-4	Lab ID: 2004-07-0729 - 4
Sampled: 07/23/2004	Extracted: 7/30/2004 12:22
Matrix: Water	QC Batch#: 2004/07/30-01.09

Compound	Conc.	RL	Unit	Dilution	Analyzed	Flag
Dichlorodifluoromethane	26	1.0	ug/L	1.00	07/30/2004 12:22	
Vinyl chloride	ND	0.50	ug/L	1.00	07/30/2004 12:22	
Chloroethane	ND	1.0	ug/L	1.00	07/30/2004 12:22	
Trichlorofluoromethane	ND	1.0	ug/L	1.00	07/30/2004 12:22	
1,1-Dichloroethene	ND	0.50	ug/L	1.00	07/30/2004 12:22	
Methylene chloride	ND	5.0	ug/L	1.00	07/30/2004 12:22	
trans-1,2-Dichloroethene	ND	0.50	ug/L	1.00	07/30/2004 12:22	
cis-1,2-Dichloroethene	1.0	0.50	ug/L	1.00	07/30/2004 12:22	
1,1-Dichloroethane	ND	0.50	ug/L	1.00	07/30/2004 12:22	
Chloroform	ND	0.50	ug/L	1.00	07/30/2004 12:22	
1,1,1-Trichloroethane	ND	0.50	ug/L	1.00	07/30/2004 12:22	
Carbon tetrachloride	0.50	0.50	ug/L	1.00	07/30/2004 12:22	
1,2-Dichloroethane	ND	0.50	ug/L	1.00	07/30/2004 12:22	
Trichloroethene	3.7	0.50	ug/L	1.00	07/30/2004 12:22	
1,2-Dichloropropane	ND	0.50	ug/L	1.00	07/30/2004 12:22	
Bromodichloromethane	ND	0.50	ug/L	1.00	07/30/2004 12:22	
2-Chloroethylvinyl ether	ND	0.50	ug/L	1.00	07/30/2004 12:22	
trans-1,3-Dichloropropene	ND	0.50	ug/L	1.00	07/30/2004 12:22	
cis-1,3-Dichloropropene	ND	0.50	ug/L	1.00	07/30/2004 12:22	
1,1,2-Trichloroethane	ND	0.50	ug/L	1.00	07/30/2004 12:22	
Tetrachloroethene	23	0.50	ug/L	1.00	07/30/2004 12:22	
Dibromochloromethane	ND	0.50	ug/L	1.00	07/30/2004 12:22	
Chlorobenzene	ND	0.50	ug/L	1.00	07/30/2004 12:22	
Bromoform	ND	2.0	ug/L	1.00	07/30/2004 12:22	
1,1,2,2-Tetrachloroethane	ND	0.50	ug/L	1.00	07/30/2004 12:22	
1,3-Dichlorobenzene	ND	0.50	ug/L	1.00	07/30/2004 12:22	
1,4-Dichlorobenzene	ND	0.50	ug/L	1.00	07/30/2004 12:22	
1,2-Dichlorobenzene	ND	0.50	ug/L	1.00	07/30/2004 12:22	
Trichlorotrifluoroethane	ND	0.50	ug/L	1.00	07/30/2004 12:22	
Chloromethane	ND	1.0	ug/L	1.00	07/30/2004 12:22	

Severn Trent Laboratories, Inc.

STL San Francisco * 1220 Quarry Lane, Pleasanton, CA 94566

Tel 925 484 1919 Fax 925 484 1096 * www.stl-inc.com * CA DHS ELAP# 2496

07/30/2004 15:08

Halogenated Volatile Organic Compounds by 8021B/8260B

Allwest Environmental
Attn.: Michael Siembieda

530 Howard Street, Suite #300
San Francisco, CA 94105
Phone: (415) 391-2510 Fax: (415) 391-2008

Project: 24070.28
Paccar GW 04

Received: 07/23/2004 15:35

Prep(s): 5030B	Test(s): 8260B
Sample ID: MW-4	Lab ID: 2004-07-0729 - 4
Sampled: 07/23/2004	Extracted: 7/30/2004 12:22
Matrix: Water	QC Batch#: 2004/07/30-01.09

Compound	Conc.	RL	Unit	Dilution	Analyzed	Flag
Bromomethane	ND	1.0	ug/L	1.00	07/30/2004 12:22	
<i>Surrogate(s)</i>						
4-Bromofluorobenzene	78.4	79-118	%	1.00	07/30/2004 12:22	sl
1,2-Dichloroethane-d4	92.8	78-117	%	1.00	07/30/2004 12:22	
Toluene-d8	89.2	77-121	%	1.00	07/30/2004 12:22	

Halogenated Volatile Organic Compounds by 8021B/8260B

Allwest Environmental
Attn.: Michael Siembieda

530 Howard Street, Suite #300
San Francisco, CA 94105
Phone: (415) 391-2510 Fax: (415) 391-2008

Project: 24070.28
Paccar GW 04

Received: 07/23/2004 15:35

Batch QC Report

Prep(s): 5030B
Method Blank
MB: 2004/07/29-1A.09-004

Water

Test(s): 8260B
QC Batch # 2004/07/29-1A.09
Date Extracted: 07/29/2004 09:48

Compound	Conc.	RL	Unit	Analyzed	Flag
Bromodichloromethane	ND	0.5	ug/L	07/29/2004 09:48	
Bromoform	ND	2.0	ug/L	07/29/2004 09:48	
Bromomethane	ND	1.0	ug/L	07/29/2004 09:48	
Carbon tetrachloride	ND	0.5	ug/L	07/29/2004 09:48	
Chlorobenzene	ND	0.5	ug/L	07/29/2004 09:48	
Chloroethane	ND	1.0	ug/L	07/29/2004 09:48	
2-Chloroethylvinyl ether	ND	0.5	ug/L	07/29/2004 09:48	
Chloroform	ND	0.5	ug/L	07/29/2004 09:48	
Chloromethane	ND	1.0	ug/L	07/29/2004 09:48	
Dibromochloromethane	ND	0.5	ug/L	07/29/2004 09:48	
1,2-Dichlorobenzene	ND	0.5	ug/L	07/29/2004 09:48	
1,3-Dichlorobenzene	ND	0.5	ug/L	07/29/2004 09:48	
1,4-Dichlorobenzene	ND	0.5	ug/L	07/29/2004 09:48	
Dichlorodifluoromethane	ND	1.0	ug/L	07/29/2004 09:48	
1,1-Dichloroethane	ND	0.5	ug/L	07/29/2004 09:48	
1,2-Dichloroethane	ND	0.5	ug/L	07/29/2004 09:48	
1,1-Dichloroethene	ND	0.5	ug/L	07/29/2004 09:48	
cis-1,2-Dichloroethene	ND	0.5	ug/L	07/29/2004 09:48	
trans-1,2-Dichloroethene	ND	0.5	ug/L	07/29/2004 09:48	
1,2-Dichloropropane	ND	0.5	ug/L	07/29/2004 09:48	
cis-1,3-Dichloropropene	ND	0.5	ug/L	07/29/2004 09:48	
trans-1,3-Dichloropropene	ND	0.5	ug/L	07/29/2004 09:48	
Methylene chloride	ND	5.0	ug/L	07/29/2004 09:48	
1,1,2,2-Tetrachloroethane	ND	0.5	ug/L	07/29/2004 09:48	
Tetrachloroethene	ND	0.5	ug/L	07/29/2004 09:48	
1,1,1-Trichloroethane	ND	0.5	ug/L	07/29/2004 09:48	
1,1,2-Trichloroethane	ND	0.5	ug/L	07/29/2004 09:48	
Trichloroethene	ND	0.5	ug/L	07/29/2004 09:48	
Trichlorofluoromethane	ND	1.0	ug/L	07/29/2004 09:48	
Trichlorotrifluoroethane	ND	0.5	ug/L	07/29/2004 09:48	

Severn Trent Laboratories, Inc.

STL San Francisco * 1220 Quarry Lane, Pleasanton, CA 94566

Tel 925 484 1919 Fax 925 484 1096 * www.stl-inc.com * CA DHS ELAP# 2496

07/30/2004 15:08

Halogenated Volatile Organic Compounds by 8021B/8260B

Allwest Environmental
Attn.: Michael Siembieda

530 Howard Street, Suite #300
San Francisco, CA 94105
Phone: (415) 391-2510 Fax: (415) 391-2008

Project: 24070.28
Paccar GW 04

Received: 07/23/2004 15:35

Batch QC Report

Prep(s): 5030B
Method Blank

Water

Test(s): 8260B
QC Batch # 2004/07/29-1A.09

MB: 2004/07/29-1A.09-004

Date Extracted: 07/29/2004 09:48

Compound	Conc.	RL	Unit	Analyzed	Flag
Vinyl chloride	ND	0.5	ug/L	07/29/2004 09:48	
4-Bromofluorobenzene	89.1	79-118	%	07/29/2004 09:48	
1,2-Dichloroethane-d4	94.6	78-117	%	07/29/2004 09:48	
Toluene-d8	92.7	77-121	%	07/29/2004 09:48	

Severn Trent Laboratories, Inc.

STL San Francisco * 1220 Quarry Lane, Pleasanton, CA 94566

Tel 925 484 1919 Fax 925 484 1096 * www.stl-inc.com * CA DHS ELAP# 2496

07/30/2004 15:08

Halogenated Volatile Organic Compounds by 8021B/8260B

Allwest Environmental
Attn.: Michael Siembieda

530 Howard Street, Suite #300
San Francisco, CA 94105
Phone: (415) 391-2510 Fax: (415) 391-2008

Project: 24070.28
Paccar GW 04

Received: 07/23/2004 15:35

Batch QC Report

Prep(s): 5030B
Method Blank
MB: 2004/07/30-01.09-004

Water

Test(s): 8260B
QC Batch # 2004/07/30-01.09
Date Extracted: 07/30/2004 09:03

Compound	Conc.	RL	Unit	Analyzed	Flag
Dichlorodifluoromethane	ND	1.0	ug/L	07/30/2004 09:03	
Vinyl chloride	ND	0.5	ug/L	07/30/2004 09:03	
Chloroethane	ND	1.0	ug/L	07/30/2004 09:03	
Trichlorofluoromethane	ND	1.0	ug/L	07/30/2004 09:03	
1,1-Dichloroethene	ND	0.5	ug/L	07/30/2004 09:03	
Methylene chloride	ND	5.0	ug/L	07/30/2004 09:03	
trans-1,2-Dichloroethene	ND	0.5	ug/L	07/30/2004 09:03	
cis-1,2-Dichloroethene	ND	0.5	ug/L	07/30/2004 09:03	
1,1-Dichloroethane	ND	0.5	ug/L	07/30/2004 09:03	
Chloroform	ND	0.5	ug/L	07/30/2004 09:03	
1,1,1-Trichloroethane	ND	0.5	ug/L	07/30/2004 09:03	
Carbon tetrachloride	ND	0.5	ug/L	07/30/2004 09:03	
1,2-Dichloroethane	ND	0.5	ug/L	07/30/2004 09:03	
Trichloroethene	ND	0.5	ug/L	07/30/2004 09:03	
1,2-Dichloropropane	ND	0.5	ug/L	07/30/2004 09:03	
Bromodichloromethane	ND	0.5	ug/L	07/30/2004 09:03	
2-Chloroethylvinyl ether	ND	0.5	ug/L	07/30/2004 09:03	
trans-1,3-Dichloropropene	ND	0.5	ug/L	07/30/2004 09:03	
cis-1,3-Dichloropropene	ND	0.5	ug/L	07/30/2004 09:03	
1,1,2-Trichloroethane	ND	0.5	ug/L	07/30/2004 09:03	
Tetrachloroethene	ND	0.5	ug/L	07/30/2004 09:03	
Dibromochloromethane	ND	0.5	ug/L	07/30/2004 09:03	
Chlorobenzene	ND	0.5	ug/L	07/30/2004 09:03	
Bromoform	ND	2.0	ug/L	07/30/2004 09:03	
1,1,2,2-Tetrachloroethane	ND	0.5	ug/L	07/30/2004 09:03	
1,3-Dichlorobenzene	ND	0.5	ug/L	07/30/2004 09:03	
1,4-Dichlorobenzene	ND	0.5	ug/L	07/30/2004 09:03	
1,2-Dichlorobenzene	ND	0.5	ug/L	07/30/2004 09:03	
Trichlorotrifluoroethane	ND	0.5	ug/L	07/30/2004 09:03	
Chloromethane	ND	1.0	ug/L	07/30/2004 09:03	
Bromomethane	ND	1.0	ug/L	07/30/2004 09:03	

Severn Trent Laboratories, Inc.

STL San Francisco * 1220 Quarry Lane, Pleasanton, CA 94566

Tel 925 484 1919 Fax 925 484 1096 * www.stl-inc.com * CA DHS ELAP# 2496

07/30/2004 15:08

Halogenated Volatile Organic Compounds by 8021B/8260B

Allwest Environmental
Attn.: Michael Siembieda

530 Howard Street, Suite #300
San Francisco, CA 94105
Phone: (415) 391-2510 Fax: (415) 391-2008

Project: 24070.28
Paccar GW 04

Received: 07/23/2004 15:35

Batch QC Report

Prep(s): 5030B
Method Blank
MB: 2004/07/30-01.09-004

Water

Test(s): 8260B
QC Batch # 2004/07/30-01.09
Date Extracted: 07/30/2004 09:03

Compound	Conc.	RL	Unit	Analyzed	Flag
Surrogates(s)					
4-Bromofluorobenzene	80.7	79-118	%	07/30/2004 09:03	
1,2-Dichloroethane-d4	94.9	78-117	%	07/30/2004 09:03	
Toluene-d8	89.7	77-121	%	07/30/2004 09:03	

Halogenated Volatile Organic Compounds by 8021B/8260B

Allwest Environmental
Attn.: Michael Siembieda

530 Howard Street, Suite #300
San Francisco, CA 94105
Phone: (415) 391-2510 Fax: (415) 391-2008

Project: 24070.28
Paccar GW 04

Received: 07/23/2004 15:35

Batch QC Report

Prep(s): 5030B

Test(s): 8260B

Laboratory Control Spike

Water

QC Batch # 2004/07/29-1A.09

LCS 2004/07/29-1A.09-002

Extracted: 07/29/2004

Analyzed: 07/29/2004 08:41

LCSD 2004/07/29-1A.09-003

Extracted: 07/29/2004

Analyzed: 07/29/2004 09:20

Compound	Conc. ug/L		Exp.Conc.	Recovery %		RPD	Ctrl.Limits %		Flags	
	LCS	LCSD		LCS	LCSD		%	Rec.	RPD	LCS
Chlorobenzene	20.1	19.7	20	100.5	98.5	2.0	61-121	20		
1,1-Dichloroethene	19.5	17.5	20	97.5	87.5	10.8	65-125	20		
Trichloroethene	18.2	19.0	20	91.0	95.0	4.3	74-134	20		
Surrogates(s)										
4-Bromofluorobenzene	405	416	500	81.0	83.2		79-118			
1,2-Dichloroethane-d4	441	461	500	88.2	92.2		78-117			
Toluene-d8	452	444	500	90.4	88.8		77-121			

Severn Trent Laboratories, Inc.

STL San Francisco * 1220 Quarry Lane, Pleasanton, CA 94566

Tel 925 484 1919 Fax 925 484 1096 * www.stl-inc.com * CA DHS ELAP# 2496

07/30/2004 15:08

Halogenated Volatile Organic Compounds by 8021B/8260B

Allwest Environmental
Attn.: Michael Siembieda

530 Howard Street, Suite #300
San Francisco, CA 94105
Phone: (415) 391-2510 Fax: (415) 391-2008

Project: 24070.28
Paccar GW 04

Received: 07/23/2004 15:35

Batch QC Report

Prep(s): 5030B

Test(s): 8260B

Laboratory Control Spike

Water

QC Batch # 2004/07/30-01.09

LCS 2004/07/30-01.09-002

Extracted: 07/30/2004

Analyzed: 07/30/2004 07:55

LCSD 2004/07/30-01.09-003

Extracted: 07/30/2004

Analyzed: 07/30/2004 08:34

Compound	Conc. ug/L		Exp. Conc.	Recovery %		RPD	Ctrl. Limits %		Flags	
	LCS	LCSD		LCS	LCSD		%	Rec.	RPD	LCS
1,1-Dichloroethene	20.7	19.6	20.0	103.5	98.0	5.5	65-125	20		
Trichloroethene	20.8	21.1	20.0	104.0	105.5	1.4	74-134	20		
Chlorobenzene	20.1	20.9	20.0	100.5	104.5	3.9	61-121	20		
Surrogates(s)										
4-Bromofluorobenzene	420	449	500	84.0	89.8		79-118			
1,2-Dichloroethane-d4	463	479	500	92.6	95.8		78-117			
Toluene-d8	472	450	500	94.4	90.0		77-121			

Severn Trent Laboratories, Inc.

STL San Francisco * 1220 Quarry Lane, Pleasanton, CA 94566

Tel 925 484 1919 Fax 925 484 1096 * www.stl-inc.com * CA DHS ELAP# 2496

07/30/2004 15:08

Halogenated Volatile Organic Compounds by 8021B/8260B

Allwest Environmental
Attn.: Michael Siembieda

530 Howard Street, Suite #300
San Francisco, CA 94105
Phone: (415) 391-2510 Fax: (415) 391-2008

Project: 24070.28
Paccar GW 04

Received: 07/23/2004 15:35

Legend and Notes

Analysis Flag

o

Reporting limits were raised due to high level of analyte present in the sample.

Result Flag

sl

Surrogate recoveries were lower than QC limit due to matrix interference,
confirmed by reanalysis.

2004-07-0729

Report To Analysis Request

Attn: MIKE SIEMBIEDA
Company: ALL WEST ENVIRONMENTAL
Address: 530 HOWARD ST., STE. 300, SF, CA
Phone: 415 391 2510 Email: michael@allwest1.com
Bill To: AllWest Sampled By: J. KONIUTO
Attn: M. SIEMBIEDA Phone: 415 391 2510

- TPH EPA - 8015/8021 8260B Gas w/ BTEX MTBE
- Purgeable Aromatics
BTEX EPA - 8021 8260B
- TEPH EPA 8015M Silica Gel Diesel Motor Oil Other _____
- Fuel Tests EPA 8260B: Gas BTEX Five Oxygenates DCA, ED8 Ethanol
- Purgeable Halocarbons
(H/VOCs) EPA ~~8021~~ 8260
- Volatile Organics GC/MS (VOCs)
 EPA 8260B 624
- Semivolatiles GC/MS
 EPA 8270 625
- Oil and Grease Petroleum (EPA 1664) Total
- Pesticides EPA 8081 808 PCBs EPA 8082 808
- PNAs by 8270 8310
- CAM17 Metals (EPA 6010/7470/7471)
- Metals: Lead LUFT RCRA Other: _____
- W.E.T (STLC) TCLP
- Hexavalent Chromium pH (24h hold time for H₂O)
- Spec Cond. Alkalinity TSS TDS
- Anions: Cl SO₄ NO₃ F Br NO₂ PO₄

Sample ID	Date	Time	Mat rix	Pres erv.	TPH EPA	Purgeable Aromatics	TEPH EPA	Fuel Tests	Purgeable Halocarbons	Volatile Organics	Semivolatiles	Oil and Grease	Pesticides	PNAs	CAM17 Metals	Metals	W.E.T	Hexavalent Chromium	Spec Cond.	Anions	Number of Containers	
MW-1	7/23/04		L	HCl					X													3
MW-2	↓		↓	↓					X													3
MW-3A	↓		↓	↓					X													3
MW-4	↓		↓	↓					X													3
																						12

Project Info.		Sample Receipt	
Project Name: <u>PACCAR GW04</u>	# of Containers: <u>12</u>	Head Space: <u>NONE</u>	Temp: <u>4°C</u>
Project#: <u>24070.28</u>	Conforms to record:		
PO#: <u>24070.28</u>			
Credit Card#:			

1) Relinquished by:
Perdeep Bhui 7/23/04 3:35 PM
Signature _____ Time _____
Printed Name _____ Date _____
Company _____

2) Relinquished by:
Signature _____ Time _____
Printed Name _____ Date _____
Company _____

3) Relinquished by:
Signature _____ Time _____
Printed Name _____ Date _____
Company _____

T 5 Day
A 72h 48h 24h Other: _____
T

Report: Routine Level 3 Level 4 EDD State Tank Fund EDF Global ID _____
Special Instructions / Comments:

1) Received by:
M. Villanueva 7/23/04 1535
Signature _____ Time _____
Printed Name _____ Date _____
Company STL SF

2) Received by:
Signature _____ Time _____
Printed Name _____ Date _____
Company _____

3) Received by:
Signature _____ Time _____
Printed Name _____ Date _____
Company _____

STL San Francisco

Sample Receipt Checklist

Submission #: 2004- 07 - 0729

Checklist completed by: (initials) DSH Date: 07,24/04

Courier name: STL San Francisco Client _____

Custody seals intact on shipping container/samples

Yes ___ No ___ Not Present

Chain of custody present?

Yes No ___

Chain of custody signed when relinquished and received?

Yes No ___

Chain of custody agrees with sample labels?

Yes No ___

Samples in proper container/bottle?

Yes No ___

Sample containers intact?

Yes No ___

Sufficient sample volume for indicated test?

Yes No ___

All samples received within holding time?

Yes No ___

Container/Temp Blank temperature in compliance ($4^{\circ}C \pm 2$)?

Temp: 6°C Yes No ___

Water - VOA vials have zero headspace?

Ice Present Yes ___ No

No VOA vials submitted ___ Yes No ___

(if bubble is present, refer to approximate bubble size and itemize in comments as S (small ~O), M (medium ~ O) or L (large ~ O))

Water - pH acceptable upon receipt? Yes No

pH adjusted- Preservative used: HNO₃ HCl H₂SO₄ NaOH ZnOAc -Lot #(s) _____

For any item check-listed "No", provided detail of discrepancy in comment section below:

Comments: _____

Project Management [Routing for instruction of indicated discrepancy(ies)]

Project Manager: (initials) _____ Date: ____/____/04

Client contacted: Yes No

Summary of discussion: _____

Corrective Action (per PM/Client): _____

Appendix A

MW-1 Groundwater Samples

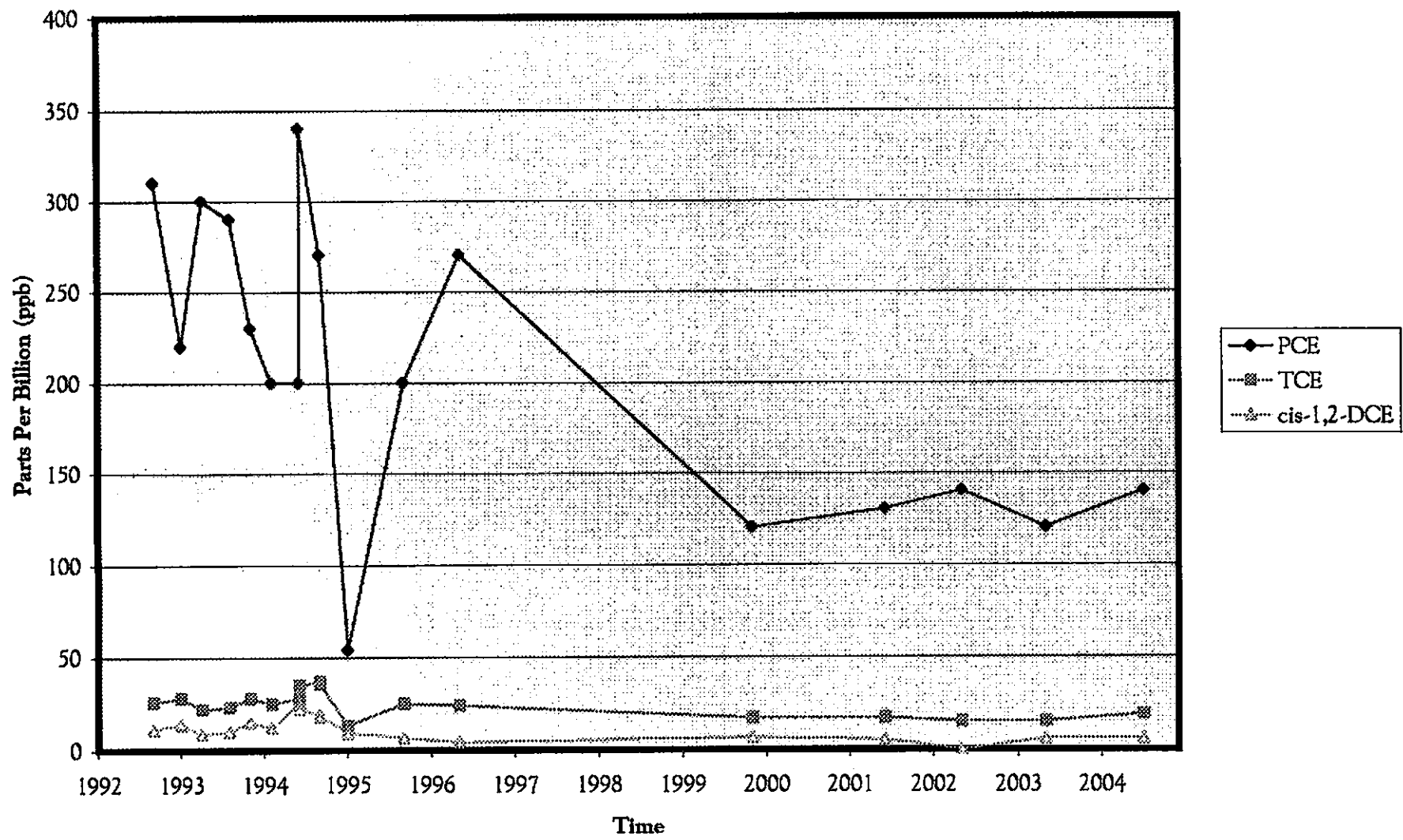

MW-2 Groundwater Samples

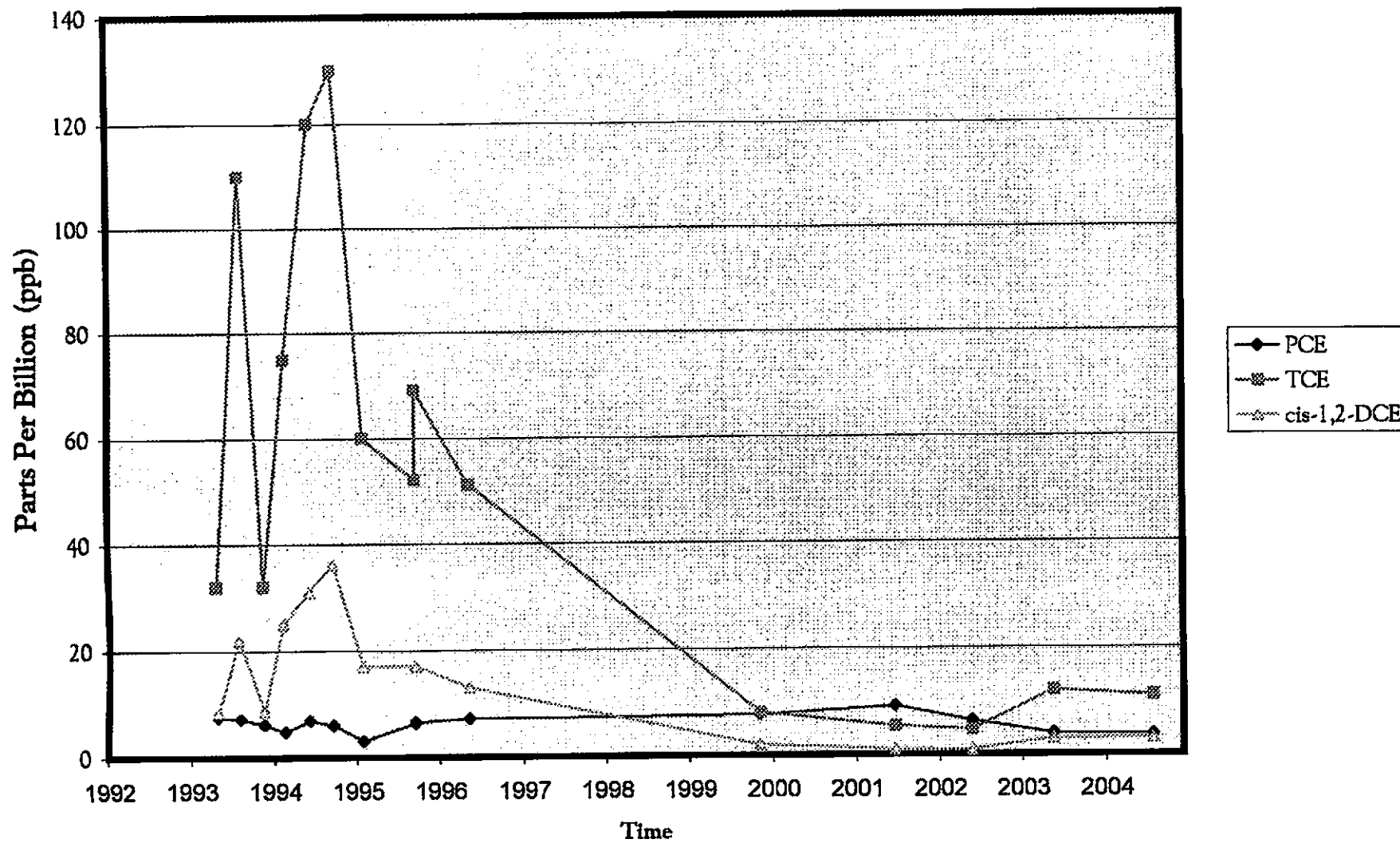

MW-3A Groundwater Samples

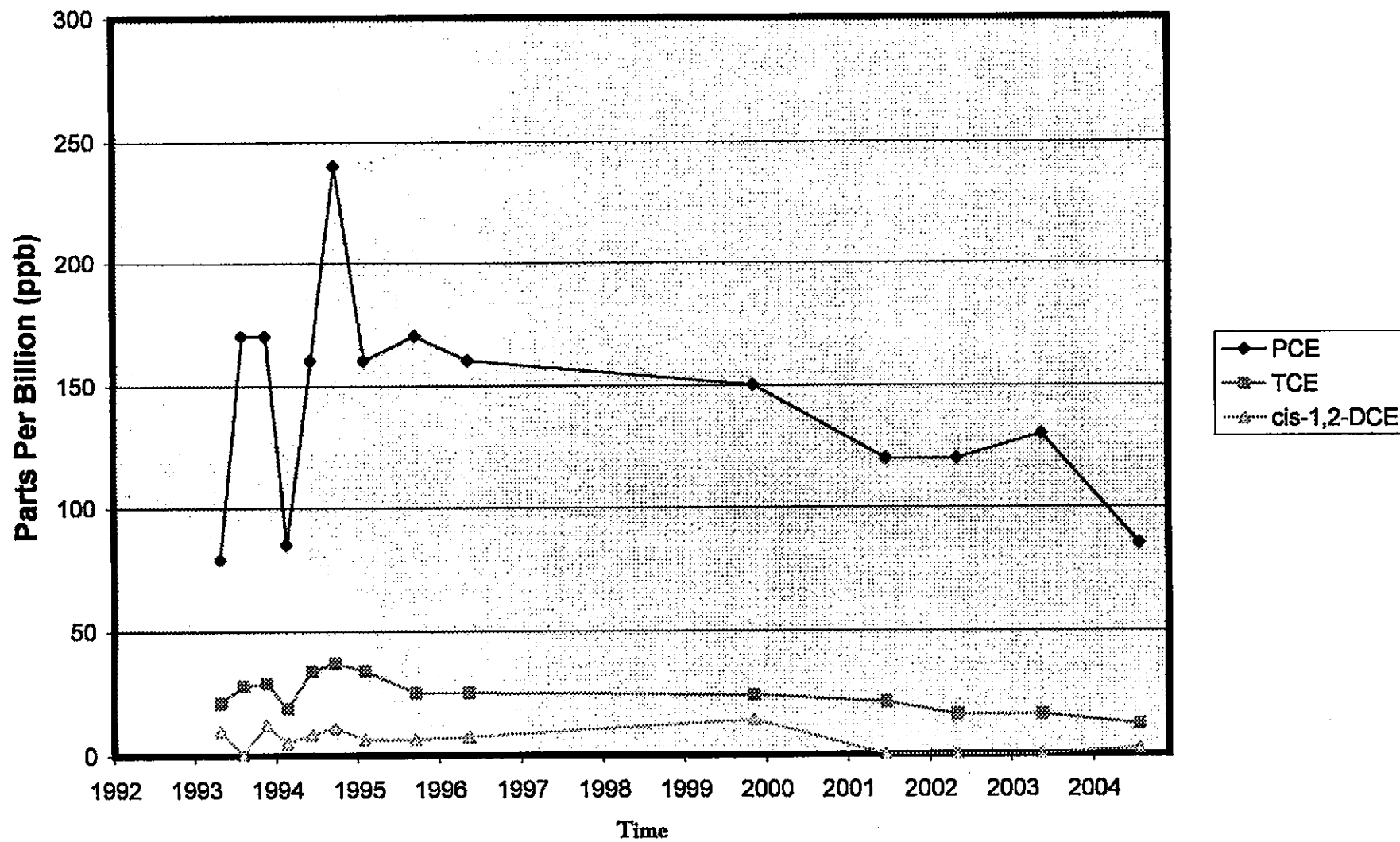

MW-4 Groundwater Samples

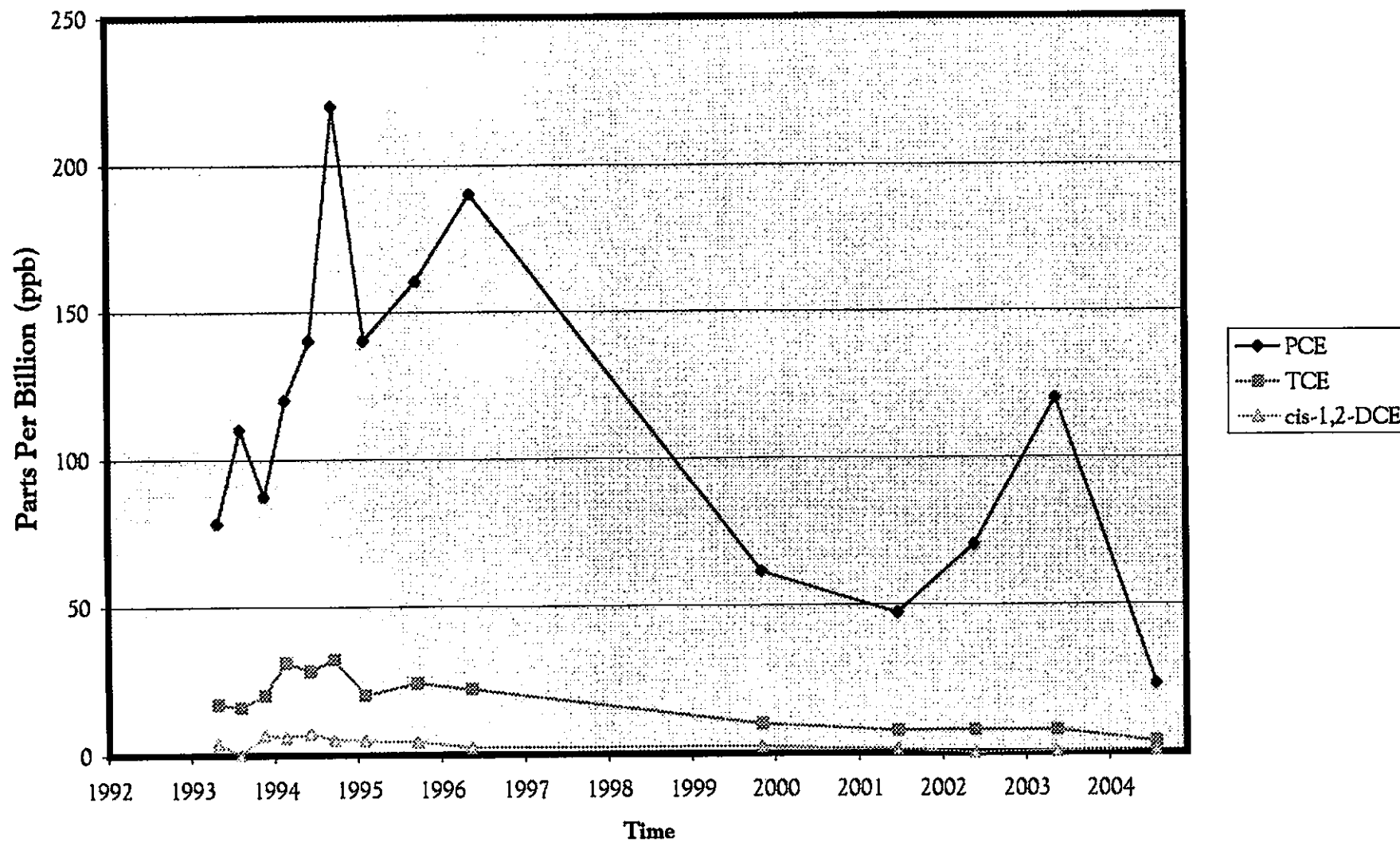

HC-1 Groundwater Samples

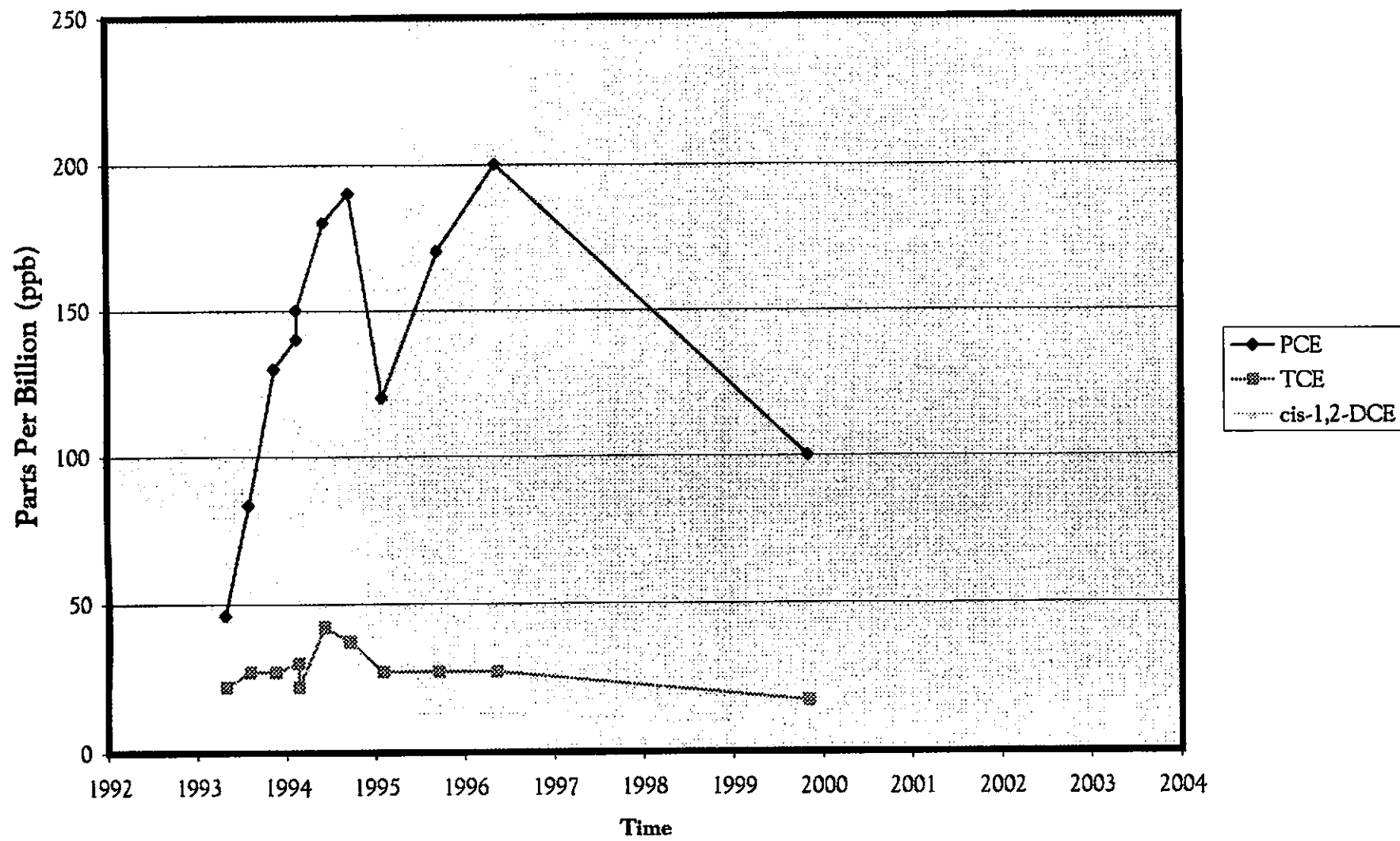

Appendix B

Groundwater Monitoring Well Sampling Field Log

Proj. No.: 24070.28

Project Name: Paccar GW '04

Well No.: MW-1

Well Location: 4240 International Blvd
Oakland, CA

Well Depth: 43.00 (ft.)

Casing Diameter: 4 (in.)

Depth to Water: 24.76 (ft.)

Date: 7/23/04 Time: 0910

Water Column in Well: 18.24 (ft.) ~~x 6.53~~ = Well Volume: 11.91 (gal.) x 3 = 35.73

Odor? No

Free Product? No

Thickness: NA

Purging Method: Hand Pump

Submersible Pump

Bailer

Other

Time	pH	Conduc. (µS)	Temp. (°F)	ORP (mV)	Volume Removed	Remark
1110	5.83	6.22	67.7	—	1.0	clear
1117	5.82	7.69	68.4	—	8.0	clear
1127	5.79	7.68	68.8	—	15.0	clear
1137	5.83	7.77	68.9	—	22.0	clear
1140	5.81	7.69	69.0	—	29.0	clear
1155	5.81	7.82	69.5	—	36.0	clear

1.1 gpm

1.0 gpm

Purging Start Time: 1109

Purging Stop Time: 1156

Total Volume Purged: 36.0 (gal.)

Well Dewater? No

Sampling Method: Teflon Bailer

Disposable Bailer

Sampling Pump

Sample Collected: HVOCs

Sample No.: MW-1

Remark: No odors.

Sampler: J. Koniuto

Date/Time: 7/23/04 @ 1200

Groundwater Monitoring Well Sampling Field Log

Proj. No.: 24070.28 Project Name: Paccar GW '04
 Well No.: MW-2 Well Location: 4240 International Blvd
Oakland, CA
 Well Depth: 45.00 (ft.) Casing Diameter: 4 (in.)
 Depth to Water: 24.62 (ft.) Date: 7/23/04 Time: 0900
 Water Column in Well: 20.40 (ft.) $\times 0.653$ Well Volume: 13.32 (gal.) $\times 3 = 40.0$
 Odor? N Free Product? N Thickness: NA
 Purging Method: Hand Pump Submersible Pump Bailer Other

Time	pH	Conduc. (μ S)	Temp. ($^{\circ}$ F)	ORP (mV)	Volume Removed	Remark
1005	6.41	6.37	68.7	—	1.0	clear
1013	6.13	6.70	68.7	—	8.0	clear
1020	6.03	7.72	68.4	—	16.0	clear
1030	5.78	7.62	68.3	—	24.0	clear
1040	5.86	7.84	68.5	—	32.0	clear
1050	5.20	8.70	68.2	—	40.0	clear

1.4 gpm
 1.2 gpm

Purging Start Time: 10:00 Purging Stop Time: 1051
 Total Volume Purged: 40.0 (gal.) Well Dewater? No
 Sampling Method: Teflon Bailer Disposable Bailer Sampling Pump
 Sample Collected: HVOCs Sample No.: MW-2
 Remark: no odor

Sampler: J. Koniuto Date/Time: 7/23/04 @ 1055

Groundwater Monitoring Well Sampling Field Log

Proj. No.: 24070.28 Project Name: Paccar GW '04
 Well No.: MW-3A Well Location: 4240 International Blvd
Oakland, CA
 Well Depth: 41.00 (ft.) Casing Diameter: 4 (in.)
 Depth to Water: 24.90 (ft.) Date: 7/23/04 Time: 0915
 Water Column in Well: 16.10 (ft.) $\times 653 =$ Well Volume: 1051 (gal.) $\times 3 = 31.53$
 Odor? No Free Product? No Thickness: NA
 Purging Method: Hand Pump Submersible Pump Bailer Other

Time	pH	Conduc. (μ S)	Temp. ($^{\circ}$ F)	ORP (mV)	Volume Removed	Remark
1210	5.87	5.80	71.9	-	1.0	clear
1220	5.79	5.69	72.3	-	8.0	clear
1230	5.66	5.71	71.2	-	15.0	lt cloudy
1237	5.82	5.80	72.0	-	23.0	"
1247	5.68	5.93	72.5	-	30.0	"

Purging Start Time: 1209 Purging Stop Time: 1255
 Total Volume Purged: 32.0 (gal.) Well Dewater? No
 Sampling Method: Teflon Bailer Disposable Bailer Sampling Pump
 Sample Collected: HVOCs Sample No.: MW-3A
 Remark: cloudy light brown

Sampler: J. Koniuto Date/Time: 7/23/04 @ 1300

Groundwater Monitoring Well Sampling Field Log

Proj. No.: 24070.28 Project Name: Paccar GW '04

Well No.: MW-4 Well Location: 4240 International Blvd
Oakland, CA

Well Depth: 45.00 (ft.) Casing Diameter: 4 (in.)

Depth to Water: 23.30 (ft.) Date: 7/23/04 Time: 0920

Water Column in Well: 21.70 (ft.) ~~x 653~~ Well Volume: 14.17 (gal.) x 3 = 42.51

Odor? No Free Product? No Thickness: NA

Purging Method: Hand Pump Submersible Pump Bailer Other

Time	pH	Conduc. (µS)	Temp. (°F)	ORP (mV)	Volume Removed	Remark
1309	5.72	8.27	75.1	-	1.0	clear
1319	5.76	8.09	74.2	-	9.0	cloudy
1329	5.74	8.59	74.0	-	17.0	cloudy
1339	4.1	8.07	71.4	-	25.0	H. cloudy
1349	4.2	8.46	74.7	-	33.0	H. cloudy
1359	5.0	8.16	75.2	-	41.0	H. cloudy

Purging Start Time: 1305 Purging Stop Time: 1400

Total Volume Purged: 42.50 (gal.) Well Dewater? No

Sampling Method: Teflon Bailer Disposable Bailer Sampling Pump

Sample Collected: HVOCs Sample No.: MW-4

Remark: No odors.

Sampler: J. Koniuto Date/Time: 7/23/04 @ 1405

Appendix C

GENERAL CONDITIONS TO THE WORK AUTHORIZATION

AGREEMENT

It is hereby agreed that the Client retains AllWest to act for and represent it in all matters set forth in the Work Authorization attached hereto (the "Work"). Such contract of retainer shall be subject to and is conditioned upon the following terms, conditions, and stipulations, which terms, conditions and stipulations will also apply to any further agreements, purchase orders, or documentation regarding the Work unless modified by a writing signed by both Parties to this Agreement. Signature by client on work authorization constitutes agreement with General Conditions as stated here.

It is recognized and agreed that AllWest has assumed responsibility only for making the investigations, reports and recommendations to the Client included within the Scope of Work. The responsibility for making any disclosures or reports to any third party and for the taking of corrective, remedial, or mitigative action shall be solely that of the Client.

REIMBURSABLE COSTS/INTEREST AND ATTORNEYS FEES

1. Reimbursable Costs will be charged to the Client in addition to the fees for the basic services under this Agreement and all Additional Services under the Agreement. Reimbursable Costs include, but are not limited to, expenses for travel, including transportation, meals, lodging, long distance telephone and other related expenses, as well as the costs of reproduction of all drawings for the Client's use, costs for specifications and type-written reports, permit and approval fees, automobile travel reimbursement, costs and fees of subcontractors, and soil and other materials testing. No overtime is accrued for time spent in travel. All costs incurred which relate to the services or materials provided by a contractor or subcontractor to AllWest shall be invoiced by AllWest on the basis of cost plus twenty percent (20%). Automobile travel reimbursement shall be at the rate of thirty-five cents (\$.35) per mile. All other reimbursable costs shall be invoiced and billed by AllWest at the rate of 1.1 times the direct cost to AllWest. Any rates set forth in this Agreement are subject to reasonable increases by AllWest upon giving thirty days' written notice to Client. Reimbursable costs will be charged to the client *only as outlined* in the attached proposal if the work is for Phase I Environmental Site Assessment. Client knowingly and willingly agrees to pay interest on the balance of on unpaid invoices overdue more than 30 days at a rate of 18% per annum and all attorney fees incurred by AllWest to secure payment of unpaid invoices. AllWest may waive such fees at its discretion.

WARRANTY AND LIMITATION OF LIABILITY

2. AllWest hereby warrants that it will perform the Work with the usual degree and standard of care and skill observed by members of AllWest's profession in the same geographic area on projects of the type engaged in by AllWest. **Client's sole remedy under this Agreement against AllWest or any of its employees or independent contractors shall be to request that AllWest repeat or correct any of the Work performed by AllWest which fails to meet these standards. The financial liability of AllWest, including its employees and independent contractors including attorney fees, shall not exceed the dollar value of this contract and shall be limited to direct damages.** All other damages such as loss of use, profits, anticipated profits and like losses are consequential damages for which neither AllWest nor its employees or independent contractors are liable. Client hereby releases AllWest from all liability and damage incurred by the Client or other person which are associated with the services provided by AllWest, or the employees, agents, contractors or subcontractors of AllWest, under this Agreement.

Further, Client hereby releases AllWest from any and all liability for risks or damages to the Project site. AllWest assumes no liability or duties regarding the Project site by reason of its performance of the Work at the Project. Client shall hold AllWest harmless from any liabilities or duties with respect to the work or the Project. Client shall further release, indemnify and hold AllWest harmless from any and all claims, liabilities or damages resulting from AllWest's use of technological or design concepts, or any other concepts or uses which, though acceptable and standard at the time the decision to use them was made, are unacceptable or non-standard beginning at the time work commences or any time thereafter. If AllWest must incur additional expenses in the work by reason or the need to incorporate new or different technologies into the Work, whether necessitated by new laws, regulations or guidelines, or by the desire of Client, Client agrees to reimburse AllWest for such expenses, as well as provide compensation for AllWest's services at the rates set forth in the Work Authorization.

Client acknowledges that AllWest and its sub-contractors have played no part in the creation of any hazardous waste, pollution sources, nuisance, or chemical or industrial disposal problem, which may exist, and that AllWest has been retained for the sole purpose of assisting the Client in assessing any problem which may exist and in assisting the Client in formulating a remedial program, if such is within the Scope of Work which AllWest has assumed. Client recognizes that while necessary for investigations, commonly used exploration methods, may penetrate through contaminated materials and serve as a connecting passageway between the contaminated material and an uncontaminated aquifer or groundwater, possibly inducing cross contamination. While back-filling with grout, or other means, according to a state of practice design, is intended to provide a seal against such passageway, it is recognized that such a seal may be imperfect and that there is an inherent risk in drilling borings of performing other exploration methods in a hazardous waste site.

AllWest shall not be required to sign any documents, no matter by whom requested, that would result in AllWest having to certify, guarantee, warrant or opine on conditions whose existence AllWest cannot ascertain. The CLIENT also agrees not to make resolution of any dispute with AllWest or payment of any amount due to AllWest in any way contingent upon AllWest signing any such documents.

TERMINATION

3. This Agreement may be terminated by either party upon seven (7) days' written notice should the other party substantially fail to perform in accordance with its terms through no fault of the party initiating the termination. In the event of termination which is not the fault of AllWest, AllWest shall be paid no less than eighty percent (80%) of the contract price, provided, however, that if AllWest shall have completed more than eighty percent of the Work at the time of said termination, AllWest shall be compensated as

provided in the Work Authorization for all services performed prior to the termination date which fall within the scope of work described in the Work Authorization and may as well, at its sole discretion and in accordance with said Schedule of Fees, charge Client its reasonable costs and labor in winding up its files and removing equipment and other materials from the Project.

AllWest may issue notice to other consultants, contractors, subcontractors and to governing agencies having jurisdiction over the Project and take such other actions as are reasonably necessary in order to give notice that AllWest is no longer associated with the Project and to protect AllWest from claims of liability from the work of others.

DOCUMENTS

4. Any documents prepared by AllWest, including but not limited to proposals, project specifications, drawings, calculations, plans and maps, and any ideas and designs incorporated therein, as well as any reproduction of the above are and shall remain the property of AllWest whether or not said documents are actually utilized in connection with the Project. The Client shall be permitted to retain a copy of any documents provided to the Client by AllWest, but said documents may not be used by the Client on other projects or for any other purpose, except the current one, except by agreement in writing with AllWest and with appropriate compensation to AllWest.

Client shall furnish, or cause to be furnished to AllWest, all documents and information known to Client that relate to the identity, location, quantity, nature, or characteristics of any asbestos, PCBs, or any other hazardous materials or waste at, on or under the site. In addition, Client will furnish or cause to be furnished such reports, data, studies, plans, specifications, documents and other information on surface or subsurface site conditions, e.g., underground tanks, pipelines and buried utilities, required by AllWest for proper performance of its services. If CLIENT fails to provide AllWest with all hazardous material subject matter reports including geotechnical assessments in their possession during the period that AllWest is actively providing expertise (30 days post the final invoice), CLIENT shall release AllWest from any and all liability for risks and damages the CLIENT incurs resulting from their reliance on AllWest's professional opinion. AllWest shall be entitled to rely upon Client - provided documents and information in performing the services required in this Agreement; however, AllWest assumes no responsibility or liability for their accuracy or completeness. Client-provided documents will remain the property of the Client.

ACCESS TO PROJECT

5. Client grants to AllWest the right of access and entry to the Project at all times necessary for AllWest to perform the Work. If Client is not the owner of the Project, then Client represents that Client has full authority to grant access and right of entry to AllWest for the purpose of AllWest's performance of the Work. This right of access and entry extends fully to any agents, employees, contractors or subcontractors of AllWest upon reasonable proof of association with AllWest.

CONFIDENTIAL INFORMATION

6. Both Client and AllWest understand that in conjunction with AllWest's performance of the Work on the project, both Client and AllWest's performance of the Work on the project, both Client and AllWest may receive or be exposed to Proprietary Information of the other. As used herein, the term "Proprietary Information" refers to any and all information of a confidential, proprietary or secret nature which may be either applicable to, or relate in any way to: (a) the personal, financial or other affairs of the business of each of the Parties, or (b) the research and development or investigations of each of the Parties. Proprietary Information includes, for example and without limitation, trade secrets, processes, formulas, data, know-how, improvements, inventions, techniques, software technical data, developments, research projects, plans for future development, marketing plans and strategies. Each of the Parties agrees that all Proprietary Information of the other party is and shall remain exclusively the property of that other party. The parties further acknowledge that the Proprietary Information of the other party is a special, valuable and unique asset of that party, and each of the Parties hereto agrees that at all times during the terms of this Agreement and thereafter to keep in confidence and trust all Proprietary Information of the other party, whether such Proprietary Information was obtained or developed by the other party before, during or after the term of this Agreement. Each of the Parties agrees not to sell, distribute, disclose or use in any other unauthorized manner the Proprietary Information of the other party. AllWest further agrees that it will not sell, distribute or disclose information or the results of any testing obtained by AllWest during the performance of the Work without the prior written approval of Client unless required to do so by federal, state or local statute, ordinance or regulation.

ADDITIONAL SERVICES

7. In addition to the services to be performed by AllWest as described in the Work Authorization, the following items shall for the purposes of this Agreement be termed "Additional Services": (a) work resulting from changes in scope or magnitude of the Work as described therein, (b) work resulting from changes necessary because of construction cost over-runs, (c) work resulting from implementation of alternative or different designs from that first contemplated by the Parties, (d) work resulting from corrections or revisions required because of errors or omissions in construction by the building contractors, (e) work due to extended design or construction time schedules, (f) layout surveys in review of in-place constructed elements, and (g) services as an expert witness in connection with any public hearing, arbitration or proceedings of a court of record with respect to the Work on the Project.

AllWest will be compensated by Client for any Additional Services as provided under the Work Authorization.

DISPOSAL OF CONTAMINATED MATERIAL

8. Client understands and agrees that AllWest is not, and has no responsibility as, a generator, operator, treater, storer, transporter or disposer of hazardous or toxic substances found or identified at the site, including investigation-derived waste. The Client shall undertake or arrange for handling, removal, treatment, storage, treatment of hazardous material shall be the sole responsibility of Client. AllWest's responsibilities shall be limited to recommendations regarding such matters and assistance with appropriate arrangements if authorized by Client.

INDEPENDENT CONTRACTOR

9. Both Client and AllWest agree that AllWest will act as an independent contractor in the performance of the Work under this Agreement. All persons or parties employed by AllWest in connection with the Work are the agents, employees or subcontractors

of AllWest and not of Client. Accordingly, AllWest shall be responsible for payment of all taxes arising out of AllWest's activities in performing the Work under this Agreement.

NOTICES

10. (a) All notices, demands or requests provided for or permitted to be given pursuant to this Agreement must be in writing and shall be deemed to have been duly given on the date of service if served personally on the party to whom notice is to be given, or if mailed by first class certified mail, return receipt requested, and properly addressed as follows:

To Client: _____
To AllWest: AllWest Environmental, Inc.
530 Howard Street, Suite 300
San Francisco, California 94105

when either (i) the return receipt is signed by the addressee, (ii) the mailing is refused by the addressee, or (iii) the mailing is not delivered because the addressee moved and left no forwarding address; b) By giving the other party to this Agreement ten (10) days' written notice thereof, the parties hereto and their respective successors and assigns shall have the right from time to time and at any time during the term of this Agreement to change their respective addresses and each shall have the right to specify as its address any other address within the United States of America.

ENTIRE AGREEMENT

11. This Agreement contains the entire agreement between the Parties pertaining to the subject matter contained in it and supersedes all prior and contemporaneous agreements, representations and understandings of the Parties. The terms of this Agreement are contractual and not a mere recital. The undersigned have carefully read and understand the contents of this Agreement and sign their names to the same as their own free act. This Agreement was entered into following negotiations between the Parties.

MODIFICATION / WAIVER / PARTIAL INVALIDITY

12. The terms of this Agreement may be modified only by a writing signed by both Parties. No consent or waiver, express or implied, by either party to or of any breach or default by another in the performance by the other of its obligations hereunder shall be deemed or construed to be a consent or waiver to or of any other breach or default in the performance by such other party of the same or any other obligations of such party hereunder. Failure on the part of either party to complain of any act or failure to act of the other, or to declare the other party in default, shall not constitute a waiver by such party of its rights hereunder. If any provision of this Agreement or the application thereof to any person or circumstances shall be invalid or unenforceable to any extent, the remainder of this Agreement and the application of such provisions to other persons or circumstances shall not be affected thereby and shall be enforced to the greatest extent permitted by law.

INUREMENT / TITLES / ATTORNEYS' FEES

13. Subject to any restrictions on transfers, assignments and encumbrances set forth herein, this Agreement shall inure to the benefit of and be binding upon the undersigned Parties and their respective heirs, executors, legal representatives, successors and assigns. Paragraph titles or captions contained in this Agreement are inserted only as a matter of convenience, and for reference only, and in no way limit, define or extend the provisions of any paragraph. If any legal action or any arbitration or other proceeding is brought for the enforcement of this Agreement, or because of an alleged dispute, breach, default or misrepresentation in connection with any of the provisions of this Agreement, the successful prevailing party shall be entitled to recover reasonable attorneys' fees and other costs incurred in that action or proceeding, in addition to any other relief to which it or they may be entitled. In addition, AllWest and Client shall be entitled to be reimbursed by the other for any attorneys' fees or other costs reasonably incurred in enforcing the terms of this Agreement in the event such fees are incurred without resorting to arbitration or litigation.

INTERPRETATION / ADDITIONAL DOCUMENTS

14. The words "Client" and "AllWest" as used herein shall include the plural as well as the singular. Words used in the neuter gender include the masculine and feminine. Words used in the masculine gender include the feminine and neuter. If there is more than one Client or Consultant, the obligations hereunder imposed on Client or AllWest or Consultant shall be joint and several. Although the printed provisions of this Agreement were drafted by the attorneys for AllWest, the terms of this Agreement were fully negotiated by the Parties and shall not be construed for or against the Client or AllWest but shall be interpreted in accordance with the general meaning of the language herein contained in an effort to reach the intended result. Each of the Parties hereto shall upon request execute and/or acknowledge and/or deliver to each other Party or to its representatives any and all further documents which may now or hereafter be necessary to enable any of the Parties to effectuate any of the provisions of this Agreement.

AUTHORITY

15. Each of the persons executing this Agreement on behalf of a corporation does hereby covenant and warrant that the corporation is duly authorized and existing under the laws of its respective state of incorporation, that the corporation has and is qualified to do business in its respective state of incorporation, that the corporation has the full right and authority to enter into this Agreement, that the Board of Directors if required pursuant to the bylaws or resolution of the corporation approved this Agreement, and that each person signing on behalf of the corporation is authorized to do so. If the Client is a joint venture or a general partnership, the signatories below warrant that said joint venture or general partnership is properly and duly organized and existing under the laws of the respective state of its formation and pursuant to the joint venture agreement or a partnership agreement as well as by virtue of the laws of the respective state of its formation, said signatory is a joint venturer or a general partner of said joint venture or general partnership and has the power and authority to bind the joint venture or the general partnership.

COUNTERPARTS / ABSENCE OF PARTNERSHIP OR JOINT VENTURE

16. This Agreement may be signed in counterparts by each of the Parties hereto and, taken together, the signed counterparts shall constitute a single document. It is expressly understood that the Client does not, in any way or for any purpose, become a

partner of AllWest in the conduct of its business, or otherwise, or joint venturer or a member of a joint enterprise with AllWest. It is expressly understood that AllWest do not, in any way or for any purpose, become a partner of the Client in the conduct of Client's business, or otherwise, or joint venturer or a member of a joint enterprise with Client.

THIRD PARTY BENEFICIARIES / CONTROLLING LAW

17. There are no intended third party beneficiaries of this Agreement. The services, data & opinions expressed by AllWest are for the sole use of the client, are for a particular project and may not be relied upon by anyone other than the client. This Agreement shall be controlled by the laws of the State of California and any action by either party to enforce this Agreement shall be brought in San Francisco County, California.

1/19/00
pc1/C:\Admin\Reports\2K4\24070.28\GeneralReliance.wpd

APPLICATION FOR AUTHORIZATION TO USE

REPORT TITLE: 2004 ANNUAL GROUNDWATER MONITORING REPORT
Grand Auto #43
4240 East 14th Street
Oakland, California

To: AllWest Environmental, Inc.
530 Howard Street, Suite 300
San Francisco, CA 94105

From (Applicant): _____
(Please clearly identify name and address of person/entity applying for permission to use or copy this document)

Ladies and Gentlemen:

Applicant hereby applies for permission to rely upon *AllWest's* work product, as described above, for the purpose of: (state here the purpose for which you wish to rely upon the work product)

Applicant only can accept and rely upon *AllWest* work product under the strict understanding that Applicant is bound by all provisions in the Terms and Conditions attached to the report. Every report, recommendation, finding, or conclusion issued by *AllWest* shall be subject to the limitations stated in the Agreement and subject report(s). If this is agreeable, please sign below and return one copy of this letter to us along with the applicable fees. Upon receipt and if acceptable, our signed letter will be returned. *AllWest* may withhold permission at its sole discretion or require additional re-use fees or terms.

FEES: A \$500 coordination and reliance fee, payable in advance, will apply. If desired, for an additional \$75 report reproduction fee, we will reissue the report in the name of the Applicant; the report date, however, will remain the same. All checks will be returned if your request for reliance is not approved.

REQUESTED BY

APPROVED BY

Applicant Company

AllWest Environmental, Inc.

Print name and Title

Print Name and Title

Signature and Date

Signature and Date