

California Environmental Management Service Co., Inc.

P.O. Box 390874 Mountain View, CA 94039-0874 650.966.1526 650.966.1146 fax

FAX

To: Ms. Madhulla Logan, Hazardous Materials Specialist Alameda County Health Department Fax 510.337.9335/Phone 510.567.6764

December 23, 1998

page 1 of 3

From: John Schultz, CEMS

Subject: Proposed Wipe Sampling Plan for Protron Technology Corporation facility at 5045 Brandin Court, Fremont, California

Dear Madhulla,

Could you please review this as soon as possible, so that I can schedule Sukla for the sampling as soon as possible. Please let me know if you would like any changes. Thank you very much.

Attached are two maps, one shows the results of the November 13, 1998 wipe sampling that Sukla De and I conducted, and the other is the proposed Wipe Sampling Locations for confirmation that an adequate cleanup has been provided at Brandin Court. As you will note, the November 13 sampling event showed that some additional cleanup was warranted in the location of sample SW8 (the test room), in the location of SW22 (for the surface areas above the conference room), and of the floor in the location of SW20 and SW21, if the cleanup was to meet the current HUD standard.

On inspection, it was determined that the top of all of the ductwork above the offices and exposed light fixtures in the drop ceiling, and other exposed surfaces needed additional cleaning. I determined that the fiberglass insulation covering the drop ceiling could not be cleaned and would need to be removed, and all of the hard, non-permeable surfaces (i.e. the tops of the light fixtures, the exhaust ductwork, and accessible conduit and plumbing, would need wiping down. This was done, and all of these structures above the drop ceiling over office areas were cleaned (except for the inaccessible fire sprinkler plumbing at the roof, as per our discussion) and this area is now ready for retesting.

I propose that we collect the following samples:

1. Two wall samples from inside of the office areas in 5045 Brandin Court.
2. Two floor samples from inside of the office areas in 5045 Brandin Court.
3. Two ductwork samples from above the office areas in 5045 Brandin Court.
4. Two ceiling light samples from above the office areas in 5045 Brandin Court.
5. Two blank samples for control.
6. Two floor samples from vicinity of SW20 and SW21 in 5035 Brandin Court.

*Air conditioners →
ceiling room exhaust fan - WS11 - WS9*

Lamp / ceiling → room exhaust - WS11 / WS9

Air condition - outside →

Fire sprinkler line (near soldier)

The sample locations will be selected and collected in the presence of Ms. Sukla De of the Fremont Fire Departments, utilizing the Appendix 13.1 Wipe Sampling Protocol for Settled Lead-contaminated Dust that she provided. Samples will be collected approximately 20 - 30 feet distances from each other so as to provide an adequate coverage of the areas of concern.

As I mentioned, in addition to wipe cleaning, we removed the fiberglass insulation since it cannot be cleaned. The insulation has been bagged and will be disposed of as hazardous waste by placing in a hazardous waste disposal bin and shipping to a permitted hazardous waste facility. The disposal will take place after all of the cleanup has been completed, and the sampling results confirm this.

Thank you for your assistance. Happy holidays!

John Schultz

cc: Ms. Sukla De, Fremont

Fax 510.494.4822/Phone 510.494.4236

To: Ms. Madhulla Logan, Haz. Mat. Specialist, ACHA

Fax 510.337.9335/Phone 510.567.6764

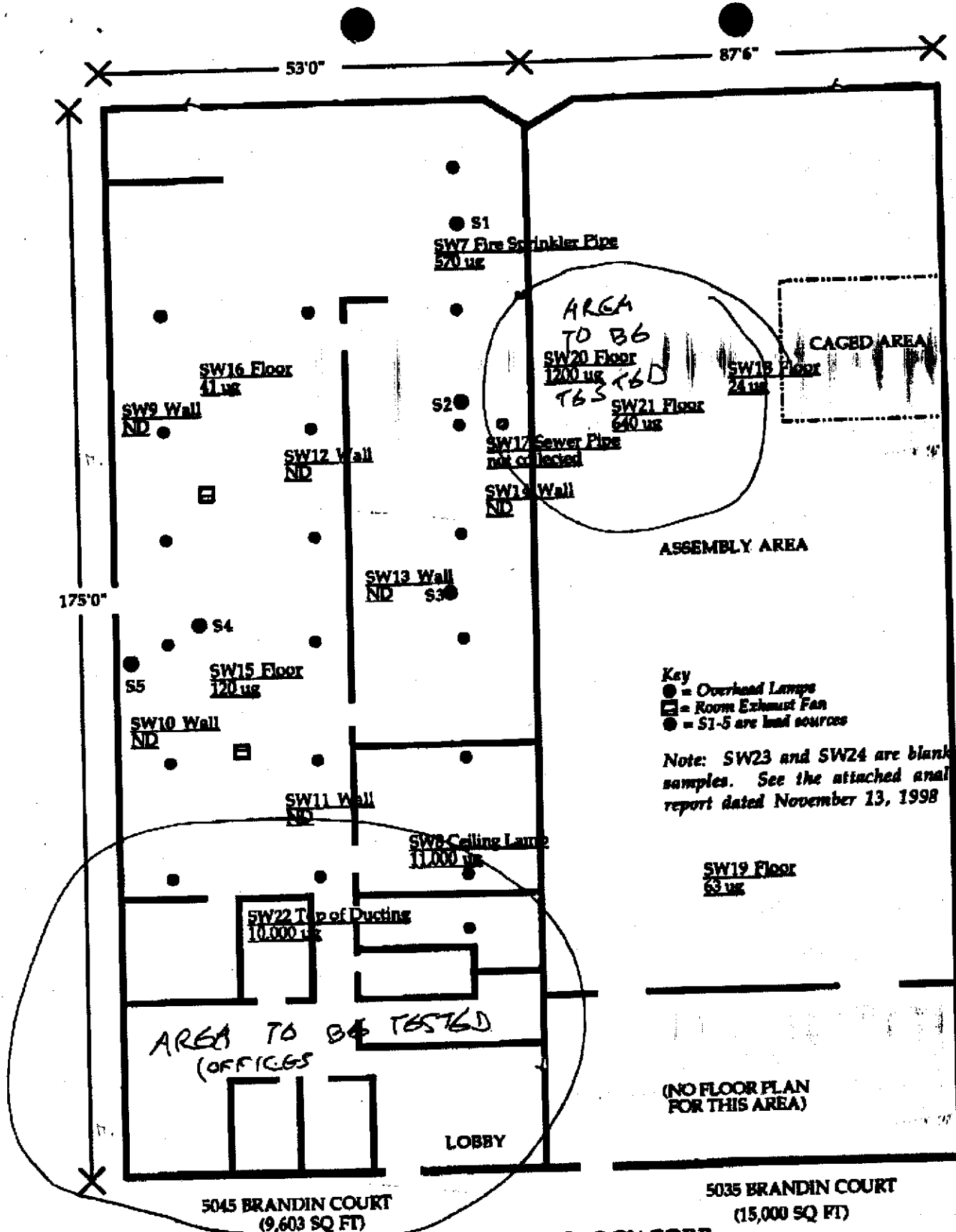

5045 BRANDIN COURT
(9,603 SQ FT)

5035 BRANDIN COURT
(15,000 SQ FT)

PROTON TECHNOLOGY CORP.
Sample Location Map
for 11-13-98
DRAWING NOT TO SCALE

PROPOSED
SAMPLING
AREAS

- Key
- = Overhead Lamps
 - = Room Exhaust Fan
 - = S1-S are lead sources

Note: SW23 and SW24 are blank samples. See the attached analytical report dated November 13, 1998

SW19 Floor
63 ug

(NO FLOOR PLAN
FOR THIS AREA)

S1
SW7 Fire Sprinkler Pipe
570 ug

AREA
TO BE
TESTED
SW20 Floor
1200 ug
TBS
SW21 Floor
640 ug
SW17 Sewer Pipe
not collected
SW18 Wall
ND

CAGED AREA

ASSEMBLY AREA

SW13 Wall
ND S3

SW16 Floor
41 ug

SW9 Wall
ND

SW12 Wall
ND

SW15 Floor
120 ug

SW10 Wall
ND

SW11 Wall
ND

SW8 Ceiling Lamp
11,000 ug

SW22 Top of Ducting
10,000 ug

AREA TO BE TESTED
(OFFICES)

LOBBY

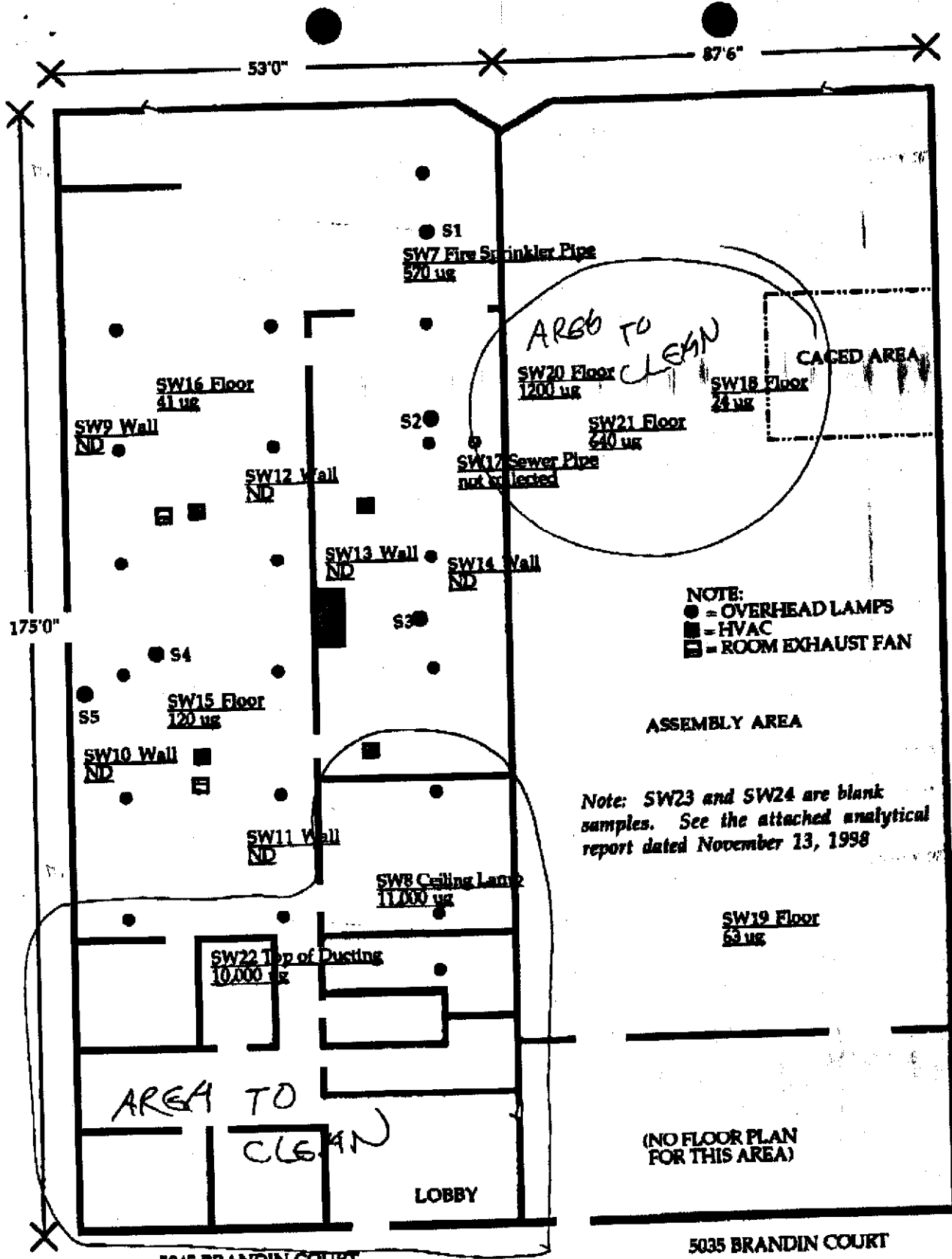

PROTON TECHNOLOGY CORP.

Sample Location Map
for 11-13-98

DRAWING NOT TO SCALE

W/AS HORIZONTAL SURFACES / REMOVAL OF FIBREGLOSS INSULATION