

GARRISON LAW CORPORATION
Attorneys and Counselors at Law

FILE #

01370010

P.O. Box 307
691 Myrtle Street
Half Moon Bay, CA 94019
Telephone 415/726-1111
Facsimile 415/726-1388

FACSIMILE MESSAGE

This facsimile message is intended only for the use of the individual or entity to which it is addressed, and may contain information that is privileged, confidential and exempt from disclosure by law. If the reader of this message is not the intended recipient, or the employee or agent responsible for delivering the message to the intended recipient, please notify Garrison Law Corporation immediately by collect telephone call to 415/726-1111. We will provide you with postage and instructions for returning the original message via the U. S. Postal Service to Garrison Law Corporation, 691 Myrtle Street, Half Moon Bay, CA 94019. Your cooperation is appreciated.

Please deliver this facsimile transmission to:

Recipient	Steve Muir
Company/Firm	WZI
Facsimile Number	805/326-0191
From	Jan Sutterfield
File/Matter	Schropp Farms
Date	April 11, 1995
Pages + Cover	1 + 7
Message	

For your information

For your request

For your review and comments

Hard copy to follow

Yes No

J
L

GARRISON LAW CORPORATION
ATTORNEYS AND COUNSELORS AT LAW

RECEIVED
Schropp

April 11, 1995

Via facsimile

Dick Jones
Agriculture Industries
P.O. Box 1076
West Sacramento, CA 95691
Fax 916/372-5615

Steve Muir
WZI
4700 Stockdale Highway, #120
Bakersfield, CA 93389
Fax 805/326-0191

Re: Shell's Draft Unauthorized Release Notification

Dear Mr. Jones and Mr. Muir:

In accordance with the agreement discussed in the March 23, 1995 conference call, Mr. Tintle of Shell Oil has provided our office with a draft copy of Shell's proposed notice to the Regional Water Quality Control Board of the unauthorized release of crude oil on the Schropp property in Byron, California.

Pursuant to the attached cover letter, Mr. Tintle has requested that any modifications to the draft unauthorized release notice be forwarded to his attention by 4:00 p.m. tomorrow, April 12.

Please review the enclosed draft notification and contact our office with any comments or suggestions at your earliest convenience. Thank you for your timely response.

Sincerely yours,

Jan Sutterfield
Legal Assistant

Shell Oil Products Company



P. O. Box 4848
511 N. Brookhurst Street
Anaheim, CA 92803

CERTIFIED MAIL
RETURN RECEIPT REQUESTED

April 6, 1995

Mr. G. S. Garrison
Attorney at Law
Garrison Law Corporation
691 Myrtle Street
Half Moon Bay, CA 94019

Dear Mr. Garrison:

ALAMEDA COUNTY, CALIFORNIA
VALLEY PIPELINES
R/W 2A-323 - SCHROPP RANCH
SOIL CONTAMINATION CLAIM

As agreed, enclosed for your information is a draft copy of Shell's proposed notice to the California Regional Water Quality Control Board advising them of the unauthorized crude oil release on Schropp Ranch property near Byron, California.

Unless we hear from you or your clients within 48 hours of your receipt of this material, the notice will be sent, as is, via U.S. Mail to the Agency.

Very truly yours,

G. F. Tittle
Senior Land Agent

GFT:
Enclosures

Shell Oil Products Company

DRAFTP.O. Box 4848
Anaheim, CA 92803-4848511 N. Brookhurst
Anaheim, CA 92801

April 5, 1995

CERTIFIED
RETURN RECEIPT REQUESTEDCalifornia Regional Water Quality Control Board
Central Valley Region
Attn: Mr. Ken Landau
3443 Routier Road
Sacramento, CA 95827-3098

Dear Mr. Ken Landau:

NOTIFICATION OF UNAUTHORIZED HYDROCARBON RELEASE
BYRON, CALIFORNIA

This letter serves to notify your agency of a recently detected unauthorized release of crude oil along an approximately 80-foot section of Shell Oil Company's (Shell) former crude oil pipeline transecting the Schropp Ranch property in Byron, California (Plate 1). PICES Associates (PICES) is currently performing a site investigation for Shell to determine the extent of soil and/or groundwater contamination due to this past release.

To date, 11 soil samples have been collected via trenching (grab sampling) or from a van mounted soil sampler (soil probe) and analyzed in a state-certified laboratory for TRPH (EPA Method 418.1), BTEX (EPA Method 8020), TPH-Gasoline (EPA Method 8015 modified for gasoline), and TPH-Diesel (EPA Method 8015 modified for diesel). A listing of the chemical results is presented in Table 1.

The results of soil sampling and chemical analysis has revealed a very localized area of hydrocarbon contamination along an approximately 80-foot section of Shell's former pipeline right-of-way (Plate 2) that extends from approximately four feet below surface grade (bgs) to groundwater (with evidence of free product). The northern, eastern, and southern extensions of contaminated soil have been defined within the immediate area of the pipeline corridor, however, the western extension of contaminated soil is currently undetermined due to accessibility considerations to the Mountain House School property. Once access requirements have been met, the western extent will be assessed in an additional round of soil samplings.

Mr. Ken Landau
April 5, 1995
Page 2

Shell is evaluating various remediation options to address this area of confirmed soil contamination and is in the process of preparing a workplan for proposed remedial actions to submit to the Board in the near future.

Please address any inquiries regarding this notification to either myself at (714) 520-3374 or to either Mr. Aklile Gessesse or Mr. George Cusimano of PICES Associates at (714) 573-4014.

Sincerely,

C. R. Jordan
Environmental & Technical-West
On Behave of Shell Oil Company

Enclosures Table 1: Results of Soil Chemical Analysis
Plate 1: Vicinity Map
Plate 2: Site Map

cc: Greg Garrison, Garrison Law Corporation
Aklile Gessesse, PICES Associates

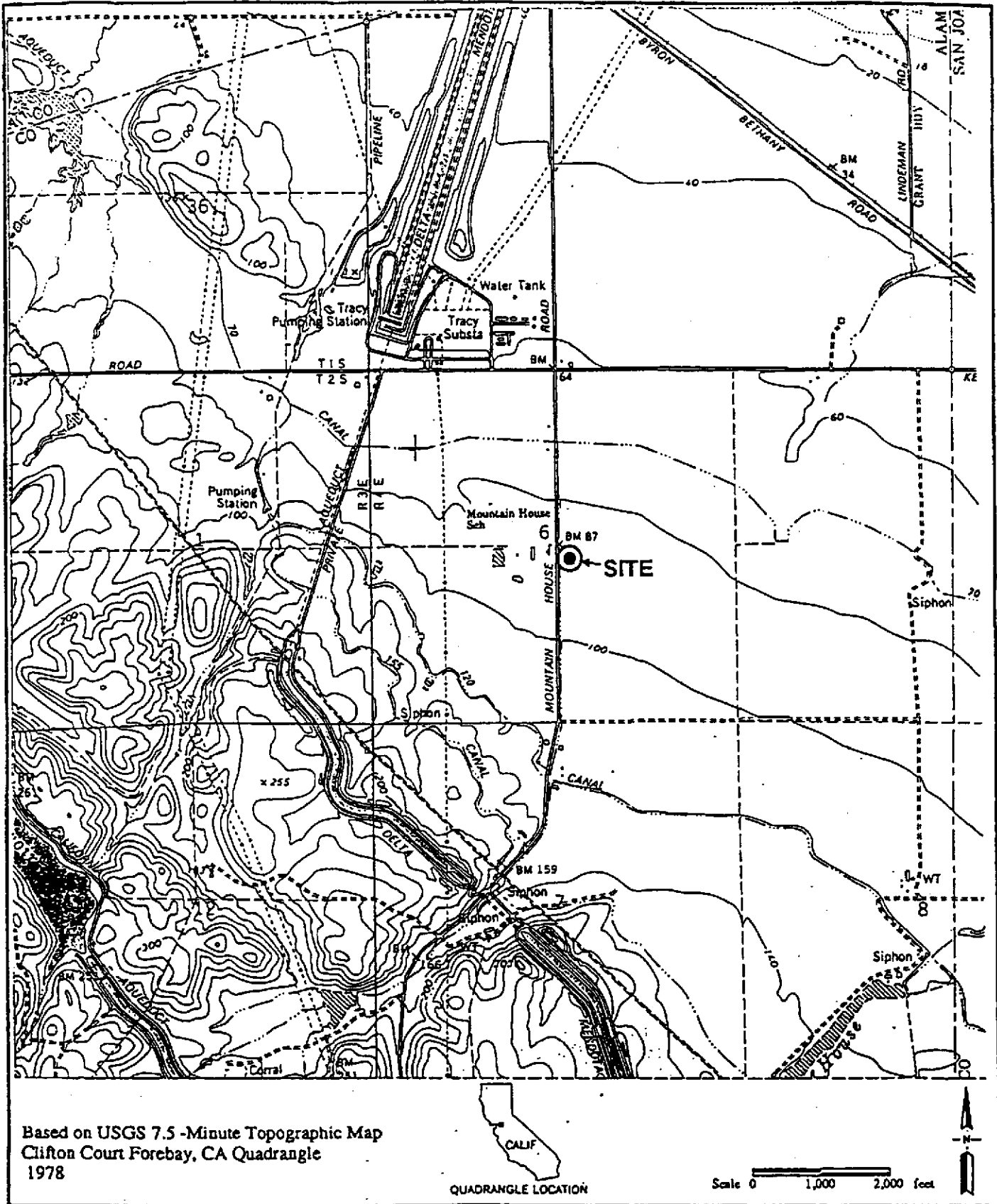

Based on USGS 7.5 -Minute Topographic Map
 Clifton Court Forebay, CA Quadrangle
 1978

QUADRANGLE LOCATION

Scale 0 1,000 2,000 feet



PROFESSIONAL INTEGRATED CONSULTING
 & ENVIRONMENTAL SERVICES
 "A Pledge to Quality"

VICINITY MAP
 Schropp Ranch
 Byron, California

PLATE
 1

DRAWN
 CME

PROJECT NUMBER
 405-005

APPROVED

DATE
 3/95

REVISED

DATE



PROFESSIONAL INTEGRATED CONSULTING
& ENVIRONMENTAL SERVICES

"A Pledge to Quality"

TABLE 1: RESULTS OF SOIL CHEMICAL ANALYSIS

Schropp Ranch
Mountain House Road
Byron, CA
Project Number: 405-005

Sample No.	Date of Collection	Depth (ft. bgs)*	Benzene	EPA Method 8020			EPA Methods†		418.1 TRPH
				Toluene	Ethybenzene	Total Xylenes	8015 Mod-G TPH-G	8015 Mod-D TPH-D	
GB-1	Oct 11	7	ND	ND	0.030	ND	ND	4781	842
GB-2	Oct 11	8	ND	ND	0.020	ND	ND	3457	1599
GB-3	Oct 11	7	ND	ND	ND	ND	ND	3137	579
GB-4	Oct 11	8	ND	ND	ND	ND	12	6917	2362
GB-5	Oct 11	8	ND	ND	ND	ND	ND	854	97
SB-1	Nov 17	16-18	ND	ND	ND	ND	ND	ND	ND
SB-2	Nov 17	14-16	ND	ND	ND	ND	ND	ND	ND
SB-3	Nov 17	17-19	ND	0.165	0.598	ND	159	1258	216
SB-4	Nov 17	18-20	ND	0.377	3.338	1.309	433	4632	ND
SB-5	Nov 17	16-18	ND	ND	ND	ND	ND	ND	ND
SB-6	Nov 17	16-18	ND	0.224	1.009	0.835	90	958	340

Note:

TPH-G 8015 Mod-G = Total Petroleum Hydrocarbons - EPA Method 8015 modified for gasoline

TPH-D 8015 Mod-D = Total Petroleum Hydrocarbons - EPA Method 8015 modified for diesel

TRPH 418.1 = Total Recoverable Petroleum Hydrocarbons - EPA Method 418.1 Oil and grease

* bgs = below grade surface

All results in ppm by weight (mg/kg)

ND denotes Not Detected at the limit of quantitation

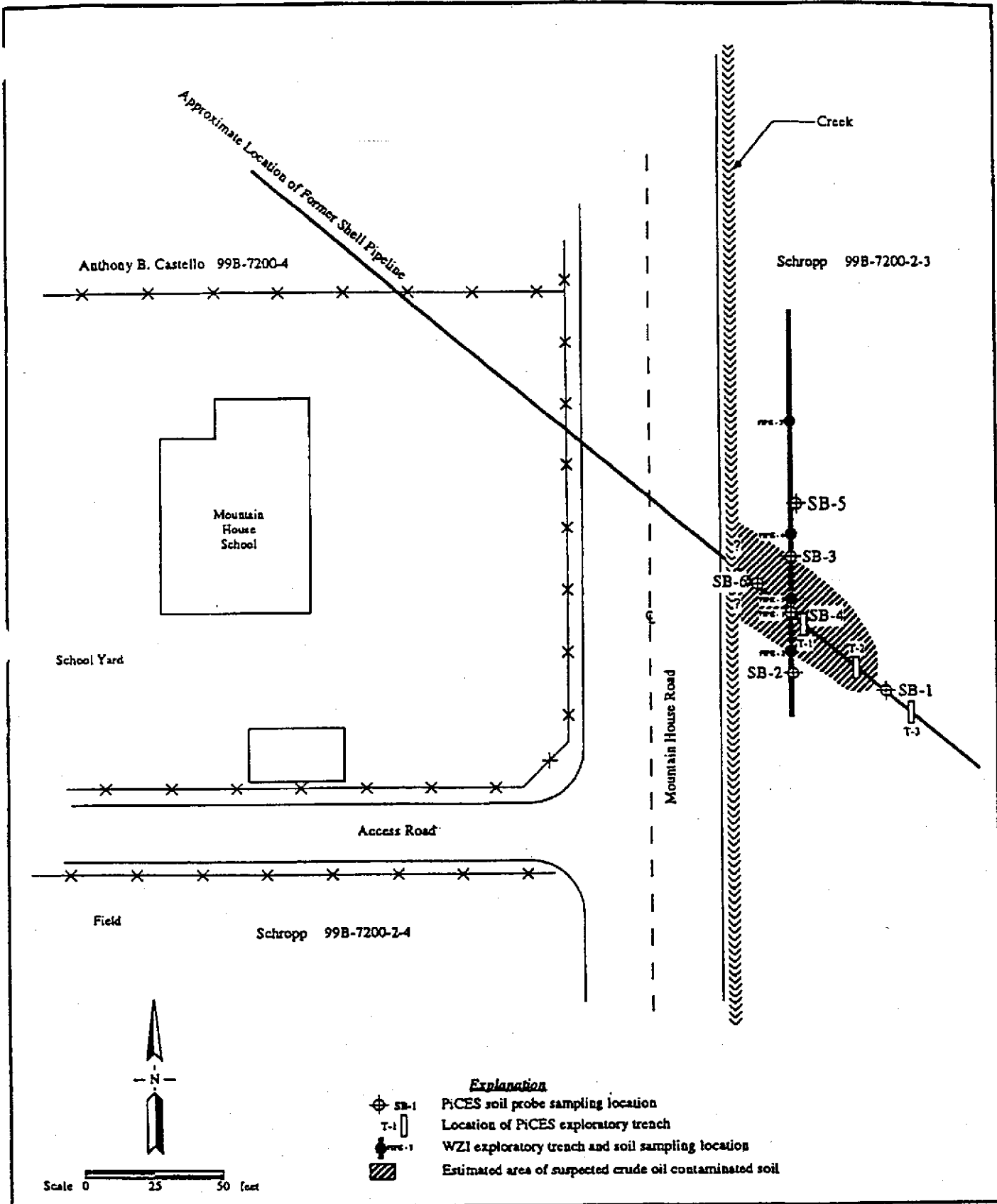

DIAGNOSTIC
ASSOCIATES
 PROFESSIONAL INTEGRATED CONSULTING
 & ENVIRONMENTAL SERVICES
 "A Pledge to Quality"

SITE MAP
 Agricultural Industries Inc. (Schropp Ranch)
 Mountain House Road
 Byron, California

PLATE
2

DRAWN CME	PROJECT NUMBER 405-005	APPROVED	DATE 1/95	REVISED	DATE
--------------	---------------------------	----------	--------------	---------	------