



Bakersfield
 4700 Stockdale Highway, Suite 120
 Post Office Box 9217
 Bakersfield, California 93389
 805/326-1112 805/326-0191 FAX

WZI INC.

FAX LEAD SHEET

To: STEVE MUIR

Company: SIERRA BRAVO/WZI

From: Allen

Subject: Pacific, Humata, Schreff

Message: These are the latest tables of data for Pacific & Humata

Schreff was sampled during 4/96 but I find no tabulated data or report.

Total Number of Pages, Include Cover Page: Call me 12

Date Transmitted: 8-13-96

Fax Number: ~~209-369-9358~~ (209) 339-8566

Telephone Number: 209-369-9421

File Number: 0826.0010 / 16310010 / 01370010



CONFIRMING TELEPHONE NUMBER IS (805) 326-1112

WZI INC. FAX NUMBER IS (805) 326-0191

Oper.: Date Sent: 8/12 Time Sent: 5:17 Initials: AM Copies & Distribution: _____

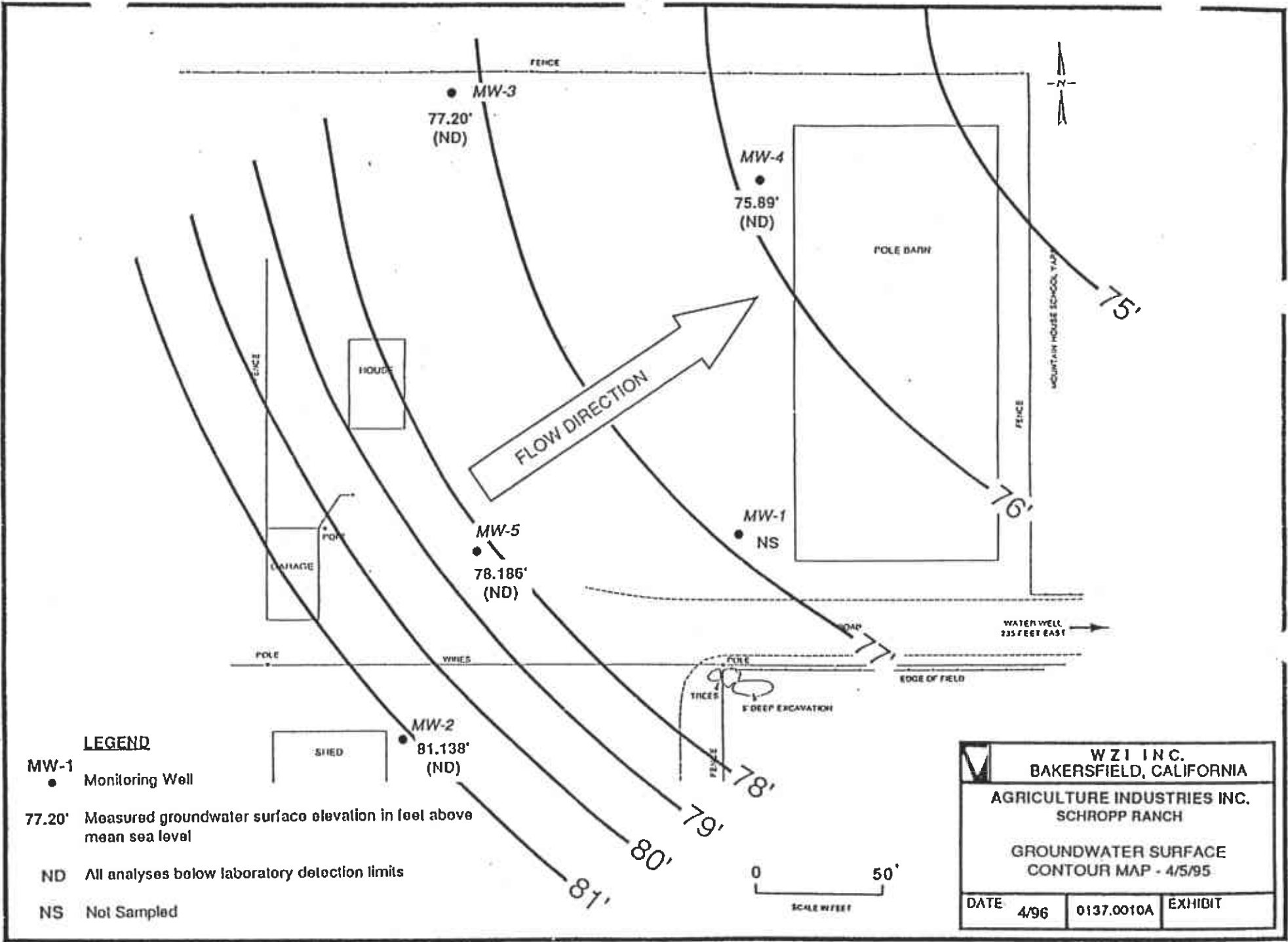

- LEGEND**
- MW-1 ● Monitoring Well
 - 77.20' Measured groundwater surface elevation in feet above mean sea level
 - ND All analyses below laboratory detection limits
 - NS Not Sampled

WZI INC. BAKERSFIELD, CALIFORNIA		
AGRICULTURE INDUSTRIES INC. SCHROPP RANCH		
GROUNDWATER SURFACE CONTOUR MAP - 4/5/95		
DATE	4/96	0137.0010A
		EXHIBIT

TABLE 1

**TABULATION SUMMARY OF GROUNDWATER MONITORING RESULTS
FOR MONITORING WELLS MW-1 TO MW-6
PACIFIC FARMS, FRESNO COUNTY, CALIFORNIA
ON NOVEMBER 2, 1995**

WELL NUMBER	TIME	SAMPLER	CASING ELEVATION (feet)	MEASURED GROUNDWATER DEPTH (feet)	GROUNDWATER ELEVATION (feet)	CHANGE IN GROUNDWATER ELEVATION FROM LAST SAMPLING (feet)	WATER SAMPLE NUMBER	US EPA TEST METHOD	ANALYTICAL RESULTS
MW-1	13:42	SGM	195.87	5.24	190.63	+0.98	PF-MW-1	3510/8015M Gas & Diesel 602 BTEX	All analytes non-detection.
MW-2	13:58	SGM	195.08	5.98	189.10	+1.01	PF-MW-2	3510/8015M Gas & Diesel 602 BTEX	All analytes non-detection.
MW-3	14:15	SGM	196.12	5.52	190.60	+0.97	PF-MW-3	3510/8015M Gas & Diesel 602 BTEX	All analytes non-detection.
MW-4	14:28	SGM	196.25	5.01	191.24	+1.03	PF-MW-4	3510/8015M Gas & Diesel 602 BTEX	All analytes non-detection.
MW-5	14:47	SGM	194.90	5.59	189.31	+1.08	PF-MW-5	3510/8015M Gas & Diesel 602 BTEX	All analytes non-detection.
MW-6	15:02	SGM	197.33	5.08	192.27	+0.98	PF-MW-6	3510/8015M Gas & Diesel 602 BTEX	All analytes non-detection.

NA - Not analyzed
NS - Not sampled

16310010.TBL1-6.TAB

TABLE 2-1

**TABULATION OF MONITORING WELL SAMPLING DATA
AND GROUNDWATER LABORATORY ANALYTICAL RESULTS
FOR MONITORING WELL MW-1
HAMATANI FARMS, SACRAMENTO COUNTY, CALIFORNIA**

DATE	TIME	SAMPLER	CASING ELEVATION (feet)	MEASURED GROUNDWATER DEPTH (feet)	GROUNDWATER ELEVATION (feet)	CHANGE IN GROUNDWATER ELEVATION FROM LAST SAMPLING (feet)	WATER SAMPLE NUMBER	US EPA TEST METHOD	ANALYTICAL RESULTS
11/22/94	09:20	SGM	1.020	7.18	-6.16	Not applicable	HF-MW-1	3510/8015(M) 602	Benzene .40 mg/l Toluene 3.15 Ethylbenzene ND Total Xylene 5.25 TPH-Gas 37.5
10/29/95	16:04	SGM	1.02	5.84	-4.82	+1.04	HF-MW-1	8015(M), 602	Benzene .670 mg/l Toluene 1.570 Ethylbenzene 1.460 Total Xylene 2.080 TPH-Gas 15.700
04/03/96	16:50	SGM	1.02	5.94	-4.92	-0.10	MW-1	8015(M), 602	Benzene 1.48 mg/l Toluene 5.62 Ethylbenzene 2.47 Total Xylene 6.310 TPH-Gas 39.7

TABLE 2-2

**TABULATION OF MONITORING WELL SAMPLING DATA
AND GROUNDWATER LABORATORY ANALYTICAL RESULTS
FOR MONITORING WELL MW-2
HAMATANI FARMS, SACRAMENTO COUNTY, CALIFORNIA**

DATE	TIME	SAMPLER	CASING ELEVATION (feet)	MEASURED GROUNDWATER DEPTH (feet)	GROUNDWATER ELEVATION (feet)	CHANGE IN GROUNDWATER ELEVATION FROM LAST SAMPLING (feet)	WATER SAMPLE NUMBER	US EPA TEST METHOD	ANALYTICAL RESULTS
11/22/94	09:00	SGM	1.890	8.05	-6.16	Not applicable	HF-MW-2	3510/8015(M) 602	Benzene ND Toluene ND Ethylbenzene ND Total Xylene ND TPH-Gas ND
06/09/95	13:55	SGM	1.89	7.76	-5.87	+0.29	HF-MW-2	3510/8015(M) 602	Benzene ND Toluene ND Ethylbenzene ND Total Xylene ND TPH-Gas ND
10/29/95	13:10	SGM	1.89	6.64	-4.75	+1.02	HF-MW-2	5030/8015(M), 602	Benzene ND Toluene ND Ethylbenzene ND Total Xylene ND TPH-Gas ND
04/03/96	15:57	SGM	1.89	6.77	-4.88	-0.13	MW-2	5030/8015(M), 602	Benzene ND Toluene ND Ethylbenzene ND Total Xylene ND TPH-Gas ND

TABLE 2-3

TABULATION OF MONITORING WELL SAMPLING DATA
AND GROUNDWATER LABORATORY ANALYTICAL RESULTS
FOR MONITORING WELL MW-3
HAMATANI FARMS, SACRAMENTO COUNTY, CALIFORNIA

DATE	TIME	SAMPLER	CASING ELEVATION (feet)	MEASURED GROUNDWATER DEPTH (feet)	GROUNDWATER ELEVATION (feet)	CHANGE IN GROUNDWATER ELEVATION FORM LAST SAMPLING (feet)	WATER SAMPLE NUMBER	US EPA TEST METHOD	ANALYTICAL RESULTS
11/22/94	09:05	SGM	5.692	6.62	-0.928	Not applicable	HF-MW-3	3510/8015(M) 602	Benzene .002 mg/l Toluene .002 Ethylbenzene .002 Total Xylene .004 TPH-Gas .087
06/09/95	14:39	SGM	5.692	6.24	-0.548	+ 0.38	HF-MW-3	3510/8015(M) 602	Benzene ND mg/l Toluene ND Ethylbenzene ND Total Xylene ND TPH-Gas ND
10/29/95	13:25	SGM	5.692	6.18	-.49	-.19	HF-MW-3	5030/8015(M) 602	Benzene ND mg/l Toluene ND Ethylbenzene .0004 Total Xylene ND TPH-Gas ND
04/03/96	15:57	SGM	5.692	5.11	0.582	+1.072	MW-3	5030/8015(M) 602	Benzene ND mg/l Toluene ND Ethylbenzene .0004 Total Xylene ND TPH-Gas ND

TABLE 2-4

**TABULATION OF MONITORING WELL SAMPLING DATA
AND GROUNDWATER LABORATORY ANALYTICAL RESULTS
FOR MONITORING WELL MW-4
HAMATANI FARMS, SACRAMENTO COUNTY, CALIFORNIA**

DATE	TIME	SAMPLER	CASING ELEVATION (feet)	MEASURED GROUNDWATER DEPTH (feet)	GROUNDWATER ELEVATION (feet)	CHANGE IN GROUNDWATER ELEVATION FROM LAST SAMPLING (feet)	WATER SAMPLE NUMBER	US EPA TEST METHOD	ANALYTICAL RESULTS
11/22/94	08:52	SGM	6.220	7.08	-0.86	Not applicable	HF-MW-4	3510/8015(M) 602	Benzene ND Toluene ND Ethylbenzene ND Total Xylene ND TPH-Gas ND
6/9/95	13:25	SGM	6.220	6.52	-0.30	+0.56	HF-MW-4	3510/8015(M) 602	Benzene ND Toluene ND Ethylbenzene ND Total Xylene ND TPH-Gas ND
06/27/95	08:36	SGM	6.220	6.74	-0.52	-0.22	HF-MW-4	N/A	Benzene ND Toluene ND Ethylbenzene ND Total Xylene ND TPH-Gas ND
10/29/95	13:40	SGM	6.220	5.50	0.72	+1.02	HF-MW-4	5030/8015(M) 602	Benzene ND Toluene ND Ethylbenzene ND Total Xylene ND TPH-Gas ND
04/03/96	15:54	SGM	6.220	5.27	0.95	+0.20	MW-4	5030/8015(M) 602	Benzene ND Toluene ND Ethylbenzene ND Total Xylene ND TPH-Gas ND

TABLE 2-5

**TABULATION OF MONITORING WELL SAMPLING DATA
AND GROUNDWATER LABORATORY ANALYTICAL RESULTS
FOR MONITORING WELL MW-5
HAMATANI FARMS, SACRAMENTO COUNTY, CALIFORNIA**

DATE	TIME	SAMPLER	CASING ELEVATION (feet)	MEASURED GROUNDWATER DEPTH (feet)	GROUNDWATER ELEVATION (feet)	CHANGE IN GROUNDWATER ELEVATION FROM LAST SAMPLING (feet)	WATER SAMPLE NUMBER	US EPA TEST METHOD	ANALYTICAL RESULTS
11/22/94	09:10	SGM	-1.505	4.52	-6.025	Not applicable	HF-MW-5	3510/8015(M) 602	Benzene .031 mg/l Toluene .003 Ethylbenzene .008 Total Xylene .002 TPH-Gas .275
06/09/95	14:50	SGM	-1.505	3.93	-5.435	+ 0.59	HF-MW-5	3510/8015M 602	Benzene .003 mg/l Toluene .001 Ethylbenzene ND Total Xylene .0006 TPH-Gas ND
10/29/95	15:30	SGM	-1.50	2.84	-4.34	+0.99	HF-MW-5	5030/8015(M) 602	Benzene ND Toluene ND Ethylbenzene ND Total Xylene ND TPH-Gas ND
04/03/96	16:45	SGM	-1.50	2.76	-4.26	+0.08	MW-5	5030/8015(M) 602	Benzene .004 mg/l Toluene .008 Ethylbenzene ND Total Xylene 0.05 TPH-Gas ND

NS - Not Sampled

TABLE 2-6

**TABULATION OF MONITORING WELL SAMPLING DATA
AND GROUNDWATER LABORATORY ANALYTICAL RESULTS
FOR MONITORING WELL MW-6
HAMATANI FARMS, SACRAMENTO COUNTY, CALIFORNIA**

DATE	TIME	SAMPLER	CASING ELEVATION (feet)	MEASURED GROUNDWATER DEPTH (feet)	GROUNDWATER ELEVATION (feet)	CHANGE IN GROUNDWATER ELEVATION FROM LAST SAMPLING (feet)	WATER SAMPLE NUMBER	US EPA TEST METHOD	ANALYTICAL RESULTS
06/09/95	13:40	SGM	5.18	6.02	-0.84	Not applicable	HF-MW-6	3510/8015(M) 602	Benzene ND Toluene ND Ethylbenzene ND Total Xylene ND TPH-Gas ND
10/29/95	14:00	SGM	5.18	4.77	0.41	+0.57	HF-MW-6	5030/8015(M) 602	Benzene ND Toluene ND Ethylbenzene ND Total Xylene ND TPH-Gas ND
04/03/96	15:28	SGM	5.18	4.91	0.27	-0.14	MW-2	5030/8015(M) 602	Benzene ND Toluene ND Ethylbenzene ND Total Xylene ND TPH-Gas ND

TABLE 2-7

**TABULATION OF MONITORING WELL SAMPLING DATA
AND GROUNDWATER LABORATORY ANALYTICAL RESULTS
FOR MONITORING WELL MW-7
HAMATANI FARMS, SACRAMENTO COUNTY, CALIFORNIA**

DATE	TIME	SAMPLER	CASING ELEVATION (feet)	MEASURED GROUNDWATER DEPTH (feet)	GROUNDWATER ELEVATION (feet)	CHANGE IN GROUNDWATER ELEVATION FROM LAST SAMPLING (feet)	WATER SAMPLE NUMBER	US EPA TEST METHOD	ANALYTICAL RESULTS
06/09/95	14:05	SGM	6.07	6.92	-0.85	Not applicable	HF-MW-7	3510/8015(M) 602	Benzene ND Toluene ND Ethylbenzene ND Total Xylene ND TPH-Gas ND
10/29/95	14:25	SGM	6.07	5.62	0.45	+0.60	HF-MW-7	5030/8015(M) 602	Benzene ND Toluene ND Ethylbenzene ND Total Xylene ND TPH-Gas ND
04/03/96	15:33	SGM	6.07	6.05	0.02	-.430	MW-7	5030/8015(M) 602	Benzene ND Toluene ND Ethylbenzene ND Total Xylene ND TPH-Gas ND

TABLE 2-8

TABULATION OF MONITORING WELL SAMPLING DATA
AND GROUNDWATER LABORATORY ANALYTICAL RESULTS
FOR MONITORING WELL MW-8
HAMATANI FARMS, SACRAMENTO COUNTY, CALIFORNIA

DATE	TIME	SAMPLER	CASING ELEVATION (feet)	MEASURED GROUNDWATER DEPTH (feet)	GROUNDWATER ELEVATION (feet)	CHANGE IN GROUNDWATER ELEVATION FROM LAST SAMPLING (feet)	WATER SAMPLE NUMBER	US EPA TEST METHOD	ANALYTICAL RESULTS
06/09/95	14:16	SGM	2.95	3.80	-0.85	Not applicable	HF-MW-8	3510/8015(M) 602	Benzene ND Toluene ND Ethylbenzene ND Total Xylene ND TPH-Gas ND
10/29/95	14:45	SGM	2.95	2.35	0.60	+0.75	HF-MW-8	5030/8015(M) 602	Benzene ND Toluene ND Ethylbenzene ND Total Xylene ND TPH-Gas ND
04/03/96	15:40	SGM	2.95	2.96	-0.01	-.61	MW-8	5030/8015(M) 602	Benzene ND Toluene ND Ethylbenzene ND Total Xylene ND TPH-Gas ND

TABLE 2-9

**TABULATION OF MONITORING WELL SAMPLING DATA
AND GROUNDWATER LABORATORY ANALYTICAL RESULTS
FOR MONITORING WELL MW-9
HAMATANI FARMS, SACRAMENTO COUNTY, CALIFORNIA**

DATE	TIME	SAMPLER	CASING ELEVATION (feet)	MEASURED GROUNDWATER DEPTH (feet)	GROUNDWATER ELEVATION (feet)	CHANGE IN GROUNDWATER ELEVATION FROM LAST SAMPLING (feet)	WATER SAMPLE NUMBER	US EPA TEST METHOD	ANALYTICAL RESULTS
06/09/95	14:25	SGM	6.07	6.56	0.49	Not applicable	NONE		N/A
06/27/95	8:45	SGM	6.07	7.08	-1.01	-0.52	HF-MW-9	3510/8015 (M)602	Benzene ND Toluene ND Ethylbenzene ND Total Xylene ND TPH-Gas ND
10/29/95	15:00	SGM	6.07	5.55	0.52	+1.03	HF-MW-9	5030/8015(M)602	Benzene ND Toluene ND Ethylbenzene ND Total Xylene ND TPH-Gas ND
04/03/96	15:46	SGM	6.07	5.28	0.79	+57	MW-9	5030/8015(M)602	Benzene ND Toluene ND Ethylbenzene ND Total Xylene ND TPH-Gas ND

N/A - Not Applicable