



**ESCM Technology, Inc.**  
*Environmental & Engineering Consultants*

1781 Mars Hill Road  
 Watkinsville, GA 30677  
 P.O. Box 7487  
 Athens, Georgia 30604  
 email: [escm@negia.net](mailto:escm@negia.net)  
 (706) 769-4134  
 FAX (706) 769-1431

ENVIRONMENTAL  
 PROTECTION

October 31, 1997 NOV 12 PM 3:54

Alameda County Health Agency  
 Division of Environmental Protection  
 Department of Environmental Health  
 1131 Harbor Bay Parkway, 2nd floor  
 Alameda, CA 94502

ATTN: Madullah Logan, Environmental Specialist

Subject: Monitoring Data Results  
 Printpack, Inc., Facility (formerly James River)  
 2101 Williams Street  
 San Leandro, CA

Dear Ms. Logan

Reference is made to our recent discussions regarding your review of the Risk Based Corrective Action Report, dated April 25, 1997, for the subject facility. Pursuant to our discussions, it was understood that additional groundwater samples were to be collected from monitor wells TW-1 and TW-2 at subject facility. The samples were to be analyzed for benzene and acetone. The laboratory analysis data is to be used to determine if the model submitted with the referenced April 25, 1997, report accurately depicts the actual situation at the facility.

Both monitor wells TW-1 and TW-2 were purged on the morning of October 24, 1997. The wells were permitted to recharge and groundwater samples were collected, placed on ice, and transported to the laboratory for analysis. Copies of the laboratory data are attached.

**DISCUSSION OF RESULTS:**

<u>Monitor Well</u>	<u>Benzene ug/L</u>	<u>Ethyl Ben ug/L</u>	<u>Toluene ug/L</u>	<u>Xylene ug/L</u>	<u>Acetone ug/L</u>
TW-1	1.0	ND	15.0	1.0	110
TW-2	ND	ND	ND	ND	4.5

The BTEX constituents detected in TW-1 are below the Primary Drinking Water Standards (40 CFR 141.60). BTEX constituents in TW-2 are all non-detect. Therefore, it appears that there should be no further concern regarding BTEX constituents.

Monitoring Data Results  
Printpack, Inc., Facility (formerly James River)  
2101 Williams Street  
San Leandro, CA  
October 31, 1997  
Page 2 of 2

The reported acetone concentration in TW-1 of 110 ug/L is well below the model predicted concentration of 100,000 ug/L at 100 feet downgradient from MW-10. TW-2 is more than 600 feet downgradient of MW-10. At TW-2 the model predicts ND for acetone. The reported acetone concentration in TW-2 of 4.5 ug/L does not conform precisely with the model, but is sufficiently low such that it supports the overall model calculations.

Acetone is not regulated under the Federal Primary or Secondary Drinking Water Standards. The State of California lists acetone as a hazardous substance only because it is ignitable in high concentrations (i.e., 250,000 ppm, see previously referenced April 25, 1997, report.) The OSHA Permissible Exposure Level (PEL) for acetone is 750,000 ppm.

It appears that the recently collected data supports the conclusions of the previously submitted Risk Based Corrective Action Report, dated April 25, 1997. It is therefore requested that a "No Further Action" response be provided for this site. Upon receipt of the NFA, Printpack will take appropriate steps to close the onsite monitoring wells.

If additional review fees are due, please advise immediately so an appropriate payment can be made. We appreciate your assistance in this matter and look forward to working with on future projects. If you have any questions, please call us at (706) 769-4434.

Sincerely,



Edward A. Shaw  
President of ESCM

Attachments: Scalable Site Map  
Laboratory Data Sheets

cc: Doug Cook, Printpack  
ESCM Files

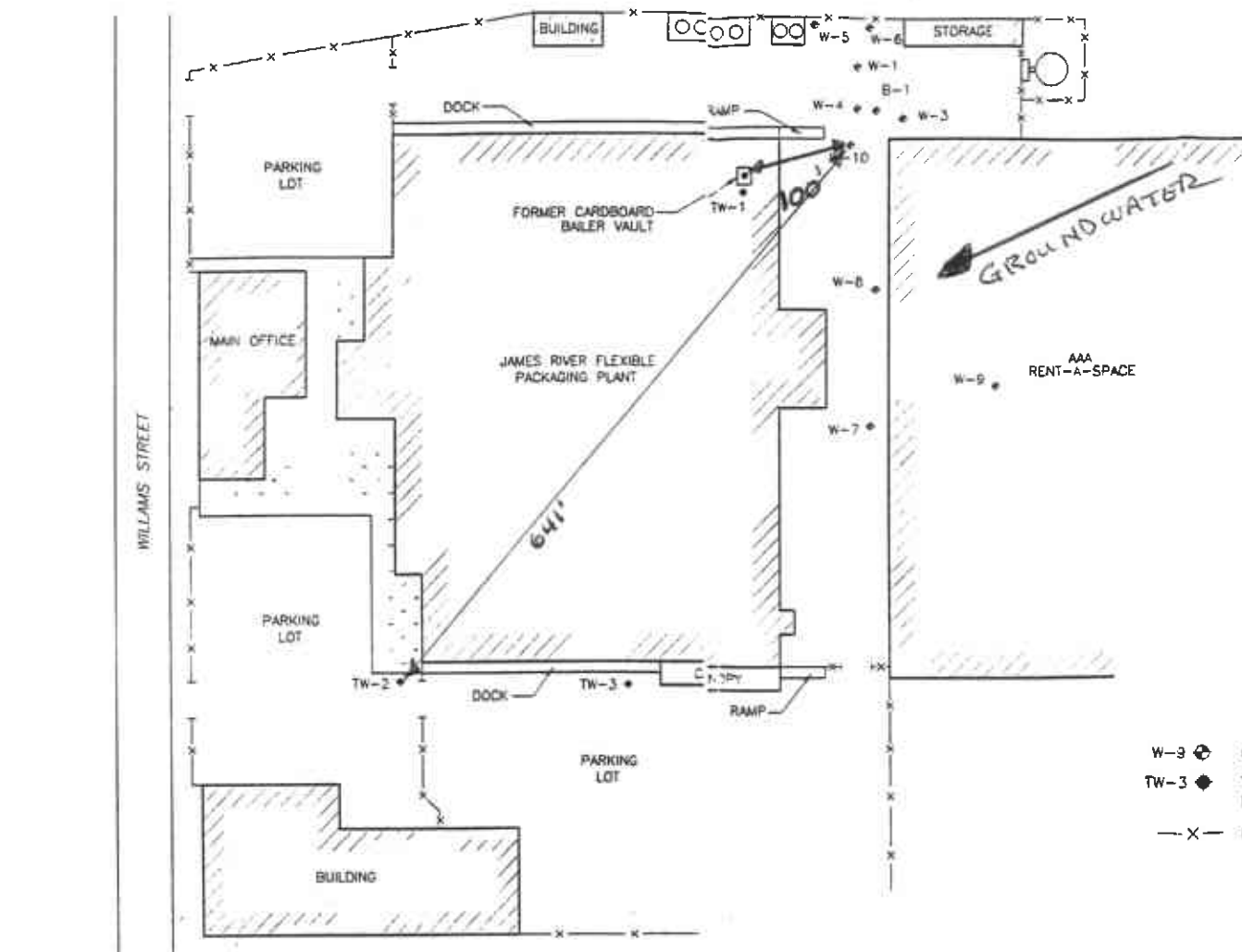

**LEGEND**

- W-3 GROUND WATER MONITORING WELL
- TW-3 TEMPORARY GROUND WATER MONITORING WELL
- X - FENCE



DOOLITTLE

Environmental Science & Engineering, Inc. 4090 NELSON AVENUE, SUITE J CONCORD, CA 94520	DATE 11/27/95	SITE MAP	FIGURE NO. 2
	REVISION 1/19/96		PROJECT NO. 65-96-064
JOB FILE 65604412		JAMES RIVER CORPORATION 2101 WILLIAMS STREET SAN LEANDRO, CALIFORNIA	

510 798 1622

10-27-1997 08:42AM FROM McCampbell Analytical Inc TO

18012260512 P.03

 <b>McCAMPBELL ANALYTICAL INC.</b>	110 Second Avenue South, #D7, Pacheco, CA 94553
	Telephone: 510-798-1620 Fax: 510-798-1622 <a href="http://www.mccampbell.com">http://www.mccampbell.com</a> E-mail: <a href="mailto:main@mccampbell.com">main@mccampbell.com</a>

ESCM Resources  51 W. Center Street, #147  Orem, Utah 84037	Client Project ID: Print Pack; San Leandro	Date Sampled: 10/24/97
	Client Contact: Lance Hess	Date Received: 10/24/97
	Client P.O.	Date Analyzed: 10/24/97
		Date Extracted: 10/24/97

**Gasoline Range (C6-C12) Volatile Hydrocarbons as Gasoline\*, with Methyl tert-Butyl Ether\* & BTEX\***  
 EPA methods 5030, modified 8015, and 8020 or 802; California RWQCB (SF Bay Region) method GC/FID(5030)

Lab ID	Client ID	Matrix	TPH(g) <sup>f</sup>	MTBE	Benzene	Toluene	Ethylbenzene	Xylenes	% Recovery Surrogate
82219	TW-2	W	740,f	---	ND	ND	ND	ND	95
82220	TW-1	W	78j,f,h	---	1.0	15	ND	1.0	107
Reporting Limit unless otherwise stated; ND means not detected above the reporting limit	W		50 ug/L	5.0	0.5	0.5	0.5	0.5	
	S		1.0 mg/kg	0.05	0.005	0.005	0.005	0.005	

\* water and vapor samples are reported in ug/L, wipe samples in ug/wipe, soil and sludge samples in mg/kg, and all TCLP and SPLP extracts in ug/L

<sup>a</sup> cluttered chromatogram; sample peak coelutes with surrogate peak

The following descriptions of the TPH chromatogram are cursory in nature and McCampbell Analytical is not responsible for their interpretation: a) unmodified or weakly modified gasoline is significant; b) heavier gasoline range compounds are significant (aged gasoline?); c) lighter gasoline range compounds (the most mobile fraction) are significant; d) gasoline range compounds having broad chromatographic peaks are significant; biologically altered gasoline?; e) TPH pattern that does not appear to be derived from gasoline (?); f) one to a few isolated peaks present; g) strongly aged gasoline or diesel range compounds are significant; h) lighter than water immiscible sheen is present; i) liquid sample that contains greater than ~3 vol. % sediment; j) no recognizable pattern.

 <b>McCAMPBELL ANALYTICAL INC.</b>	110 Second Avenue South, #D7, Pacheco, CA 94553 Telephone: 510-798-1620 Fax: 510-798-1622 <a href="http://www.mccampbell.com">http://www.mccampbell.com</a> E-mail: main@mccampbell.com
	(Additional contact information or address details)

<b>ESCM Resources</b> 51 W. Center Street, #147 Orem, Utah 84057	Client Project ID: Print Pack; San Leandro	Date Sampled: 10/24/97
	Client Contact: Lance Hess	Date Received: 10/24/97
	Client P.O:	Date Extracted: 10/24/97
		Date Analyzed: 10/24/97

**Acetone\***

EPA method 8260

Lab ID	Client ID	Matrix	Acetone*	% Recovery Surrogate
82219	TW-2	W	4.5	95
82220	TW-1	W	110,h	94
Reporting Limit unless otherwise stated; ND means not detected above the reporting limit		W	1.0 ug/L	
		S	5.0 ug/kg	

\* water samples are reported in ug/L, soil and sludge samples in ug/kg, wine samples in ug/wipe and all TCLP / STLC / SPLP extracts in ug/L  
 h) lighter than water immiscible sheen is present i) liquid sample that contains greater than 5 vol. % sediment

DHS Certification No. 1644   
Edward Hamilton, Lab Director

**McCAMPBELL ANALYTICAL**  
 110 2nd AVENUE, # D7  
 (510) 708-1620 PACIFIC CO, CA 94553 FAX (510) 708-1622

REPORT TO: **LANCE Hess** BILL TO: **ESCALA ASSOC.**  
 COMPANY: **26th Resources** 1781 Marshall Rd  
**51 W. Center St. #147** WATKINSVILLE, GA  
**ORLANDO 32807**  
 TEL: **801-765-0025** FAX: **801-226-0512**

PROJECT NUMBER: PROJECT NAME: **Pink Pack**  
 PROJECT LOCATION: **SAVILLON** SAMPLER SIGNATURE: *[Signature]*

**CHAIN OF CUSTODY RECORD**  
 TURN AROUND TIME:  RUSH  24 HOUR  48 HOUR  5 DAY

		ANALYSIS REQUEST										OTHER
		<input type="checkbox"/> Total Petroleum Hydrocarbons (LH)										
		<input type="checkbox"/> Total Petroleum Hydrocarbons (LH) & Diesel (OH)										
		<input type="checkbox"/> EPA 161/810										
		<input type="checkbox"/> EPA 162/802										
		<input type="checkbox"/> EPA 163/808										
		<input type="checkbox"/> EPA 164/800 - PCBs Dry										
		<input checked="" type="checkbox"/> EPA 165/816 ACETONE										
		<input type="checkbox"/> EPA 166/870										
		<input type="checkbox"/> CAN - 17 Metals										
		<input type="checkbox"/> EPA - Priority Pollutants Metal										
		<input type="checkbox"/> LEAD (306/181/182/183)										
		<input type="checkbox"/> DRIVING LEAD										
		<input type="checkbox"/> PCB										

02219  
02220

SAMPLE ID	LOCATION	SAMPLING		# CONTAINERS	TYPE CONTAINERS	MATRIX				METHOD PRESERVED					
		DATE	TIME			WATER	SOIL	AIR	SLUDGS	OTHER	HCL	HNO <sub>3</sub>	OTHER		
#1	TW-2	10/24		1	40ml										
#2	TW-2	10/24		1	"										
#3	TW-1	10/24		1	"										
#4	TW-1	10/24		1	"										

RELINQUISHED BY: <i>[Signature]</i> DATE: 10/24/97 TIME: 2:30 PM	RECEIVED BY: <b>MILENIC MAI</b> DATE: _____ TIME: _____
RELINQUISHED BY: _____ DATE: _____ TIME: _____	RECEIVED BY: _____ DATE: _____ TIME: _____
RELINQUISHED BY: _____ DATE: _____ TIME: _____	RECEIVED BY LABORATORY: _____ DATE: _____ TIME: _____

REMARKS:  
**-HOLD "EXTRAS" TW-1**

10-27-97 09:43 PREMIERE REAL ESTATE - 8015273059  
 10-27-1997 08:40AM McCampbell Analytical Inc TO 18012260512 P.02  
 801-522-3042