

779

ASSESSOR'S MAP 10

Code Area No. 17-001

10

Lakeside Subdivision of Adams Point Property (St. 2/7, 45)

scale 1" = 50'

REV. 3-11-57 L.S.
J.P. GIBLIN

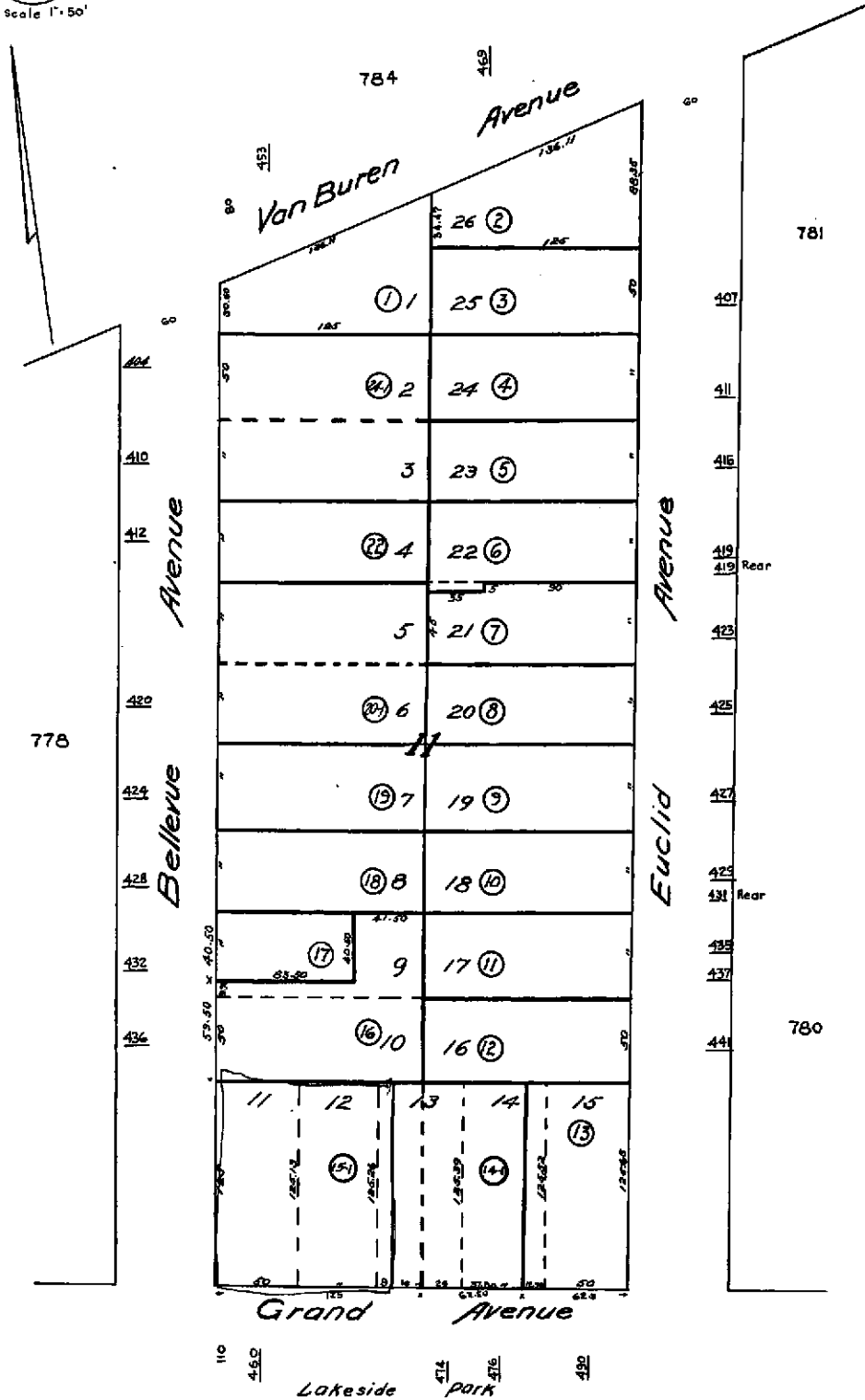

Ind 2



COUNTY OF ALAMEDA
Assessor's Office

Property Value System

History

Value

Transfer

New Query

Parcel Number: 10-779-15-1 Inactive: N Lien Date: 01/01/2006 Owner: 460 GRAND OAKLAND LLC
 Property Address: 460 GRAND AVE , OAKLAND, CA 94610-5010

Mailing Name	Historical Mailing Address	Document Date	Document Number	Value From Trans Tax	Parcel Count	Use
460 GRAND OAKLAND LLC	1800 SUTTER ST STE 500, CONCORD, CA 94520-2587	08/29/2005	2005-369365		3	7000
460 GRAND OAKLAND LLC	1800 SUTTER ST STE 500, CONCORD, CA 94520-2587	08/29/2005	2005-369365		3	3000
D & B BELLEVUE LLC	165 10TH ST , SAN FRANCISCO, CA 94103-2604	03/12/2004	2004-106917	\$1,225,000	1	3000
FALASCHI BROTHERS c/o JOHN C GIBSON	1629 5TH AVE , SAN RAFAEL, CA 94901-1828	08/03/1978	1978-148698	\$175,000	1	3000
GULF OIL CORPORATION	460 GRAND AVE , OAKLAND, CA 94610-5010	01/16/1961	AS-6293		7	3000

All information on this site is to be assumed accurate for property assessment purposes only, and is based upon the Assessor's knowledge of each property. Caution is advised for use other than its intended purpose.

The Alameda County Intranet site is best viewed in Internet Explorer Version 5.5 or later.
 Click [here](#) for more information regarding supported browsers.

Copyright © 2001 Alameda County