



ENVIRONMENTAL  
PROTECTION

00 JUN -6 PM 4: 51

Mr. Hugh Murphy  
Environmental Specialist  
City of Hayward Fire Department  
777 B Street  
Hayward, California 94541-3340

RECEIVED BY  
FIRE PREVENTION OFFICE

May 31, 2000

JUN 01 2000

HAYWARD FIRE DEPARTMENT

RE: Underground Tank Closure Verification Request Work Plan for Site Investigation at  
Runnels Industries, Inc., 3590 Enterprise Avenue, Hayward, CA.

Dear Mr. Murphy;

Runnels Industries, Inc., has requested that the undersigned prepare this closure verification request for the tanks removed from the site in 1993. According to Ms. Eva Chu with the Alameda County Health Care Services Agency (ACHCSA) this is a City of Hayward, Fire Department issue.

In 1993 an Underground Storage Tank Closure Report was prepared by DECON Environmental Services, Inc. (Copy attached). Neither Runnels Industries, Inc., nor the ACHCSA has any records verifying that tank closure was granted.

Please provide verification of the status of the 3590 Enterprise Avenue, Hayward, property with respect to underground tanks.

Please do not hesitate to call the undersigned at 925-373-9211 or FAX at 925-373-9222 should you have any questions.

Sincerely,

Gary D. Lowe, R.G., C.E.G., C.HG.  
Principal, Hydrogeologist

cc: Mr. Al Gant, Runnels Industries



June 18, 1993

Mr. Al Gant  
Runnels Industries, Inc.  
390 Enterprise Avenue  
Hayward, CA 94545

RECEIVED BY  
HAZARDOUS MATERIALS OFFICE

JUL 13 1993

HAYWARD FIRE DEPARTMENT

RE: UST REMOVAL, 3590 ENTERPRISE AVENUE, HAYWARD

Dear Mr. Gant:

DECON Environmental Services, Inc. (DECON) was hired by Runnels Industries, Inc. to remove three underground storage tanks at their facility in Hayward. The three underground tanks included a 1000 gallon Methylethyl ketone tank, a 1000 gallon diesel fuel tank and a 500 gallon gasoline tank. The tanks were located under a concrete pad to the South of the office.

DECON applied for and received a permit from the City of Hayward Fire Department and notified Bay Area Quality Management District of the project. Underground Service Alert (USA) was called to locate and mark the underground utilities in the area.

DECON mobilized a crew and equipment on May 10th and commenced field operations. The three tanks were free of any product. The concrete above the tanks was broken up and removed with a backhoe. The concrete rubble was hauled to a local recycler. The soil above each tank was removed and stockpiled in the parking lot. All vent and product lines were properly removed and disposed of with the tanks.

On May 11th, the three tanks were inerted with dry ice at the rate of 15 lbs. of ice per 1000 gallons of tank capacity. Accompanied by a representative of the Hayward Fire Department, DECON checked the lower explosive limits (LEL) and oxygen (O<sub>2</sub>) content of each tank. The LEL and O<sub>2</sub> contents were within permissible limits set forth by the Fire Department.

With their approval DECON removed the tanks from the excavation with the backhoe and placed them on a flatbed truck licensed to haul hazardous waste. The tanks were hauled under Hazardous Waste Manifest #90661540 to Erickson Inc. in Richmond. Erickson is a facility licensed to receive empty storage tanks for proper destruction.

**UNIFORM HAZARDOUS WASTE MANIFEST**

1. Generator's US EPA ID No. **C1A1C101010171910181214110121011**

Manifest Document No. **110121011**

2. Page 1 of 1

Information in the shaded areas is not required by Federal law.

3. Generator's Name and Mailing Address  
**Runnels Industries**  
**3590 Enterprise Avenue Hayward, CA 94545**

4. Generator's Phone **(510) 783-4171**

A. State Manifest Document Number  
**90661540**

B. State Generator's ID

5. Transporter 1 Company Name  
**DECON Environmental Services, Inc**

6. US EPA ID Number  
**C1A1D19181214161811813**

C. State Transporter's ID

7. Transporter 2 Company Name

8. US EPA ID Number

D. Transporter's Phone **(510) 732-6444**

E. State Transporter's ID

F. Transporter's Phone

9. Designated Facility Name and Site Address  
**Erickson, Inc.**  
**455 Parr Boulevard**  
**Richmond, CA 94801**

10. US EPA ID Number  
**C1A1D101019141616131912**

G. State Facility's ID  
**CAD100946613912**

H. Facility's Phone  
**(510) 235-1393**

11. US DOT Description (Including Proper Shipping Name, Hazard Class, and ID Number)	12. Containers No.	13. Total Quantity	14. Unit	15. Waste No.
a. Non RCRA Hazardous Waste Solid Empty Storage Tanks	01013	01201010	P	State 512 EPA/Other None
b.				State EPA/Other
c.				State EPA/Other
d.				State EPA/Other

J. Additional Descriptions for Materials Listed Above  
**Tanks inerted with dry ice at the rate of 30 lbs/1000 gal capacity.**

K. Handling Codes for Wastes Listed Above  
 a. **01**  
 b.  
 c.  
 d.

15. Special Handling Instructions and Additional Information  
**AVOID CONTACT. WEAR APPROPRIATE PERSONAL PROTECTIVE CLOTHING AND EQUIPMENT.**  
**GENERATOR 24 HOUR EMERGENCY PHONE NUMBER (510) 475-2901**

16. GENERATOR'S CERTIFICATION: I hereby declare that the contents of this consignment are fully and accurately described above by proper shipping name and are classified, packed, marked, and labeled, and are in all respects in proper condition for transport by highway according to applicable international and national government regulations.  
 If I am a large quantity generator, I certify that I have a program in place to reduce the volume and toxicity of waste generated to the degree I have determined to be economically practicable and that I have selected the practicable method of treatment, storage, or disposal currently available to me which minimizes the present and future threat to human health and the environment; OR, if I am a small quantity generator, I have made a good faith effort to minimize my waste generation and select the best waste management method that is available to me and that I can afford.

Printed/Typed Name **ALFRED B. GANT** Signature *Alfred B. Gant* Month Day Year **5 11 93**

17. Transporter 1 Acknowledgement of Receipt of Materials  
 Printed/Typed Name **ROBERT L. STEIN** Signature *Robert L. Stein* Month Day Year **05/11/93**

18. Transporter 2 Acknowledgement of Receipt of Materials  
 Printed/Typed Name \_\_\_\_\_ Signature \_\_\_\_\_ Month Day Year \_\_\_\_\_

19. Discrepancy Indication Space  
**C. SAME TRANSPORTER ID . 401465 .**  
**RECEIVED TANK #S . 11114 11115 11116 .**  
**7. SITE ADDRESS . 255 PARR BLVD**

20. Facility Owner or Operator Certification of receipt of hazardous materials covered by this manifest except as noted in item 19.  
 Printed/Typed Name **DAVID SATO** Signature *DAVE SATO* Month Day Year **10/5/11/93**

IN CASE OF AN EMERGENCY OR SPILL, CALL THE NATIONAL RESPONSE CENTER 1-800-424-8802; WITHIN CALIFORNIA CALL 1-800-862-7550  
 GENERATOR  
 TRANSPORTER  
 FACILITY

TELEPHONE  
(510) 235-1393

# CERTIFIED SERVICES COMPANY

255 Parr Boulevard • Richmond, California 94801

CUSTOMER REQ.	
JOB NO.	31455

FOR: Erickson, Inc. TANK NO. 11110

LOCATION: Richmond DATE: 05/14/92 TIME: 09:20:10

TEST METHOD Visual Gastech/1314 SMPN LAST PRODUCT EG

This is to certify that I have personally determined that this tank is in accordance with the American Petroleum Institute and have found the condition to be in accordance with its assigned designation. This certificate is based on conditions existing at the time the inspection herein set forth was completed and is issued subject to compliance with all qualifications and instructions.

TANK SIZE 1000 Gallon Tank CONDITION SAFE FOR FIRE

REMARKS: OXYGEN 20.9%  
LOWER EXPLOSIVE LIMIT LESS THAN 0.10

"ERICKSON INC. HEREBY CERTIFIES THAT THE ABOVE NUMBERED TANK HAS BEEN  
CUT OPEN, PROCESSED, AND THEREFORE DESTROYED AT OUR PERMITTED HAZARDOUS  
WASTE FACILITY."

In the event of any physical or atmospheric changes affecting the gas-free conditions of the above tanks, or if in any doubt, immediately stop all hot work and contact the undersigned. This permit is valid for 24 hours if no physical or atmospheric changes occur.

## STANDARD SAFETY DESIGNATION

**SAFE FOR MEN:** Means that in the compartment or space so designated (a) The oxygen content of the atmosphere is at least 19.5 percent by volume; and that (b) Toxic materials in the atmosphere are within permissible concentrations; and (c) In the judgment of the Inspector, the residues are not capable of producing toxic materials under existing atmospheric conditions while maintained as directed on the inspector's certificate.

**SAFE FOR FIRE:** Means that in the compartment so designated (a) The concentration of flammable materials in the atmosphere is below 10 percent of the lower explosive limit; and that (b) In the judgment of the Inspector, the residues are not capable of producing a higher concentration that permitted under existing atmospheric conditions in the presence of fire and while maintained as directed on the Inspector's certificate, and further, (c) All adjacent spaces have either been cleaned sufficiently to prevent the spread of fire, are satisfactorily inerted, or in the case of fuel tanks, have been treated as deemed necessary by the Inspector.

The undersigned representative acknowledges receipt of this certificate and understands the conditions and limitations under which it was issued.

K. A. [Signature] REPRESENTATIVE      DS TITLE      INSPECTOR

# CERTIFIED SERVICES COMPANY

255 Parr Boulevard • Richmond, California 94801

CUSTOMER

JOB NO.

31400

FOR: Erickson, Inc. TANK NO. 11114

LOCATION: Richmond DATE: 05/12/93 TIME: 10:50:10

Visual Gastech/1311 SMPN LAST PRODUCT UG

I certify that I have personally determined that this tank is in accordance with the American Institute and have found the condition to be in accordance with its assigned designation. This certificate is based on conditions existing at the time the inspection herein set forth was made and is issued subject to compliance with all qualifications and instructions.

1000 Gallon Tank CONDITION SAFE FOR FIRE

OXYGEN 20.9%

LOWER EXPLOSIVE LIMIT LESS THAN 0.1%

"I, INC. HEREBY CERTIFIES THAT THE ABOVE NUMBERED TANK HAS BEEN  
PROCESSED, AND THEREFORE DESTROYED AT OUR PERMITTED HAZARDOUS  
FACILITY."

If any physical or atmospheric changes affecting the gas-free conditions of the above tanks, or if in any doubt, stop all hot work and contact the undersigned. This permit is valid for 24 hours if no physical or atmospheric changes occur.

## RD SAFETY DESIGNATION

**RD:** Means that in the compartment or space so designated (a) The oxygen content of the atmosphere is at least 19.5 percent by volume; and that (b) Toxic materials in the atmosphere are within permissible concentrations; and (c) In the judgment of the Inspector, the residues are not capable of producing toxic materials under existing atmospheric conditions as directed on the Inspector's certificate.

**FIRE:** Means that in the compartment so designated (a) The concentration of flammable materials in the atmosphere is below 10 percent of the lower explosive limit; and that (b) In the judgment of the Inspector, the residues are not capable of producing a higher concentration than permitted under existing atmospheric conditions in the presence of fire as directed on the Inspector's certificate, and further, (c) All adjacent spaces have either been cleaned, vented to prevent the spread of fire, are satisfactorily inerted, or in the case of fuel tanks, have been treated as deemed safe by the Inspector.

The undersigned representative acknowledges receipt of this certificate and understands the conditions and limitations under which it is issued.

K. A. [Signature] TITLE [Signature] INSPECTOR

31400

192

**CHAIN OF CUSTODY REPORT**

80110

JOB NUMBER AND NAME: Runnels 1020				ANALYSIS REQUESTED								TURNAROUND TIME: 5-day
REPORT AND BILL TO: DECON Environmental Services, Inc. 23490 Connecticut Street Hayward, CA 94545 (510) 732-6444												
SAMPLER: Tom Reese			DATE: 5-11-93	TPH-G	OTEX	TPH-D	CADMIUM-TTL	CHROMIUM-TTL	LEAD-TTLC	NICKEL-TTLC	ZINC-TTLC	REMARKS
SAMPLE ID/ STATION	SAMPLE DESCRIPTION	CONTAINERS NUMBER	TYPE	SAMPLING TIME/DATE								
#1	NORTH END OF GASOLINE TANK	1	W	1500	X	X						
#2	SOUTH END OF GASOLINE TANK	1	W	1510	X	X						
#3	UNDER DIESEL TANK	1	W	1520		X	X					
#4	NORTH END OF MEK TANK	1	W	1530		X	X	X	X	X	X	
#5	SOUTH END OF MEK TANK	1	W	1540		X	X	X	X	X	X	
#6	STOCKPILE - SAND	1	W	1550	X	X						Please hold on sample #6 and #7
#7	STOCKPILE - SOIL	1	W	1600	X	X						

RELINQUISHED BY: Tom Reese	DATE: 5-11-93	TIME: 1600	RECEIVED BY: Kathy Watkins	Laboratory Use Only: <input type="checkbox"/> None completed <input type="checkbox"/> preserved/on ice? <input type="checkbox"/> in good condition? <input type="checkbox"/> labeled?	Yes	No
RELINQUISHED BY: Barbara Loop (DECON)	DATE: 5-12-93	TIME: 13:00	RECEIVED BY: Kelly Koofer #62			
RELINQUISHED BY: Kelly Koofer #62	DATE: 5/12/93	TIME: 14:00	RECEIVED IN LAB BY: Kelly Koofer			

\* G - Grab C - Composite W - Wipe

5/12/93 2:00pm  
Sup Superior



# Superior Precision Analytical, Inc.

825 Arnold Drive, Suite 114 • Martinez, California 94553 • (510) 229-1512 / fax (510) 229-1576

Decon Environmental Services  
Attn: TOM REESE

Project RUNNELS 1020  
Reported 05/19/93

## TOTAL PETROLEUM HYDROCARBONS

Lab #	Sample Identification	Sampled	Analyzed Matrix
88578- 1	#1	05/11/93	05/15/93 Soil
88578- 2	#2	05/11/93	05/15/93 Soil
88578- 3	#3	05/11/93	05/19/93 Soil
88578- 4	#4	05/11/93	05/19/93 Soil
88578- 5	#5	05/11/93	05/19/93 Soil

## RESULTS OF ANALYSIS

Laboratory Number: 88578- 1    88578- 2    88578- 3

Gasoline:	ND<1	ND<1	NA
Benzene:	ND<.003	ND<.003	ND<0.3
Toluene:	ND<.003	ND<.003	ND<0.3
Ethyl Benzene:	0.021	0.10	ND<0.3
Xylenes:	0.066	0.35	ND<0.3
Diesel:	NA	NA	20
Concentration:	mg/kg	mg/kg	mg/kg

Laboratory Number: 88578- 4    88578- 5

Gasoline:	NA	NA
Benzene:	ND<.003	ND<.003
Toluene:	ND<.003	ND<.003
Ethyl Benzene:	ND<.003	ND<.003
Xylenes:	ND<.009	ND<.009
Diesel:	ND<10	13
Concentration:	mg/kg	mg/kg



# Superior Precision Analytical, Inc.

825 Arnold Drive, Suite 114 • Martinez, California 94553 • (510) 779-1512 / fax (510) 229-1526

## C E R T I F I C A T E O F A N A L Y S I S

### ANALYSIS FOR TOTAL PETROLEUM HYDROCARBONS

Page 2 of 2  
QA/OC INFORMATION  
SET: 88578

NA = ANALYSIS NOT REQUESTED  
ND = ANALYSIS NOT DETECTED ABOVE QUANTITATION LIMIT  
mg/kg = parts per million (ppm)

OIL AND GREASE ANALYSIS By Standard Methods Method 5520F:  
Minimum Detection Limit in Soil: 50mg/kg

Modified EPA SW-846 Method 8015 for Extractable Hydrocarbons:  
Minimum Quantitation Limit for Diesel in Soil: 10mg/kg

EPA SW-846 Method 8015/5030 Total Purgable Petroleum Hydrocarbons:  
Minimum Quantitation Limit for Gasoline in Soil: 1mg/kg

EPA SW-846 Method 8020/BTXR  
Minimum Quantitation Limit in Soil: 0.003mg/kg

ANALYTE	MS/MSD RECOVERY	RPD	CONTROL LIMIT
Gasoline:	92/92	0%	70-130
Benzene:	100/93	7%	70-130
Toluene:	100/96	4%	70-130
Ethyl Benzene:	106/106	0%	70-130
Xylenes:	107/106	1%	70-130
Diesel:	106/107	1%	75-125

Richard Srna, Ph.D.  
*Richard Srna*  
Laboratory Director





# Superior Precision Analytical, Inc.

825 Arnold Drive, Suite 114 • Martinez, California 94553 • (510) 229-1517 / fax (510) 229-1576

## CERTIFICATE OF ANALYSIS

LABORATORY NO.: 88578  
 CLIENT: Decon Environmental Services  
 CLIENT JOB NO.: RUNNELS 1020

DATE RECEIVED: 05/12/93  
 DATE REPORTED: 05/19/93  
 DATE SAMPLED: 05/11/93

ANALYSIS FOR CADMIUM, CHROMIUM, LEAD, ZINC & NICKEL  
 by EPA SW-846 Method 6010

LAB #	Sample Identification	Concentration (mg/kg)				
		Cadmium	Chromium	Lead	Zinc	Nickel
4	#4	ND	90	14	80	97
5	#5	ND	2400	85	200	1600

mg/kg - parts per million (ppm)

Method Detection Limit for Cadmium in Soil: 1 mg/kg

Method Detection Limit for Chromium in Soil: 5 mg/kg

Method Detection Limit for Lead in Soil: 5 mg/kg

Method Detection Limit for Zinc in Soil: 10 mg/kg

Method Detection Limit for Nickel in Soil: 10 mg/kg

QA/QC Summary: MS/MSD Recovery Range : 88%-99%  
 Duplicate RPD : < 2%

Rich

Nickel

$\frac{\Delta}{\text{Lab}}$

TTLIC = 2000 ppm

STLC = 20 ppm

Soluble test = 10-fold  
 dilution

UNDERGROUND STORAGE TANK REMOVAL/CLOSURE  
CHECKLIST AND FIELD REPORT

ADDRESS: 3590 ENTERPRISE AVENUE

FACILITY NAME: RUNNELS INDUSTRIES

NUMBER OF TANKS/CAPACITIES: 3; 2x 1,000-gal; 1x 500-gal

A. CLOSURE PLAN	YES	NO	COMMENTS
0. Date Received noted?	( <input checked="" type="checkbox"/> )	( )	
Permit Number noted?	( <input checked="" type="checkbox"/> )	( )	
Amount Paid correct?	( <input checked="" type="checkbox"/> )	( )	
1. Facility data complete?	( <input checked="" type="checkbox"/> )	( )	
2. Property Owner data complete?	( <input checked="" type="checkbox"/> )	( )	
3. Consultant data complete?	( )	( <input checked="" type="checkbox"/> )	n/a
4. Contractor data complete?	( <input checked="" type="checkbox"/> )	( )	
Contractor's License Type Suitable?	( <input checked="" type="checkbox"/> )	( )	
Contractor's License valid?	( <input checked="" type="checkbox"/> )	( )	
Haz-Substance Certification?	( <input checked="" type="checkbox"/> )	( )	
Hayward Business Lic. valid?	( <input checked="" type="checkbox"/> )	( )	
Workers' Comp. valid?	( <input checked="" type="checkbox"/> )	( )	
5. Project Manager identified?	( <input checked="" type="checkbox"/> )	( )	TOM REESE
6. Reason for closure given?	( <input checked="" type="checkbox"/> )	( )	
Proposed date for removal?			5/11/93 @ 12nn
Drawing attached?	( )	( )	
Attachment 4 completed?	( )	( <input checked="" type="checkbox"/> )	n/a
BAAQMD notified?	( <input checked="" type="checkbox"/> )	( <input checked="" type="checkbox"/> )	mail/fax #H. 5
Inerting method acceptable?	( <input checked="" type="checkbox"/> )	( )	
LEL equipment given?	( <input checked="" type="checkbox"/> )	( )	
7. Sampling protocol acceptable?	( )	( <input checked="" type="checkbox"/> )	2 samples for 1,000-gal tanks
Sampling map attached?	( )	( <input checked="" type="checkbox"/> )	
Pipings disposal acceptable?	( )	( <input checked="" type="checkbox"/> )	

	YES	NO	COMMENTS
Sampling summary complete?	( )	(X)	
Sampler identified?	(X)	( )	Tom Reese
Analytical Lab identified?	(X)	( )	Sequoia
Analytical Lab certified?	(X)	( )	
8. Tank hauler identified?	(X)	( )	DEWON
Tank T/DF identified?	(X)	( )	ERICKSON
Product/Rinsate hauler identified?	( )	(X)	
Product/Rinsate T/DF identified?	( )	( )	
Soil hauler identified?	( )	(X)	
Soil T/DF Identified?	( )	( )	
9. Certification signed?	( )	(X)	
Certification dated?	(X)	( )	
10. Are all pages initialed?	(X)	( )	
11. SWEEPS Forms complete?	(X)	( )	
12. Is Plan approved?	( )	(X)	
WHO REVIEWED THE PLAN?			duy

**B. NOTIFICATION**

1. Scheduled Removal Date: Tuesday, 5-11-93  
 Scheduled Removal Time: 1:00 p.m.

2. Notice Received (Date): Monday, 5-3-93  
 (Time): 9:40 a.m.  
 Notice Given By (Name): Tom Reese

**C. FIELD REPORT**

1. Time Arrived on Site: 1:00 p.m.  
 Contact Person on Site: Tom Reese

(SKETCH EXCAVATION SITE ON SEPARATE PAGE.)

2. Fire extinguisher adequate? (X) ( ) \_\_\_\_\_  
 No Smoking signs posted? (X) ( ) \_\_\_\_\_

YES NO

COMMENTS

9. Excavation backfilled?

( ) ( )

Describe backfilling: None

10. If not backfilled, describe safety precautions taken around excavation:

tape / barriers

11. Soil stockpile lined/covered?

YES NO  
( ) ( )

No - Set on concrete

12. Contact reminded about report due in 30 days?

() ( )

Yes

13. If leak is confirmed or suspected, was contact given "Underground Storage Tank Unauthorized Release (Leak) / Contamination Site Report"?

( ) ()

If yes, was the need for this form explained?

( ) ( )

14. Time tanks were hauled off-site: 3:00 pm

Time operation completed/called off: 3:30 pm

15. Other Comments:

Run Metals Cd Cr Pb Ni Zn (e)  
for samples under Tank #3 - MEK/

(used sandblast was used as backfill /  
curbs when tanks were installed)

5-11-93

Date of Removal

[Signature]

Hazardous Materials Investigator

TANK CLOSURE DIAGRAM

Note Following:

- Sketch area of excavation.
- Dimensions of excavation.
- Exact location of excavation. (i.e. Distances from building or other stationary features).
- Location of samples.
- If any damage to tank/pipes noted, sketch detailed location of pipes and fittings.

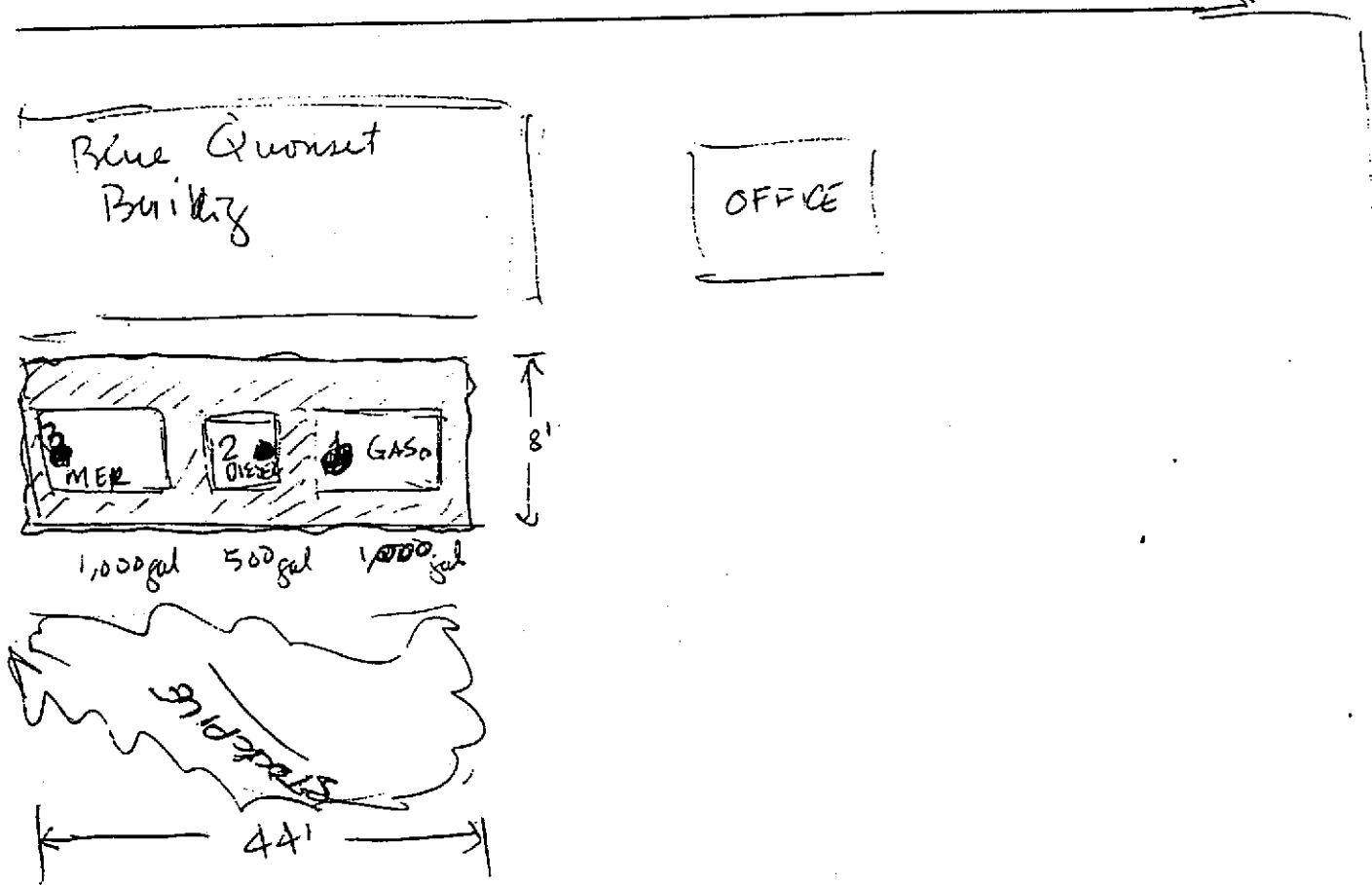

FACILITY NAME: \_\_\_\_\_

FACILITY ADDRESS \_\_\_\_\_