

FA-R-2002-11-22

PO 2448

CLEARWATER

GROUP

Environmental Services

FACSIMILE TRANSMITTAL

To: Scott Seery, ACHCSA

Fax No.: 510-337-9335

From: J. Rhea Farley • Clearwater Group

Date: Friday, November 22, 2002

Pages: 2 (Including Cover)

Re: EBS Jobs

Mr. Seery:

As per our conversation today, I am faxing you a copy of the Sunol Tree Gas site plan from the Preliminary Site Assessment workplan. However I have (roughly) sketched the gas and vapor return piping that interferes with the Proposed Soil Boring site between UST #3 and #4. For this document's purpose, I have arbitrarily labeled the Proposed Boring Sites 1-5, north to south. The boring site that is inhibited by a large number of piping lines is Site 4.

It is Mr. Pierskalla's hope that four remaining sample sites will be sufficient to assess the subsurface conditions. Please examine this, and if you require more information on the piping layout, please call him at 510-307-9943 ext. 229, or myself at ext. 239.

If there are further questions or comments, please contact me and let me know.

Clearwater Group
 Environmental Services
 J. Rhea Farley
 Geologist/GPS Specialist
 Telephone: (510) 307-9943 ext. 239
 Fax: (510) 232-2823
 E-mail: jrfarley@clearwatergroup.com

Please notify us if all pages are not received.

680N

Athenour Way

Andrade Road

T Rear Bench

Temp H2O Storage Tanks

Gravel Road

Temp H2O Storage Tanks

Stock Pile

Attendant & Kiosk

C.T.

Straw

Control Box

Equipment Release

UST-Approx 15,000 Gallons each

Key

Note: Map is not to scale

C1 - Construction Trailer

||| - Pump Island

⊙ - Proposed Soil Borings

--- - Fence/Property Line

Fuel & Vapor Return Piping

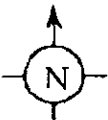

** Sketched in. R. Farley*

SITE PLAN

Sunol Tree Gas
3004 Andrade Road
Sunol, CA

CLEARWATER GROUP, INC.

Project No.
CB021C

Report Date
8/23/02

Figure
1.

PSA_R_2003-2-11

202448

CLEARWATER
 G R O U P
 Environmental Services

FACSIMILE TRANSMITTAL SHEET

TO: Scott Seery	FROM: Brian Pierskalla
COMPANY: ACHCSA	DATE: 2/11/2003
FAX NUMBER: 510-337-9335	TOTAL NO. OF PAGES INCLUDING COVER: 5
PHONE NUMBER: 510-567-6783	SENDER'S REFERENCE NUMBER: 510-307-9943 x 229
RE: Sunol Tree Gas Preliminary Site Assessment Analytical	YOUR REFERENCE NUMBER: CB021C

URGENT
 FOR REVIEW
 PLEASE COMMENT
 PLEASE REPLY
 PLEASE RECYCLE

NOTES/COMMENTS:

Dear Scott

Please see attached Preliminary Site Assessment Analytical and Figure showing approximate location of bore holes for the Sunol Tree Gas site on Andrade Road, Sunol. Please call me with any questions at (510) 307-9943 x 231.

Sincerely,



Brian Pierskalla

Project Manager

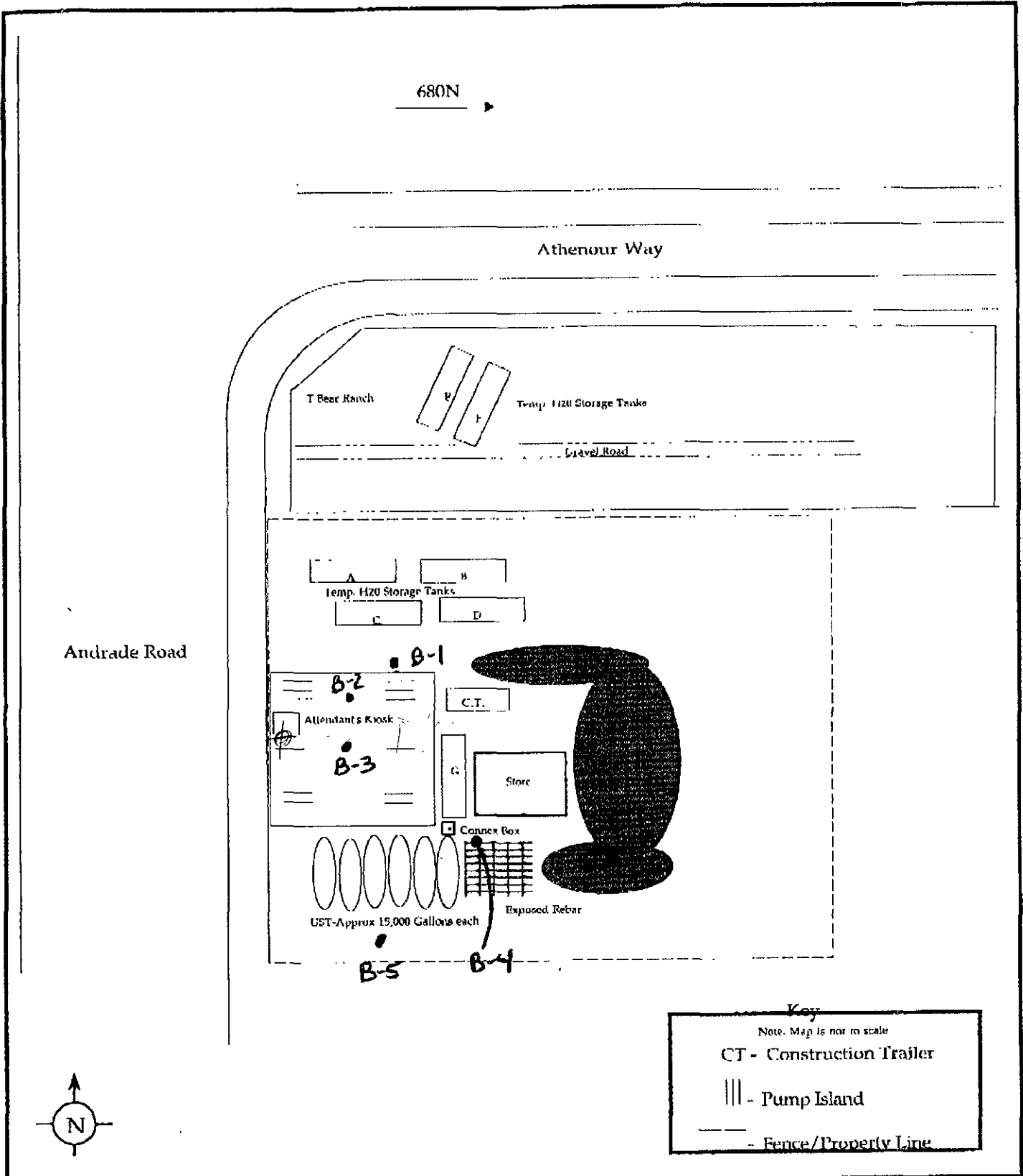

SITE PLAN

Sunol Tree Service
3004 Andrade Road
Sunol, CA

CLEARWATER GROUP, INC.

Project No.
CB021C

Report Date
8/23

Figure
1

Table 1
 Analytical Data - Soil
 Sunol Tree Gas
 3004 Andrade Rd., Sunol, CA
 Clearwater Project Number: CP032F

Sample I.D	Sample Date	B mg/kg	T mg/kg	E mg/kg	X mg/kg	MTBE mg/kg	DIPE mg/kg	ETBE mg/kg	TAME mg/kg	Tert-Butanol mg/kg	TPHg mg/kg	TPHd mg/kg	TPHm mg/kg
B-1-8	11/27/02	<0.0050	<0.0050	<0.0050	<0.0050	0.010	<0.0050	<0.0050	<0.0050	0.026	<1.0	<1.0	<10.0
B-1-12	11/27/02	<0.0050	<0.0050	<0.0050	<0.0050	0.0055	<0.0050	<0.0050	<0.0050	0.0081	<1.0	<1.0	<10.0
B-1-16	11/27/02	<0.0050	<0.0050	<0.0050	<0.0050	<0.0050	<0.0050	<0.0050	<0.0050	<0.0050	<1.0	<1.0	<10.0
B-1-20	11/27/02	<0.0050	<0.0050	<0.0050	<0.0050	<0.0050	<0.0050	<0.0050	<0.0050	<0.0050	<1.0	<1.0	<10.0
B-2-4	11/27/02	<0.0050	<0.0050	<0.0050	<0.0050	<0.0050	<0.0050	<0.0050	<0.0050	<0.0050	<1.0	<1.0	12.0
B-2-8	11/27/02	<0.0050	<0.0050	<0.0050	<0.0050	<0.0050	<0.0050	<0.0050	<0.0050	<0.0050	<1.0	<1.0	<10.0
B-2-12	11/27/02	<0.0050	<0.0050	<0.0050	<0.0050	<0.0050	<0.0050	<0.0050	<0.0050	<0.0050	<1.0	<1.0	<10.0
B-2-16	11/27/02	<0.0050	<0.0050	<0.0050	<0.0050	<0.0050	<0.0050	<0.0050	<0.0050	<0.0050	<1.0	1.90	<10.0
B-2-20	11/27/02	<0.0050	<0.0050	<0.0050	<0.0050	<0.0050	<0.0050	<0.0050	<0.0050	<0.0050	<1.0	2.30	<10.0
B-3-4	11/27/02	<0.0050	<0.0050	0.0095	0.021	<0.0050	<0.0050	<0.0050	<0.0050	<0.0050	18.0	59.0	19.0
B-3-8	11/27/02	<0.0050	<0.0050	<0.0050	<0.0050	<0.0050	<0.0050	<0.0050	<0.0050	<0.0050	<1.0	6.90	<10.0
B-3-12	11/27/02	<0.0250	0.034	1.30	9.50	1.20	<0.0250	<0.0250	<0.0250	1.0	250.0	50.0	<10.0
B-3-16	11/27/02	<0.0050	<0.0050	0.0093	0.28	0.12	<0.0050	<0.0050	<0.0050	0.12	1.30	16.0	<10.0
B-3-20	11/27/02	<0.0050	<0.0050	<0.0050	<0.0050	<0.0050	<0.0050	<0.0050	<0.0050	<0.0050	<1.0	<1.0	<10.0
B-4-4	11/27/02	<0.0050	<0.0050	<0.0050	<0.0050	<0.0050	<0.0050	<0.0050	<0.0050	<0.0050	<1.0	<1.0	15.0
B-4-8	11/27/02	<0.0050	<0.0050	<0.0050	<0.0050	<0.0050	<0.0050	<0.0050	<0.0050	<0.0050	<1.0	<1.0	<10.0
B-4-12	11/27/02	<0.0050	<0.0050	<0.0050	<0.0050	<0.0050	<0.0050	<0.0050	<0.0050	<0.0050	<1.0	<1.0	<10.0
B-4-16	11/27/02	<0.0050	<0.0050	<0.0050	<0.0050	0.0073	<0.0050	<0.0050	<0.0050	<0.0050	<1.0	<1.0	<10.0
B-4-20	11/27/02	<0.0050	<0.0050	<0.0050	<0.0050	<0.0050	<0.0050	<0.0050	<0.0050	<0.0050	<1.0	<1.0	<10.0
B-4-24	11/27/02	<0.0050	<0.0050	<0.0050	<0.0050	<0.0050	<0.0050	<0.0050	<0.0050	<0.0050	<1.0	<1.0	<10.0
B-5-4	11/27/02	<0.0050	<0.0050	<0.0050	<0.0050	<0.0050	<0.0050	<0.0050	<0.0050	<0.0050	<1.0	13.0	29.0
B-5-8	11/27/02	<0.0050	<0.0050	<0.0050	<0.0050	<0.0050	<0.0050	<0.0050	<0.0050	<0.0050	<1.0	<1.0	<10.0
B-5-12	11/27/02	<0.0050	<0.0050	<0.0050	<0.0050	<0.0050	<0.0050	<0.0050	<0.0050	<0.0050	<1.0	<1.0	<10.0
B-5-16	11/27/02	<0.0050	<0.0050	<0.0050	<0.0050	<0.0050	<0.0050	<0.0050	<0.0050	<0.0050	<1.0	<1.0	<10.0
B-5-20	11/27/02	<0.0050	<0.0050	<0.0050	<0.0050	<0.0050	<0.0050	<0.0050	<0.0050	<0.0050	<1.0	<1.0	<10.0

Table 2
Analytical Data -Water
Sunol Tree Gas
3004 Andrade Rd., Sunol, CA
Clearwater Project Number: CP032F

Sample I.D	Sample Date	B µg/L	T µg/L	E µg/L	X µg/L	MTBE µg/L	DIPE µg/L	ETBE µg/L	TAME µg/L	Tert-Butanol µg/L	TPHg µg/L	TPHd µg/L	TPHm µg/L
B-1-W	11/27/02	<0.50	<0.50	<0.50	<0.50	<0.50	<0.50	<0.50	<0.50	<5.0	260.0	<200.0	<100.0
B-2-W	11/27/02	<0.50	<0.50	<0.50	0.76	0.68	<0.50	<0.50	<0.50	<5.0	500.0	<200.0	180.0
B-3-W	11/27/02	1.10	<0.50	6.60	20.0	43.0	<0.50	<0.50	<0.50	<5.0	670.0	<300.0	<100.0
B-4-W	11/27/02	<2.50	<2.50	360	84.0	4.70	<2.50	<2.50	<2.50	<25.0	17000.0	<15000	<100.0
B-5-W	11/27/02	<0.50	<0.50	<0.50	<0.50	<0.50	<0.50	<0.50	<0.50	<5.0	<50.0	<50.0	<100.0

Notes:

B = Benzene
T = Toluene
E = Ethylbenzene
X = Total Xylenes
MTBE = Methyl-t-butyl
DIPE = Diisopropyl ether

ETBE = Ethyl-t-butyl ether
TAME = Tert-amyl methyl ether
TPHg = Total petroleum hydrocarbons as gasoline
TPHd = Total petroleum hydrocarbons as diesel
TPHm = Total petroleum hydrocarbons as motor oil
µg/L = Micrograms per liter

<### = Below reporting limits

Notes:

B = Benzene
T = Toluene
E = Ethylbenzene
X = Total Xylenes
MTBE = Methyl-t-butyl
DIPE = Diisopropyl ether

ETBE = Ethyl-t-butyl ether
TAME = Tert-amyl methyl ether
TPHg = Total petroleum hydrocarbons as gasoline
TPHd = Total petroleum hydrocarbons as diesel
TPHm = Total petroleum hydrocarbons as motor oil
mg/Kg = Milligrams per kilogram

<#.# = Below reporting limits