



GETTLER-RYAN INC.

✓ RD
2444

TRANSMITTAL

Alameda County

March 4, 2003

G-R #180299

MAR 24 2003

TO: Mr. David B. De Witt
ConocoPhillips
2000 Crow Canyon Place, Suite 400
San Ramon, California 94583

Environmental Health
CC: Mr. Forrest McFarland
Secor International, Inc.
2301 Leghorn Street
Mountain View, CA 94043

FROM: Deanna L. Harding
Project Coordinator
Gettler-Ryan Inc.
6747 Sierra Court, Suite J
Dublin, California 94568

RE: **Tosco (Unocal) Service Station
#7124
10151 East 14th Street
Oakland, California**

WE HAVE ENCLOSED THE FOLLOWING:

COPIES	DATED	DESCRIPTION
1	March 3, 2003	Groundwater Monitoring and Sampling Report First Quarter - Event of January 24, 2003

COMMENTS:

This report is being sent to you for your review/comment, prior to being distributed on your behalf. If no comments are received by **March 18, 2003**, this report will be distributed to the following:

cc: Ms. Eva Chu, Alameda County Health Care Services, 1131 Harbor Bay Parkway, Suite 250 Alameda, CA 94502

Enclosure



GETTLER-RYAN INC.

March 3, 2003
G-R Job #180299

Mr. David B. De Witt
ConocoPhillips
2000 Crow Canyon Place, Suite 400
San Ramon, California 94583

RE: First Quarter Event of January 24, 2003
Groundwater Monitoring & Sampling Report
Tosco (Unocal) Service Station #7124
10151 East 14th Street
Oakland, California

Dear Mr. De Witt:

This report documents the most recent groundwater monitoring and sampling event performed by Gettler-Ryan Inc. (G-R) at the referenced site. All field work was conducted in accordance with G-R Standard Operating Procedure - Groundwater Sampling (attached).

Static groundwater levels were measured and all wells were checked for the presence of separate-phase hydrocarbons. Separate-phase hydrocarbons were not present in the wells. Static water level data and groundwater elevations are summarized in Table 1. A Potentiometric Map is included as Figure 1.

Groundwater samples were collected from the monitoring wells and submitted to a state certified laboratory for analyses. The field data sheets for this event are attached. Analytical results are presented in the table(s) listed below. A Concentration Map is included as Figure 2. The chain of custody document and laboratory analytical report are also attached.

Sincerely,

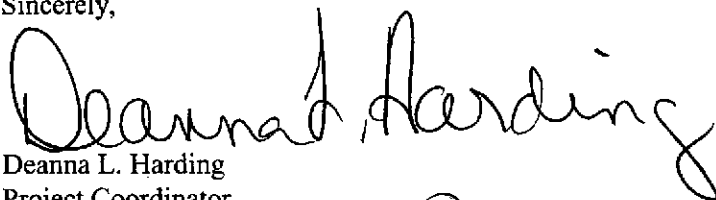
Deanna L. Harding
Project Coordinator

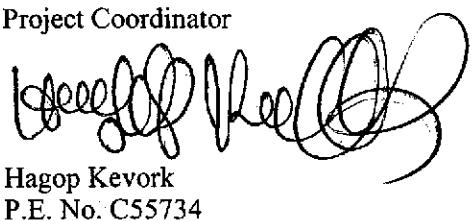
Hagop Kevork
P.E. No. C55734

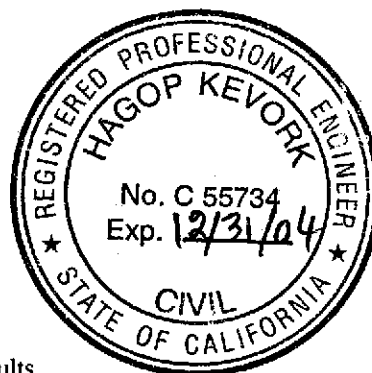
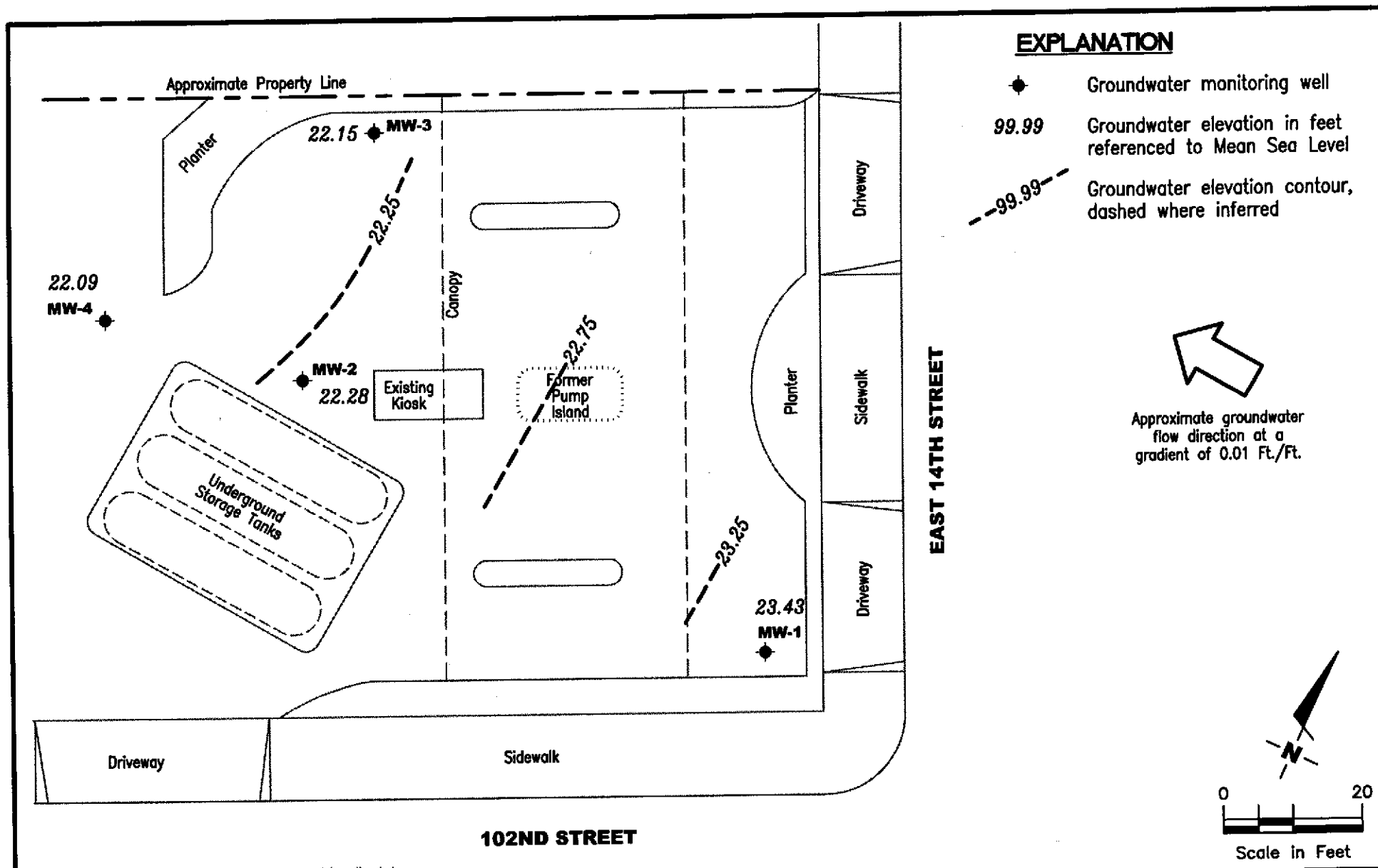

Figure 1: Potentiometric Map
Figure 2: Concentration Map
Table 1: Groundwater Monitoring Data and Analytical Results
Table 2: Groundwater Analytical Results
Attachments: Standard Operating Procedure - Groundwater Sampling
Field Data Sheets
Chain of Custody Document and Laboratory Analytical Reports

7124.qml



Source: Figure modified from drawing provided by Secor International, Inc.

GETTLER - RYAN INC.
 6747 Sierra Ct., Suite J
 Dublin, CA 94568 (925) 551-7555

POTENTIOMETRIC MAP
 Tosco (Unocal) Service Station #7124
 10151 East 14th Street
 Oakland, California

FIGURE

1

PROJECT NUMBER
 180299

REVIEWED BY

DATE
 January 24, 2003

REVISED DATE

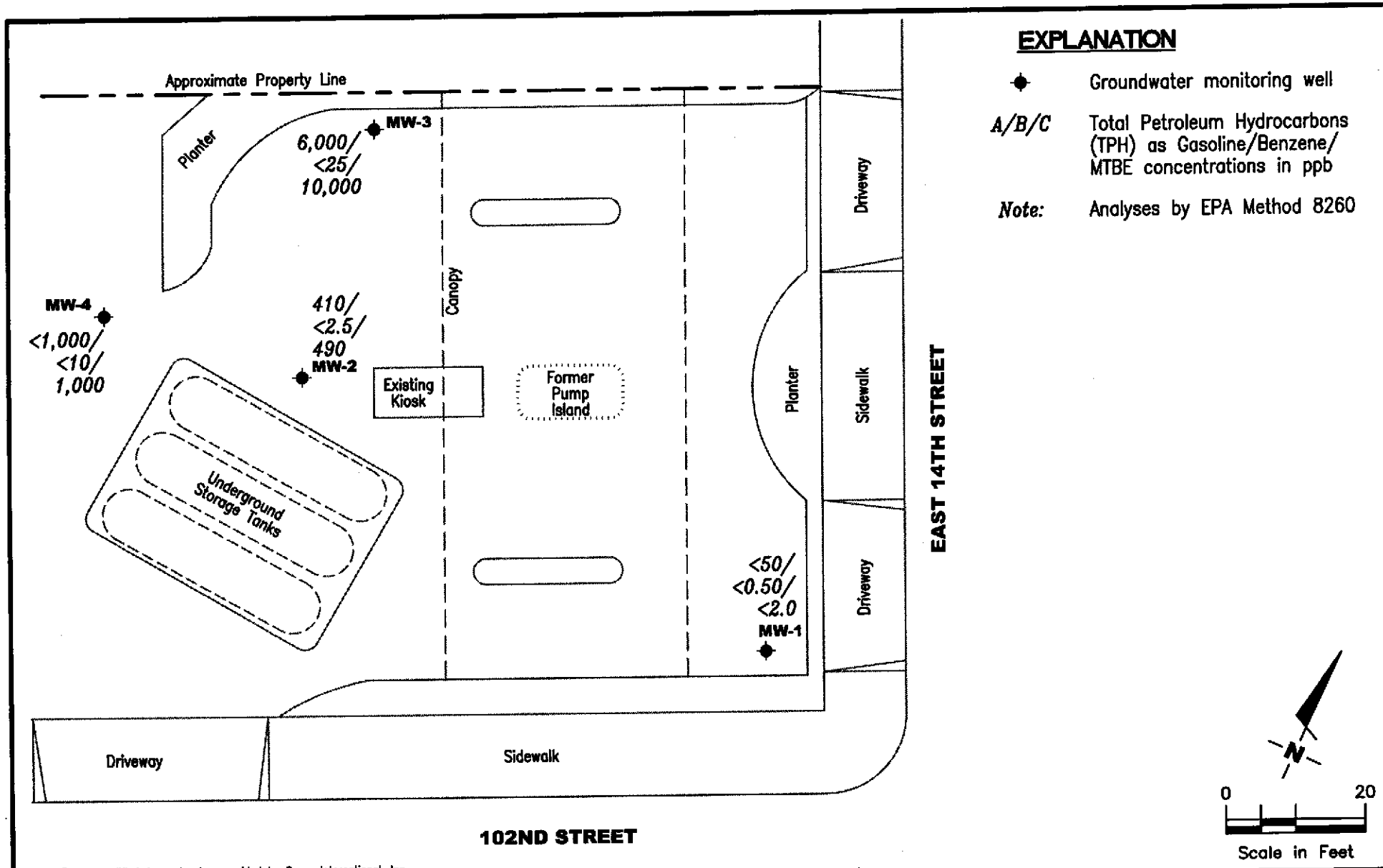

Source: Figure modified from drawing provided by Secor International, Inc.



GETTLER - RYAN INC.

6747 Sierra Ct., Suite J
Dublin, CA 94568 (925) 551-7555

CONCENTRATION MAP
Tosco (Unocal) Service Station #7124
10151 East 14th Street
Oakland, California

FIGURE

2

PROJECT NUMBER
180299

REVIEWED BY

DATE
January 24, 2003

REVISED DATE

Table 1
Groundwater Monitoring Data and Analytical Results
 Tosco (Unocal) Service Station #7124
 10151 East 14th Street
 Oakland, California

WELL ID/ TOC*(ft.)	DATE	DTW (ft.)	GWE (msl)	TPH-G (ppb)	B (ppb)	T (ppb)	E (ppb)	X (ppb)	MTBE (ppb)
MW-1 37.37	04/08/02 ¹	14.27	23.10	<50	<0.50	<0.50	<0.50	<0.50	<2.5/<2.0 ²
	07/28/02 ³	15.88	21.49	<50	<0.50	<0.50	<0.50	<1.0	<2.0
	11/03/02 ³	16.75	20.62	<50	<0.50	<0.50	<0.50	<1.0	<2.0
	01/24/03 ³	13.94	23.43	<50	<0.50	<0.50	<0.50	<1.0	<2.0
MW-2 37.87	04/08/02 ¹	15.86	22.01	4,400	<2.5	<2.5	6.4	<2.5	380/490 ²
	07/28/02 ³	17.28	20.59	3,200 ⁴	<2.5	<2.5	<2.5	<5.0	170
	11/03/02 ³	18.03	19.84	3,800 ⁴	<5.0	<5.0	<5.0	<10	72
	01/24/03 ³	15.59	22.28	410 ⁴	<2.5	<2.5	<2.5	<5.0	490
MW-3 37.72	04/08/02 ¹	15.86	21.86	8,700	65	<25	400	<25	6,500/8,300 ²
	07/28/02 ³	17.22	20.50	4,500 ⁴	<25	<25	<25	<50	1,100
	11/03/02 ³	17.90	19.82	25,000 ⁴	<5.0	<5.0	25	<10	470
	01/24/03 ³	15.57	22.15	6,000	<25	<25	94	<50	10,000
MW-4 38.36	04/08/02 ¹	16.59	21.77	13,000	<5.0	<5.0	28	<5.0	790/980 ²
	07/28/02 ³	17.93	20.43	18,000 ⁴	<2.5	<2.5	<2.5	<5.0	170
	11/03/02 ³	18.66	19.70	220 ⁴	<0.50	<0.50	<0.50	<1.0	5.7
	01/24/03 ³	16.27	22.09	<1,000	<10	<10	<10	<20	1,000

Table 1
Groundwater Monitoring Data and Analytical Results
 Tosco (Unocal) Service Station #7124
 10151 East 14th Street
 Oakland, California

WELL ID/ TOC*(ft.)	DATE	DTW (ft.)	GWE (msl)	TPH-G (ppb)	B (ppb)	T (ppb)	E (ppb)	X (ppb)	MTBE (ppb)
Trip Blank									
TB-LB	04/08/02	--	--	<50	<0.50	<0.50	<0.50	<0.50	<2.5
QA	07/28/02 ³	--	--	<50	<0.50	<0.50	<0.50	<1.0	<2.0
	11/03/02 ³	--	--	<50	<0.50	<0.50	<0.50	<1.0	<2.0
	01/24/03 ³	--	--	<50	<0.50	<0.50	<0.50	<1.0	<2.0

Table 1
Groundwater Monitoring Data and Analytical Results
Tosco (Unocal) Service Station #7124
10151 East 14th Street
Oakland, California

EXPLANATIONS:

TOC = Top of Casing

(ft.) = Feet

DTW = Depth to Water

GWE = Groundwater Elevation

(msl) = Mean sea level

TPH-G = Total Petroleum Hydrocarbons as Gasoline

B = Benzene

T = Toluene

E = Ethylbenzene

X = Xylenes

MTBE = Methyl tertiary butyl ether

(ppb) = Parts per billion

-- = Not Measured/Not Analyzed

QA = Quality Assurance/Trip Blank

* TOC elevations were surveyed on March 18, 2002, by Mid Coast Engineers. The benchmark used for the survey is HT0281, a benchmark disk in a concrete headwall on the east side of Railroad Avenue approximately 500 feet south of 85th Avenue (Benchmark Elevation = 11.50 feet NGVD 29).

¹ Well development performed.

² MTBE by EPA Method 8260.

³ TPH-G, BTEX and MTBE by EPA Method 8260.

⁴ Laboratory report indicates hydrocarbon pattern is present in the requested fuel quantitation range but does not resemble the pattern of the requested fuel.

Table 2
Groundwater Analytical Results - Oxygenate Compounds
 Tosco (Unocal) Service Station #7124
 10151 East 14th Street
 Oakland, California

WELL ID	DATE	ETHANOL (ppb)	TBA (ppb)	MTBE (ppb)	DIPE (ppb)	ETBE (ppb)	TAME (ppb)	1,2-DCA (ppb)	EDB (ppb)
MW-1	04/08/02	<500	<100	<2.0	<2.0	<2.0	<2.0	<2.0	<2.0
	07/28/02	<500	<100	<2.0	<2.0	<2.0	<2.0	<2.0	<2.0
	11/03/02	<500	<100	<2.0	<2.0	<2.0	<2.0	<2.0	<2.0
	01/24/03	<500	<100	<2.0	<2.0	<2.0	<2.0	<2.0	<2.0
MW-2	04/08/02	<10,000	<2,000	490	<40	<40	<40	<40	<40
	07/28/02	<2,500	<500	170	<10	<10	<10	<10	<10
	11/03/02	<5,000	<1,000	72	<20	<20	<20	<20	<20
	01/24/03	<2,500	<500	490	<10	<10	<10	<10	<10
MW-3	04/08/02	<250,000	<50,000	8,300	<1,000	<1,000	<1,000	<1,000	<1,000
	07/28/02	<25,000	<5,000	1,100	<100	<100	<100	<100	<100
	11/03/02	<5,000	<1,000	470	<20	<20	<20	<20	<20
	01/24/03	<25,000	<5,000	10,000	<100	<100	<100	<100	<100
MW-4	04/08/02	<25,000	<5,000	980	<100	<100	<100	<100	<100
	07/28/02	<2,500	<500	170	<10	<10	<10	<10	<10
	11/03/02	<500	<100	5.7	<2.0	<2.0	<2.0	<2.0	<2.0
	01/24/03	<10,000	<2,000	1,000	<40	<40	<40	<40	<40

Table 2
Groundwater Analytical Results - Oxygenate Compounds
Tosco (Unocal) Service Station #7124
10151 East 14th Street
Oakland, California

EXPLANATIONS:

TBA = Tertiary butyl alcohol
MTBE = Methyl tertiary butyl ether
DIPE = Di-isopropyl ether
ETBE = Ethyl tertiary butyl ether
TAME = Tertiary amyl methyl ether
1,2-DCA = 1,2-Dichloroethane
EDB = 1,2-Dibromoethane
(ppb) = Parts per billion

ANALYTICAL METHOD:

EPA Method 8260 for Oxygenate Compounds

STANDARD OPERATING PROCEDURE - GROUNDWATER SAMPLING

Gettler-Ryan Inc. field personnel adhere to the following procedures for the collection and handling of groundwater samples prior to analysis by the analytical laboratory. Prior to sample collection, the type of analysis to be performed is determined. Loss prevention of volatile compounds is controlled and sample preservation for subsequent analysis is maintained.

Prior to sampling, the presence or absence of free-phase hydrocarbons is determined using an interface probe. Product thickness, if present, is measured to the nearest 0.01 foot and is noted in the field notes. In addition, all depth to water level measurements are collected with a static water level indicator and are also recorded in the field notes, prior to purging and sampling any wells.

After water levels are collected and prior to sampling, temperature, pH and electrical conductivity are measured. If purging is to occur, each well is purged a minimum of three well casing volumes of water using pre-cleaned pumps (stack, suction, Grundfos), or disposable bailers. The measurements are taken a minimum of three times during the purging. Purging continues until these parameters stabilize.

Groundwater samples are collected using disposable bailers. The water samples are transferred from the bailer into appropriate containers. Pre-preserved containers, supplied by analytical laboratories, are used when possible. When pre-preserved containers are not available, the laboratory is instructed to preserve the sample as appropriate. Duplicate samples are collected for the laboratory to use in maintaining quality assurance/quality control standards. The samples are labeled to include the job number, sample identification, collection date and time, analysis, preservation (if any), and the sample collector's initials. The water samples are placed in a cooler, maintained at 4°C for transport to the laboratory. Once collected in the field, all samples are maintained under chain of custody until delivered to the laboratory.

The chain of custody document includes the job number, type of preservation, if any, analysis requested, sample identification, date and time collected, and the sample collector's name. The chain of custody is signed and dated (including time of transfer) by each person who receives or surrenders the samples, beginning with the field personnel and ending with the laboratory personnel.

A laboratory supplied trip blank accompanies each sampling set and is labeled as QA. For sampling sets greater than 20 samples, 5% trip blanks are included. The trip blank is analyzed for some or all of the same compounds as the groundwater samples.

As requested by Phillips 66 Company, the purge water and decontamination water generated during sampling activities is transported to Phillips 66 - San Francisco Refinery, located in Rodeo, California.



GETTLER-RYAN INC.

WELL MONITORING/SAMPLING FIELD DATA SHEET

Client/Facility #: Tosco #7124 Job Number: 180299
 Site Address: 10151 East 14th Avenue Event Date: 1/24/03 (inclusive)
 City: Oakland, CA Sampler: G.R.

Well ID: MW-1 Date Monitored: 1/24/03 Well Condition: OK
 Well Diameter: 4 in.
 Total Depth: 25.40 ft.
 Depth to Water: 13.74 ft.
 Volume Factor (VF) table:

3/4" = 0.02	1" = 0.04	2" = 0.17	3" = 0.38
4" = 0.66	5" = 1.02	6" = 1.50	12" = 5.80

 $11.46 \times VF \ 0.66 = 7.56 \times 3 \text{ (case volume)} = \text{Estimated Purge Volume: } 23 \text{ gal.}$

Purge Equipment:
 Disposable Bailer _____
 Stainless Steel Bailer _____
 Stack Pump _____
 Suction Pump _____
 Grundfos _____
 Other: _____

Sampling Equipment:
 Disposable Bailer _____
 Pressure Bailer _____
 Discrete Bailer _____
 Other: _____

Time Started: _____ (2400 hrs)
 Time Bailed: _____ (2400 hrs)
 Depth to Product: _____ ft
 Depth to Water: _____ ft
 Hydrocarbon Thickness: 0 ft
 Visual Confirmation/Description:
 Skimmer / Absorbent Sock (circle one)
 Amt Removed from Skimmer: _____ gal
 Amt Removed from Well: _____ gal
 Product Transferred to: _____

Start Time (purge): 0735 Weather Conditions: Clear
 Sample Time/Date: 0805 1/24/03 Water Color: Clear Odor: No
 Purging Flow Rate: 1.5 gpm. Sediment Description: _____
 Did well de-water? No If yes, Time: _____ Volume: _____ gal.

Time (2400 hr.)	Volume (gal.)	pH	Conductivity (u mhos/cm)	Temperature (°F)	D.O. (mg/L)	ORP (mV)
<u>0744</u>	<u>8</u>	<u>6.73</u>	<u>572</u>	<u>72.8</u>		
<u>0750</u>	<u>16</u>	<u>6.67</u>	<u>517</u>	<u>23.0</u>		
<u>0755</u>	<u>23</u>	<u>6.70</u>	<u>529</u>	<u>22.9</u>		

LABORATORY INFORMATION

SAMPLE ID	(#) CONTAINER	REFRIG.	PRESERV. TYPE	LABORATORY	ANALYSES
<u>MW-1</u>	<u>3 x voa vial</u>	<u>YES</u>	<u>HCL</u>	<u>STL Pleasanton</u>	<u>TPH-G/BTEX/MTBE/8 Oxy's(8260)</u>

COMMENTS: _____

Add/Replaced Lock: _____

Add/Replaced Plug: _____ Size: _____



GETTLER-RYAN INC.

WELL MONITORING/SAMPLING FIELD DATA SHEET

Client/Facility #: Tosco #7124 Job Number: 180299
 Site Address: 10151 East 14th Avenue Event Date: 1/24/03 (inclusive)
 City: Oakland, CA Sampler: G.R.

Well ID: MW-2 Date Monitored: 1/24/03 Well Condition: OK
 Well Diameter: 4 in.
 Total Depth: 25.46 ft.
 Depth to Water: 15.59 ft.
 $9.87 \times VF \ 0.66 = 6.51 \times 3 \text{ (case volume) = Estimated Purge Volume: } 20 \text{ gal.}$

Volume	3/4"= 0.02	1"= 0.04	2"= 0.17	3"= 0.38
Factor (VF)	4"= 0.66	5"= 1.02	6"= 1.50	12"= 5.80

Purge Equipment:
 Disposable Bailer _____
 Stainless Steel Bailer _____
 Stack Pump
 Suction Pump _____
 Grundfos _____
 Other: _____

Sampling Equipment:
 Disposable Bailer
 Pressure Bailer _____
 Discrete Bailer _____
 Other: _____

Time Started: _____ (2400 hrs)
 Time Bailed: _____ (2400 hrs)
 Depth to Product: _____ ft
 Depth to Water: _____ ft
 Hydrocarbon Thickness: 0 ft
 Visual Confirmation/Description: _____
 Skimmer / Absorbant Sock (circle one)
 Amt Removed from Skimmer: _____ gal
 Amt Removed from Well: _____ gal
 Product Transferred to: _____

Start Time (purge): 0850 Weather Conditions: Clean
 Sample Time/Date: 0920 1/23/03 Water Color: Clean Odor: NO
 Purging Flow Rate: ~1.5 gpm. Sediment Description: _____
 Did well de-water? No If yes, Time: _____ Volume: _____ gal.

Time (2400 hr.)	Volume (gal.)	pH	Conductivity (u mhos/cm)	Temperature (C/F)	D.O. (mg/L)	ORP (mV)
<u>0900</u>	<u>7</u>	<u>6.54</u>	<u>428</u>	<u>22.9</u>	_____	_____
<u>0905</u>	<u>14</u>	<u>6.45</u>	<u>417</u>	<u>23.0</u>	_____	_____
<u>0909</u>	<u>20</u>	<u>6.47</u>	<u>417</u>	<u>23.0</u>	_____	_____
_____	_____	_____	_____	_____	_____	_____

LABORATORY INFORMATION

SAMPLE ID	(#) CONTAINER	REFRIG.	PRESERV. TYPE	LABORATORY	ANALYSES
<u>MW-2</u>	<u>3 x vov vial</u>	<u>YES</u>	<u>HCL</u>	<u>STL Pleasanton</u>	<u>TPH-G/BTEX/MTBE/8 Oxy's(8260)</u>
_____	_____	_____	_____	_____	_____
_____	_____	_____	_____	_____	_____

COMMENTS: _____

Add/Replaced Lock: _____

Add/Replaced Plug: _____ Size: _____



GETTLER-RYAN INC.

WELL MONITORING/SAMPLING FIELD DATA SHEET

Client/Facility #: Tosco #7124 Job Number: 180299
 Site Address: 10151 East 14th Avenue Event Date: 1/24/03 (inclusive)
 City: Oakland, CA Sampler: G.R.

Well ID: MW-3 Date Monitored: 1/24/03 Well Condition: OK
 Well Diameter: 4 in.
 Total Depth: 25.38 ft.
 Depth to Water: 15.57 ft.
 $9.81 \times VF \ 0.66 = 6.47 \times 3 \text{ (case volume) = Estimated Purge Volume: } ~~19.5~~ \ 20 \text{ gal.}$

Volume	3/4"= 0.02	1"= 0.04	2"= 0.17	3"= 0.38
Factor (VF)	4"= 0.66	5"= 1.02	6"= 1.50	12"= 5.80

Purge Equipment:
 Disposable Bailer _____
 Stainless Steel Bailer _____
 Stack Pump ✓
 Suction Pump _____
 Grundfos _____
 Other: _____

Sampling Equipment:
 Disposable Bailer ✓
 Pressure Bailer _____
 Discrete Bailer _____
 Other: _____

Time Started: _____ (2400 hrs)
 Time Bailed: _____ (2400 hrs)
 Depth to Product: _____ ft
 Depth to Water: _____ ft
 Hydrocarbon Thickness: 0 ft
 Visual Confirmation/Description:
 Skimmer / Absorbant Sock (circle one)
 Amt Removed from Skimmer: _____ gal
 Amt Removed from Well: _____ gal
 Product Transferred to: _____

Start Time (purge): 0930 Weather Conditions: Clear
 Sample Time/Date: 0955T 1/24/03 Water Color: Clear Odor: Yes
 Purging Flow Rate: 2.6 gpm. Sediment Description: _____
 Did well de-water? NO If yes, Time: _____ Volume: _____ gal.

Time (2400 hr.)	Volume (gal.)	pH	Conductivity (u mhos/cm)	Temperature (C/F)	D.O. (mg/L)	ORP (mV)
<u>0938</u>	<u>7</u>	<u>6.44</u>	<u>430</u>	<u>23.0</u>	_____	_____
<u>0943</u>	<u>14</u>	<u>6.40</u>	<u>427</u>	<u>23.3</u>	_____	_____
<u>0947</u>	<u>22</u>	<u>6.41</u>	<u>425</u>	<u>23.2</u>	_____	_____
_____	_____	_____	_____	_____	_____	_____

LABORATORY INFORMATION

SAMPLE ID	(#) CONTAINER	REFRIG.	PRESERV. TYPE	LABORATORY	ANALYSES
<u>MW-3</u>	<u>3 x vov vial</u>	<u>YES</u>	<u>HCL</u>	<u>STL Pleasanton</u>	<u>TPH-G/BTEX/MTBE/8 Oxy's(8260)</u>
_____	_____	_____	_____	_____	_____
_____	_____	_____	_____	_____	_____

COMMENTS: _____

Add/Replaced Lock: _____ Add/Replaced Plug: _____ Size: _____



GETTLER - RYAN INC.

WELL MONITORING/SAMPLING FIELD DATA SHEET

Client/Facility #: Tosco #7124 Job Number: 180299
 Site Address: 10151 East 14th Avenue Event Date: 1/24/03 (inclusive)
 City: Oakland, CA Sampler: G.A.

Well ID: MW-4 Date Monitored: 1/24/03 Well Condition: OK

Well Diameter: 4 in.

Total Depth: 25.44 ft.

Depth to Water: 16.27 ft.

Volume	3/4"= 0.02	1"= 0.04	2"= 0.17	3"= 0.38
Factor (VF)	4"= 0.66	5"= 1.02	6"= 1.50	12"= 5.80

9.17 xVF 0.66 = 6.05 x3 (case volume) = Estimated Purge Volume: 18 gal.

Purge Equipment:

Disposable Bailer _____
 Stainless Steel Bailer _____
 Stack Pump ✓
 Suction Pump _____
 Grundfos _____
 Other: _____

Sampling Equipment:

Disposable Bailer ✓
 Pressure Bailer _____
 Discrete Bailer _____
 Other: _____

Time Started: _____ (2400 hrs)
 Time Bailed: _____ (2400 hrs)
 Depth to Product: _____ ft
 Depth to Water: _____ ft
 Hydrocarbon Thickness: 0 ft
 Visual Confirmation/Description: _____
 Skimmer / Absorbant Sock (circle one)
 Amt Removed from Skimmer: _____ gal
 Amt Removed from Well: _____ gal
 Product Transferred to: _____

Start Time (purge): 0813 Weather Conditions: Clear
 Sample Time/Date: 0840 1/24/03 Water Color: Clear Odor: yes
 Purging Flow Rate: ~1.5 gpm. Sediment Description: _____
 Did well de-water? No If yes, Time: _____ Volume: _____ gal.

Time (2400 hr.)	Volume (gal.)	pH	Conductivity (umhos/cm)	Temperature (C/F)	D.O. (mg/L)	ORP (mV)
<u>0822</u>	<u>6</u>	<u>6.61</u>	<u>456</u>	<u>22.6</u>	_____	_____
<u>0826</u>	<u>12</u>	<u>6.51</u>	<u>455</u>	<u>22.7</u>	_____	_____
<u>0830</u>	<u>18</u>	<u>6.54</u>	<u>447</u>	<u>22.8</u>	_____	_____
_____	_____	_____	_____	_____	_____	_____

LABORATORY INFORMATION

SAMPLE ID	(#) CONTAINER	REFRIG.	PRESERV. TYPE	LABORATORY	ANALYSES
<u>MW-4</u>	<u>3 x vov vial</u>	<u>YES</u>	<u>HCL</u>	<u>STL Pleasanton</u>	<u>TPH-G/BTEX/MTBE/8 Oxy's(8260)</u>
_____	_____	_____	_____	_____	_____
_____	_____	_____	_____	_____	_____

COMMENTS:

Add/Replaced Lock: _____

Add/Replaced Plug: _____ Size: _____

Gettler-Ryan Inc., Chain-of-Custody

Tosco Corp./
Phillips 66 Co.
2000 Crow Canyon Place
Suite 400
San Ramon, CA 94583

Facility Number 47124
Facility Address 10151 EAST 14TH STREET, OAKLAND, CA
Global ID _____ Project 180299.80
Client Contact MR. DAVID B. DEWITT
Phone (925) 277-2384

Laboratory Name STL - PLEASANTON, CA
Consultant GETTLER-RYAN, INC. DEANNA L. HARDING
Address 6747 SIERRA CT., SUITE J, DUBLIN CA 94568
Phone (925) 551-7555 Fax (925) 551-7899
Samples Collected by G. Rogers

SAMPLE ID	Number of Containers Matrix	S = Soil W = Water A = Air C = Charcoal	Sample Preservation	Date/Time (2400 Hrs)	TPH-GAS/BTEX/MTBE EPA 8015/8021B	TPH-DIESEL EPA 8015	TPH-DIESEL w/Silica gel EPA 8015	TPH-GAS EPA 8015	TPH-GAS/BTEX/MTBE EPA 8260	OXYGENATES EPA 8260	METHANOL EPA 8015	TOTAL OIL & GREASE EPA 5520	METALS Cd, Cr, Pb, Zn, Ni	NITRATE/SULFATE/ALKALINITY EPA 300 SERIES	HVOC'S (8010) EPA 8021B	VOC'S (8240) EPA 8260	SVOC'S EPA 8270	Remarks
QA	1	W	HCL	1/24/03					✓									
MW-1	3	W	HCL	0805					✓	✓								
MW-2	3	W	HCL	0920					✓	✓								
MW-3	3	W	HCL	0955					✓	✓								
MW-4	3	W	HCL	✓ 0840					✓	✓								

- OXYGENATES 8260**
- 1 - MTBE
 - 2 - TBA
 - 3 - TAME
 - 4 - DIPE
 - 5 - ETBE
 - 6 - 1,2-DCA
 - 7 - EDB
 - 8 - ETHANOL

Relinquished By (Signature) 	Organization <u>Gettler-Ryan</u>	Date/Time <u>1/24/03 1345</u>	Received By (Signature) 	Organization <u>STL - Pleasanton, CA</u>	Date/Time <u>1-24-03</u>	Iced Y/N <u>1610</u>
Relinquished By (Signature)	Organization	Date/Time	Received By (Signature)	Organization	Date/Time	Iced Y/N
Relinquished By (Signature)	Organization	Date/Time	Received For Laboratory By (Signature)	Organization	Date/Time	Iced Y/N

Turn Around Time (Circle Choice)

- 24 Hrs.
- 48 Hrs.
- 72 Hrs.
- 5 Days
- 10 Days
- As Contracted

Gettler Ryan

February 12, 2003

6747 Sierra Court Suite J
Dublin, CA 94568

Attn.: Deanna Harding

Project#: 180299.80

Project: Tosco #7124

Site: 10151 East 14th Street
Oakland, CA

Dear Ms. Harding,

Attached is our report for your samples received on 01/24/2003 16:10

This report has been reviewed and approved for release. Reproduction of this report is permitted only in its entirety.

Please note that any unused portion of the samples will be discarded after 03/10/2003 unless you have requested otherwise.

We appreciate the opportunity to be of service to you. If you have any questions, please call me at (925) 484-1919.

You can also contact me via email. My email address is: tgranicher@stl-inc.com

Sincerely,



Tod Granicher
Project Manager

Gas/BTEX Fuel Oxygenates by 8260B

Gettler Ryan

Attn.: Deanna Harding

6747 Sierra Court Suite J

Dublin, CA 94568

Phone: (925) 551-7444 Fax: (925) 551-7899

Project: 180299.80

Tosco #7124

Received: 01/24/2003 16:10

Site: 10151 East 14th Street
Oakland, CA**Samples Reported**

Sample Name	Date Sampled	Matrix	Lab #
QA	01/24/2003	Water	1
MW-1	01/24/2003 08:05	Water	2
MW-2	01/24/2003 09:20	Water	3
MW-3	01/24/2003 09:55	Water	4
MW-4	01/24/2003 08:40	Water	5

Severn Trent Laboratories, Inc.

STL San Francisco * 1220 Quarry Lane, Pleasanton, CA 94566

Tel 925 484 1919 Fax 925 484 1096 * www.stl-inc.com * CA DHS ELAP# 2496

02/07/2003 11:55

Page 1 of 11

Gas/BTEX Fuel Oxygenates by 8260B

Gettler Ryan

Attn.: Deanna Harding

6747 Sierra Court Suite J

Dublin, CA 94568

Phone: (925) 551-7444 Fax: (925) 551-7899

Project: 180299.80

Tosco #7124

Received: 01/24/2003 16:10

Site: 10151 East 14th Street
Oakland, CA

Prep(s):	5030B	Test(s):	8260FAB
Sample ID:	QA	Lab ID:	2003-01-0462 - 1
Sampled:	01/24/2003	Extracted:	2/3/2003 11:25
Matrix:	Water	QC Batch#:	2003/02/03-01.62

Compound	Conc.	RL	Unit	Dilution	Analyzed	Flag
Gasoline	ND	50	ug/L	1.00	02/03/2003 11:25	
Benzene	ND	0.50	ug/L	1.00	02/03/2003 11:25	
Toluene	ND	0.50	ug/L	1.00	02/03/2003 11:25	
Ethylbenzene	ND	0.50	ug/L	1.00	02/03/2003 11:25	
Total xylenes	ND	1.0	ug/L	1.00	02/03/2003 11:25	
Methyl tert-butyl ether (MTBE)	ND	2.0	ug/L	1.00	02/03/2003 11:25	
Surrogates(s)						
1,2-Dichloroethane-d4	105.7	76-114	%	1.00	02/03/2003 11:25	
Toluene-d8	95.3	88-110	%	1.00	02/03/2003 11:25	

Gas/BTEX Fuel Oxygenates by 8260B

Gettler Ryan

Attn.: Deanna Harding

6747 Sierra Court Suite J

Dublin, CA 94568

Phone: (925) 551-7444 Fax: (925) 551-7899

Project: 180299.80

Tosco #7124

Received: 01/24/2003 16:10

 Site: 10151 East 14th Street
Oakland, CA

Prep(s):	5030B	Test(s):	8260FAB
Sample ID:	MW-1	Lab ID:	2003-01-0462 - 2
Sampled:	01/24/2003 08:05	Extracted:	2/6/2003 13:41
Matrix:	Water	QC Batch#:	2003/02/06-01.27

Compound	Conc.	RL	Unit	Dilution	Analyzed	Flag
Gasoline	ND	50	ug/L	1.00	02/06/2003 13:41	
Benzene	ND	0.50	ug/L	1.00	02/06/2003 13:41	
Toluene	ND	0.50	ug/L	1.00	02/06/2003 13:41	
Ethylbenzene	ND	0.50	ug/L	1.00	02/06/2003 13:41	
Total xylenes	ND	1.0	ug/L	1.00	02/06/2003 13:41	
tert-Butyl alcohol (TBA)	ND	100	ug/L	1.00	02/06/2003 13:41	
Methyl tert-butyl ether (MTBE)	ND	2.0	ug/L	1.00	02/06/2003 13:41	
Di-isopropyl Ether (DIPE)	ND	2.0	ug/L	1.00	02/06/2003 13:41	
Ethyl tert-butyl ether (ETBE)	ND	2.0	ug/L	1.00	02/06/2003 13:41	
tert-Amyl methyl ether (TAME)	ND	2.0	ug/L	1.00	02/06/2003 13:41	
1,2-DCA	ND	2.0	ug/L	1.00	02/06/2003 13:41	
EDB	ND	2.0	ug/L	1.00	02/06/2003 13:41	
Ethanol	ND	500	ug/L	1.00	02/06/2003 13:41	
Surrogates(s)						
1,2-Dichloroethane-d4	107.2	76-114	%	1.00	02/06/2003 13:41	
Toluene-d8	96.6	88-110	%	1.00	02/06/2003 13:41	

Severn Trent Laboratories, Inc.

STL San Francisco * 1220 Quarry Lane, Pleasanton, CA 94566

Tel 925 484 1919 Fax 925 484 1096 * www.stl-inc.com * CA DHS ELAP# 2496

02/07/2003 11:55

Gas/BTEX Fuel Oxygenates by 8260B

 Gettler Ryan
 Attn.: Deanna Harding

 6747 Sierra Court Suite J
 Dublin, CA 94568
 Phone: (925) 551-7444 Fax: (925) 551-7899

 Project: 180299.80
 Tosco #7124

Received: 01/24/2003 16:10

 Site: 10151 East 14th Street
 Oakland, CA

Prep(s):	5030B	Test(s):	8260FAB
Sample ID:	MW-2	Lab ID:	2003-01-0462 - 3
Sampled:	01/24/2003 09:20	Extracted:	2/6/2003 14:03
Matrix:	Water	QC Batch#:	2003/02/06-01.27
Analysis Flag: 0 (See Legend and Note Section)			

Compound	Conc.	RL	Unit	Dilution	Analyzed	Flag
Gasoline	410	250	ug/L	5.00	02/06/2003 14:03	g
Benzene	ND	2.5	ug/L	5.00	02/06/2003 14:03	
Toluene	ND	2.5	ug/L	5.00	02/06/2003 14:03	
Ethylbenzene	ND	2.5	ug/L	5.00	02/06/2003 14:03	
Total xylenes	ND	5.0	ug/L	5.00	02/06/2003 14:03	
tert-Butyl alcohol (TBA)	ND	500	ug/L	5.00	02/06/2003 14:03	
Methyl tert-butyl ether (MTBE)	490	10	ug/L	5.00	02/06/2003 14:03	
Di-isopropyl Ether (DIPE)	ND	10	ug/L	5.00	02/06/2003 14:03	
Ethyl tert-butyl ether (ETBE)	ND	10	ug/L	5.00	02/06/2003 14:03	
tert-Amyl methyl ether (TAME)	ND	10	ug/L	5.00	02/06/2003 14:03	
1,2-DCA	ND	10	ug/L	5.00	02/06/2003 14:03	
EDB	ND	10	ug/L	5.00	02/06/2003 14:03	
Ethanol	ND	2500	ug/L	5.00	02/06/2003 14:03	
Surrogates(s)						
1,2-Dichloroethane-d4	109.7	76-114	%	5.00	02/06/2003 14:03	
Toluene-d8	96.7	88-110	%	5.00	02/06/2003 14:03	

Gas/BTEX Fuel Oxygenates by 8260B

Gettler Ryan

Attn.: Deanna Harding

6747 Sierra Court Suite J

Dublin, CA 94568

Phone: (925) 551-7444 Fax: (925) 551-7899

Project: 180299.80

Tosco #7124

Received: 01/24/2003 16:10

Site: 10151 East 14th Street
Oakland, CA

Prep(s):	5030B	Test(s):	8260FAB
Sample ID:	MW-3	Lab ID:	2003-01-0462 - 4
Sampled:	01/24/2003 09:55	Extracted:	2/6/2003 14:24
Matrix:	Water	QC Batch#:	2003/02/06-01.27
Analysis Flag: o (See Legend and Note Section)			

Compound	Conc.	RL	Unit	Dilution	Analyzed	Flag
Gasoline	6000	2500	ug/L	50.00	02/06/2003 14:24	
Benzene	ND	25	ug/L	50.00	02/06/2003 14:24	
Toluene	ND	25	ug/L	50.00	02/06/2003 14:24	
Ethylbenzene	94	25	ug/L	50.00	02/06/2003 14:24	
Total xylenes	ND	50	ug/L	50.00	02/06/2003 14:24	
tert-Butyl alcohol (TBA)	ND	5000	ug/L	50.00	02/06/2003 14:24	
Methyl tert-butyl ether (MTBE)	10000	100	ug/L	50.00	02/06/2003 14:24	
Di-isopropyl Ether (DIPE)	ND	100	ug/L	50.00	02/06/2003 14:24	
Ethyl tert-butyl ether (ETBE)	ND	100	ug/L	50.00	02/06/2003 14:24	
tert-Amyl methyl ether (TAME)	ND	100	ug/L	50.00	02/06/2003 14:24	
1,2-DCA	ND	100	ug/L	50.00	02/06/2003 14:24	
EDB	ND	100	ug/L	50.00	02/06/2003 14:24	
Ethanol	ND	25000	ug/L	50.00	02/06/2003 14:24	
Surrogates(s)						
1,2-Dichloroethane-d4	114.7	76-114	%	50.00	02/06/2003 14:24	sh
Toluene-d8	97.0	88-110	%	50.00	02/06/2003 14:24	

Gas/BTEX Fuel Oxygenates by 8260B

Gettler Ryan

Attn.: Deanna Harding

6747 Sierra Court Suite J

Dublin, CA 94568

Phone: (925) 551-7444 Fax: (925) 551-7899

Project: 180299.80

Tosco #7124

Received: 01/24/2003 16:10

Site: 10151 East 14th Street

Oakland, CA

Prep(s):	5030B	Test(s):	8260FAB
Sample ID:	MW-4	Lab ID:	2003-01-0462 - 5
Sampled:	01/24/2003 08:40	Extracted:	2/6/2003 14:46
Matrix:	Water	QC Batch#:	2003/02/06-01.27
Analysis Flag: o (See Legend and Note Section)			

Compound	Conc.	RL	Unit	Dilution	Analyzed	Flag
Gasoline	ND	1000	ug/L	20.00	02/06/2003 14:46	
Benzene	ND	10	ug/L	20.00	02/06/2003 14:46	
Toluene	ND	10	ug/L	20.00	02/06/2003 14:46	
Ethylbenzene	ND	10	ug/L	20.00	02/06/2003 14:46	
Total xylenes	ND	20	ug/L	20.00	02/06/2003 14:46	
tert-Butyl alcohol (TBA)	ND	2000	ug/L	20.00	02/06/2003 14:46	
Methyl tert-butyl ether (MTBE)	1000	40	ug/L	20.00	02/06/2003 14:46	
Di-isopropyl Ether (DIPE)	ND	40	ug/L	20.00	02/06/2003 14:46	
Ethyl tert-butyl ether (ETBE)	ND	40	ug/L	20.00	02/06/2003 14:46	
tert-Amyl methyl ether (TAME)	ND	40	ug/L	20.00	02/06/2003 14:46	
1,2-DCA	ND	40	ug/L	20.00	02/06/2003 14:46	
EDB	ND	40	ug/L	20.00	02/06/2003 14:46	
Ethanol	ND	10000	ug/L	20.00	02/06/2003 14:46	
Surrogates(s)						
1,2-Dichloroethane-d4	109.4	76-114	%	20.00	02/06/2003 14:46	
Toluene-d8	99.2	88-110	%	20.00	02/06/2003 14:46	

Gas/BTEX Fuel Oxygenates by 8260B

Gettler Ryan

Attn.: Deanna Harding

6747 Sierra Court Suite J
Dublin, CA 94568
Phone: (925) 551-7444 Fax: (925) 551-7899

Project: 180299.80
Tosco #7124

Received: 01/24/2003 16:10

Site: 10151 East 14th Street
Oakland, CA

Batch QC Report		
Prep(s): 5030B	Water	Test(s): 8260FAB
Method Blank		QC Batch # 2003/02/03-01.62
MB: 2003/02/03-01.62-003		Date Extracted: 02/03/2003 11:03

Compound	Conc.	RL	Unit	Analyzed	Flag
Gasoline	ND	50	ug/L	02/03/2003 11:03	
Benzene	ND	0.5	ug/L	02/03/2003 11:03	
Toluene	ND	0.5	ug/L	02/03/2003 11:03	
Ethylbenzene	ND	0.5	ug/L	02/03/2003 11:03	
Total xylenes	ND	1.0	ug/L	02/03/2003 11:03	
tert-Butyl alcohol (TBA)	ND	100	ug/L	02/03/2003 11:03	
Methyl tert-butyl ether (MTBE)	ND	1.0	ug/L	02/03/2003 11:03	
Di-isopropyl Ether (DIPE)	ND	2.0	ug/L	02/03/2003 11:03	
Ethyl tert-butyl ether (ETBE)	ND	2.0	ug/L	02/03/2003 11:03	
tert-Amyl methyl ether (TAME)	ND	2.0	ug/L	02/03/2003 11:03	
1,2-DCA	ND	2.0	ug/L	02/03/2003 11:03	
EDB	ND	2.0	ug/L	02/03/2003 11:03	
Ethanol	ND	500	ug/L	02/03/2003 11:03	
Surrogates(s)					
1,2-Dichloroethane-d4	106.5	76-114	%	02/03/2003 11:03	
Toluene-d8	95.0	88-110	%	02/03/2003 11:03	

Gas/BTEX Fuel Oxygenates by 8260B

Gettler Ryan
Attn.: Deanna Harding

6747 Sierra Court Suite J
Dublin, CA 94568
Phone: (925) 551-7444 Fax: (925) 551-7899

Project: 180299.80
Tosco #7124

Received: 01/24/2003 16:10

Site: 10151 East 14th Street
Oakland, CA

Batch QC Report			
Prep(s): 5030B			Test(s): 8260FAB
Method Blank	Water		QC Batch # 2003/02/06-01.27
MB: 2003/02/06-01.27-005			Date Extracted: 02/06/2003 10:59

Compound	Conc.	RL	Unit	Analyzed	Flag
Gasoline	ND	50	ug/L	02/06/2003 10:59	
Benzene	ND	0.5	ug/L	02/06/2003 10:59	
Toluene	ND	0.5	ug/L	02/06/2003 10:59	
Ethylbenzene	ND	0.5	ug/L	02/06/2003 10:59	
Total xylenes	ND	1.0	ug/L	02/06/2003 10:59	
tert-Butyl alcohol (TBA)	ND	100	ug/L	02/06/2003 10:59	
Methyl tert-butyl ether (MTBE)	ND	2.0	ug/L	02/06/2003 10:59	
Di-isopropyl Ether (DIPE)	ND	2.0	ug/L	02/06/2003 10:59	
Ethyl tert-butyl ether (ETBE)	ND	2.0	ug/L	02/06/2003 10:59	
tert-Amyl methyl ether (TAME)	ND	2.0	ug/L	02/06/2003 10:59	
1,2-DCA	ND	2.0	ug/L	02/06/2003 10:59	
EDB	ND	2.0	ug/L	02/06/2003 10:59	
Ethanol	ND	500	ug/L	02/06/2003 10:59	
Surrogates(s)					
1,2-Dichloroethane-d4	104.9	76-114	%	02/06/2003 10:59	
Toluene-d8	94.6	88-110	%	02/06/2003 10:59	

Gas/BTEX Fuel Oxygenates by 8260B

Gettler Ryan

Attn.: Deanna Harding

6747 Sierra Court Suite J
Dublin, CA 94568
Phone: (925) 551-7444 Fax: (925) 551-7899

Project: 180299.80
Tosco #7124

Received: 01/24/2003 16:10

Site: 10151 East 14th Street
Oakland, CA

Batch QC Report

Prep(s): 5030B

Test(s): 8260FAB

Laboratory Control Spike

Water

QC Batch # 2003/02/03-01.62

LCS 2003/02/03-01.62-018

Extracted: 02/03/2003

Analyzed: 02/03/2003 10:18

LCSD 2003/02/03-01.62-041

Extracted: 02/03/2003

Analyzed: 02/03/2003 10:41

Compound	Conc. ug/L		Exp.Conc.	Recovery		RPD	Ctrl.Limits %		Flags	
	LCS	LCSD		LCS	LCSD		%	Rec.	RPD	LCS
Benzene	21.8	22.3	25.0	87.2	89.2	2.3	69-129	20		
Toluene	21.8	22.8	25.0	87.2	91.2	4.5	70-130	20		
Methyl tert-butyl ether (MTBE)	21.1	21.1	25.0	84.4	84.4	0.0	65-165	20		
Surrogates(s)										
1,2-Dichloroethane-d4	543	544	500	108.6	108.8		76-114			
Toluene-d8	484	483	500	96.8	96.6		88-110			

Gas/BTEX Fuel Oxygenates by 8260B

Gettler Ryan

Attn.: Deanna Harding

6747 Sierra Court Suite J

Dublin, CA 94568

Phone: (925) 551-7444 Fax: (925) 551-7899

Project: 180299.80

Tosco #7124

Received: 01/24/2003 16:10

Site: 10151 East 14th Street
Oakland, CA

Batch QC Report										
Prep(s): 5030B						Test(s): 8260FAB				
Laboratory Control Spike			Water			QC Batch # 2003/02/06-01.27				
LCS	2003/02/06-01.27-003		Extracted: 02/06/2003			Analyzed: 02/06/2003 10:08				
LCSD	2003/02/06-01.27-004		Extracted: 02/06/2003			Analyzed: 02/06/2003 10:37				
Compound	Conc. ug/L		Exp.Conc.	Recovery		RPD	Ctrl.Limits %		Flags	
	LCS	LCSD		LCS	LCSD		Rec.	RPD	LCS	LCSD
Benzene	20.6	20.3	25.0	82.4	81.2	1.5	69-129	20		
Toluene	22.0	22.0	25.0	88.0	88.0	0.0	70-130	20		
Methyl tert-butyl ether (MTBE)	24.3	24.7	25.0	97.2	98.8	1.6	65-165	20		
<i>Surrogates(s)</i>										
1,2-Dichloroethane-d4	514	525	500	102.8	105.0		76-114			
Toluene-d8	501	482	500	100.2	96.4		88-110			

Gas/BTEX Fuel Oxygenates by 8260B

Gettler Ryan
Attn.: Deanna Harding

6747 Sierra Court Suite J
Dublin, CA 94568
Phone: (925) 551-7444 Fax: (925) 551-7899

Project: 180299.80
Tosco #7124

Received: 01/24/2003 16:10

Site: 10151 East 14th Street
Oakland, CA

Legend and Notes

Analysis Flag

o

Reporting limits were raised due to high level of analyte present in the sample.

Result Flag

g

Hydrocarbon reported in the gasoline range does not match our gasoline standard.

sh

Surrogate recovery was higher than QC limit due to matrix interference.