

Ro-2444



# GETTLER-RYAN INC.

## TRANSMITTAL

Alameda County

OCT 11 2002

September 23, 2002

G-R #180299

### Environmental Health

TO: Mr. David B. De Witt  
Phillips 66 Company  
2000 Crow Canyon Place, Suite 400  
San Ramon, California 94583

CC: Mr. Forrest McFarland  
Secor International, Inc.  
2301 Leghorn Street  
Mountain View, CA 94043

FROM: Deanna L. Harding  
Project Coordinator  
Gettler-Ryan Inc.  
6747 Sierra Court, Suite J  
Dublin, California 94568

RE: Tosco (Unocal) Service Station  
#7124  
10151 East 14<sup>th</sup> Street  
Oakland, California

WE HAVE ENCLOSED THE FOLLOWING:

COPIES	DATED	DESCRIPTION
1	September 9, 2002	Groundwater Monitoring and Sampling Report Third Quarter - Event of July 28, 2002

### COMMENTS:

This report is being sent to you for your review/comment, prior to being distributed on your behalf. If no comments are received by **October 7, 2002**, this report will be distributed to the following:

cc: Ms. Eva Chu, Alameda County Health Care Services, 1131 Harbor Bay Parkway, Suite 250 Alameda, CA 94502

Enclosure



# GETTLER-RYAN INC.

September 9, 2002  
G-R Job #180299

Mr. David B. De Witt  
Phillips 66 Company  
2000 Crow Canyon Place, Suite 400  
San Ramon, California 94583

**RE: Third Quarter Event of July 28, 2002**  
Groundwater Monitoring & Sampling Report  
Tosco (Unocal) Service Station #7124  
10151 East 14<sup>th</sup> Street  
Oakland, California

Dear Mr. De Witt:

This report documents the most recent groundwater monitoring and sampling event performed by Gettler-Ryan Inc. (G-R) at the referenced site. All field work was conducted in accordance with G-R Standard Operating Procedure - Groundwater Sampling (attached).

Static groundwater levels were measured and all wells were checked for the presence of separate-phase hydrocarbons. Separate-phase hydrocarbons were not present in the wells. Static water level data and groundwater elevations are summarized in Table 1. A Potentiometric Map is included as Figure 1.

Groundwater samples were collected from the monitoring wells and submitted to a state certified laboratory for analyses. The field data sheets for this event are attached. Analytical results are presented in the table(s) listed below. A Concentration Map is included as Figure 2. The chain of custody document and laboratory analytical report are also attached.

Sincerely,

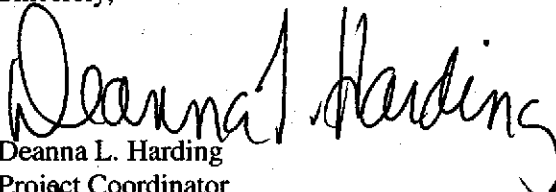
  
Deanna L. Harding  
Project Coordinator

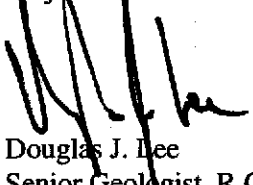
  
Douglas J. Lee  
Senior Geologist, R.G. No. 6882

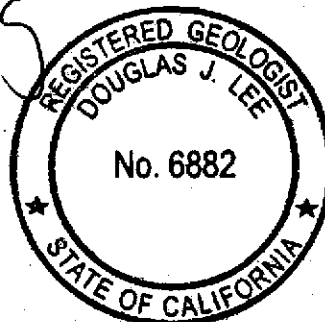
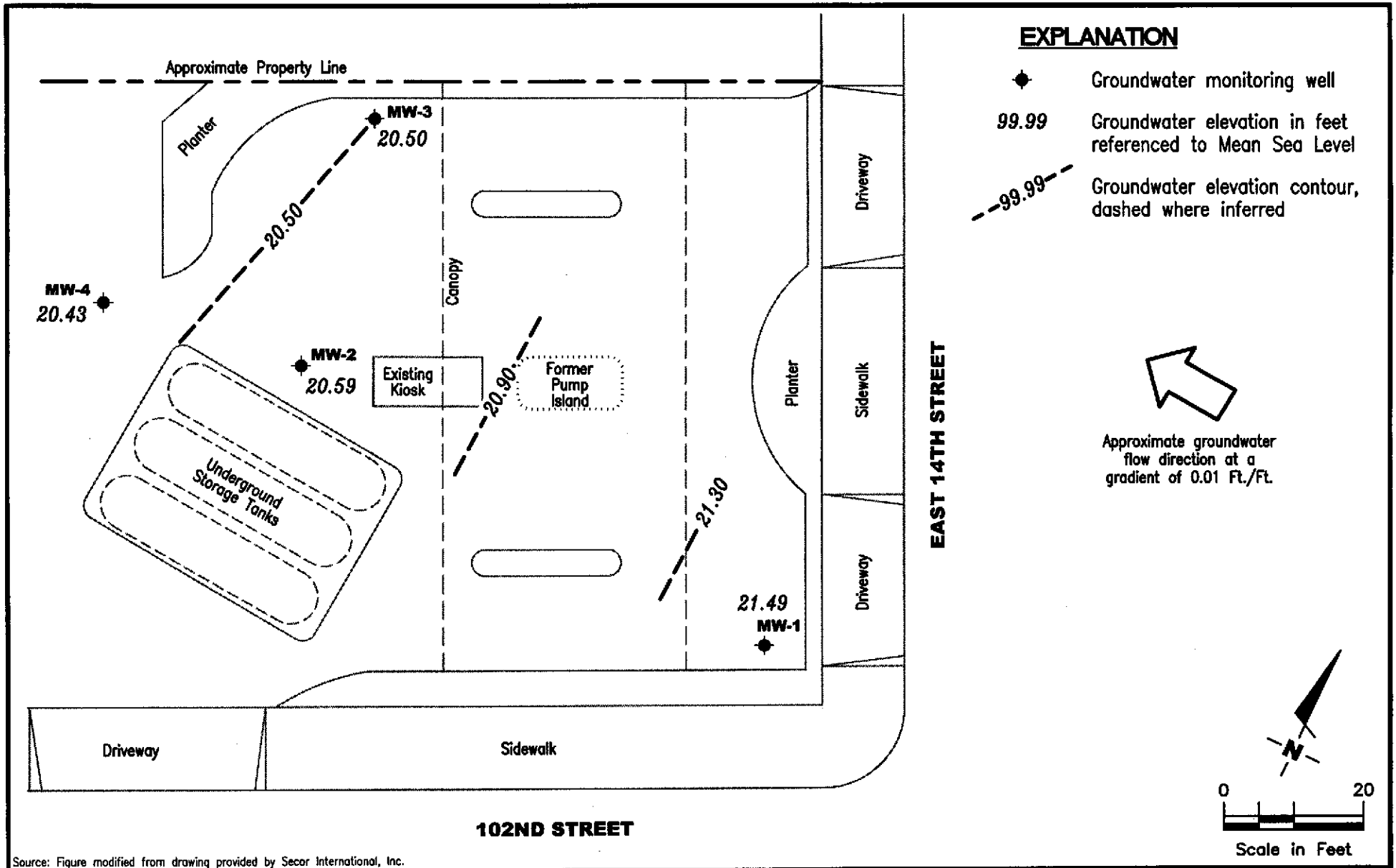

Figure 1: Potentiometric Map  
Figure 2: Concentration Map  
Table 1: Groundwater Monitoring Data and Analytical Results  
Table 2: Groundwater Analytical Results  
Attachments: Standard Operating Procedure - Groundwater Sampling  
Field Data Sheets  
Chain of Custody Document and Laboratory Analytical Reports

7124.qml



Source: Figure modified from drawing provided by Secor International, Inc.

**GETTLER - RYAN INC.**  
 6747 Sierra Ct., Suite J  
 Dublin, CA 94568 (925) 551-7555

**POTENTIOMETRIC MAP**  
 Tosco (Unocal) Service Station #7124  
 10151 East 14th Street  
 Oakland, California

FIGURE  
**1**

PROJECT NUMBER  
 180299

REVIEWED BY

DATE  
 July 28, 2002

REVISED DATE

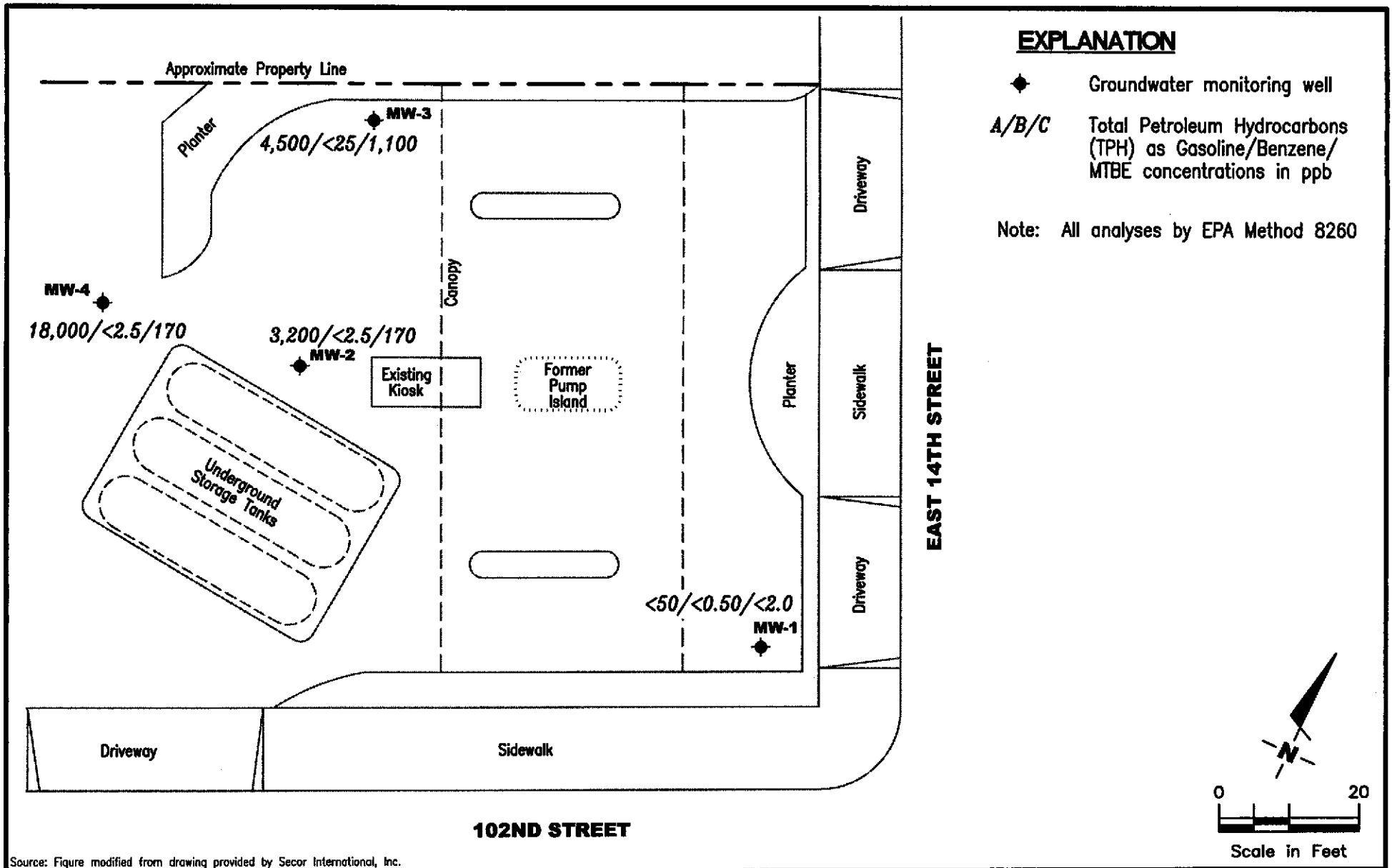

Source: Figure modified from drawing provided by Secor International, Inc.

**GETTLER - RYAN INC.**  
 6747 Sierra Ct., Suite J  
 Dublin, CA 94568 (925) 551-7555

PROJECT NUMBER  
 180299

REVIEWED BY

DATE  
 July 28, 2002

REVISED DATE

FILE NAME: P:\ENVIRO\TOSCO\7124\Q02-7124.DWG | Layout Tab: Con3

FIGURE

2

**Table 1**  
**Groundwater Monitoring Data and Analytical Results**  
 Tosco (Unocal) Service Station #7124  
 10151 East 14th Street  
 Oakland, California

WELL ID/ TOC* (ft.)	DATE	DTW (ft.)	GWE (mst)	TPH-G (ppb)	B (ppb)	T (ppb)	E (ppb)	X (ppb)	MTBE (ppb)
<b>MW-1</b>									
37.37	04/08/02 <sup>1</sup>	14.27	23.10	<50	<0.50	<0.50	<0.50	<0.50	<2.5/<2.0 <sup>2</sup>
	07/28/02 <sup>3</sup>	15.88	21.49	<50	<0.50	<0.50	<0.50	<1.0	<2.0
<b>MW-2</b>									
37.87	04/08/02 <sup>1</sup>	15.86	22.01	4,400	<2.5	<2.5	6.4	<2.5	380/490 <sup>2</sup>
	07/28/02 <sup>3</sup>	17.28	20.59	3,200 <sup>4</sup>	<2.5	<2.5	<2.5	<5.0	170
<b>MW-3</b>									
37.72	04/08/02 <sup>1</sup>	15.86	21.86	8,700	65	<25	400	<25	6,500/8,300 <sup>2</sup>
	07/28/02 <sup>3</sup>	17.22	20.50	4,500 <sup>4</sup>	<25	<25	<25	<50	1,100
<b>MW-4</b>									
38.36	04/08/01 <sup>1</sup>	16.59	21.77	13,000	<5.0	<5.0	28	<5.0	790/980 <sup>2</sup>
	07/28/02 <sup>3</sup>	17.93	20.43	18,000 <sup>4</sup>	<2.5	<2.5	<2.5	<5.0	170
<b>Trip Blank</b>									
TB-LB	04/08/02	--	--	<50	<0.50	<0.50	<0.50	<0.50	<2.5
QA	07/28/02 <sup>3</sup>	--	--	<50	<0.50	<0.50	<0.50	<1.0	<2.0

**Table 1**  
**Groundwater Monitoring Data and Analytical Results**  
Tosco (Unocal) Service Station #7124  
10151 East 14th Street  
Oakland, California

---

**EXPLANATIONS:**

TOC = Top of Casing

(ft.) = Feet

DTW = Depth to Water

GWE = Groundwater Elevation

(msl) = Mean sea level

TPH-G = Total Petroleum Hydrocarbons as Gasoline

B = Benzene

T = Toluene

E = Ethylbenzene

X = Xylenes

MTBE = Methyl tertiary butyl ether

(ppb) = Parts per billion

-- = Not Measured/Not Analyzed

QA = Quality Assurance

\* TOC elevations were surveyed on March 18, 2002, by Mid Coast Engineers. The benchmark used for the survey is HT0281, a benchmark disk in a concrete headwall on the east side of Railroad Avenue approximately 500 feet south of 85th Avenue (Benchmark Elevation = 11.50 feet NGVD 29).

<sup>1</sup> Well development performed.

<sup>2</sup> MTBE by EPA Method 8260.

<sup>3</sup> TPH-G, BTEX and MTBE by EPA Method 8260.

<sup>4</sup> Laboratory report indicates hydrocarbon pattern is present in the requested fuel quantitation range but does not resemble the pattern of the requested fuel.

**Table 2**  
**Groundwater Analytical Results - Oxygenate Compounds**  
 Tosco (Unocal) Service Station #7124  
 10151 East 14th Street  
 Oakland, California

WELL ID	DATE	ETHANOL (ppb)	TBA (ppb)	MTBE (ppb)	DIPE (ppb)	ETBE (ppb)	TAME (ppb)	1,2-DCA (ppb)	EDB (ppb)
MW-1	04/08/02	<500	<100	<2.0	<2.0	<2.0	<2.0	<2.0	<2.0
	07/28/02	<500	<100	<2.0	<2.0	<2.0	<2.0	<2.0	<2.0
MW-2	04/08/02	<10,000	<2,000	490	<40	<40	<40	<40	<40
	07/28/02	<2,500	<500	170	<10	<10	<10	<10	<10
MW-3	04/08/02	<250,000	<50,000	8,300	<1,000	<1,000	<1,000	<1,000	<1,000
	07/28/02	<25,000	<5,000	1,100	<100	<100	<100	<100	<100
MW-4	04/08/02	<25,000	<5,000	980	<100	<100	<100	<100	<100
	07/28/02	<2,500	<500	170	<10	<10	<10	<10	<11

**EXPLANATIONS:**

TBA = Tertiary butyl alcohol  
 MTBE = Methyl tertiary butyl ether  
 DIPE = Di-isopropyl ether  
 ETBE = Ethyl tertiary butyl ether  
 TAME = Tertiary amyl methyl ether  
 1,2-DCA = 1,2-Dichloroethane  
 EDB = 1,2-Dibromoethane  
 (ppb) = Parts per billion

**ANALYTICAL METHOD:**

EPA Method 8260 for Oxygenate Compounds

## STANDARD OPERATING PROCEDURE - GROUNDWATER SAMPLING

Gettler-Ryan Inc. field personnel adhere to the following procedures for the collection and handling of groundwater samples prior to analysis by the analytical laboratory. Prior to sample collection, the type of analysis to be performed is determined. Loss prevention of volatile compounds is controlled and sample preservation for subsequent analysis is maintained.

Prior to sampling, the presence or absence of free-phase hydrocarbons is determined using an interface probe. Product thickness, if present, is measured to the nearest 0.01 foot and is noted in the field notes. In addition, static water level measurements are collected with the interface probe and are also recorded in the field notes.

After water levels are collected and prior to sampling, temperature, pH and electrical conductivity are measured. If purging is to occur, each well is purged a minimum of three well casing volumes of water using pre-cleaned pumps (stack, suction, Grundfos), or polyvinyl chloride bailers. The measurements are taken a minimum of three times during the purging. Purging continues until these parameters stabilize.

Groundwater samples are collected using disposable bailers. The water samples are transferred from the bailer into appropriate containers. Pre-preserved containers, supplied by analytical laboratories, are used when possible. When pre-preserved containers are not available, the laboratory is instructed to preserve the sample as appropriate. Duplicate samples are collected for the laboratory to use in maintaining quality assurance/quality control standards. The samples are labeled to include the job number, sample identification, collection date and time, analysis, preservation (if any), and the sample collector's initials. The water samples are placed in a cooler, maintained at 4°C for transport to the laboratory. Once collected in the field, all samples are maintained under chain of custody until delivered to the laboratory.

The chain of custody document includes the job number, type of preservation, if any, analysis requested, sample identification, date and time collected, and the sample collector's name. The chain of custody is signed and dated (including time of transfer) by each person who receives or surrenders the samples, beginning with the field personnel and ending with the laboratory personnel.

A laboratory supplied trip blank accompanies each sampling set. For sampling sets greater than 20 samples, 5% trip blanks are included. The trip blank is analyzed for some or all of the same compounds as the groundwater samples.

As requested by Phillips 66 Company, the purge water and decontamination water generated during sampling activities is transported to Phillips 66 - San Francisco Refinery, located in Rodeo, California.





# GETTLER-RYAN INC.

## WELL MONITORING/SAMPLING FIELD DATA SHEET

Client/Facility #: Tosco #7124 Job Number: 180299  
 Site Address: 10151 East 14th Street Event Date: 7-28-02  
 City: Oakland, CA Sampler: P.O.

Well ID: MW-1 Well Condition: OK  
 Well Diameter: 4 in. Hydrocarbon Thickness: 0 ft. Amount Bailed (product/water): 0 gal.  
 Total Depth: 25.40 ft.  
 Depth to Water: 15.88 ft.  
 Volume Factor (VF) table:  

Volume	3/4" = 0.02	1" = 0.04	2" = 0.17	3" = 0.38
Factor (VF)	4" = 0.66	5" = 1.02	6" = 1.50	12" = 5.80

 $9.52 \times VF .66 = 6.28 \times 3 \text{ (case volume)} = \text{Estimated Purge Volume: } 19 \text{ gal.}$

Purge Equipment: Disposable Bailer \_\_\_\_\_  
 Stainless Steel Bailer \_\_\_\_\_  
 Stack Pump X  
 Suction Pump \_\_\_\_\_  
 Grundfos \_\_\_\_\_  
 Other: \_\_\_\_\_  
 Sampling Equipment: Disposable Bailer X  
 Pressure Bailer \_\_\_\_\_  
 Discrete Bailer \_\_\_\_\_  
 Other: \_\_\_\_\_

Start Time (purge): 1441 Weather Conditions: clear  
 Sample Time/Date: 1501/7-28-02 Water Color: light brown Odor: no  
 Purging Flow Rate: 1.5 gpm. Sediment Description: \_\_\_\_\_  
 Did well de-water? no If yes, Time: \_\_\_\_\_ Volume: \_\_\_\_\_ gal.

Time (2400 hr.)	Volume (gal.)	pH	Conductivity (umhos/cm)	Temperature (°F)	D.O. (mg/L)	ORP (mV)
<u>1445</u>	<u>6</u>	<u>7.70</u>	<u>302</u>	<u>19.7</u>		
<u>1449</u>	<u>12</u>	<u>7.59</u>	<u>311</u>	<u>19.8</u>		
<u>1453</u>	<u>19</u>	<u>7.51</u>	<u>317</u>	<u>19.6</u>		

### LABORATORY INFORMATION

SAMPLE ID	(#) CONTAINER	REFRIG.	PRESERV. TYPE	LABORATORY	ANALYSES
<u>MW-1</u>	<u>3 x voa vial</u>	<u>YES</u>	<u>HCL</u>	<u>STL Pleasanton</u>	<u>TPH-G, BTEX, MTBE &amp; 8 Oxy's by 8260</u>

COMMENTS: \_\_\_\_\_  
 \_\_\_\_\_  
 \_\_\_\_\_

Add/Replaced Lock: \_\_\_\_\_ Add/Replaced Plug: \_\_\_\_\_ Size: \_\_\_\_\_



# GETTLER-RYAN INC.

## WELL MONITORING/SAMPLING FIELD DATA SHEET

Client/Facility #: Tosco #7124  
 Site Address: 10151 East 14th Street  
 City: Oakland, CA

Job Number: 180299  
 Event Date: 7.28.02  
 Sampler: P.O.

Well ID: MW-2  
 Well Diameter: 4 in.  
 Total Depth: 25.46 ft.  
 Depth to Water: 17.28 ft.

Well Condition: OK  
 Hydrocarbon Thickness: Ø ft.  
 Amount Bailed (product/water): Ø gal.

Volume Factor (VF)	3/4" = 0.02	1" = 0.04	2" = 0.17	3" = 0.38
	4" = 0.66	5" = 1.02	6" = 1.50	12" = 5.80

8.18 xVF .66 = 5.39 x3 (case volume) = Estimated Purge Volume: 16 gal.

Purge Equipment: Disposable Bailer \_\_\_\_\_  
 Stainless Steel Bailer \_\_\_\_\_  
 Stack Pump X  
 Suction Pump \_\_\_\_\_  
 Grundfos \_\_\_\_\_  
 Other: \_\_\_\_\_

Sampling Equipment: Disposable Bailer X  
 Pressure Bailer \_\_\_\_\_  
 Discrete Bailer \_\_\_\_\_  
 Other: \_\_\_\_\_

Start Time (purge): 1512 Weather Conditions: clear  
 Sample Time/Date: 1531 / 7.28.02 Water Color: cloudy grey Odor: no  
 Purging Flow Rate: 1.5 gpm. Sediment Description: \_\_\_\_\_  
 Did well de-water? NO If yes, Time: \_\_\_\_\_ Volume: \_\_\_\_\_ gal.

Time (2400 hr.)	Volume (gal.)	pH	Conductivity (umhos/cm)	Temperature (°F)	D.O. (mg/L)	ORP (mV)
<u>1516</u>	<u>5.5</u>	<u>7.36</u>	<u>145</u>	<u>20.6</u>		
<u>1519</u>	<u>11</u>	<u>7.28</u>	<u>152</u>	<u>20.4</u>		
<u>1523</u>	<u>16</u>	<u>7.22</u>	<u>155</u>	<u>20.3</u>		

### LABORATORY INFORMATION

SAMPLE ID	(#) CONTAINER	REFRIG.	PRESERV. TYPE	LABORATORY	ANALYSES
<u>MW-2</u>	<u>3</u> x vovial	<u>YES</u>	<u>HCL</u>	<u>STL Pleasanton</u>	<u>TPH-G, BTEX, MTBE &amp; 8 Oxy's by 8260</u>

COMMENTS: \_\_\_\_\_

Add/Replaced Lock: \_\_\_\_\_

Add/Replaced Plug: \_\_\_\_\_ Size: \_\_\_\_\_



# GETTLER-RYAN INC.

## WELL MONITORING/SAMPLING FIELD DATA SHEET

Client/Facility #: Tosco #7124 Job Number: 180299  
 Site Address: 10151 East 14th Street Event Date: 7-28-02  
 City: Oakland, CA Sampler: D.O.

Well ID: MW-3 Well Condition: OK  
 Well Diameter: 4 in. Hydrocarbon Thickness: 0 ft. Amount Bailed (product/water): 0 gal.  
 Total Depth: 25.38 ft.  
 Depth to Water: 17.22 ft.

Volume Factor (VF)	3/4" = 0.02	1" = 0.04	2" = 0.17	3" = 0.38
	4" = 0.66	5" = 1.02	6" = 1.50	12" = 5.80

8.16 xVF .66 = 5.38 x3 (case volume) = Estimated Purge Volume: 16 gal.

Purge Equipment: Disposable Bailer \_\_\_\_\_  
 Stainless Steel Bailer \_\_\_\_\_  
 Stack Pump X  
 Suction Pump \_\_\_\_\_  
 Grundfos \_\_\_\_\_  
 Other: \_\_\_\_\_

Sampling Equipment: Disposable Bailer X  
 Pressure Bailer \_\_\_\_\_  
 Discrete Bailer \_\_\_\_\_  
 Other: \_\_\_\_\_

Start Time (purge): 1539 Weather Conditions: Clear  
 Sample Time/Date: 1559 / 7-28-02 Water Color: Cloudy grey Odor: yes  
 Purging Flow Rate: 1.5 gpm. Sediment Description: \_\_\_\_\_  
 Did well de-water? no If yes, Time: \_\_\_\_\_ Volume: \_\_\_\_\_ gal.

Time (2400 hr.)	Volume (gal.)	pH	Conductivity (umhos/cm)	Temperature (C/F)	D.O. (mg/L)	ORP (mV)
<u>1543</u>	<u>5.5</u>	<u>7.11</u>	<u>139</u>	<u>19.2</u>		
<u>1547</u>	<u>11</u>	<u>7.06</u>	<u>135</u>	<u>19.2</u>		
<u>1551</u>	<u>16</u>	<u>7.02</u>	<u>138</u>	<u>19.1</u>		

### LABORATORY INFORMATION

SAMPLE ID	(#) CONTAINER	REFRIG.	PRESERV. TYPE	LABORATORY	ANALYSES
<u>MW-3</u>	<u>3 x vov vial</u>	<u>YES</u>	<u>HCL</u>	<u>STL Pleasanton</u>	<u>TPH-G, BTEX, MTBE &amp; 8 Oxy's by 8260</u>

COMMENTS: \_\_\_\_\_  
 \_\_\_\_\_  
 \_\_\_\_\_

Add/Replaced Lock: \_\_\_\_\_ Add/Replaced Plug: \_\_\_\_\_ Size: \_\_\_\_\_



# GETTLER-RYAN INC.

## WELL MONITORING/SAMPLING FIELD DATA SHEET

Client/Facility #: Tosco #7124 Job Number: 180299  
 Site Address: 10151 East 14th Street Event Date: 7.28.02  
 City: Oakland, CA Sampler: D.O.

Well ID: MW-4 Well Condition: OK  
 Well Diameter: 4 in. Hydrocarbon Thickness: Ø ft. Amount Bailed (product/water): Ø gal.  
 Total Depth: 25.44 ft.  
 Depth to Water: 17.93 ft.

Volume Factor (VF)	3/4"= 0.02	1"= 0.04	2"= 0.17	3"= 0.36
	4"= 0.66	5"= 1.02	6"= 1.50	12"= 5.80

7.51 xVF .66 = 4.95 x3 (case volume) = Estimated Purge Volume: 15 gal.

Purge Equipment: Disposable Bailer \_\_\_\_\_ Sampling Equipment: Disposable Bailer X  
 Stainless Steel Bailer \_\_\_\_\_ Pressure Bailer \_\_\_\_\_  
 Stack Pump X \_\_\_\_\_ Discrete Bailer \_\_\_\_\_  
 Suction Pump \_\_\_\_\_ Other: \_\_\_\_\_  
 Grundfos \_\_\_\_\_  
 Other: \_\_\_\_\_

Start Time (purge): 1611 Weather Conditions: Clear  
 Sample Time/Date: 1631 7.28.02 Water Color: Cloudy grey Odor: yes  
 Purging Flow Rate: 1.5 gpm. Sediment Description: \_\_\_\_\_  
 Did well de-water? no If yes, Time: \_\_\_\_\_ Volume: \_\_\_\_\_ gal.

Time (2400 hr.)	Volume (gal.)	pH	Conductivity (umhos/cm)	Temperature (C/F)	D.O. (mg/L)	ORP (mV)
<u>1615</u>	<u>5</u>	<u>7.23</u>	<u>124</u>	<u>19.9</u>		
<u>1618</u>	<u>10</u>	<u>7.18</u>	<u>131</u>	<u>19.7</u>		
<u>1622</u>	<u>15</u>	<u>7.10</u>	<u>139</u>	<u>19.4</u>		

### LABORATORY INFORMATION

SAMPLE ID	(#) CONTAINER	REFRIG.	PRESERV. TYPE	LABORATORY	ANALYSES
<u>MW-4</u>	<u>3</u> x vovial	<u>YES</u>	<u>HCL</u>	<u>STL Pleasanton</u>	<u>TPH-G, BTEX, MTBE &amp; 8 Oxy's by 8260</u>

COMMENTS: \_\_\_\_\_  
 \_\_\_\_\_  
 \_\_\_\_\_

Add/Replaced Lock: \_\_\_\_\_ Add/Replaced Plug: \_\_\_\_\_ Size: \_\_\_\_\_

2002-07-0586

Settler-Ryan Inc., Chain-of-Custody

67795

Tosco Corp./  
Phillips 66 Co.  
1000 Crow Canyon Place  
Suite 400  
San Ramon, CA 94583

Facility Number #7124  
Facility Address 10151 EAST 14TH STREET, OAKLAND, CA  
Global ID \_\_\_\_\_ Project 180299.80  
Client Contact MR. DAVID B. DEWITT  
Phone (925) 277-2384

Laboratory Name STL - PLEASANTON, CA  
Consultant GETTLER-RYAN, INC. DEANNA L. HARDING  
Address 6747 SIERRA CT., SUITE J, DUBLIN CA 94568  
Phone (925) 551-7555 Fax (925) 551-7899  
Samples Collected by David Okimoto

SAMPLE ID	Number of Containers Matrix	S = Soil W = Water A = Air C = Charcoal	Sample Preservation	Date/Time (2400 Hrs)	TPH-GAS/BTEX/MTBE EPA 8015/8021B	TPH-DIESEL EPA 8015	TPH-DIESEL w/Silica gel EPA 8015	TPH-GAS EPA 8015	TPH-GAS/BTEX/MTBE EPA 8260	8-OXYGENATES EPA 8260	METHANOL EPA 8015	TOTAL OIL & GREASE EPA 9520	METALS Cd, Cr, Pb, Zn, Ni	NITRATE/SULFATE/ALKALINITY EPA 300 SERIES	HWOC'S (8010) EPA 8021B	VOC'S (8240) EPA 8260	SVOC'S EPA 8270	Remarks
QA	1	W	HCZ	7-28-02					X									
MW-1	3			1501					X	X								
MW-2	3			1531					X	X								
MW-3	3			1559					X	X								
MW-4	3			1631					X	X								

- OXYGENATES 8260
- 1 - MTBE
  - 2 - TBA
  - 3 - TAME
  - 4 - DIPE
  - 5 - ETBE
  - 6 - 1,2-DCA
  - 7 - EDB
  - 8 - ETHANOL

Shipped By (Signature) <i>David Okimoto</i>	Organization G.R.	Date/Time 7-28-02/1730	Received By (Signature)	Organization	Date/Time	Iced Y/N	Turn Around Time (Circle Choice) 24 Hrs. 48 Hrs. 72 Hrs. 5 Days 10 Days <u>As Contracted</u>
Shipped By (Signature)	Organization	Date/Time	Received By (Signature)	Organization	Date/Time	Iced Y/N	
Shipped By (Signature)	Organization	Date/Time	Received For Laboratory By (Signature)		Date/Time 7-29-02	Iced <input checked="" type="checkbox"/> N 1355	

Aug 13 02 11:23a st10n site 9256003002 P.4

Submission#: 2002-07-0586

August 13, 2002

SEVERN

TRENT

LABORATORY

**Gettler Ryan**

6747 Sierra Court Suite J  
Dublin, CA 94568

Attn.: Deanna Harding

Project#: 180299.80

Project: Tosco #7124

Site: 10151 East 14th Street  
Oakland, CA

STL San Francisco  
1220 Quarry Ln  
Pleasanton CA 94566

Tel.: (925) 484-1919  
Fax: (925) 484-1096  
www.stl-inc.com  
www.chromalab.com

CA DHS ELAP#:2496

RECEIVED

GETTLER-RYAN, INC.  
GENERAL CONTRACTOR

Dear Ms. Harding,

Attached is our report for your samples received on 07/29/2002 13:55

This report has been reviewed and approved for release. Reproduction of this report is permitted only in its entirety.

Please note that any unused portion of the samples will be discarded after 09/12/2002 unless you have requested otherwise.

We appreciate the opportunity to be of service to you. If you have any questions, please call me at (925) 484-1919.

You can also contact me via email. My email address is: [tgranicher@chromalab.com](mailto:tgranicher@chromalab.com)

Sincerely,

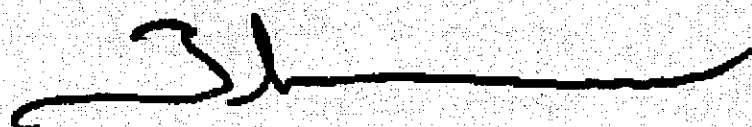

Tod Granicher  
Project Manager

Submission #: 2002-07-0586

Gas/BTEX Fuel Oxygenates by 8260B

Gettler Ryan

Attn.: Deanna Harding  
6747 Sierra Court Suite J  
Dublin, CA 94568

Phone: (925) 551-7444 Fax: (925) 551-7899

Project: 180299.80  
Tosco #7124

Received: 07/29/2002 13:55

Site: 10151 East 14th Street  
Oakland, CA

**SEVERN**  
**TRENT**  
**LABORATORY**

STL San Francisco  
1220 Quarry Lane  
Pleasanton, CA 94566

Tel: (925) 484-1919  
Fax: (925) 484-1096  
www.stl-inc.com  
www.chromalab.com

CA DHS ELAP# 2496

**Samples Reported**

Sample Name	Date Sampled	Matrix	Lab #
QA	07/28/2002	Water	1
MW-1	07/28/2002 15:01	Water	2
MW-2	07/28/2002 15:31	Water	3
MW-3	07/28/2002 15:59	Water	4
MW-4	07/28/2002 16:31	Water	5

Submission #: 2002-07-0586

Gas/BTEX Fuel Oxygenates by 8260B

Gettler Ryan

Attn.: Deanna Harding  
6747 Sierra Court Suite J  
Dublin, CA 94568

Phone: (925) 551-7444 Fax: (925) 551-7899

Project: 180299.80  
Tosco #7124

Received: 07/29/2002 13:55

Site: 10151 East 14th Street  
Oakland, CA

**SEVERN**  
**TRENT**  
**LABORATORY**

STL San Francisco  
1220 Quarry Lane  
Pleasanton, CA 94566

Tel: (925) 484-1919  
Fax: (925) 484-1096  
www.stl-inc.com  
www.chromalab.com

CA DHS ELAP# 2496

Prep(s):	5030B	Test(s):	8260FAB
Sample ID:	QA	Lab ID:	2002-07-0586 - 1
Sampled:	07/28/2002	Extracted:	8/5/2002 19:57
Matrix:	Water	QC Batch#:	2002/08/05-01.27

Compound	Conc.	RL	Unit	Dilution	Analyzed	Flag
Gasoline	ND	50	ug/L	1.00	08/05/2002 19:57	
Benzene	ND	0.50	ug/L	1.00	08/05/2002 19:57	
Toluene	ND	0.50	ug/L	1.00	08/05/2002 19:57	
Ethylbenzene	ND	0.50	ug/L	1.00	08/05/2002 19:57	
Total xylenes	ND	1.0	ug/L	1.00	08/05/2002 19:57	
Methyl tert-butyl ether (MTBE)	ND	2.0	ug/L	1.00	08/05/2002 19:57	
<b>Surrogates(s)</b>						
1,2-Dichloroethane-d4	111.7	76-114	%	1.00	08/05/2002 19:57	
Toluene-d8	97.6	88-110	%	1.00	08/05/2002 19:57	



Submission #: 2002-07-0586

Gas/BTEX Fuel Oxygenates by 8260B

Gettler Ryan

Attn.: Deanna Harding  
6747 Sierra Court Suite J  
Dublin, CA 94568

Phone: (925) 551-7444 Fax: (925) 551-7899

Project: 180299.80  
Tosco #7124

Received: 07/29/2002 13:55

Site: 10151 East 14th Street  
Oakland, CA

**SEVERN**  
**TRENT**  
**LABORATORY**

STL San Francisco  
1220 Quarry Lane  
Pleasanton, CA 94566

Tel: (925) 484-1919  
Fax: (925) 484-1096  
www.stl-inc.com  
www.chromalab.com

CA DHS ELAP# 2496

Prep(s):	5030B	Test(s):	8260FAB
Sample ID:	MW-1	Lab ID:	2002-07-0586 - 2
Sampled:	07/28/2002 15:01	Extracted:	8/3/2002 18:47
Matrix:	Water	QC Batch#:	2002/08/03-01.27

Compound	Conc.	RL	Unit	Dilution	Analyzed	Flag
Gasoline	ND	50	ug/L	1.00	08/03/2002 18:47	
Benzene	ND	0.50	ug/L	1.00	08/03/2002 18:47	
Toluene	ND	0.50	ug/L	1.00	08/03/2002 18:47	
Ethylbenzene	ND	0.50	ug/L	1.00	08/03/2002 18:47	
Total xylenes	ND	1.0	ug/L	1.00	08/03/2002 18:47	
tert-Butyl alcohol (TBA)	ND	100	ug/L	1.00	08/03/2002 18:47	
Methyl tert-butyl ether (MTBE)	ND	2.0	ug/L	1.00	08/03/2002 18:47	
Di-isopropyl Ether (DIPE)	ND	2.0	ug/L	1.00	08/03/2002 18:47	
Ethyl tert-butyl ether (ETBE)	ND	2.0	ug/L	1.00	08/03/2002 18:47	
tert-Amyl methyl ether (TAME)	ND	2.0	ug/L	1.00	08/03/2002 18:47	
1,2-DCA	ND	2.0	ug/L	1.00	08/03/2002 18:47	
EDB	ND	2.0	ug/L	1.00	08/03/2002 18:47	
Ethanol	ND	500	ug/L	1.00	08/03/2002 18:47	
<b>Surrogates(s)</b>						
1,2-Dichloroethane-d4	109.7	76-114	%	1.00	08/03/2002 18:47	
Toluene-d8	98.7	88-110	%	1.00	08/03/2002 18:47	

Gas/BTEX Fuel Oxygenates by 8260B

Gettler Ryan

Attn.: Deanna Harding  
6747 Sierra Court Suite J  
Dublin, CA 94568

Phone: (925) 551-7444 Fax: (925) 551-7899

Project: 180299.80  
Tosco #7124

Received: 07/29/2002 13:55

STL San Francisco  
1220 Quarry Lane  
Pleasanton, CA 94566

Tel: (925) 484-1919  
Fax: (925) 484-1096  
www.stl-inc.com  
www.chromalab.com

Site: 10151 East 14th Street  
Oakland, CA

CA DHS ELAP# 2496

Prep(s):	5030B	Test(s):	8260FAB
Sample ID:	MW-2	Lab ID:	2002-07-0586 - 3
Sampled:	07/28/2002 15:31	Extracted:	8/3/2002 19:09
Matrix:	Water	QC Batch#:	2002/08/03-01.27

Compound	Conc.	RL	Unit	Dilution	Analyzed	Flag
Gasoline	3200	250	ug/L	5.00	08/03/2002 19:09	g
Benzene	ND	2.5	ug/L	5.00	08/03/2002 19:09	
Toluene	ND	2.5	ug/L	5.00	08/03/2002 19:09	
Ethylbenzene	ND	2.5	ug/L	5.00	08/03/2002 19:09	
Total xylenes	ND	5.0	ug/L	5.00	08/03/2002 19:09	
tert-Butyl alcohol (TBA)	ND	500	ug/L	5.00	08/03/2002 19:09	
Methyl tert-butyl ether (MTBE)	170	10	ug/L	5.00	08/03/2002 19:09	
Di-isopropyl Ether (DIPE)	ND	10	ug/L	5.00	08/03/2002 19:09	
Ethyl tert-butyl ether (ETBE)	ND	10	ug/L	5.00	08/03/2002 19:09	
tert-Amyl methyl ether (TAME)	ND	10	ug/L	5.00	08/03/2002 19:09	
1,2-DCA	ND	10	ug/L	5.00	08/03/2002 19:09	
EDB	ND	10	ug/L	5.00	08/03/2002 19:09	
Ethanol	ND	2500	ug/L	5.00	08/03/2002 19:09	
<b>Surrogates(s)</b>						
1,2-Dichloroethane-d4	113.4	76-114	%	5.00	08/03/2002 19:09	
Toluene-d8	100.6	88-110	%	5.00	08/03/2002 19:09	

Gas/BTEX Fuel Oxygenates by 8260B

Gettler Ryan

Attn.: Deanna Harding  
6747 Sierra Court Suite J  
Dublin, CA 94568  
Phone: (925) 551-7444 Fax: (925) 551-7899

STL San Francisco  
1220 Quarry Lane  
Pleasanton, CA 94566

Tel: (925) 484-1919  
Fax: (925) 484-1096  
www.stl-inc.com  
www.chromalab.com

Project: 180299.80  
Tosco #7124

Received: 07/29/2002 13:55

Site: 10151 East 14th Street  
Oakland, CA

CA DHS ELAP# 2496

Prep(s):	5030B	Test(s):	8260FAB
Sample ID:	MW-3	Lab ID:	2002-07-0586 - 4
Sampled:	07/28/2002 15:59	Extracted:	8/7/2002 12:55
Matrix:	Water	QC Batch#:	2002/08/07-01.27

Compound	Conc.	RL	Unit	Dilution	Analyzed	Flag
Gasoline	4500	2500	ug/L	50.00	08/07/2002 12:55	g
Benzene	ND	25	ug/L	50.00	08/07/2002 12:55	
Toluene	ND	25	ug/L	50.00	08/07/2002 12:55	
Ethylbenzene	ND	25	ug/L	50.00	08/07/2002 12:55	
Total xylenes	ND	50	ug/L	50.00	08/07/2002 12:55	
tert-Butyl alcohol (TBA)	ND	5000	ug/L	50.00	08/07/2002 12:55	
Methyl tert-butyl ether (MTBE)	1100	100	ug/L	50.00	08/07/2002 12:55	
Di-isopropyl Ether (DIPE)	ND	100	ug/L	50.00	08/07/2002 12:55	
Ethyl tert-butyl ether (ETBE)	ND	100	ug/L	50.00	08/07/2002 12:55	
tert-Amyl methyl ether (TAME)	ND	100	ug/L	50.00	08/07/2002 12:55	
1,2-DCA	ND	100	ug/L	50.00	08/07/2002 12:55	
EDB	ND	100	ug/L	50.00	08/07/2002 12:55	
Ethanol	ND	25000	ug/L	50.00	08/07/2002 12:55	
<b>Surrogates(s)</b>						
1,2-Dichloroethane-d4	102.0	76-114	%	50.00	08/07/2002 12:55	
Toluene-d8	99.3	88-110	%	50.00	08/07/2002 12:55	

Submission #: 2002-07-0586

Gas/BTEXFuel Oxygenates by 8260B

Gettler Ryan

Attn.: Deanna Harding  
6747 Sierra Court Suite J  
Dublin, CA 94568  
Phone: (925) 551-7444 Fax: (925) 551-7899

Project: 180299.80  
Tosco #7124

Received: 07/29/2002 13:55

Site: 10151 East 14th Street  
Oakland, CA

**SEVERN**  
**TRENT**  
**LABORATORY**

STL San Francisco  
1220 Quarry Lane  
Pleasanton, CA 94566

Tel: (925) 484-1919  
Fax: (925) 484-1096  
www.stl-inc.com  
www.chromalab.com

CA DHS ELAP# 2496

Prep(s):	5030B	Test(s):	8260FAB
Sample ID:	MW-4	Lab ID:	2002-07-0586 - 5
Sampled:	07/28/2002 16:31	Extracted:	8/9/2002 14:27
Matrix:	Water	QC Batch#:	2002/08/09-01.27

Compound	Conc.	RL	Unit	Dilution	Analyzed	Flag
Gasoline	18000	250	ug/L	5.00	08/09/2002 14:27	g
Benzene	ND	2.5	ug/L	5.00	08/09/2002 14:27	
Toluene	ND	2.5	ug/L	5.00	08/09/2002 14:27	
Ethylbenzene	ND	2.5	ug/L	5.00	08/09/2002 14:27	
Total xylenes	ND	5.0	ug/L	5.00	08/09/2002 14:27	
tert-Butyl alcohol (TBA)	ND	500	ug/L	5.00	08/09/2002 14:27	
Methyl tert-butyl ether (MTBE)	170	10	ug/L	5.00	08/09/2002 14:27	
Di-isopropyl Ether (DIPE)	ND	10	ug/L	5.00	08/09/2002 14:27	
Ethyl tert-butyl ether (ETBE)	ND	10	ug/L	5.00	08/09/2002 14:27	
tert-Amyl methyl ether (TAME)	ND	10	ug/L	5.00	08/09/2002 14:27	
1,2-DCA	ND	10	ug/L	5.00	08/09/2002 14:27	
EDB	ND	11	ug/L	5.00	08/09/2002 14:27	
Ethanol	ND	2500	ug/L	5.00	08/09/2002 14:27	
<b>Surrogates(s)</b>						
1,2-Dichloroethane-d4	112.6	76-114	%	5.00	08/09/2002 14:27	
Toluene-d8	102.5	88-110	%	5.00	08/09/2002 14:27	

Gas/BTEX Fuel Oxygenates by 8260B

Gettler Ryan

Attn.: Deanna Harding  
6747 Sierra Court Suite J  
Dublin, CA 94568  
Phone: (925) 551-7444 Fax: (925) 551-7899

Project: 180299.80  
Tosco #7124

Received: 07/29/2002 13:55

Site: 10151 East 14th Street  
Oakland, CA

STL San Francisco  
1220 Quarry Lane  
Pleasanton, CA 94566

Tel: (925) 484-1919  
Fax: (925) 484-1096  
www.stl-inc.com  
www.chromalab.com

CA DHS ELAP# 2496

Batch QC Report			
Prep(s): 5030B			Test(s): 8260FAB
Method Blank		Water	QC Batch # 2002/08/03-01-27
MB: 2002/08/03-01-27-010			Date Extracted: 08/03/2002 10:43

Compound	Conc.	RL	Unit	Analyzed	Flag
Gasoline	ND	50	ug/L	08/03/2002 10:43	
Benzene	ND	0.5	ug/L	08/03/2002 10:43	
Toluene	ND	0.5	ug/L	08/03/2002 10:43	
Ethylbenzene	ND	0.5	ug/L	08/03/2002 10:43	
Total xylenes	ND	1.0	ug/L	08/03/2002 10:43	
tert-Butyl alcohol (TBA)	ND	100	ug/L	08/03/2002 10:43	
Methyl tert-butyl ether (MTBE)	ND	2.0	ug/L	08/03/2002 10:43	
Di-isopropyl Ether (DIPE)	ND	2.0	ug/L	08/03/2002 10:43	
Ethyl tert-butyl ether (ETBE)	ND	2.0	ug/L	08/03/2002 10:43	
tert-Amyl methyl ether (TAME)	ND	2.0	ug/L	08/03/2002 10:43	
1,2-DCA	ND	2.0	ug/L	08/03/2002 10:43	
EDB	ND	2.0	ug/L	08/03/2002 10:43	
Ethanol	ND	500	ug/L	08/03/2002 10:43	
<b>Surrogates(s)</b>					
1,2-Dichloroethane-d4	108.6	76-114	%	08/03/2002 10:43	
Toluene-d8	100.8	88-110	%	08/03/2002 10:43	

Submission #: 2002-07-0586

SEVERN

Gas/BTEXFuel Oxygenates by 8260B

TRENT

LABORATORY

Gettler Ryan

Attn.: Deanna Harding  
6747 Sierra Court Suite J  
Dublin, CA 94568

Phone: (925) 551-7444 Fax: (925) 551-7899

Project: 180299.80  
Tosco #7124

Received: 07/29/2002 13:55

Site: 10151 East 14th Street  
Oakland, CA

STL San Francisco  
1220 Quarry Lane  
Pleasanton, CA 94566

Tel: (925) 484-1919  
Fax: (925) 484-1096  
www.stl-inc.com  
www.chromalab.com

CA DHS ELAP# 2496

Batch QC Report

Prep(s): 5030B

Method Blank

MB: 2002/08/05-01.27-026

Water

Test(s): 8260FAB

QC Batch # 2002/08/05-01.27

Date Extracted: 08/05/2002 11:56

Compound	Conc.	RL	Unit	Analyzed	Flag
Gasoline	ND	50	ug/L	08/05/2002 11:56	
Benzene	ND	0.5	ug/L	08/05/2002 11:56	
Toluene	ND	0.5	ug/L	08/05/2002 11:56	
Ethylbenzene	ND	0.5	ug/L	08/05/2002 11:56	
Total xylenes	ND	1.0	ug/L	08/05/2002 11:56	
tert-Butyl alcohol (TBA)	ND	100	ug/L	08/05/2002 11:56	
Methyl tert-butyl ether (MTBE)	ND	2.0	ug/L	08/05/2002 11:56	
Di-isopropyl Ether (DIPE)	ND	2.0	ug/L	08/05/2002 11:56	
Ethyl tert-butyl ether (ETBE)	ND	2.0	ug/L	08/05/2002 11:56	
tert-Amyl methyl ether (TAME)	ND	2.0	ug/L	08/05/2002 11:56	
1,2-DCA	ND	2.0	ug/L	08/05/2002 11:56	
EDB	ND	2.0	ug/L	08/05/2002 11:56	
Ethanol	ND	500	ug/L	08/05/2002 11:56	
<b>Surrogates(s)</b>					
1,2-Dichloroethane-d4	110.8	76-114	%	08/05/2002 11:56	
Toluene-d8	102.6	88-110	%	08/05/2002 11:56	

Gas/BTEX Fuel Oxygenates by 8260B

Gettler Ryan

Attn.: Deanna Harding  
6747 Sierra Court Suite J  
Dublin, CA 94568  
Phone: (925) 551-7444 Fax: (925) 551-7899

STL San Francisco  
1220 Quarry Lane  
Pleasanton, CA 94566

Tel: (925) 484-1919  
Fax: (925) 484-1096  
www.stl-inc.com  
www.chromalab.com

Project: 180299.80  
Tosco #7124

Received: 07/29/2002 13:55

Site: 10151 East 14th Street  
Oakland, CA

CA DHS ELAP# 2496

Batch QC Report					
Prep(s): 5030B				Test(s): 8260FAB	
Method Blank		Water		QC Batch # 2002/08/07-01.27	
MB: 2002/08/07-01.27-007				Date Extracted: 08/07/2002 12:05	

Compound	Conc.	RL	Unit	Analyzed	Flag
Gasoline	ND	50	ug/L	08/07/2002 12:05	
Benzene	ND	0.5	ug/L	08/07/2002 12:05	
Toluene	ND	0.5	ug/L	08/07/2002 12:05	
Ethylbenzene	ND	0.5	ug/L	08/07/2002 12:05	
Total xylenes	ND	1.0	ug/L	08/07/2002 12:05	
tert-Butyl alcohol (TBA)	ND	100	ug/L	08/07/2002 12:05	
Methyl tert-butyl ether (MTBE)	ND	2.0	ug/L	08/07/2002 12:05	
Di-isopropyl Ether (DIPE)	ND	2.0	ug/L	08/07/2002 12:05	
Ethyl tert-butyl ether (ETBE)	ND	2.0	ug/L	08/07/2002 12:05	
tert-Amyl methyl ether (TAME)	ND	2.0	ug/L	08/07/2002 12:05	
1,2-DCA	ND	2.0	ug/L	08/07/2002 12:05	
EDB	ND	2.0	ug/L	08/07/2002 12:05	
Ethanol	ND	500	ug/L	08/07/2002 12:05	
<b>Surrogates(s)</b>					
1,2-Dichloroethane-d4	112.6	76-114	%	08/07/2002 12:05	
Toluene-d8	99.6	88-110	%	08/07/2002 12:05	

Submission #: 2002-07-0586

Gas/BTEXFuel Oxygenates by 8260B

Gettler Ryan

Attn.: Deanna Harding  
6747 Sierra Court Suite J  
Dublin, CA 94568  
Phone: (925) 551-7444 Fax: (925) 551-7899

Project: 180299.80  
Tosco #7124

Received: 07/29/2002 13:55

Site: 10151 East 14th Street  
Oakland, CA

**SEVERN**  
**TRENT**  
**LABORATORY**

STL San Francisco  
1220 Quarry Lane  
Pleasanton, CA 94566

Tel: (925) 484-1919  
Fax: (925) 484-1096  
www.stl-inc.com  
www.chromalab.com

CA DHS ELAP# 2496

**Batch QC Report**

Prep(s): 5030B

Method Blank

MB: 2002/08/09-01.27-006

Water

Test(s): 8260FAB

QC Batch # 2002/08/09-01.27

Date Extracted: 08/09/2002 11:43

Compound	Conc.	RL	Unit	Analyzed	Flag
Gasoline	ND	50	ug/L	08/09/2002 11:43	
Benzene	ND	0.5	ug/L	08/09/2002 11:43	
Toluene	ND	0.5	ug/L	08/09/2002 11:43	
Ethylbenzene	ND	0.5	ug/L	08/09/2002 11:43	
Total xylenes	ND	1.0	ug/L	08/09/2002 11:43	
tert-Butyl alcohol (TBA)	ND	100	ug/L	08/09/2002 11:43	
Methyl tert-butyl ether (MTBE)	ND	2.0	ug/L	08/09/2002 11:43	
Di-isopropyl Ether (DIPE)	ND	2.0	ug/L	08/09/2002 11:43	
Ethyl tert-butyl ether (ETBE)	ND	2.0	ug/L	08/09/2002 11:43	
tert-Amyl methyl ether (TAME)	ND	2.0	ug/L	08/09/2002 11:43	
1,2-DCA	ND	2.0	ug/L	08/09/2002 11:43	
EDB	ND	2.0	ug/L	08/09/2002 11:43	
Ethanol	ND	500	ug/L	08/09/2002 11:43	
<b>Surrogates(s)</b>					
1,2-Dichloroethane-d4	112.8	76-114	%	08/09/2002 11:43	
Toluene-d8	100.8	88-110	%	08/09/2002 11:43	



Gas/BTEX Fuel Oxygenates by 8260B

Gettler Ryan

Attn.: Deanna Harding  
6747 Sierra Court Suite J  
Dublin, CA 94568  
Phone: (925) 551-7444 Fax: (925) 551-7899

Project: 180299.80  
Tosco #7124

Received: 07/29/2002 13:55

Site: 10151 East 14th Street  
Oakland, CA

STL San Francisco  
1220 Quarry Lane  
Pleasanton, CA 94566

Tel: (925) 484-1919  
Fax: (925) 484-1096  
www.stl-inc.com  
www.chromalab.com

CA DHS ELAP# 2496

Batch QC Report										
Prep(s): 5030B						Test(s): 8260FAB				
Laboratory Control Spike			Water			QC Batch # 2002/08/03-01.27				
LCS	2002/08/03-01.27-003		Extracted: 08/03/2002			Analyzed: 08/03/2002 09:49				
LCSD	2002/08/03-01.27-004		Extracted: 08/03/2002			Analyzed: 08/03/2002 10:21				
Compound	Conc. ug/L		Exp.Conc.	Recovery		RPD	Ctrl.Limits %		Flags	
	LCS	LCSD		LCS	LCSD		%	Rec.	RPD	LCS
Benzene	25.1	26.1	25.0	100.4	104.4	3.9	69-129	20		
Toluene	26.4	27.1	25.0	105.6	108.4	2.6	70-130	20		
Methyl tert-butyl ether (MTBE)	26.2	24.8	25.0	104.8	99.2	5.5	65-165	20		
<b>Surrogates(s)</b>										
1,2-Dichloroethane-d4	537	522	500	107.4	104.4		76-114			
Toluene-d8	489	508	500	97.8	101.6		88-110			

Submission #: 2002-07-0586

Gas/BTEXFuel Oxygenates by 8260B

Gettler Ryan

Attn.: Deanna Harding  
6747 Sierra Court Suite J  
Dublin, CA 94568

Phone: (925) 551-7444 Fax: (925) 551-7899

Project: 180299.80  
Tosco #7124

Received: 07/29/2002 13:55

Site: 10151 East 14th Street  
Oakland, CA

**SEVERN**

**TRENT**

**LABORATORY**

STL San Francisco  
1220 Quarry Lane  
Pleasanton, CA 94566

Tel: (925) 484-1919  
Fax: (925) 484-1096  
www.stl-inc.com  
www.chromalab.com

CA DHS ELAP# 2496

**Batch QC Report**

Prep(s): 5030B

Test(s): 8260FAB

**Laboratory Control Spike**

**Water**

**QC Batch # 2002/08/05-01.27**

LCS 2002/08/05-01.27-003

Extracted: 08/05/2002

Analyzed: 08/05/2002 11:05

LCSD 2002/08/05-01.27-004

Extracted: 08/05/2002

Analyzed: 08/05/2002 11:34

Compound	Conc. ug/L		Exp.Conc.	Recovery		RPD	Ctrl.Limits %		Flags	
	LCS	LCSD		LCS	LCSD		%	Rec.	RPD	LCS
Benzene	26.2	26.3	25.0	104.8	105.2	0.4	69-129	20		
Toluene	27.8	27.5	25.0	111.2	110.0	1.1	70-130	20		
Methyl tert-butyl ether (MTBE)	27.4	29.3	25.0	109.6	117.2	6.7	65-165	20		
<b>Surrogates(s)</b>										
1,2-Dichloroethane-d4	564	570	500	112.8	114.0		76-114			
Toluene-d8	510	495	500	102.0	99.0		88-110			

Submission #: 2002-07-0586

Gas/BTEXFuel Oxygenates by 8260B

Gettler Ryan

Attn.: Deanna Harding  
6747 Sierra Court Suite J  
Dublin, CA 94568  
Phone: (925) 551-7444 Fax: (925) 551-7899

Project: 180299.80  
Tosco #7124

Received: 07/29/2002 13:55

Site: 10151 East 14th Street  
Oakland, CA

SEVERN

TRENT

LABORATORY

STL San Francisco  
1220 Quarry Lane  
Pleasanton, CA 94566

Tel: (925) 484-1919  
Fax: (925) 484-1096  
www.stl-inc.com  
www.chromalab.com

CA DHS ELAP# 2496

Batch QC Report

Prep(s): 5030B

Test(s): 8260FAB

Laboratory Control Spike

Water

QC Batch # 2002/08/07-01.27

LCS 2002/08/07-01.27-003

Extracted: 08/07/2002

Analyzed: 08/07/2002 11:15

LCSD 2002/08/07-01.27-004

Extracted: 08/07/2002

Analyzed: 08/07/2002 11:43

Compound	Conc. ug/L		Exp.Conc.	Recovery		RPD	Ctrl.Limits %		Flags	
	LCS	LCSD		LCS	LCSD		%	Rec.	RPD	LCS
Benzene	23.8	24.0	25.0	95.2	96.0	0.8	69-129	20		
Toluene	26.1	26.3	25.0	104.4	105.2	0.8	70-130	20		
Methyl tert-butyl ether (MTBE)	23.5	27.1	25.0	94.0	108.4	14.2	65-165	20		
<b>Surrogates(s)</b>										
1,2-Dichloroethane-d4	511	567	500	102.2	113.4		76-114			
Toluene-d8	502	495	500	100.4	99.0		88-110			

Submission #: 2002-07-0586

Gas/BTEXFuel Oxygenates by 8260B

Gettler Ryan

Attn.: Deanna Harding  
6747 Sierra Court Suite J  
Dublin, CA 94568  
Phone: (925) 551-7444 Fax: (925) 551-7899

Project: 180299.80  
Tosco #7124

Received: 07/29/2002 13:55

Site: 10151 East 14th Street  
Oakland, CA

**SEVERN**  
**TRENT**  
**LABORATORY**

STL San Francisco  
1220 Quarry Lane  
Pleasanton, CA 94566

Tel: (925) 484-1919  
Fax: (925) 484-1096  
www.stl-inc.com  
www.chromalab.com

CA DHS ELAP# 2496

**Batch QC Report**

Prep(s): 5030B Test(s): 8260B  
Laboratory Control Spike Water QC Batch # 2002/08/09-01.27  
LCS 2002/08/09-01.27-003 Extracted: 08/09/2002 Analyzed: 08/09/2002 10:52  
LCSD 2002/08/09-01.27-004 Extracted: 08/09/2002 Analyzed: 08/09/2002 11:20

Compound	Conc. ug/L		Exp.Conc.	Recovery		RPD	Ctrl.Limits %		Flags	
	LCS	LCSD		LCS	LCSD		%	Rec.	RPD	LCS
Methyl tert-butyl ether (MTBE)	25.8	21.9	25.0	103.2	87.6	16.4	65-165	20		
Benzene	22.6	23.4	25.0	90.4	93.6	3.5	69-129	20		
Toluene	25.4	25.3	25.0	101.6	101.2	0.4	70-130	20		
<i>Surrogates(s)</i>										
1,2-Dichloroethane-d4	568	515	500	113.6	103.0		76-114			
Toluene-d8	509	509	500	101.8	101.8		88-110			

Submission #: 2002-07-0586

Gas/BTEX Fuel Oxygenates by 8260B

Gettler Ryan

Attn.: Deanna Harding

6747 Sierra Court Suite J

Dublin, CA 94568

Phone: (925) 551-7444 Fax: (925) 551-7899

Project: 180299.80

Tosco #7124

Received: 07/29/2002 13:55

Site: 10151 East 14th Street  
Oakland, CA

**SEVERN**

**TRENT**

**LABORATORY**

STL San Francisco  
1220 Quarry Lane  
Pleasanton, CA 94566

Tel: (925) 484-1919  
Fax: (925) 484-1096  
www.stl-inc.com  
www.chromalab.com

CA DHS ELAP# 2496

### Legend and Notes

#### Result Flag

g

Hydrocarbon reported in the gasoline range does not match our gasoline standard.