



RECEIVED

2:24 pm, Nov 03, 2008

Alameda County
Environmental Health

October 27, 2008

Mr. Jerry Wickham
Alameda County Environmental Health Department
1131 Harbor Bay Parkway, Suite 250
Alameda, California 94502-6577

**Re: Monitoring Well Destruction Report
New West Stations Livermore - Bernard's Gas
1051 Airway Boulevard
Livermore, CA**

Dear Mr. Wickham:

On behalf of New West Stations, Inc. (New West), Closure Solutions, Inc. (Closure Solutions) has prepared this *Monitoring Well Destruction Report* (Report) for the facility located at 1051 Airway Boulevard, in Livermore, California (the Site, Figure 1). Closure Solutions destroyed all of the groundwater monitoring wells at the Site as approved by the Alameda County Environmental Health (ACEH) letter dated July 30, 2008 (Attachment A).

Prior to initiating field activities, Closure Solutions obtained the necessary well destruction permit (Permit Number 28116) from the Zone 7 Water Agency (Attachment B).

On September 15, 2008, Closure Solutions observed Gregg Drilling and Testing, Inc. (Gregg) of Martinez, California destroy all five groundwater monitoring wells (MW-1 through MW-5) by pressure grouting. Prior to the destruction of each of the monitoring wells, total depth was measured to confirm that no obstruction or sediment was present. The depths of the monitoring wells were measured as 34.8, 33.8, 34.1, 35.0, and 34.8 feet below the top of the casing (TOC) in monitoring wells MW-1, MW-2, MW-3, MW-4, and MW-5, respectively. The monitoring well locations are shown on Figure 2.

Each well box and associated concrete collar was removed using a jack hammer and hand tools. Each monitoring well was pressure grouted with neat cement and completed at the surface with concrete (dyed, where appropriate, to match the adjacent surface). A copy of the California Department of Water Resources (DWR) well destruction logs are attached (Attachment C).

In accordance with Assembly Bill 2886, Closure Solutions will upload this report to GeoTracker.

The purpose of this work was to destroy all groundwater monitoring wells at the Site as required for the issuance of a Remedial Action Completion Certificate by ACEH. No further environmental work is planned at the Site.

If you have any questions or concerns, please contact Mr. Roger Hoffmore at (916) 983-5604.

Sincerely,

CLOSURE SOLUTIONS, Inc.

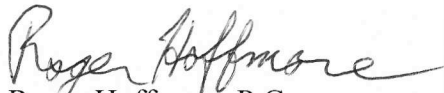
Roger Hoffmore, P.G.
Senior Geologist

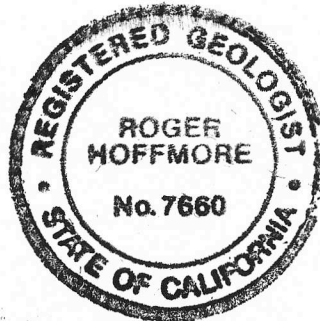

ATTACHMENTS:

Figure 1: Site Location Map
Figure 2: Site Map

Attachment A: ACEH letter dated July 30, 2008
Attachment B: Zone 7 Water Agency Permit
Attachment C: DWR Well Destruction Logs

cc: Ms. Marta Garcia, New West Stations, Inc.

FIGURES

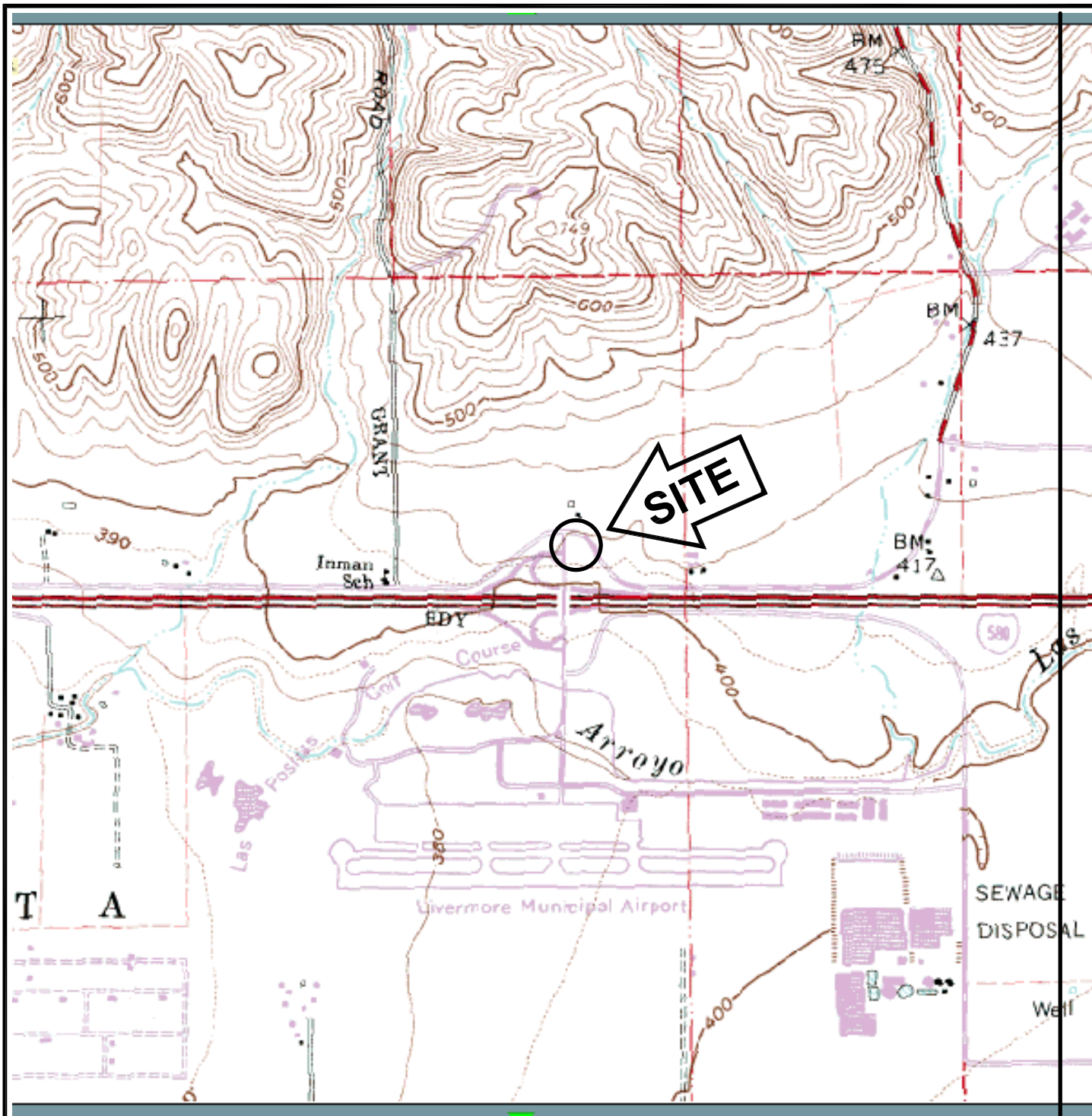
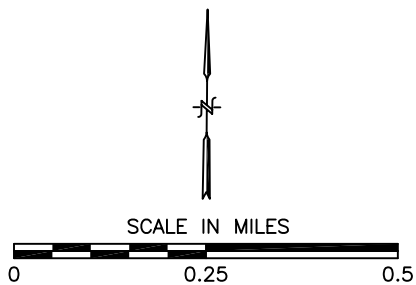

FIGURE 1
SITE LOCATION MAP

NEW WEST STATIONS, INC.
1051 AIRWAY BOULEVARD
LIVERMORE, CALIFORNIA



NOTES:

1. BASEMAP SOURCE: USGS TOPOGRAPHIC MAP
ALBION, CALIFORNIA QUADRANGLE, 1:24,000 SERIES



1243 Oak Knoll Drive • Concord
California • 94521
Phone: (925) 348-0656 • Fax: (925) 459-5602

NORTH CANYON PARKWAY

AIRWAY BOULEVARD

VACANT LOT

PARKING

**NEW WEST
STATION
BUILDING**

**DISPENSER
CANOPY**

MW-3

MW-4

MW-5

MW-1

MW-2

PLANTER

DRIVEWAY

PLANTER

DRIVEWAY

DRIVEWAY

PLANTER

DRIVE - THRU

PLANTER

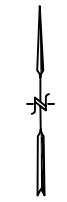

LEGEND:

 DESTROYED GROUNDWATER MONITORING WELL

NOTES:

1. BASEMAP SOURCE: GOOGLE EARTH
2. WELL COORDINATE DATA: VIRGIL CHAVEZ LAND SURVEYING, 3/19/07

FIGURE 2

SITE MAP

SEPTEMBER 2008

NEW WEST STATIONS, INC.
1051 AIRWAY BLVD
LIVERMORE, CA



1243 Oak Knoll Drive • Concord
California • 94521
Phone: (925) 429-5555 • Fax: (925) 459-5602

ATTACHMENT A

ACEH LETTER DATED JULY 30, 2008

ALAMEDA COUNTY
HEALTH CARE SERVICES



AGENCY
DAVID J. KEARS, Agency Director

ENVIRONMENTAL HEALTH SERVICES
ENVIRONMENTAL PROTECTION
1131 Harbor Bay Parkway, Suite 250
Alameda, CA 94502-6577
(510) 567-6700
FAX (510) 337-9335

July 30, 2008

Mr. J. Gilbert Moore
New West Stations, Inc.
1831 16th Street
Sacramento, CA 95814

Subject: Fuel Leak Case No. RO0002440 and Geotracker Global ID T0600148042, Bernard's Gas, 1051 Airway Blvd., Livermore, CA 94550

Dear Mr. Moore:

Alameda County Environmental Health (ACEH) and California Regional Water Quality Control Board staff have reviewed the fuel leak case file and case closure summary for the above-referenced site and concur that no further action related to the underground storage tank fuel release is required at this time. Prior to issuance of a Remedial Action Completion Certificate, the monitoring wells at the site are to be properly decommissioned, should the monitoring wells have no further use at the site. Please decommission the monitoring wells and provide documentation of the well decommissioning to this office. A Remedial Action Completion Certificate will be issued following receipt of the documentation.

Well destruction permits may be obtained from the Zone 7 Water Agency (<http://www.zone7water.com>). If you have any questions, please call me at (510) 567-6791 or send me an electronic mail message at jerry.wickham@acgov.org.

Sincerely,

Jerry Wickham, California PG 3766, CEG 1177, and CHG 297
Senior Hazardous Materials Specialist

Enclosure: ACEH Electronic Report Upload (ftp) Instructions

cc: Cheryl Dizon, QIC 80201, Zone 7 Water Agency, 100 North Canyons Parkway
Livermore, CA 94551

Danielle Stefani, Livermore-Pleasanton Fire Department, 3560 Nevada Street
Pleasanton, CA 94566

Roger Hoffmore, Closure Solutions, Inc., 1243 Oak Knoll Drive
Concord, CA 94521

Donna Drogos, ACEH
Jerry Wickham, ACEH
File

ATTACHMENT B

ZONE 7 WATER AGENCY PERMIT



ALAMEDA COUNTY FLOOD CONTROL AND WATER CONSERVATION DISTRICT

100 NORTH CANYONS PARKWAY, LIVERMORE, CA 94551-9486

PHONE (925) 454-5000

August 28, 2008

Mr. Roger Hoffmore
Closure Solutions
1243 Oak Knoll Drive
Concord, CA 94521

Dear Mr. Hoffmore:

Enclosed is drilling permit 28116 for the destruction of monitoring wells 3S/1E-1F3 (MW-1), 3S/1E-1F4 (MW-2), 3S/1E-1F5 (MW-3), 3S/1E-1F6 (MW-4) and 3S/1E-1F7 (MW-5)) at 1051 Airway Boulevard in Livermore for New West Petroleum. Also enclosed is a current drilling permit application for you files. Drilling permit applications for future projects can also be downloaded from our web site (www.zone7water.com).

Please note that permit condition A-2 requires that a well destruction report (DWR Form 188) be submitted after completion of the work. The report should include destruction completion logs, the method and materials used to destroy the well, location sketch, date of destruction, and permit number. Please submit the original of your completion report. We will forward your submittal to the California Department of Water Resources.

If you have any questions, please contact me at extension 5056 or Matt Katen at extension 5071.

Sincerely,

Wyman Hong
Water Resources Specialist

Enc.



ZONE 7 WATER AGENCY

100 NORTH CANYONS PARKWAY, LIVERMORE, CALIFORNIA 94551 VOICE (925) 454-5000 FAX (925) 245-9306
E-MAIL whong@zone7water.com

DRILLING PERMIT APPLICATION

FOR APPLICANT TO COMPLETE

FOR OFFICE USE

LOCATION OF PROJECT 1051 Airway Blvd.
Livermore, CA
Bernard's Gas

PERMIT NUMBER 28116
WELL NUMBER 3S/1E-1F3 to 1F7 (MW-1 to MW-5)
APN 905-0009-045-00

Coordinates Source _____ ft. Accuracy V _____ ft.
LAT: _____ ft. LONG: _____ ft.
APN 905-0009-045-00

PERMIT CONDITIONS
(Circled Permit Requirements Apply)

CLIENT Name New West Petroleum (Gil Moore)
Address 1831 16th Street Phone _____
City Sacramento Zip 95814

- A. GENERAL
 1. A permit application should be submitted so as to arrive at the Zone 7 office five days prior to your proposed starting date.
 2. Submit to Zone 7 within 60 days after completion of permitted work the original **Department of Water Resources Water Well Drillers Report (DWR Form 188), signed by the driller.**
 3. Permit is void if project not begun within 90 days of approval date.

APPLICANT Name Closure Solutions (Roger Hoffmore)
Email rhoffmore@closureolutions.com Fax (925) 459-5602
Address 1243 Oak Knoll Drive Phone (916) 983-5604
City Concord Zip 94521

- B. WATER SUPPLY WELLS
 1. Minimum surface seal diameter is four inches greater than the well casing diameter.
 2. Minimum seal depth is 50 feet for municipal and industrial wells or 20 feet for domestic and irrigation wells unless a lesser depth is specially approved.
 3. Grout placed by tremie.
 4. An access port at least 0.5 inches in diameter is required on the wellhead for water level measurements.
 5. A sample port is required on the discharge pipe near the wellhead.

TYPE OF PROJECT:

Well Construction	9	Geotechnical Investigation	9
Well Destruction	9	Contamination Investigation	9
Cathodic Protection	9	Other _____	9

- C. GROUNDWATER MONITORING WELLS INCLUDING PIEZOMETERS
 1. Minimum surface seal diameter is four inches greater than the well or piezometer casing diameter.
 2. Minimum seal depth for monitoring wells is the maximum depth practicable or 20 feet.
 3. Grout placed by tremie.

PROPOSED WELL USE:

Domestic	9	Irrigation	9
Municipal	9	Remediation	9
Industrial	9	Groundwater Monitoring	9
Dewatering	9	Other _____	9

DRILLING METHOD:
Mud Rotary 9 Air Rotary 9 Hollow Stem Auger 9
Cable Tool 9 Direct Push 9 Other Pressuregrout

- D. GEOTECHNICAL. Backfill bore hole with compacted cuttings or heavy bentonite and upper two feet with compacted material. In areas of known or suspected contamination, tremied cement grout shall be used in place of compacted cuttings.

DRILLING COMPANY Gregg Drilling & Testing

DRILLER'S LICENSE NO. 485165 C-57

WELL SPECIFICATIONS:
Drill Hole Diameter 8 in. Maximum Depth 35 ft.
Casing Diameter 2 in. Number 5 wells
Surface Seal Depth 16 ft. MW-1 to MW-5

SOIL BORINGS:
Number of Borings _____ Maximum Hole Diameter _____ in. Depth _____ ft.

ESTIMATED STARTING DATE August/September 2008
ESTIMATED COMPLETION DATE September 2008

- E. CATHODIC. Fill hole above anode zone with concrete placed by tremie.
- F. WELL DESTRUCTION. See attached.
- G. SPECIAL CONDITIONS. Submit to Zone 7 within 60 days after completion of permitted work the well installation report **including all soil and water laboratory analysis results.**

I hereby agree to comply with all requirements of this permit and Alameda County Ordinance No. 73-68.

APPLICANT'S SIGNATURE Roger Hoffmore Date 8/5/08
Roger Hoffmore

Approved Wyman Hong Date 8/26/08
Wyman Hong

ATTACH SITE PLAN OR SKETCH

August 28, 2008

**Zone 7
Water Resources Engineering
Groundwater Protection Ordinance**

**New West Petroleum
1051 Airway Boulevard
Livermore**

**Wells 3S/1E-1F3 (MW-1), 3S/1E-1F4 (MW-2), 3S/1E-1F5 (MW-3) &
3S/1E-1F6 (MW-4) and 3S/1E-1F7 (MW-5)
Permit 28116**

Destruction Requirements:

1. Clean out all bridged or poorly compacted materials to the bottom of the well.
2. Sound the well as deeply as practicable and record for your report.
3. Pressure grout the casing to two feet below the finished grade or original ground, whichever is the lower elevation.
4. Remove the casing, seal, and gravel pack to two feet below the finished grade or original ground, whichever is the lower elevation (optional).
5. After the seal has set, backfill the remaining hole with compacted material (optional).

ATTACHMENT C

DWR WELL DESTRUCTION LOGS

CONFIDENTIAL

STATE OF CALIFORNIA DWR
WELL COMPLETION REPORT
(WELL LOGS)

REMOVED

CONFIDENTIAL

STATE OF CALIFORNIA DWR
WELL COMPLETION REPORT
(WELL LOGS)

REMOVED

CONFIDENTIAL

**STATE OF CALIFORNIA DWR
WELL COMPLETION REPORT
(WELL LOGS)**

REMOVED

CONFIDENTIAL

STATE OF CALIFORNIA DWR
WELL COMPLETION REPORT
(WELL LOGS)

REMOVED

CONFIDENTIAL

STATE OF CALIFORNIA DWR
WELL COMPLETION REPORT
(WELL LOGS)

REMOVED

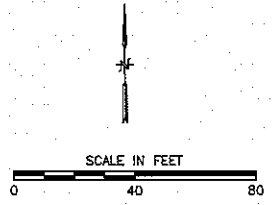
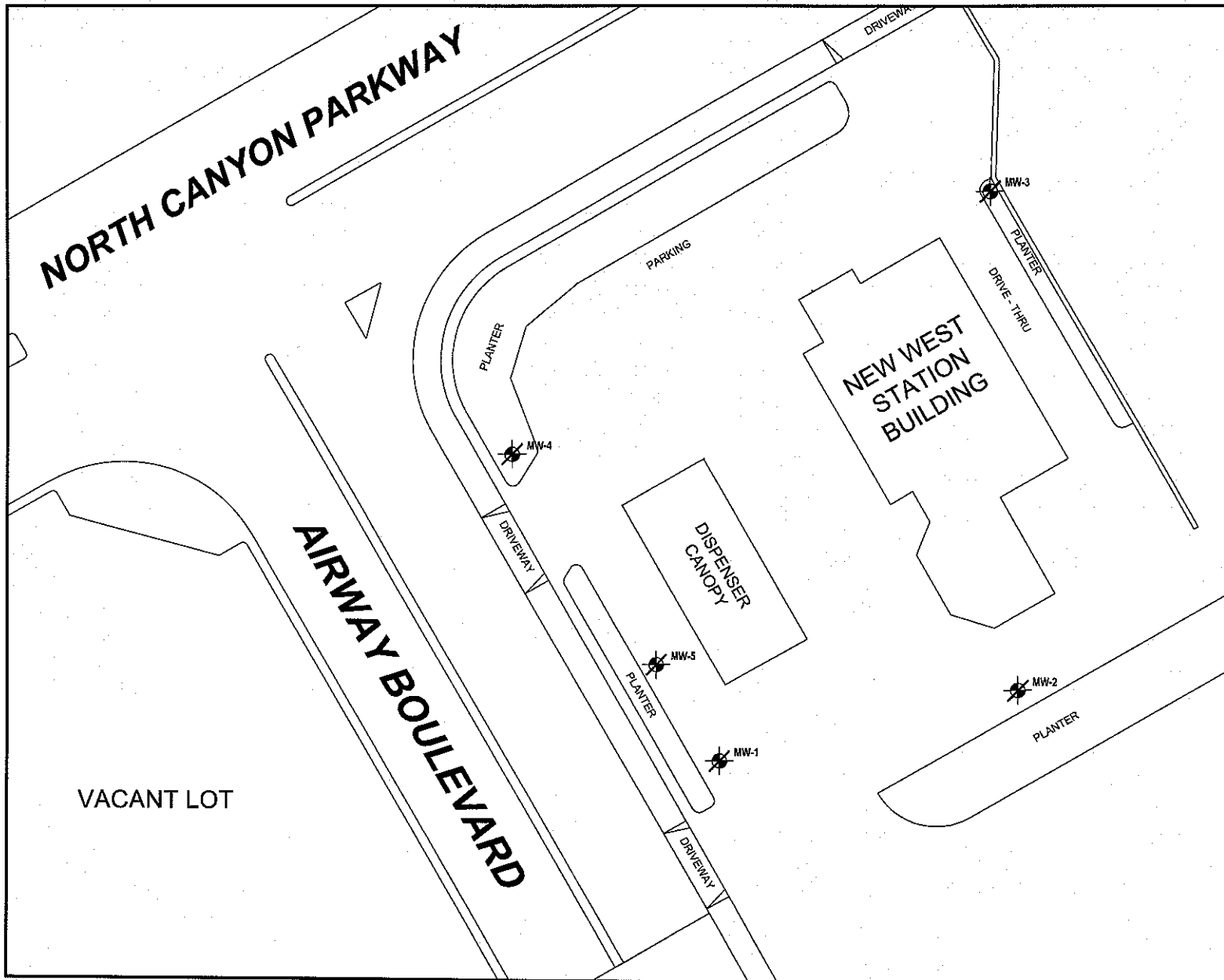

LEGEND:

 DESTROYED GROUNDWATER MONITORING WELL

NOTES:

1. BASEMAP SOURCE: GOOGLE EARTH
2. WELL COORDINATE DATA: VIRGIL CHAVEZ LAND SURVEYING, 3/19/07

FIGURE 2

SITE MAP

SEPTEMBER 2008

NEW WEST STATIONS, INC.
1051 AIRWAY BLVD
LIVERMORE, CA

 **CLOSURE SOLUTIONS, INC.**
1243 Oak Knoll Drive • Concord
California • 94521
Phone: (925) 429-5555 • Fax: (925) 459-5602

CONFIDENTIAL

STATE OF CALIFORNIA DWR
WELL COMPLETION REPORT
(WELL LOGS)

REMOVED