

RECEIVED

By Alameda County Environmental Health at 2:39 pm, Apr 30, 2014

Atlantic Richfield Company

Chuck Carmel
Project Manager

PO Box 1257
San Ramon, CA 94583
Phone: (925) 275-3803
Fax: (925) 275-3815
E-Mail: charles.carmel@bp.com

April 25, 2014

Re: First Quarter 2014 Status Report
Atlantic Richfield Company Station #4977
2770 Castro Valley Boulevard, Castro Valley, California
ACEH Case #RO0002436

"I declare, that to the best of my knowledge at the present time, that the information and/or recommendations contained in the attached document are true and correct.

Submitted by,



Chuck Carmel
Project Manager

Attachment



**FIRST QUARTER 2014 STATUS REPORT
Atlantic Richfield Company Station #4977
2770 Castro Valley Blvd.
Castro Valley, Alameda County, California**

Prepared for:

Mr. Chuck Carmel
Atlantic Richfield Company
P.O. Box 1257
San Ramon, CA 94583

Prepared by:

Broadbent & Associates, Inc.
1370 Ridgewood Dr., Suite 5
Chico, California 95973
(530) 566-1400

April 25, 2014

No. 06-82-625



BROADBENT

1370 Ridgewood Drive, Suite 5, Chico, CA 95973

[T] 530-566-1400 [F] 530-566-1401

broadbentinc.com

CREATING SOLUTIONS. BUILDING TRUST.

April 25, 2014

Project No. 06-82-625

Atlantic Richfield Company
P.O. Box 1257
San Ramon, California 94583
Submitted via ENFOS

Attn.: Mr. Chuck Carmel

Re: First Quarter 2014 Status Report, Atlantic Richfield Company Station #4977
2770 Castro Valley Blvd, Castro Valley, California; ACEH Case #RO0002436

Dear Mr. Carmel:

Provided herein is the *First Quarter 2014 Status Report* for Atlantic Richfield Company (a BP affiliated company) Station #4977 located at 2770 Castro Valley Blvd., Castro Valley, Alameda County, California (Site). This report presents a summary of current developments regarding the Site through the First Quarter 2014.

Should you have questions regarding this submission, please do not hesitate to contact us at (530) 566-1400.

Sincerely,

BROADBENT & ASSOCIATES, INC.

Jason Duda
Senior Scientist

Robert H. Miller, P.G., C.HG.
Principal Hydrogeologist

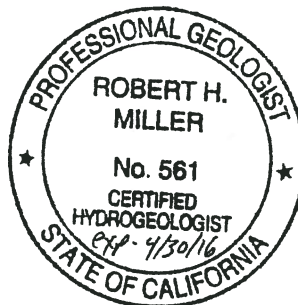

Enclosures

cc: Ms. Karel Detterman, ACEH (Submitted via ACEH ftp Site)
GeoTracker

**FIRST QUARTER 2014 STATUS REPORT
STATION #4977, CASTRO VALLEY, CA**

Broadbent & Associates, Inc. (Broadbent) is pleased to present this *First Quarter 2014 Status Report* on behalf of Atlantic Richfield Company (a BP affiliated company) for Station #4977 located in Castro Valley, Alameda County, California. Reporting is being submitted to the Alameda County Environmental Health Services Agency (ACEH) consistent with their requirements under the legal authority of the California Regional Water Quality Control Board as codified by California Code of Regulations Title 23, Section 2652(d). A summary description of current developments regarding the site is provided below.

Facility Name / Address:	Station #4977 / 2770 Castro Valley Boulevard, Castro Valley, CA
Client Project Manager / Title:	Mr. Chuck Carmel / Project Manager
Broadbent Contact:	Jason Duda, (530) 566-1400
Broadbent Project No.:	06-82-625
Primary Regulatory Agency / ID No.:	ACEH, Case #RO0002436
Current phase of project:	Case Closure Evaluation
List of Acronyms / Abbreviations:	See end of report text for list of acronyms/abbreviations used in report.

WORK PERFORMED THIS QUARTER (First Quarter 2014):

1. Prepared and submitted the *Fourth Quarter 2013 Semi-Annual Groundwater Monitoring Report* (Broadbent, 1/27/2014).
2. Prepared and submitted the *Conceptual Site Model and Case Closure Request* (Broadbent, 3/26/2014)
3. No environmental work was conducted at the Site during First Quarter 2014.

WORK PROPOSED FOR NEXT QUARTER (Second Quarter 2014):

1. Prepared and submitted this *First Quarter 2014 Status Report* (contained herein).
2. Upon receipt of case closure acceptance, prepare for and conduct well abandonment activities.

GROUNDWATER MONITORING PLAN SUMMARY:

Groundwater level gauging:	Ceased due to case closure eval.
Groundwater sample collection:	Ceased due to case closure eval.
Biodegradation indicator parameter monitoring:	NA

DISCUSSION:

No environmental field activities were conducted at the Site during First Quarter 2014. For reference, a Site Location Map is provided as Drawing 1. Provided as Drawing 2 is the Groundwater Elevation Contour and Analytical Summary Map from the *Fourth Quarter 2013 Semi-Annual Groundwater Monitoring Report* (Broadbent, 1/27/2014) for groundwater monitoring/sampling conducted on October 9, 2013.

On March 26, 2014, Broadbent submitted the *Conceptual Site Model and Case Closure Request* for Station #4977. A response from ACEH regarding this report has not yet been received. In the interim, it is requested that conduct of semi-annual groundwater monitoring and sampling activities cease during the case closure evaluation process. Previously scheduled groundwater monitoring and sampling for Second Quarter 2014 will not be completed unless otherwise directed by ACEH.

ATTACHMENTS:

- Drawing 1 Site Location Map, Station #4977, 2770 Castro Valley Boulevard, Castro Valley, California
- Drawing 2. Groundwater Elevation Contour and Analytical Summary Map, Fourth Quarter 2013, Station #4977, 2770 Castro Valley Boulevard, Castro Valley, California

LIST OF COMMONLY USED ACCRONYMS/ABBREVIATIONS:

ACEH:	Alameda County Environmental Health	gal:	Gallons
BTEX:	Benzene, Toluene, Ethylbenzene, Total Xylenes	GRO:	Gasoline-Range Organics
1,2-DCA:	1,2-Dichloroethane	LNAPL:	Light Non-Aqueous Phase Liquid
DIPE:	Di-Isopropyl Ether	MTBE:	Methyl Tertiary Butyl Ether
DO:	Dissolved Oxygen	NO ₃ :	Nitrate as Nitrogen
DRO:	Diesel-Range Organics	ppb:	parts per billion
EDB:	1,2-Dibromomethane	SO ₄ :	Sulfate
ft/ft:	feet per foot		

DRAWINGS

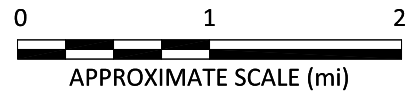

IMAGE SOURCE: DELORME



1370 Ridgewood Dr., Suite 5
Chico, California 95973

Project No.: 06-82-625 Date: 11/29/2012

Station #4977
2770 Castro Valley Blvd.
Castro Valley, California

Site Location Map

Drawing

1

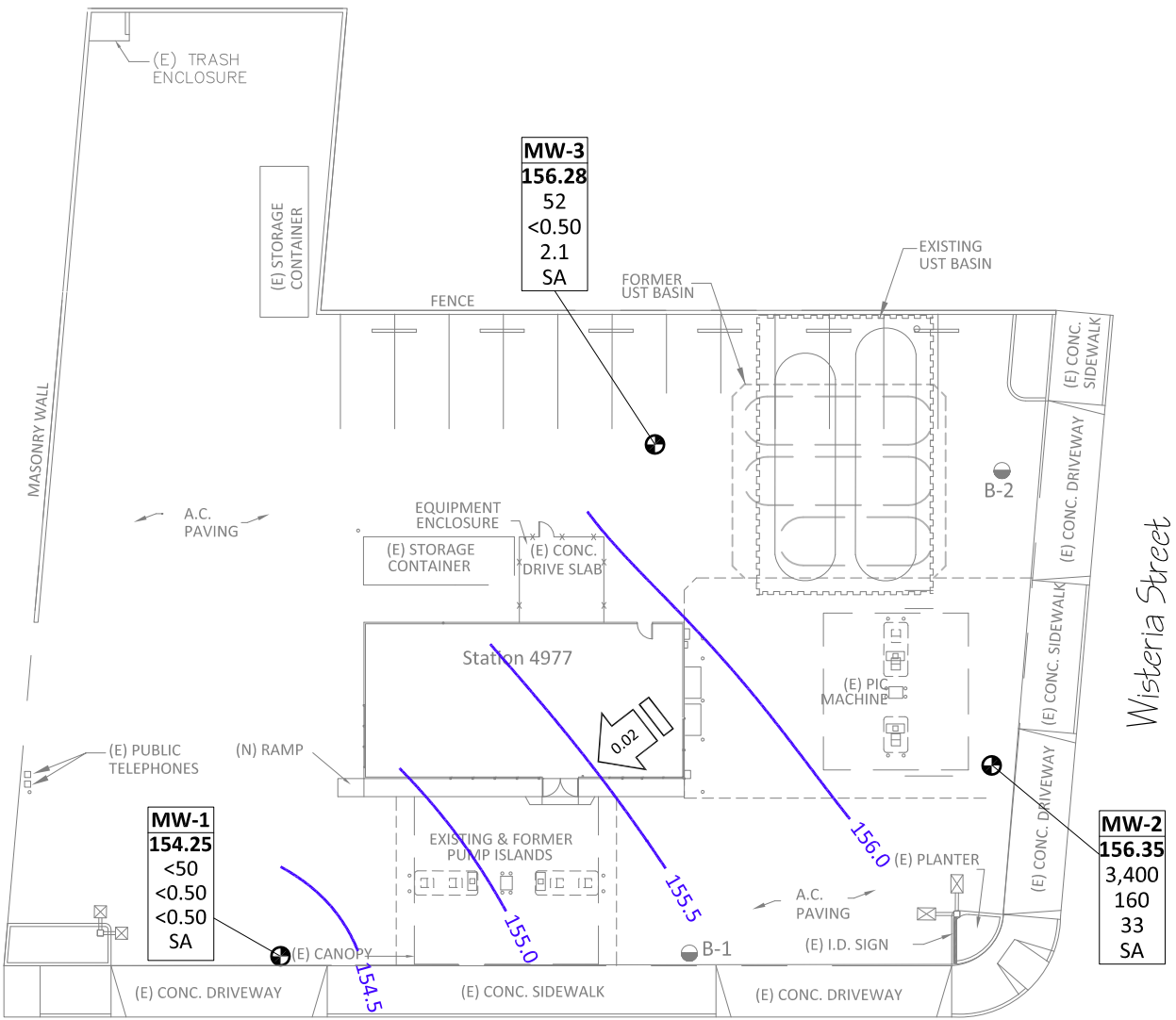

NOTE: SITE MAP ADAPTED FROM DELTA ENVIRONMENTAL FIGURES. SITE DIMENSIONS AND FACILITY LOCATIONS NOT VERIFIED.

Castro Valley Blvd.

LEGEND

⊕ Monitor Well Location

● Soil Boring Location

Well	Well Designation
ELEV	Groundwater Elevation (ft.)
GRO	Concentration of GRO, Benzene and MTBE in Groundwater (µg/L)
BZ	
MTBE	
SA	Sampling Frequency

< Not Detected at or Above Laboratory Reporting Limits

SA Sampled Semi-Annually

155.0 Groundwater Elevation Contour (ft)

0.02 Approximate Groundwater Gradient (ft/ft)

