

Atlantic Richfield Company

Shannon Couch
Project Manager

PO Box 1257
San Ramon, CA 94583
Phone: (925) 275-3804
Fax: (925) 275-3815
E-Mail: shannon.couch@bp.com

April 30, 2013

RECEIVED

By Alameda County Environmental Health at 10:56 am, May 01, 2013

Re: First Quarter 2013 Status Report
Atlantic Richfield Company Station #4977
2770 Castro Valley Boulevard, Castro Valley, California
ACEH Case #RO0002436

"I declare, that to the best of my knowledge at the present time, that the information and/or recommendations contained in the attached document are true and correct.

Submitted by,

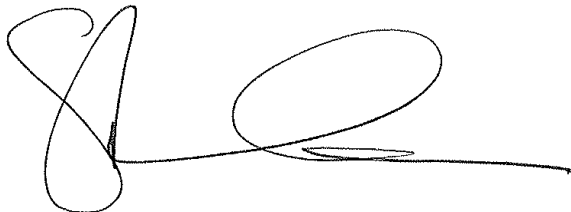

Shannon Couch
Project Manager

Attachment



**FIRST QUARTER 2013 STATUS REPORT
Atlantic Richfield Company Station #4977
2770 Castro Valley Blvd.
Castro Valley, Alameda County, California**

Prepared for:

Ms. Shannon Couch
Atlantic Richfield Company
P.O. Box 1257
San Ramon, CA 94583

Prepared by:

Broadbent & Associates, Inc.
1370 Ridgewood Drive, Suite 5
Chico, California 95973
(530) 566-1400

April 30, 2013

No. 06-82-625



BROADBENT

1370 Ridgewood Drive, Suite 5, Chico, CA 95973

[T] 530-566-1400 [F] 530-566-1401

broadbentinc.com

CREATING SOLUTIONS. BUILDING TRUST.

April 30, 2013

Project No. 06-82-625

Atlantic Richfield Company
P.O. Box 1257
San Ramon, California 94583
Submitted via ENFOS

Attn.: Ms. Shannon Couch

Re: First Quarter 2013 Status Report, Atlantic Richfield Company Station #4977
2770 Castro Valley Blvd, Castro Valley, California; ACEH Case #RO0002436

Dear Ms. Couch:

Provided herein is the *First Quarter 2013 Status Report* for Atlantic Richfield Company (a BP affiliated company) Station #4977 located at 2770 Castro Valley Blvd., Castro Valley, Alameda County, California (Site). This report presents a summary of current developments regarding the Site through the First Quarter 2013.

Should you have questions regarding this submission, please do not hesitate to contact us at (530) 566-1400.

Sincerely,

BROADBENT & ASSOCIATES, INC.

Jason Duda
Project Scientist

Matthew G. Herrick, P.G., C.HG.
Senior Hydrogeologist

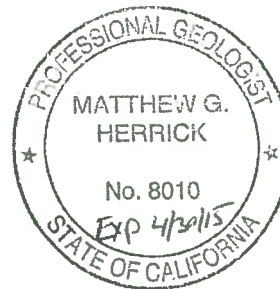

Enclosures

cc: Ms. Dilan Roe, ACEH (Submitted via ACEH ftp Site)
GeoTracker

**FIRST QUARTER 2013
STATUS REPORT
STATION #4977, CASTRO VALLEY, CA**

Broadbent & Associates, Inc. (Broadbent) is pleased to present this *First Quarter 2013 Status Report* on behalf of Atlantic Richfield Company (a BP affiliated company) for Station #4977 located in Castro Valley, Alameda County, California. Reporting is being submitted to the Alameda County Environmental Health Services Agency (ACEH) consistent with their requirements under the legal authority of the California Regional Water Quality Control Board as codified by California Code of Regulations Title 23, Section 2652(d). A summary description of current developments regarding the site is provided below.

Facility Name / Address:	<u>Station #4977 / 2770 Castro Valley Boulevard, Castro Valley, CA</u>
Client Project Manager / Title:	<u>Ms. Shannon Couch / Project Manager</u>
Broadbent Contact:	<u>Jason Duda, (530) 566-1400</u>
Broadbent Project No.:	<u>06-82-625</u>
Primary Regulatory Agency / ID No.:	<u>ACEH, Case #RO0002436</u>
Current phase of project:	<u>Monitoring and Additional Site Assessment</u>
List of Acronyms / Abbreviations:	<u>See end of report text for list of acronyms/abbreviations used in report.</u>

WORK PERFORMED THIS QUARTER (First Quarter 2013):

1. Prepared and submitted the *Fourth Quarter 2012 Semi-Annual Groundwater Monitoring Report* (Broadbent, 1/11/2013).
2. No environmental work was conducted at the Site during First Quarter 2013.

WORK PROPOSED FOR NEXT QUARTER (Second Quarter 2013):

1. Prepared and submitted this *First Quarter 2013 Status Report* (contained herein).
2. Conduct semi-annual groundwater monitoring/sampling for Second Quarter 2013.
3. Prepare and submit On-Site Soil and Groundwater Investigation Work Plan.

GROUNDWATER MONITORING PLAN SUMMARY:

Groundwater level gauging:	<u>MW-1 through MW-3</u>	(2Q & 4Q)
Groundwater sample collection:	<u>MW-1 through MW-3</u>	(2Q & 4Q)
Biodegradation indicator parameter monitoring:	<u>NA</u>	

DISCUSSION:

No environmental field activities were conducted at the Site during First Quarter 2013. For reference, a Site Location Map is provided as Drawing 1. Provided as Drawing 2 is the Groundwater Elevation Contour and Analytical Summary Map from the *Fourth Quarter 2012 Semi-Annual Groundwater Monitoring Report* (Broadbent, 1/11/2013) for groundwater monitoring/sampling conducted on October 9, 2012. The next groundwater monitoring/sampling event is scheduled to be conducted during Second Quarter 2013.

Recent review of Site data suggests that current contaminant concentrations observed on-Site are relatively low and appear to meet the requirements for low-threat closure. However, groundwater

samples could not be collected during the additional on-Site investigation conducted in 2011, presumably due to the predominant stiff clays observed during borehole advancement. Based on a cursory review of sites within the vicinity of Station #4977 listed on the GeoTracker database and the lack of groundwater observed during the on-Site investigation, it appears that the existing wells at the Site may be screened within a potentially perched water-bearing zone and the primary, shallow water-bearing zone may be present within a more transmissive stratigraphic layer of silty sand between approximately 25 and 30 feet bgs. It is anticipated that an On-Site Groundwater Investigation Work Plan will be prepared and submitted during Second Quarter 2013 in order to further investigate groundwater properties and concentrations at the Site.

ATTACHMENTS:

- Drawing 1 Site Location Map, Station #4977, 2770 Castro Valley Boulevard, Castro Valley, California
- Drawing 2. Groundwater Elevation Contour and Analytical Summary Map, October 9, 2012,
Station #4977, 2770 Castro Valley Boulevard, Castro Valley, California

LIST OF COMMONLY USED ACRONYMS/ABBREVIATIONS:

ACEH:	Alameda County Environmental Health	gal:	Gallons
BTEX:	Benzene, Toluene, Ethylbenzene, Total Xylenes	GRO:	Gasoline-Range Organics
1,2-DCA:	1,2-Dichloroethane	LNAPL:	Light Non-Aqueous Phase Liquid
DIPE:	Di-Isopropyl Ether	MTBE:	Methyl Tertiary Butyl Ether
DO:	Dissolved Oxygen	NO ₃ :	Nitrate as Nitrogen
DRO:	Diesel-Range Organics	ppb:	parts per billion
EDB:	1,2-Dibromomethane	SO ₄ :	Sulfate
ft/ft:	feet per foot		

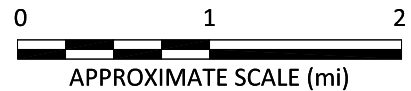

IMAGE SOURCE: DELORME



1370 Ridgewood Dr., Suite 5
Chico, California 95973

Project No.: 06-82-625 Date: 11/29/2012

Station #4977
2770 Castro Valley Blvd.
Castro Valley, California

Site Location Map

Drawing

1

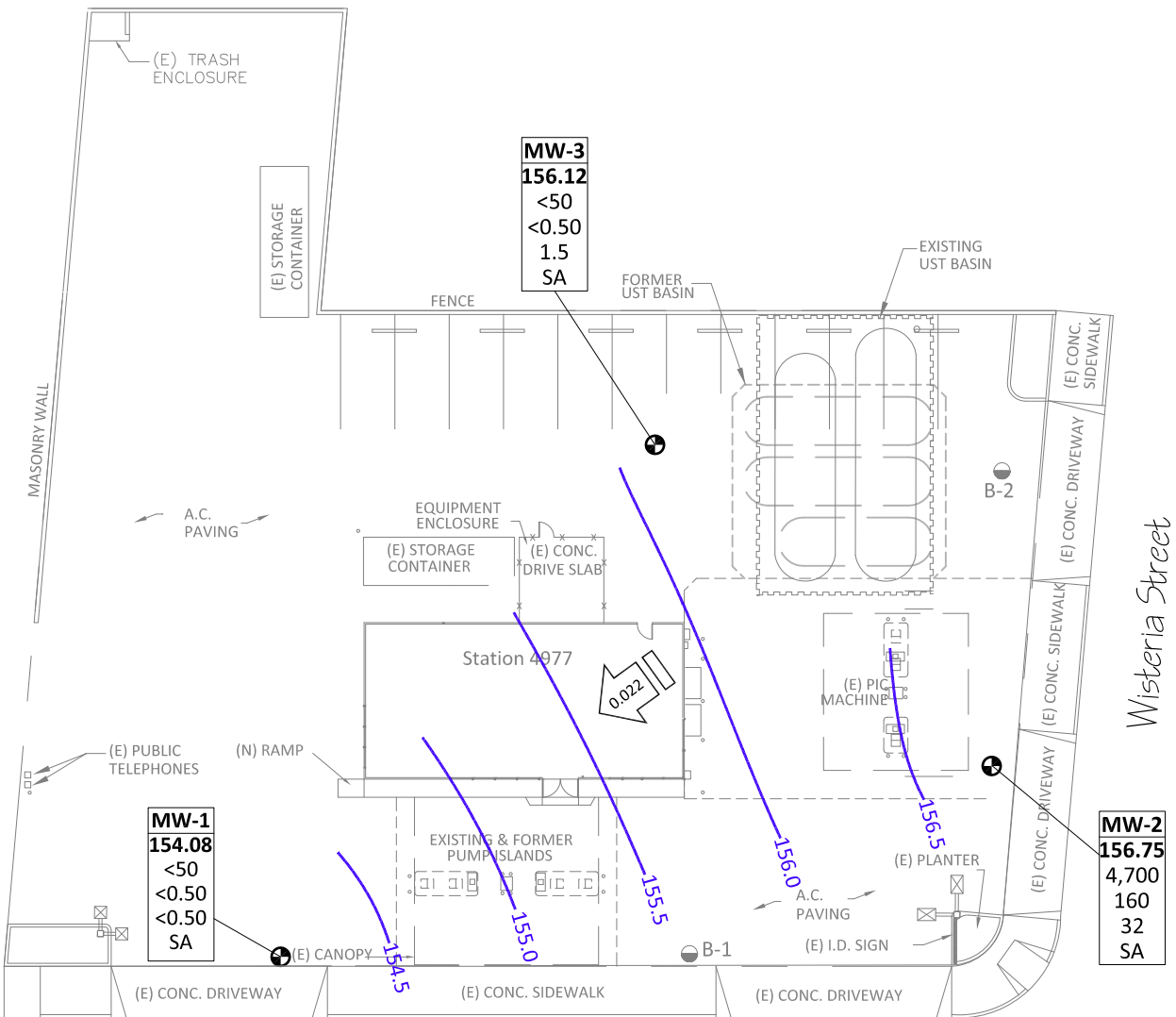

NOTE: SITE MAP ADAPTED FROM DELTA ENVIRONMENTAL FIGURES.
SITE DIMENSIONS AND FACILITY LOCATIONS NOT VERIFIED.

Castro Valley Blvd.

Wisteria Street

LEGEND

- Monitor Well Location
- Soil Boring Location

Well	Well Designation
ELEV	Groundwater Elevation (ft.)
GRO	Concentration of GRO, Benzene and MTBE in Groundwater ($\mu\text{g/L}$)
BZ	
MTBE	
SA	Sampling Frequency

- < Not Detected at or Above Laboratory Reporting Limits
- A Sampled Annually
- SA Sampled Semi-Annually

155.0 Groundwater Elevation Contour (ft)

0.022 Approximate Groundwater Gradient (ft/ft)

