

Atlantic Richfield Company

Shannon Couch
Project Manager

PO Box 1257
San Ramon, CA 94583
Phone: (925) 275-3804
Fax: (925) 275-3815
E-Mail: shannon.couch@bp.com

RECEIVED

3:58 pm, Oct 28, 2011

Alameda County
Environmental Health

October 17, 2011

Re: Third Quarter 2011 Status Report
Atlantic Richfield Company Station #4977
2770 Castro Valley Boulevard, Castro Valley, California
ACEH Case #RO0002436

"I declare, that to the best of my knowledge at the present time, that the information and/or recommendations contained in the attached document are true and correct.

Submitted by,

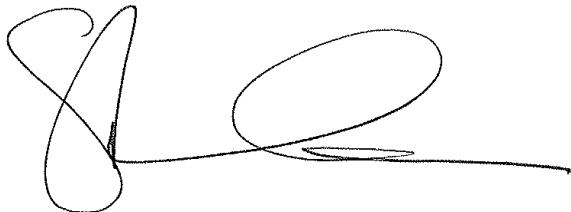

Shannon Couch
Project Manager

Attachment

THIRD QUARTER 2011 STATUS REPORT
Atlantic Richfield Company Station #4977
2770 Castro Valley Boulevard, Castro Valley, California
ACEH Case # RO0002436

Prepared for

Ms. Shannon Couch
Project Manager
Atlantic Richfield Company
P.O. Box 1257
San Ramon, California 94583

Prepared by



1324 Mangrove Avenue, Suite 212
Chico, California 95926
(530) 566-1400
www.broadbentinc.com

October 17, 2011

Project No. 06-82-625

Broadbent & Associates, Inc.
1324 Mangrove Ave. Suite 212
Chico, CA 95926
Voice (530) 566-1400
Fax (530) 566-1401

Creating Valuable Solutions, Building Trust



October 17, 2011

Project No. 06-82-625

Atlantic Richfield Company
P.O. Box 1257
San Ramon, California 94583
Submitted via ENFOS

Attn.: Ms. Shannon Couch

Re: Third Quarter 2011 Status Report, Atlantic Richfield Company Station #4977
2770 Castro Valley Blvd, Castro Valley, California; ACEH Case #RO0002436

Dear Ms. Couch:

Provided herein is the *Third Quarter 2011 Status Report* for Atlantic Richfield Company (a BP affiliated company) Station #4977 located at 2770 Castro Valley Blvd., Castro Valley, Alameda County, California (Site). This report presents a summary of current developments regarding the Site through the Third Quarter 2011.

Should you have questions regarding this submission, please do not hesitate to contact us at (530) 566-1400.

Sincerely,

BROADBENT & ASSOCIATES, INC.

A handwritten signature in red ink that reads 'Jason Duda'.

Jason Duda
Project Scientist

A handwritten signature in black ink that reads 'Matt Herrick'.

Matthew G. Herrick, P.G., C.HG.
Senior Hydrogeologist

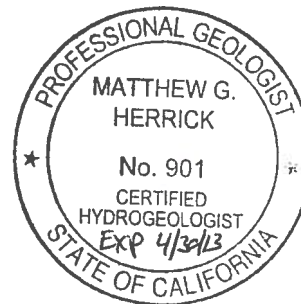

Enclosures

cc: Mr. Paresh Khatri, ACEH (Submitted via ACEH ftp Site)
GeoTracker

**THIRD QUARTER 2011
STATUS REPORT
STATION #4977, CASTRO VALLEY, CA**

Broadbent & Associates, Inc. (BAI) is pleased to present this *Third Quarter 2011 Status Report* on behalf of Atlantic Richfield Company (a BP affiliated company) for Station #4977 located in Castro Valley, Alameda County, California. Reporting is being submitted to the Alameda County Environmental Health Services Agency (ACEH) consistent with their requirements under the legal authority of the California Regional Water Quality Control Board as codified by California Code of Regulations Title 23, Section 2652(d). A summary description of current developments regarding the site is provided below.

Facility Name / Address:	<u>Station #4977 / 2779 Castro Valley Boulevard, Castro Valley, CA</u>
Client Project Manager / Title:	<u>Ms. Shannon Couch / Project Manager</u>
BAI Contact:	<u>Jason Duda, (530) 566-1400</u>
BAI Project No.:	<u>06-82-625</u>
Primary Regulatory Agency / ID No.:	<u>ACEH, Case #RO0002436</u>
Current phase of project:	<u>Monitoring and On-site Assessment</u>
List of Acronyms / Abbreviations:	<u>See end of report text for list of acronyms/abbreviations used in report.</u>

WORK PERFORMED THIS QUARTER (Third Quarter 2011):

1. Prepared and submitted the *Second Quarter 2011 Semi-Annual Groundwater Monitoring Report* (BAI, 7/29/2011).
2. Conducted on-site soil and groundwater investigation on September 23, 2011.

WORK PROPOSED FOR NEXT QUARTER (Fourth Quarter 2011):

1. Prepared and submitted this *Third Quarter 2011 Status Report* (contained herein).
2. Prepare and submit On-Site Soil and Groundwater Investigation Report.
3. Conduct semi-annual groundwater monitoring/sampling for Fourth Quarter 2011.

GROUNDWATER MONITORING PLAN SUMMARY:

Groundwater level gauging:	<u>MW-1 through MW-3</u>	(2Q & 4Q)
Groundwater sample collection:	<u>MW-1 through MW-3</u>	(2Q & 4Q)
Biodegradation indicator parameter monitoring:	<u>NA</u>	

DISCUSSION:

On-site soil and groundwater investigation activities took place at the Site during Third Quarter 2011. Results from this investigation will be submitted under separate cover during Fourth Quarter 2011. For reference, a Site Location Map is provided as Drawing 1. Provided as Drawing 2 is the Groundwater Elevation Contour and Analytical Summary Map from the *Second Quarter 2011 Semi-Annual Groundwater Monitoring Report* (BAI, 7/29/2011) for groundwater monitoring/sampling conducted on May 17, 2011. The next groundwater monitoring/sampling event is scheduled to be conducted during Fourth Quarter 2011.

ATTACHMENTS:

- Drawing 1 Site Location Map, Station #4977, 2770 Castro Valley Boulevard, Castro Valley, California
- Drawing 2. Groundwater Elevation Contour and Analytical Summary Map, May 17, 2011, Station #4977, 2770 Castro Valley Boulevard, Castro Valley, California

LIST OF COMMONLY USED ACCRONYMS/ABBREVIATIONS:

ACEH:	Alameda County Environmental Health	ft/ft:	feet per foot
BAI:	Broadbent & Associates, Inc.	gal:	Gallons
BTEX:	Benzene, Toluene, Ethylbenzene, Total Xylenes	GRO:	Gasoline-Range Organics
1,2-DCA:	1,2-Dichloroethane	LNAPL:	Light Non-Aqueous Phase Liquid
DIPE:	Di-Isopropyl Ether	MTBE:	Methyl Tertiary Butyl Ether
DO:	Dissolved Oxygen	NO ₃ :	Nitrate as Nitrogen
DRO:	Diesel-Range Organics	ppb:	parts per billion
EDB:	1,2-Dibromomethane	SO ₄ :	Sulfate

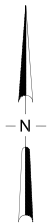

APPROXIMATE SCALE (mi)

IMAGE SOURCE: DELORME

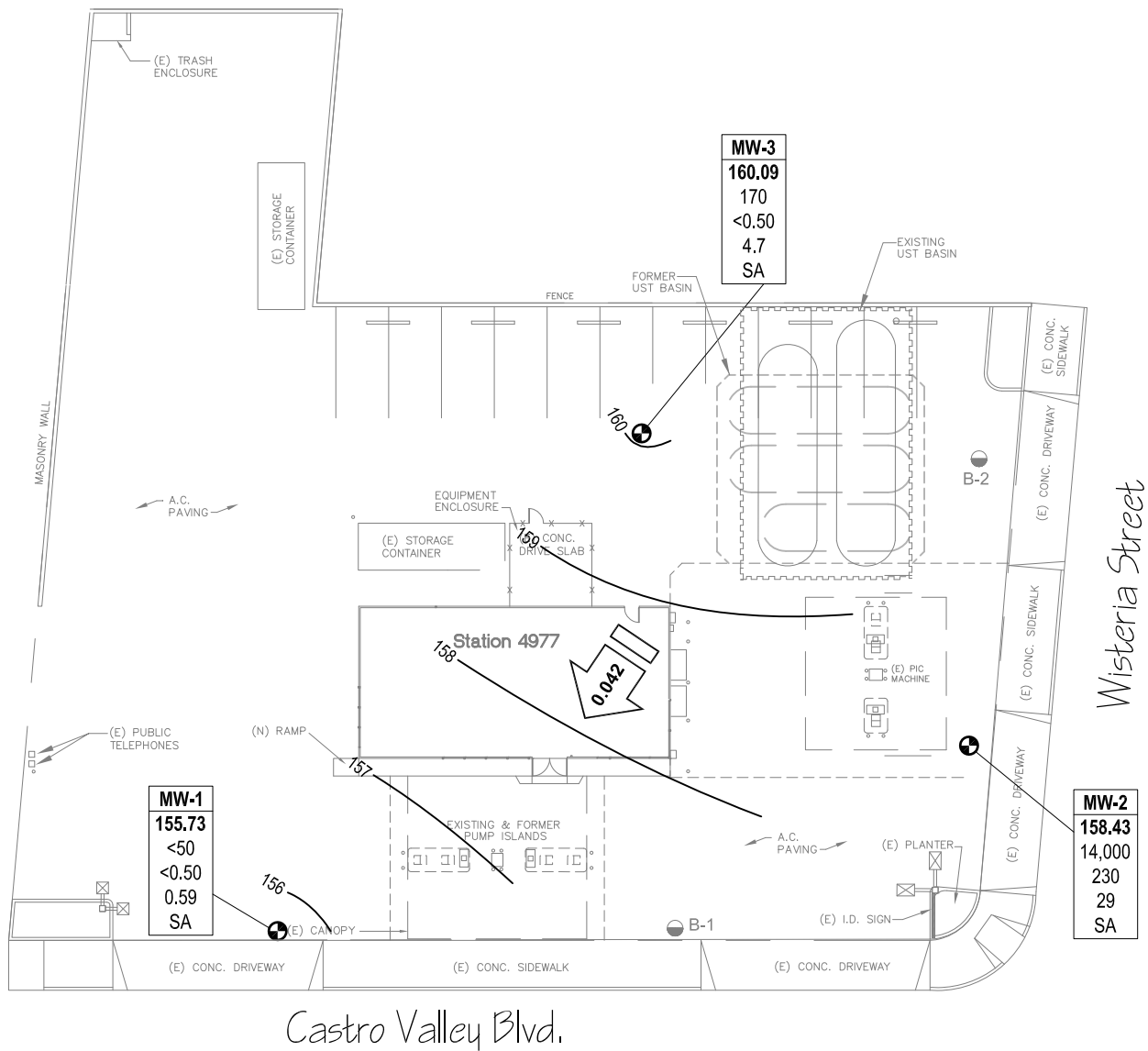

LEGEND

- MONITORING WELL
- SOIL BORING

Well	WELL DESIGNATION
ELEV	GROUND-WATER ELEVATION (FT)
GRO	CONCENTRATION OF GRO, BENZENE AND MTBE IN GROUND WATER ($\mu\text{g/L}$)
BZ	
MTBE	
Q	SAMPLING FREQUENCY

- < NOT DETECTED AT OR ABOVE LABORATORY REPORTING LIMITS
- SA SAMPLED SEMI-ANNUALLY (2ND AND 4TH QUARTERS)
- 156 GROUNDWATER ELEVATION CONTOUR (FT)
- GROUNDWATER GRADIENT (FT/FT)

NOTE: SITE MAP ADAPTED FROM DELTA ENVIRONMENTAL FIGURES. SITE DIMENSIONS AND FACILITY LOCATIONS NOT VERIFIED.

