

Atlantic Richfield Company

Shannon Couch
Project Manager

PO Box 1257
San Ramon, CA 94583
Phone: (925) 275-3804
Fax: (925) 275-3815
E-Mail: shannon.couch@bp.com

October 26, 2012

Re: Third Quarter 2012 Status Report
Atlantic Richfield Company Station #4977
2770 Castro Valley Boulevard, Castro Valley, California
ACEH Case #RO0002436

RECEIVED
1:51 pm, Nov 01, 2012
Alameda County
Environmental Health

"I declare, that to the best of my knowledge at the present time, that the information and/or recommendations contained in the attached document are true and correct.

Submitted by,

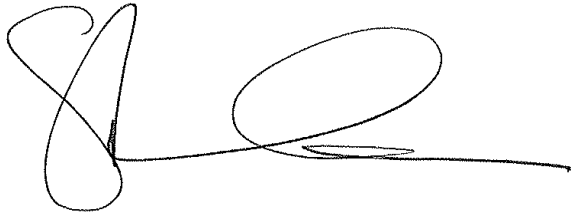

Shannon Couch
Project Manager

Attachment



THIRD QUARTER 2012 STATUS REPORT
Atlantic Richfield Company Station #4977
2770 Castro Valley Blvd.
Castro Valley, Alameda County, California

Prepared for:

Ms. Shannon Couch
Atlantic Richfield Company
P.O. Box 1257
San Ramon, CA 94583

Prepared by:

Broadbent & Associates, Inc.
1324 Mangrove Avenue, Suite 212
Chico, California 95926
(530) 566-1400

October 26, 2012

No. 06-82-625



BROADBENT

1324 Mangrove Ave., Suite 212, Chico, CA 95926

[T] 530-566-1400 [F] 530-566-1401

broadbentinc.com

Creating Solutions. Building Trust.

October 26, 2012

Project No. 06-82-625

Atlantic Richfield Company
P.O. Box 1257
San Ramon, California 94583
Submitted via ENFOS

Attn.: Ms. Shannon Couch

Re: Third Quarter 2012 Status Report, Atlantic Richfield Company Station #4977
2770 Castro Valley Blvd, Castro Valley, California; ACEH Case #RO0002436

Dear Ms. Couch:

Provided herein is the *Third Quarter 2012 Status Report* for Atlantic Richfield Company (a BP affiliated company) Station #4977 located at 2770 Castro Valley Blvd., Castro Valley, Alameda County, California (Site). This report presents a summary of current developments regarding the Site through the Third Quarter 2012.

Should you have questions regarding this submission, please do not hesitate to contact us at (530) 566-1400.

Sincerely,

BROADBENT & ASSOCIATES, INC.

Jason Duda
Project Scientist

Matthew G. Herrick, P.G., C.HG.
Senior Hydrogeologist

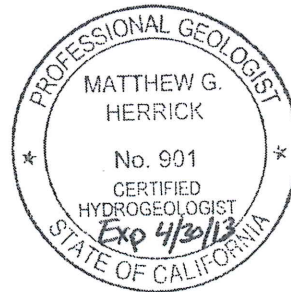

Enclosures

cc: Ms. Dilan Roe, ACEH (Submitted via ACEH ftp Site)
GeoTracker

**THIRD QUARTER 2012
STATUS REPORT
STATION #4977, CASTRO VALLEY, CA**

Broadbent & Associates, Inc. (Broadbent) is pleased to present this *Third Quarter 2012 Status Report* on behalf of Atlantic Richfield Company (a BP affiliated company) for Station #4977 located in Castro Valley, Alameda County, California. Reporting is being submitted to the Alameda County Environmental Health Services Agency (ACEH) consistent with their requirements under the legal authority of the California Regional Water Quality Control Board as codified by California Code of Regulations Title 23, Section 2652(d). A summary description of current developments regarding the site is provided below.

Facility Name / Address:	<u>Station #4977 / 2770 Castro Valley Boulevard, Castro Valley, CA</u>
Client Project Manager / Title:	<u>Ms. Shannon Couch / Project Manager</u>
Broadbent Contact:	<u>Jason Duda, (530) 566-1400</u>
Broadbent Project No.:	<u>06-82-625</u>
Primary Regulatory Agency / ID No.:	<u>ACEH, Case #RO0002436</u>
Current phase of project:	<u>Monitoring</u>
List of Acronyms / Abbreviations:	<u>See end of report text for list of acronyms/abbreviations used in report.</u>

WORK PERFORMED THIS QUARTER (Third Quarter 2012):

1. Prepared and submitted the *Second Quarter 2012 Semi-Annual Groundwater Monitoring Report* (Broadbent, 7/30/2012).
2. No environmental work was conducted at the Site during Third Quarter 2012.

WORK PROPOSED FOR NEXT QUARTER (Fourth Quarter 2012):

1. Prepared and submitted this *Third Quarter 2012 Status Report* (contained herein).
2. Conduct semi-annual groundwater monitoring/sampling for Fourth Quarter 2012.

GROUNDWATER MONITORING PLAN SUMMARY:

Groundwater level gauging:	<u>MW-1 through MW-3</u>	(2Q & 4Q)
Groundwater sample collection:	<u>MW-1 through MW-3</u>	(2Q & 4Q)
Biodegradation indicator parameter monitoring:	<u>NA</u>	

DISCUSSION:

No environmental field activities were conducted at the Site during Third Quarter 2012. For reference, a Site Location Map is provided as Drawing 1. Provided as Drawing 2 is the Groundwater Elevation Contour and Analytical Summary Map from the *Second Quarter 2012 Semi-Annual Groundwater Monitoring Report* (Broadbent, 7/30/2012) for groundwater monitoring/sampling conducted on April 10, 2012. The next groundwater monitoring/sampling event is scheduled to be conducted during Fourth Quarter 2012.

The *On-Site Soil and Groundwater Investigation Report* dated January 16, 2012 summarized that the lateral and vertical extent of petroleum hydrocarbon impacted soil has been adequately characterized. Recommendations within the report included preparation of a Conceptual Site Model in order to determine if case closure is appropriate for the Site.

ATTACHMENTS:

- Drawing 1 Site Location Map, Station #4977, 2770 Castro Valley Boulevard, Castro Valley, California
- Drawing 2. Groundwater Elevation Contour and Analytical Summary Map, April 10, 2012, Station #4977, 2770 Castro Valley Boulevard, Castro Valley, California

LIST OF COMMONLY USED ACCRONYMS/ABBREVIATIONS:

ACEH:	Alameda County Environmental Health	gal:	Gallons
BTEX:	Benzene, Toluene, Ethylbenzene, Total Xylenes	GRO:	Gasoline-Range Organics
1,2-DCA:	1,2-Dichloroethane	LNAPL:	Light Non-Aqueous Phase Liquid
DIPE:	Di-Isopropyl Ether	MTBE:	Methyl Tertiary Butyl Ether
DO:	Dissolved Oxygen	NO ₃ :	Nitrate as Nitrogen
DRO:	Diesel-Range Organics	ppb:	parts per billion
EDB:	1,2-Dibromomethane	SO ₄ :	Sulfate
ft/ft:	feet per foot		



APPROXIMATE SCALE (mi)

IMAGE SOURCE: DELORME

BROADBENT & ASSOCIATES, INC.
 ENGINEERING, WATER RESOURCES & ENVIRONMENTAL
 1324 Mangrove Ave. Suite 212, Chico, California 95926
 Project No.: 06-82-625 Date: 12/16/2009

Station #4977
 2770 Castro Valley Blvd.
 Castro Valley, California

Site Location Map

Drawing
1

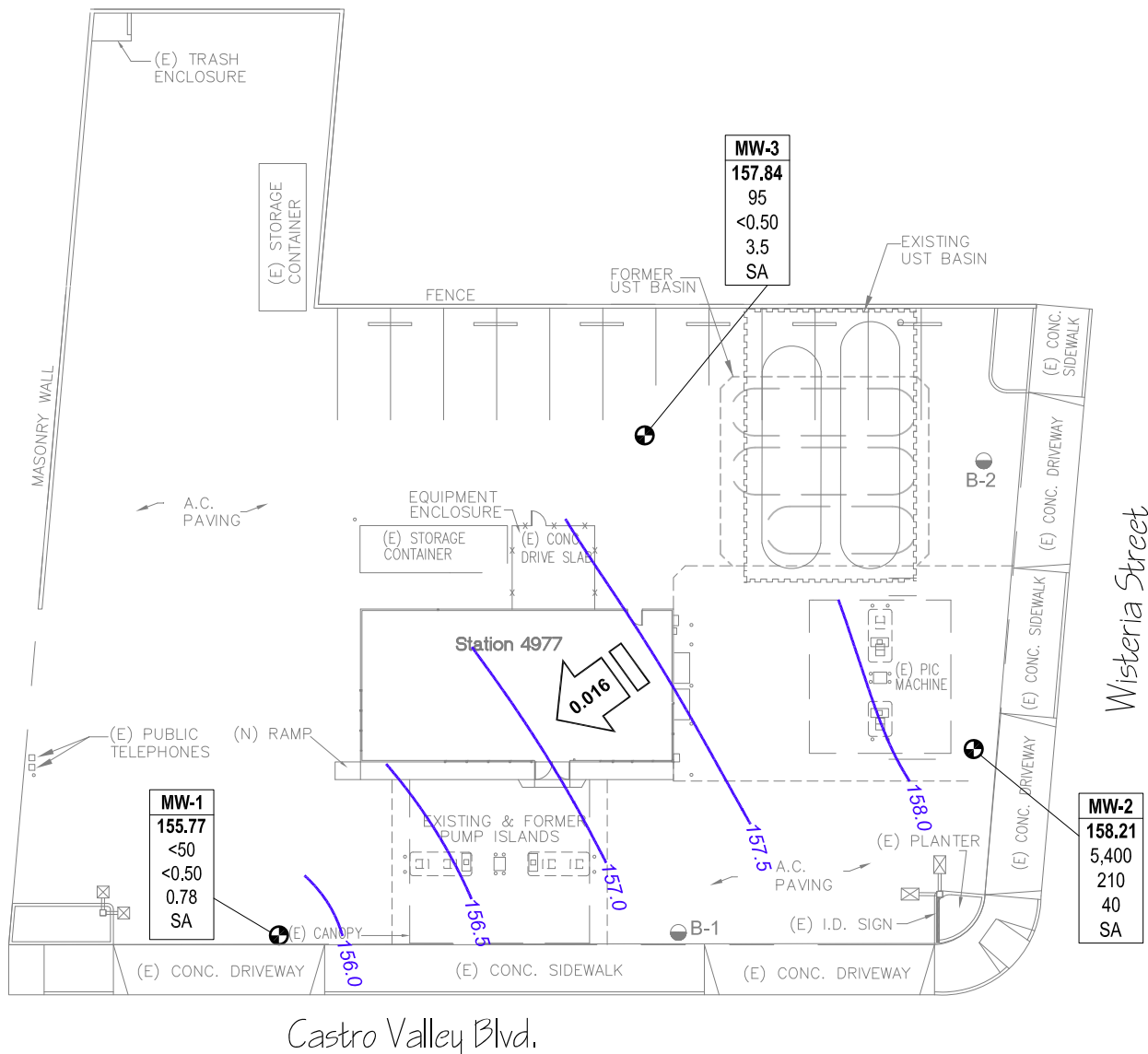

LEGEND

- MONITORING WELL
- SOIL BORING

Well	WELL DESIGNATION
ELEV	GROUND-WATER ELEVATION (FT)
GRO	CONCENTRATION OF GRO, BENZENE AND MTBE IN GROUND WATER (µg/L)
BZ	
MTBE	
SA	SAMPLING FREQUENCY

- < NOT DETECTED AT OR ABOVE LABORATORY REPORTING LIMITS
- A SAMPLED ANNUALLY
- SA SAMPLED SEMI-ANNUALLY (2ND AND 4TH QUARTERS)

- 156 GROUNDWATER ELEVATION CONTOUR (FT)
- 0.016 GROUNDWATER GRADIENT (FT/FT)

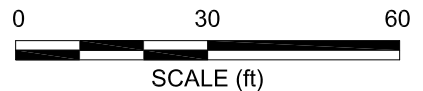

NOTE: SITE MAP ADAPTED FROM DELTA ENVIRONMENTAL FIGURES.
SITE DIMENSIONS AND FACILITY LOCATIONS NOT VERIFIED.