

RO 2435 ✓



J. Mark Inglis
Project Manager

**Retail & Terminal
Business Unit**
Chevron Environmental
Management Company
6001 Bollinger Canyon Road,
Room K2256
San Ramon, CA 94583-2324
Tel 925 842 1589
Fax 925 842 8370
jmark.inglis@chevrontexaco.
com

December 21, 2005

Alameda County
DEC 21 2005
Environmental Services

Alameda County Health Care Services
1131 Harbor Bay Parkway, Suite 250
Alameda, CA 94502-6577

Re: Chevron Service Station # 9-3600

Address: 2200 Telegraph Ave., Oakland, California

I have reviewed the attached routine groundwater monitoring report dated December 6, 2005.

I agree with the conclusions and recommendations presented in the referenced report. The information in this report is accurate to the best of my knowledge and all local Agency/Regional Board guidelines have been followed. This report was prepared by Gettler-Ryan, Inc., upon whose assistance and advice I have relied.

This letter is submitted pursuant to the requirements of California Water Code Section 13267(b)(1) and the regulating implementation entitled Appendix A pertaining thereto.

I declare under penalty of perjury that the foregoing is true and correct.

Sincerely,

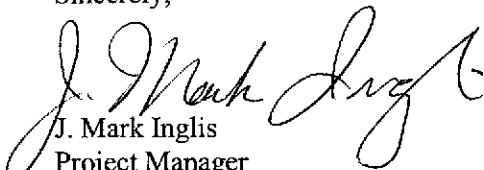
J. Mark Inglis
Project Manager

Enclosure: Report



GETTLER-RYAN INC.

TRANSMITTAL

December 6, 2005

G-R #386895

TO: Ms. Laura Genin
Cambria Environmental Technology, Inc.
5900 Hollis Street, Suite A
Emeryville, CA 94608

CC: Mr. Mark Inglis
ChevronTexaco Company
P.O. Box 6012, Room K2256
San Ramon, California 94583

FROM: Deanna L. Harding
Project Coordinator
Gettler-Ryan Inc.
6747 Sierra Court, Suite J
Dublin, California 94568

RE: **Chevron Service Station**
#9-3600
2200 Telegraph Avenue
Oakland, California
RO 0002435

DEC 21 2005
COMMUNICATIONS DEPARTMENT

WE HAVE ENCLOSED THE FOLLOWING:

COPIES	DATED	DESCRIPTION
1	December 5, 2005	Groundwater Monitoring and Sampling Report Fourth Quarter - Event of October 27, 2005

COMMENTS:

This report is being sent for your review. Please provide any comments/changes and propose any groundwater monitoring modifications for the next event prior to **December 20, 2005**, at which time the final report will be distributed to the following:

cc: Mr. Barney Chan, Alameda County Health Care Services, Dept. of Environmental Health, 1131 Harbor Bay Parkway, Suite 250, Alameda, CA 94502-6577

Enclosures



GETTLER-RYAN INC.

December 5, 2005
G-R Job #386895

Mr. Mark Inglis
ChevronTexaco Company
P.O. Box 6012, Room K2256
San Ramon, CA 94583

RE: Fourth Quarter Event of October 27, 2005
Groundwater Monitoring & Sampling Report
Chevron Service Station #9-3600
2200 Telegraph Avenue
Oakland, California

Dear Mr. Inglis:

This report documents the most recent groundwater monitoring and sampling event performed by Gettler-Ryan Inc. (G-R) at the referenced site. All field work was conducted in accordance with G-R Standard Operating Procedure - Groundwater Sampling (attached).

Static groundwater levels were measured and the wells were checked for the presence of separate-phase hydrocarbons. Static water level data, groundwater elevations, and separate-phase hydrocarbon thickness (if any) are presented in the attached Table 1. A Potentiometric Map is included as Figure 1.

Groundwater samples were collected from the monitoring wells and submitted to a state certified laboratory for analyses. The field data sheets for this event are attached. Analytical results are presented in the table(s) listed below. The chain of custody document and laboratory analytical report are also attached.

Please call if you have any questions or comments regarding this report. Thank you.

Sincerely,

Deanna L. Harding
Project Coordinator

Robert A. Lauritzen
Senior Geologist, P.G. No. 7504



- Figure 1: Potentiometric Map
- Table 1: Groundwater Monitoring Data and Analytical Results
- Table 2: Groundwater Analytical Results - Oxygenate Compounds
- Attachments: Standard Operating Procedure - Groundwater Sampling
Field Data Sheets
Chain of Custody Document and Laboratory Analytical Reports

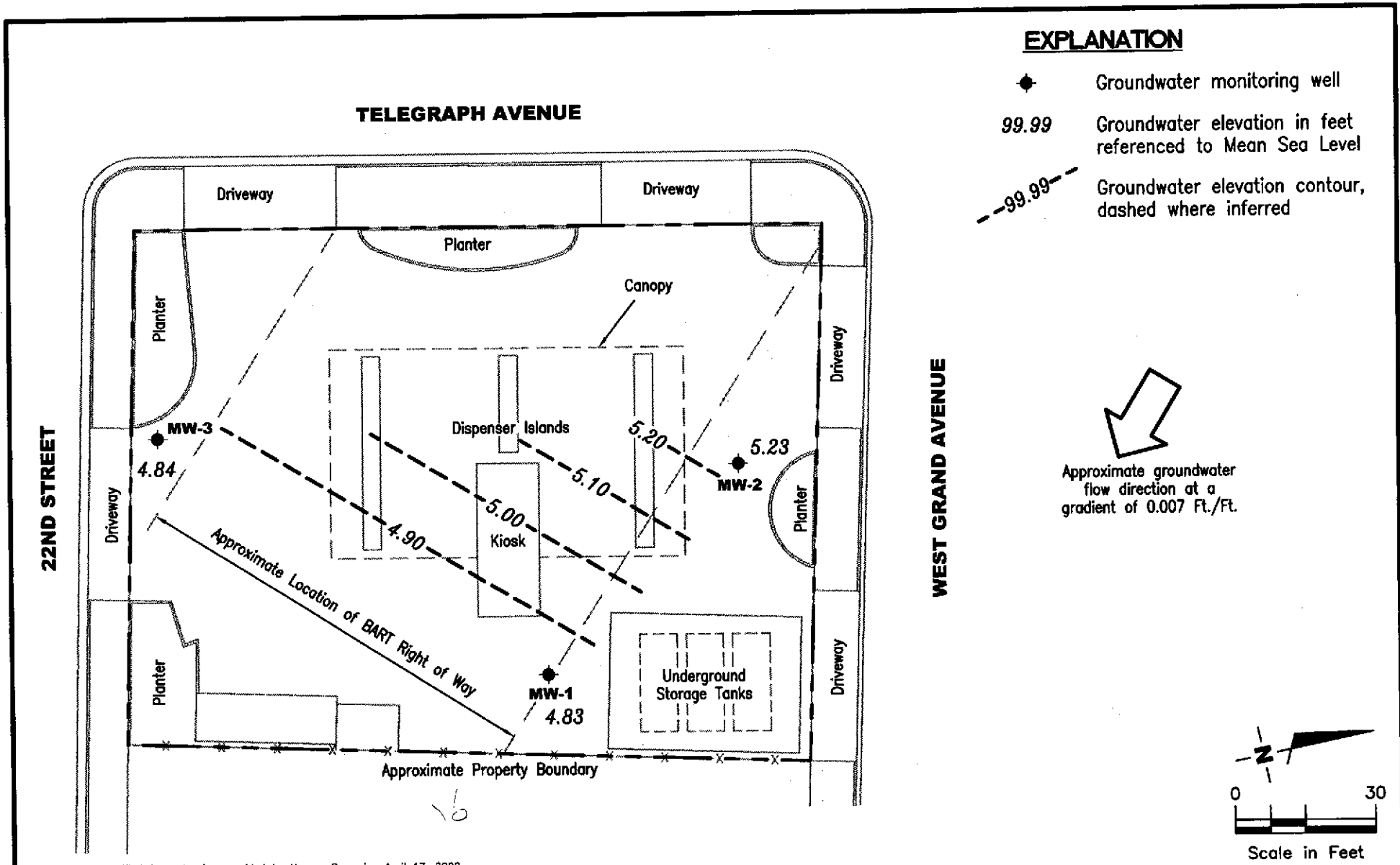

GETTLER - RYAN INC.
 6747 Sierra Court, Suite J
 Dublin, CA 94568 (925) 551-7555

POTENTIOMETRIC MAP
 Chevron Service Station #9-3600
 2200 Telegraph Avenue
 Oakland, California

FIGURE
1

PROJECT NUMBER 386895	REVIEWED BY	DATE October 27, 2005	REVISED DATE
---------------------------------	-------------	--------------------------	--------------

Table 1
Groundwater Monitoring Data and Analytical Results
Chevron Service Station #9-3600
2200 Telegraph Avenue
Oakland, California

WELL ID/ DATE	TOC* (ft.)	DTW (ft.)	GWE (ft.)	TPH-G (ppb)	B (ppb)	T (ppb)	E (ppb)	X (ppb)	MTBE (ppb)
MW-1									
04/05/02 ¹	17.07	11.68	5.39	2,000	5.0	<1.0	14	8.4	310/370 ²
07/01/02	17.07	12.01	5.06	2,000	8.9	<1.0	97	31	370/420 ²
10/08/02	17.07	12.20	4.87	1,400	9.2	<10	75	20	440/360 ²
01/11/03	17.07	11.13	5.94	1,600	7.1	0.51	53	13	280/270 ²
04/01/03	17.07	11.53	5.54	1,800	5.2	0.6	25	9.1	210/210 ²
07/01/03 ³	17.07	11.95	5.12	2,000	4	<0.5	31	12	170
10/02/03 ³	17.07	12.25	4.82	480	<5	<5	<5	<5	9,800
01/05/04 ¹	17.07	11.05	6.02	1,700	3	<0.5	27	4	140
04/05/04 ³	17.07	11.63	5.44	1,500	2	<0.5	21	0.6	120
07/01/04 ³	17.07	12.08	4.99	1,500	1	<0.5	3	<0.5	130
10/05/04 ³	17.07	12.21	4.86	1,400	<0.5	<0.5	1	0.5	130
01/04/05 ³	17.07	11.15	5.92	1,500	<0.5	<0.5	<0.5	<0.5	<0.5
04/14/05 ³	17.07	11.20	5.87	2,100	<0.5	<0.5	4	0.5	61
07/08/05 ³	17.07	11.38	5.69	1,800	<0.5	<0.5	0.8	<0.5	71
10/27/05 ³	17.07	12.24	4.83	800	<0.5	<0.5	<0.5	<0.5	76
MW-2									
04/05/02 ¹	16.82	11.17	5.65	<50	<0.50	<0.50	<0.50	<1.5	<2.5/<2 ²
07/01/02	16.82	11.36	5.46	<50	<0.50	0.57	0.52	<1.5	<2.5/<2 ²
10/08/02	16.82	11.57	5.25	<100	<2.0	<2.0	<2.0	<5.0	<10/<2 ²
01/11/03	16.82	10.94	5.88	<50	<0.50	<0.50	<0.50	<1.5	<2.5/<2 ²
04/01/03	16.82	11.03	5.79	<50	<0.5	<0.5	<0.5	<1.5	<2.5/<0.5 ²
07/01/03 ³	16.82	11.30	5.52	<50	<0.5	<0.5	<0.5	<0.5	<0.5
10/02/03 ³	16.82	11.63	5.19	<50	<0.5	<0.5	<0.5	<0.5	<0.5
01/05/04 ³	16.82	10.82	6.00	<50	<0.5	<0.5	<0.5	<0.5	<0.5
04/05/04 ³	16.82	11.21	5.61	<50	<0.5	<0.5	<0.5	<0.5	<0.5
07/01/04 ³	16.82	11.46	5.36	<50	<0.5	<0.5	<0.5	<0.5	<0.5
10/05/04 ³	16.82	11.57	5.25	<50	<0.5	<0.5	<0.5	<0.5	<0.5
01/04/05 ³	16.82	10.87	5.95	<50	0.5	<0.5	8	0.9	87
04/14/05 ³	16.82	10.72	6.10	<50	<0.5	<0.5	<0.5	<0.5	<0.5
07/08/05 ³	16.82	11.16	5.66	<50	<0.5	<0.5	<0.5	<0.5	<0.5
10/27/05 ³	16.82	11.59	5.23	<50	<0.5	<0.5	<0.5	<0.5	<0.5

Table 1
Groundwater Monitoring Data and Analytical Results
Chevron Service Station #9-3600
2200 Telegraph Avenue
Oakland, California

WELL ID/ DATE	TOC* (ft.)	DTW (ft.)	GWE (ft.)	TPH-G (ppb)	B (ppb)	T (ppb)	E (ppb)	X (ppb)	MTBE (ppb)
MW-3									
04/05/02 ¹	16.52	11.29	5.23	<50	<0.50	0.59	<0.50	<1.5	<2.5/<2 ²
07/01/02	16.52	11.55	4.97	<50	<0.50	0.60	<0.50	<1.5	<2.5/<2 ²
10/08/02	16.52	11.62	4.90	<100	<2.0	<2.0	<2.0	<5.0	<10/<2 ²
01/11/03	16.52	11.09	5.43	<50	<0.50	<0.50	<0.50	<1.5	<2.5/<2 ²
04/01/03	16.52	11.25	5.27	<50	<0.5	<0.5	<0.5	<1.5	<2.5/<0.5 ²
07/01/03 ³	16.52	11.42	5.10	<50	<0.5	<0.5	<0.5	<0.5	2
10/02/03 ³	16.52	11.74	4.78	<50	<0.5	<0.5	<0.5	<0.5	<0.5
01/05/04 ³	16.52	11.06	5.46	<50	<0.5	<0.5	<0.5	<0.5	<0.5
04/05/04 ³	16.52	11.40	5.12	<50	<0.5	<0.5	<0.5	<0.5	0.6
07/01/04 ³	16.52	11.58	4.94	<50	<0.5	<0.5	<0.5	<0.5	0.8
10/05/04 ³	16.52	11.60	4.92	<50	<0.5	<0.5	<0.5	<0.5	<0.5
01/04/05 ³	16.52	10.95	5.57	<50	<0.5	<0.5	<0.5	<0.5	<0.5
04/14/05 ³	16.52	11.10	5.42	<50	<0.5	<0.5	<0.5	<0.5	<0.5
07/08/05 ³	16.52	11.29	5.23	<50	<0.5	<0.5	<0.5	<0.5	<0.5
10/27/05 ³	16.52	11.68	4.84	<50	<0.5	<0.5	<0.5	<0.5	<0.5
TRIP BLANK									
QA									
04/05/02	--	--	--	<50	<0.50	<0.50	<0.50	<1.5	<2.5
07/01/02	--	--	--	<50	<0.50	<0.50	<0.50	<1.5	<2.5
10/08/02	--	--	--	<100	<2.0	<2.0	<2.0	<5.0	<10
01/11/03	--	--	--	<50	<0.50	<0.50	<0.50	<1.5	<2.5
04/01/03	--	--	--	<50	<0.5	<0.5	<0.5	<1.5	<2.5
07/01/03 ³	--	--	--	<50	<0.5	<0.5	<0.5	<0.5	<0.5
10/02/03 ³	--	--	--	<50	<0.5	<0.5	<0.5	<0.5	<0.5
01/05/04 ³	--	--	--	<50	<0.5	<0.5	<0.5	<0.5	<0.5
04/05/04 ³	--	--	--	<50	<0.5	<0.5	<0.5	<0.5	<0.5
07/01/04 ³	--	--	--	<50	<0.5	<0.5	<0.5	<0.5	<0.5
10/05/04 ³	--	--	--	<50	<0.5	<0.5	<0.5	<0.5	<0.5
01/04/05 ³	--	--	--	<50	<0.5	<0.5	<0.5	<0.5	<0.5
04/14/05 ³	--	--	--	<50	<0.5	<0.5	<0.5	<0.5	<0.5
07/08/05 ³	--	--	--	<50	<0.5	<0.5	<0.5	<0.5	<0.5
10/27/05 ³	--	--	--	<50	<0.5	<0.5	<0.5	<0.5	<0.5

Table 1
Groundwater Monitoring Data and Analytical Results
Chevron Service Station #9-3600
2200 Telegraph Avenue
Oakland, California

EXPLANATIONS:

TOC = Top of Casing
(ft.) = Feet

DTW = Depth to Water

GWE = Groundwater Elevation

TPH-G = Total Petroleum Hydrocarbons as Gasoline

B = Benzene

T = Toluene

E = Ethylbenzene

X = Xylenes

MTBE = Methyl tertiary butyl ether

(ppb) = Parts per billion

-- = Not Measured/Not Analyzed

QA = Quality Assurance/Trip Blank

* TOC elevations were surveyed on April 17, 2002, by Morrow Surveying. The elevations are based on a City of Oakland Benchmark No. 37JC,
(Benchmark Elevation = 17.68 Feet).

¹ Well development performed.

² MTBE by EPA Method 8260.

³ BTEX and MTBE by EPA Method 8260.

Table 2
Groundwater Analytical Results - Oxygenate Compounds
Chevron Service Station #9-3600
2200 Telegraph Avenue
Oakland, California

WELL ID	DATE	ETHANOL (ppb)	TBA (ppb)	MTBE (ppb)	DIPE (ppb)	ETBE (ppb)	TAME (ppb)
MW-1	04/05/02	--	200	370	<2	<2	10
	07/01/02	--	190	420	<2	<2	9
	10/08/02	--	110	360	<2	<2	8
	01/11/03	--	<100	270	<2	<2	7
	04/01/03	--	22	210	<0.5	<0.5	5
	07/01/03	<50	26	170	<0.5	<0.5	5
	10/02/03	<500	2,600	9,800	<5	<5	6
	01/05/04	<50	21	140	<0.5	<0.5	3
	04/05/04	<50	17	120	<0.5	<0.5	3
	07/01/04	<50	13	130	<0.5	<0.5	2
	10/05/04	<50	14	130	<0.5	<0.5	2
	01/04/05	<50	<5	<0.5	<0.5	<0.5	<0.5
	04/14/05	<50	15	61	<0.5	<0.5	1
	07/08/05	<50	15	71	<0.5	<0.5	1
	10/27/05	<50	10	76	<0.5	<0.5	1
MW-2	04/05/02	--	<100	<2	<2	<2	<2
	07/01/02	--	<100	<2	<2	<2	<2
	10/08/02	--	<100	<2	<2	<2	<2
	01/11/03	--	<100	<2	<2	<2	<2
	04/01/03	--	<5	<0.5	<0.5	<0.5	<0.5
	07/01/03	<50	<5	<0.5	<0.5	<0.5	<0.5
	10/02/03	<50	<5	<0.5	<0.5	<0.5	<0.5
	01/05/04	<50	<5	<0.5	<0.5	<0.5	<0.5
	04/05/04	<50	<5	<0.5	<0.5	<0.5	<0.5
	07/01/04	<50	<5	<0.5	<0.5	<0.5	<0.5
	10/05/04	<50	<5	<0.5	<0.5	<0.5	<0.5
	01/04/05	<50	14	87	<0.5	<0.5	2
	04/14/05	<50	<5	<0.5	<0.5	<0.5	<0.5
	07/08/05	<50	<5	<0.5	<0.5	<0.5	<0.5
	10/27/05	<50	<5	<0.5	<0.5	<0.5	<0.5

Table 2
Groundwater Analytical Results - Oxygenate Compounds
Chevron Service Station #9-3600
2200 Telegraph Avenue
Oakland, California

WELL ID	DATE	ETHANOL (ppb)	TBA (ppb)	MTBE (ppb)	DIPE (ppb)	ETBE (ppb)	TAME (ppb)
MW-3	04/05/02	--	<100	<2	<2	<2	<2
	07/01/02	--	<100	<2	<2	<2	<2
	10/08/02	--	<100	<2	<2	<2	<2
	01/11/03	--	<100	<2	<2	<2	<2
	04/01/03	--	<5	<0.5	<0.5	<0.5	<0.5
	07/01/03	<50	<5	2	<0.5	<0.5	<0.5
	10/02/03	<50	<5	<0.5	<0.5	<0.5	<0.5
	01/05/04	<50	<5	<0.5	<0.5	<0.5	<0.5
	04/05/04	<50	<5	0.6	<0.5	<0.5	<0.5
	07/01/04	<50	<5	0.8	<0.5	<0.5	<0.5
	10/05/04	<50	<5	<0.5	<0.5	<0.5	<0.5
	01/04/05	<50	<5	<0.5	<0.5	<0.5	<0.5
	04/14/05	<50	<5	<0.5	<0.5	<0.5	<0.5
	07/08/05	<50	<5	<0.5	<0.5	<0.5	<0.5
	10/27/05	<50	<5	<0.5	<0.5	<0.5	<0.5

Table 2

Groundwater Analytical Results - Oxygenate Compounds

Chevron Service Station #9-3600

2200 Telegraph Avenue

Oakland, California

EXPLANATIONS:

TBA = Tertiary butyl alcohol

MTBE = Methyl tertiary butyl ether

DIPE = Di-isopropyl ether

ETBE = Ethyl tertiary butyl ether

TAME = Tertiary amyl methyl ether

(ppb) = Parts per billion

-- = Not Analyzed

ANALYTICAL METHOD:

EPA Method 8260 for Oxygenate Compounds

STANDARD OPERATING PROCEDURE - GROUNDWATER SAMPLING

Gettler-Ryan Inc. field personnel adhere to the following procedures for the collection and handling of groundwater samples prior to analysis by the analytical laboratory. Prior to sample collection, the type of analysis to be performed is determined. Loss prevention of volatile compounds is controlled and sample preservation for subsequent analysis is maintained.

Prior to sampling, the presence or absence of free-phase hydrocarbons is determined using an interface probe. Product thickness, if present, is measured to the nearest 0.01 foot and is noted in the field notes. In addition, all depth to water level measurements are collected with a static water level indicator and are also recorded in the field notes, prior to purging and sampling any wells.

After water levels are collected and prior to sampling, if purging is to occur, each well is purged a minimum of three well casing volumes of water using pre-cleaned pumps (stack, suction, Grundfos), or disposable bailers. Temperature, pH and electrical conductivity are measured a minimum of three times during the purging. Purging continues until these parameters stabilize.

Groundwater samples are collected using disposable bailers. The water samples are transferred from the bailer into appropriate containers. Pre-preserved containers, supplied by analytical laboratories, are used when possible. When pre-preserved containers are not available, the laboratory is instructed to preserve the sample as appropriate. Duplicate samples are collected for the laboratory to use in maintaining quality assurance/quality control standards. The samples are labeled to include the job number, sample identification, collection date and time, analysis, preservation (if any), and the sample collector's initials. The water samples are placed in a cooler, maintained at 4°C for transport to the laboratory. Once collected in the field, all samples are maintained under chain of custody until delivered to the laboratory.

The chain of custody document includes the job number, type of preservation, if any, analysis requested, sample identification, date and time collected, and the sample collector's name. The chain of custody is signed and dated (including time of transfer) by each person who receives or surrenders the samples, beginning with the field personnel and ending with the laboratory personnel.

A laboratory supplied trip blank accompanies each sampling set. For sampling sets greater than 20 samples, 5% trip blanks are included. The trip blank is analyzed for some or all of the same compounds as the groundwater samples.

As requested by ChevronTexaco Company, the purge water and decontamination water generated during sampling activities is transported by IWM to McKittrick Waste Management located in McKittrick, California.



GETTLER - RYAN INC.

WELL MONITORING/SAMPLING FIELD DATA SHEET

Client/Facility #: ChevronTexaco #9-3600
 Site Address: 2200 Telegraph Avenue
 City: Oakland, CA

Job Number: 386895
 Event Date: 10-27-05 (inclusive)
 Sampler: Soc

Well ID: MW-1
 Well Diameter: 2 in.
 Total Depth: 20.29 ft.
 Depth to Water: 12.24 ft.
8.05 xVF = 0.17 = 1.37 x3 case volume = Estimated Purge Volume: 4.5 gal.

Date Monitored: 10-27-05 Well Condition: OK

Volume	3/4" = 0.02	1" = 0.04	2" = 0.17	3" = 0.38
Factor (VF)	4" = 0.66	5" = 1.02	6" = 1.50	12" = 5.80

Purge Equipment:
 Disposable Bailer
 Stainless Steel Bailer
 Stack Pump
 Suction Pump
 Grundfos
 Other:

Sampling Equipment:
 Disposable Bailer
 Pressure Bailer
 Discrete Bailer
 Other:

Time Started: _____ (2400 hrs)
 Time Completed: _____ (2400 hrs)
 Depth to Product: _____ ft
 Depth to Water: _____ ft
 Hydrocarbon Thickness: 0.2 ft
 Visual Confirmation/Description: _____
 Skimmer / Absorbant Sock (circle one)
 Amt Removed from Skimmer: _____ gal
 Amt Removed from Well: _____ gal
 Water Removed: _____ gal
 Product Transferred to: _____

Start Time (purge): 1056 Weather Conditions: Overcast
 Sample Time/Date: 1122 / 10-27-05 Water Color: clear Odor: yes
 Purging Flow Rate: 0.5 gpm. Sediment Description: _____
 Did well de-water? _____ If yes, Time: _____ Volume: _____ gal.

Time (2400 hr.)	Volume (gal.)	pH	Conductivity (umhos/cm)	Temperature (C/F)	D.O. (mg/L)	ORP (mV)
<u>1105</u>	<u>1.5</u>	<u>6.81</u>	<u>942</u>	<u>63.1</u>	_____	_____
<u>1109</u>	<u>3</u>	<u>6.83</u>	<u>950</u>	<u>63.4</u>	_____	_____
<u>1112</u>	<u>4.5</u>	<u>6.87</u>	<u>963</u>	<u>63.2</u>	_____	_____
_____	_____	_____	_____	_____	_____	_____

LABORATORY INFORMATION

SAMPLE ID	(#) CONTAINER	REFRIG.	PRESERV. TYPE	LABORATORY	ANALYSES
<u>MW-1</u>	<u>6 x vial</u>	<u>YES</u>	<u>HCL</u>	<u>LANCASTER</u>	<u>TPH-G(8015)/BTEX+MTBE(8260)/ 5 OXYS+ETHANOL(8260)</u>
_____	_____	_____	_____	_____	_____
_____	_____	_____	_____	_____	_____
_____	_____	_____	_____	_____	_____

COMMENTS: _____

Add/Replaced Lock: _____

Add/Replaced Plug: _____ Size: _____



GETTLER-RYAN INC.

WELL MONITORING/SAMPLING FIELD DATA SHEET

Client/Facility #: ChevronTexaco #9-3600 Job Number: 386895
 Site Address: 2200 Telegraph Avenue Event Date: 10-27-05 (inclusive)
 City: Oakland, CA Sampler: Joe

Well ID: MW-2 Date Monitored: 10-27-05 Well Condition: 0.1c
 Well Diameter: 2 in.
 Total Depth: 20.26 ft.
 Depth to Water: 11.59 ft.
8.67 xVF 0.17 = 1.47 x3 case volume = Estimated Purge Volume: 4.5 gal.

Volume	3/4"= 0.02	1"= 0.04	2"= 0.17	3"= 0.38
Factor (VF)	4"= 0.66	5"= 1.02	6"= 1.50	12"= 5.80

Purge Equipment:
 Disposable Bailer
 Stainless Steel Bailer
 Stack Pump
 Suction Pump
 Grundfos
 Other:

Sampling Equipment:
 Disposable Bailer
 Pressure Bailer
 Discrete Bailer
 Other:

Time Started: _____ (2400 hrs)
 Time Completed: _____ (2400 hrs)
 Depth to Product: _____ ft
 Depth to Water: _____ ft
 Hydrocarbon Thickness: _____ ft
 Visual Confirmation/Description: _____
 Skimmer / Absorbant Sock (circle one)
 Amt Removed from Skimmer: _____ gal
 Amt Removed from Well: _____ gal
 Water Removed: _____ gal
 Product Transferred to: _____

Start Time (purge): 1015 Weather Conditions: Overcast
 Sample Time/Date: 1045 11027-05 Water Color: clear Odor: none
 Purging Flow Rate: 0.5 gpm. Sediment Description: _____
 Did well de-water? _____ If yes, Time: _____ Volume: _____ gal.

Time (2400 hr.)	Volume (gal.)	pH	Conductivity (umhos/cm)	Temperature (C/E)	D.O. (mg/L)	ORP (mV)
<u>1026</u>	<u>1.5</u>	<u>7.16</u>	<u>1213</u>	<u>69.0</u>	_____	_____
<u>1030</u>	<u>3</u>	<u>7.18</u>	<u>1197</u>	<u>63.6</u>	_____	_____
<u>1034</u>	<u>4.5</u>	<u>7.12</u>	<u>1192</u>	<u>63.5</u>	_____	_____
_____	_____	_____	_____	_____	_____	_____

LABORATORY INFORMATION

SAMPLE ID	(#) CONTAINER	REFRIG.	PRESERV. TYPE	LABORATORY	ANALYSES
<u>MW-2</u>	<u>6 x vva vial</u>	<u>YES</u>	<u>HCL</u>	<u>LANCASTER</u>	<u>TPH-G(8015)/BTEX+MTBE(8260)/ 5 OXYS+ETHANOL(8260)</u>
_____	_____	_____	_____	_____	_____
_____	_____	_____	_____	_____	_____
_____	_____	_____	_____	_____	_____

COMMENTS: _____

Add/Replaced Lock: _____

Add/Replaced Plug: _____ Size: _____



GETTLER-RYAN INC.

WELL MONITORING/SAMPLING FIELD DATA SHEET

Client/Facility #: ChevronTexaco #9-3600 Job Number: 386895
 Site Address: 2200 Telegraph Avenue Event Date: 10-27-05 (inclusive)
 City: Oakland, CA Sampler: Soc

Well ID: MW-3 Date Monitored: 10-27-05 Well Condition: OK
 Well Diameter: 2 in.
 Total Depth: 20.20 ft.
 Depth to Water: 11.63 ft.
 $8.52 \times VF \ 0.17 = 1.45 \times 3 \text{ case volume} = \text{Estimated Purge Volume: } 4.5 \text{ gal.}$

Volume	3/4"= 0.02	1"= 0.04	2"= 0.17	3"= 0.38
Factor (VF)	4"= 0.66	5"= 1.02	6"= 1.50	12"= 5.80

Purge Equipment:
 Disposable Bailer
 Stainless Steel Bailer _____
 Stack Pump _____
 Suction Pump _____
 Grundfos _____
 Other: _____

Sampling Equipment:
 Disposable Bailer
 Pressure Bailer _____
 Discrete Bailer _____
 Other: _____

Time Started: _____ (2400 hrs)
 Time Completed: _____ (2400 hrs)
 Depth to Product: _____ ft
 Depth to Water: _____ ft
 Hydrocarbon Thickness: 0 ft
 Visual Confirmation/Description: _____
 Skimmer / Absorbent Sock (circle one)
 Amt Removed from Skimmer: _____ gal
 Amt Removed from Well: _____ gal
 Water Removed: _____ gal
 Product Transferred to: _____

Start Time (purge): 0935 Weather Conditions: Overcast
 Sample Time/Date: 1005 10-27-05 Water Color: clear Odor: none
 Purging Flow Rate: 0.5 gpm. Sediment Description: _____
 Did well de-water? _____ If yes, Time: _____ Volume: _____ gal.

Time (2400 hr.)	Volume (gal.)	pH	Conductivity (umhos/cm)	Temperature (C)	D.O. (mg/L)	ORP (mV)
<u>0946</u>	<u>1.5</u>	<u>7.72</u>	<u>1908</u>	<u>63.9</u>	_____	_____
<u>0950</u>	<u>3</u>	<u>7.61</u>	<u>1912</u>	<u>63.8</u>	_____	_____
<u>0954</u>	<u>4.5</u>	<u>7.58</u>	<u>1907</u>	<u>63.5</u>	_____	_____
_____	_____	_____	_____	_____	_____	_____

LABORATORY INFORMATION

SAMPLE ID	(#) CONTAINER	REFRIG.	PRESERV. TYPE	LABORATORY	ANALYSES
<u>MW-3</u>	<u>6 x vial</u>	<u>YES</u>	<u>HCL</u>	<u>LANCASTER</u>	<u>TPH-G(8015)/BTEX+MTBE(8260)/ 5 OXYS+ETHANOL(8260)</u>
_____	_____	_____	_____	_____	_____
_____	_____	_____	_____	_____	_____
_____	_____	_____	_____	_____	_____

COMMENTS: _____

Add/Replaced Lock: _____ Add/Replaced Plug: _____ Size: _____



Analysis Report

2425 New Holland Pike, PO Box 12425, Lancaster, PA 17605-2425 • 717-656-2300 Fax: 717-656-2681 • www.lancasterlabs.com

ANALYTICAL RESULTS

Prepared for:

ChevronTexaco
6001 Bollinger Canyon Rd L4310
San Ramon CA 94583

925-842-8582

Prepared by:

Lancaster Laboratories
2425 New Holland Pike
Lancaster, PA 17605-2425

RECEIVED

GENERAL CONTRACTOR

SAMPLE GROUP

The sample group for this submittal is 965098. Samples arrived at the laboratory on Friday, October 28, 2005. The PO# for this group is 99011184 and the release number is INGLIS.

Client Description

Client Description	NA	Water
QA-T-051027		
MW-1-W-051027	Grab	Water
MW-2-W-051027	Grab	Water
MW-3-W-051027	Grab	Water

Lancaster Labs Number

4634790
4634791
4634792
4634793

1 COPY TO
ELECTRONIC
COPY TO

Cambria C/O Gettler- Ryan
Gettler-Ryan

Attn: Deanna L. Harding
Attn: Cheryl Hansen



Analysis Report

2425 New Holland Pike, PO Box 12425, Lancaster, PA 17605-2425 • 717-656-2300 Fax: 717-656-2681 • www.lancasterlabs.com

Questions? Contact your Client Services Representative
Lynn M Frederiksen at (717) 656-2300

Respectfully Submitted,

A handwritten signature in cursive script that reads "Dana M. Kauffman".

Dana M. Kauffman
Manager



Analysis Report

2425 New Holland Pike, PO Box 12425, Lancaster, PA 17605-2425 • 717-656-2300 Fax: 717-656-2681 • www.lancasterlabs.com

Page 1 of 1

Lancaster Laboratories Sample No. WW 4634790

QA-T-051027 NA Water
Facility# 93600 Job# 386895 GRD
2200 Telegraph-Oakland T0600161613 QA
Collected: 10/27/2005

Account Number: 10904

Submitted: 10/28/2005 09:00
Reported: 11/07/2005 at 18:19
Discard: 12/08/2005

ChevronTexaco
6001 Bollinger Canyon Rd L4310
San Ramon CA 94583

220QA

CAT No.	Analysis Name	CAS Number	As Received Result	As Received Method Detection Limit	Units	Dilution Factor
01728	TPH-GRO - Waters	n.a.	N.D.	50.	ug/l	1
	The reported concentration of TPH-GRO does not include MTBE or other gasoline constituents eluting prior to the C6 (n-hexane) TPH-GRO range start time.					
06054	BTEX+MTBE by 8260B					
02010	Methyl Tertiary Butyl Ether	1634-04-4	N.D.	0.5	ug/l	1
05401	Benzene	71-43-2	N.D.	0.5	ug/l	1
05407	Toluene	108-88-3	N.D.	0.5	ug/l	1
05415	Ethylbenzene	100-41-4	N.D.	0.5	ug/l	1
06310	Xylene (Total)	1330-20-7	N.D.	0.5	ug/l	1

State of California Lab Certification No. 2116

Laboratory Chronicle

CAT No.	Analysis Name	Method	Trial#	Analysis Date and Time	Analyst	Dilution Factor
01728	TPH-GRO - Waters	N. CA LUFT Gasoline Method	1	11/01/2005 21:15	Steven A Skiles	1
06054	BTEX+MTBE by 8260B	SW-846 8260B	1	10/31/2005 10:53	Ginelle L Feister	1
01146	GC VOA Water Prep	SW-846 5030B	1	11/01/2005 21:15	Steven A Skiles	1
01163	GC/MS VOA Water Prep	SW-846 5030B	1	10/31/2005 10:53	Ginelle L Feister	n.a.

Lancaster Laboratories Sample No. WW 4634791

 MW-1-W-051027 Grab Water
 Facility# 93600 Job# 386895 GRD
 2200 Telegraph-Oakland T0600161613 MW-1
 Collected: 10/27/2005 11:22 by JA

Account Number: 10904

 Submitted: 10/28/2005 09:00
 Reported: 11/07/2005 at 18:19
 Discard: 12/08/2005

 ChevronTexaco
 6001 Bollinger Canyon Rd L4310
 San Ramon CA 94583

220M1

CAT No.	Analysis Name	CAS Number	As Received Result	As Received		Units	Dilution Factor
				Method	Detection Limit		
01728	TPH-GRO - Waters	n.a.	800.	50.		ug/l	1
	The reported concentration of TPH-GRO does not include MTBE or other gasoline constituents eluting prior to the C6 (n-hexane) TPH-GRO range start time.						
06059	BTEX+5 Oxygenates+ETOH						
01587	Ethanol	64-17-5	N.D.	50.		ug/l	1
02010	Methyl Tertiary Butyl Ether	1634-04-4	76.	0.5		ug/l	1
02011	di-Isopropyl ether	108-20-3	N.D.	0.5		ug/l	1
02013	Ethyl t-butyl ether	637-92-3	N.D.	0.5		ug/l	1
02014	t-Amyl methyl ether	994-05-8	1.	0.5		ug/l	1
02015	t-Butyl alcohol	75-65-0	10.	5.		ug/l	1
05401	Benzene	71-43-2	N.D.	0.5		ug/l	1
05407	Toluene	108-88-3	N.D.	0.5		ug/l	1
05415	Ethylbenzene	100-41-4	N.D.	0.5		ug/l	1
06310	Xylene (Total)	1330-20-7	N.D.	0.5		ug/l	1

State of California Lab Certification No. 2116

Laboratory Chronicle

CAT No.	Analysis Name	Method	Trial#	Analysis		Analyst	Dilution Factor
				Date	Time		
01728	TPH-GRO - Waters	N. CA LUFT Gasoline Method	1	11/02/2005	21:35	Steven A Skiles	1
06059	BTEX+5 Oxygenates+ETOH	SW-846 8260B	1	11/04/2005	01:55	Dawn M Harle	1
01146	GC VOA Water Prep	SW-846 5030B	1	11/02/2005	21:35	Steven A Skiles	1
01163	GC/MS VOA Water Prep	SW-846 5030B	1	11/04/2005	01:55	Dawn M Harle	n.a.



Analysis Report

2425 New Holland Pike, PO Box 12425, Lancaster, PA 17605-2425 • 717-656-2300 Fax: 717-656-2681 • www.lancasterlabs.com

Page 1 of 1

Lancaster Laboratories Sample No. WW 4634792

MW-2-W-051027 Grab Water GRD
 Facility# 93600 Job# 386895
 2200 Telegraph-Oakland T0600161613 MW-2
 Collected: 10/27/2005 10:45 by JA

Account Number: 10904

Submitted: 10/28/2005 09:00
 Reported: 11/07/2005 at 18:19
 Discard: 12/08/2005

ChevronTexaco
 6001 Bollinger Canyon Rd L4310
 San Ramon CA 94583

220M2

CAT No.	Analysis Name	CAS Number	As Received Result	As Received Method Detection Limit	Units	Dilution Factor
01728	TPH-GRO - Waters	n.a.	N.D.	50.	ug/l	1
The reported concentration of TPH-GRO does not include MTBE or other gasoline constituents eluting prior to the C6 (n-hexane) TPH-GRO range start time.						
06059	BTEX+5 Oxygenates+ETOH					
01587	Ethanol	64-17-5	N.D.	50.	ug/l	1
02010	Methyl Tertiary Butyl Ether	1634-04-4	N.D.	0.5	ug/l	1
02011	di-Isopropyl ether	108-20-3	N.D.	0.5	ug/l	1
02013	Ethyl t-butyl ether	637-92-3	N.D.	0.5	ug/l	1
02014	t-Amyl methyl ether	994-05-8	N.D.	0.5	ug/l	1
02015	t-Butyl alcohol	75-65-0	N.D.	5.	ug/l	1
05401	Benzene	71-43-2	N.D.	0.5	ug/l	1
05407	Toluene	108-88-3	N.D.	0.5	ug/l	1
05415	Ethylbenzene	100-41-4	N.D.	0.5	ug/l	1
06310	Xylene (Total)	1330-20-7	N.D.	0.5	ug/l	1
The vial submitted for volatile analysis did not have a pH < 2 at the time of analysis. Due to the volatile nature of the analytes, it is not appropriate for the laboratory to adjust the pH at the time of sample receipt. The pH of this sample was pH = 7.						

State of California Lab Certification No. 2116

Laboratory Chronicle

CAT No.	Analysis Name	Method	Trial#	Analysis Date and Time	Analyst	Dilution Factor
01728	TPH-GRO - Waters	N. CA LUFT Gasoline Method	1	11/01/2005 22:26	Steven A Skiles	1
06059	BTEX+5 Oxygenates+ETOH	SW-846 8260B	1	11/04/2005 02:19	Dawn M Harle	1
01146	GC VOA Water Prep	SW-846 5030B	1	11/01/2005 22:26	Steven A Skiles	1
01163	GC/MS VOA Water Prep	SW-846 5030B	1	11/04/2005 02:19	Dawn M Harle	n.a.



Analysis Report

2425 New Holland Pike, PO Box 12425, Lancaster, PA 17605-2425 • 717-656-2300 Fax: 717-656-2681 • www.lancasterlabs.com

Page 1 of 1

Lancaster Laboratories Sample No. **WW 4634793**

MW-3-W-051027 Grab Water
Facility# 93600 Job# 386895 GRD
2200 Telegraph-Oakland T0600161613 MW-3
Collected: 10/27/2005 10:05 by JA

Account Number: 10904

Submitted: 10/28/2005 09:00
Reported: 11/07/2005 at 18:19
Discard: 12/08/2005

ChevronTexaco
6001 Bollinger Canyon Rd L4310
San Ramon CA 94583

220M3

CAT No.	Analysis Name	CAS Number	As Received Result	As Received Method Detection Limit	Units	Dilution Factor
01728	TPH-GRO - Waters	n.a.	N.D.	50.	ug/l	1
The reported concentration of TPH-GRO does not include MTBE or other gasoline constituents eluting prior to the C6 (n-hexane) TPH-GRO range start time.						
06059	BTEX+5 Oxygenates+ETOH					
01587	Ethanol	64-17-5	N.D.	50.	ug/l	1
02010	Methyl Tertiary Butyl Ether	1634-04-4	N.D.	0.5	ug/l	1
02011	di-Isopropyl ether	108-20-3	N.D.	0.5	ug/l	1
02013	Ethyl t-butyl ether	637-92-3	N.D.	0.5	ug/l	1
02014	t-Amyl methyl ether	994-05-8	N.D.	0.5	ug/l	1
02015	t-Butyl alcohol	75-65-0	N.D.	5.	ug/l	1
05401	Benzene	71-43-2	N.D.	0.5	ug/l	1
05407	Toluene	108-88-3	N.D.	0.5	ug/l	1
05415	Ethylbenzene	100-41-4	N.D.	0.5	ug/l	1
06310	Xylene (Total)	1330-20-7	N.D.	0.5	ug/l	1

State of California Lab Certification No. 2116

Laboratory Chronicle

CAT No.	Analysis Name	Method	Trial#	Analysis Date and Time	Analyst	Dilution Factor
01728	TPH-GRO - Waters	N. CA LUFT Gasoline Method	1	11/01/2005 23:01	Steven A Skiles	1
06059	BTEX+5 Oxygenates+ETOH	SW-846 8260B	1	11/04/2005 02:43	Dawn M Harle	1
01146	GC VOA Water Prep	SW-846 5030B	1	11/01/2005 23:01	Steven A Skiles	1
01163	GC/MS VOA Water Prep	SW-846 5030B	1	11/04/2005 02:43	Dawn M Harle	n.a.

Quality Control Summary

 Client Name: ChevronTexaco
 Reported: 11/07/05 at 06:19 PM

Group Number: 965098

Matrix QC may not be reported if site-specific QC samples were not submitted. In these situations, to demonstrate precision and accuracy at a batch level, a LCS/LCSD was performed, unless otherwise specified in the method.

Laboratory Compliance Quality Control

<u>Analysis Name</u>	<u>Blank Result</u>	<u>Blank MDL</u>	<u>Report Units</u>	<u>LCS %REC</u>	<u>LCSD %REC</u>	<u>LCS/LCSD Limits</u>	<u>RPD</u>	<u>RPD Max</u>
Batch number: 05305A07A TPH-GRO - Waters	Sample number(s): 4634790, 4634792-4634793							
	N.D.	50.	ug/l	96	93	70-130	3	30
Batch number: 05306A07A TPH-GRO - Waters	Sample number(s): 4634791							
	N.D.	50.	ug/l	103	103	70-130	0	30
Batch number: Z053042AA Methyl Tertiary Butyl Ether	Sample number(s): 4634790							
Benzene	N.D.	0.5	ug/l	105	104	77-127	1	30
Toluene	N.D.	0.5	ug/l	89	88	85-117	1	30
Ethylbenzene	N.D.	0.5	ug/l	92	91	85-115	1	30
Xylene (Total)	N.D.	0.5	ug/l	93	93	82-119	0	30
	N.D.	0.5	ug/l	95	94	83-113	1	30
Batch number: Z053071AA Ethanol	Sample number(s): 4634791-4634793							
Methyl Tertiary Butyl Ether	N.D.	50.	ug/l	107		30-155		
di-Isopropyl ether	N.D.	0.5	ug/l	105		77-127		
Ethyl t-butyl ether	N.D.	0.5	ug/l	89		67-130		
t-Amyl methyl ether	N.D.	0.5	ug/l	91		74-120		
t-Butyl alcohol	N.D.	0.5	ug/l	94		79-113		
Benzene	N.D.	5.	ug/l	93		60-133		
Toluene	N.D.	0.5	ug/l	90		85-117		
Ethylbenzene	N.D.	0.5	ug/l	92		85-115		
Xylene (Total)	N.D.	0.5	ug/l	94		82-119		
	N.D.	0.5	ug/l	97		83-113		

Sample Matrix Quality Control

<u>Analysis Name</u>	<u>MS %REC</u>	<u>MSD %REC</u>	<u>MS/MSD Limits</u>	<u>RPD</u>	<u>RPD MAX</u>	<u>BKG Conc</u>	<u>DUP Conc</u>	<u>DUP RPD</u>	<u>Dup RPD Max</u>
Batch number: 05305A07A TPH-GRO - Waters	Sample number(s): 4634790, 4634792-4634793								
	100		63-154						
Batch number: 05306A07A TPH-GRO - Waters	Sample number(s): 4634791								
	102		63-154						
Batch number: Z053042AA Methyl Tertiary Butyl Ether	Sample number(s): 4634790								
Benzene	107		69-134						
Toluene	94		83-128						
Ethylbenzene	97		83-127						
Xylene (Total)	99		82-129						
	99		82-130						

*- Outside of specification

- (1) The result for one or both determinations was less than five times the LOQ.
- (2) The background result was more than four times the spike added.

Quality Control Summary

 Client Name: ChevronTexaco
 Reported: 11/07/05 at 06:19 PM

Group Number: 965098

Sample Matrix Quality Control

Analysis Name	MS %REC	MSD %REC	MS/MSD Limits	RPD	RPD MAX	BKG Conc	DUP Conc	DUP RPD	Dup RPD Max
Batch number: Z053071AA	Sample number(s): 4634791-4634793								
Ethanol	101	88	26-162	14	30				
Methyl Tertiary Butyl Ether	(2)	(2)	69-134	2	30				
di-Isopropyl ether	91	91	75-130	0	30				
Ethyl t-butyl ether	94	94	78-119	0	30				
t-Amyl methyl ether	105	104	72-125	0	30				
t-Butyl alcohol	95	92	56-134	3	30				
Benzene	96	97	83-128	1	30				
Toluene	98	98	83-127	0	30				
Ethylbenzene	102	100	82-129	2	30				
Xylene (Total)	102	102	82-130	0	30				

Surrogate Quality Control

 Analysis Name: TPH-GRO - Waters
 Batch number: 05305A07A
 Trifluorotoluene-F

4634790	90
4634792	90
4634793	90
Blank	87
LCS	110
LCSD	109
MS	114

Limits: 63-135

 Analysis Name: TPH-GRO - Waters
 Batch number: 05306A07A
 Trifluorotoluene-F

4634791	133
Blank	89
LCS	116
LCSD	115
MS	119

Limits: 63-135

 Analysis Name: BTEX+MTBE by 8260B
 Batch number: Z053042AA

	Dibromofluoromethane	1,2-Dichloroethane-d4	Toluene-d8	4-Bromofluorobenzene
4634790	98	103	92	94
Blank	96	99	92	92
LCS	97	101	93	97
LCSD	98	101	92	97
MS	98	103	92	96

Limits: 80-116 77-113 80-113 78-113

*- Outside of specification

- (1) The result for one or both determinations was less than five times the LOQ.
- (2) The background result was more than four times the spike added.

Quality Control Summary

Client Name: ChevronTexaco
Reported: 11/07/05 at 06:19 PM

Group Number: 965098

Surrogate Quality Control

Analysis Name: BTEX+5 Oxygenates+ETOH
Batch number: Z053071AA

	Dibromofluoromethane	1,2-Dichloroethane-d4	Toluene-d8	4-Bromofluorobenzene
4634791	89	87	88	91
4634792	89	85	88	87
4634793	88	85	90	87
Blank	93	95	90	89
LCS	92	94	90	93
MS	93	96	91	95
MSD	93	97	90	95
Limits:	80-116	77-113	80-113	78-113

*- Outside of specification

- (1) The result for one or both determinations was less than five times the LOQ.
- (2) The background result was more than four times the spike added.

Explanation of Symbols and Abbreviations

The following defines common symbols and abbreviations used in reporting technical data:

N.D.	none detected	BMQL	Below Minimum Quantitation Level
TNTC	Too Numerous To Count	MPN	Most Probable Number
IU	International Units	CP Units	cobalt-chloroplatinate units
umhos/cm	micromhos/cm	NTU	nephelometric turbidity units
C	degrees Celsius	F	degrees Fahrenheit
meq	milliequivalents	lb.	pound(s)
g	gram(s)	kg	kilogram(s)
ug	microgram(s)	mg	milligram(s)
ml	milliliter(s)	l	liter(s)
m3	cubic meter(s)	ul	microliter(s)
<	less than - The number following the sign is the <u>limit of quantitation</u> , the smallest amount of analyte which can be reliably determined using this specific test.		
>	greater than		
J	estimated value - The result is \geq the Method Detection Limit (MDL) and $<$ the Limit of Quantitation (LOQ).		
ppm	parts per million - One ppm is equivalent to one milligram per kilogram (mg/kg), or one gram per million grams. For aqueous liquids, ppm is usually taken to be equivalent to milligrams per liter (mg/l), because one liter of water has a weight very close to a kilogram. For gases or vapors, one ppm is equivalent to one microliter of gas per liter of gas.		
ppb	parts per billion		
Dry weight basis	Results printed under this heading have been adjusted for moisture content. This increases the analyte weight concentration to approximate the value present in a similar sample without moisture. All other results are reported on an as-received basis.		

U.S. EPA CLP Data Qualifiers:

Organic Qualifiers

A	TIC is a possible aldol-condensation product
B	Analyte was also detected in the blank
C	Pesticide result confirmed by GC/MS
D	Compound quantitated on a diluted sample
E	Concentration exceeds the calibration range of the instrument
N	Presumptive evidence of a compound (TICs only)
P	Concentration difference between primary and confirmation columns $>25\%$
U	Compound was not detected
X,Y,Z	Defined in case narrative

Inorganic Qualifiers

B	Value is $<$ CRDL, but \geq IDL
E	Estimated due to interference
M	Duplicate injection precision not met
N	Spike sample not within control limits
S	Method of standard additions (MSA) used for calculation
U	Compound was not detected
W	Post digestion spike out of control limits
*	Duplicate analysis not within control limits
+	Correlation coefficient for MSA <0.995

Analytical test results for methods listed on the laboratories' accreditation scope meet all requirements of NELAC unless otherwise noted under the individual analysis.

Measurement uncertainty values, as applicable, are available upon request.

Tests results relate only to the sample tested. Clients should be aware that a critical step in a chemical or microbiological analysis is the collection of the sample. Unless the sample analyzed is truly representative of the bulk of material involved, the test results will be meaningless. If you have questions regarding the proper techniques of collecting samples, please contact us. We cannot be held responsible for sample integrity, however, unless sampling has been performed by a member of our staff. This report shall not be reproduced except in full, without the written approval of the laboratory.

WARRANTY AND LIMITS OF LIABILITY - In accepting analytical work, we warrant the accuracy of test results for the sample as submitted. THE FOREGOING EXPRESS WARRANTY IS EXCLUSIVE AND IS GIVEN IN LIEU OF ALL OTHER WARRANTIES, EXPRESSED OR IMPLIED. WE DISCLAIM ANY OTHER WARRANTIES, EXPRESSED OR IMPLIED, INCLUDING A WARRANTY OF FITNESS FOR PARTICULAR PURPOSE AND WARRANTY OF MERCHANTABILITY. IN NO EVENT SHALL LANCASTER LABORATORIES BE LIABLE FOR INDIRECT, SPECIAL, CONSEQUENTIAL, OR INCIDENTAL DAMAGES INCLUDING, BUT NOT LIMITED TO, DAMAGES FOR LOSS OF PROFIT OR GOODWILL REGARDLESS OF (A) THE NEGLIGENCE (EITHER SOLE OR CONCURRENT) OF LANCASTER LABORATORIES AND (B) WHETHER LANCASTER LABORATORIES HAS BEEN INFORMED OF THE POSSIBILITY OF SUCH DAMAGES. We accept no legal responsibility for the purposes for which the client uses the test results. No purchase order or other order for work shall be accepted by Lancaster Laboratories which includes any conditions that vary from the Standard Terms and Conditions of Lancaster Laboratories and we hereby object to any conflicting terms contained in any acceptance or order submitted by client.