

R0 2433

C A M B R I A

November 15, 2005

Mr. Jerry Wickham
Alameda County Environmental Health
1131 Harbor Bay Parkway, Suite 250
Alameda, California 94502-6577

Re: **Well Destruction Report**
Former Shell Service Station/Current Office Max
2160 Otis Drive
Alameda, California
SAP Code 135034
Incident No. 98995140

Alameda County
NOV 18 2005



Dear Mr. Wickham:

Cambria Environmental Technology, Inc. (Cambria) prepared this report on behalf of Equilon Enterprises LLC dba Shell Oil Products US to document the destruction of one groundwater monitoring well (MW-3) at the above referenced site. This work was performed in response to the October 27, 2005 Alameda County Environmental Health (ACEH) letter as a condition of case closure. Well destruction was performed to comply with Alameda County Public Works Agency (ACPWA) and California Well Standards Well Destruction Guidelines.

Site Description

This former Shell Service Station is located on Otis Drive, between Willow and Park Streets, in Alameda, California approximately 3,000 feet east of San Francisco Bay (Figure 1). Shell discontinued operation of the station in September 1997, demolished the aboveground facilities, and removed the USTs and piping. The site is a current Office Max Office Supply Store with associated parking and landscaping (Figure 2).

Monitoring Well Destruction

Destruction Date: October 31, 2005.

Well Destroyed: MW-3 (Figure 2).

Permit: ACPWA Permit #W2005-1044 (Attachment A).

Cambria
Environmental
Technology, Inc.

270 Perkins Street
Sonoma, CA 95476
Tel (707) 935-4850
Fax (707) 935-6649

C A M B R I A

Cambria Personnel Bill DeBoer, Staff Geologist, Cambria.

Present:

Drilling Company: Gregg Drilling of Martinez, California, (C-57 License # 485-165).

Destruction Methods: Gregg filled well MW-3 with neat Portland Type I/II cement grout from the bottom up. Once the well was completely filled with grout, 25 pounds per square inch of air pressure were applied with a portable air compressor for approximately 5 minutes. After the well was pressurized, the excess space in the well casing was topped off with grout, the well vault was removed, and the void was filled with native soil to match surrounding conditions. Attachment B presents Cambria's Standard Field Procedures for Monitoring Well Destruction. Attachment C presents Department of Water Resources (DWR) well completion reports.



Closing

The well destruction and this report complete the closure activities at this site. After your review of this report, please provide Shell with the case closure certificate. We appreciate your assistance with this project.

Please call Ana Friel at (707) 268-3812 if you have any questions or comments.

Sincerely,
Cambria Environmental Technology, Inc.

Bill DeBoer
Staff Geologist

Ana Friel
Senior Project Geologist
P.G. 6452

C A M B R I A

Attachments:

Figure 1. Site Vicinity Map

Figure 2. Site Plan

Appendix A. Well Destruction Permit

Appendix B. Cambria's Standard Field Procedures for Monitoring Well Destruction

Appendix C. DWR Well Driller's Completion Reports

cc: Mr. Denis Brown, Shell Oil Products US



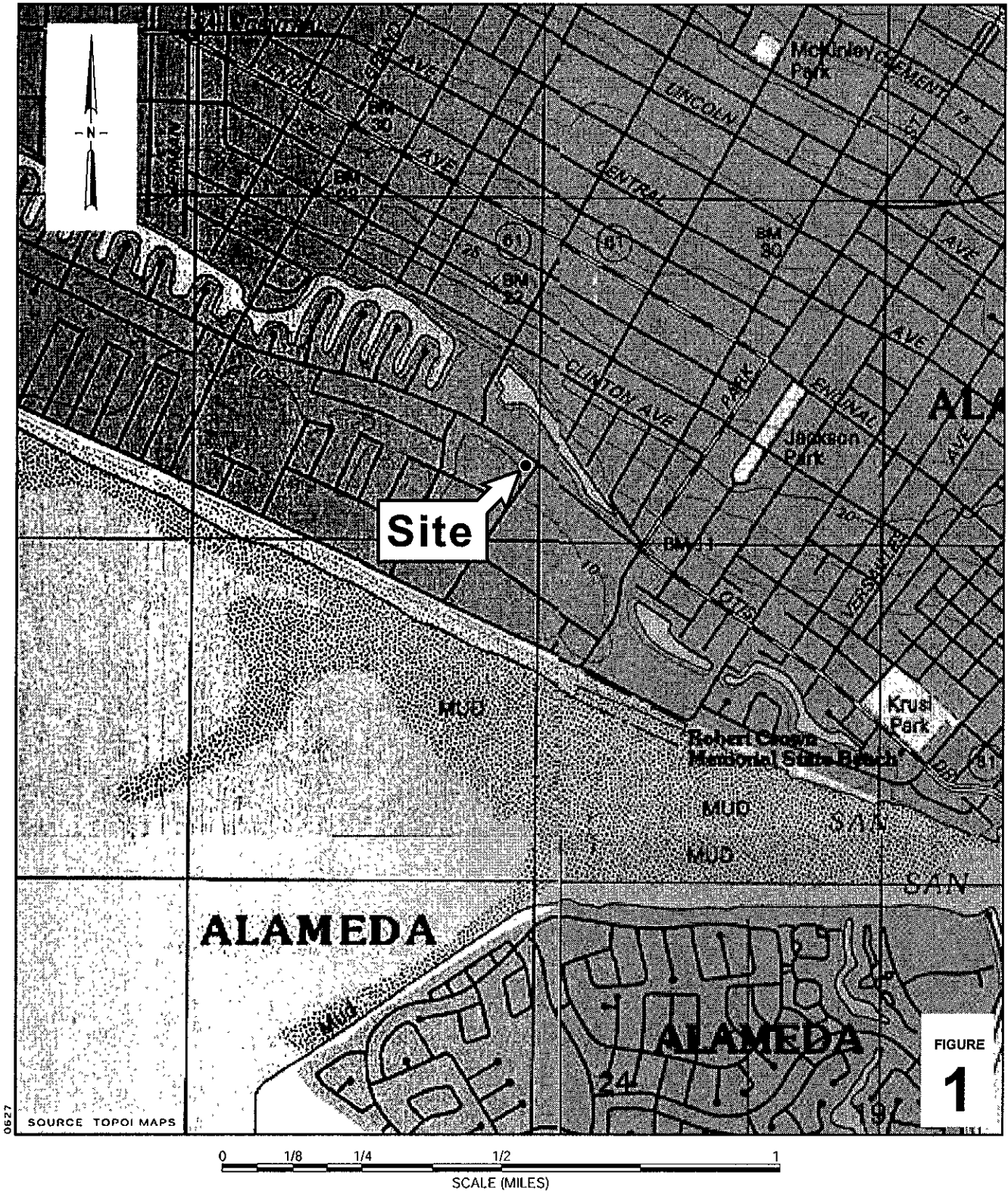

Former Shell Service Station
 2160 Otis Drive
 Alameda, California



Site Vicinity Map

C A M B R I A

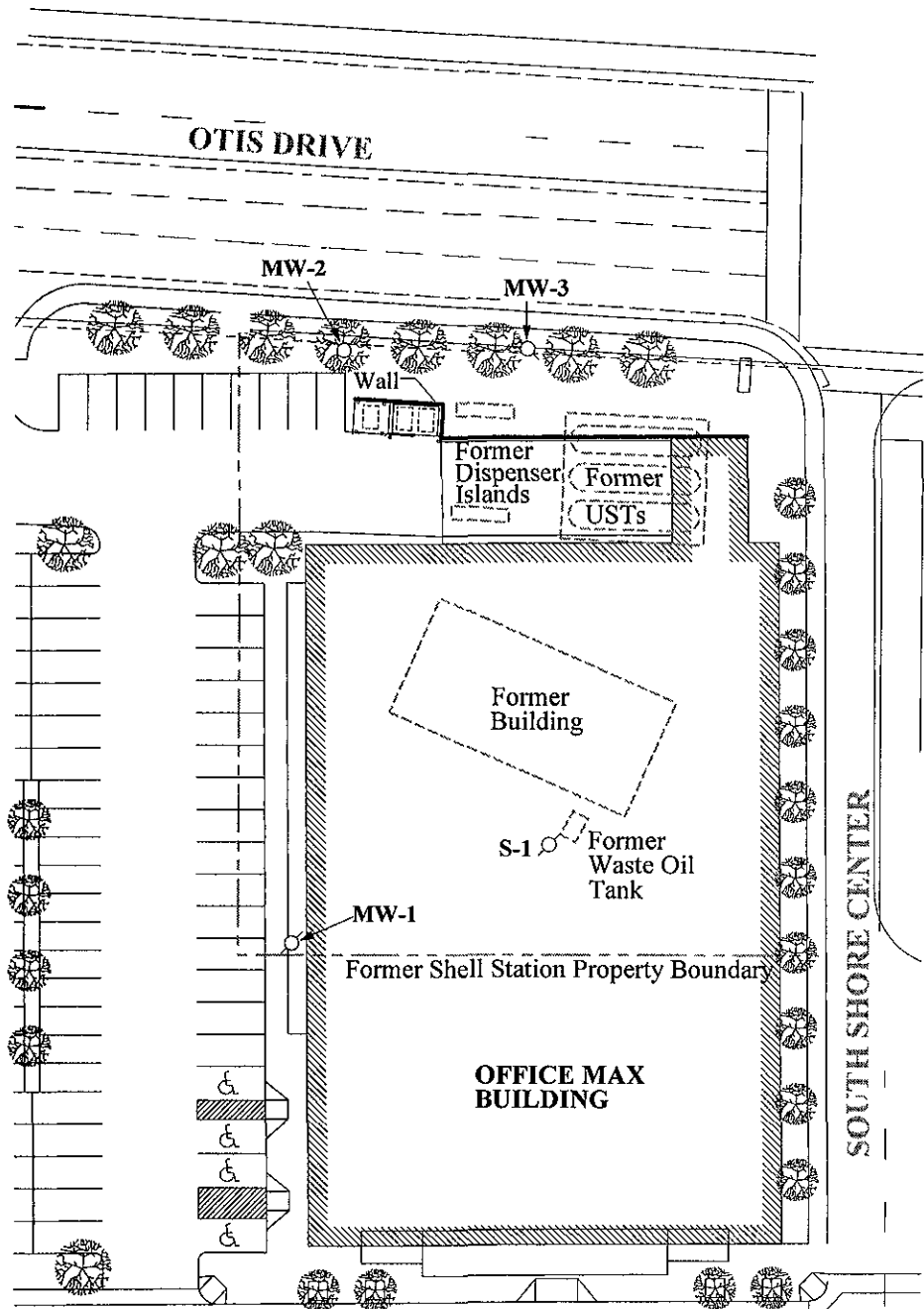

EXPLANATION

☉ Destroyed monitoring well

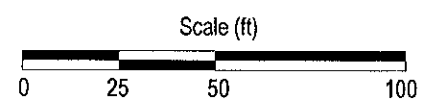

FIGURE
2

0627

Former Shell Service Station
2160 Otis Drive
Alameda, California



CAMBRIA

Site Plan

Appendix A

Well Destruction Permit

Alameda County Public Works Agency - Water Resources Well Permit



399 Elmhurst Street
Hayward, CA 94544-1395
Telephone: (510)670-6633 Fax:(510)782-1939

Application Approved on: 10/27/2005 **By Jamesy**
Permits Issued: W2005-1044

Receipt Number: WR2005-2162
Permits Valid from 10/31/2005 **to** 10/31/2005

Application Id: 1129852011750
Site Location: 2160 Otis Dr, Alameda, CA 94501
Project Start Date: 10/31/2005

City of Project Site: Alameda
Completion Date: 10/31/2005

Applicant: Cambria Environmental - Bill De Boer
5900 Hollis St. #1, Emeryville, CA 94608
Property Owner: Shell Oil Products Co. (US)
20945 Wilmington, Carson, CA 90810
Client: ** same as Property Owner **

Phone: 510-420-3369
Phone: --

Total Due: \$300.00
Total Amount Paid: \$300.00
Paid By: CHECK **PAID IN FULL**

Works Requesting Permits:

Well Destruction-Monitoring - 1 Wells

Driller: Gregg Drilling - Lic #: 485165 - Method: over

Work Total: \$300.00

Specifications

Permit #	Issued Date	Expire Date	Owner Well Id	Hole Diam.	Casing Diam.	Seal Depth	Max. Depth	State Well #	Orig. Permit #	DWR #
W2005-1044	10/27/2005	01/29/2006	MW-3	8.00 in.	2.00 in.	4.00 ft	19.00 ft			

Specific Work Permit Conditions

1. Drilling Permit(s) can be voided/ cancelled only in writing. It is the applicant's responsibility to notify Alameda County Public Works Agency, Water Resources Section in writing for an extension or to cancel the drilling permit application. No drilling permit application(s) shall be extended beyond ninety (90) days from the original start date. Applicants may not cancel a drilling permit application after the completion date of the permit issued has passed.
2. Prior to any drilling activities, it shall be the applicant's responsibility to contact and coordinate an Underground Service Alert (USA), obtain encroachment permit(s), excavation permit(s) or any other permits or agreements required for that Federal, State, County or City, and follow all City or County Ordinances. No work shall begin until all the permits and requirements have been approved or obtained.
3. Compliance with the well-sealing specifications shall not exempt the well-sealing contractor from complying with appropriate State reporting-requirements related to well destruction (Sections 13750 through 13755 (Division 7, Chapter 10, Article 3) of the California Water Code). Contractor must complete State DWR Form 188 and mail original to the Alameda County Public Works Agency, Water Resources Section, within 60 days. Including permit number and site map.
4. Permittee shall assume entire responsibility for all activities and uses under this permit and shall indemnify, defend and save the Alameda County Public Works Agency, its officers, agents, and employees free and harmless from any and all expense, cost and liability in connection with or resulting from the exercise of this Permit including, but not limited to, property damage, personal injury and wrongful death.
5. Applicant shall contact George Bolton for an inspection time at 510-670-5594 at least five (5) working days prior to starting, once the permit has been approved. Confirm the scheduled date(s) at least 24 hours prior to drilling.

Alameda County Public Works Agency - Water Resources Well Permit

6. Permitte, permittee's contractors, consultants or agents shall be responsible to assure that all material or waters generated during drilling, boring destruction, and/or other activities associated with this Permit will be safely handled, properly managed, and disposed of according to all applicable federal, state, and local statutes regulating such. In no case shall these materials and/or waters be allowed to enter, or potentially enter, on or off-site storm sewers, dry wells, or waterways or be allowed to move off the property where work is being completed.

7. Overdrill & Tremie Grout with Cement (All depths)

8. Copy of approved drilling permit must be on site at all times. Failure to present or show proof of the approved permit application on site shall result in a fine of \$500.00.

9. Prior to installation of any monitoring wells into any public right-of-ways, it shall be the applicants responsibilities to contact and coordinate a Underground Service Alert (USA), obtain encroachment permit(s), excavation permit(s) or any other permits required for that City or to the County and follow all City or County Ordinances. It shall also be the applicants responsibilities to provide to the Cities or to Alameda County a Traffic Safety Plan for any lane closures or detours planned. No work shall begin until all the permits and requirements have been approved or obtained.

Appendix B

Cambria's Standard Field Procedures for Monitoring Well Destruction

CAMBRIA

STANDARD FIELD PROCEDURES FOR MONITORING WELL DESTRUCTION

This document presents standard field methods for destroying groundwater monitoring wells. The objective of well destruction is to destroy wells in a manner that is protective of potential water resources. The two procedures most commonly used are pressure grouting and drilling out the well. These procedures are designed to comply with Federal, State and local regulatory guidelines. Specific field procedures are summarized below.

Pressure Grouting

Pressure grouting consists of injecting neat Portland cement through a tremie pipe under pressure to the bottom of the well. The cement is composed of about five gallons of water to a 94 lb. sack of Portland I/II Cement. Once the well casing is full of grout, it remains pressurized for five minutes by applying a pressure of 25 pounds per square inch (psi) with a grout pump. The well casing can also be pressurized by extending the well casing to the appropriate height and filling it with grout. In either case, the additional pressure allows the grout to be forced into the sand pack. After grouting the sand pack and casing, the well vault is removed and the area resurfaced or backfilled as required.

Well Drill Out

When well drill out is required, the well location is cleared for subsurface utilities and a hollow-stem auger drilling rig is used to drill out the well casing and filter pack materials. First, drill rods are dropped down the well and used to guide the augers as they drill out the well. Once the well is drilled out, the boring is filled with Portland cement injected through the augers or a tremie pipe under pressure to the bottom of the boring. The well vault is removed and the area resurfaced or backfilled as required.

F:\TEMPLATE\SOPs\Well Destruction SOP.doc

Appendix C

DWR Well Driller's Completion Reports

CONFIDENTIAL

STATE OF CALIFORNIA DWR
WELL COMPLETION REPORT
(WELL LOGS)

REMOVED