

Post-it™ brand fax transmittal memo 7671

of pages >



GTEL

ENVIRONMENTAL
LABORATORIES, INC.

Northwest Region

4080-C Pike Lane
Concord, CA 94520
(415) 685-7852
(800) 544-3422 from inside California
(800) 423-7143 from outside California
(415) 825-0720 (FAX)

To	EVA CHIS	From	QUEN KIMMEL
Co.		Co.	FUGRO WEST
Dept.		Phone #	916-782-2110
Fax #	510-5694757	Fax #	

April 9, 1991

Soil sample analysis from
weld dispensers

Peter Timmerman
Bay Area Tank Testing
2681 Overlook Dr., P.O. Box 4479
Walnut Creek, CA 94596

Enclosed please find the analytical results report prepared by GTEL for samples received on 04/01/91, under chain of custody number 72-12901.

GTEL is certified by the California State Department of Health Services to perform analyses for drinking water, wastewater, and hazardous waste materials according to EPA protocols.

A formal quality control/quality assurance program is maintained by GTEL, which is designed to meet or exceed the EPA requirements. Analytical work for this project was performed in strict adherence to our QA/QC program to ensure sample integrity and to meet quality control criteria.

If you have any questions concerning this analysis or if we can be of further assistance, please call our Customer Service Representative.

Sincerely,

GTEL Environmental Laboratories, Inc.

Emma P. Popek / PAKS

Emma P. Popek
Laboratory Director



Client Number: BAY01.BAY010-72
Project ID: 6873 Village Parkway
Dublin, CA
Work Order Number: C1-04-034

Northwest Region
4080 Pike Lane
Concord, CA 94520
(415) 685-7852
(800) 544-3422 from inside California
(800) 423-7143 from outside California

April 5, 1991

Peter Timmerman
Bay Area Tank Testing
2681 Overlook Dr., P.O. Box 4479
Walnut Creek, CA 94596

Enclosed please find the analytical results report prepared by GTEL for samples received on 04/01/91, under chain of custody number 72-12901.

GTEL is certified by the California State Department of Health Services to perform analyses for drinking water, wastewater, and hazardous waste materials according to EPA protocols.

A formal quality control/quality assurance program is maintained by GTEL, which is designed to meet or exceed the EPA requirements. Analytical work for this project was performed in strict adherence to our QA/QC program to ensure sample integrity and to meet quality control criteria.

If you have any questions concerning this analysis or if we can be of further assistance, please call our Customer Service Representative.

Sincerely,

GTEL Environmental Laboratories, Inc.

A handwritten signature in cursive script that reads 'Emma P. Popek'.

Emma P. Popek
Laboratory Director

Client Number: BAY01.BAY01-72
 Project ID: 6973 Village Parkway
 Dublin, CA
 Work Order Number: C1-04-035

Table 1
ANALYTICAL RESULTS
Lead in Soil
EPA Method 6010^a

a. Test Methods for Evaluating Solid Waste, SW-846, Third Edition, Revision 0, US EPA November 1986. Sample preparation by Method 3080.

GTEL Sample Number		01	02		
Client Identification		1	2		
Date Sampled		04/01/91	04/01/91		
Date Prepared		04/03/91	04/03/91		
Date Analyzed		04/03/91	04/03/91		
Analyte	Detection Limit, mg/Kg	Concentration, mg/Kg			
Lead, total	5	5	6		
Detection Limit Multiplier		1	1		

Client Number: BAY01.BAY010-72
 Project ID: 8872 Village Parkway
 Dublin, CA
 Work Order Number: C1-04-034

Table 1

ANALYTICAL RESULTS

Aromatic Volatile Organics and
 Total Petroleum Hydrocarbons as Gasoline in Soil

(Under Dispensers)

EPA Methods 5030, 8020, and Modified 8015^a

GTEL Sample Number		01	02		
Client Identification		1	2		
Date Sampled		04/01/91	04/01/91		
Date Extracted		04/01/91	04/01/91		
Date Analyzed		04/01/91	04/01/91		
Analyte	Detection Limit, mg/Kg	Concentration, mg/Kg			
Benzene	0.005	0.06	0.9		
Toluene	0.005	<0.005	0.9		
Ethylbenzene	0.005	0.1	0.6		
Xylene, total	0.015	0.2	3		
BTEX, total	--	0.36	5		
TPH as Gasoline	1	65	16		
Detection Limit Multiplier		1	1		

- a. Test Methods for Evaluating Solid Waste, SW-846, Third Edition, Revision 0, US EPA November 1986. Modification for TPH as gasoline as per California State Water Resources Control Board LUST Manual protocols, May 1988 revision.

004 034



4080 Pike Lane
Concord, CA 94520
415-665-7862
600-544-3422 (In CA)
800-423-7143 (Outside CA)

CHAIN-OF-CUSTODY RECORD
AND ANALYSIS REQUEST

72-12901

CUSTODY RECORD

ANALYSIS REQUEST

Project Manager: *BY AREA TANK TERROR* Phone #: *932-4343*
Peter Timmerman FAX #: *934-1823*

Address: *P.O. Box 4479* Site location: *6973 Village Parkway, Dublin*

Project Number: *X* Project Name: *Corwood Car Wash*

I attest that the proper field sampling procedures were used during the collection of these samples. Sampler Name (Print): *Peter Timmerman*

- STEK 502 6020 with MDE
- STEK/TPM Glass 6020/6015 6020/6015 MTBE
- TPH as Gas Diesel Jet Fuel
- Product LD. by GC (SIM/DIS)
- Total Oil & Grease: 413.1 413.2 503A
- Total Petroleum Hydrocarbons: 416.1 503E
- EPA 801 8010 DCA only
- EPA 802 8020
- EPA 808 8080 PCBs only
- EPA 810 8310
- EPA 824 8240 NBS +15
- EPA 825 8270 NBS +25
- EPTOX: Metals Pesticides Herbicides
- TCLP Metals VOA Semi VOA
- EPA Priority Pollutant Metals HSL
- LEAD 7490 7421 326.2 6010 Org. Lead
- CAM Metals TLIC
- Conductivity TSS Reactivity

Field Sample ID	Source of Sample	GTEL Lab # (Lab use only)	# CONTAINERS	Matrix					Method Preserved					Sampling		
				WATER	SOIL	AIR	SLUDGE	OTHER	HCl	HNO3	H2SO4	ICE	NONE	OTHER	DATE	TIME
1	Soil	01	1	X							X				4/19/91	8:15
2	Soil	02	1	X							X				"	9:15

Received by: *[Signature]*

Received by: *[Signature]*

Received by Laboratory: *[Signature]*

Date: 4/19/91 **Time:** 11:03

Date: 4/19/91 **Time:** 11:03

Date: 4/19/91 **Time:** 11:03

May bill #

SPECIAL HANDLING
 24 HOURS *m. wood*
 EXPEDITED 48 Hours
 SEVEN DAY
 OTHER _____ (#) BUSINESS DAYS
 QA/QC CLP Level Blue Level
 FAX

SPECIAL DETECTION LIMITS (Specify) REMARKS:

SPECIAL REPORTING REQUIREMENTS (Specify)

Lab Use Only Lot #: Storage Location Work Order #:

Relinquished by Sampler: *[Signature]*
Relinquished by: *[Signature]*
Relinquished by:

P. 5/6

APR 22 '94 02:46PM FUGRO WEST ROSEVILLE

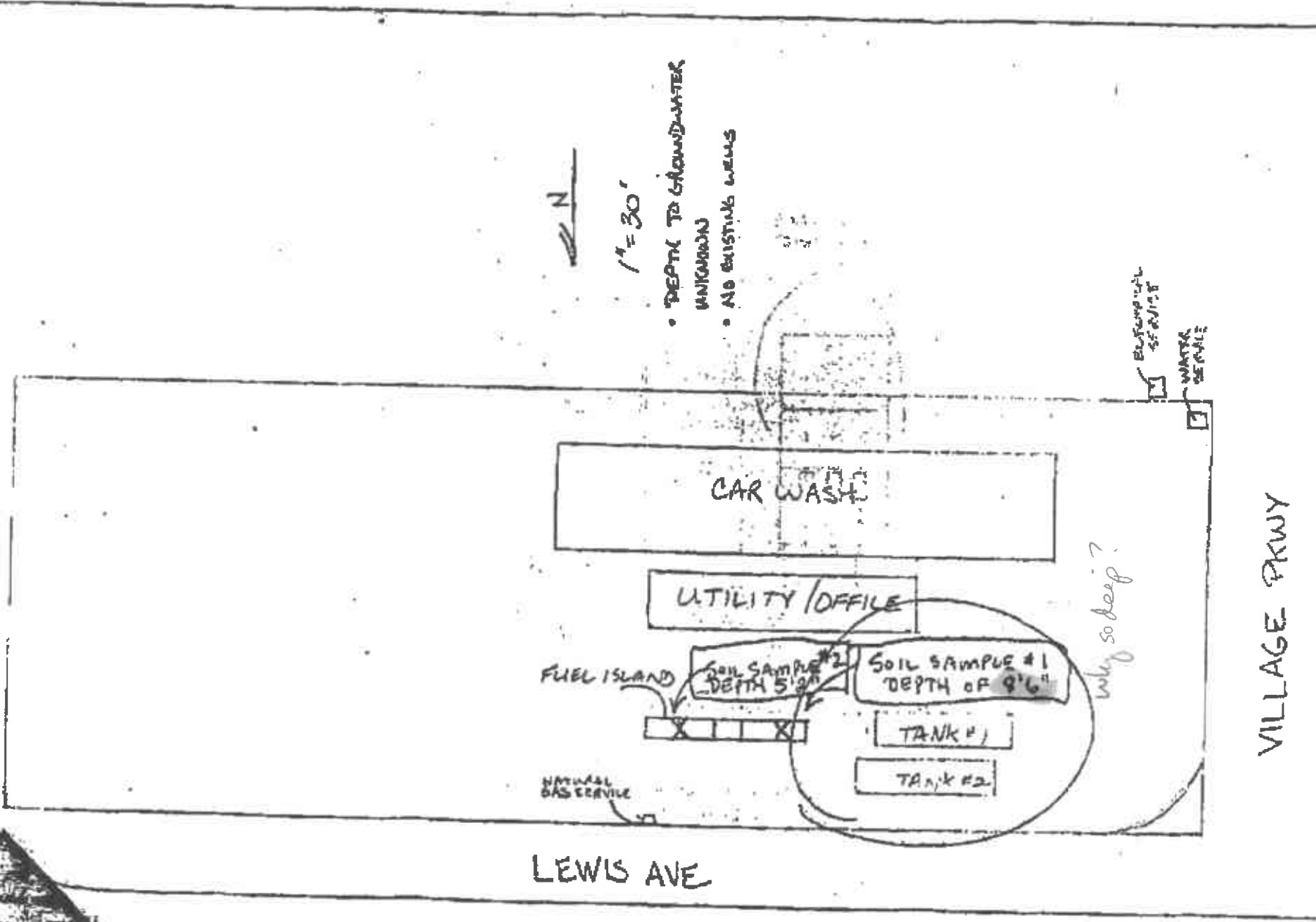

VILLAGE PKWY

LEWIS AVE