

ExxonMobil
Refining & Supply Company
Global Remediation

Gene. N. Ortega
Territory Manager
Global Remediation – US Retail

2300 Clayton Road, Suite 1250
Concord, CA 94520
(925) 246-8768 Telephone
(925) 246-8798 Facsimile
darin.l.rouse@exxonmobil.com

ExxonMobil
Refining & Supply

May 23, 2003

Mr. Scott Seery
Alameda County Health Care Services Agency
Department of Environmental Health
1131 Harbor Bay Parkway, Suite 250
Alameda, California 94502-6577

Alameda County
JUN 05 2003
Environmental Health

RE: Former Exxon RAS #7-3567/3192 Santa Rita Road, Pleasanton, California.

Dear Mr. Seery:

Attached for your review and comment is a letter report entitled *Quarterly Groundwater Monitoring Report, Second Quarter 2003*, dated May 12, 2002, for the above-referenced site. The report was prepared by Environmental Resolutions, Inc. (ERI) of Novato, California, and presents the results of quarterly groundwater monitoring and sampling activities for the subject site.

If you have any questions or comments, please contact me at (925) 246-8747.

Sincerely,



Gene N. Ortega
Territory Manager

Attachment: ERI's Quarterly Groundwater Monitoring Report, Second Quarter 2003, dated May 12, 2002.

cc: w/ attachment
Mr. Eddy So, California Regional Water Quality Control Board, San Francisco Bay Region
Ms. Colleen Morf, Zone 7 Water Agency
Mr. Joseph A. Aldridge, Valero Energy Corporation

w/o attachment
Mr. Scott R. Graham, Environmental Resolutions, Inc.



ENVIRONMENTAL RESOLUTIONS, INC.

May 12, 2003
ERI 243113.Q032
Alameda County

JUN 05 2003

Environmental Health

Mr. Gene N. Ortega
ExxonMobil Oil Corporation
2300 Clayton Road, Suite 1250
Concord, California 94520

Subject: Quarterly Groundwater Monitoring Report, Second Quarter 2003, Former Exxon Service Station 7-3567, 3192 Santa Rita Road, Pleasanton, California.

Mr. Ortega:

At the request of ExxonMobil Oil Corporation (ExxonMobil), Environmental Resolutions, Inc. (ERI) performed second quarter 2003 groundwater monitoring and sampling at the subject site. The purpose of quarterly monitoring and sampling is to evaluate hydrocarbon concentrations in groundwater and groundwater flow direction and hydraulic gradient. The location of the site is shown on the Site Vicinity Map (Plate 1). The configuration of the site and select site features are shown on the Generalized Site Plan (Plate 2).

GROUNDWATER MONITORING AND SAMPLING

On April 10, 2003, ERI measured depth to water (DTW) and collected groundwater samples from select monitoring wells for laboratory analysis. Work was performed in accordance with ERI's groundwater sampling protocol provided in Attachment A.

The calculated hydraulic gradient and groundwater flow direction for the lower water-bearing zone and upper water-bearing zone are presented on Plate 3 and Plate 4, respectively. Historical and recent monitoring data are summarized in Table 1.

Laboratory Analyses And Results

ERI submitted groundwater samples to Test America Incorporated (Test America), a California state-certified laboratory, under Chain-of-Custody protocol. The samples were analyzed for benzene, toluene, ethylbenzene, and total xylenes (BTEX); methyl tertiary butyl ether (MTBE); total petroleum hydrocarbons as diesel (TPHd); and total petroleum hydrocarbons as gasoline (TPHg) using the methods listed in the notes in Table 1. Additionally, at the request of Alameda County Health Care Services, in a letter dated October 29 2002, ERI also collected and analyzed samples for the presence of total fuel oxygenates (MTBE; tertiary-amyl ether [TAME]; ethyl tertiary butyl ether [ETBE]; di-isopropyl ether [DIPE]; and tertiary butyl alcohol [TBA]); and lead scavengers (1,2-dibromoethane [EDB] and 1,2-dichloroethane [1,2-DCA]), using EPA Method 8260. The laboratory analysis report and Chain-of-Custody record are attached (Attachment B). Cumulative results of laboratory analyses of groundwater samples are summarized in Table 1. Analytical results of recent groundwater samples are presented on Plate 2.

DOCUMENT DISTRIBUTION

ERI recommends forwarding copies of this report to:

Mr. Scott Seery
Alameda County Health Care Services Agency
Department of Environmental Health
1131 Harbor Bay Parkway, Suite 250
Alameda, California 94502-6577

Mr. Eddy So
California Regional Water Quality Control Board
San Francisco Bay Region
1515 Clay Street, Suite 1400
Oakland, California 94612

Ms. Colleen Morf
Zone 7 Water Agency
5997 Parkside Drive
Pleasanton, California 94588

Mr. Joseph A. Aldridge
Valero Energy Corporation
685 West Third Street
Hanford, California 93230

LIMITATIONS

This report was prepared in accordance with generally accepted standards of environmental practice in California at the time this investigation was performed. This report has been prepared for ExxonMobil, and any reliance on this report by third parties shall be at such party's sole risk.

Please call Mr. Scott R. Graham, ERI's project manager for this site, (415) 382-5989 with any questions regarding this project.

Sincerely,
Environmental Resolutions, Inc.



Scott R. Graham
Scott R. Graham
Project Manager

Steve M. Zigan
Steve M. Zigan
R.G. 4333
H.G. 133

- Attachments: Table 1: Cumulative Groundwater Monitoring and Sampling Data
- Plate 1: Site Vicinity Map
- Plate 2: Generalized Site Plan
- Plate 3: Groundwater Elevation Map Lower Water-Bearing Zone
- Plate 4: Groundwater Elevation Map Upper Water-Bearing Zone
- Attachment A: Groundwater Sampling Protocol
- Attachment B: Laboratory Analysis Report and Chain-of-Custody Record

TABLE 1
CUMULATIVE GROUNDWATER MONITORING AND SAMPLING DATA
Former Exxon Service Station 7-3567
3192 Santa Rita Road
Pleasanton, California
(Page 1 of 4)

Well ID# (TOC)	Sampling Date	SUBJ	DTW feet	Elev.	TPHd	TPHg	MTBE	B ug/L	T	E	X	VOCs	
(340.86)	11/17/98	NLPH	21.90	318.96	<50	<50	<2.5	<0.5	<0.5	<0.5	<0.5	---	
	03/15/99	NLPH	21.15	319.71	<50	<50	<2.5	<0.5	<0.5	<0.5	<0.5	---	
	06/25/99	NLPH	20.34	320.52	a	<50	<2.0	<0.5	<0.5	<0.5	<0.5	---	
	09/24/99	NLPH	20.42	320.44	<50	<50	24.6	<0.5	<0.5	<0.5	<0.5	---	
	12/22/99	NLPH	21.11	319.75	<61	<50	<2	<0.5	<0.5	<0.5	<0.5	---	
	03/07/00	NLPH	14.12	326.74	57	<50	220	<0.5	<0.5	<0.5	<0.5	---	
	06/06/00	NLPH	17.79	323.07	<50	<50	5.4	<0.5	<0.5	<0.5	<0.5	---	
	06/16/00	Property transferred to Valero Refining Company.											
	07/31/00	NLPH	19.02	321.84	<50	<50	51/38d	<0.5	<0.5	<0.5	<0.5	---	
	10/10/00	NLPH	18.56	322.30	<50	<50	63	<0.5	<0.5	<0.5	<0.5	---	
	01/11/01	NLPH	21.43	319.43	<50	<50	110/98d	<0.5	<0.5	<0.5	<0.5	---	
	04/11/01	NLPH	19.83	321.03	960e	<50	29/33d	<0.5	<0.5	<0.5	<0.5	---	
	07/20/01	NLPH	20.50	320.36	<50	<50	27/20d	<0.5	<0.5	<0.5	<0.5	---	
	10/19/01	NLPH	19.48	321.38	<50	<50	390/420d	<0.5	<0.5	<0.5	<0.5	---	
	(340.86)	Nov-2001	Well surveyed in compliance with AB 2886 requirements.										
	01/28/02	NLPH	19.72	321.14	<100	178	196	<0.50	<0.50	<0.50	<0.50	---	
	04/17/02	NLPH	22.17	318.69	<50	124	116.1/131d	<0.5	<0.50	<0.50	<0.50	---	
	07/17/02	NLPH	22.51	318.35	<50	<50.0	5.1/8.76d	<0.5	<0.5	<0.5	<0.5	---	
	10/24/02	NLPH	22.51	318.35	<50	217	574/302d	<0.5	<0.5	<0.5	<0.5	---	
	03/21/03	NLPH	21.32	319.54	<50	70.9	83.4d	<0.50	<0.5	<0.5	<0.5	ND	
	04/10/03	NLPH	21.27	319.59	<51	67.2	71.0d	<0.50	<0.5	<0.5	<0.5	ND	
(340.61)	11/17/98	NLPH	20.42	320.19	91	<50	17/23d	1.5	<0.5	0.98	2.6	---	
	03/15/99	NLPH	28.35	312.26	90	<50	12/12.5d	0.73	1.1	2.4	2.2	---	
	06/25/99	NLPH	25.20	315.41	a	<50	<2.0	<0.5	<0.5	<0.5	<0.5	---	
	09/24/99	NLPH	23.93	316.68	<50	<50	3.06	<0.5	<0.5	<0.5	<0.5	---	
	12/22/99	NLPH	23.39	317.22	<56	<50	<2	<0.5	<0.5	<0.5	<0.5	---	
	03/07/00	NLPH	17.08	323.53	52	<50	<2	<0.5	0.80	<0.5	<0.5	---	
	06/06/00	NLPH	21.01	319.60	<50	<50	<2	<0.5	<0.5	<0.5	<0.5	---	
	06/16/00	Property transferred to Valero Refining Company.											
	07/31/00	NLPH	22.08	318.53	<50	<50	6.8/<5d	<0.5	<0.5	<0.5	<0.5	---	
	10/10/00	NLPH	22.35	318.26	<50	<50	<2	<0.5	<0.5	<0.5	<0.5	---	
	01/11/01	NLPH	23.74	316.87	<50	<50	<2	0.54	<0.5	<0.5	<0.5	---	
	04/11/01	NLPH	22.34	318.27	760e	<50	<2	<0.5	1.4	<0.5	<0.5	---	
	07/20/01	NLPH	23.74	316.87	<50	<50	<2	<0.5	<0.5	<0.5	<0.5	---	
	10/19/01	NLPH	22.68	317.93	<50	<50	<2	<0.5	<0.5	<0.5	<0.5	---	
	(340.16)	Nov-2001	Well surveyed in compliance with AB 2886 requirements.										
	01/28/02	NLPH	20.79	319.37	<50.0	<50.0	0.70	<0.50	<0.50	<0.50	<0.50	---	
	04/17/02	NLPH	25.52	314.64	<50	<50.0	4.20/4.35d	<0.5	0.90	<0.50	<0.50	---	
	07/17/02	NLPH	28.18	311.98	<50	<50.0	9.4/10.3d	<0.5	0.6	2.4	2.0	---	
	10/24/02	NLPH	28.42	311.74	<50	<50.0	8.6/9.30d	<0.5	<0.5	<0.5	<0.5	---	
	03/21/03	NLPH	23.54	316.62	<50	<50.0	<0.50d	1.10	0.5	1.3	2.2	ND	
	04/10/03	NLPH	28.19	311.97	<50	<50.0	2.10d	0.60	0.5	0.8	1.0	ND	

TABLE 1
CUMULATIVE GROUNDWATER MONITORING AND SAMPLING DATA
Former Exxon Service Station 7-3567
3192 Santa Rita Road
Pleasanton, California
(Page 2 of 4)

Well ID# (TOC)	Sampling Date	SUBJ	DTW feet	Elev.	TPHd	TPHg	MTBE	B	T	E	X	VOCs	
								ug/L					
(342.95)	11/17/98	NLPH	36.58	306.37	120	<50	180/220d	<0.5	<0.5	<0.5	<0.5	---	
	03/15/99	NLPH	40.01	302.94	180	<50	290/314d	<0.5	<0.5	<0.5	<0.5	---	
	06/25/99	NLPH	46.83	296.12	a	<50	107/113d	<0.5	<0.5	<0.5	<0.5	---	
	9/24/99 ^b	NLPH	47.71	295.24	---	---	---	---	---	---	---	---	
	12/22/99	NLPH	43.82	299.13	140	<50	65	<0.5	<0.5	<0.5	<0.5	---	
	03/07/00	NLPH	32.75	310.20	<50	<50	82	<0.5	0.88	<0.5	<0.5	---	
	06/06/00	NLPH	36.05	306.90	<50	<50	140	<0.5	<0.5	0.82	<0.5	---	
	06/16/00	Property transferred to Valero Refining Company.											
	07/31/00	NLPH	36.77	306.18	<50	<50	230/160d	<0.5	<0.5	<0.5	<0.5	<0.5	i
	10/10/00	NLPH	35.82	307.13	<50	<50	200	<0.5	<0.5	<0.5	<0.5	<0.5	---
	01/11/01	NLPH	38.08	304.87	<50	<50	280/230d	<0.5	<0.5	<0.5	<0.5	<0.5	---
	04/11/01	NLPH	36.03	306.92	1,000e	<50	240/280d	<0.5	<0.5	<0.5	<0.5	<0.5	---
	07/20/01	NLPH	36.05	306.90	<50	270	240/190d	<0.5	<0.5	<0.5	<0.5	<0.5	---
	10/19/01	NLPH	34.58	308.37	<50	<50	180/190d	<0.5	<0.5	<0.5	<0.5	<0.5	---
(342.95)	Nov-2001	Well surveyed in compliance with AB 2886 requirements.											
	01/28/02	NLPH	34.96	307.99	<100	167	179	<0.50	<0.50	<0.50	<0.50	<0.50	---
	04/17/02	NLPH	38.21	304.74	<50	194	179.3/216d	<0.5	<0.50	<0.50	<0.50	<0.50	---
	07/17/02	g	g	g	<50h	163h	185/198d,h	<0.5h	<0.5h	<0.5h	<0.5h	<0.5h	---
	10/24/02	NLPH	38.68	304.27	<50	128	163/183d	<0.5	<0.5	<0.5	<0.5	<0.5	---
	03/21/03	NLPH	36.50	306.45	<50	119	141d	<0.50	<0.5	<0.5	<0.5	<0.5	ND
	04/10/03	NLPH	36.82	306.13	<53	119	130d	<0.50	<0.5	<0.5	<0.5	<0.5	ND
(342.96)	11/17/98	NLPH	50.20	292.76	72	<50	4.1/3.5d	<0.5	<0.5	<0.5	<0.5	---	
	03/15/99	NLPH	47.93	295.03	91	<50	280/260d	<0.5	<0.5	<0.5	<0.5	---	
	6/25/99 ^b	NLPH	48.15	294.81	---	---	---	---	---	---	---	---	
	9/24/99 ^b	NLPH	49.29	293.67	---	---	---	---	---	---	---	---	
	12/22/99	NLPH	49.33	293.63	b	---	---	---	---	---	---	---	
	03/07/00	NLPH	49.05	293.91	190	<50	710	<0.5	0.84	<0.5	<0.5	<0.5	---
	06/06/00	NLPH	49.02	293.94	110	<50	460	<0.5	<0.5	<0.5	<0.5	<0.5	---
	06/16/00	Property transferred to Valero Refining Company.											
	07/31/00	NLPH	49.13	293.83	<50	<50	480/490d	<0.5	<0.5	<0.5	<0.5	<0.5	i
	10/10/00	NLPH	40.08	302.88	c	c	c	c	c	c	c	c	c
	01/11/01	NLPH	36.41	306.55	110	<50	27/21d	<0.5	<0.5	<0.5	<0.5	<0.5	---
	04/11/01	NLPH	36.43	306.53	870e	<50	3.6/14d	<0.5	0.56	<0.5	<0.5	<0.5	---
	07/20/01	f	---	---	---	---	---	---	---	---	---	---	---
	10/19/01	NLPH	33.67	309.29	71	<50	15/16d	<0.5	<0.5	<0.5	<0.5	<0.5	---
(342.96)	Nov-2001	Well surveyed in compliance with AB 2886 requirements.											
	01/28/02	NLPH	33.11	309.85	148	<50.0	18.7	<0.50	<0.50	<0.50	<0.50	<0.50	---
	04/17/02	NLPH	36.03	306.93	<50	<50.0	19.10/23.4d	<0.5	<0.50	<0.50	<0.50	<0.50	---
	07/17/02	NLPH	37.65	305.31	<50	<50.0	16.7/15.8d	<0.5	<0.5	<0.5	<0.5	<0.5	---
	10/24/02	NLPH	37.41	305.55	<50	<50.0	8.7/8.90d	<0.5	<0.5	<0.5	<0.5	<0.5	---
	03/21/03	NLPH	36.18	306.78	<56	<50.0	14.2d	<0.50	<0.5	<0.5	<0.5	<0.5	ND
	04/10/03	NLPH	36.55	306.41	<51	<50.0	15.3d	<0.50	<0.5	<0.5	<0.5	<0.5	ND

TABLE 1
CUMULATIVE GROUNDWATER MONITORING AND SAMPLING DATA
Former Exxon Service Station 7-3567
3192 Santa Rita Road
Pleasanton, California
(Page 3 of 4)

Well ID# (TOC)	Sampling Date	SUBJ ←.....feet.....→	DTW feet	Elev.	TPHd	TPHg	MTBE	B	T	E	X	VOCs	
					←.....ug/l.....→								
MW5 (342.87)	06/16/00	Property transferred to Valero Refining Company.											
	07/31/00	---	dry		b	b	b	b	b	b	b	---	
	10/10/00	NLPH	29.12	313.75	150	<50	4.2	<0.5	<0.5	<0.5	<0.5	---	
	01/11/01	NLPH	28.89	313.98	b	b	b	b	b	b	b	---	
	04/11/01	NLPH	28.23	314.64	b	b	b	b	b	b	b	---	
	07/20/01	f	---	---	---	---	---	---	---	---	---	---	
	10/19/01	NLPH	27.62	315.25	86	<50	3.4/5d	<0.5	<0.5	<0.5	<0.5	---	
(342.87)	Nov-2001	Well surveyed in compliance with AB 2886 requirements.											
	01/28/02	NLPH	28.04	314.83	<100	<50.0	5.90	<0.50	<0.50	<0.50	<0.50	---	
	04/17/02	NLPH	29.10	313.77	85	<50.0	5.60/6.7d	<0.5	<0.50	<0.50	<0.50	---	
	07/17/02	NLPH	29.37	313.50	b	b	b	b	b	b	b	---	
	10/24/02	NLPH	29.36	313.51	b	b	b	b	b	b	b	---	
	03/21/03	NLPH	28.55	314.32	b	57.8	8.70d	2.50	1.0	3.5	5.9	ND	
	04/10/03	NLPH	29.10	313.77	b	56.1	7.20d	5.50	3.0	2.9	4.3	ND	
MW6 (341.05)	06/16/00	Property transferred to Valero Refining Company.											
	07/31/00	NLPH	39.72	301.33	<50	<50	<2/<5	<0.5	<0.5	<0.5	<0.5	i	
	10/10/00	NLPH	40.12	300.93	<50	c	c	c	c	c	c	c	
	01/11/01	NLPH	46.13	294.92	<50	<50	<2	<0.5	<0.5	<0.5	<0.5	---	
	04/11/01	NLPH	45.40	295.65	b	b	b	b	b	b	b	---	
	07/20/01	NLPH	41.75	299.30	<50	<50	<5	<0.3	<0.3	<0.6	<0.6	---	
	10/19/01	NLPH	44.10	296.95	<50	<50	<2	<0.5	<0.5	<0.5	<0.5	---	
(341.05)	Nov-2001	Well surveyed in compliance with AB 2886 requirements.											
	01/28/02	NLPH	39.57	301.48	<100	<50.0	<0.50	<0.50	<0.90	<0.50	<0.50	---	
	04/17/02	NLPH	41.84	299.21	52	<50.0	<0.50	<0.5	<0.50	<0.50	<0.50	---	
	07/17/02	NLPH	42.85	298.20	<50	<50.0	<0.5	<0.5	<0.5	<0.5	<0.5	---	
	10/24/02	NLPH	42.10	298.95	<50	<50.0	<0.5	<0.5	<0.5	<0.5	<0.5	---	
	03/21/03	NLPH	44.81	296.24	107	<50.0	<0.50	<0.50	<0.5	<0.5	<0.5	ND	
	04/10/03	NLPH	44.28	296.77	60	<50.0	0.80d	<0.50	<0.5	<0.5	<0.5	ND	
MW7 (341.73)	06/16/00	Property transferred to Valero Refining Company.											
	07/31/00	NLPH	24.22	317.51	150	<50	13/8d	<0.5	<0.5	<0.5	<0.5	i	
	10/10/00	NLPH	24.09	317.64	1,500	c	c	c	c	c	c	c	
	01/11/01	NLPH	25.86	315.87	330	<50	6.9/7d	0.55	<0.5	<0.5	<0.5	---	
	04/11/01	NLPH	24.28	317.45	980e	<250	<10	<2.5	<2.5	<2.5	<2.5	---	
	07/20/01	NLPH	25.52	316.21	300	<50	8.2/6d	<0.5	<0.5	<0.5	<0.5	---	
	10/19/01	NLPH	24.99	316.74	120	<50	4.9/<5d	<0.5	<0.5	<0.5	<0.5	---	
(341.73)	Nov-2001	Well surveyed in compliance with AB 2886 requirements.											
	01/28/02	NLPH	23.84	317.89	<100	<50.0	8.50	<0.50	<0.50	<0.50	<0.50	---	
	04/17/02	NLPH	28.19	313.54	55	<50.0	9.70/11.6d	<0.5	2.10	<0.50	<0.50	---	
	07/17/02	NLPH	29.74	311.99	69	<50.0	9.7/9.00d	<0.5	<0.5	<0.5	<0.5	---	
	10/24/02	NLPH	29.50	312.23	262	<50.0	5.4/6.00d	<0.5	<0.5	<0.5	<0.5	---	
	03/21/03	NLPH	26.07	315.66	<50	<50.0	6.00	<0.50	0.8	<0.5	<0.5	ND	
	04/10/03	NLPH	26.06	315.67	<50	<50.0	9.00d	<0.50	<0.5	<0.5	<0.5	ND	

TABLE 1
 CUMULATIVE GROUNDWATER MONITORING AND SAMPLING DATA
 Former Exxon Service Station 7-3567
 3192 Santa Rita Road
 Pleasanton, California
 (Page 4 of 4)

Well ID# (TOC)	Sampling Date	SUBJfeet.....	DTWfeet.....	Elev.	TPHd	TPHg	MTBE	B	T	E	X	VOCs
.....ug/L.....>												
MW8 (341.44)	06/16/00	Property transferred to Valero Refining Company.										
	04/11/01	---	dry	dry	b	b	b	b	b	b	b	---
	04/11/01	---	b	---	b	b	b	b	b	b	b	---
	07/20/01	---	dry	dry	b	b	b	b	b	b	b	---
	10/19/01	---	dry	dry	b	b	b	b	b	b	b	---
	01/28/02	---	dry	dry	b	b	b	b	b	b	b	---
	04/17/02	---	dry	dry	b	b	b	b	b	b	b	---
	07/17/02	---	dry	dry	b	b	b	b	b	b	b	---
	10/24/02	---	dry	dry	b	b	b	b	b	b	b	---
	03/21/03	---	dry	dry	b	b	b	b	b	b	b	b
	04/10/03	---	dry	dry	b	b	b	b	b	b	b	b

Notes:

- TOC = Elevation of top of well casing; in feet above mean sea level.
- SUBJ = Results of subjective evaluation, liquid-phase hydrocarbon thickness (HT) in feet.
- DTW = Depth to water.
- Elev. = Elevation of groundwater in feet above mean sea level.
- NLPH = No liquid-phase hydrocarbons present in well.
- TPHd = Total petroleum hydrocarbons as diesel analyzed using modified EPA Method 8015.
- TPHg = Total petroleum hydrocarbons as gasoline analyzed using modified EPA Method 5030/8015 (modified).
- BTEX = Benzene, toluene, ethylbenzene, and total xylenes analyzed using EPA Method 8021B.
- MTBE = Methyl tertiary butyl ether analyzed using EPA Method 8021B.
- VOCs = Volatile organic compounds analyzed using EPA Method 8260B.
- ug/L = Micrograms per liter.
- a = No result because of sample loss during laboratory fire.
- b = Well contained an insufficient amount of water to collect a sample or well was dry.
- c = Samples were damaged during transportation to laboratory.
- d = MTBE confirmed using EPA Method 8260.
- e = Diesel-range hydrocarbons detected in bailer blank; result is suspect.
- f = Well inaccessible.
- g = Due to equipment failure, DTW was not measured.
- h = Grab sample; Equipment failure unable to purge well.
- i = Not detected at or above the stated laboratory method reporting limit for the following constituents: 1,2 Dichloroethane, 2-Nitropropane, Di-isopropyl ether, tertiary amyl methyl ether, and tertiary butyl ethyl ether.
- < = Not detected at or above the stated laboratory method reporting limit.
- = Not analyzed/Not applicable.

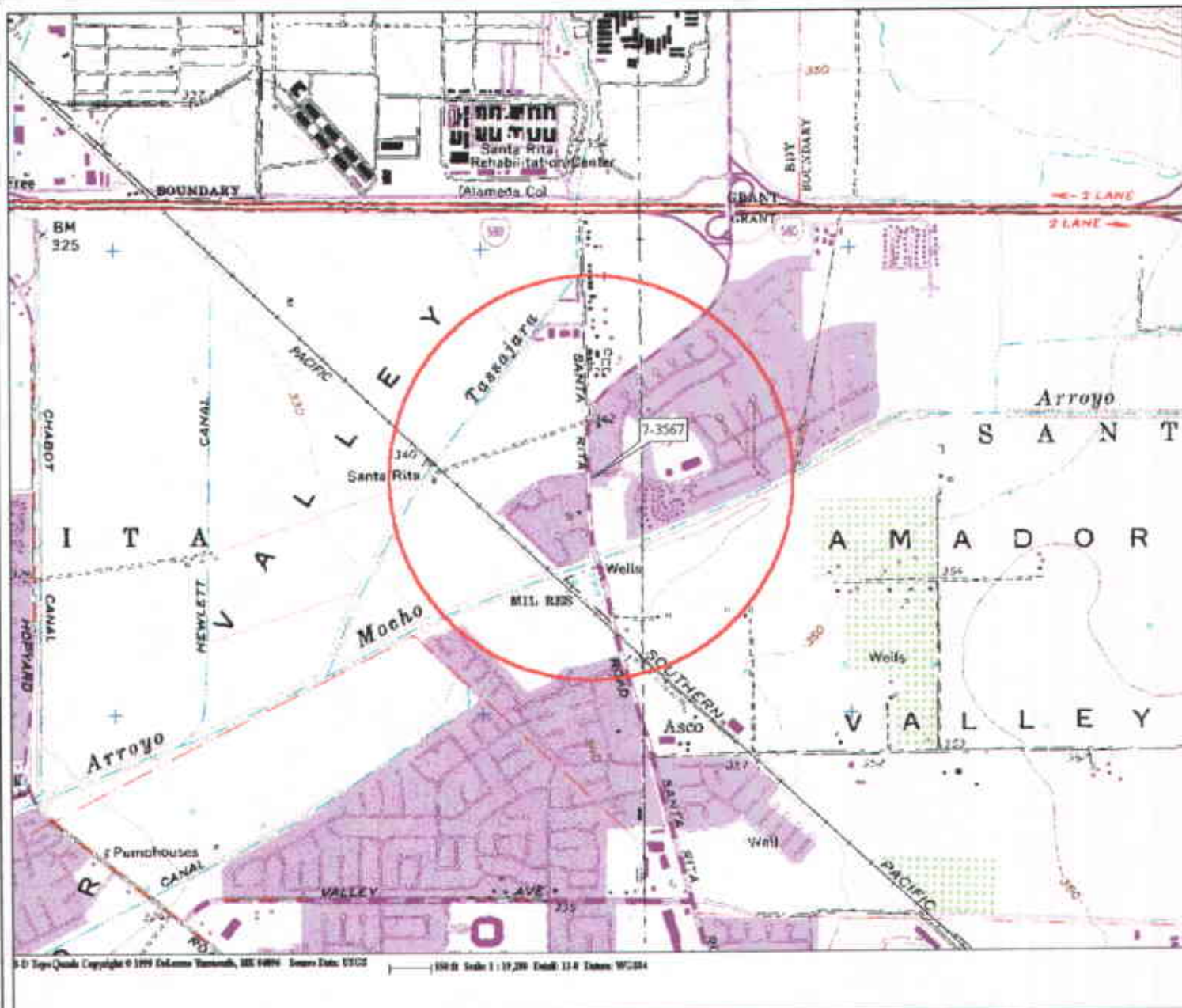

3-D TopoQuads Copyright © 1999 DeLorme Barre, ME 04896 Source Data: 53123 1:50,000 Scale 1:10,000 Elevation: 12.8 Inches WGS84

FN 2431Topo

EXPLANATION



1/2-mile radius circle



APPROXIMATE SCALE

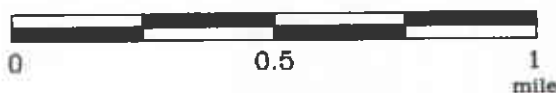

SOURCE:
Modified from a map
provided by
DeLorme 3-D TopoQuads



SITE VICINITY MAP

FORMER EXXON SERVICE STATION 7-3567
3192 Santa Rita Road
Pleasanton, California

PROJECT NO.

2431

PLATE

1

APPROXIMATE SCALE



LAS POSITAS BOULEVARD



SANTA RITA ROAD

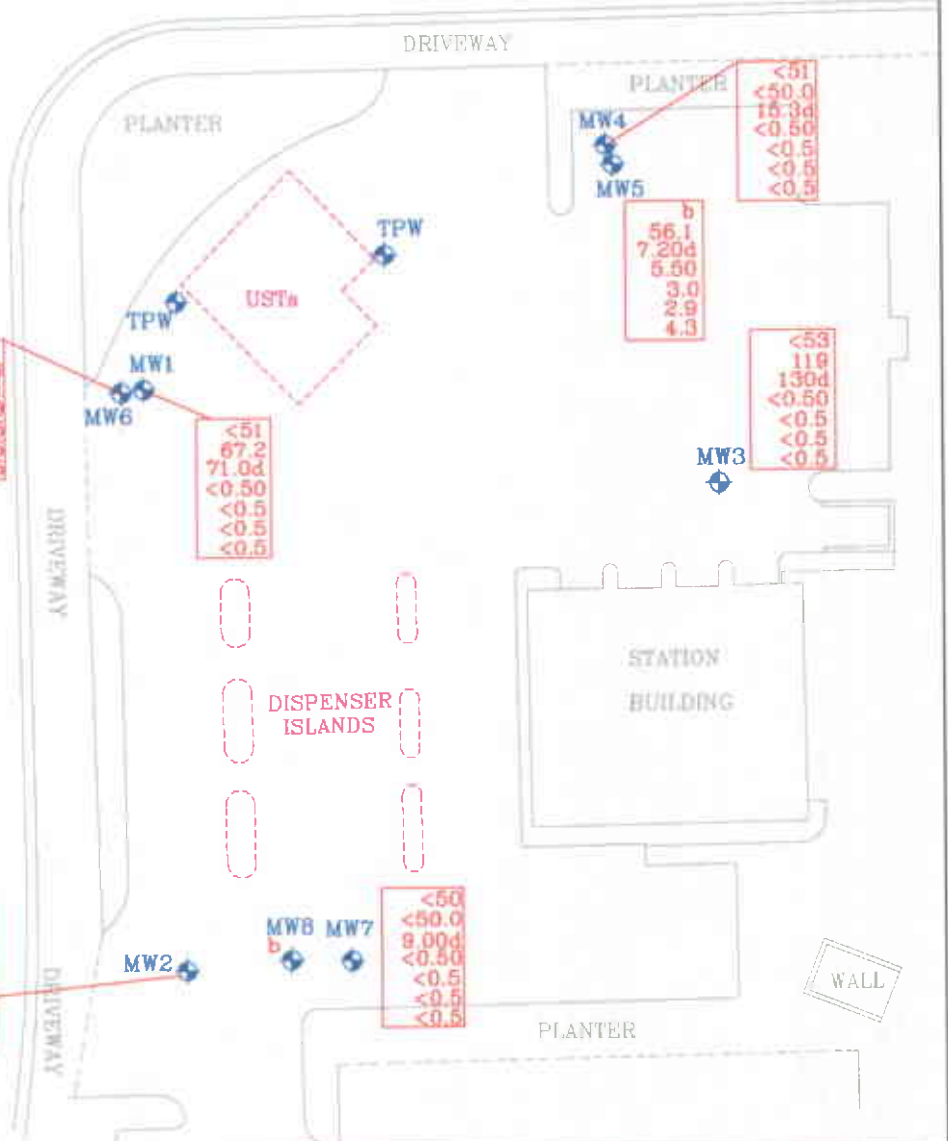

SOURCE:
Modified from a map
provided by
Morrow Surveying

FN 24310003

EXPLANATION

Groundwater Monitoring Well

Tank Pit Well

Analyte Concentrations in ug/L
Sampled April 10, 2003

- 60 Total Petroleum Hydrocarbons as Diesel
- <50.0 Total Petroleum Hydrocarbons as Gasoline
- 9.00d Methyl Tertiary Butyl Ether
- <0.50 Benzene
- <0.5 Toluene
- <0.5 Ethylbenzene
- <0.5 Total Xylenes
- < Less Than the Stated Laboratory Reporting Limit

d MTBE confirmed using EPA Method 8260.

ug/L Micrograms per Liter
b Well contained an insufficient amount of
of water to collect a sample or well was dry.



GENERALIZED SITE PLAN

FORMER EXXON SERVICE STATION 7-3567
3192 Santa Rita Road
Pleasanton, California

PROJECT NO.

2431

PLATE

2

APPROXIMATE SCALE



LAS POSITAS BOULEVARD



SANTA RITA ROAD

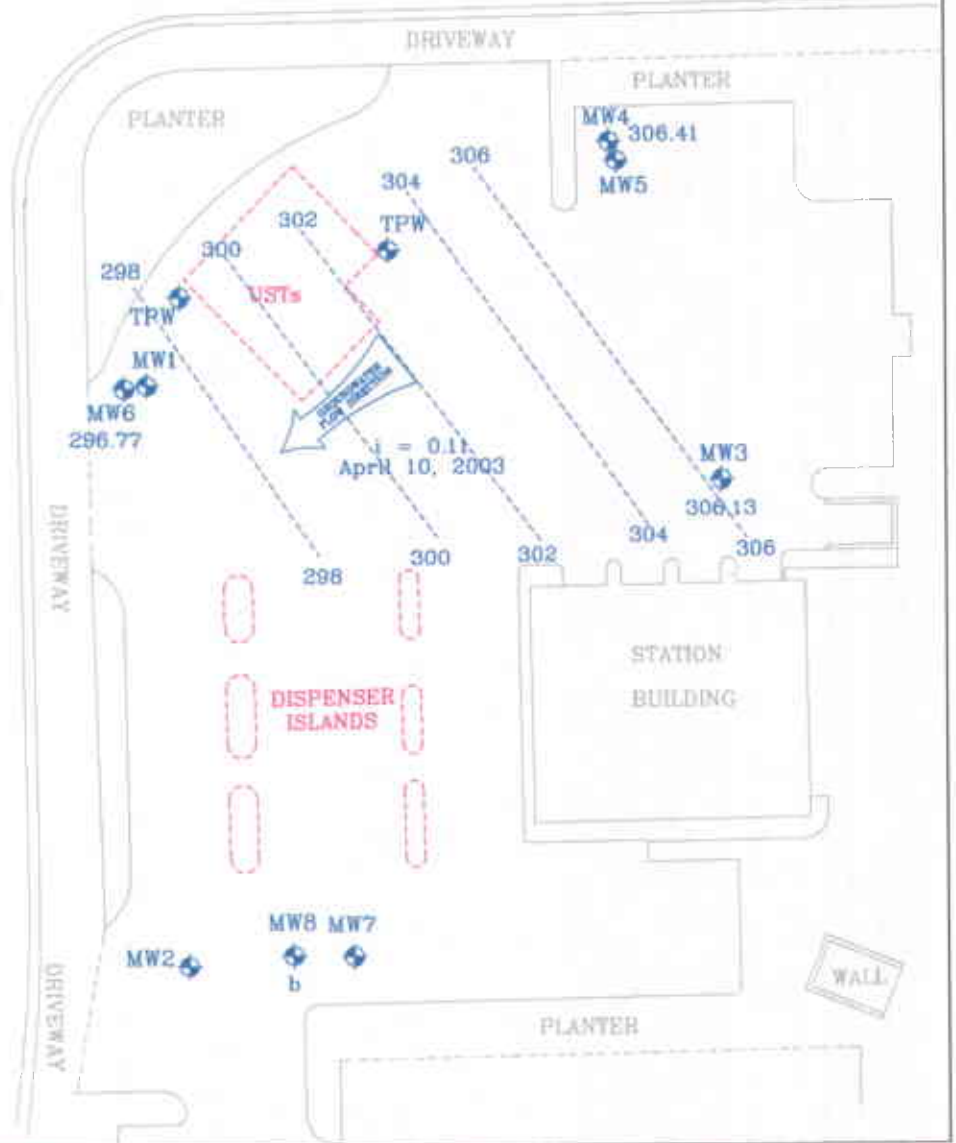

SOURCE:
Modified from a map
provided by
Morrow Surveying

FN 24310003

EXPLANATION

- MW6 Groundwater Monitoring Well
- 296.24 Groundwater elevation in feet; datum is mean sea level
- TPW Tank Pit Well
- b Well contained an insufficient amount of water to collect a sample or well was dry
- i = Interpreted Hydraulic Gradient



**GROUNDWATER ELEVATION MAP
LOWER WATER-BEARING ZONE**
FORMER EXXON SERVICE STATION 7-3567
3192 Santa Rita Road
Pleasanton, California

PROJECT NO.
2431
PLATE
3

APPROXIMATE SCALE



LAS POSITAS BOULEVARD



SANTA RITA ROAD

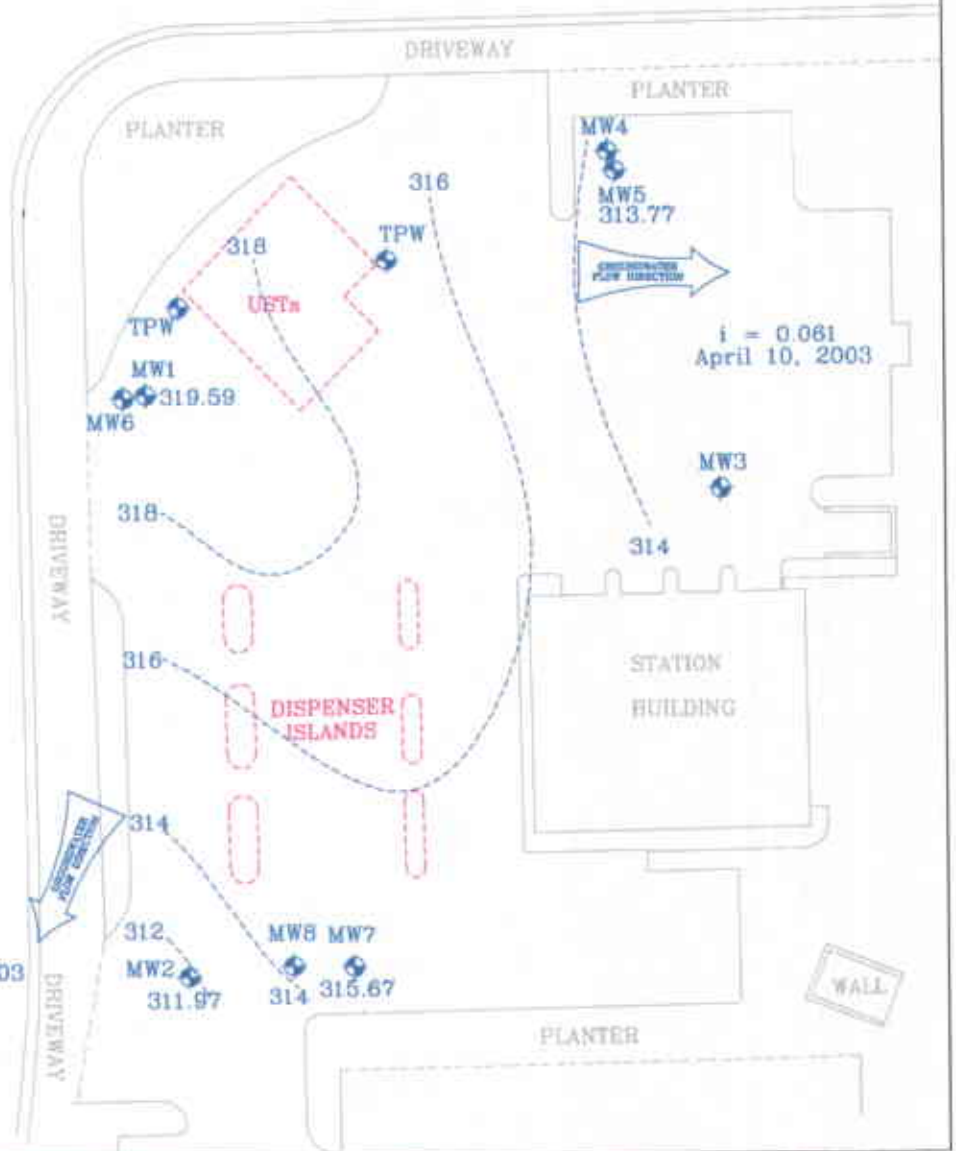

SOURCE:
Modified from a map
provided by
Morrow Surveying

FN 24310003

EXPLANATION

- MW7 Groundwater Monitoring Well
- 315.66 Groundwater elevation in feet; datum is mean sea level
- TPW Tank Pit Well



**GROUNDWATER ELEVATION MAP
UPPER WATER-BEARING ZONE**

FORMER EXXON SERVICE STATION 7-3567
3192 Santa Rita Road
Pleasanton, California

PROJECT NO.

2431

PLATE

4

ATTACHMENT A
GROUNDWATER SAMPLING PROTOCOL

GROUNDWATER SAMPLING PROTOCOL

The static water level and separate-phase product level, if present, in each well that contains water and/or separate-phase product are measured with an ORS Interface Probe, which is accurate to the nearest 0.01 foot. To calculate groundwater elevations and evaluate groundwater gradient, depth to water (DTW) levels are subtracted from top of casing elevations.

Groundwater samples collected for subjective evaluation are collected by gently lowering approximately half the length of a clean Teflon® or polypropylene bailer past the air-water interface (if possible) and collecting a sample from near the surface of the water in the well. The samples are checked for measurable free-phase hydrocarbons or sheen. If appropriate, free-phase hydrocarbons are removed from the well.

Before water samples are collected from the groundwater monitoring wells, the wells are purged until a minimum of three well casing volumes is purged and stabilization of the temperature, pH, and conductivity is obtained. Water samples from the wells that do not obtain stability of the temperature, pH, and conductivity are considered to be "grab samples". The quantity of water purged from each well is calculated as follows:

1 well casing volume = $\pi r^2 h(7.48)$ where:

r	=	radius of the well casing in feet.
h	=	column of water in the well in feet (depth to bottom - depth to water)
7.48	=	conversion constant from cubic feet to gallons
π	=	ratio of the circumference of a circle to its diameter

Gallons of water purged/gallons in 1 well casing volume = well casing volumes removed.

After purging, each well is allowed to recharge to at least 80% of the initial water level. Water samples from wells that do not recover at least 80% (due to slow recharging of the well) between purging and sampling are considered to be "grab samples". Water samples are collected with a new, disposable Teflon® or polypropylene bailer. The groundwater is carefully poured into selected sample containers (40-milliliter (ml) glass vials, 1,000 ml glass amber bottles, etc.), which are filled so as to produce a positive meniscus.

Depending on the required analysis, each sample container is preserved with hydrochloric acid, nitric acid, etc., or it is preservative free. The type of preservative used for each sample is specified on the chain of custody form.

Each vial and glass amber bottle is sealed with a cap containing a Teflon® septum, and subsequently examined for air bubbles to avoid headspace, which would allow volatilization to occur. The samples are promptly transported in iced storage in a thermally-insulated ice chest, accompanied by a Chain-of-Custody Record, to a California state-certified laboratory.

ATTACHMENT B
LABORATORY ANALYSIS REPORT
AND CHAIN-OF-CUSTODY RECORD

4/23/03

ERI - NORTHERN CA 3876
SCOTT GRAHAM
73 DIGITAL DRIVE, SUITE 100
NOVATO, CA 94949

RECEIVED
APR 24 2003

BY:.....

This report includes the analytical certificates of analysis for all samples listed below. These samples relate to your project identified below:

Project Name: EXXONMOBIL 7-3567
Project Number: 243113X.
Laboratory Project Number: 327899.

An executed copy of the chain of custody, the project quality control data, and the sample receipt form are also included as an addendum to this report. If you have any questions relating to this analytical report, please contact your Laboratory Project Manager at 1-800-765-0980.

Sample Identification	Lab Number	Collection Date
MW2	03-A57282	4/10/03
MW6	03-A57283	4/10/03
MW5	03-A57284	4/10/03
MW7	03-A57285	4/10/03
MW4	03-A57286	4/10/03
MW3	03-A57287	4/10/03
MW1	03-A57288	4/10/03

ANALYTICAL REPORT

ERI - NORTHERN CA 3876
SCOTT GRAHAM
73 DIGITAL DRIVE, SUITE 100
NOVATO, CA 94949

Lab Number: 03-A57282
Sample ID: MW2
Sample Type: Water
Site ID: 7-3567

Project: 243113X
Project Name: EXXONMOBIL 7-3567
Sampler: VICKI BURNS

Date Collected: 4/10/03
Time Collected: 16:39
Date Received: 4/15/03
Time Received: 8:10
Page: 1

Analyte	Result	Units	Report	Dil	Analysis		Analyst	Method	Batch
			Limit	Factor	Date	Time			
ORGANIC PARAMETERS									
Benzene	0.60	ug/L	0.50	1.0	4/22/03	10:36	I. Ahmed	8021B	5651
Ethylbenzene	0.8	ug/L	0.5	1.0	4/22/03	10:36	I. Ahmed	8021B	5651
Toluene	0.5	ug/L	0.5	1.0	4/22/03	10:36	I. Ahmed	8021B	5651
Xylenes (Total)	1.0	ug/L	0.5	1.0	4/22/03	10:36	I. Ahmed	8021B	5651
TPH (Gasoline Range)	ND	ug/L	50.0	1.0	4/22/03	10:36	I. Ahmed	8015B	5651
TPH (Diesel Range)	ND	ug/L	50.	1.0	4/19/03	20:24	M.Jarrett	8015B/3510	4415
VOLATILE ORGANICS									
Ethyl-t-butylether	ND	ug/L	0.50	1.0	4/16/03	20:49	C. Spry	8260B	2707
tert-amyl methyl ether	ND	ug/L	0.50	1.0	4/16/03	20:49	C. Spry	8260B	2707
Tertiary butyl alcohol	ND	ug/L	10.0	1.0	4/16/03	20:49	C. Spry	8260B	2707
1,2-Dibromoethane	ND	ug/L	0.50	1.0	4/16/03	20:49	C. Spry	8260B	2707
1,2-Dichloroethane	ND	ug/L	0.50	1.0	4/16/03	20:49	C. Spry	8260B	2707
Methyl-t-butyl ether	2.10	ug/L	0.50	1.0	4/16/03	20:49	C. Spry	8260B	2707
Diisopropyl ether	ND	ug/L	0.50	1.0	4/16/03	20:49	C. Spry	8260B	2707

Silica Gel Cleanup performed for TPH-DRO analysis.

Sample Extraction Data

Parameter	Wt/vol		Date	Time	Analyst	Method
	Extracted	Extract Vol				
EPH	1000 ml	1.00 ml	4/17/03		M. Cauthen	3510

Sample report continued . . .

ANALYTICAL REPORT

Laboratory Number: 03-A57282

Sample ID: MW2

Project: 243113X

Page 2

Surrogate	% Recovery	Target Range
-----	-----	-----
TPH Hi Surr., o-Terphenyl	108.	41. - 155.
BTEX/GRO Surr., a.a.a-TFT	75.	69. - 132.
VOA Surr 1,2-DCA-d4	106.	73. - 133.
VOA Surr Toluene-d8	92.	80. - 121.
VOA Surr, 4-BFB	96.	80. - 128.
VOA Surr, DBPM	105.	81. - 121.

LABORATORY COMMENTS:

ND = Not detected at the report limit.

B = Analyte was detected in the method blank.

J = Estimated Value below Report Limit.

E = Estimated Value above the calibration limit of the instrument.

= Recovery outside Laboratory historical or method prescribed limits.

End of Sample Report.

ANALYTICAL REPORT

ERI - NORTHERN CA 3876
 SCOTT GRAHAM
 73 DIGITAL DRIVE, SUITE 100
 NOVATO, CA 94949

Lab Number: 03-A57283
 Sample ID: MW6
 Sample Type: Water
 Site ID: 7-3567

Project: 243113X
 Project Name: EXXONMOBIL 7-3567
 Sampler: VICKI BURNS

Date Collected: 4/10/03
 Time Collected: 14:06
 Date Received: 4/15/03
 Time Received: 8:10
 Page: 1

Analyte	Result	Units	Report Limit	Dil Factor	Analysis		Analyst	Method	Batch
					Date	Time			
ORGANIC PARAMETERS									
Benzene	ND	ug/L	0.50	1.0	4/22/03	11:07	I. Ahmed	8021B	5651
Ethylbenzene	ND	ug/L	0.5	1.0	4/22/03	11:07	I. Ahmed	8021B	5651
Toluene	ND	ug/L	0.5	1.0	4/22/03	11:07	I. Ahmed	8021B	5651
Xylenes (Total)	ND	ug/L	0.5	1.0	4/22/03	11:07	I. Ahmed	8021B	5651
TPH (Gasoline Range)	ND	ug/L	50.0	1.0	4/22/03	11:07	I. Ahmed	8015B	5651
TPH (Diesel Range)	60.	ug/L	51.	1.0	4/19/03	20:43	M. Jarrett	8015B/3510	4415
VOLATILE ORGANICS									
Ethyl-t-butylether	ND	ug/L	0.50	1.0	4/16/03	21:21	C. Spry	8260B	2707
tert-amyl methyl ether	ND	ug/L	0.50	1.0	4/16/03	21:21	C. Spry	8260B	2707
Tertiary butyl alcohol	ND	ug/L	10.0	1.0	4/16/03	21:21	C. Spry	8260B	2707
1,2-Dibromoethane	ND	ug/L	0.50	1.0	4/16/03	21:21	C. Spry	8260B	2707
1,2-Dichloroethane	ND	ug/L	0.50	1.0	4/16/03	21:21	C. Spry	8260B	2707
Methyl-t-butyl ether	0.80	ug/L	0.50	1.0	4/16/03	21:21	C. Spry	8260B	2707
Diisopropyl ether	ND	ug/L	0.50	1.0	4/16/03	21:21	C. Spry	8260B	2707

Silica Gel Cleanup performed for TPH-DRO analysis.

Sample Extraction Data

Parameter	Wt/Vol		Date	Time	Analyst	Method
	Extracted	Extract Vol				
EPH	980. ml	1.00 ml	4/17/03		M. Cauthen	3510

Sample report continued . . .

ANALYTICAL REPORT

Laboratory Number: 03-A57283
Sample ID: MW6
Project: 243113X
Page 2

Surrogate	% Recovery	Target Range
-----	-----	-----
TPH Hi Surr., o-Terphenyl	92.	41. - 155.
BTEX/GRO Surr., a,a,a-TFT	75.	69. - 132.
VOA Surr 1,2-DCA-d4	106.	73. - 133.
VOA Surr Toluene-d8	109.	80. - 121.
VOA Surr, 4-BFB	95.	80. - 128.
VOA Surr, DBPM	104.	81. - 121.

LABORATORY COMMENTS:

- ND = Not detected at the report limit.
- B = Analyte was detected in the method blank.
- J = Estimated Value below Report Limit.
- E = Estimated Value above the calibration limit of the instrument.
- * = Recovery outside Laboratory historical or method prescribed limits.
- DRO contamination is not diesel fuel.

End of Sample Report.

ANALYTICAL REPORT

ERI - NORTHERN CA 3876
SCOTT GRAHAM
73 DIGITAL DRIVE, SUITE 100
NOVATO, CA 94949

Lab Number: 03-A57284
Sample ID: MW5
Sample Type: Water
Site ID: 7-3567

Project: 243113X
Project Name: EXXONMOBIL 7-3567
Sampler: VICKI BURNS

Date Collected: 4/10/03
Time Collected: 14:26
Date Received: 4/15/03
Time Received: 8:10
Page: 1

Analyte	Result	Units	Report Limit	Dil Factor	Analysis Date	Analysis Time	Analyst	Method	Batch
ORGANIC PARAMETERS									
Benzene	5.50	ug/L	0.50	1.0	4/23/03	10:09	D.Ramey	8021B	3611
Ethylbenzene	2.9	ug/L	0.5	1.0	4/23/03	10:09	D.Ramey	8021B	3611
Toluene	3.0	ug/L	0.5	1.0	4/23/03	10:09	D.Ramey	8021B	3611
Xylenes (Total)	4.3	ug/L	0.5	1.0	4/23/03	10:09	D.Ramey	8021B	3611
TPH (Gasoline Range)	56.1	ug/L	50.0	1.0	4/23/03	10:09	D.Ramey	8015B	3611
VOLATILE ORGANICS									
Ethyl-t-butylether	ND	ug/L	0.50	1.0	4/16/03	21:53	C. Spry	8260B	2707
tert-amyl methyl ether	ND	ug/L	0.50	1.0	4/16/03	21:53	C. Spry	8260B	2707
Tertiary butyl alcohol	ND	ug/L	10.0	1.0	4/16/03	21:53	C. Spry	8260B	2707
1,2-Dibromoethane	ND	ug/L	0.50	1.0	4/16/03	21:53	C. Spry	8260B	2707
1,2-Dichloroethane	ND	ug/L	0.50	1.0	4/16/03	21:53	C. Spry	8260B	2707
Methyl-t-butyl ether	7.20	ug/L	0.50	1.0	4/16/03	21:53	C. Spry	8260B	2707
Diisopropyl ether	ND	ug/L	0.50	1.0	4/16/03	21:53	C. Spry	8260B	2707

Surrogate	% Recovery	Target Range
BTEX/GRO Surr., a,a,a-TPT	100.	69. - 132.
VOA Surr 1,2-DCA-d4	104.	73. - 133.
VOA Surr Toluene-d8	110.	80. - 121.
VOA Surr, 4-BFB	94.	80. - 128.
VOA Surr, DBFM	100.	81. - 121.

Sample report continued . . .

ANALYTICAL REPORT

Laboratory Number: 03-A57284
Sample ID: MW5
Project: 243113X
Page 2

LABORATORY COMMENTS:

- ND = Not detected at the report limit.
- B = Analyte was detected in the method blank.
- J = Estimated Value below Report Limit.
- E = Estimated Value above the calibration limit of the instrument.
- # = Recovery outside Laboratory historical or method prescribed limits.

End of Sample Report.

ANALYTICAL REPORT

ERI - NORTHERN CA 3876
SCOTT GRAHAM
73 DIGITAL DRIVE, SUITE 100
NOVATO, CA 94949

Lab Number: 03-A57285
Sample ID: MW7
Sample Type: Water
Site ID: 7-3567

Project: 243113X
Project Name: EXXONMOBIL 7-3567
Sampler: VICKI BURNS

Date Collected: 4/10/03
Time Collected: 14:58
Date Received: 4/15/03
Time Received: 8:10
Page: 1

Analyte	Result	Units	Report	Dil	Analysis		Analyst	Method	Batch
			Limit		Factor	Date			
ORGANIC PARAMETERS									
Benzene	ND	ug/L	0.50	1.0	4/23/03	10:40	D.Ramey	8021B	3611
Ethylbenzene	ND	ug/L	0.5	1.0	4/23/03	10:40	D.Ramey	8021B	3611
Toluene	ND	ug/L	0.5	1.0	4/23/03	10:40	D.Ramey	8021B	3611
Xylenes (Total)	ND	ug/L	0.5	1.0	4/23/03	10:40	D.Ramey	8021B	3611
TPH (Gasoline Range)	ND	ug/L	50.0	1.0	4/23/03	10:40	D.Ramey	8015B	3611
TPH (Diesel Range)	ND	ug/L	50.	1.0	4/19/03	21:03	M.Jarrett	8015B/3510	4415
VOLATILE ORGANICS									
Ethyl-t-butylether	ND	ug/L	0.50	1.0	4/17/03	2:41	C. Spry	8260B	2707
tert-amyl methyl ether	ND	ug/L	0.50	1.0	4/17/03	2:41	C. Spry	8260B	2707
Tertiary butyl alcohol	ND	ug/L	10.0	1.0	4/17/03	2:41	C. Spry	8260B	2707
1,2-Dibromoethane	ND	ug/L	0.50	1.0	4/17/03	2:41	C. Spry	8260B	2707
1,2-Dichloroethane	ND	ug/L	0.50	1.0	4/17/03	2:41	C. Spry	8260B	2707
Methyl-t-butyl ether	9.00	ug/L	0.50	1.0	4/17/03	2:41	C. Spry	8260B	2707
Diisopropyl ether	ND	ug/L	0.50	1.0	4/17/03	2:41	C. Spry	8260B	2707

Silica Gel Cleanup performed for TPH-DRO analysis.

Sample Extraction Data

Parameter	Wt/Vol		Date	Time	Analyst	Method
	Extracted	Extract Vol				
EPH	995. ml	1.00 ml	4/17/03		M. Cauthen	3510

Sample report continued . . .

ANALYTICAL REPORT

Laboratory Number: 03-A57285
Sample ID: MW7
Project: 243113X
Page 2

Surrogate	% Recovery	Target Range
-----	-----	-----
TPH Hi Surr., o-Terphenyl	91.	41. - 155.
BTEX/GRO Surr., a,a,a-TFT	104.	69. - 132.
VOA Surr 1,2-DCA-d4	105.	73. - 133.
VOA Surr Toluene-d8	109.	80. - 121.
VOA Surr, 4-BFB	95.	80. - 128.
VOA Surr, DBPM	105.	81. - 121.

LABORATORY COMMENTS:

- ND = Not detected at the report limit.
- B = Analyte was detected in the method blank.
- J = Estimated Value below Report Limit.
- E = Estimated value above the calibration limit of the instrument.
- # = Recovery outside Laboratory historical or method prescribed limits.

End of Sample Report.

ANALYTICAL REPORT

ERI - NORTHERN CA 3876
 SCOTT GRAHAM
 73 DIGITAL DRIVE, SUITE 100
 NOVATO, CA 94949

Lab Number: 03-A57286
 Sample ID: MW4
 Sample Type: Water
 Site ID: 7-3567

Project: 243113X
 Project Name: EXXONMOBIL 7-3567
 Sampler: VICKI BURNS

Date Collected: 4/10/03
 Time Collected: 15:22
 Date Received: 4/15/03
 Time Received: 8:10
 Page: 1

Analyte	Result	Units	Report Limit	Dil Factor	Analysis Date	Analysis Time	Analyst	Method	Batch
ORGANIC PARAMETERS									
Benzene	ND	ug/L	0.50	1.0	4/23/03	11:11	D. Ramey	8021B	3611
Ethylbenzene	ND	ug/L	0.5	1.0	4/23/03	11:11	D. Ramey	8021B	3611
Toluene	ND	ug/L	0.5	1.0	4/23/03	11:11	D. Ramey	8021B	3611
Xylenes (Total)	ND	ug/L	0.5	1.0	4/23/03	11:11	D. Ramey	8021B	3611
TPH (Gasoline Range)	ND	ug/L	50.0	1.0	4/23/03	11:11	D. Ramey	8015B	3611
TPH (Diesel Range)	ND	ug/L	51.	1.0	4/19/03	21:23	M. Jarrett	8015B/3510	4415
VOLATILE ORGANICS									
Ethyl-t-butylether	ND	ug/L	0.50	1.0	4/17/03	3:13	C. Spry	8260B	2707
tert-amyl methyl ether	ND	ug/L	0.50	1.0	4/17/03	3:13	C. Spry	8260B	2707
Tertiary butyl alcohol	ND	ug/L	10.0	1.0	4/17/03	3:13	C. Spry	8260B	2707
1,2-Dibromoethane	ND	ug/L	0.50	1.0	4/17/03	3:13	C. Spry	8260B	2707
1,2-Dichloroethane	ND	ug/L	0.50	1.0	4/17/03	3:13	C. Spry	8260B	2707
Methyl-t-butyl ether	15.3	ug/L	0.50	1.0	4/17/03	3:13	C. Spry	8260B	2707
Diisopropyl ether	ND	ug/L	0.50	1.0	4/17/03	3:13	C. Spry	8260B	2707

Silica Gel Cleanup performed for TPH-DRO analysis.

Sample Extraction Data

Parameter	Wt/Vol		Date	Time	Analyst	Method
	Extracted	Extract Vol				
EPH	975. ml	1.00 ml	4/17/03		M. Cauthen	3510

Sample report continued . . .

ANALYTICAL REPORT

Laboratory Number: 03-A57286
Sample ID: MW4
Project: 243113X
Page 2

Surrogate	% Recovery	Target Range
-----	-----	-----
TPH Hi Surr., o-Terphenyl	92.	41. - 155.
BTEX/GRO Surr., a,a,a-TPT	102.	69. - 132.
VOA Surr 1,2-DCA-d4	104.	73. - 133.
VOA Surr Toluene-d8	109.	80. - 121.
VOA Surr, 4-BFB	95.	80. - 128.
VOA Surr, DBPM	102.	81. - 121.

LABORATORY COMMENTS:

- ND = Not detected at the report limit.
- B = Analyte was detected in the method blank.
- J = Estimated Value below Report Limit.
- E = Estimated Value above the calibration limit of the instrument.
- # = Recovery outside Laboratory historical or method prescribed limits.

End of Sample Report.

ANALYTICAL REPORT

ERI - NORTHERN CA 3876
SCOTT GRAHAM
73 DIGITAL DRIVE, SUITE 100
NOVATO, CA 94949

Lab Number: 03-A57287
Sample ID: MW3
Sample Type: Water
Site ID: 7-3567

Project: 243113X
Project Name: EXXONMOBIL 7-3567
Sampler: VICKI BURNS

Date Collected: 4/10/03
Time Collected: 16:12
Date Received: 4/15/03
Time Received: 8:10
Page: 1

Analyte	Result	Units	Report Limit	Dil Factor	Analysis Date	Analysis Time	Analyst	Method	Batch
ORGANIC PARAMETERS									
Benzene	ND	ug/L	0.50	1.0	4/23/03	11:42	D.Ramey	8021B	3611
Ethylbenzene	ND	ug/L	0.5	1.0	4/23/03	11:42	D.Ramey	8021B	3611
Toluene	ND	ug/L	0.5	1.0	4/23/03	11:42	D.Ramey	8021B	3611
Xylenes (Total)	ND	ug/L	0.5	1.0	4/23/03	11:42	D.Ramey	8021B	3611
TPH (Gasoline Range)	119.	ug/L	50.0	1.0	4/23/03	11:42	D.Ramey	8015B	3611
TPH (Diesel Range)	ND	ug/L	53.	1.0	4/19/03	21:43	M.Jarrett	8015B/3510	4415
VOLATILE ORGANICS									
Ethyl-t-butylether	ND	ug/L	0.50	1.0	4/17/03	3:45	C. Spry	8260B	2707
tert-amyl methyl ether	ND	ug/L	0.50	1.0	4/17/03	3:45	C. Spry	8260B	2707
Tertiary butyl alcohol	ND	ug/L	10.0	1.0	4/17/03	3:45	C. Spry	8260B	2707
1,2-Dibromoethane	ND	ug/L	0.50	1.0	4/17/03	3:45	C. Spry	8260B	2707
1,2-Dichloroethane	ND	ug/L	0.50	1.0	4/17/03	3:45	C. Spry	8260B	2707
Methyl-t-butyl ether	130.	ug/L	0.50	1.0	4/17/03	3:45	C. Spry	8260B	2707
Diisopropyl ether	ND	ug/L	0.50	1.0	4/17/03	3:45	C. Spry	8260B	2707

Silica Gel Cleanup performed for TPH-DRO analysis.

Sample Extraction Data

Parameter	Wt/Vol		Date	Time	Analyst	Method
	Extracted	Extract Vol				
EPH	950. ml	1.00 ml	4/17/03		M. Cauthen	3510

Sample report continued . . .

ANALYTICAL REPORT

Laboratory Number: 03-A57287
Sample ID: MW3
Project: 243113X
Page 2

Surrogate	† Recovery	Target Range
-----	-----	-----
TPH RI Surr., o-Terphenyl	119.	41. - 155.
BTEX/GRO Surr., m,m,m-TFT	102.	69. - 132.
VOA Surr 1,2-DCA-d4	104.	73. - 133.
VOA Surr Toluene-d8	107.	80. - 121.
VOA Surr, 4-BFE	94.	80. - 128.
VOA Surr, DBFM	102.	81. - 121.

LABORATORY COMMENTS:

- ND = Not detected at the report limit.
- B = Analyte was detected in the method blank.
- J = Estimated Value below Report Limit.
- E = Estimated Value above the calibration limit of the instrument.
- # = Recovery outside Laboratory historical or method prescribed limits.

End of Sample Report.

ANALYTICAL REPORT

ERI - NORTHERN CA 3876
SCOTT GRAHAM
73 DIGITAL DRIVE, SUITE 100
NOVATO, CA 94949

Lab Number: 03-A57288
Sample ID: MW1
Sample Type: Water
Site ID: 7-3567

Project: 243113X
Project Name: EXXONMOBIL 7-3567
Sampler: VICKI BURNS

Date Collected: 4/10/03
Time Collected: 15:51
Date Received: 4/15/03
Time Received: 8:10
Page: 1

Analyte	Result	Units	Report Limit	Dil Factor	Analysis Date	Analysis Time	Analyst	Method	Batch
ORGANIC PARAMETERS									
Benzene	ND	ug/L	0.50	1.0	4/23/03	12:13	D.Ramey	8021B	3611
Ethylbenzene	ND	ug/L	0.5	1.0	4/23/03	12:13	D.Ramey	8021B	3611
Toluene	ND	ug/L	0.5	1.0	4/23/03	12:13	D.Ramey	8021B	3611
Xylenes (Total)	ND	ug/L	0.5	1.0	4/23/03	12:13	D.Ramey	8021B	3611
TPH (Gasoline Range)	67.2	ug/L	50.0	1.0	4/23/03	12:13	D.Ramey	8015B	3611
TPH (Diesel Range)	ND	ug/L	51.	1.0	4/19/03	22:02	M.Jarrett	8015B/3510	4415
VOLATILE ORGANICS									
Ethyl-t-butylether	ND	ug/L	0.50	1.0	4/17/03	4:17	C. Spry	8260B	2707
tert-amyl methyl ether	ND	ug/L	0.50	1.0	4/17/03	4:17	C. Spry	8260B	2707
Tertiary butyl alcohol	ND	ug/L	10.0	1.0	4/17/03	4:17	C. Spry	8260B	2707
1,2-Dibromoethane	ND	ug/L	0.50	1.0	4/17/03	4:17	C. Spry	8260B	2707
1,2-Dichloroethane	ND	ug/L	0.50	1.0	4/17/03	4:17	C. Spry	8260B	2707
Methyl-t-butyl ether	71.0	ug/L	0.50	1.0	4/17/03	4:17	C. Spry	8260B	2707
Diisopropyl ether	ND	ug/L	0.50	1.0	4/17/03	4:17	C. Spry	8260B	2707

Silica Gel Cleanup performed for TPH-DRO analysis.

Sample Extraction Data

Parameter	Wt/Vol		Date	Time	Analyst	Method
	Extracted	Extract Vol				
EPH	990. ml	1.00 ml	4/17/03		M. Cauthen	3510

Sample report continued . . .

ANALYTICAL REPORT

Laboratory Number: 03-A57288
Sample ID: MW1
Project: 243113X
Page 2

Surrogate	% Recovery	Target Range
-----	-----	-----
TPH Hi Surr., o-Terphenyl	114.	41. - 155.
BTEX/GRO Surr., a,a,a-TFT	103.	69. - 132.
VOA Surr 1,2-DCA-d4	104.	73. - 133.
VOA Surr Toluene-d8	106.	80. - 121.
VOA Surr, 4-BFB	95.	80. - 128.
VOA Surr, DBPM	103.	81. - 121.

LABORATORY COMMENTS:

- ND = Not detected at the report limit.
- B = Analyte was detected in the method blank.
- J = Estimated Value below Report Limit.
- E = Estimated Value above the calibration limit of the instrument.
- # = Recovery outside Laboratory historical or method prescribed limits.

End of Sample Report.

PROJECT QUALITY CONTROL DATA
Project Number: 243113X
Project Name: EXXONMOBIL 7-3567
Page: 1
Laboratory Receipt Date: 4/16/03

Matrix Spike Recovery

Note: If Blank is referenced as the sample spiked, insufficient volume was received for the defined analytical batch for MS/MSD analysis on an true sample matrix. Laboratory reagent water was used for QC purposes.

Analyte	units	Orig. Val.	MS Val	Spike Conc	Recovery	Target Range	Q.C. Batch	Spike Sample
UST ANALYSIS								
Benzene	mg/l	0.00550	0.0616	0.0500	112	74. - 129.	3611	03-A57284
Benzene	mg/l	< 0.00050	0.0569	0.0500	114	74. - 129.	5651	blank
Toluene	mg/l	0.0030	0.0568	0.0500	108	74. - 128.	3611	03-A57284
Toluene	mg/l	< 0.0005	0.0523	0.0500	105	74. - 128.	5651	blank
Ethylbenzene	mg/l	0.0029	0.0555	0.0500	105	75. - 128.	3611	03-A57284
Ethylbenzene	mg/l	< 0.0005	0.0524	0.0500	105	75. - 128.	5651	blank
Xylenes (Total)	mg/l	0.0043	0.111	0.100	107	72. - 126.	3611	03-A57284
Xylenes (Total)	mg/l	< 0.0005	0.0981	0.100	98	72. - 126.	5651	blank
TPH (Gasoline Range)	mg/l	0.0561	0.972	1.00	92	59. - 128.	3611	03-A57284
TPH (Gasoline Range)	mg/l	< 0.0500	0.967	1.00	97	59. - 128.	5651	blank
TPH (Diesel Range)	mg/l	< 0.050	0.512	1.00	51	23. - 120.	4415	BLANK
BTEX/GRO Surr., a,a,a-TFT	† Recovery				100	69 - 132	3611	
BTEX/GRO Surr., a,a,a-TFT	† Recovery				88	69 - 132	5651	
VOA Surr 1,2-DCA-d4	† Rec				99	73. - 133.	2707	
VOA Surr Toluene-d8	† Rec				110	80. - 121.	2707	
VOA Surr, 4-BFB	† Rec				103	80. - 128.	2707	
VOA Surr, DBFM	† Rec				101	81. - 121.	2707	

Matrix Spike Duplicate

Analyte	units	Orig. Val.	Duplicate	RPD	Limit	Q.C. Batch
UST PARAMETERS						
Benzene	mg/l	0.0616	0.0632	2.56	15.	3611
Benzene	mg/l	0.0569	0.0586	2.94	15.	5651
Toluene	mg/l	0.0568	0.0586	3.12	15.	3611
Toluene	mg/l	0.0523	0.0530	1.33	15.	5651

Project QC continued . . .

PROJECT QUALITY CONTROL DATA
Project Number: 243113X
Project Name: EXXONMOBIL 7-3567
Page: 2
Laboratory Receipt Date: 4/16/03

Matrix Spike Duplicate

Analyte	units	Orig. Val.	Duplicate	RPD	Limit	Q.C. Batch
Ethylbenzene	mg/l	0.0555	0.0571	2.84	15.	3611
Ethylbenzene	mg/l	0.0524	0.0532	1.52	15.	5651
Xylenes (Total)	mg/l	0.111	0.115	3.54	19.	3611
Xylenes (Total)	mg/l	0.0981	0.0979	0.20	19.	5651
TPH (Gasoline Range)	mg/l	0.972	0.893	8.47	22.	3611
TPH (Gasoline Range)	mg/l	0.967	0.931	3.79	22.	5651
TPH (Diesel Range)	mg/l	0.512	0.593	14.66	20.	4415
BTEX/GRO Surr., a,a,a-TFT	‡ Recovery		100.			3611
BTEX/GRO Surr., a,a,a-TFT	‡ Recovery		91.			5651
VOA Surr 1,2-DCA-d4	‡ Rec		102.			2707
VOA Surr Toluene-d8	‡ Rec		111.			2707
VOA Surr, 4-BFB	‡ Rec		101.			2707
VOA Surr, DBFM	‡ Rec		105.			2707

Laboratory Control Data

Analyte	units	Known Val.	Analyzed Val	‡ Recovery	Target Range	Q.C. Batch
UST PARAMETERS						
Benzene	mg/l	0.100	0.105	105	74 - 124	3611
Benzene	mg/l	0.100	0.112	112	74 - 124	5651
Toluene	mg/l	0.100	0.0996	100	74 - 121	3611
Toluene	mg/l	0.100	0.0971	97	74 - 121	5651
Ethylbenzene	mg/l	0.100	0.0981	98	75 - 123	3611
Ethylbenzene	mg/l	0.100	0.0963	96	75 - 123	5651
Xylenes (Total)	mg/l	0.200	0.199	100	72 - 120	3611
Xylenes (Total)	mg/l	0.200	0.188	94	72 - 120	5651
TPH (Gasoline Range)	mg/l	1.00	0.972	97	61 - 139	3611
TPH (Gasoline Range)	mg/l	1.00	0.967	97	61 - 139	5651
TPH (Diesel Range)	mg/l	1.00	0.958	96	42 - 115	4415

Project QC continued . . .

PROJECT QUALITY CONTROL DATA

Project Number: 243113X

Project Name: EXXONMOBIL 7-3567

Page: 3

Laboratory Receipt Date: 4/16/03

BTEX/GRO Surr., a,a,a-TPT	% Recovery	99	69 - 132	3611
BTEX/GRO Surr., a,a,a-TPT	% Recovery	93	69 - 132	5651

Laboratory Control Data

Analyte	units	Known Val.	Analyzed Val	% Recovery	Target Range	Q.C. Batch
VOA PARAMETERS						
Ethyl-t-butylether	mg/l	0.0500	0.0456	91	69 - 142	2707
Ethyl-t-butylether	mg/l	0.0500	0.0470	94	69 - 142	2707
tert-amyl methyl ether	mg/L	0.0500	0.0430	86	70 - 141	2707
tert-amyl methyl ether	mg/L	0.0500	0.0451	90	70 - 141	2707
Tertiary butyl alcohol	mg/l	0.500	0.365	73	35 - 157	2707
Tertiary butyl alcohol	mg/l	0.500	0.407	81	35 - 157	2707
1,2-Dibromoethane	mg/l	0.0500	0.0522	104	79 - 126	2707
1,2-Dibromoethane	mg/l	0.0500	0.0534	107	79 - 126	2707
1,2-Dichloroethane	mg/l	0.0500	0.0477	95	71 - 135	2707
1,2-Dichloroethane	mg/l	0.0500	0.0501	100	71 - 135	2707
Methyl-t-butyl ether	mg/l	0.0500	0.0429	86	66 - 137	2707
Methyl-t-butyl ether	mg/l	0.0500	0.0451	90	66 - 137	2707
Diisopropyl ether	mg/l	0.0500	0.0490	98	70 - 134	2707
Diisopropyl ether	mg/l	0.0500	0.0484	97	70 - 134	2707
VOA Surr 1,2-DCA-d4	% Rec			95	73 - 133	2707
VOA Surr 1,2-DCA-d4	% Rec			102	73 - 133	2707
VOA Surr Toluene-d8	% Rec			110	80 - 121	2707
VOA Surr Toluene-d8	% Rec			111	80 - 121	2707
VOA Surr, 4-BFB	% Rec			99	80 - 128	2707
VOA Surr, 4-BFB	% Rec			101	80 - 128	2707
VOA Surr, DBPM	% Rec			99	81 - 121	2707
VOA Surr, DBPM	% Rec			102	81 - 121	2707

Project QC continued . . .

PROJECT QUALITY CONTROL DATA
Project Number: 243113X
Project Name: EXXONMOBIL 7-3567
Page: 4
Laboratory Receipt Date: 4/16/03

Blank Data

Analyte	Blank Value	Units	Q.C. Batch	Date Analyzed	Time Analyzed
UST PARAMETERS					
Benzene	< 0.00050	mg/l	5651	4/22/03	10:05
Benzene	< 0.00050	mg/l	3611	4/23/03	9:38
Toluene	< 0.0005	mg/l	5651	4/22/03	10:05
Toluene	< 0.0005	mg/l	3611	4/23/03	9:38
Ethylbenzene	< 0.0005	mg/l	5651	4/22/03	10:05
Ethylbenzene	< 0.0005	mg/l	3611	4/23/03	9:38
Xylenes (Total)	< 0.0005	mg/l	5651	4/22/03	10:05
Xylenes (Total)	< 0.0005	mg/l	3611	4/23/03	9:38
TPH (Gasoline Range)	< 0.0500	mg/l	5651	4/22/03	10:05
TPH (Gasoline Range)	< 0.0500	mg/l	3611	4/23/03	9:38
TPH (Diesel Range)	< 0.050	mg/l	4415	4/19/03	19:05

Blank Data

Analyte	Blank Value	Units	Q.C. Batch	Date Analyzed	Time Analyzed
UST PARAMETERS					
BTEX/GRO Surr., a,a,a-TFT	80.	% Recovery	5651	4/22/03	10:05
BTEX/GRO Surr., a,a,a-TFT	105.	% Recovery	3611	4/23/03	9:38

Blank Data

Analyte	Blank Value	Units	Q.C. Batch	Date Analyzed	Time Analyzed
VOA PARAMETERS					
Ethyl-t-butylether	< 0.00010	mg/l	2707	4/16/03	12:52
Ethyl-t-butylether	< 0.00010	mg/l	2707	4/17/03	2:09

Project QC continued . . .

PROJECT QUALITY CONTROL DATA
Project Number: 243113X
Project Name: EXXONMOBIL 7-3567
Page: 5
Laboratory Receipt Date: 4/16/03

Blank Data

Analyte	Blank Value	Units	Q.C. Batch	Analysis Date	Analysis Time
tert-amyl methyl ether	< 0.00019	mg/L	2707	4/16/03	12:52
tert-amyl methyl ether	< 0.00019	mg/L	2707	4/17/03	2:09
Tertiary butyl alcohol	< 0.00257	mg/l	2707	4/16/03	12:52
Tertiary butyl alcohol	< 0.00257	mg/l	2707	4/17/03	2:09
1,2-Dibromoethane	< 0.00018	mg/l	2707	4/16/03	12:52
1,2-Dibromoethane	< 0.00018	mg/l	2707	4/17/03	2:09
1,2-Dichloroethane	< 0.00021	mg/l	2707	4/16/03	12:52
1,2-Dichloroethane	< 0.00021	mg/l	2707	4/17/03	2:09
Methyl-t-butyl ether	< 0.00014	mg/l	2707	4/16/03	12:52
Methyl-t-butyl ether	< 0.00014	mg/l	2707	4/17/03	2:09
Diisopropyl ether	< 0.00003	mg/l	2707	4/16/03	12:52
Diisopropyl ether	< 0.00003	mg/l	2707	4/17/03	2:09
VOA Surr 1,2-DCA-d4	102.	‡ Rec	2707	4/16/03	12:52
VOA Surr 1,2-DCA-d4	102.	‡ Rec	2707	4/17/03	2:09
VOA Surr Toluene-d8	108.	‡ Rec	2707	4/16/03	12:52
VOA Surr Toluene-d8	110.	‡ Rec	2707	4/17/03	2:09
VOA Surr, 4-BFB	96.	‡ Rec	2707	4/16/03	12:52
VOA Surr, 4-BFB	95.	‡ Rec	2707	4/17/03	2:09
VOA Surr, DBFM	104.	‡ Rec	2707	4/16/03	12:52
VOA Surr, DBFM	102.	‡ Rec	2707	4/17/03	2:09

‡ = Value outside Laboratory historical or method prescribed QC limits.

End of Report for Project 327899

**TEST AMERICA ANALYTICAL
TESTING CORP.-NASHVILLE**

COOLER RECEIPT FORM

BC#

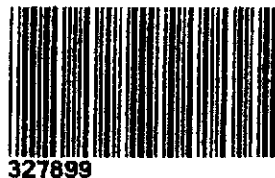

Client: ERI

Cooler Received On: 4/15/03 And Opened On: 4/15/03 By: Mike McBride

Mike McBride
(Signature)

1. Temperature of Cooler when opened 2° **Degrees Celsius**
2. Were custody seals on outside of cooler?..... YES...NO...NA
 - a. If yes, how many, what kind and where: 0/1
3. Were custody seals on containers and intact?..... NO...YES...NA
4. Were the seals intact, signed, and dated correctly?..... YES...NO...NA
5. Were custody papers inside cooler?..... YES...NO...NA
6. Were custody papers properly filled out (ink,signed,etc)?..... YES...NO...NA
7. Did you sign the custody papers in the appropriate place?..... YES...NO...NA
8. What kind of packing material used? Bubblewrap Peanuts Vermiculite Other None
9. Was sufficient ice used (if appropriate)?..... YES...NO...NA
10. Did all bottles arrive in good condition(unbroken)?..... YES...NO...NA
11. Were all bottle labels complete (#,date,signed,pres,etc)?..... YES...NO...NA
12. Did all bottle labels and tags agree with custody papers?..... YES...NO...NA
13. Were correct bottles used for the analysis requested?..... YES...NO...NA
14. a. Were VOA vials received?..... YES...NO...NA
 - b. Was there any observable head space present in any VOA vial?..... NO...YES...NA
15. Was sufficient amount of sample sent in each bottle?..... YES...NO...NA
16. Were correct preservatives used?..... YES...NO...NA
If not, record standard ID of preservative used here _____
17. Was residual chlorine present?.....NO...YES... NA
18. See attached for resolution of non-conformance:

<input checked="" type="radio"/> Fed-Ex	<input type="radio"/> UPS	<input type="radio"/> Velocity	<input type="radio"/> Airborne	<input type="radio"/> Route	<input type="radio"/> Off-street	<input type="radio"/> Misc.
Cooler Receipt Form			LF-1			3/6/03



(615) 726-0177
Nashville Division
2960 Foster Creighton
Nashville, TN 37204



Consultant Name: Environmental Resolutions, Inc.

Address: 73 Digital Drive, Suite 100

City/State/Zip: Novato, California 94949

Project Manager: Scott Graham

Telephone Number: (415) 382-5989

ERI Job Number: 243113X

Sampler Name: (Print) Vicki Burns

Sampler Signature: Vicki Burns

ExxonMobil Engineer Gene N. Ortega

Telephone Number (925) 246-8747

Account #: 3876

PO #: _____

Facility ID # 7-3567

Global ID# T0600191822

Site Address 3192 Santa Rita Road

City, State Zip Pleasanton, California, 94566

TAT
 24 hour 72 hour
 48 hour 96 hour
 8 day

PROVIDE:
 EDF Report
 FAX Results

Special Instructions:
 Please use Silica gel clean-up on the TPHd samples.
 Oxygenates (MTBE, TAME, ETBE, DIPE & TBA) using 8260
 Lead Scavengers (1,2 DCA & EDB) using 8260.

Matrix: _____
 Analyze For:

Sample ID / Description	DATE	TIME	COMP	GRAB	PRESERV	NUMBER	Matrix			Analyze For:								
							Water	Soil	Vapor	TPHd 8015	TPHg 8015	BTEX 8021B	MTBE 8021B	confirm mtbe 8260	Oxygenates 8260	VOCs 8260	Total Lead 6010	HVOCs 801
03A 57282 MW2	4/10/2003	1639		X	HCL	6/2	X			X	X	X		X				X
83 MW6	4/10/2003	1406		X	HCL	6/2	X			X	X	X		X				X
84 MW5	4/10/2003	1426		X	HCL	6/0	X			X	X	X		X				X
85 MW7	4/10/2003	1458		X	HCL	6/2	X			X	X	X		X				X
86 MW4	4/10/2003	1522		X	HCL	6/2	X			X	X	X		X				X
87 MW3	4/10/2003	1612		X	HCL	6/2	X			X	X	X		X				X
57288 MW1	4/10/2003	1551		X	HCL	6/2	X			X	X	X		X				X
MW6 Delq Vb	4/10/2003			X	HCL	7/6	X			X	X	X		X				X
03A QCTB Vb	4/10/2003	-		X	HCL	3	X			H	O	L	D					

Relinquished by: [Signature] Date: 4/14/03 Time: 10:00
 Received by: [Signature] Date: 4/15/03 Time: 08:10

Relinquished by: _____ Date: _____ Time: _____
 Received by TestAmerica: _____ Date: _____ Time: _____

Laboratory Comments:
 Temperature Upon Receipt: 2.2
 Sample Containers Intact? yes
 VOAs Free of Headspace? yes