

RAYMOND F. GREENWOOD, P.E.
A California Corporation
CIVIL ENGINEER
19131 Redwood Road, Suite A * Castro Valley, CA 94546
Tel 510\581-2772 Fax 510\581-2772

August 6, 1993

Mr. Robert Blackman
Castro Valley Autohaus
20697 Park Way
Castro Valley, CA 94546

Subject: Monitoring Well Survey at 20697 Park Way, Castro Valley

Dear Mr. Blackman:

Our firm was previously engaged by you to perform a survey of the existing monitoring well located in the southeast portion of the subject property in accordance with the requirements of the Department of Environmental Health. Said survey was performed on October 4, 1991 (see copy attached).

Since we have no reason to suspect that the monitoring well rim elevation has significantly changed in the twenty-two months since the original survey was carried out, the elevation of the rim should continue to be taken as **160.50 M.S.L.** as established by the October 4, 1991 survey.

I hope that the foregoing provides you with the required information.

Very truly yours,

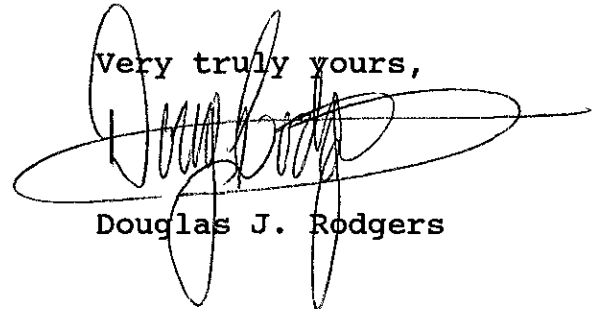
A handwritten signature in black ink, appearing to read 'Douglas J. Rodgers', is written over a horizontal line. The signature is stylized and somewhat cursive.

Douglas J. Rodgers

DJR/dr

93 AUG 11 PM 3:31

SCALE: 1" = 20'

SAN CARLOS AVENUE

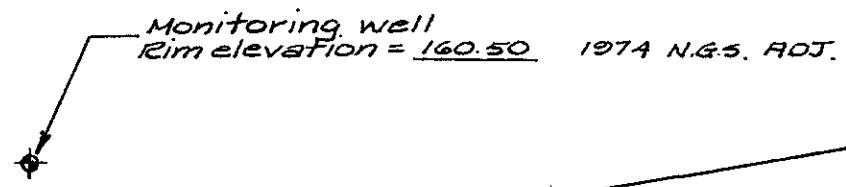
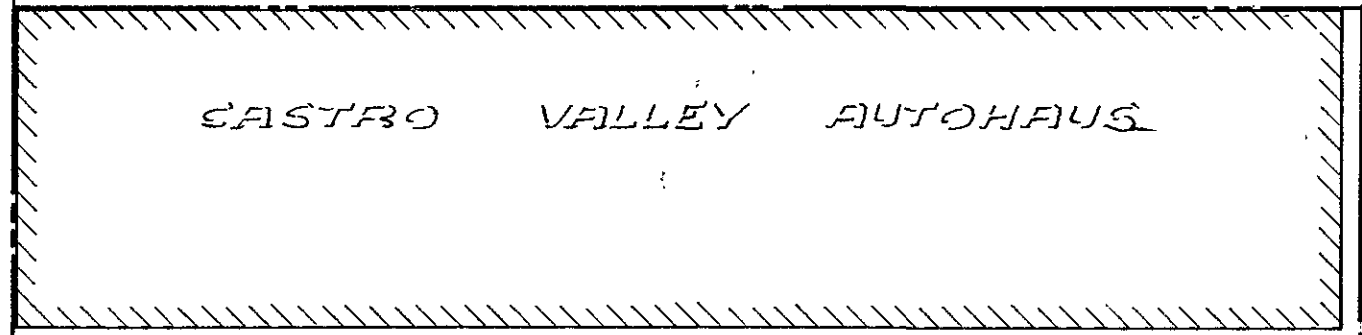

PARK

WAY

MONITORING WELL PLAT
FOR CASTRO VALLEY AUTOHAUS
20697 PARK WAY, CASTRO VALLEY, CA. 94546
Prepared by: Raymond F. Greenwood, Inc.
Civil Engineering and Land Surveying
19131 Redwood Road, Castro Valley, CA.