

GROUNDWATER TECHNOLOGY

547

Groundwater Technology, Inc.

4057 Port Chicago Highway, Concord, CA 94520
Tel: (510) 671-2387 Fax: (510) 685-9148

FAX TRANSMITTAL

DATE: 6/19/95

TIME:

TO: Mr. Barney Chan
@ Lounney Associates, 405 Clyde Ave. Mt. View

FROM: Bridget Baxter 1415 967-2365

FAX NUMBER: (510) 337-7335

NO. OF PAGES (including cover page): 10

If you do not receive any of the pages, please call (510) 671-2387, Concord Regional/District Office.

↳ EXTN: 244

To fax a reply, please send to (510) 685-9148.

MESSAGE

6/19/95 If you have any questions please call. Spoke w/B. Baxter + told her that all borings are OK (however, soil sample in all borings is not necessary especially # 7, 8 + 9. Also told her to let me know where MW's will be located prior to installation.

Additional 9 borings - July:

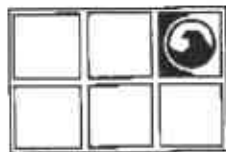

GROUNDWATER TECHNOLOGY

Groundwater Technology, Inc.

4057 Port Chicago Highway, Concord, CA 94520 USA
Tel: (510) 671-2387 Fax: (510) 685-9148

June 19, 1995

Mr. Barney Chan
Alameda County
Dept. of Environmental Health
Environmental Protection Division.
1131 Harbor Bay Parkway., #250
Alameda, Ca. 94502-6577

SUBJECT: GMC Truck Center
8099 S. Coliseum Way
Oakland, Ca. 94621

Dear Mr. Chan:

Enclosed are Tables 1 and 2 presenting a summary of the soil and groundwater analytical data for the work completed at the referenced property on March 23 and 24 1995. The soil and groundwater samples were submitted to a state certified analytical laboratory. We have proposed to drill nine additional soil borings at the site, with the collection and analysis of soil and groundwater samples, to further evaluate subsurface conditions. The proposed borehole location map is also attached for your reference.

Drilling activities have been scheduled for Friday June 23, 1995. You will be notified 48 hours prior to drilling activities. If you have any questions or comments, please contact either of the undersigned at (510) 671-2387.

Sincerely,
Groundwater Technology, Inc.
Submitted by:

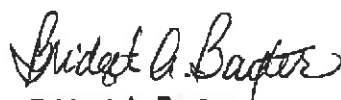
Bridget A. Baxter
Project Geologist

Christopher P. DeSocio
Project Manager

cc: GMC, Mr. Kleth West

TABLE 1
SOIL SAMPLE ANALYTICAL RESULTS
GENERAL MOTORS TRUCKING FACILITY
OAKLAND, CALIFORNIA

DRAFT

Sample I.D.- Depth	Date Collected	Benzene	Toluene	Ethly- Benzene	Xylenes	TPH-as- gasoline mg/kg	TPH-as- diesel fuel mg/kg	Hydrocar- bons (C) mg/kg
BH-1-6*	07/23/93	--	--	--	--	340	280	480
BH-1-10.5*	07/23/93	--	--	--	--	20	8	<50
BH-1-15.5*	07/23/93	--	--	--	--	0.5	10	140
BH-3-5.5*	07/23/93	--	--	--	--	6.3	44	180
BH-4-5.5*	07/23/93	--	--	--	--	51	17	70
BH-5-5.5*	07/23/93	--	--	--	--	0.5	700	820
BH-5-10.5*	07/23/93	--	--	--	--	<0.3	3	<50
B4D-7*	09/09/93	--	--	--	--	<0.3	27	--
B4D-5*	09/09/93	--	--	--	--	1.4(a)	1,700	<5
B8D-4.5*	09/09/93	--	--	--	--	<0.3	1,500	<5
B9D-5.5*	09/09/93	--	--	--	--	<0.3	900	--
B7D-5*	09/09/93	--	--	--	--	<0.3	1,900	--
B10D-10*	09/09/93	--	--	--	--	1.1(a,b)	7,000	--
B11-4.5D*	09/09/93	--	--	--	--	<0.3	3,800	--
BH4-B-5*	09/10/93	--	--	--	--	--	570	580
BH1-B-4.5*	09/10/93	--	--	--	--	--	6	<50
BH2-B-5*	09/10/93	--	--	--	--	--	490	540
BH3-B-5.5*	09/10/93	--	--	--	--	--	470	440

DRAFT

TABLE 1
SOIL SAMPLE ANALYTICAL RESULTS
GENERAL MOTORS TRUCKING FACILITY
OAKLAND, CALIFORNIA

Sample I.D.- Depth	Date Collected	Benzene	Toluene	Ethyl- Benzene	Xylenes	TPH-as- gasoline mg/kg	TPH-as- diesel fuel mg/kg	Hydrocar- bons (c) mg/kg
B2-D-2.5*	09/15/93	<0.005	<0.005	<0.005	<0.005	<0.3	320	-
B6-D-2*	09/15/93	<0.005	<0.005	0.005	<0.005	<30	400	-
B13-D-3.5*	09/15/93	<0.005	<0.005	<0.005	<0.005	<0.3	5,400	-
B12-D-4.5*	09/15/93	-	-	-	-	-	1,100	-
B12-D-7.0*	09/15/93	-	-	-	-	-	2,400	-
B14-D-10.0*	09/15/93	<0.005	<0.005	0.005	<0.005	0.9	1,000	-
B1-0-5.5*	09/15/93	-	-	-	-	-	92	230
B2-0-6.5*	09/15/93	-	-	-	-	-	1,400	1,400
B3-0-6.0*	09/15/93	-	-	-	-	-	1,200	1,100
B7-0-4.5*	09/15/93	-	-	-	-	-	350	3,900
B7-0-9.5*	09/15/93	-	-	-	-	-	5	<50
B9-0-6.5*	09/15/93	-	-	-	-	-	1,500	2,100
B10-0-4.5*	09/15/93	-	-	-	-	-	170	160
B11-0-4.5*	09/15/93	-	-	-	-	-	1,300	1,100
B11-0-6.5*	09/15/93	-	-	-	-	-	1,100	2,500
SB1-10**	03/23/95	<0.005	<0.005	<0.005	<0.015	<1.0	<10	<100
SB2-10**	03/23/95	<0.005	<0.005	<0.005	<0.015	<0.1	<10	<100
SB3-10**	03/23/95	<0.25	<0.25	5.4	87	3,500	<500	1,800(d)

06/19/95 09:24 9510 685 9148 GROUNDWATER TECH 004/010

DRAFT

TABLE 1
SOIL SAMPLE ANALYTICAL RESULTS
GENERAL MOTORS TRUCKING FACILITY
OAKLAND, CALIFORNIA

Sample I.D.- Depth	Date Collected	Benzene	Toluene	Ethyl- Benzene	Xylenes	TPH-as- gasoline mg/kg	TPH-as- diesel fuel mg/kg	Hydrocar- bons (c) mg/kg
SB4-10**	03/23/95	<0.005	<0.005	<0.005	<0.015	<1.0	<10	<100
SB5-10**	03/23/95	<0.005	<0.005	<0.005	<0.015	<1.0	<10	<100
SB6-10**	03/23/95	<0.005	<0.005	<0.005	<0.015	<1.0	<100	<1000
SB7-10**	03/23/95	<0.005	<0.005	<0.005	<0.015	<1.0	<10	<100
SB8-10**	03/23/95	<0.005	<0.005	<0.005	<0.015	<1.0	<100	<1000
SB9-10**	03/23/95	<0.005	<0.005	<0.005	<0.015	<1.0	<100	<1000
SB10-5**	03/24/95	<0.005	<0.005	<0.005	<0.015	<1.0	<100	<1000
SB11-10**	03/24/95	<0.005	<0.005	<0.005	<0.015	<1.0	<10	<100
SB12-10**	03/24/95	<0.005	<0.005	<0.005	<0.015	<1.0	<10	<100
SB13-10**	03/24/95	<0.005	<0.005	<0.005	<0.015	<1.0	<10	<100
SB14-10**	03/25/95	<0.005	<0.005	<0.005	<0.015	<1.0	<10	<100
SB15-5**	03/24/95	<0.005	<0.005	<0.005	<0.015	<1.0	<50	<500
SB16-5**	03/24/95	<0.005	<0.005	<0.005	<0.015	<1.0	<100	<1000
SB17-10**	03/24/95	<0.005	<0.005	<0.005	<0.015	<1.0	<50	<500

Note:
See laboratory reports for Environmental Protection Agency (EPA) analytical methods

TPH = Total Petroleum Hydrocarbons

* = Samples collected by Clayton Environmental Consultants.

DRAFT

TPH mo

TABLE 2
 WATER SAMPLE ANALYTICAL RESULTS
 GENERAL MOTORS TRUCKING FACILITY
 OAKLAND, CALIFORNIA

Sample I.D. Depth	Date Collected	Benzene	Toluene	Ethyl- Benzene	Xylenes	TPH-as- gasoline ug/l	TPH-as- diesel fuel ug/l	Hydrocar- bons (a) ug/l
SB5-WATER**	03/23/95	<0.3	<0.3	<0.3	<0.4	<50	500	<250
SB6-WATER**	03/24/95	1.3	<0.3	<0.3	<0.4	<50	<250	2,100
SB7-WATER **	03/23/95	<0.3	<0.3	<0.3	<0.4	<50	2,300	<250
SB8-WATER**	03/23/95	<0.3	<0.3	<0.3	<0.4	<50	<50	480
SB9-WATER **	03/23/95	<0.3	<0.3	<0.3	<0.4	<50	<1,000	7,600
SB10- WATER**	03/24/95	<0.3	<0.3	<0.3	<0.4	<50	<500	4,200
SB11- WATER**	03/24/95	<0.3	<0.3	<0.3	<0.4	<50	<250	2,000
SB12- WATER**	03/24/95	<0.3	<0.3	<0.3	<0.4	<50	<500	<2,500
SB13- WATER**	03/24/95	<0.3	<0.3	<0.3	<0.4	<50	<250	<1,250
SB14- WATER**	03/24/95	<0.3	<0.3	<0.3	<0.4	<50	<50	1,000
SB15- WATER**	03/24/95	<0.3	<0.3	<0.3	<0.4	<50	<50	720
SB16- WATER**	03/24/95	0.4	<0.3	<0.3	<0.4	<50	<50	1200
SB17- WATER**	03/24/95	<0.3	<0.3	<0.3	<0.4	<50	<250	<1,250

Note:

06/19/95 09:25 510 885 9148 GROUNDWATER TECH 006/010

DRAFT

TABLE 2
 WATER SAMPLE ANALYTICAL RESULTS
 GENERAL MOTORS TRUCKING FACILITY
 OAKLAND, CALIFORNIA

Sample I.D. Depth	Date Collected	Benzene	Toluene	Ethyl- Benzene	Xylenes	TPH-as- gasoline ug/l	TPH-as- diesel fuel ug/l	Hydrocar- bons (a) ug/l
BH-1*	07/23/93	--	--	--	--	780	1,300	--
BH-3*	07/23/93	--	--	--	--	--	47,000	--
1-WD (under fuel tank)	08/05/93	<0.4	0.4	<0.3	0.5	--	--	--
B4-O*	09/10/93	<0.4	<0.3	<0.3	<0.4	<50	5,600	18,000
B6-O*	09/10/93	<0.4	<0.3	<0.3	<0.4	<50	1,400	<5
B11-O*	09/15/93	<0.4	<0.3	<0.3	<0.4	<50	6,000	10,000
B14-O*	09/15/93	<0.4	<0.3	<0.3	<0.4	<50	10,000	--
B3-O* (FREE PRODUCT)	09/15/93	--	--	--	--	--	--	150,000
BH9-D*	09/09/93	--	--	--	--	--	110,000	--
BH10-D*	09/09/93	--	--	--	--	--	8,500	--
BH-8D*	09/09/93	--	--	--	--	--	7,700	--
B14-D*	09/15/93	<0.4	<0.3	<0.3	<0.4	<50	10,000	--
SB1-WATER**	03/23/95	0.4	<0.3	<0.3	0.6	<50	260	<250
SB2- WATER***	03/23/95	<0.3	<0.3	<0.3	<0.5	<50	<500	4,000
SB3 (FREE PROJECT)**	03/23/95	--	--	--	--	--	--	--
SB4-WATER**	03/23/95	<0.3	<0.3	<0.3	<0.4	<50	300	<250

DRAFT

- **** = Samples collected by Groundwater Technology, Inc.
- a** = According to lab report "Purgeable hydrocarbons quantitated as gasoline may be due to heavier petroleum product.
- b** = According to lab report Purgeable hydrocarbons quantitated as gasoline do not match typical gasoline pattern.
- c** = Hydrocarbons reported as oil and grease.
- d** = Reported by laboratory as uncategorized compound TPH Kerosene.

DRAFT

See laboratory reports for Environmental Protection Agency (EPA) analytical methods

- TPH = Total Petroleum Hydrocarbons
- * = Samples collected by Clayton Environmental Consultants
- ** = Samples collected by Groundwater Technology, Inc.
- = Not analyzed
- a = Hydrocarbons reported as oil.

*waiting for next fieldwork results to include?
Q: when will a final copy be sent?*

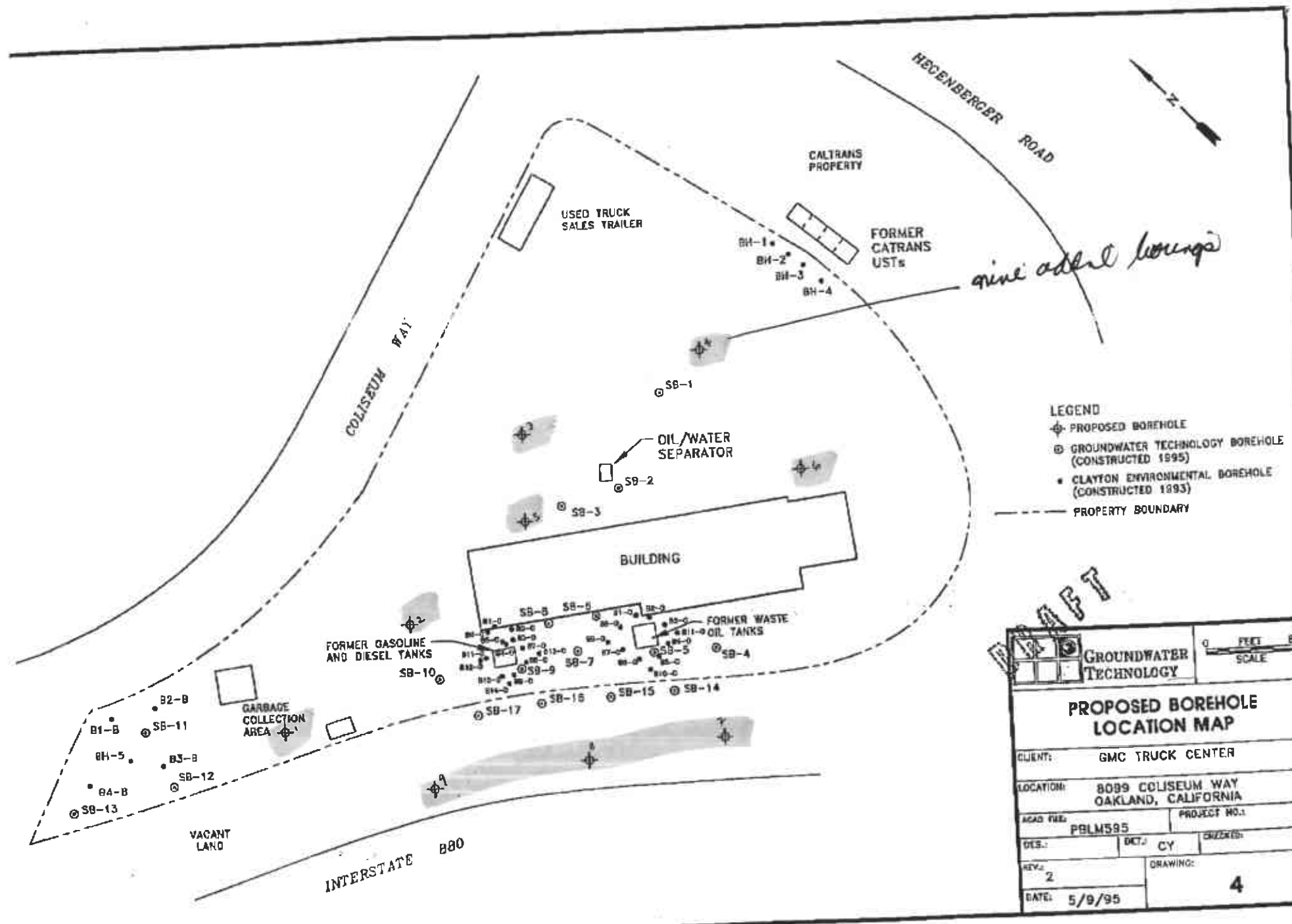

vine adobe lounge