

ALAMEDA COUNTY
HEALTH CARE SERVICES

AGENCY
DAVID J. KEARS, Agency Director



April 24, 1997
STID 44
page 1 of 2

Attn: Ms. Lynn Sautter
Union Machine Works
534-2nd St.
Oakland CA 94607

ENVIRONMENTAL HEALTH SERVICES
ENVIRONMENTAL PROTECTION (LOP)
1131 Harbor Bay Parkway, Suite 250
Alameda, CA 94502-6577
(510) 567-6700
FAX (510) 337-9335

REMEDIAL ACTION COMPLETION CERTIFICATION

RE: Union Machine Works, 534-2nd St., Oakland CA 94607
Case File Number 44

Dear Ms. Sautter,

This letter confirms the completion of site investigation and remedial action for the 1,000-gallon gasoline underground storage tank formerly located below the sidewalk on 2nd St. at the above referenced site. Thank you for your cooperation throughout this investigation. Your willingness and promptness in responding to our inquiries concerning the former underground storage tank is greatly appreciated.

Based on information in the above-referenced file, and with the provision that the information provided to this agency was accurate and representative of site conditions, **no further action related to the underground tank release is required.**

This notice is issued pursuant to a regulation contained in Title 23, Division 3, Chapter 16, Section 2721(e) of the California Code of Regulations.

Please contact our office if you have any questions regarding this matter.

Sincerely,

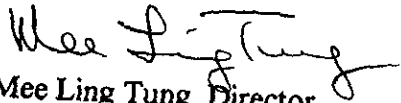
Mee Ling Tung, Director

ALAMEDA COUNTY
HEALTH CARE SERVICES

AGENCY
DAVID J. KEARS, Agency Director



April 24, 1997
STID 44

Attn: Ms. Lynn Sautter
Union Machine Works
534-2nd St.
Oakland CA 94607

ENVIRONMENTAL HEALTH SERVICES
ENVIRONMENTAL PROTECTION (LOP)
1131 Harbor Bay Parkway, Suite 250
Alameda, CA 94502-6577
(510) 567-6700
FAX (510) 337-9335

RE: **CASE CLOSURE**, Union Machine Works, 534-2nd St., Oakland CA 94607

Dear Ms. Sautter,

This letter transmits the enclosed underground storage tank (UST) case closure letter in accordance with Chapter 6.75 (Article 4, Section 25299.37[h]). The State Water Resources Control Board (SWRCB) adopted this letter on 2/20/97. As of 3/1/97, Alameda County Health Care Services Agency, Environmental Health Services, Local Oversight Program is required to use this case closure letter for all UST leak sites. We are also transmitting to you the enclosed case closure summary. These documents confirm the completion of the investigation and cleanup of the reported release at the subject site. **The subject fuel leak case is closed.**

If you have any questions, please call Ms. Jennifer Eberle at 510-567-6761. Thank you.

Sincerely,

Tom Peacock
Supervisor, Local Oversight Program

Enclosures:

1. Case Closure Letter
2. Case Closure Summary

cc: Misty Kaltreider, ACC Environmental, 7977 Capwell Dr., Suite 100, Oakland CA 94621
Jennifer Eberle (3 copies of letter only)

je.44clos.let
enclosures

April 24, 1997

STID 44

page 2 of 2

Attn: Ms. Lynn Sautter

cc: Acting Chief, Environmental Protection Division
Kevin Graves, RWQCB
Lori Casias, SWRCB (with Closure Summary)
Dave Deaner, SWRCB, UST Cleanup Fund Program
Misty Kaltreider, ACC Environmental, 7977 Capwell Dr., Suite 100, Oakland CA 94621
Jennifer Eberle (3 copies of letter only)

LOP/Completion
je.44clos.let
enclosure (clos sum)

01-1537

CASE CLOSURE SUMMARY
Leaking Underground Fuel Storage Tank Program

I. AGENCY INFORMATION

Date: 7/1/96

Agency name: **Alameda County-HazMat**
City/State/Zip: **Alameda CA 94502**
Responsible staff person: **Jennifer Eberle**

Address: **1131 Harbor Bay Pky**
Phone: **(510) 567-6700**
Title: **Hazardous Materials Spec.**

II. CASE INFORMATION

Site facility name: **Union Machine Works**
Site facility address: **534-2nd St., Oakland CA 94607**
RB LUSTIS Case No: **N/A** Local Case No./LOP Case No.: **44**
URF filing date: **SWEEPS No: N/A**

Responsible Parties: Addresses: Phone Numbers:
Ms. Lynne Sautter, Union Machine Works, 534-2nd St., Oakland CA 94607

451-8989

<u>Tank No:</u>	<u>Size in gal.:</u>	<u>Contents:</u>	<u>Closed in-place or removed?:</u>	<u>Date:</u>
1	1000	gasoline	removed	8/20/90

III. RELEASE AND SITE CHARACTERIZATION INFORMATION

Cause and type of release: unknown
Site characterization complete? YES
Monitoring Wells installed? YES Number: one
Proper screened interval? YES
Highest depth to water (DTW): 6.50' bgs Lowest DTW: 6.92' bgs
Flow direction: presumed to be southwest, based on proximity to the estuary. Nearby site at 50 Martin Luther King Way reported groundwater flow as west and north.
Most sensitive current use: industrial
Are drinking water wells affected? NO Aquifer name: NA
Is surface water affected? NO Nearest affected SW name: NA
Off-site beneficial use impacts (addresses/locations): unknown

Report(s) on file? YES Where is report(s) filed?
Alameda County, 1131 Harbor Bay Pky, Alameda Ca 94502

ENVIRONMENTAL
PROTECTION
16 AUG 22 PM 2: 20

Leaking Underground Fuel Storage Tank Program

Treatment and Disposal of Affected Material:

<u>Material</u>	<u>Amount (include units)</u>	<u>Action (Treatment of Disposal w/destination)</u>	<u>Date</u>
Tank	1000 gal	disposed to H&H (manifest #90281476)	8/20/90
Tank's Contents	150 gal	disposed to Gibson Oil Refinery (manifest #90009834)	8/18/90

III. RELEASE AND SITE CHARACTERIZATION INFORMATION (Continued) Maximum Documented Contaminant Concentrations - - Before and After Cleanup

<u>Contaminant</u>	<u>Soil (ppm)</u>		<u>Water (ppb)</u>	
	<u>Before*</u>	<u>After**</u>	<u>Before#</u>	<u>After##</u>
TPH (Gas)	ND	ND	5300	ND
Benzene	ND	ND	110	ND
Toluene	ND	ND	190	ND
Ethylbenzene	ND	ND	58	ND
Xylenes	ND	ND	180	ND
total lead		9.9		

Comments (Depth of Remediation, etc.):

* samples from tank pit during tank removal on 8/20/90

** sample from well borehole, 11/7/95

grab water sample from tank pit during tank removal on 8/20/90

water sample from MW1

IV. CLOSURE

Does completed corrective action protect existing beneficial uses per the Regional Board Basin Plan? Undetermined

Does completed corrective action protect potential beneficial uses per the Regional Board Basin Plan? Undetermined

Does corrective action protect public health for current land use? YES

Site management requirements: NA

Leaking Underground Fuel Storage Tank Program

Should corrective action be reviewed if land use changes? YES
Monitoring wells Decommissioned: it will be upon signoff from RWQCB
Number Decommissioned: Number Retained:
List enforcement actions taken: none
List enforcement actions rescinded: none

V. ADDITIONAL COMMENTS, DATA, ETC.

On 8/20/90, a 1,000-gallon gasoline UST was removed by Scott Co., in the presence of Paul Smith of Alameda County and the RP Lynne Sautter. Water was present in the excavation; a water sample was collected. Two soil samples were collected from the ends of the UST at the water/soil interface. A 4-point composite sample was collected from the soil stockpile. See **Figures 1 and 2.**

Soil results indicated ND TPHg and BTEX in the tank pit samples as well as the stockpiled soil sample. The County had requested lead analysis on soil samples, but it was apparently forgotten. The stockpiled soil was apparently used to backfill the excavation. Water results indicated 5300 ppb Tphg and 110 ppb benzene, as well as TEX. Based on the water results, further investigation was requested.

On 5/1/91, a soil sample was apparently collected from below the sidewalk at a depth of approximately 0.5 to 1.0' bgs, and analyzed for organic lead. Results indicated 0.005 mg/kg organic lead; the detection limit was 0.001 mg/kg. Scott Company's cover letter dated 5/24/91 stated that "the results show no organic lead present." However, it was unclear where this sample was taken in relation to the former UST excavation. Therefore, lead analysis was requested in the soil samples for the forthcoming monitoring well.

Union Machine Works submitted a report prepared by Testing Engineers Inc (TEI), dated 5/13/93, under Ms. Sautter's cover letter dated 8/12/93. The TEI report stated that they collected water samples from "the excavated tank site and a nearby manhole location" on 4/15/93 and 4/29/93. The sample identified as "tank site" contained ND BTEX and 150 ug/L TPH as diesel. The sample identified as "manhole PG&E" contained 9.4 mg/L sodium. See **Figure 3.** It was unclear as to what these samples represented.

Another TEI report, dated 7/26/94, was submitted under Union Machine Works' cover letter dated 8/3/94. The TEI report states that water was again sampled from "the excavated tank site" on 7/18/94. Results indicated ND TPHg and ND BTEX. Again, it was unclear as to what these

Leaking Underground Fuel Storage Tank Program

samples represented. Lynne Sautter reported that the samples had been collected from a "well point" was apparently constructed near the former UST excavation (telephone conversation w/J. Eberle, 5/19/93). Eventually, a bona fide groundwater monitoring well was installed by ACC Environmental (ACC) on 11/7/95. See Figure 4. The well was located approximately 12' southwest of the former tank excavation. Only one well was installed, due to known groundwater flow direction at 50 Martin Luther King Way (west and northwest), and the proximity of the site to the Oakland Inner Harbor (2 blocks, or 0.375 mile or 1980 feet to the southwest).

One soil sample was collected from the borehole at 6.5'bgs; this sample was classified as "wet." Results indicated 9.9 mg/kg total lead (by method 3050M/7420), ND TPHg, and ND BTEX. The presence of lead in the absence of hydrocarbons indicates that the lead is likely biogenic, and not related to the UST. Groundwater was first encountered at 10'bgs, and stabilized at 7'bgs. The well was screened from 4.5'bgs to 14.5'bgs.

Groundwater has been sampled from this well for 3 consecutive quarters; on 11/13/95, 2/13/96, and 5/14/96. Results have been ND for TPHg and BTEX. Combined with the previous groundwater sampling events, there is a good amount of groundwater data.

Case closure is recommended for the following reasons:

- 1) tank pit and stockpiled soils were ND for TPHg and BTEX;
- 2) groundwater has been ND for TPHg and BTEX for 3 consecutive quarters, particularly during the rainier seasons;
- 3) further groundwater sampling would occur in August, when the water table is at its lowest, and would likely be ND;
- 4) the presence of lead in the borehole in the absence of hydrocarbons indicates that the lead is likely biogenic and not related to the UST; and
- 5) although not yet classified as such, this groundwater is likely not beneficial due to its proximity to the estuary (and likely high TDS levels), and the historic industrial usage of the surrounding area.

Leaking Underground Fuel Storage Tank Program

VI. LOCAL AGENCY REPRESENTATIVE DATA

Name: Jennifer Eberle Title: Hazardous Materials Specialist

Signature: *J Eberle* Date: 7-9-96 ..

Reviewed by

Name: Susan Hugo Title: Senior Hazardous Materials Specialist

Signature: *Susan L. Hugo* Date: 7-10-96

Name: Tom Peacock Title: Manager

Signature: *Tom Peacock* Date: 7-9-96

VII. RWQCB NOTIFICATION

Date Submitted to RB: 7-11-96 RB Response: *Approved*
RWQCB Staff Name: Kevin Graves Title: Associate Water Resources Control Engineer

Date: 8/12/96 *K Graves*

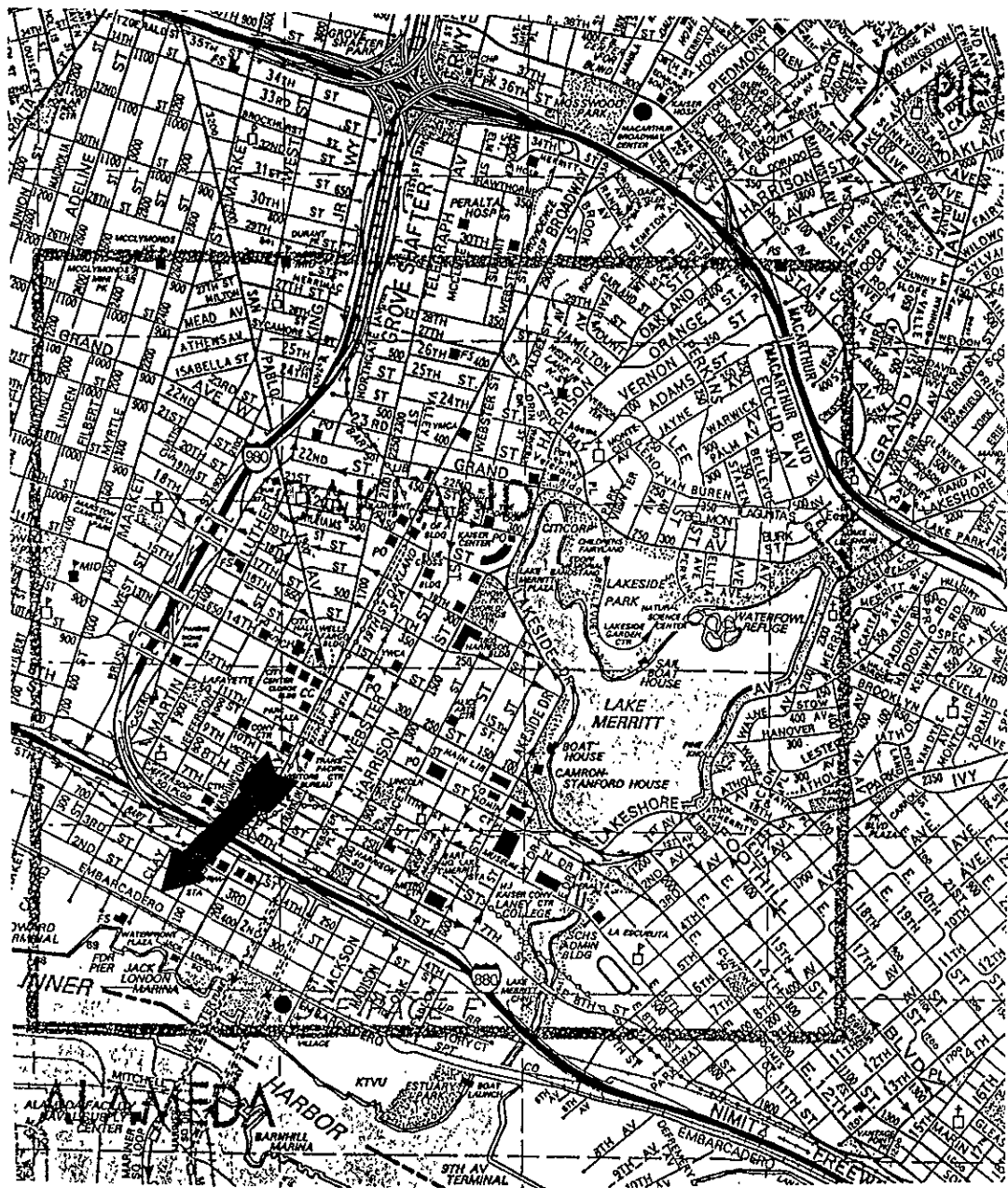

SOURCE: THOMAS BROTHERS GUIDE, 1990 ed

Fig. 1

Title: Location Map Union Machine Works 534 Second Street Oakland, California	
Figure Number: 1	Scale: 1" = 1/4 mi
Drawn By: MCR	Date: 5/31/96
Project Number: 95-6207-1	
ACC Environmental Consultants 7977 Capwell Drive, Suite 100 Oakland, California 94621 (510) 638-8400 Fax: (510) 638-8404	

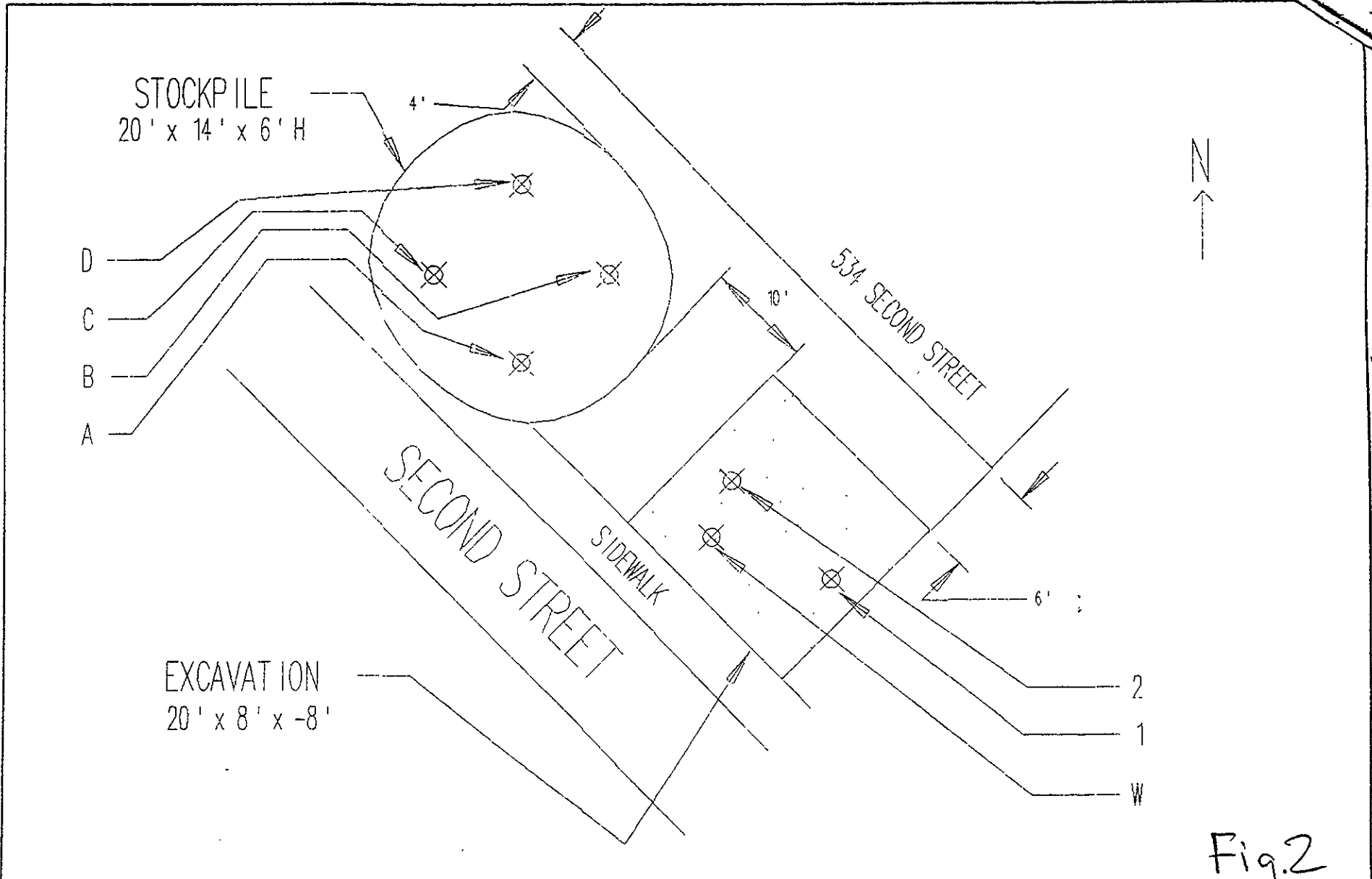

UNION MACHINE WORKS (SCOTT CO.)
534 SECOND STREET
OAKLAND, CALIFORNIA

SLOG #: 1745
DATE: 8/20/1990

W. E. S. T.
1046 Olive Drive #3, Davis, CA 95616
(916)753-9500 Drawn By: TGT

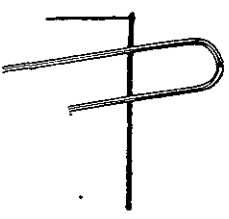
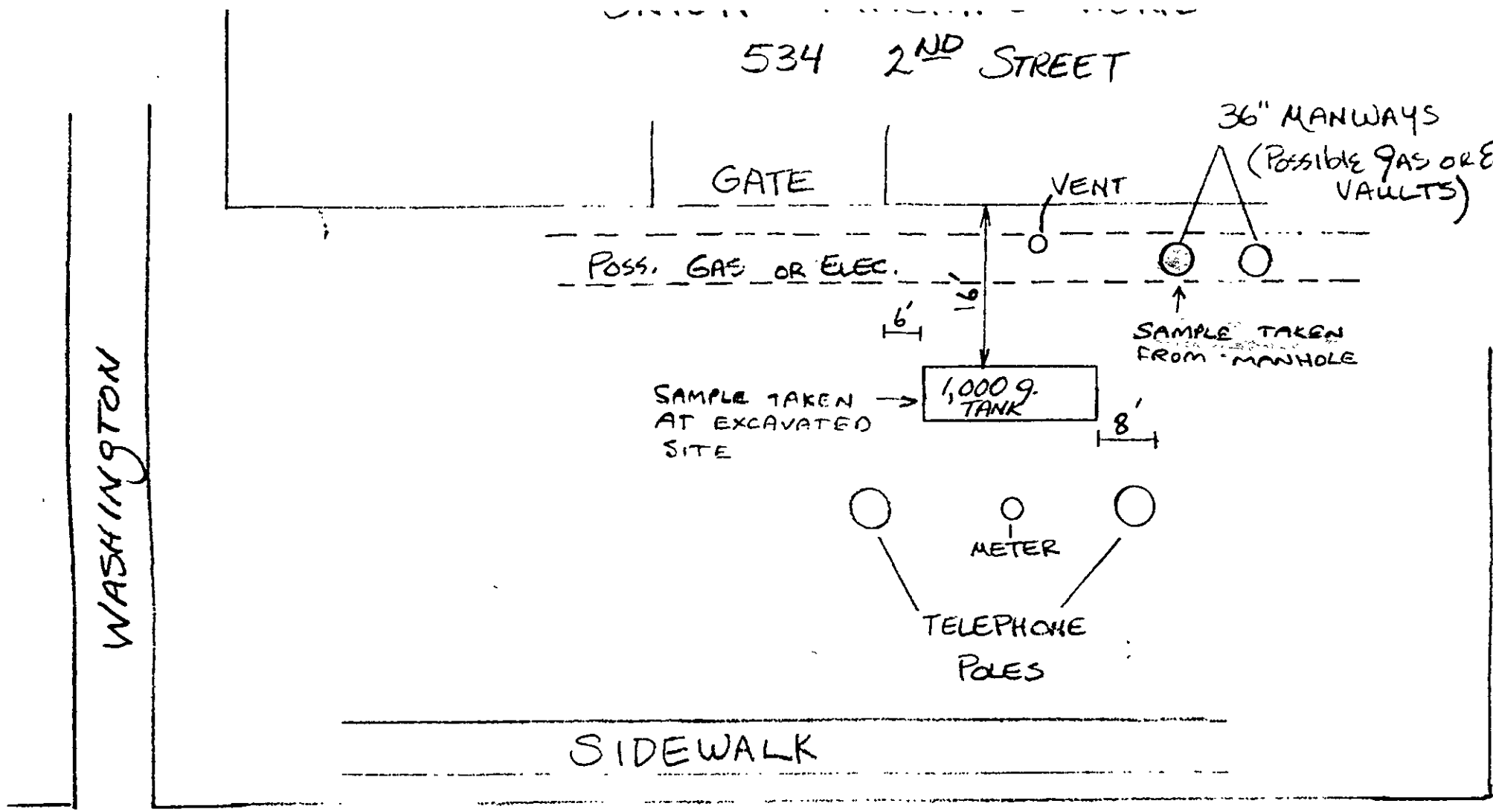

Fig 3
NOT TO SCALE
5.25.90

**UNION MACHINE WORKS
534 2nd STREET**

← Not to Scale
This Way

Dispenser
Location

Former 1,000-Gallon
Gasoline UST Excavation

Electric Lines

SIDEWALK

Telephone Poles

PARKING LANE

Fiber Optics/ Water/ EBMUD



MW-1

Sewer Line

2nd STREET

PARKING LANE

Legend

- MW-1  - Groundwater Monitoring Well Location
-  - Existing Well Point

Title **Site Plan
534 2nd Street
Oakland, California**

Figure No. 2.0 Date: 5/14/96

Drawn By: JVC Scale: 1" = 20'

Project No. 94-6207-1

ACC Environmental Consultants
7977 Capwell Drive, Suite 100
Oakland, California 94621

(510)638-8400 Fax: (510)638-8404



Fig. 4

Clay Street

54'

Doorway

Doorway