

1252 Quarry Lane  
P.O. Box 9019  
Pleasanton, CA 94566  
(510) 426-2600  
Fax (510) 426-0106

**Clayton**  
ENVIRONMENTAL  
CONSULTANTS

April 8, 1993

Clayton Project No. 47051.00

Mr. Ron Imperiale  
VALLEY AUTO CENTER  
6015 Scarlett Court  
Dublin, California 94568

Subject: Analytical Results of Groundwater Monitoring and Sampling at  
5787 Scarlett Court in Dublin, California

Dear Mr. Imperiale:

Clayton Environmental Consultants, Inc. is pleased to present our laboratory report (Attachment 1) for groundwater sampling conducted on March 9, 1993 at the Valley Auto Center facility, located at 5787 Scarlett Court in Dublin, California.

Groundwater samples were collected from monitoring wells MW-3, MW-4, and MW-5 (see attached figure) and analyzed by the following Environmental Protection Agency (EPA) Methods:

- EPA Method 8015 for total petroleum hydrocarbons as gasoline (TPH-G)
- EPA Method 8020 for benzene, toluene, ethylbenzene and xylenes (BTEX)

Details of this groundwater sampling event are provided in the water sampling field survey forms (Attachment 2).

Based on the analytical reports, our findings follow:

- Toluene was detected in the groundwater sample collected from MW-5 at a concentration of 0.9 micrograms per liter ( $\mu\text{g/l}$ ).
- The analytical results revealed the presence of 150  $\mu\text{g/l}$  of TPH-G in the groundwater sample collected from MW-5.
- No TPH-G or BTEX was detected at or above the analytical detection limits in groundwater samples collected from MW-3 and MW-4.
- Groundwater flow direction beneath the site was calculated to be to the south.

00 2 13 01 001 96

Mr. Ron Imperiale  
Valley Auto Center  
April 8, 1993

Page 2  
Clayton Project No. 47051.00

We recommend that Valley Auto Center sent a copy of this report to:

- Ms. Eva Chu  
Hazardous Material Specialist  
Alameda County Health Care Services Agency  
80 Swan Way Room 200  
Oakland, California 94612
- Eddy So  
Regional Water Quality Control Board  
2101 Webster Avenue  
Oakland, CA 94612

If you have any questions, please call me at (510) 426-2616 or Dariush Dastmalchi at (510) 426-2609.

Sincerely,

  
Anthony S. McElligott, P.E.  
Supervisor, Remediation  
Western Operations

ASM/dd

**FIGURE**

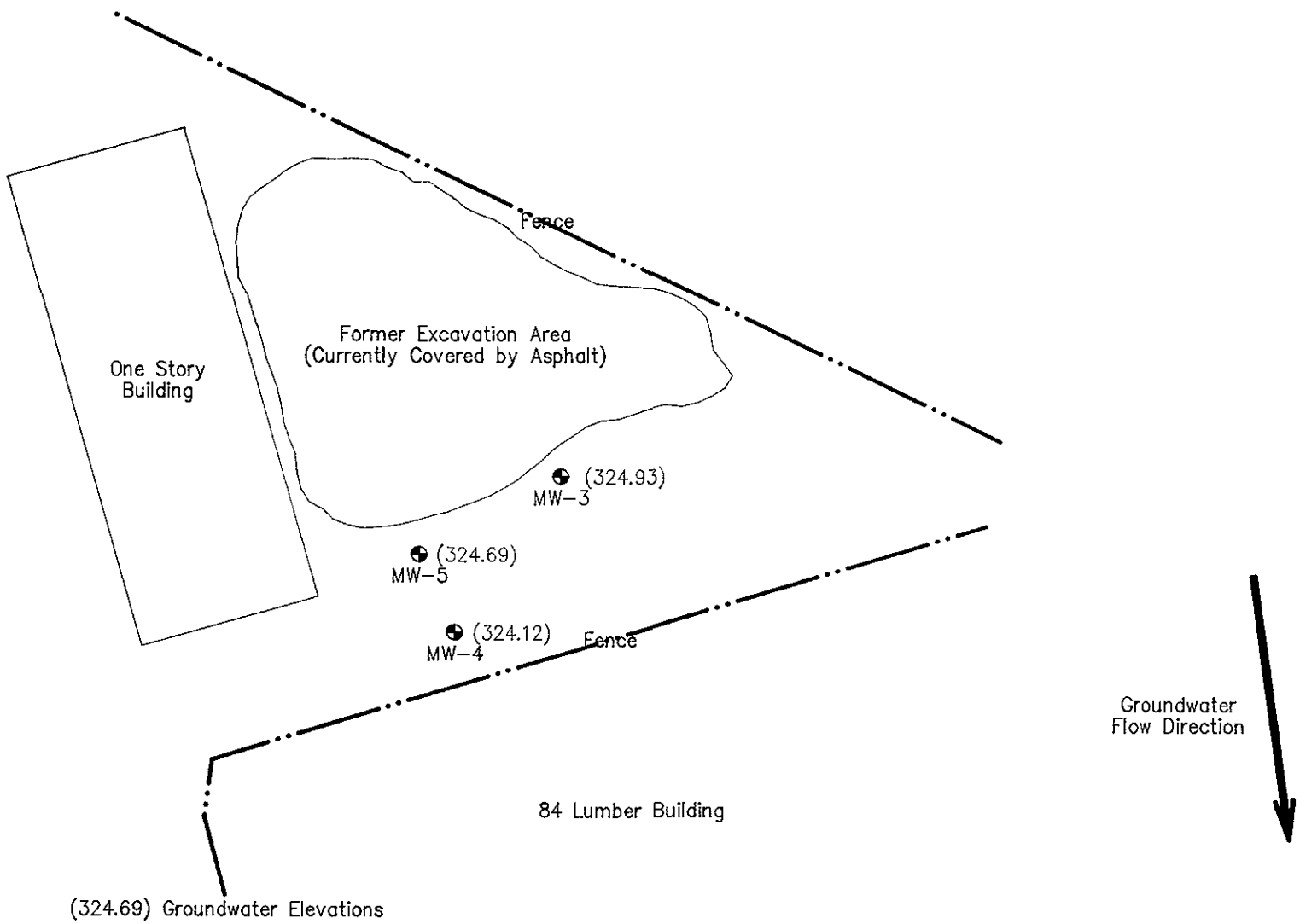

(324.69) Groundwater Elevations

(not to scale)

Groundwater Elevations & Monitoring Wells Location  
 VALLEY AUTO CENTER  
 5787 Scarlett Court  
 Dublin, California  
 Clayton Project No. 47051.00

Figure  
 1  
 47051-00-16

**Clayton**  
 ENVIRONMENTAL  
 CONSULTANTS

**ATTACHMENT 1**

**LABORATORY REPORTS**

1252 Quarry Lane  
P.O. Box 9019  
Pleasanton, CA 94566  
(510) 426-2600  
Fax (510) 426-0106

**Clayton**  
ENVIRONMENTAL  
CONSULTANTS

March 19, 1993

Mr. Dariush Dastmalchi  
CLAYTON ENVIRONMENTAL CONSULTANTS, INC.  
1252 Quarry Lane  
Pleasanton, CA 94566

Client Ref. 47051.00  
Clayton Project No. 93030.89

Dear Mr. Dastmalchi:

Attached is our analytical laboratory report for the samples received on March 9, 1993. A copy of the Chain-of-Custody form acknowledging receipt of these samples is attached.

Please note that any unused portion of the samples will be disposed of 30 days after the date of this report, unless you have requested otherwise.

We appreciate the opportunity to be of assistance to you. If you have any questions, please contact Suzanne Silvera, Client Services Supervisor, at (510) 426-2657.

Sincerely,



Ronald H. Peters, CIH  
Director, Laboratory Services  
Western Operations

RHP/caa  
Attachments

Results of Analysis  
for  
Valley Nissan

Client Reference: 47051.00  
Clayton Project No. 93030.89

Sample Identification:	MW-3	Date Sampled:	03/09/93
Lab Number:	9303089-01A	Date Received:	03/09/93
Sample Matrix/Media:	WATER	Date Prepared:	03/12/93
Preparation Method:	EPA 5030	Date Analyzed:	03/12/93
Analytical Method:	EPA 8015/8020		

Analyte	CAS #	Concentration (ug/L)	Limit of Detection (ug/L)
<u>BTEX/Gasoline</u>			
Benzene	71-43-2	ND	0.4
Ethylbenzene	100-41-4	ND	0.3
Toluene	108-88-3	ND	0.3
o-Xylene	95-47-6	ND	0.4
p,m-Xylenes	--	ND	0.4
Gasoline	--	ND	50
<u>Surrogates</u>		<u>Recovery (%)</u>	<u>QC Limits (%)</u>
1,4-Difluorobenzene	540-36-3	101	50 - 150

ND: Not detected at or above limit of detection  
--: Information not available or not applicable

Results of Analysis  
for  
Valley Nissan

Client Reference: 47051.00  
Clayton Project No. 93030.89

Sample Identification:	MW-4	Date Sampled:	03/09/93
Lab Number:	9303089-02A	Date Received:	03/09/93
Sample Matrix/Media:	WATER	Date Prepared:	03/12/93
Preparation Method:	EPA 5030	Date Analyzed:	03/12/93
Analytical Method:	EPA 8015/8020		

Analyte	CAS #	Concentration (ug/L)	Limit of Detection (ug/L)
<u>BTEX/Gasoline</u>			
Benzene	71-43-2	ND	0.4
Ethylbenzene	100-41-4	ND	0.3
Toluene	108-88-3	ND	0.3
o-Xylene	95-47-6	ND	0.4
p,m-Xylenes	--	ND	0.4
Gasoline	--	ND	50
<u>Surrogates</u>		<u>Recovery (%)</u>	<u>QC Limits (%)</u>
1,4-Difluorobenzene	540-36-3	104	50 - 150

ND: Not detected at or above limit of detection  
--: Information not available or not applicable



Results of Analysis  
for  
Valley Nissan

Client Reference: 47051.00  
Clayton Project No. 93030.89

Sample Identification:	MW-5	Date Sampled:	03/09/93
Lab Number:	9303089-03A	Date Received:	03/09/93
Sample Matrix/Media:	WATER	Date Prepared:	03/15/93
Preparation Method:	EPA 5030	Date Analyzed:	03/15/93
Analytical Method:	EPA 8015/8020		

Analyte	CAS #	Concentration (ug/L)	Limit of Detection (ug/L)
<u>BTEX/Gasoline</u>			
Benzene	71-43-2	ND	0.4
Ethylbenzene	100-41-4	ND	0.3
Toluene	108-88-3	0.9	0.3
o-Xylene	95-47-6	ND	0.4
p,m-Xylenes	--	ND	0.4
Gasoline	--	130	50
<u>Surrogates</u>		<u>Recovery (%)</u>	<u>QC Limits (%)</u>
1,4-Difluorobenzene	540-36-3	115	50 - 150

ND: Not detected at or above limit of detection  
--: Information not available or not applicable

# Clayton

ENVIRONMENTAL  
CONSULTANTS

A Marsh & McLennan Company

## REQUEST FOR LABORATORY ANALYTICAL SERVICES

For Clayton Use Only Page 1 of 1

Project No. 47051.00

Batch No. 9303089

Client No. \_\_\_\_\_

Date Logged In 3/10/93 By TS

REPORT RESULTS TO	Name <u>D. DALSTMACH</u>	Title _____	Purchase Order No. _____		Client Job No. _____	
	Company <u>CEC</u>	Dept. <u>EE</u>	Name _____		Company <u>VALLEY NISSAN</u>	
	Mailing Address _____	City, State, Zip _____	Address _____		City, State, Zip <u>DUBLIN, CA 94568</u>	
	Telephone No. _____	Telefax No. _____	ANALYSIS REQUESTED (Enter an 'X' in the box below to indicate request; Enter a 'P' if Preservative added.)			
Date Results Required: <u>STANDARD T/A</u>	Rush Charges Authorized? <input type="checkbox"/> Yes <input checked="" type="checkbox"/> No	Phone Results <input type="checkbox"/>	Samples are: (check if applicable)			
Special Instructions: (method, limit of detection, etc.)			<input type="checkbox"/> Drinking Water			
* Explanation of Preservative: <u>HCl</u>			<input type="checkbox"/> Collected in the State of New York			
CLIENT SAMPLE IDENTIFICATION		DATE SAMPLED	MATRIX/MEDIA	AIR VOLUME (specify units)	Number of Containers	FOR LAB USE ONLY
<u>MW-3</u>		<u>3-9-93</u>	<u>H2O</u>	<u>40 ML</u>	<u>2</u>	<u>01 A, B</u>
<u>MW-4</u>		<u>3-9-93</u>	<u>H2O</u>	<u>40 ML</u>	<u>2</u>	<u>02</u>
<u>MW-5</u>		<u>3-9-93</u>	<u>H2O</u>	<u>40 ML</u>	<u>2</u>	<u>03</u>
<u>TRIP BLANK</u>		<u>"</u>	<u>H2O</u>	<u>40 ML</u>	<u>1</u>	<u>04 A</u>
Relinquished by: <u>[Signature]</u>		Date/Time <u>3-9-93 1505</u>	Received by: <u>[Signature]</u>		Date/Time _____	
Relinquished by: _____		Date/Time _____	Received at Lab by: <u>Terry Sato</u>		Date/Time <u>3/9/93 3:05</u>	
Method of Shipment: _____		Sample Condition Upon Receipt: <input checked="" type="checkbox"/> Acceptable <input type="checkbox"/> Other (explain)				
Authorized by: _____		Date _____				
(Client Signature <u>Must</u> Accompany Request)						

Please return completed form and samples to one of the Clayton Environmental Consultants, Inc. labs listed below:

22345 Roethel Drive  
Novi, MI 48375  
(313) 344-1770

Raritan Center  
160 Fieldcrest Ave.  
Edison, NJ 08837  
(201) 225-6040

400 Chastain Center Blvd., N.W.  
Suite 490  
Kennesaw, GA 30144  
(404) 499-7500

1252 Quarry Lane  
Pleasanton, CA 94566  
(415) 426-2600

DISTRIBUTION:  
WHITE - Clayton Laboratory  
YELLOW - Clayton Accounting  
PINK - Client Copy

**ATTACHMENT 2**

**WATER SAMPLING FIELD SURVEY FORMS**

**CLAYTON ENVIRONMENTAL CONSULTANTS, INC.  
WATER SAMPLING FIELD SURVEY FORM**

Job No: 47051.00

Site: Valley Nissan

Date: March 9, 1993

Well No: MW-5

Sampling Team: Williams

Sampling Method: Disposable bailer, 2-inch 12 volt pump

Field Conditions: Clear, warm

Describe Equipment Decontamination Before Sampling This Well:

**Pump washed with soap and water and rinsed with deionized water**

Total Depth of Well:

13.92 ft.

Time: 1100

Depth to Water Before Purging:

3.17 ft.

Height of Water Column:

10.75 ft.

2-inch

\* .16

4-inch

.65

=

Volume

7.02 gals

Purge Factor

\* 4

=

Volume To Purge

28.8 gals.

Depth Purging From: ft.

Time Purging Begins:

Notes on Initial Discharge: Slightly turbid

Time	Volume Purged	pH	Conductivity	T°C	Comments
1140	10	6.6	Off scale	17.4	Clear
1150	20	6.9	Off scale	18.1	Dry @ 22 gal
1215	30	6.8	Off scale	18.4	Dry @ 22 gal

CLAYTON ENVIRONMENTAL CONSULTANTS, INC.  
 WATER SAMPLING FIELD SURVEY FORM  
 (CONTINUED)

Time Field Parameter Measurement Begins: 1309

	Rep #1	Rep #2	Rep #3	Rep #4
pH	6.8	6.8	6.8	6.8
Conductivity	Off scale	>2,000		
T°C	18.4	18.4	18.4	18.4

Pre-Sample Collection Gallons Purged: 29  
Time Sample Collection Begins: 1315  
Time Sample Collection Ends: 1318  
Total Gallons Purged: 30

Comments:

**CLAYTON ENVIRONMENTAL CONSULTANTS, INC.  
WATER SAMPLING FIELD SURVEY FORM**

Job No: 47051.00

Site: Valley Nissan

Date: March 9, 1993

Well No: MW-4

Sampling Team: Williams

Sampling Method: Disposable bailer, 2-inch 12 volt pump

Field Conditions: Clear, warm

Describe Equipment Decontamination Before Sampling This Well:

Pump washed with soap and water and rinsed with deionized water

Total Depth of Well:

18.92 ft.

Time:

1130

Depth to Water Before Purging:

3 ft.

Height of Water Column:

15.92 ft.

2-inch

\*

.16

4-inch

.65

=

Volume

10.33 gals

\*

Purge Factor

4

=

Volume To Purge

41.34 gals.

Depth Purging From: ft.

Time Purging Begins:

Notes on Initial Discharge: Slightly turbid

Time	Volume Purged	pH	Conductivity	T°C	Comments
1228	10	7.3	Off scale	18.1	Clearing
1234	20	7.3	Off scale	17.6	Clear
1242	30	7.3	Off scale	17.9	Clear
1248	40	7.3	Off scale	17.8	

CLAYTON ENVIRONMENTAL CONSULTANTS, INC.  
 WATER SAMPLING FIELD SURVEY FORM  
 (CONTINUED)

Time Field Parameter Measurement Begins: 1300

	Rep #1	Rep #2	Rep #3	Rep #4
pH	7.3	7.3	7.3	7.3
Conductivity	Off scale	Off scale	Off scale	Off scale
T°C	17.8	17.7	17.6	17.6

Pre-Sample Collection Gallons Purged: 42  
Time Sample Collection Begins: 1305  
Time Sample Collection Ends: 1306  
Total Gallons Purged: 43

Comments:

CLAYTON ENVIRONMENTAL CONSULTANTS, INC.  
WATER SAMPLING FIELD SURVEY FORM

Job No: 47051.00

Site: Valley Nissan

Date: March 9, 1993

Well No: MW-3

Sampling Team: Williams

Sampling Method: Disposable bailer, 2-inch 12 volt pump

Field Conditions: Clear, warm

Describe Equipment Decontamination Before Sampling This Well:

Pump washed with soap and water and rinsed with deionized water

Total Depth of Well:

14.21 ft.

Time: 1030

Depth to Water Before Purging:

3 ft.

Height of Water Column:

11.21 ft.

2-inch

\* .16

4-inch

.65

=

Volume

7.31 gals

Purge Factor

\* 4

=

Volume To Purge

29.25 gals.

Depth Purging From: ft.

Time Purging Begins:

Notes on Initial Discharge: Very sandy

Time	Volume Purged	pH	Conductivity	TC	Comments
1059	10	7.5	Off scale	19.4	Clear with sand
1107	12	6.9	Off scale	19.2	Clear with sand
1110	20	7.0	Off scale	18.9	Clear with sand
1120	30		Off scale	19.3	Clear with sand



CLAYTON ENVIRONMENTAL CONSULTANTS, INC.  
 WATER SAMPLING FIELD SURVEY FORM  
 (CONTINUED)

Time Field Parameter Measurement Begins: 1155

	Rep #1	Rep #2	Rep #3	Rep #4
pH	7.1	7.0	7.0	7.0
Conductivity	Off scale	Off scale	Off scale	Off scale
T°C	19.0	19.0	18.9	18.9

Pre-Sample Collection Gallons Purged: 30  
Time Sample Collection Begins: 1200  
Time Sample Collection Ends: 1201  
Total Gallons Purged: 31

Comments: