



September 7, 1990  
Sample Log 1775

Jay Groh  
Scott Company  
1919 Market Street  
Oakland, CA 94607

Subject: Analytical Results for 2 Soil Sample(s)  
Identified as: Plants Unlimited  
Received: September 6, 1990  
Purchase Order: 106595-58398-72-7001

Dear Mr. Groh:

Analysis of the sample(s) referenced above has been completed. This report is written to confirm results communicated on September 7, 1990 and describes procedures used to analyze the samples.

Sample(s) were received in brass sleeves that were sealed with aluminum foil and plastic endcaps. Each sample was transported and received under documented chain of custody and stored at 4 degrees C until analysis was performed.

Sample(s) were analyzed using the following method(s):

- "BTEX" (EPA Method 8020/Purge-and-Trap)
- "TPH as Gasoline" (Modified EPA Method 8015/Purge-and-Trap)

Please refer to the following table(s) for summarized analytical results and contact us if you have questions regarding procedures or results. The chain-of-custody document is enclosed.

Approved by:

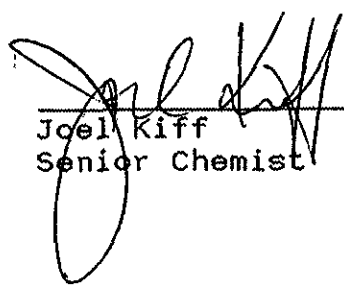
  
\_\_\_\_\_  
Joel Kiff  
Senior Chemist



September 7, 1990  
Sample Log 1775

Sample: CC

From : Plants Unlimited  
Received : September 6, 1990  
Matrix : Soil

--all concentrations are units of mg/kg--

Parameter / (Reporting Limit)	Measured Value
Benzene (.005)	<.005
Toluene (.005)	<.005
Ethylbenzene (.005)	<.005
Total Xylenes (.005)	<.005
TPH as Gasoline (.5)	<.5



September 7, 1990  
Sample Log 1775

Sample: DD

From : Plants Unlimited  
Received : September 6, 1990  
Matrix : Soil

--all concentrations are units of mg/kg--

Parameter / (Reporting Limit)	Measured Value
Benzene (.005)	<.005
Toluene (.005)	<.005
Ethylbenzene (.005)	<.005
Total Xylenes (.005)	<.005
TPH as Gasoline (.5)	<.5

KENT AVENUE

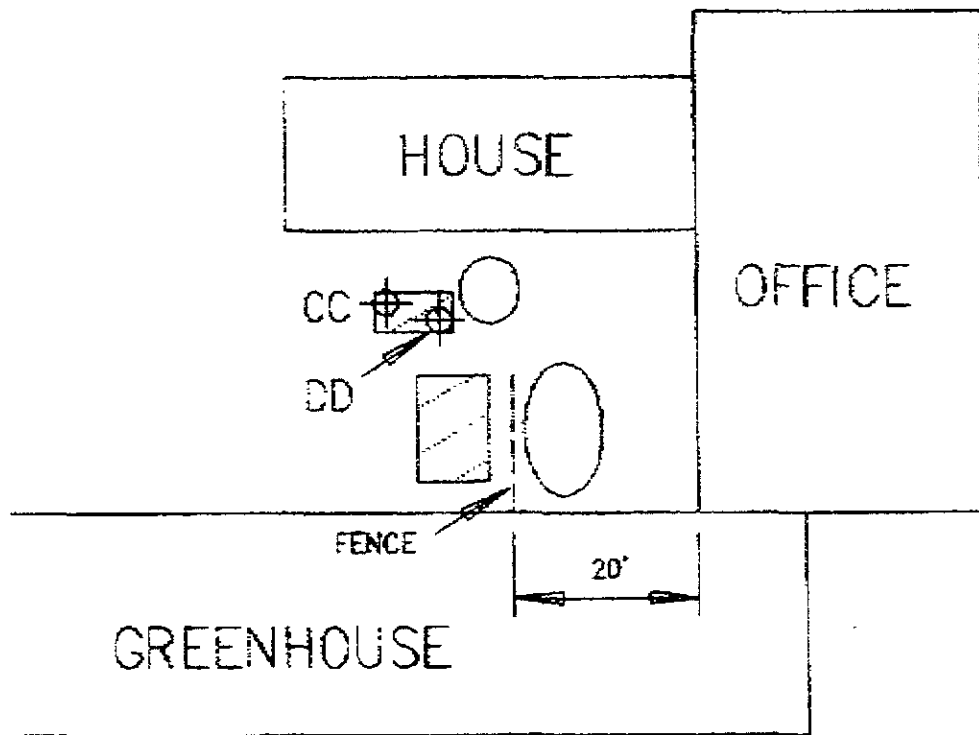

1st set of samples  
8-10' depth

NOTES: 2nd set

▷ Samples CC and DD  
were taken at a  
depth of 12 feet.

PLANTS UNLIMITED (SCOTT CO.)  
16450 KENT AVENUE  
SAN LORENZO, CALIFORNIA

Sample Log#: 1775  
DATE: 9/05/1990  
NOT TO SCALE



Western Environmental  
Science & Technology

1046 Olive Drive #3, Davis, CA 95616

Phone: (916) 753-9500

Drawn by: TGT

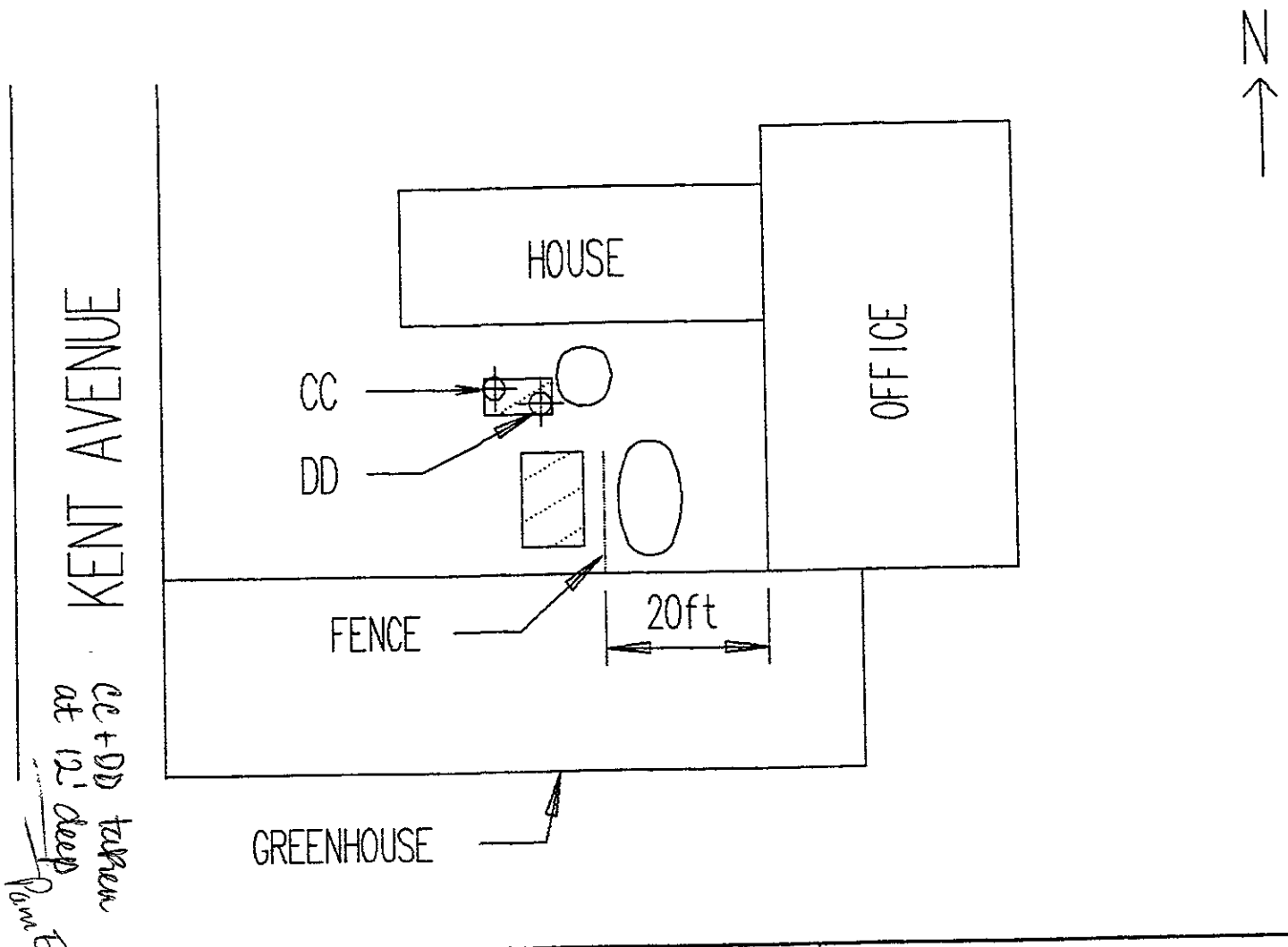

*CC + DD taken at 12' deep*  
*Pam E.*

PLANTS UNLIMITED (SCOTT CO.)  
 16450 KENT AVENUE  
 SAN LORENZO, CALIFORNIA

SLOG #: 1775  
 DATE: 9/5/1990

W. E. S. T.  
 1046 Olive Drive #3, Davis, CA 95616  
 (916)753-9500 Drawn By:

