



Mr. Charles Lemoine  
OLD WORLD GERMAN SAUSAGE COMPANY  
1367 52nd Avenue  
Oakland, California 94601

RE: Soil and water sampling at 6085 Scarlett Ct., Dublin, 04/28/92

Dear Mr. Lemoine;

This letter provides documentation of sample locations and results from sampling activities around a former tank removal excavation at your property located at 6085 Scarlett Court in Dublin, California.

At 09:00 on April 28, 1992 I met with you and your contracted backhoe operator at the Dublin property. Prior to backhoe excavation a water sample was taken from about the middle of the water standing in the open excavation. The water was sampled with a PVC bailer attached to a length of pipe. This water sample was transferred from the bailer to 40 mL VOA vials using a teflon™ bottom emptying device. The approximate location of the water sample is shown on the attached Figure.

Following the water sampling, the backhoe operator was directed to sequentially dig caved material from four positions around the perimeter of the existing former tank removal excavation at the approximate locations shown on the attached Figure. The operator dug a trench inside the excavation from about the edge of the standing water to the edge of the excavation so as to remove material caved from the excavation walls. The backhoe bucket was then used to remove a bucketful of fresh soil from the wall of the excavation at about the depth of the standing water and about one foot outward from the lip of the open excavation. A 2.5-inch by 6-inch brass sample tube was driven into the soil in the backhoe bucket. The ends of the brass tube containing the soil sample was covered with aluminum foil and capped. Each sample was designated by the excavation wall from which it came (i.e., south, east, north, and west).

A soil sample was also collected from the existing soil aeration area, at a location you selected as representing the soil with the highest levels of gasoline when originally excavated. This sample was designated Pile (for soil pile).

The soil samples and the water sample were labeled and immediately placed in an ice chest with frozen blue ice. The samples were logged onto a chain-of-custody form and delivered to ChromaLab, Inc. in San Ramon.

The laboratory report and chain-of-custody form are attached. None of the samples were found to contain detectable concentrations of total petroleum hydrocarbons as gasoline, benzene, toluene, ethylbenzene, or total xylenes.

The results of these analyses indicate that it is appropriate to backfill the former tank removal excavation. If you plan to backfill the excavation with the aerated soils, confirmation samples should be analyzed at a rate of one sample for every 20 cubic yards. Only clean soils should be used.

Please do not hesitate to call me at (510) 373-9211 should you have any questions.

Sincerely,

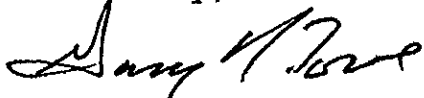

Gary D. Lowe, R.G., C.E.G.  
Principal, Hydrogeologist.

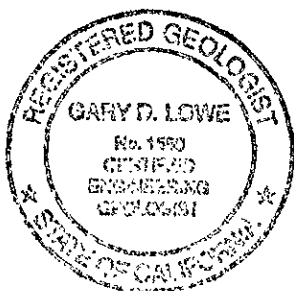

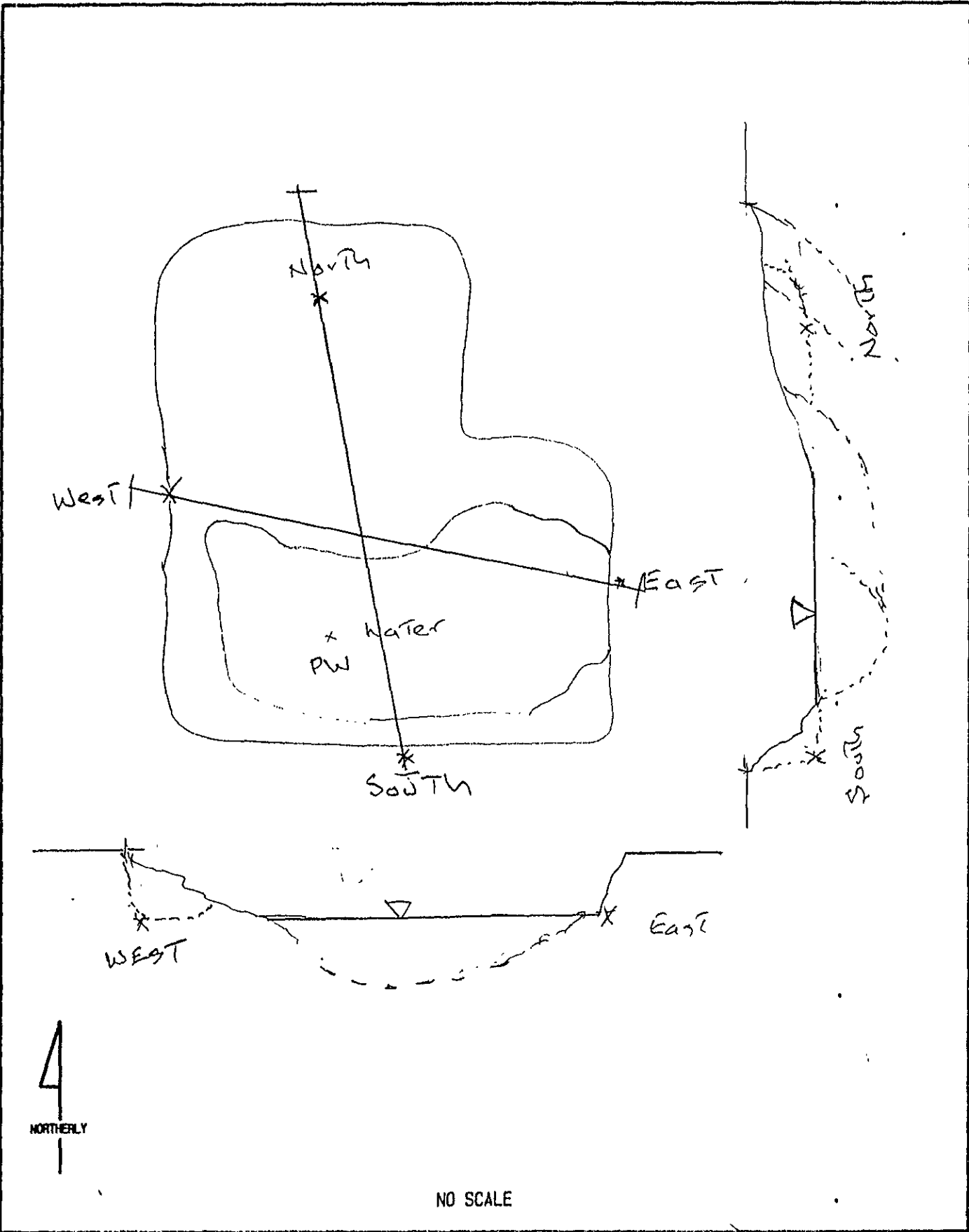

SAMPLE LOCATION SKETCH - APRIL 28, 1992

FIGURE

Charles Lemoane Property  
 6085 Scarlett Court, Dublin, California

1

**H<sub>2</sub>OGEOL**  
 A GROUND WATER CONSULTANCY

# CHROMALAB, INC.

Environmental Laboratory (1094)

5 DAYS TURNAROUND

May 5, 1992

ChromaLab File No.: 0492250

H<sub>2</sub>OGEOL

Attn: Gary Lowe

RE: Six soil samples for Gas/BTEX analysis

Project Name: CHARLES LEMOAR PL.

Project Location: 6085 Scarlott Ct.

Date Sampled: April 28, 1992

Date Submitted: April 28, 1992

Date Analyzed: May 4, 1992

## RESULTS:

Sample I.D.	Gasoline (mg/Kg)	Benzene (µg/Kg)	Toluene (µg/Kg)	Ethyl Benzene (µg/Kg)	Total Xylenes (µg/Kg)
041892 PW	N.D.	N.D.	N.D.	N.D.	N.D.
041892 South	N.D.	N.D.	N.D.	N.D.	N.D.
041892 East	N.D.	N.D.	N.D.	N.D.	N.D.
041892 North	N.D.	N.D.	N.D.	N.D.	N.D.
041892 West	N.D.	N.D.	N.D.	N.D.	N.D.
041892 Pile	N.D.	N.D.	N.D.	N.D.	N.D.
BLANK	N.D.	N.D.	N.D.	N.D.	N.D.
SPIKE RECOVERY	88%	104%	90%	99%	98%
DUP. SPIKE RECOVERY	92%	105%	89%	98%	98%
DETECTION LIMIT	1.0	5.0	5.0	5.0	5.0
METHOD OF ANALYSIS	5030/8015	8020	8020	8020	8020

ChromaLab, Inc.

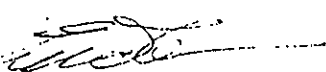
  
Eric Tam  
Laboratory Director

# CHROMALAB, INC.

2239 Omega Road, #1 • San Ramon, California 94583  
415/831-1788 • Facsimile 415/831-8798

## Chain of Custody

DATE 04/10/01 PAGE 1 OF 1

PROJ. MGR. <u>Gary P. Lowe</u>					ANALYSIS REPORT													NUMBER OF CONTAINERS
COMPANY <u>H2OGEOL</u>					TPH - Gasoline (EPA 5030)	TPH - Gasoline (5030, 8015) w/BTEX (EPA 602, 8020)	TPH - Diesel (EPA 3510, 3650, 8015)	PURGEABLE AROMATICS BYTEX (EPA 602, 8020)	PURGEABLE HALOCARBONS (EPA 601, 8010)	VOLATILE ORGANICS (EPA 624, 8240)	BASENEUTRALS, ACIDS (EPA 825/827, 8270)	TOTAL OIL & GREASE (EPA 5520 D&F)	PESTICIDES/PCB (EPA 608, 8080)	PHENOLS (EPA 604, 8040)	METALS	CAM ME w/Cr VI	PRIORITY METALS	
ADDRESS <u>P.O. Box 2165</u> <u>Livermore CA 94551</u>																		
SAMPLERS (SIGNATURE) <u>[Signature]</u> (PHONE NO.)																		
SAMPLE ID.	DATE	TIME	MATRIX	LAB ID.														
042892 PLS	04/28	0908	Liq		X													3
042892 - soil	04/28	0946	Soil		X													1
042892 Earth	04/28	0922	Soil		X													1
042892 NW	04/28	0933	Soil		X													1
042892 W	04/28	0952	Soil		X													1
042892 P. 10	04/28	0957	Soil		X													1

PROJECT INFORMATION		SAMPLE RECEIPT		RELINQUISHED BY 1.		RELINQUISHED BY 2.		RELINQUISHED BY 3.	
PROJECT NAME: <u>Charter Loma PL-1</u>	TOTAL NO. OF CONTAINERS <u>8</u>	CHAIN OF CUSTODY SEALS	REC'D GOOD CONDITION/COLD	(SIGNATURE) <u>[Signature]</u>	(TIME) <u>1015</u>	(SIGNATURE) <u>[Signature]</u>	(TIME)	(SIGNATURE) <u>[Signature]</u>	(TIME)
PROJECT NUMBER: <u>6085 Scario PCE</u>	CONFORMS TO RECORD	(PRINTED NAME) <u>Gary P. Lowe</u>		(DATE) <u>4/10/01</u>	(PRINTED NAME)	(DATE)	(PRINTED NAME)	(DATE)	
SHIPPING ID. NO.	LAB NO.	(COMPANY) <u>H2OGEOL</u>		(COMPANY)	(COMPANY)	(COMPANY)		(COMPANY)	
VIA:		RECEIVED BY 1.	RECEIVED BY 2.	RECEIVED BY (LABORATORY) 3.					
SPECIAL INSTRUCTIONS/COMMENTS: <u>Normal TAT.</u>				(SIGNATURE) <u>[Signature]</u>	(TIME) <u>1015</u>	(SIGNATURE) <u>[Signature]</u>	(TIME)	(SIGNATURE) <u>[Signature]</u>	(TIME)
				(PRINTED NAME) <u>[Name]</u>	(DATE)	(PRINTED NAME) <u>ERIC TAM</u>	(DATE) <u>4/10/01</u>	(PRINTED NAME) <u>CHROMALAB, INC</u>	(DATE)
				(COMPANY)	(COMPANY)	(COMPANY)		(LAB)	