

STD 4075

7/23/97  
Talked to Al Smith  
re: Case closure  
FP?

# ALISTO ENGINEERING GROUP

## FACSIMILE TRANSMISSION SHEET

DATE: 7/7/97 7/29/97 Talked to Brady Nagle re: site visit - Case closure FP? or IFS (in download)

TO: Susan Hugo

COMPANY: ACHA

FAX NO: 337-9335

FROM: Brady Nagle

NUMBER OF PAGES INCLUDING THIS SHEET: 2

MESSAGE: As we discussed, map for 3505 Broadway.  
Talk to you Wednesday.

Please call if you do not receive this facsimile in full.

**ALISTO ENGINEERING GROUP**  
 1575 Treat Boulevard, Suite 201  
 Walnut Creek, California 94598  
 TEL: 510-295-1650 FAX: 510-295-1823

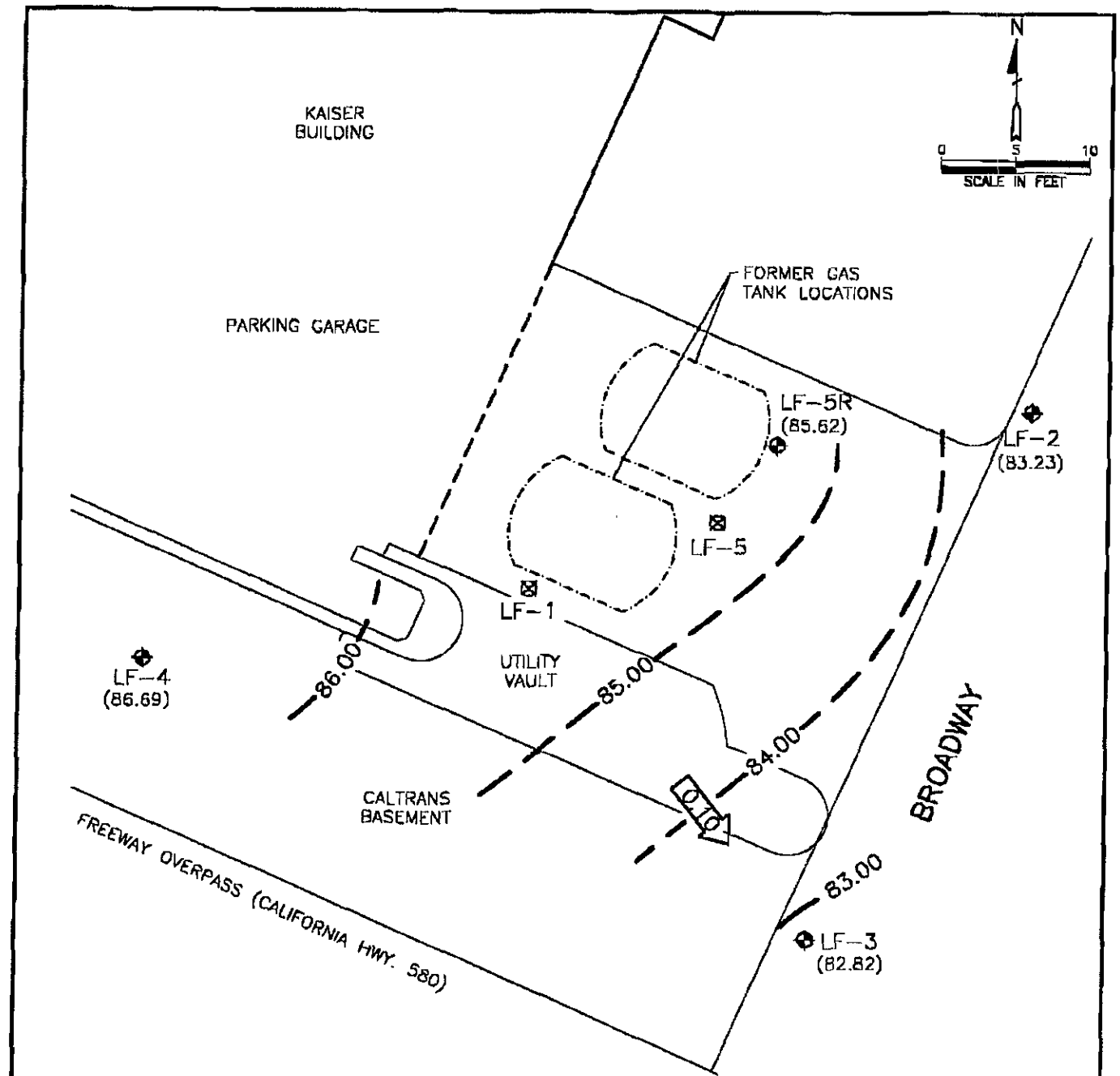

**LEGEND**

- ◆ GROUNDWATER MONITORING WELL
- ⊠ DESTROYED WELL
- (82.82) GROUNDWATER ELEVATION IN FEET ABOVE MEAN SEA LEVEL
- 83.00 — GROUNDWATER ELEVATION CONTOUR IN FEET ABOVE MEAN SEA LEVEL (CONTOUR INTERVAL—1.00 FOOT)
- ← 0.10 → CALCULATED GROUNDWATER GRADIENT DIRECTION AND MAGNITUDE IN FOOT PER FOOT

**FIGURE 2**

**POTENTIOMETRIC GROUNDWATER ELEVATION CONTOUR MAP**

**DECEMBER 13, 1995**

**KAISER MOSSWOOD BUILDING  
3505 BROADWAY  
OAKLAND, CALIFORNIA**

**PROJECT NO. 10-229**



**ALISTO ENGINEERING GROUP**  
WALNUT CREEK, CALIFORNIA

10229-229-1-10-95 R/W 1-10