



91 MAR 20 PM 3:48

March 19, 1991

Ms. Pam Evans  
Alameda County Health Agency  
80 Swan Way, Room 200  
Oakland, CA 94621

Dear Ms. Evans:

Enclosed is information per our conversation this morning. The sampling information I put together was initially done to develop a work plan to submit to BAAQMD for aeration. As you can see, levels indicate very low levels of contamination and therefore do not require review by BAAQMD.

The report by Engeo contains a description of on-site work they did in conjunction with DECON. Their report contains a description of on-site sampling and screening procedures and analytical results. The report also includes 'Test Pit Logs' for both phases of excavation.

I will send you site geological information as soon as I receive it from Engeo.

If there are any problems or questions, please do not hesitate to call me at (415) 732-6444.

Sincerely,

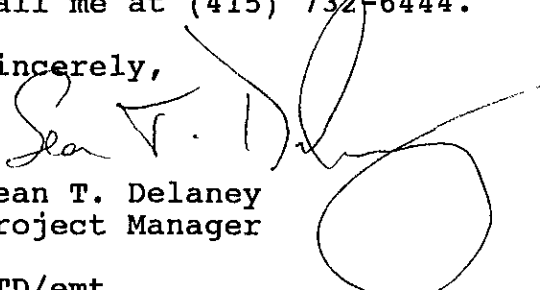
  
Sean T. Delaney  
Project Manager

STD/emt

Enclosures

PROJECT NO.		PROJECT NAME					PARAMETERS										INDUSTRIAL HYGIENE SAMPLE		Y				
453		Tahoe Lake Truck																	N				
SAMPLERS: (Signature)					(Printed)					NO. OF CONTAINERS											REMARKS		
Sean T. DeLeon					Sean T. DeLeon																		
FIELD SAMPLE NUMBER	DATE	TIME	COMP.	GRAB	STATION LOCATION																		
453-305-01	3/5/91	0935	✓		Tahoe Lake Truck					✓											Regular TAT		
453-305-02	3/11	11	✓							✓													
453-305-03	11	11	✓							✓													
453-305-04	11	11	✓							✓													
453-305-05	11	11	✓							✓													
Relinquished by: (Signature)			Date / Time		Received by: (Signature)			Date / Time			Received by: (Signature)			Date / Time			Received by: (Signature)						
Sean T. DeLeon			3/5/91 0930		Sean T. DeLeon			3/5/91 1040			Tom McCarthy												
(Printed name) & Company					(Printed name) & Company			(Printed name) & Company			(Printed name) & Company			(Printed name) & Company			(Printed name) & Company						
Sean T. DeLeon					T-MCARTHY																		
Relinquished by: (Signature)			Date / Time		Received for Laboratory by: (Signature)			Date / Time		Remarks													
Tom McCarthy			3/5/91 1040		Tom McCarthy			3/5/91 1040		None													
(Printed name) & Company					(Printed name) & Company																		
Tom McCarthy					Superior Lab SF																		

## SUPERIOR ANALYTICAL LABORATORY, INC.

1555 BURKE, UNIT I • SAN FRANCISCO, CA 94124 • PHONE (415) 647-2081

DOHS #1332

## C E R T I F I C A T E   O F   A N A L Y S I S

LABORATORY NO.: 53265  
 CLIENT: Decon Environmental Services  
 CLIENT JOB NO.: 453

DATE RECEIVED: 03/05/91  
 DATE REPORTED: 03/12/91

ANALYSIS FOR TOTAL PERTROLEUM HYDROCARBONS  
 by Modified EPA SW-846 Method 8015

LAB #	Sample Identification	Concentration (mg/kg) Gasoline Range
-----	-----	-----
1	453-305-01	ND<1
2	453-305-02	3
3	453-305-03	ND<1
4	453-305-04	ND<1
5	453-305-05	ND<1

mg/kg - parts per million (ppm)

Minimum Detection Limit for Gasoline in Soil: 1mg/kg

QAQC Summary:

Daily Standard run at 2mg/L: RPD Gasoline = <15%  
 MS/MSD Average Recovery = 96%: Duplicate RPD = 4%

Richard Srna, Ph.D.

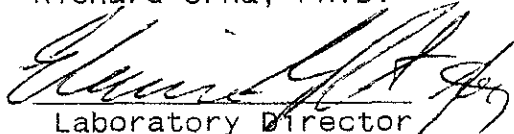
  
 Laboratory Director

OUTSTANDING QUALITY AND SERVICE

Anderson Lift + Truck 310 Bartlett Ave.  
Sample locations for determination of aeration plan

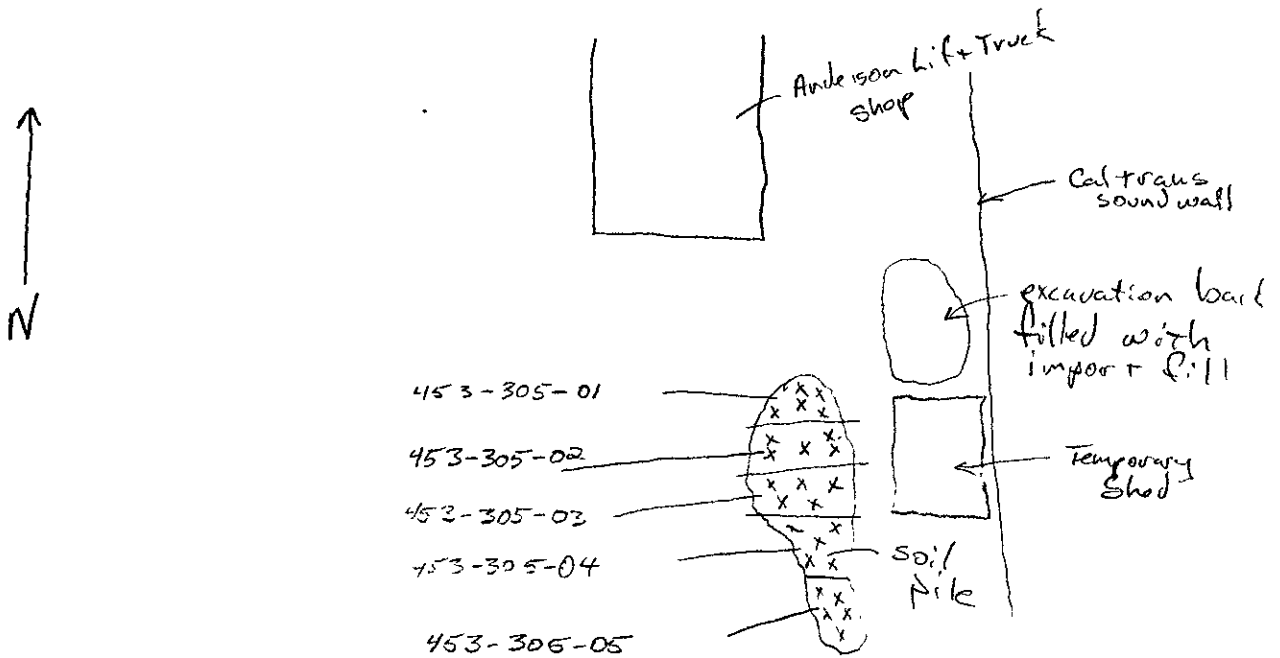

Each Sample was a composite sample collected from 5 different locations marked with x's within 5 sections separated by lines drawn across pile.