

ALL ENVIRONMENTAL, INC.

Environmental Engineering & Construction

ALCO
HAZMAT
94 MAR 10 PM 12:38

March 8, 1994

Eva Chu
Department of Environmental Health
80 Swan Way, Rm. 200
Oakland, CA 94621

RE: 5965 Dougherty Road
Dublin, CA 94568

Dear Ms. Chu:

Enclosed is a revised soil boring and well location map, for the Soil Boring and Monitoring Well Installation Work Plan dated January 13, 1994, as you requested. The map has been updated to show the location of the monitoring well on the adjoining property to the north that will be used in groundwater flow direction determination.

Please call me should you have any questions.

Sincerely,

S. J. Penshorn
Steve Penshorn
Project Engineer

cc: Mr. R.N. Stefan, La Mirada Association, 18 Sunnyside Ln.
Orinda, CA 94563

3/14/94 S Penshorn says they will verify existing well depth & screen intervals. Told Steve that those wells will need to be monitored w/ MW planned for La Mirada to verify flow direction

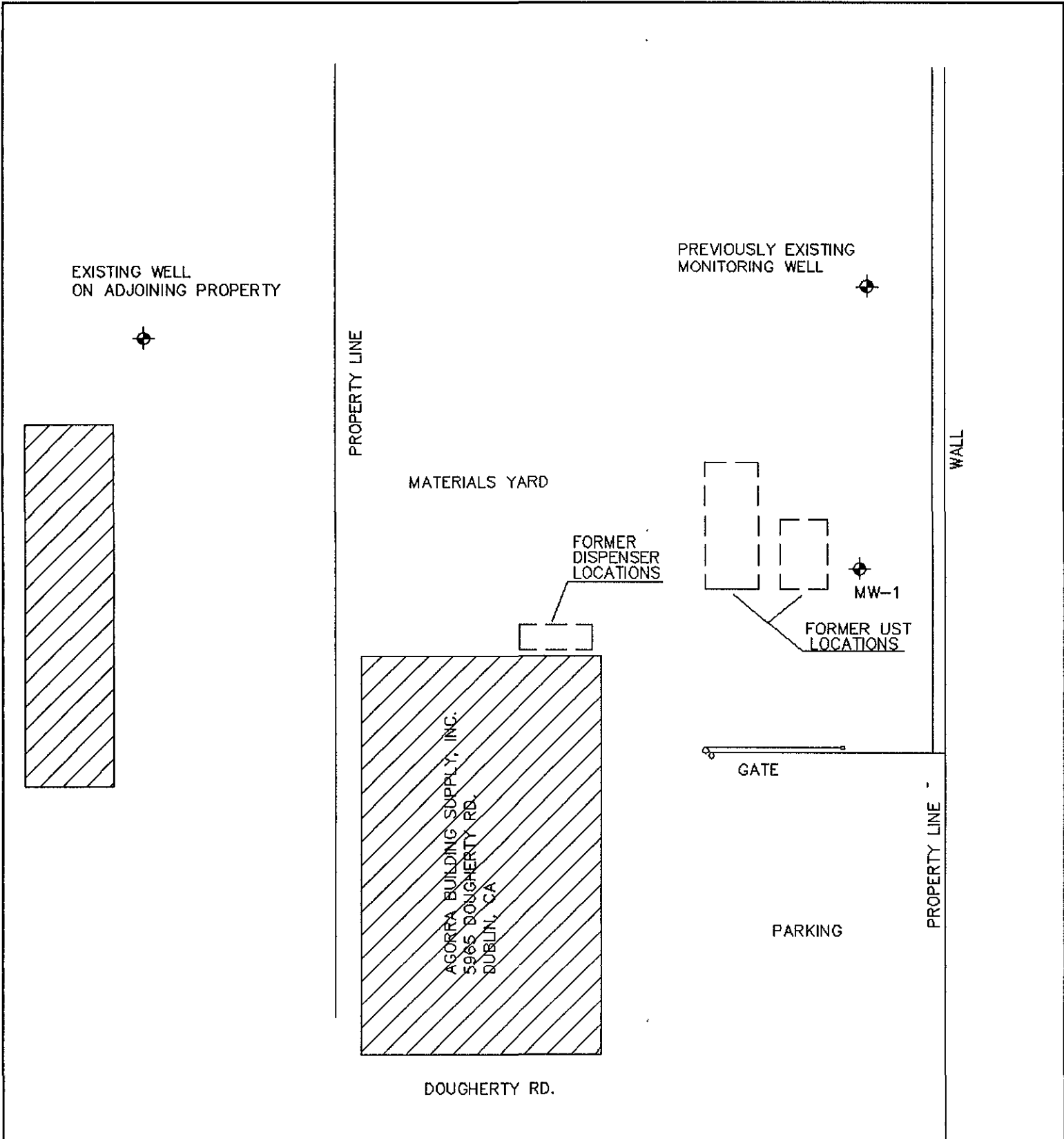

ALL ENVIRONMENTAL, INC. 2641 CROW CANYON RD, SAN RAMON		
SCALE: NOT TO SCALE	APPROVED BY:	DRAWN BY: S.P.
DATE: 3/8/94		REVISED: S.P.
BORING AND WELL LOCATION MAP		
5965 DOUGHERTY RD.		DRAWING NUMBER: FIGURE 3