

ALCO
HAZMAT

94 FEB 22 PM 2:31



Chevron

February 17, 1994

Chevron U.S.A. Products Company
2410 Camino Ramon
San Ramon, CA 94583
P.O. Box 5004
San Ramon, CA 94583-0804

Ms. Juliet Shin
Alameda County Health Care Services
Department of Environmental Health
80 Swan Way, Room 200
Oakland, CA 94621

Marketing Department
Phone 510 842 9500

**Re: Former Chevron Service Station #9-2384
15526 Hesperian Boulevard, San Lorenzo, CA**

Dear Ms. Shin:

Enclosed is the quarterly Groundwater Monitoring and Sampling Activities report dated January 10, 1994, prepared by our consultant Groundwater Technology, Inc. for the above referenced site. As indicated in the report, ground water samples collected were analyzed for total petroleum hydrocarbons as gasoline (TPH-G) and BTEX. Concentrations of these constituents are consistent with historical results. Depth to ground water was measured at approximately 14 feet below grade and the direction of flow is to the west.

Chevron will continue to monitor and sample this site for an additional three quarters. At that time we will evaluate next appropriate actions. A potential buyer has expressed interest in developing the site as an oil changing facility. Appropriate wells will be relocated or abandoned as necessary to allow for the development.

If you have any questions or comments, please do not hesitate to contact me at (510) 842-8134.

Sincerely,
CHEVRON U.S.A. PRODUCTS COMPANY

Mark A. Miller
Site Assessment and Remediation Engineer

Enclosure

cc: Mr. Eddy So, RWQCB - Bay Area
Ms. B.C. Owen

Mr. Alan Gordon
Gordon Real Estate
524 30th Avenue
San Francisco, CA 94121

Dr. Beryl Bearint
19135 S.E. Coral Reef Lane
Jupiter, FL 33458-1051

File: 9-2384 QM5

JAN 13 '94 J.M.M.

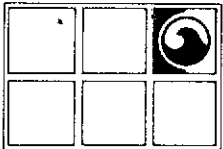

GROUNDWATER TECHNOLOGY, INC.

4057 Port Chicago Highway, Concord, CA 94520 (415) 671-2387

FAX: (415) 685-9148

January 10, 1994

Project No. 020204094

Mr. Mark Miller
Chevron U.S.A. Products Company
2410 Camino Ramon
San Ramon, CA 94583-0804

SUBJECT: *Groundwater Monitoring and Sampling Activities*
Chevron Service Station No. 9-2384
15526 Hesperian Boulevard, San Lorenzo, California

Dear Mr. Miller:

Groundwater Technology, Inc. presents the attached groundwater monitoring and sampling data collected on December 2, 1993. The six groundwater monitoring wells at this site were gauged to measure depth to groundwater (DTW) and to check for the presence of separate-phase hydrocarbons. Separate-phase hydrocarbons were not detected in the monitoring wells. A potentiometric surface map (Figure 1) and a summary of groundwater monitoring data (Table 1) are presented in Attachments 1 and 2, respectively. After the DTW was measured, the monitoring wells were purged and sampled. The groundwater samples were analyzed for benzene, toluene, ethylbenzene, and xylenes and for total petroleum hydrocarbons-as-gasoline. Results of the chemical analyses are summarized in Table 1. The laboratory report and chain-of-custody record are included in Attachment 3. Monitoring-well purge water was removed by Groundwater Technology and transported to the Chevron Terminal in Richmond, California, for recycling.

Groundwater Technology is pleased to assist Chevron on this project. If you have any questions or comments, please call our Concord office at (510) 671-2387.

Sincerely,
Groundwater Technology, Inc.
Written/Submitted by

Groundwater Technology, Inc.
Reviewed/Approved by



Tim Watchers
Project Geologist



Michael C. Blundell
Registered Geologist
No. 5146

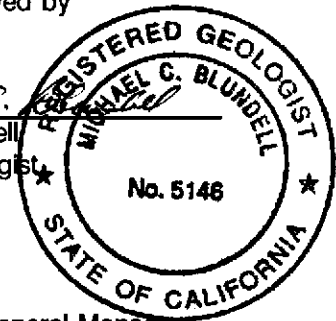

PR 

For:
Wendell W. Lattz
Vice President, General Manager
West Region

Attachment 1 Figure
Attachment 2 Table
Attachment 3 Laboratory Report

4094R033.020

ATTACHMENT 1

Figure

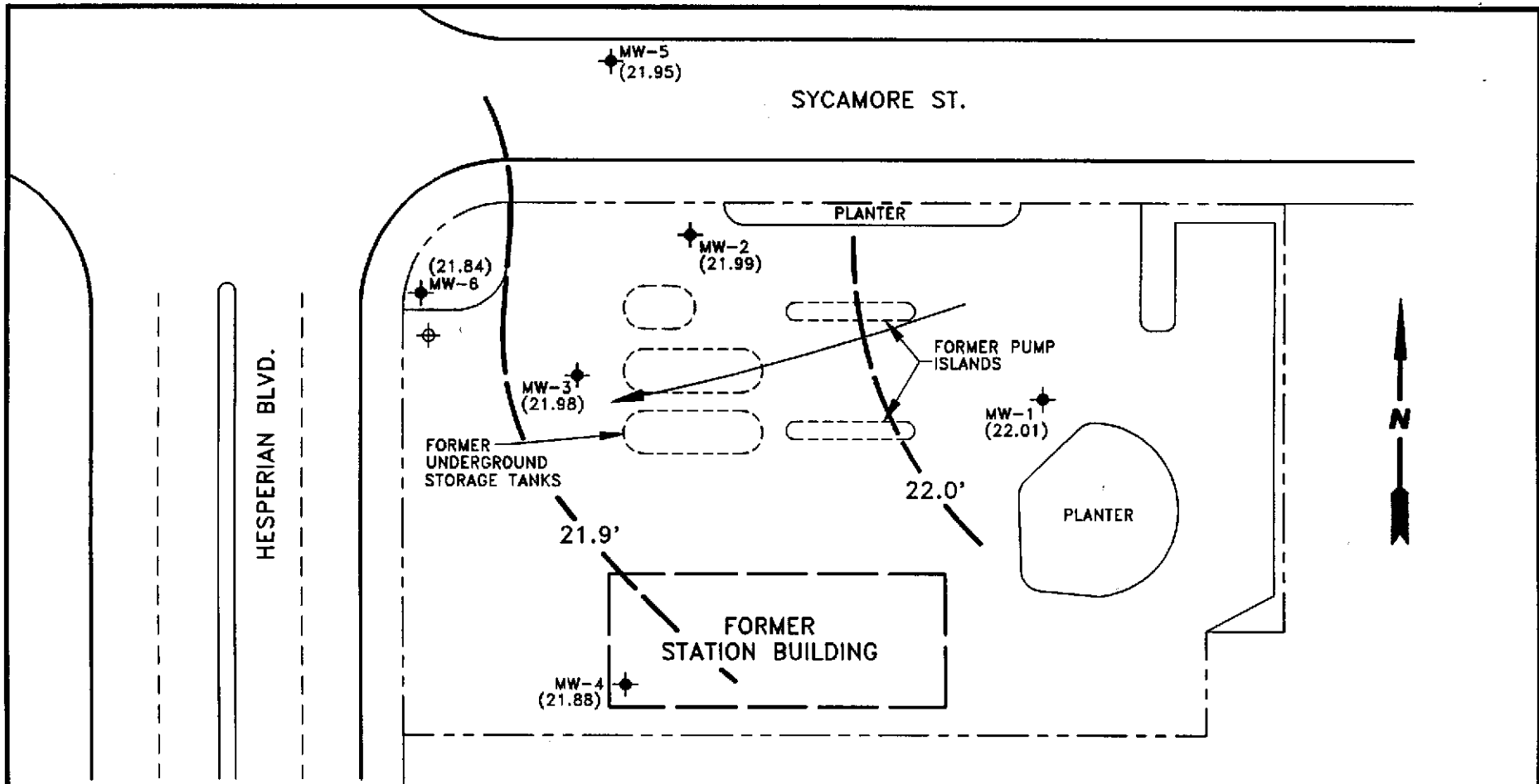

LEGEND

- ◆ MONITORING WELL
- ⊕ ABANDONED MONITORING WELL
- () POTENTIOMETRIC SURFACE ELEVATION (FEET ABOVE MEAN SEA LEVEL)
- POTENTIOMETRIC SURFACE CONTOUR
- ← GROUNDWATER FLOW DIRECTION



GROUNDWATER TECHNOLOGY
 4057 PORT CHICAGO HWY
 CONCORD, CA 94520
 (510) 671-2387

POTENTIOMETRIC SURFACE MAP
 (12/2/93)

CLIENT: CHEVRON U.S.A. PRODUCTS CO. SERVICE STATION No. 9-2384			LOCATION: 15526 HESPERIAN BLVD. SAN LORENZO, CALIFORNIA		REV. NO.: 1	DATE: 1/3/94
PM <i>[Signature]</i>	PE/RG <i>[Signature]</i>	DESIGNED TW	DETAILED ML	ACAD FILE: PSMD293/SP993	PROJECT NO.: 020204376	FIGURE: 1

ATTACHMENT 2

Table

TABLE 1
HISTORICAL GROUNDWATER ANALYTICAL RESULTS AND MONITORING DATA
Chevron Service Station No. 9-2384
15526 Hesperian Boulevard, San Lorenzo, California

Well ID/ Elevation	Date	TPH-as- Gasoline	Benzene	Toluene	Ethyl- benzene	Xylenes	DTW (ft)	SPT (ft)	GWE (ft)
MW-1 35.64	06/04/92	<50	<0.5	<0.5	<0.5	<0.5	13.12	0.00	22.52
	07/30/92	—	—	—	—	—	13.82	0.00	21.82
	08/25/92	—	—	—	—	—	14.20	0.00	21.44
	09/23/92	<50	<0.5	<0.5	<0.5	<0.5	14.59	0.00	21.05
	12/29/92	<50	<0.5	<0.5	<0.5	<0.5	14.28	0.00	21.36
35.65	03/19/93	<50	<0.5	<0.5	<0.5	<1.5	10.90	0.00	24.74
	07/02/93	<50	<0.5	<0.5	<0.5	<1.5	11.41	0.00	24.24
	09/22/93	<50	0.9	0.9	<0.5	<1.5	12.77	0.00	22.88
	10/01/93	—	—	—	—	—	12.93	0.00	22.72
	12/02/93	<50	<0.5	<0.5	<0.5	<0.5	13.55	0.00	22.01
MW-2 35.85	06/04/92	6,700	910	17	210	30	13.48	0.00	22.73
	07/30/92	—	—	—	—	—	14.17	0.00	21.68
	08/25/92	—	—	—	—	—	14.56	0.00	21.29
	09/23/92	1,500	110	1.2	81	<0.5	14.95	0.00	20.90
	12/29/92	1,200	51	1.1	27	<0.5	14.61	0.00	21.24
35.86	03/19/93	750	37	1.0	34	1.6	11.24	0.00	24.61
	07/02/93	2,100	45	1.4	87	4.8	11.76	0.00	24.10
	09/22/93	880	23	2.8	38	<1.5	13.12	0.00	22.74
	10/01/93	—	—	—	—	—	13.30	0.00	22.56
	12/02/93	340	3.2	<0.5	8.9	<0.5	13.87	0.00	21.99
MW-3 35.42	06/04/92	460	12	0.8	5.8	14	13.12	0.00	22.30
	07/30/92	—	—	—	—	—	13.81	0.00	21.61
	08/25/92	—	—	—	—	—	14.20	0.00	21.22
	09/23/92	1,100	62	1.5	110	4.0	14.58	0.00	20.84
	12/29/92	450	21	0.7	12	3.0	14.22	0.00	21.20
35.43	03/19/93	1,200	67	1.3	96	5.5	10.87	0.00	24.55
	07/02/93	610	73	0.5	42	<1.5	11.37	0.00	24.06
	09/22/93	400	<0.5	0.6	2.7	<1.5	12.71	0.00	22.72
	10/04/93	—	—	—	—	—	12.88	0.00	22.55
	12/02/93	140	<0.5	<0.5	<0.5	4.2	13.45	0.00	21.98

TABLE 1
HISTORICAL GROUNDWATER ANALYTICAL RESULTS AND MONITORING DATA
Chevron Service Station No. 9-2384
15526 Hesperian Boulevard, San Lorenzo, California

Well ID/ Elevation	Date	TPH-as- Gasoline	Benzene	Toluene	Ethyl- benzene	Xylenes	DTW (ft)	SPT (ft)	GWE (ft)
MW-4 35.73	07/02/93	80	<0.5	0.6	<0.5	<1.5	11.77	0.00	23.96
	09/22/93	—	—	—	—	—	—	—	—
	10/01/93	<50	<0.5	<0.5	<0.5	<0.5	13.12	0.00	22.61
	12/02/93	<50	<0.5	<0.5	<0.5	<0.5	13.85	0.00	21.88
MW-5 35.50	07/02/93	<50	<0.5	<0.5	<0.5	<1.5	11.42	0.00	24.08
	09/22/93	—	—	—	—	—	—	—	—
	10/01/93	—	—	—	—	—	—	—	—
	12/02/93	<50	<0.5	<0.5	<0.5	<0.5	13.55	0.00	21.95
MW-6 36.01	07/02/93	14,000	330	28	980	580	12.07	0.00	23.94
	09/22/93	—	—	—	—	—	—	—	—
	10/01/93	<50	<0.5	<0.5	<0.5	<0.5	12.71	0.00	23.30
	12/02/93	3,100	100	<5	430	<5	14.17	0.00	21.84
TB-LB	06/04/92	<50	<0.5	<0.5	<0.5	<0.5	—	—	—
	09/23/92	<50	<0.5	<0.5	<0.5	<0.5	—	—	—
	12/29/92	<50	<0.5	<0.5	<0.5	<0.5	—	—	—
	03/19/93	<50	<0.5	<0.5	<0.5	<1.5	—	—	—
	07/02/93	<50	<0.5	<0.5	<0.5	<1.5	—	—	—
	09/22/93	<50	<0.5	<0.5	<0.5	<1.5	—	—	—
	10/01/93	<50	<0.5	<0.5	<0.5	<0.5	—	—	—
	12/02/93	<50	<0.5	<0.5	<0.5	<0.5	—	—	—

All elevations are given as feet above mean sea level.
Concentrations shown in parts per billion.

- TPH = Total petroleum hydrocarbons
- DTW = Depth to water
- SPT = Separate-phase hydrocarbon thickness
- GWE = Groundwater elevation in feet above mean sea level
- = Not applicable, not sampled, not measured

ATTACHMENT 3

Laboratory Report





Superior Precision Analytical, Inc.

825 Arnold Drive, Suite 114 • Martinez, California 94553 • (510) 229-1512 / fax (510) 229-1526

GROUNDWATER TECHNOLOGY, INC.
Attn: TIM WATCHERS

Project 9-2384
Reported 12/10/93

TOTAL PETROLEUM HYDROCARBONS

Lab #	Sample Identification	Sampled	Analyzed Matrix
30110- 1	TB-LB	12/02/93	12/09/93 Water
30110- 2	RBMW5	12/02/93	12/09/93 Water
30110- 3	MW5	12/02/93	12/10/93 Water
30110- 5	MW4	12/02/93	12/09/93 Water
30110- 7	MW1	12/02/93	12/10/93 Water
30110- 9	MW3	12/02/93	12/09/93 Water
30110-11	MW2	12/02/93	12/09/93 Water
30110-13	MW6	12/02/93	12/09/93 Water

RESULTS OF ANALYSIS

Laboratory Number: 30110- 1 30110- 2 30110- 3 30110- 5 30110- 7

Gasoline:	ND<50	ND<50	ND<50	ND<50	ND<50
Benzene:	ND<0.5	ND<0.5	ND<0.5	ND<0.5	ND<0.5
Toluene:	ND<0.5	ND<0.5	ND<0.5	ND<0.5	ND<0.5
Ethyl Benzene:	ND<0.5	ND<0.5	ND<0.5	ND<0.5	ND<0.5
Total Xylenes:	ND<0.5	ND<0.5	ND<0.5	ND<0.5	ND<0.5

Concentration: ug/L ug/L ug/L ug/L ug/L

Laboratory Number: 30110- 9 30110-11 30110-13

Gasoline:	140	340	3100
Benzene:	ND<0.5	3.2	100
Toluene:	ND<0.5	ND<0.5	ND<5
Ethyl Benzene:	ND<0.5	8.9	430
Total Xylenes:	4.2	ND<0.5	ND<5

Concentration: ug/L ug/L ug/L



Superior Precision Analytical, Inc.

825 Arnold Drive, Suite 114 • Martinez, California 94553 • (510) 229-1512 / fax (510) 229-1526

C E R T I F I C A T E O F A N A L Y S I S

ANALYSIS FOR TOTAL PETROLEUM HYDROCARBONS

Page 2 of 2
QA/QC INFORMATION
SET: 30110

NA = ANALYSIS NOT REQUESTED
ND = ANALYSIS NOT DETECTED ABOVE QUANTITATION LIMIT
ug/L = parts per billion (ppb)

OIL AND GREASE ANALYSIS By Standard Methods Method 5520F:
Minimum Detection Limit in Water: 5000ug/L

Modified EPA SW-846 Method 8015 for Extractable Hydrocarbons:
Minimum Quantitation Limit for Diesel in Water: 50ug/L

EPA SW-846 Method 8015/5030 Total Purgable Petroleum Hydrocarbons:
Minimum Quantitation Limit for Gasoline in Water: 50ug/L

EPA SW-846 Method 8020/BTXE
Minimum Quantitation Limit in Water: 0.5ug/L

ANALYTE	MS/MSD RECOVERY	RPD	CONTROL LIMIT
Gasoline:	97/90	7%	70-130
Benzene:	90/88	2%	70-130
Toluene:	89/88	1%	70-130
Ethyl Benzene:	94/94	0%	70-130
Total Xylenes:	103/104	1%	70-130

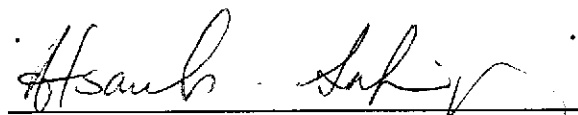
Senior Chemist

