



**Chevron U.S.A. Products Company**

2410 Camino Ramon, San Ramon, California • Phone (510) 842-9500  
Mail Address: P.O. Box 5004, San Ramon, CA 94583-0804

92 NOV 17 10:56  
November 17, 1992

Ms. Juliet Shin  
Alameda County Health Care Services  
Department of Environmental Health  
80 Swan Way, Room 200  
Oakland, CA 94621

**Re: Former Chevron Service Station #9-2384  
15526 Hesperian Boulevard, San Lorenzo, CA**

Dear Ms. Shin:

Enclosed we are forwarding the Ground Water Monitoring and Sampling Activities Report dated October 26, 1992, prepared by our consultant Groundwater Technology, Inc. (GTI) for the above referenced site. As indicated in the report, ground water samples collected were analyzed for total petroleum hydrocarbons as gasoline and benzene. Benzene was detected in monitor wells MW-2 and MW-3 only at concentrations of 110, and 62 ppb, respectively. Depth to groundwater was measured at approximately 14.5 ft. to 15.0 ft. below grade and direction of flow is to the west.

Depth to ground water measurements were taken each month for the past three (3) months, confirming the direction of ground water flow. Depth to ground water measurements will continue to be taken on a quarterly basis hereafter.

Chevron has received your letter of October 8, 1992, regarding comments to the Environmental Assessment Report dated July 16, 1992, prepared by GTI. All contaminated soils at the site were excavated, aerated, and used as backfill as documented in the Blaine Tech. report dated December 13, 1992. The soil sample from the installation of monitor well MW-3 containing 400 ppm TPH-G was taken from 14 feet below grade. Depth to ground water has varied from approximately 13 to 14.5 feet below grade since June 4, 1992. This indicates that contamination exists in the ground water which has smeared across the capillary zone, therefore this will be addressed as a ground water issue.

Chevron will continue to monitor and sample all wells on a quarterly basis. We will instruct our consultant to permit and install additional ground water monitor wells to delineate the extent of the hydrocarbon contamination in the subsurface and ground water. A work plan will be prepared proposing the additional assessment work and forwarded to your office for your review and formal concurrence.

If you have any questions or comments, please do not hesitate to contact me at (510) 842-8134.

Very truly yours,  
CHEVRON U.S.A. PRODUCTS COMPANY

Mark A. Miller  
Site Assessment and Remediation Engineer

Enclosure

cc: Mr. Eddy So, RWQCB-Bay Area  
Ms. B.C. Owen  
File (9-2384 QM1)

Mr. Gary Allen  
Century 21 Korpi & Associates  
15200 Hesperian Blvd.  
San Leandro, CA 94570

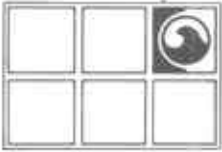

# GROUNDWATER TECHNOLOGY, INC.

4057 Port Chicago Highway, Concord, CA 94520 (415) 671-2387

FAX: (415) 685-9148

October 26, 1992

Project No. 020203215

NOV 10 '92 JST

Mr. Mark Miller  
Chevron U.S.A. Products Company, Inc.  
P.O. Box 5004  
San Ramon, CA 94583-0804

**SUBJECT: GROUNDWATER MONITORING AND SAMPLING ACTIVITIES  
CHEVRON SERVICE STATION NO. 9-2384  
15526 HESPERIAN BLVD, SAN LORENZO, CALIFORNIA**

Dear Mr. Miller:

Groundwater Technology, Inc. presents the attached groundwater monitoring and sampling data collected on September 23, 1992. The three groundwater monitoring wells at this site were gauged to determine depth to groundwater (DTW) and to check for the presence of separate-phase hydrocarbons. A potentiometric surface map (Figure 1) and a summary of groundwater monitoring data (Table 1) are presented in Attachments A and B, respectively. After measuring the DTW, each monitoring well was purged and sampled. The groundwater samples were analyzed for benzene, toluene, ethylbenzene, xylenes (BTEX), and total petroleum hydrocarbons (TPH)-as-gasoline. Results of the chemical analyses are summarized in Table 1. Laboratory report and chain-of-custody record are included in Attachment C. Monitoring well purge water was removed by Groundwater Technology and transported to the Chevron terminal in Richmond, California for recycling.

Groundwater Technology, Inc. is pleased to assist Chevron on this project. If you have any questions or comments please call our Concord office at (510) 671-2387.

Sincerely,  
GROUNDWATER TECHNOLOGY, INC.

Sandra L. Lindsey  
Project Manager

David R. Kleesattel  
Registered Geologist  
No. 5136

Attachments: Attachment A - Figure 1  
Attachment B - Table 1  
Attachment C - Laboratory Report

LR3215A1.NM

For:  
John Gaines, V.P.  
General Manager  
West Region



**ATTACHMENT A**

**FIGURE**

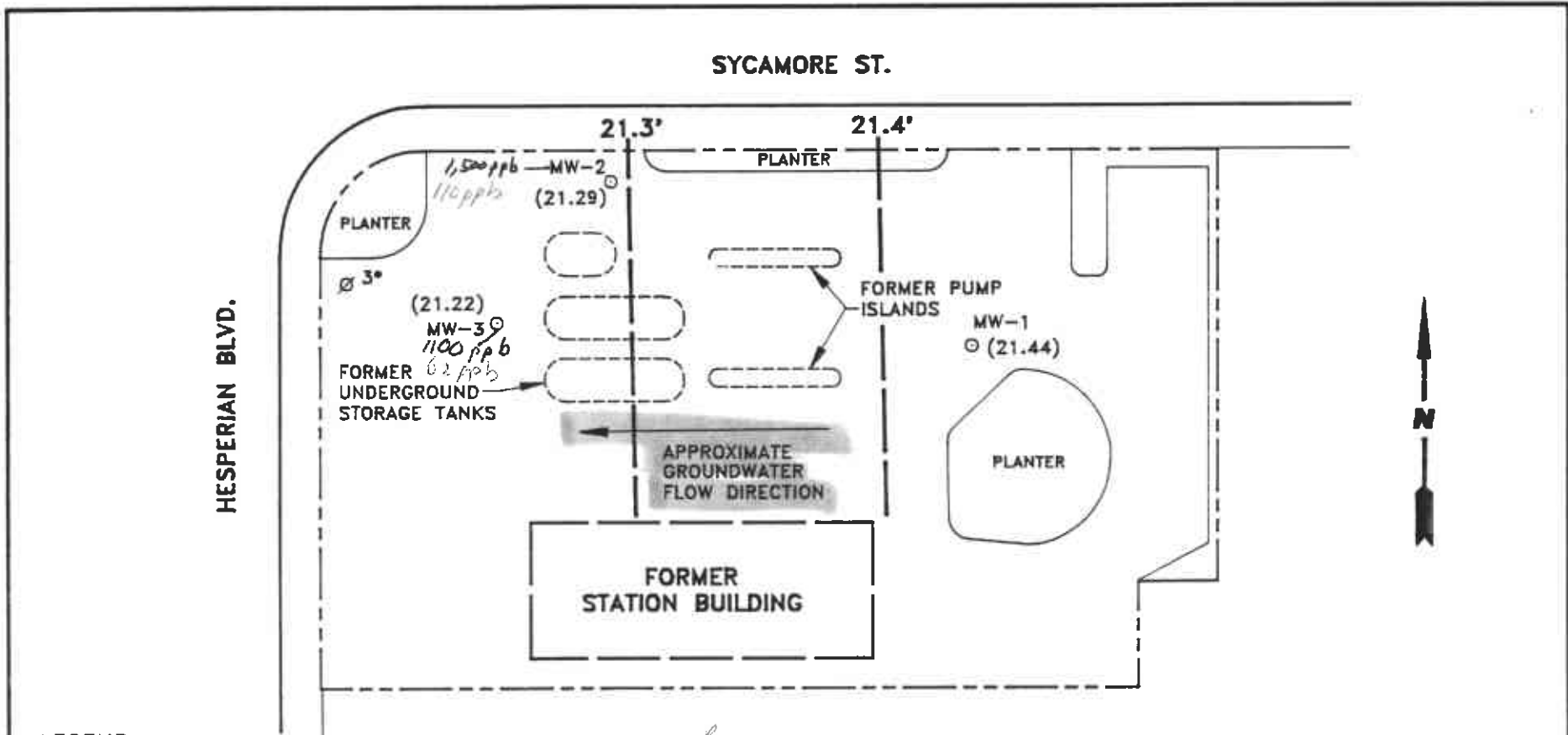

**LEGEND**

- MONITORING WELL
- ∅ 3" ABANDONED MONITORING WELL (FORMER LOCATION OF MW-3)
- ( ) POTENTIOMETRIC SURFACE ELEVATION
- POTENTIOMETRIC SURFACE CONTOUR

*- benzene conc.*  
*- TPH conc.*

				<b>GROUNDWATER TECHNOLOGY</b> 4957 PORT CHICAGO HWY CONCORD, CA 94520 (510) 671-2387		<b>POTENTIOMETRIC SURFACE MAP</b> <b>(8/25/92)</b>			
<b>CLIENT:</b> CHEVRON U.S.A. PRODUCTS CO. SERVICE STATION No. 9-2384				<b>LOCATION:</b> 15526 HESPERIAN BLVD. SAN LORENZO, CALIFORNIA		<b>REV. NO.:</b> 0	<b>DATE:</b> 10/23/92		
<b>PM</b> <i>Jaw</i>	<b>PE/RG</b> <i>DRK</i>	<b>DESIGNED</b> TW	<b>DETAILED</b> ML	<b>ACAD FILE:</b> PSM82592/SP692		<b>PROJECT NO.:</b> 020202746		<b>FIGURE:</b> 1	

**ATTACHMENT B**

**TABLE**

**TABLE 1**  
**HISTORICAL GROUNDWATER ANALYTICAL RESULTS AND MONITORING DATA**  
**CHEVRON SERVICE STATION NO. 9-2384**  
**15526 HESPERIAN BLVD, SAN LORENZO, CALIFORNIA**

WELL ID/ ELEVATION	DATE	TPH-AS- GASOLINE	BENZENE	TOLUENE	ETHYL- BENZENE	XYLENES	DTW (ft.)	SPT (ft.)	GWE (ft.)
MW-1 35.64	06/04/92	<50	<0.5	<0.5	<0.5	<0.5	13.12	0.0	22.52
	07/30/92	—	—	—	—	—	13.82	0.0	21.82
	08/25/92	—	—	—	—	—	14.20	0.0	21.44
	09/23/92	<50	<0.5	<0.5	<0.5	<0.5	14.59	0.0	21.05
MW-2 35.85	06/04/92	0.700	12	17	210	30	13.48	0.0	22.73
	07/30/92	—	—	—	—	—	14.17	0.0	21.68
	08/25/92	—	—	—	—	—	14.56	0.0	21.29
	09/23/92	—	—	1.2	81	<0.5	14.95	0.0	20.90
MW-3 35.42	06/04/92	—	12	0.8	5.8	14	13.12	0.0	22.30
	07/30/92	—	—	—	—	—	13.81	0.0	21.61
	08/25/92	—	—	—	—	—	14.20	0.0	21.22
	09/23/92	—	62	1.5	110	4.0	14.58	0.0	20.84
TRIP BLANK	06/04/92	<50	<0.5	<0.5	<0.5	<0.5	—	—	—
	09/23/92	<50	<0.5	<0.5	<0.5	<0.5	—	—	—

— All elevations are given as feet above mean sea level.  
 Concentrations shown in parts per billion.

- DTW = Depth to water
- SPT = Separate-phase hydrocarbon thickness
- GWE = Groundwater elevation in feet above mean sea level
- = Not applicable, not sampled, not measured

**ATTACHMENT C**  
**LABORATORY REPORT**





# Superior Precision Analytical, Inc.

1555 Burke, Unit I ▪ San Francisco, California 94124 ▪ (415) 647-2081 / fax (415) 821-7123

Groundwater Technology Inc.  
Attn: Sandra Lindsey

Project 020202746  
Reported 09/30/92

## TOTAL PETROLEUM HYDROCARBONS

Lab #	Sample Identification	Sampled	Analyzed Matrix
13513- 1	TB-LB	09/23/92	09/29/92 Water
13513- 2	RBMW1	09/23/92	09/28/92 Water
13513- 3	MW1	09/23/92	09/28/92 Water
13513- 5	MW3	09/23/92	09/28/92 Water
13513- 7	MW2	09/23/92	09/28/92 Water

## RESULTS OF ANALYSIS

Laboratory Number: 13513- 1 13513- 2 13513- 3 13513- 5 13513- 7

Gasoline:	ND<50	ND<50	ND<50	1100	1500
Benzene:	ND<0.5	ND<0.5	ND<0.5	62	110
Toluene:	ND<0.5	ND<0.5	ND<0.5	1.5	1.2
Ethyl Benzene:	ND<0.5	ND<0.5	ND<0.5	110	81
Xylenes:	ND<0.5	ND<0.5	ND<0.5	4.0	ND<0.5
Concentration:	ug/L	ug/L	ug/L	ug/L	ug/L



# Superior Precision Analytical, Inc.

1555 Burke, Unit I • San Francisco, California 94124 • (415) 647-2081 / fax (415) 821-7123

## C E R T I F I C A T E   O F   A N A L Y S I S

### ANALYSIS FOR TOTAL PETROLEUM HYDROCARBONS

Page 2 of 2  
QA/QC INFORMATION  
SET: 13513

NA = ANALYSIS NOT REQUESTED  
ND = ANALYSIS NOT DETECTED ABOVE QUANTITATION LIMIT  
ug/L = parts per billion (ppb)

OIL AND GREASE ANALYSIS By Standard Methods Method 5520F:  
Minimum Detection Limit in Water: 5000ug/L

Modified EPA SW-846 Method 8015 for Extractable Hydrocarbons:  
Minimum Quantitation Limit for Diesel in Water: 50ug/L

EPA SW-846 Method 8015/5030 Total Purgable Petroleum Hydrocarbons:  
Minimum Quantitation Limit for Gasoline in Water: 50ug/L

EPA SW-846 Method 8020/BTXE  
Minimum Quantitation Limit in Water: 0.5ug/L

ANALYTE	MS/MSD RECOVERY	RPD	CONTROL LIMIT
Gasoline:	88/83	6%	76-111
Benzene:	95/102	7%	78-110
Toluene:	94/94	0%	78-111
Ethyl Benzene:	93/97	4%	78-118
Xylenes:	93/93	0%	73-113

Richard Srna Ph.D.  
*[Signature]*  
Laboratory Director

omw  
10/1/92

Fax copy of Lab Report and COC to Chevron Contact:  Yes  No 15513

Chain-of-Custody-Record

Chevron U.S.A. Inc. P.O. BOX 5004 San Ramon, CA 94583 FAX (415)842-9591	Chevron Facility Number: <u>9-2384</u>	Chevron Contact (Name): <u>Mark Miller</u>
	Facility Address: <u>15526 Hesperian Blvd. San Leandro</u>	(Phone): _____
	Consultant Project Number: <u>020202746 325</u>	Laboratory Name: <u>Superior Analytical</u>
	Consultant Name: <u>Groundwater Tech Inc</u>	Laboratory Release Number: <u>5832660</u>
Address: <u>4057 Port Chicago Highway Concord CA</u>	Samples Collected by (Name): <u>Hector Merino</u>	Collection Date: <u>9-23-92</u>
Project Contact (Name): <u>Sandra Lindsay</u>	Signature:	
(Phone) <u>671-2387</u> (Fax Number) <u>685-9148</u>		

Sample Number	Lab Sample Number	Number of Containers	Matrix S = Soil W = Water A = Air C = Charcoal	Type G = Grab C = Composite D = Discrete	Time	Sample Preservation	Iced (Yes or No)	Analytes To Be Performed											Remarks							
								BTEX + TPH GAS (8020 + 8015)	TPH Diesel (8015)	Oil and Grease (5520)	Purgeable Halocarbons (8010)	Purgeable Aromatics (8020)	Purgeable Organics (8240)	Extractable Organics (8270)	Metals Cd, Cr, Pb, Zn, Ni (ICAP or AA)											
TBLB		1	W	G		HCL	yes	X																	Analyze but do not charge for "TB-LB"	
RB MW1		1						X																		
MW1		3						X																		
RB MW3		1																								
MW3		3						X																		
RB MW2		1																								
MW2		3	X	X		X	X	X																		

Please Initial: [Signature]

Samples Stored in Ice: [Signature]

Appropriate containers: [Signature]

Samples preserved: [Signature]

VOA's without headspace: [Signature]

Comments: \_\_\_\_\_

Relinquished By (Signature):	Organization: <u>GTI</u>	Date/Time: <u>9/23/92</u>	Received By (Signature):	Organization:	Date/Time:	Turn Around Time (Circle Choice) 24 Hrs. 48 Hrs. 5 Days 10 Days <u>As Contracted</u>
Relinquished By (Signature):	Organization:	Date/Time:	Received By (Signature):	Organization:	Date/Time:	
Relinquished By (Signature):	Organization:	Date/Time:	Received For Laboratory By (Signature): <u>Brenda L. Oli</u>	Organization: <u>SAL</u>	Date/Time: <u>1500 9/23/92</u>	

COC-3.DWG/03 91/HCH