

ENVIRONMENTAL  
PROTECTION



**Chevron**

99 JAN 25 PM 3: 51

January 22, 1999

**Chevron Products Company**  
6001 Bollinger Canyon Road  
Building L, Room 1110  
PO Box 6004  
San Ramon, CA 94583-0904

**Philip R. Briggs**  
Project Manager  
Site Assessment & Remediation  
Phone 925 842-9136  
Fax 925 842-8370

Mr. Larry Seto  
Alameda County Health Care Services  
Department of Environmental Health  
1131 harbor Bay Parkway, Suite 250  
Alameda, CA 94502-6577

**Re: Former Chevron Service Station #9-0191  
900 Otis Drive  
Alameda, California**

Dear Mr. Seto:

Enclosed is the Well Destruction report, dated January 18, 1999, that was prepared by our consultant Gettler-Ryan at the above noted site. This report describes the destruction of six ground water monitoring wells, MW-2 through MW-7. Copies of the State of California Well Completion Reports, the Alameda County Public Works Agency permit and copy of encroachment permit issued by East Bay Regional park District are attached.

With the destruction of the wells, please issue a Remedial Action Completion Certification (closure letter) for this site as stated in your letter of October 16, 1998.

If you have any questions please call me at (925) 842-9136.

Sincerely,  
**CHEVRON PRODUCTS COMPANY**

A handwritten signature in cursive script that reads "Philip R. Briggs".

Philip R. Briggs  
Site Assessment and Remediation Project Manger

Enclosure

January 22, 1999  
Mr. Larry Seto  
Former Chevron Service Station #9-0191  
Page 2

Cc: Ms. Bette Owen, Chevron

Mr. Michael Dosen  
Vice President  
Harsch Envestment Corp.  
523 West Plaza  
South Shore Plaza  
Alameda, CA 94501

Mr. Steve Sorensen  
Broker Associate  
Harbor Bay Realty  
885 Island Drive  
Alameda, CA 94502

Mr. Phil Eyring  
Eyring Realty Inc.  
1901 Olympic Blvd., Suite 220  
Walnut Creek, CA 94596-5079

Mr. Steven Hill  
RWQCB-San Francisco Bay Region  
2101 Webster Street, Suite 500  
Oakland, CA 94612



# GETTLER-RYAN INC.

---

January 18, 1999

Mr. Phil Briggs  
Chevron Products Company  
P. O. Box 6004  
San Ramon, California 94583

**Subject: Well Destruction at Former Chevron Service Station #9-0191, 900 Otis Drive, Alameda, California.**

Mr. Briggs:

At the request of Chevron Products Company, Gettler-Ryan Inc. (GR) destroyed six groundwater monitoring wells at the above referenced site. The well destruction was requested by the Alameda County Health Care Services Agency (ACHCSA) in their letter to Chevron dated October 16, 1998 (attached). On December 21, 1998, GR observed Bay Area Exploration Inc. (C57 #522125) destroy wells MW-2 through MW-7. A copy of a well destruction permit #98WR530 issued by the Alameda County Public Works Agency (ACPWA) on December 16, 1998, and a copy of an encroachment permit #079E-98-09 (for wells MW-6 and MW-7) issued by the East Bay Regional Park District on December 17, 1998, are attached. Well MW-5 was destroyed under an existing encroachment permit issued by the City of Alameda prior to well installation. Locations of the former wells are shown on the Site Plan (Figure 1). Well destruction activities are summarized in Table 1. Copies of the State of California Well Completion Reports are attached.

Six 2-inch diameter wells were backfilled to the top of casing with neat cement using a tremie pipe and pump. Prior to removal of the wellhead boxes, a pressure of approximately 10 pounds per square inch was applied to the top of each well casing for approximately 2 minutes. The well boxes were removed, the upper 2 feet of casing were drilled out, and the upper 0.5-foot of the borings were backfilled with concrete (MW-4 through MW-7) or native soil (MW-2 and MW-3).

The wells have been properly abandoned as required by California Department of Water Resources' *California Well Standards* (Bulletins 74-81 and 74-90) and ACPWA guidelines. If you have questions, please call us at (925) 551-7555.

Sincerely  
Gettler-Ryan Inc.

*Barbara Sieminski*  
Barbara Sieminski  
Project Geologist  
R.G. 6676

*Stephen J. Carter*  
Stephen J. Carter  
Senior Geologist  
R.G. 5577



Attachments: Figure 1. Site Plan  
Table 1. Summary of Well Destruction Activities  
ACHCSA Well Destruction Request Letter  
Encroachment and Well Destruction Permits  
State of California Well Completion Reports

## **ATTACHMENTS**

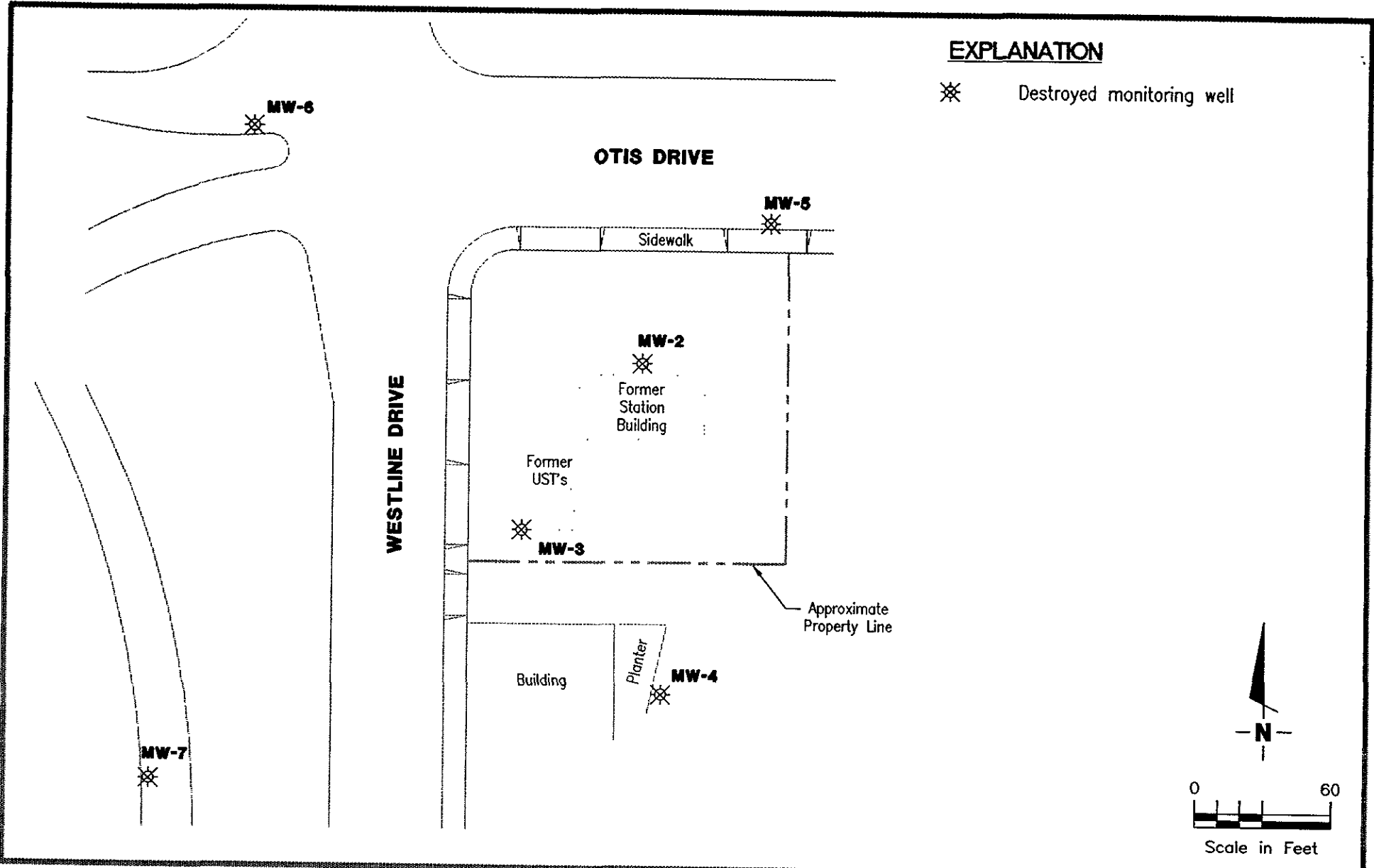

**Gettler - Ryan Inc.**  
 6747 Sierra Ct., Suite J (925) 551-7555  
 Dublin, CA 94568

**SITE PLAN**  
 Former Chevron Service Station No. 9-0191  
 900 Otis Drive  
 Alameda, California

DATE  
 January, 1999

REVISD DATE

FIGURE  
**1**

JOB NUMBER  
 346324.01

REVIEWED BY  
 [Signature]

Table 1. Summary of Well Destruction Activities - Former Chevron Service Station #9-0191, 900 Otis Drive, Alameda, California.

Well ID	Well Destruction Date	Well Diameter (inches)	Installed Well Depth (feet)	Well Depth on 12/21/98 (feet)	Depth to Water on 12/21/98 (feet)	Destruction Method
MW-2	12/21/98	2	17.0	15.2	4.60	Pressure grouted with neat cement
MW-3	12/21/98	2	15.5	13.9	2.82	Pressure grouted with neat cement
MW-4	12/21/98	2	17.0	16.9	2.90	Pressure grouted with neat cement
MW-5	12/21/98	2	17.0	16.0	2.70	Pressure grouted with neat cement
MW-6	12/21/98	2	17.0	17.0	3.50	Pressure grouted with neat cement
MW-7	12/21/98	2	17.0	15.1	2.90	Pressure grouted with neat cement

346324.01

ALAMEDA COUNTY  
HEALTH CARE SERVICES



AGENCY

DAVID J. KEARS, Agency Director

Post-it™ brand fax transmittal memo 7671		# of pages ▶ 1
To <i>Phil Briggs</i>	From <i>Larry Seto</i>	
Co. <i>Chevron</i>	Co.	
Dist.	Phone # <i>567-6774</i>	
Fax # <i>925-842-8370</i>	Fax #	

October 16, 1998

ENVIRONMENTAL HEALTH SERVICES  
ENVIRONMENTAL PROTECTION (LOP)  
1131 Harbor Bay Parkway, Suite 250  
Alameda, CA 94502-8577  
(510) 567-6700  
FAX (510) 337-9335

Mr. Phillip Briggs  
Chevron Products  
6001 Bollinger Canyon Road  
Building L, Room 1110  
P.O. 6004  
San Ramon, CA 94583-0904

#  
9-0191

RE: Chevron, 900 Otis Drive, Alameda, CA 94501

Dear Mr. Briggs:

The Alameda County Department of Environmental Health, Environmental Protection Division has recently received concurrence from the Regional Water Quality Control Board regarding this office determination that no further action is required concerning the six (6) monitoring wells reportedly removed in 1993 at the above referenced site.

Please be advised that the six groundwater monitoring wells (MW-2 to MW-7) at the site must be properly decommissioned before our agency will issue the "Remedial Action Completion Certification" (closure letter) for the subject site. A report must be submitted documenting the abandonment of the monitoring wells. Additionally, you will need to notify this office 72 hours in advance of the well abandonment field activities.

If you have any questions concerning this letter, please contact me at (510) 567-6774.

Sincerely,

Larry Seto  
Sr. Hazardous Materials Specialist

Cc: Charles Headlee, San Francisco Bay RWQCB  
Files

Post-it® Fax Note	7671	Date	<i>10-29-98</i>	# of pages ▶	1
To	<i>Charles Gurses</i>	From	<i>PHIL BRIGGS</i>		
Co./Dept.	<i>COTILLON RYAN</i>	Co.	<i>CHEVRON</i>		
Phone #		Phone #	<i>925 842-9136</i>		
Fax #	<i>916 631-1317</i>	Fax #			

CONFIRMING LETTER FROM ACHCS

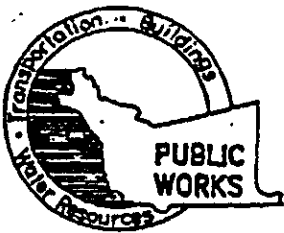

# ALAMEDA COUNTY PUBLIC WORKS AGENCY

## WATER RESOURCES SECTION

951 TURNER COURT, SUITE 300, HAYWARD, CA 94545-2651  
PHONE (510) 670-5575 ANDREAS GODFREY FAX (510) 670-5262  
(510) 670-5248 ALVIN KAN

### DRILLING PERMIT APPLICATION

#### FOR APPLICANT TO COMPLETE

#### FOR OFFICE USE

LOCATION OF PROJECT 900 Otis Drive,  
Alameda, CA  
Former Chevron SS# 9-0191

PERMIT NUMBER 98WR529  
WELL NUMBER \_\_\_\_\_  
APN \_\_\_\_\_

California Coordinates Source \_\_\_\_\_ ft. Accuracy ± \_\_\_\_\_ ft.  
CCN \_\_\_\_\_ ft. CCE \_\_\_\_\_ ft.  
APN \_\_\_\_\_

#### PERMIT CONDITIONS

Circled Permit Requirements Apply

CLIENT  
Name Chevron Products Co.  
Address P.O. Box 6004 Phone (925) 892-9136  
City San Ramon Zip 94583

#### (A) GENERAL

1. A permit application should be submitted so as to arrive at the ACPWA office five days prior to proposed starting date.
2. Submit to ACPWA within 60 days after completion of permitted work the original Department of Water Resources Water Well Drillers Report or equivalent for well projects, or drilling logs and location sketch for geotechnical projects.
3. Permit is void if project not begun within 90 days of approval date.

APPLICANT  
Name Gettler-Ryan, Inc.  
Barbara Steinfeld Fax (925) 551-7888  
Address 6747 Sierra Ct, Ste 3 Phone (925) 551-7555  
City Dublin Zip 94568

#### B. WATER SUPPLY WELLS

1. Minimum surface seal thickness is two inches of cement grout placed by tremie.
2. Minimum seal depth is 50 feet for municipal and industrial wells or 20 feet for domestic and irrigation wells unless a lesser depth is specially approved.

#### TYPE OF PROJECT

Well Construction		Geotechnical Investigation	
Cathodic Protection	<input type="checkbox"/>	General	<input type="checkbox"/>
Water Supply	<input type="checkbox"/>	Contamination	<input type="checkbox"/>
Monitoring	<input type="checkbox"/>	Well Destruction	<input checked="" type="checkbox"/>

*pressure grouting with neat cement*

#### C. GROUNDWATER MONITORING WELLS INCLUDING PIEZOMETERS

1. Minimum surface seal thickness is two inches of cement grout placed by tremie.
2. Minimum seal depth for monitoring wells is the maximum depth practicable or 20 feet.

PROPOSED WATER SUPPLY WELL USE

New Domestic	<input type="checkbox"/>	Replacement Domestic	<input type="checkbox"/>
Municipal	<input type="checkbox"/>	Irrigation	<input type="checkbox"/>
Industrial	<input type="checkbox"/>	Other _____	<input type="checkbox"/>

#### D. GEOTECHNICAL

Backfill bore hole with compacted cuttings or heavy bentonite and upper two feet with compacted material. In areas of known or suspected contamination, tremied cement grout shall be used in place of compacted cuttings.

#### DRILLING METHOD:

Mud Rotary	<input type="checkbox"/>	Air Rotary	<input type="checkbox"/>	Auger	<input type="checkbox"/>
Cable	<input type="checkbox"/>	Other	<input type="checkbox"/>		

#### E. CATHODIC

Fill hole above anode zone with concrete placed by tremie.

DRILLER'S LICENSE NO. C57-522125

#### (F) WELL DESTRUCTION

See attached.

#### WELL PROJECTS

Drill Hole Diameter	<u>N/A</u> in.	Maximum	
Casing Diameter	<u>2</u> in.	Depth	<u>17</u> ft.
Surface Seal Depth	<u>N/A</u> ft.	Number	<u>6</u> (MW-2 through MW-7)

#### G. SPECIAL CONDITIONS

#### GEOTECHNICAL PROJECTS

Number of Borings	_____	Maximum	
Hole Diameter	_____ in.	Depth	_____ ft.

ESTIMATED STARTING DATE 12/21/98  
ESTIMATED COMPLETION DATE 12/21/98

APPROVED Alvin Kan DATE 12/16/98

I hereby agree to comply with all requirements of this permit and Alameda County Ordinance No. 73-68.

APPLICANT'S SIGNATURE Barbara Steinfeld DATE 12/07/98



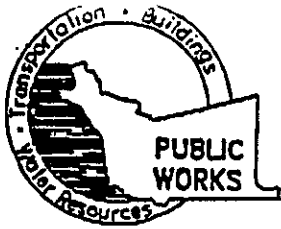

# ALAMEDA COUNTY PUBLIC WORKS AGENCY

## WATER RESOURCES SECTION

951 TURNER COURT, SUITE 300, HAYWARD, CA 94545-2651

PHONE (510) 670-5575 ANDREAS GODFREY FAX (510) 670-5262

(510) 670-5248 ALVIN KAN

---

### WATER RESOURCES SECTION GROUNDWATER PROTECTION ORDINANCE For Pressure Grouting of Monitoring Well

900 OTIS DR

ALAMEDA

PERMIT NO. 98WR529

#### Destruction Requirements:

1. Clean out all bridged or poorly compacted materials to the bottom of the well.
2. Pressure grout the casing to 2 feet below finished grade or original ground, whichever is the lower elevation.
3. Remove casing, seal and gravel pack to 2 feet below finished grade or original ground, whichever is the lower elevation.
4. After the seal has set, backfill the remaining hole with compacted material.



**EAST BAY REGIONAL PARK DISTRICT**

**ENCROACHMENT PERMIT**

**RECEIVED**

DEC 23 1998

**GETTLER-RYAN INC.**  
GENERAL CONTRACTORS

**PERMIT NO:** 079E-98-09

**PERMIT FEE:** \$100

**EBRPD FACILITY AFFECTED:** Crown Beach

**PERMITTEE:** Chevron Products Co.

**CONTACT:** Barbara Sieminski

**PHONE:** 925 551-7444, ext.188

**FAX:** 925 551-7888

**E-MAIL:** bsieminski@grinc.com

**CONDITIONS:**

1. This permit is valid through December 31, 1998. Permit extensions must be approved by Park Supervisor.
2. Notify Anne Rockwell, Park Supervisor, at 510 748-8252 to coordinate access.
3. The Permittee shall supply an Insurance Certificate showing general liability insurance for coverage of at least \$1,000,000.00 and automobile liability coverage in the amount of \$1,000,000.00 per occurrence. East Bay Regional Park District shall be named on the Certificate as additional insured.
4. Permittee agrees to indemnify, hold harmless, defend and protect District, its officers, directors, agents, employees, invitees (each of which is an indemnitee) from and against any and all claims, losses, damages, demands, liabilities, suits, costs, expenses (including attorneys' fees), penalties, judgments, or obligations whatsoever for or in connection with injury (including death) or damage to any person or the loss or damage of property to whomsoever belonging or pecuniary or monetary loss resulting from, arising out of, or in any way related to activity conducted by or the omission of Permittee, including but not limited to  
Permittee's development, construction, occupation, use, operation, maintenance and/or removal of the property, premises, or any facilities or operations thereon, including events occurring on or off the property, premises, or facilities, regardless of how the injury or damage was caused or suffered, unless the injury or damage resulted from the sole negligence or the intentional and willful misconduct of the District, its officers, directors, agents or employees.
5. The Permittee agrees to restore any damage to pavement, trails, turf and any other District property to its original condition prior to access. The District may elect to make repairs and charge the Permittee the cost thereof.
6. After both entering and exiting East Bay Regional Park District property, all gates must be closed and locked immediately.

7. Monitoring wells to be abandoned according to current industry standards.
8. Permittee is responsible for providing and placing caution signs to alert public trail users of Permittee's vehicle traffic on District property.
9. This Permit may be revoked at any time

.Subject to the above conditions, A PERMIT IS HEREBY ISSUED FOR:

**Construction to abandon two monitoring wells.**

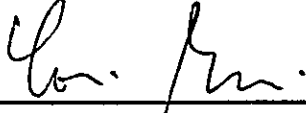
ISSUED BY:   
Louie Gross, Administrative Analyst

DATE: 12/22/98

CONDITIONS ACCEPTED BY: 

DATE: 12/17/98

**Permittee**

**CONFIDENTIAL**

STATE OF CALIFORNIA DWR  
WELL COMPLETION REPORT  
(WELL LOGS)

**REMOVED**

**CONFIDENTIAL**

STATE OF CALIFORNIA DWR  
WELL COMPLETION REPORT  
(WELL LOGS)

**REMOVED**

**CONFIDENTIAL**

**STATE OF CALIFORNIA DWR  
WELL COMPLETION REPORT  
(WELL LOGS)**

**REMOVED**

**CONFIDENTIAL**

STATE OF CALIFORNIA DWR  
WELL COMPLETION REPORT  
(WELL LOGS)

**REMOVED**

**CONFIDENTIAL**

STATE OF CALIFORNIA DWR  
WELL COMPLETION REPORT  
(WELL LOGS)

**REMOVED**



**CONFIDENTIAL**

STATE OF CALIFORNIA DWR  
WELL COMPLETION REPORT  
(WELL LOGS)

**REMOVED**