

PARK STREET

		TVM-GAS	BENZENE	TOLUENE	ETHYL BENZENE	XYLENES	DIESEL
HB2-2	66"	56 ppm	15 ppb	22 ppb	660 ppb	250 ppb	..
HB2-3	84"	39 ppm	9.3 ppb	9.4 ppb	390 ppb	260 ppb	13 ppm

		TOG	DIESEL	KEROSENE
HB3-1	90"	1500 ppm	2,000 ppm	ND

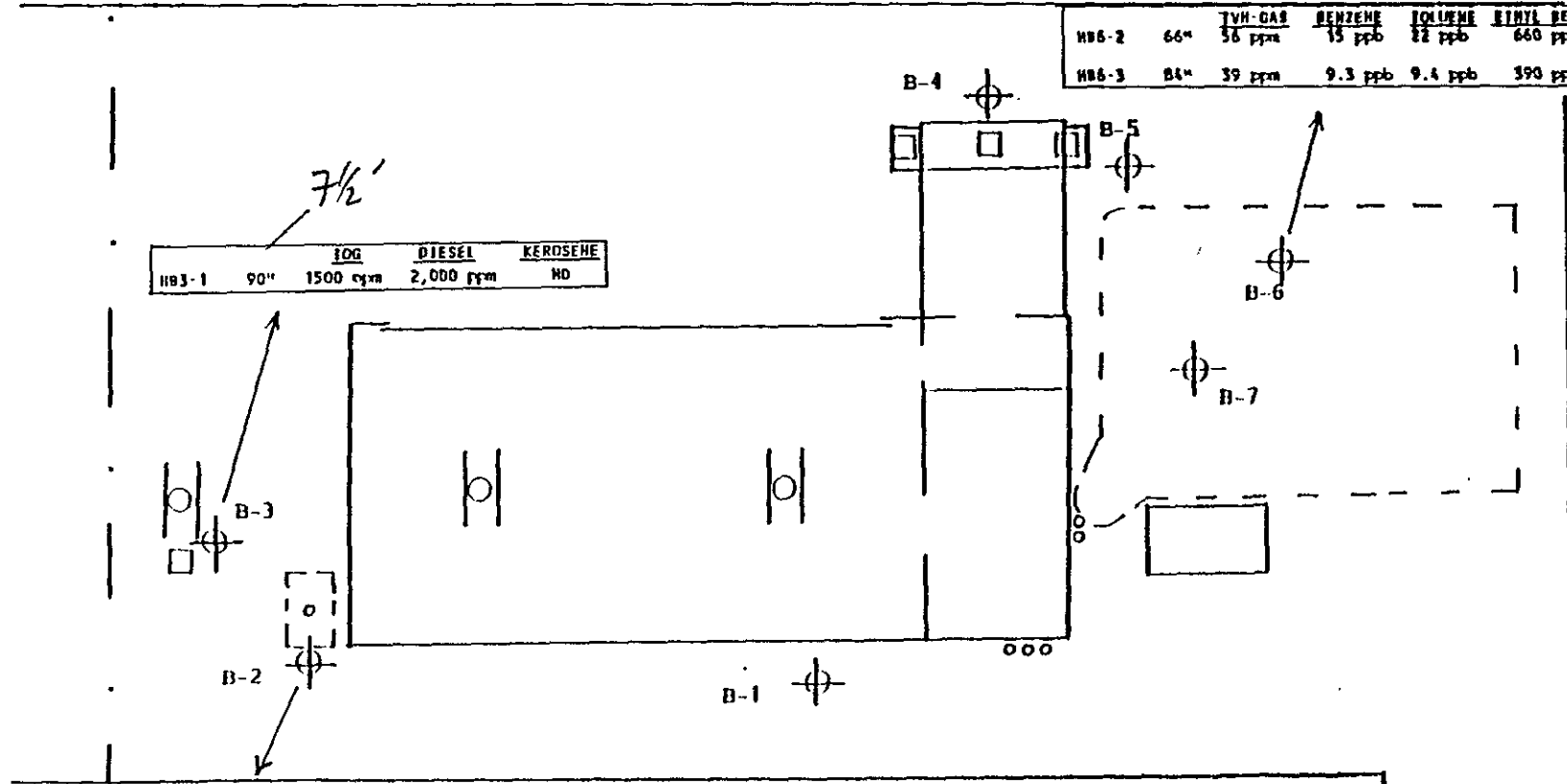

EAGLE AVENUE

		TOG	DIESEL	KEROSENE
HB2-1	12"	340 ppm	30 ppm	ND
HB2-3	87"	ND	ND	210

NEIGHBORING BUILDING/PROPERTY

**KEY**

- B-1      Approx. location of Soil Boring
- HB3-1    Soil Sample Number
- 90"      Depth of Soil Sample in Inches
- 340 ppm    Chemical Analysis Results in Parts per Million

**TMC ENVIRONMENTAL, INC.**

SCALE: 1" ± 15'	APPROVED BY:	DRAWN BY MAP
DATE:		REVISED

HAND BORING LOCATIONS  
AND CHEMICAL ANALYSIS RESULTS  
1726 Park Street, Alameda, California

Job: 104891

PG 2

DRAWING NUMBER  
Plate 3

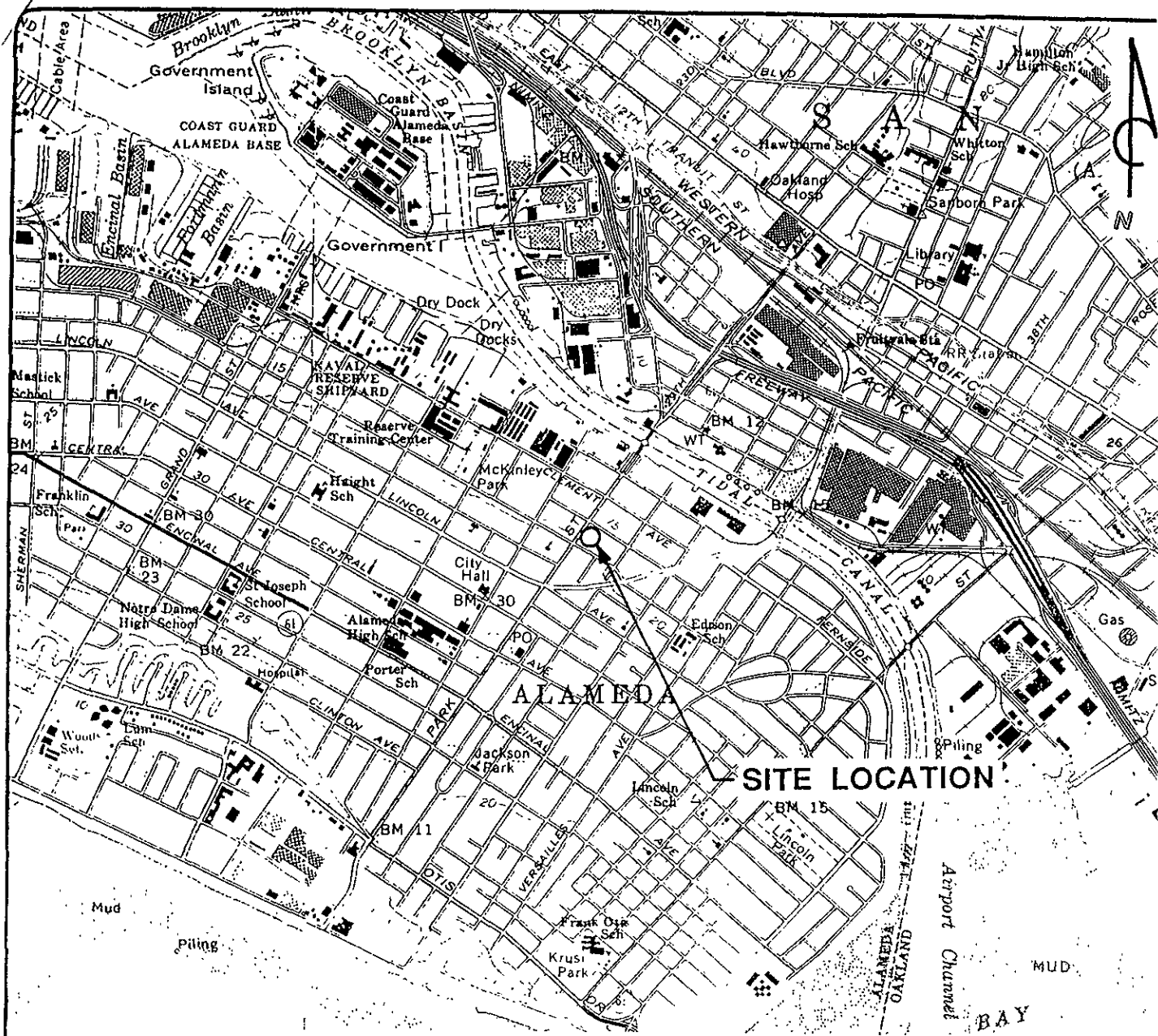

QUADRANGLE LOCATION

**REFERENCES:**

USGS 7.5 MIN. TOPOGRAPHIC MAP  
 TITLED: OAKLAND WEST, CALIFORNIA  
 DATED: 1959 REVISED: 1980  
 TITLED: OAKLAND EAST, CALIFORNIA  
 DATED: 1959 REVISED: 1980

SCALE IN FEET

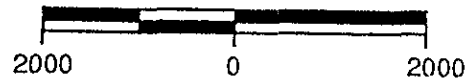

PACIFIC ENVIRONMENTAL GROUP, INC.

ESTATE OF JOHN B. HENRY PROPERTY  
 1726 Park Street at Eagle Avenue  
 Alameda, California

SITE LOCATION MAP

FIGURE:  
 1  
 PROJECT:  
 286-001.6A



# PARK STREET

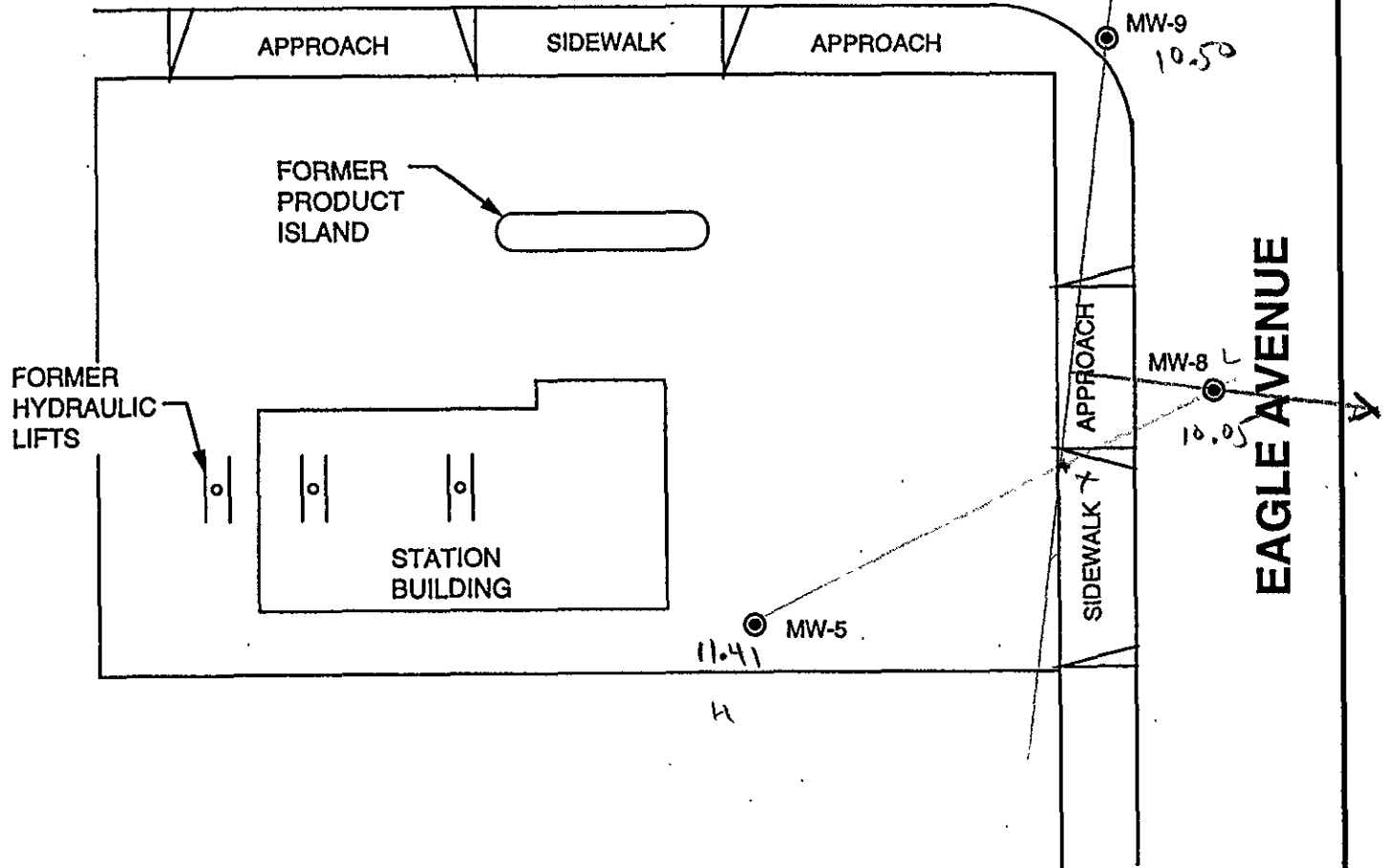

### LEGEND

MW-5 ● GROUNDWATER MONITORING WELL LOCATION AND DESIGNATION

$$x = \frac{91}{13\%} \times 2.8 = 1.87$$

*gradient / outflow for 431196*

### SCALE



PACIFIC ENVIRONMENTAL GROUP, INC.

ESTATE OF JOHN B. HENRY PROPERTY  
1726 Park Street at Eagle Avenue  
Alameda, California

SITE MAP

FIGURE:  
2  
PROJECT:  
286-001.4C

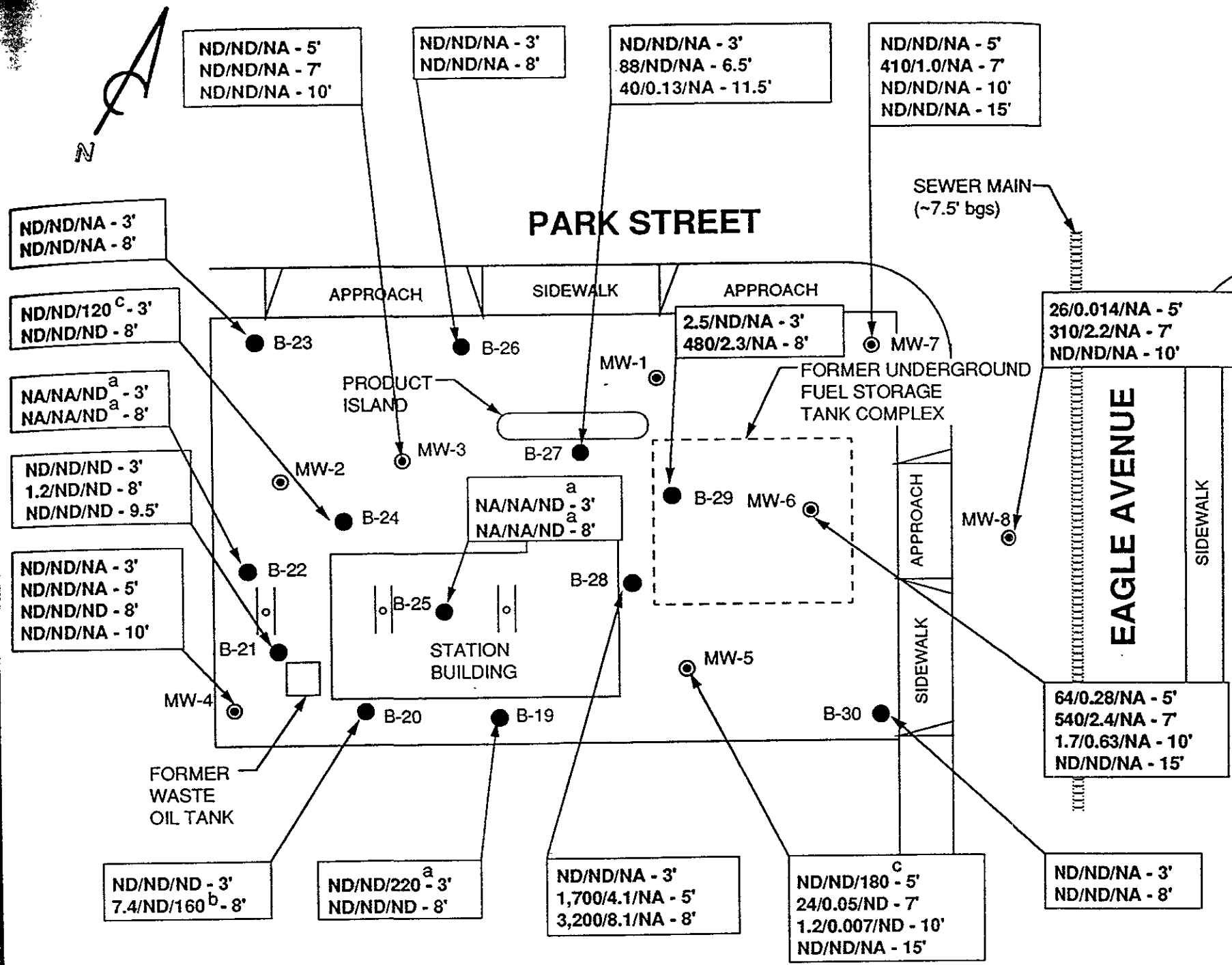

**LEGEND**

MW-1 ● GROUNDWATER MONITORING WELL LOCATION AND DESIGNATION

B-27 ● SOIL BORING LOCATION AND DESIGNATION

24/0.05/ND TPH-g/BENZENE/OIL and GREASE CONCENTRATION IN SOIL, IN PARTS PER MILLION, AT DEPTH INDICATED IN FEET, 2-9-94 and 2-10-94

ND NOT DETECTED

NA NOT ANALYZED

TOTAL OIL AND GREASE CHARACTERISTICS QUALITATED AS FOLLOWS:

a. HYDRAULIC OIL

b. KEROSENE (ALSO QUANTIFIED AS KEROSENE IN DIESEL RANGE)

c. WASTE OIL

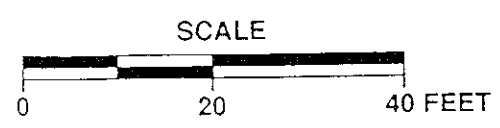

ESTATE OF JOHN B. HENRY  
1726 Park Street at Eagle Avenue  
Alameda, California

SOIL ANALYTICAL RESULTS MAP

FIGURE 24  
PROJECT 286-001 1A

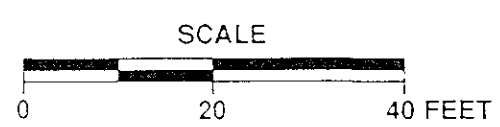
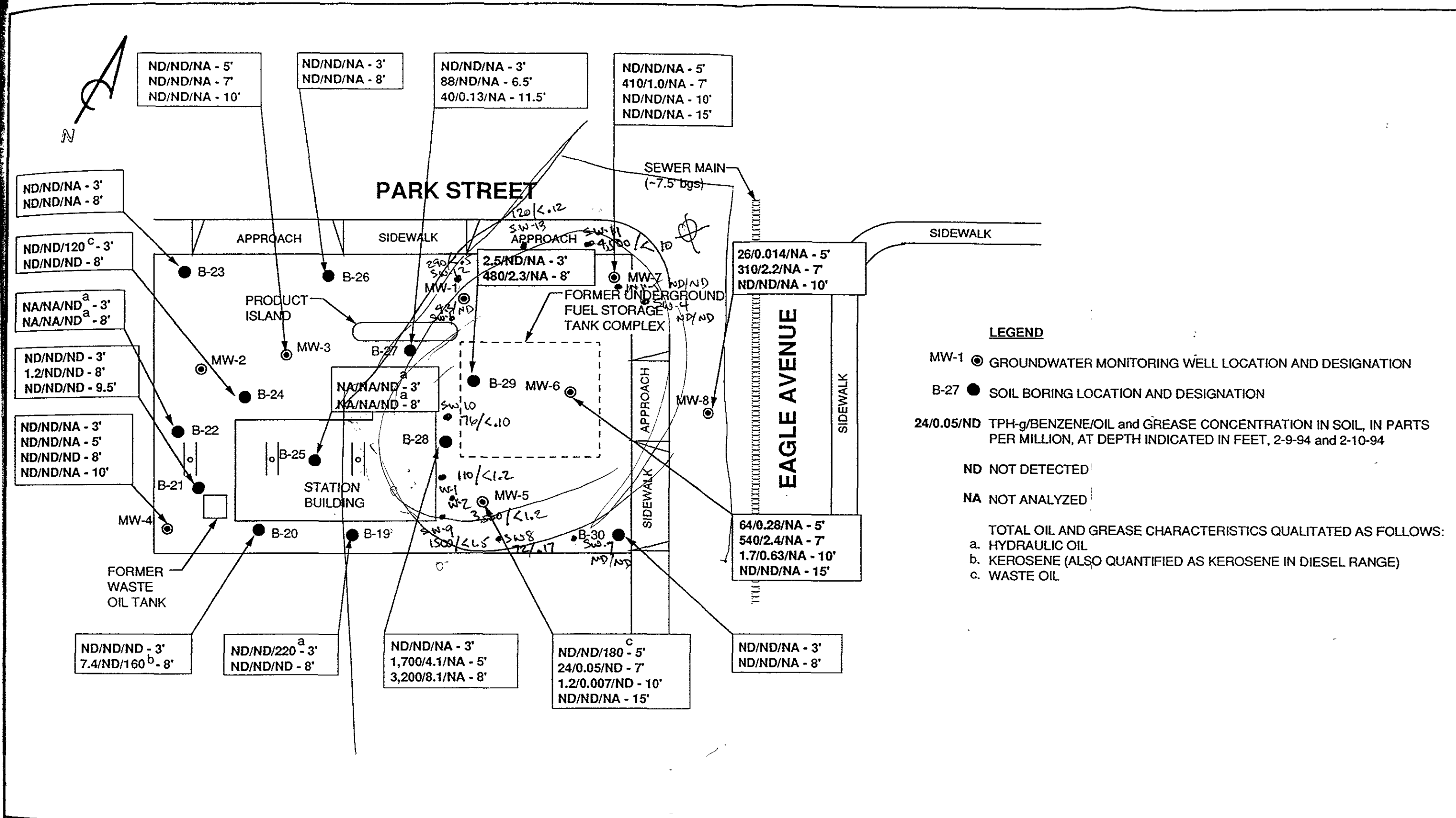

ESTATE OF JOHN B. HENRY  
1726 Park Street at Eagle Avenue  
Alameda, California

SOIL ANALYTICAL RESULTS MAP

FIGURE 2  
PROJECT 286-001 1A

680 cy

Property Line

Eagle Ave.

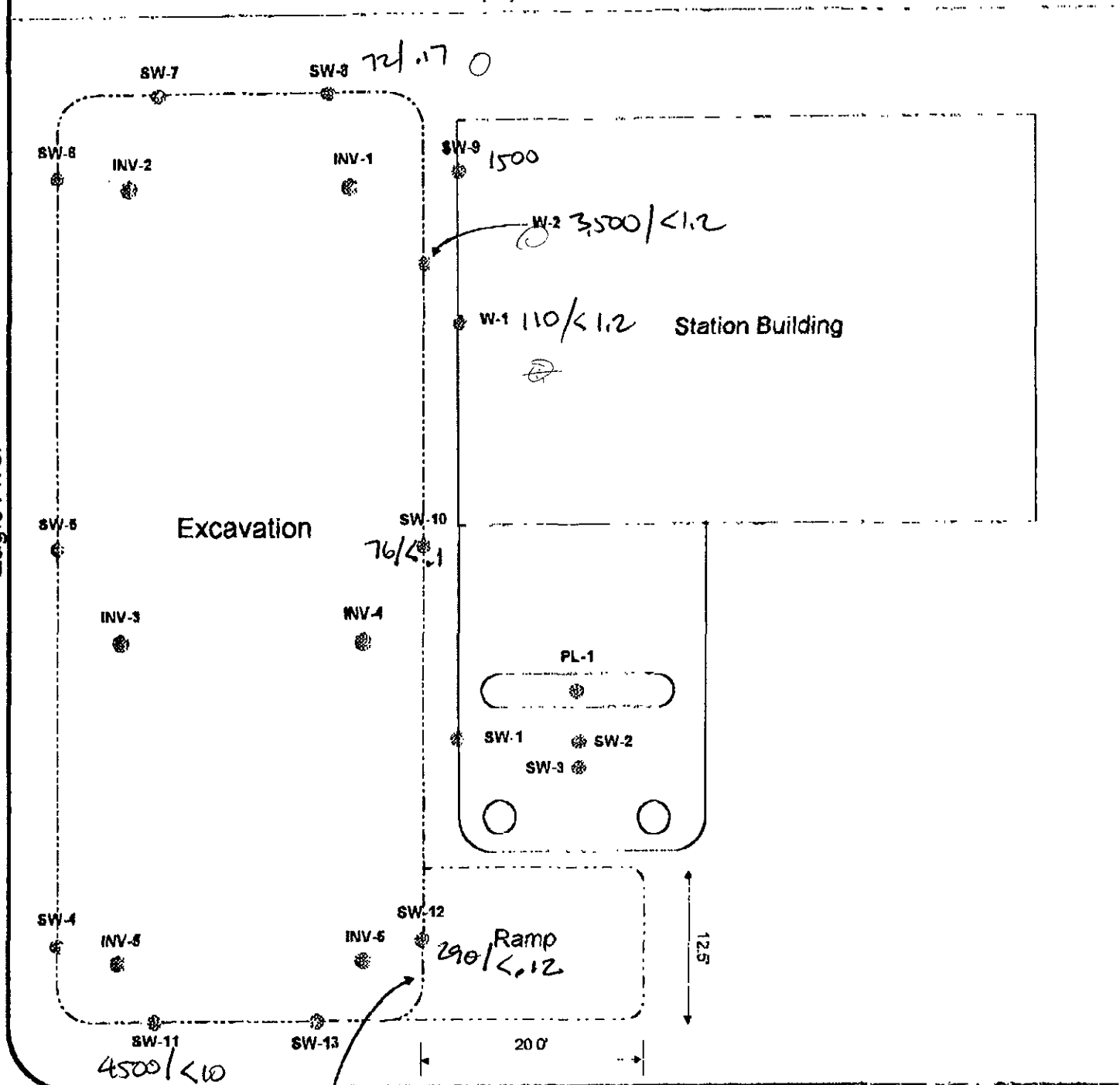

7' b.g.s. @ bottom of ramp

Park St.



**PROPERTY ADDRESS**  
1726 PARK STREET  
ALAMEDA, CA.

**SURVEYOR**  
DAVID M. LOGAN L.S. 5003  
803 DORSET WAY  
BENICIA, CA.  
(707) 745-5053

**DATE:** MAY, 1992

**SCALE:** 1" = ± 25'

REVISED JUNE 12, 1992 BY TMC, INC.

**LEGEND**

- ⊕ M.W. MONITOR WELL
- PROPERTY LINE
- ⊕ SOIL BORING

SAMPLE DEPTH (FEET)	GAS (PPM)	B (PPB)	T (PPB)	E (PPB)	X (PPB)	DIESEL (PPM)	POG (PPM)	EPA 8010 (PPB)	EPA 8240 (PPB)
4-5	ND	ND	ND	ND	ND	1	NA	NA	NA
6-6h	870	ND	ND	12000	67000	57	NA	NA	NA
8-8h	NA	NA	NA	NA	NA	NA	NA	ND	NA

SAMPLE DEPTH (FEET)	GAS (PPM)	B (PPB)	T (PPB)	E (PPB)	X (PPB)	DIESEL (PPM)	POG (PPM)	EPA 8010 (PPB)	EPA 8240 (PPB)
17-18	NA	NA	NA	NA	NA	NA	NA	ND	NA

SAMPLE DEPTH (FEET)	GAS (PPM)	B (PPB)	T (PPB)	E (PPB)	X (PPB)	DIESEL (PPM)	POG (PPM)	EPA 8010 (PPB)	EPA 8240 (PPB)
5-6	ND	ND	ND	ND	ND	ND	NA	NA	NA
7-7h	580	ND	ND	1600	6200	2	ND	NA	NA

SAMPLE DEPTH (FEET)	GAS (PPM)	B (PPB)	T (PPB)	E (PPB)	X (PPB)	DIESEL (PPM)	POG (PPM)	EPA 8010 (PPB)	EPA 8240 (PPB)
6-6h	94	ND	120	500	3400	10	NA	NA	NA

SAMPLE DEPTH (FEET)	GAS (PPM)	B (PPB)	T (PPB)	E (PPB)	X (PPB)	DIESEL (PPM)	POG (PPM)	EPA 8010 (PPB)	EPA 8240 (PPB)
4-5	ND	ND	ND	ND	ND	ND	NA	NA	NA
6-7	1000	1600	1600	10000	58000	7	NA	NA	*

\* ACETONE - 47 ppm; 2-BUTANONE - 11 ppm

SAMPLE DEPTH (FEET)	GAS (PPM)	B (PPB)	T (PPB)	E (PPB)	X (PPB)	DIESEL (PPM)	POG (PPM)	EPA 8010 (PPB)	EPA 8240 (PPB)
5-6	1300	ND	3600	15000	90000	31	NA	NA	NA
7-7h	550	ND	2400	9400	46000	21	NA	NA	NA

SAMPLE DEPTH (FEET)	GAS (PPM)	B (PPB)	T (PPB)	E (PPB)	X (PPB)	DIESEL (PPM)	POG (PPM)	EPA 8010 (PPB)	EPA 8240 (PPB)
4-4h	NA	NA	NA	NA	NA	NA	ND	NA	NA
6-6h	NA	NA	NA	NA	NA	NA	240	NA	NA

SAMPLE DEPTH (FEET)	GAS (PPM)	B (PPB)	T (PPB)	E (PPB)	X (PPB)	DIESEL (PPM)	POG (PPM)	EPA 8010 (PPB)	EPA 8240 (PPB)
1-1h	NA	NA	NA	NA	NA	NA	640	NA	NA
5-5h	NA	NA	NA	NA	NA	NA	52	NA	ND

SAMPLE DEPTH (FEET)	GAS (PPM)	B (PPB)	T (PPB)	E (PPB)	X (PPB)	DIESEL (PPM)	POG (PPM)	EPA 8010 (PPB)	EPA 8240 (PPB)
6-6h	NA	NA	NA	NA	NA	NA	1600	NA	ND

SAMPLE DEPTH (FEET)	GAS (PPM)	B (PPB)	T (PPB)	E (PPB)	X (PPB)	DIESEL (PPM)	POG (PPM)	EPA 8010 (PPB)	EPA 8240 (PPB)
4-1	ND	ND	ND	ND	ND	5	1800	NA	ND
4-4h	ND	ND	ND	ND	ND	10	ND	NA	NA
5-6	ND	ND	ND	ND	ND	ND	ND	NA	NA

SAMPLE DEPTH (FEET)	GAS (PPM)	B (PPB)	T (PPB)	E (PPB)	X (PPB)	DIESEL (PPM)	POG (PPM)	EPA 8010 (PPB)	EPA 8240 (PPB)
4-4h	ND	ND	ND	ND	ND	ND	ND	NA	NA
7-7h	ND	ND	ND	ND	ND	ND	ND	NA	ND

SAMPLE DEPTH (FEET)	GAS (PPM)	B (PPB)	T (PPB)	E (PPB)	X (PPB)	DIESEL (PPM)	POG (PPM)	EPA 8010 (PPB)	EPA 8240 (PPB)
4-5	ND	ND	ND	ND	ND	ND	ND	NA	NA
7-7h	ND	ND	ND	ND	ND	ND	ND	NA	NA

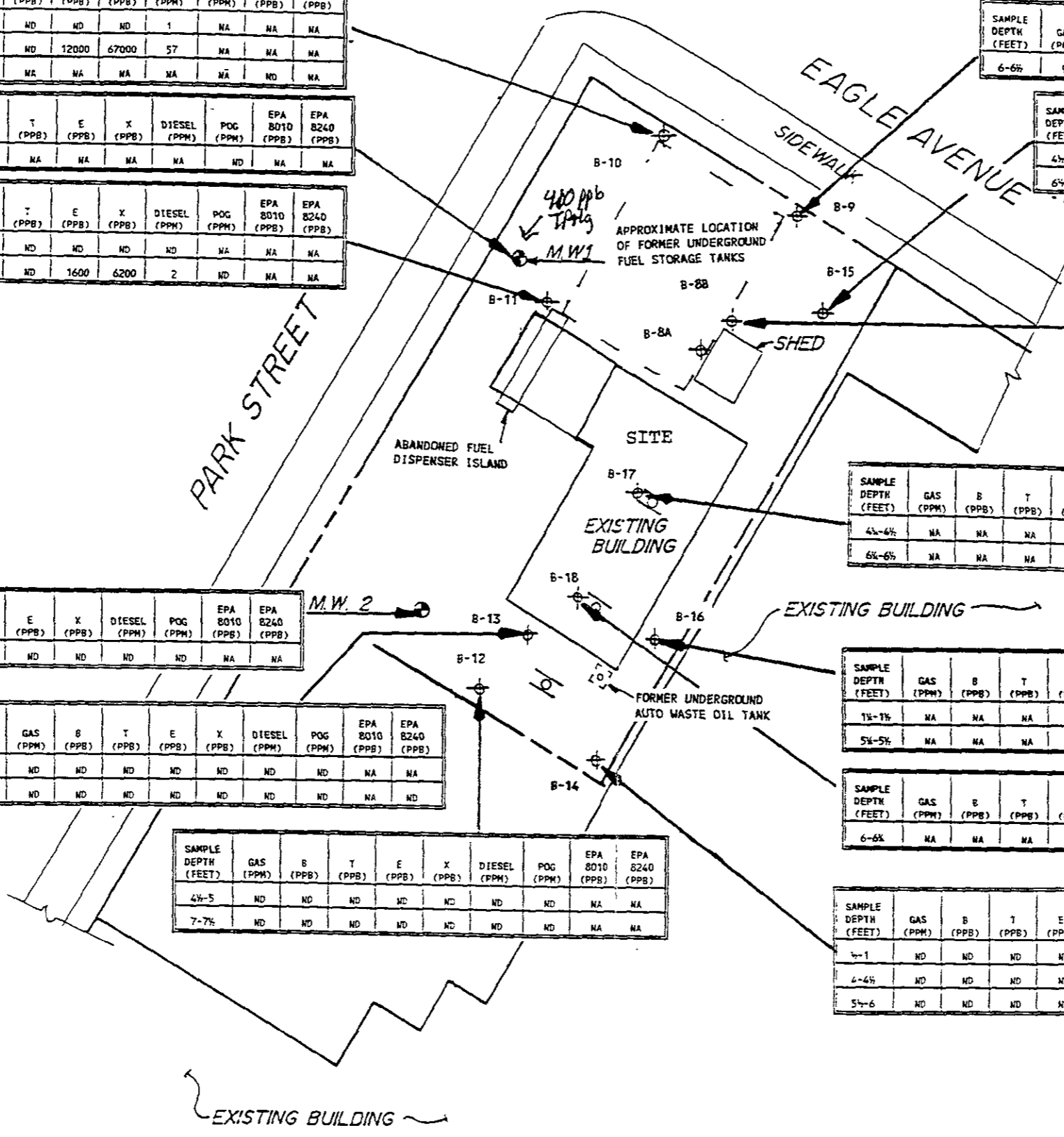

*"Crab" g.w. sample identified high conc. of carbon*



**RESULTS OF SOIL BORING SAMPLES**  
MAY 5 AND 8, 1992  
1726 PARK STREET  
ALAMEDA, CALIFORNIA



JOB: 104891