

**S E M C O**  
ENVIRONMENTAL CONTRACTORS & GENERAL ENGINEERING  
1741 LESLIE STREET  
SAN MATEO, CALIFORNIA 94402-24

October 9, 1995

Susan Hugo  
County of Alameda  
Department of Environmental Health  
1131 Harbor Bay Parkway, Room 250  
Alameda, California 94502

Re: Tank Removal Report  
3623 Adeline Street, Emeryville

Dear Susan:

Please find enclosed, a copy of the tank removal report for the above mentioned address.

If you have any questions, please give me a call.

Respectfully,

  
Rhonda Reames-Kiper  
SEMCO-SAN MATEO

cc: Scott Barde, Owens Financial  
File

---

License # 449864  
A,B, C-61/D40  
Hazardous Substances Certification

(800) 831-2344  
(415) 572-8033  
(415) 572-9734 FAX

**TANK REMOVAL  
ACTIVITY REPORT**

**3623 ADELINE STREET  
EMERYVILLE, CALIFORNIA**

**Prepared for:**

**OWENS FINANCIAL GROUP, INC.  
P.O. BOX 2308  
WALNUT CREEK, CALIFORNIA 94595**

**Submitted to:**

**COUNTY OF ALAMEDA  
ENVIRONMENTAL HEALTH DEPARTMENT  
1131 HARBOR BAY PARKWAY, RM 250  
ALAMEDA, CALIFORNIA 94502  
(510) 567-6700**

**Prepared by:**

**SEMCO  
1741 LESLIE STREET  
SAN MATEO, CALIFORNIA 94402  
(415) 572-8033**

**JOB # 95-4366  
OCTOBER 1995**

**Tank Removal Report  
3623 Adeline Street  
Emeryville, California**

SEMCO was contracted by Owens Financial Group to remove one (1) 2500 gallon diesel heating oil Underground Storage Tank (UST) from the commercial site located at 3623 Adeline Street, Emeryville, California. This report covers the tank removal, sampling and disposal activities.

On August 18, 1995, SEMCO removed the concrete above the tank. Evergreen Environmental was on site and pumped 2500 gallons of product, which was transported for disposal under manifest number 95643892. All soil excavated was placed on 6 mil polyfilm and covered with the same. The tank removal was scheduled for August 31, 1995.

On August 31, 1995, the tank was inerted with solid carbon dioxide (dry ice) until acceptable levels of oxygen and lower explosive limits were reached to meet safety requirements. Susan Hugo of the Alameda County Environmental Health Department and George Warren of the Emeryville Fire Department were on site to verify the tank readings and to witness the removal, loading and sampling activities.

The tank had a hole in the bottom at the north end, measuring approximately 3"-4" in diameter. The soil had a strong petroleum odor and discoloration. All piping was badly deteriorated and numerous and separate, previously abandoned lines were noted in the excavation.

Soil samples were collected in the bottom of the excavation, under the direction of Susan Hugo, at the north and south ends at a depth of 9' below floor level (bfl). The samples were collected in clean brass tubes, which were sealed with Teflon tape, pre-formed plastic end caps and masking tape. The samples were labeled, entered onto a chain of custody and placed in an iced cooler for transportation to North State Environmental for the analysis of Total Petroleum Hydrocarbons as Diesel (TPH-D), Benzene, Toluene, Ethyl Benzene & Xylenes (BTEX).

Based on the analytical data received, additional excavation was performed on September 5, 1995. A total of 54.34 tons of soil was loaded, transported and disposed at Remco, Inc., a State Certified Class II Disposal Facility in Richmond.

Confirmation samples were collected under the direction of Susan Hugo at the east and west sidewalls at 7' bfl, the north west center at 9'bfl, and the bottom center at 9'bfl. These samples were also transported to North State Environmental for the analysis of TPH-D and BTEX. Analytical results of all samples are included as an attachment to this report.

Due to the working constraints, further excavation was not possible. SEMCO backfilled the excavation upon the approval of the Alameda County Environmental Health Department.

This report was prepared from field technician's daily reports, inspector's field notes and analytical data pertaining to this site.

SITE

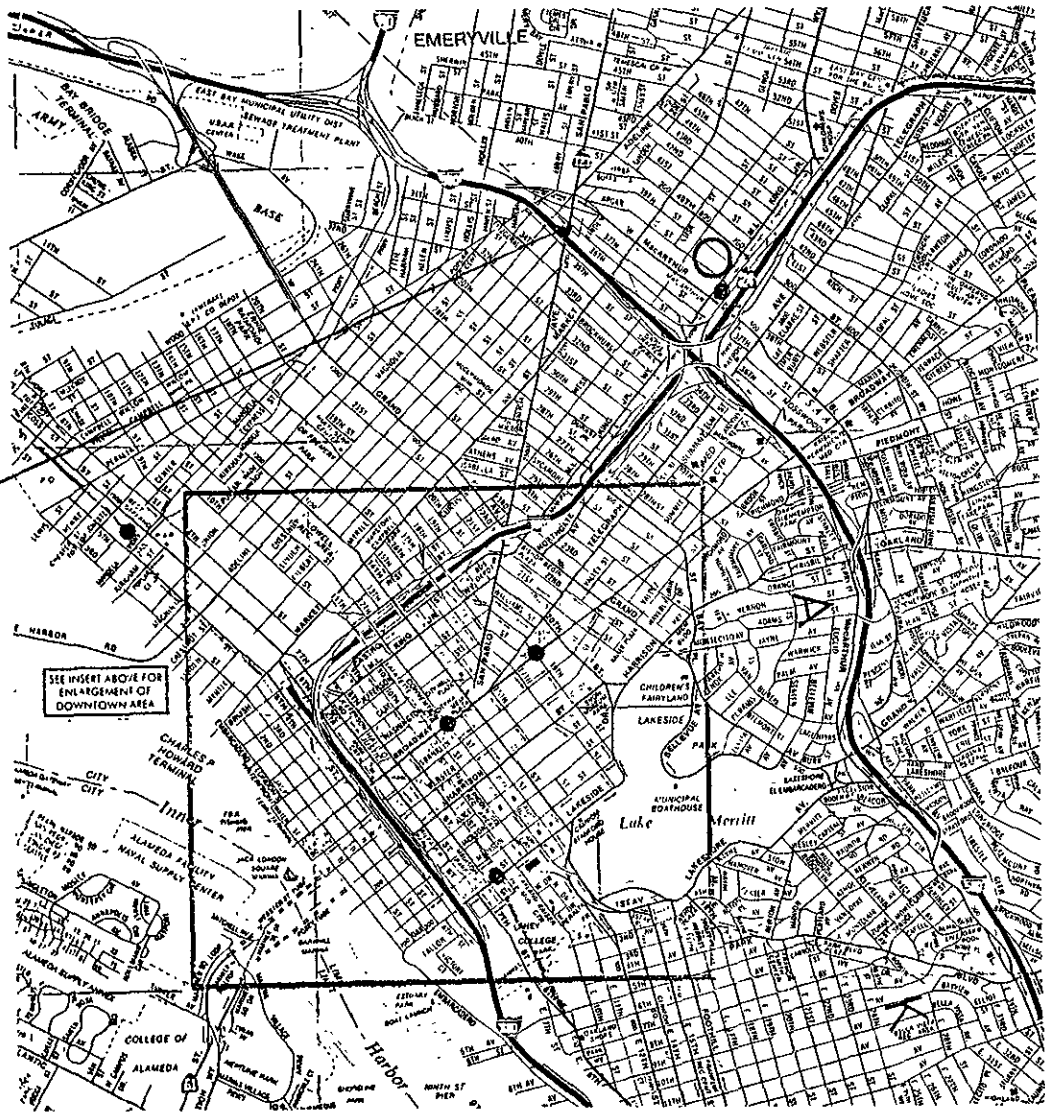

SITE LOCATION MAP

# APPENDIX





# North State Environmental Analytical Laboratory

## Chain of Custody/Request for Analysis

*95-007*

(415) 588-9652

Client: SEMCO		Phone: (415) 572-8033		Report to: SEMCO				Turnaround Time			
Mailing Address: 1741 LESLIE STREET SAN MATEO, CA 94402				Billing to: 1741 LESLIE STREET SAN MATEO, CA 94402				8 Hr	24 Hr		
Site Address: 3623 ADELINE ST., EMERYVILLE				PO# / Billing Reference: 95-4366 OWENS FINANCIAL				40 Hr	5 Days		
Sampler: <i>JAMES ATZILISON</i>		Date: <i>8-31-95</i>						Other			
Sample ID:	Sample Description	Container # / type	Sampling Time/Date	ANALYSIS REQUESTED							Remarks
				TPH-D	TPH-G	BTEX	O+G				
<i>#1</i>	<i>NORTH END @ 9'</i>	<i>TUBE</i>	<i>2:50pm / 8-31</i>	<i>X</i>		<i>X</i>					
<i>#2</i>		<i>TUBE</i>	<i>3:15pm / 8-31</i>	<i>X</i>		<i>X</i>					<i>HOLD</i>
<i>#3</i>	<i>SOUTH END @ 9'</i>	<i>TUBE</i>	<i>3:40pm / 8-31</i>	<i>X</i>		<i>X</i>					
Relinquished by: <i>James Atzilison</i>		Date: <i>8-31</i> Time: <i>6 PM</i>		Received by: <i>[Signature]</i>				Yes No			
Relinquished by:		Date: Time:		Received by:				Were samples Preserved ? <input checked="" type="checkbox"/>			
Relinquished by:		Date: Time:		Received in lab by: <i>[Signature]</i>				In good condition ? <input checked="" type="checkbox"/>			



MAGNOLIA STREET

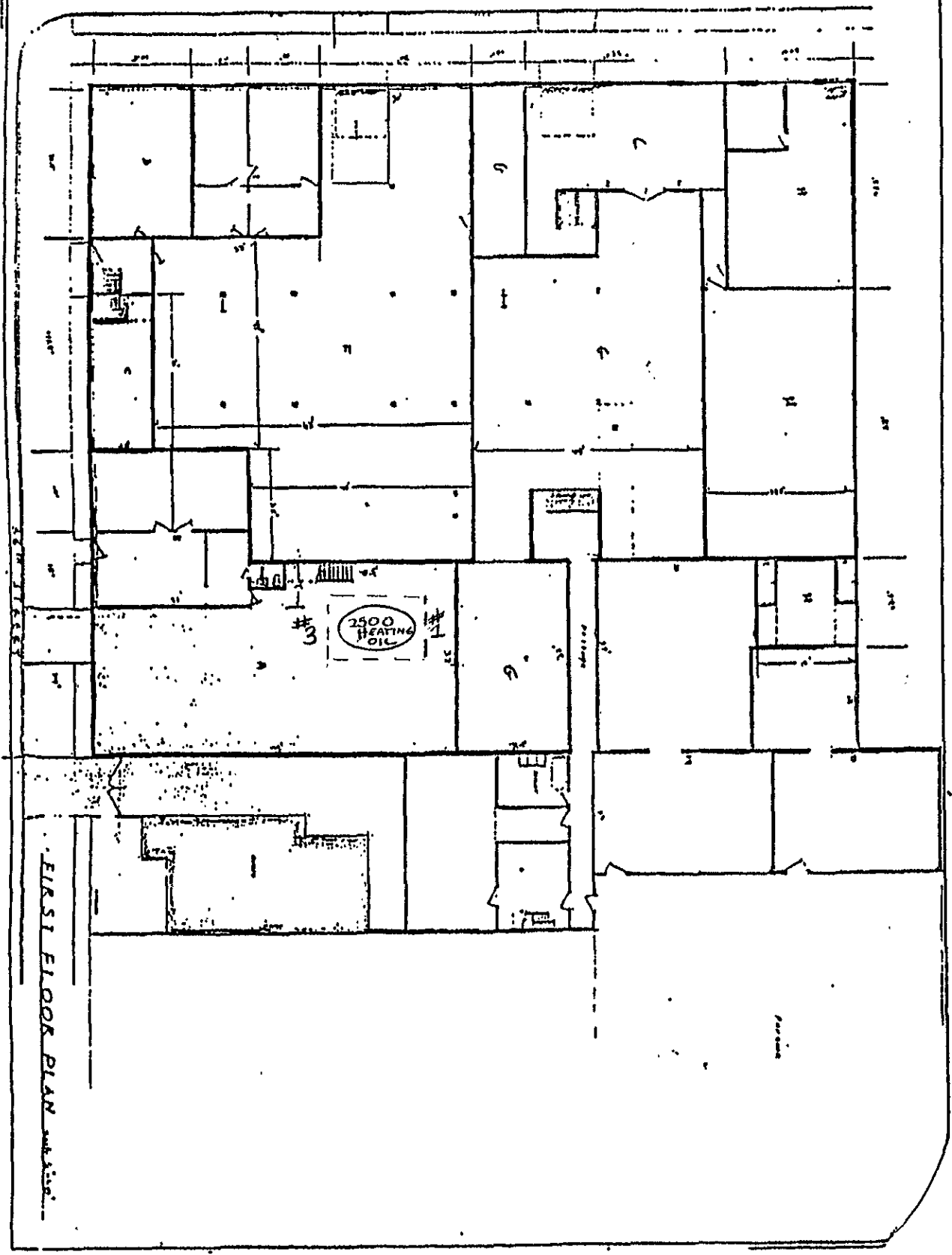

#1-NORTH END @ 9'  
#3- SOUTH END @9'

FIRST FLOOR PLAN

ADELINE STREET

SEMCO  
3623 ADELINE ST.  
EMERYVILLE

N →



**North State Environmental**  
 Chemical Waste Disposal · Trucking · Consulting

C E R T I F I C A T E O F A N A L Y S I S

JOB NO: 95-428

DATE SAMPLED: 09-05-95

CLIENT: SEMCO

DATE EXTRACTED: 09-05-95

PROJECT NAME: 95-4366

DATE ANALYZED: 09-05-95

OWENS FINANCIAL

BTXE RANGE ORGANICS BY  
 EPA METHOD 8020/5030 AND 8015 M  
 DIESEL RANGE HYDROCARBONS BY EPA METHOD 8015 M

Sample No.	Client ID	Analyte	Result
95-428-01	#4 EAST S.W. 7'	Benzene	ND<10 ug/Kg
		Toluene	21 ug/Kg
		Ethylbenzene	ND<10 ug/Kg
		Xylenes	62 ug/Kg
		Diesel	1400 mg/Kg
95-428-02	#5 WEST S.W. 7'	<del>Benzene</del>	<del>81 ug/Kg</del>
		<del>Toluene</del>	<del>800 ug/Kg</del>
		Ethylbenzene	170 ug/Kg
		Xylenes	1700 ug/Kg
		Diesel	4900 mg/Kg
95-428-03	#6 N.W. CENTER 9'	Benzene	ND<25 ug/Kg
		Toluene	180 ug/Kg
		<del>Ethylbenzene</del>	<del>190 ug/Kg</del>
		<del>Xylenes</del>	<del>1700 ug/Kg</del>
		<del>Diesel</del>	<del>21000 mg/Kg</del>
95-428-04	#7 Bottom Center 9'	Benzene	ND
		Toluene	10 ug/Kg
		Ethylbenzene	ND
		Xylenes	25 ug/Kg
		Diesel	400 mg/Kg

Quality Control Quality Assurance Summary: Soil

Analyte	Method	Reporting limit	Blank	MS/MSD Recovery	RPD
Benzene	8020	5 ug/Kg	ND	AVG 93%	7
Toluene	8020	5 ug/Kg	ND		
Ethylbenzene	8020	5 ug/Kg	ND		
Xylenes	8020	10 ug/Kg	ND		
Diesel	8015 M	1 mg/Kg	ND	AVG 90%	5

ELAP CERTIFICATION NUMBER 1753

Reviewed and Approved by

  
 John Murphy

Laboratory Director



# North State Environmental Analytical Laboratory

## Chain of Custody/Request for Analysis

(415) 588-9652

95-028

Client: <b>SEMCO</b>		Phone: (415) 572-8033		Report to: <b>SEMCO</b>				Turnaround Time					
Mailing Address: <b>1741 Leslie St. San Mateo, Ca. 94402</b>				Billing to: <b>1741 Leslie St. San Mateo, Ca. 94402</b>				8 Hr <input type="checkbox"/>		24 Hr <input type="checkbox"/>			
Site Address: <b>3623 Adeline St. Emeryville</b>				PO# / Billing Reference: <b>95-4366 Owens Financial</b>				40 Hr <input type="checkbox"/>		5 Days <input type="checkbox"/>			
Sampler: <b>James Archison</b>			Date: <b>9-5-95</b>						Other <input type="checkbox"/>				
Sample ID:	Sample Description	Container # / type	Sampling Time/Date	ANALYSIS REQUESTED								Remarks	
				TPH-D	TPH-G	BTEX	O+G						
#4	EAST S.W. Q7'	1 tube	11:47 AM / 9-5	X		X							
#5	WEST S.W. Q7'	1 tube	11:58 AM / 9-5	X		X							
#6	N.W. corner Q9'	1 tube	12:02 PM / 9-5	X		X							
#7	BOTTOM CENTER Q9'	1 tube	12:15 PM / 9-5	X		X							
Relinquished by: <b>James Archison</b>			Date: <b>9-5-95</b> Time: <b>1:52</b>		Received by: <b>[Signature]</b>				Yes <input type="checkbox"/> No <input type="checkbox"/>				
Relinquished by: <b>[Signature]</b>			Date: <b>[Signature]</b> Time: <b>[Signature]</b>		Received by: <b>[Signature]</b>				Were samples Preserved ? <input checked="" type="checkbox"/>				
Relinquished by:			Date: Time:		Received in lab by: <b>[Signature]</b>				In good condition ? <input checked="" type="checkbox"/>				

SOIL SAMPLES COLLECTED

MAGNOLIA STREET

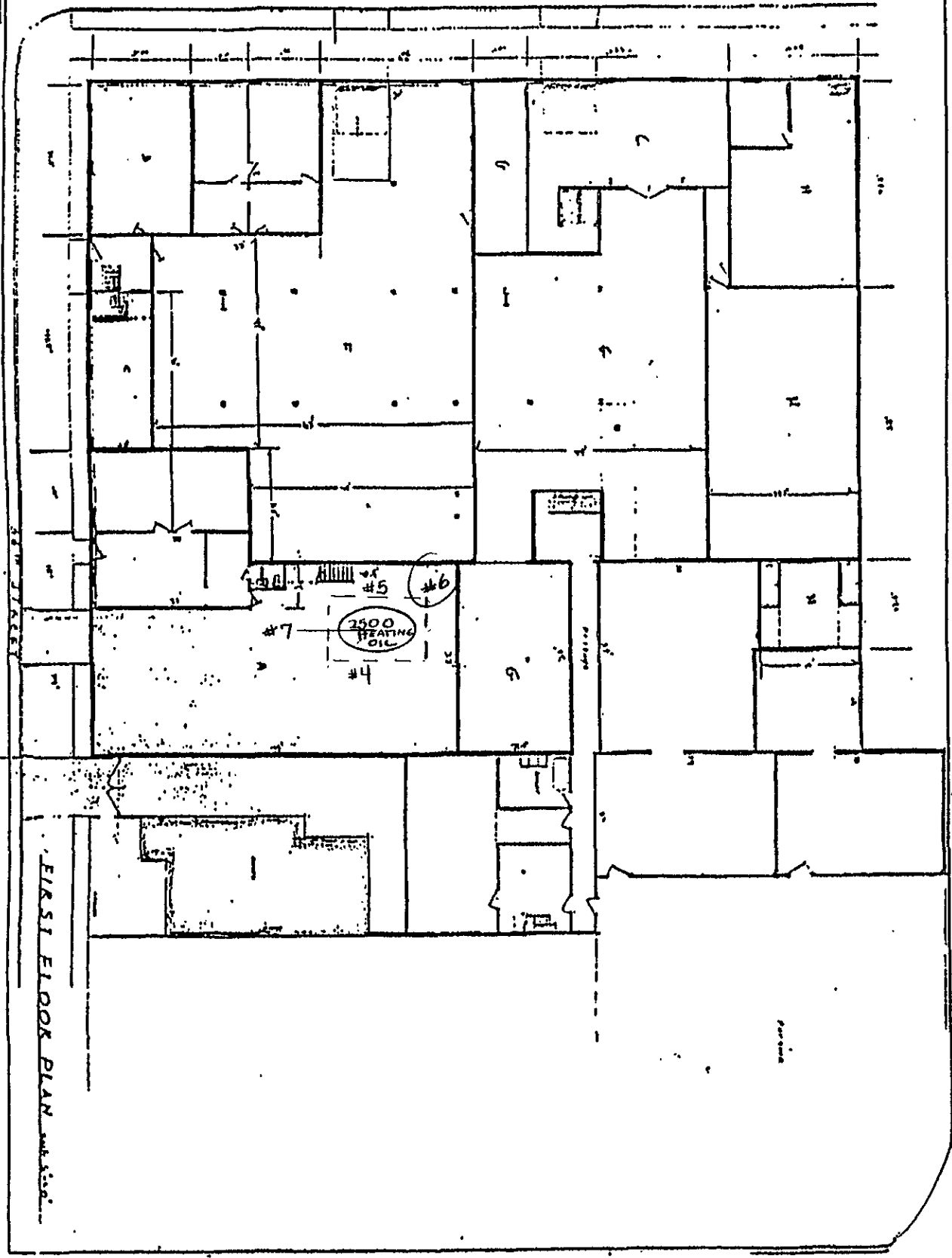

- #4-EAST SIDEWALL @ 7'
- #5-WEST SIDEWALL @ 7'
- #6-N.W. CORNER @ 9'
- #7-BOTTOM CENTER @ 9'

FIRST FLOOR PLAN

ADELINE STREET

SEMCO
3623 ADELINE ST.
EMERYVILLE

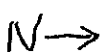

<b>McCAMPBELL ANALYTICAL INC.</b>	110 2nd Avenue South, #D7, Pacheco, CA 94553 Tele: 510-798-1620 Fax: 510-798-1622
-----------------------------------	--

Remco 2717 Goodrick Avenue Richmond, CA 94801	Client Project ID: Senico, 36th St.	Date Sampled: 08/21/95
	Date Received: 08/22/95	
	Client Contact: Steve Humphrey	Date Extracted: 08/22/95
	Client P.O.:	Date Analyzed: 08/25/95

LUFT Metals*									
EPA analytical methods 6010/200.7, 239.2†									
Lab ID	Client ID	Matrix	Extraction <sup>o</sup>	Cadmium	Chromium	Lead	Nickel	Zinc	% Rec. Surrogate
55616	36	S	TTLIC	ND	29	8.3	52	35	92
Reporting Limit unless otherwise stated; ND means not detected above the reporting limit	S	TTLIC	0.5 mg/L	0.5	3.0	2.0	1.0		
	W	TTLIC	0.01 mg/kg	0.005	0.005	0.02	0.01		
	---	STLC, TCLP	0.01 mg/L	0.05	0.2	0.05	0.05		

\* soil samples are reported in mg/kg, and water samples and all STLC & TCLP extracts in mg/L

† Lead is analysed using EPA method 6010 (ICP) for soils, STLC & TCLP extracts and method 239.2 (AA Furnace) for water samples

o EPA extraction methods 1311 (TCLP), 3010/3020 (water, TTLIC), 3040 (organic matrices, TTLIC), 3050 (solids, TTLIC); STLC from CA Title 22

W surrogate diluted out of range; N/A means surrogate not applicable to this analysis

o) liquid sample that contains greater than ~ 2 vol. % sediment, this sediment is extracted with the liquid, in accordance with EPA methodologies and can significantly effect reported metal concentrations.

DHS Certification No. 1644  Edward Hamilton, Lab Director

<b>McCAMPBELL ANALYTICAL INC.</b>	110 2nd Avenue South, #D7, Pacheco, CA 94553 Tel: 510-798-1620 Fax: 510-798-1622
-----------------------------------	---

Remco 2717 Goodrick Avenue Richmond, CA 94801	Client Project ID: Semco, 36th St.	Date Sampled: 08/21/95
	Client Contact: Steve Humphrey	Date Received: 08/22/95
	Client P.O:	Date Extracted: 08/25/95
		Date Analyzed: 08/25/95

**RCI (Reactivity, Corrosivity & Ignitability)**  
CA Title 22, Section 66261.21-66261.23

Lab ID	Client ID	Matrix	Reactivity <sup>+</sup>	Corrosivity (pH)	Ignitability <sup>o</sup>
55616	36	S	negative	8.08	negative

<sup>+</sup> negative means no obvious reaction with water, no evolution of gas upon contact with water, appears to contain no reactive cyanide or sulfide (< ~ 5 mg/kg cyanide and 50mg/kg sulfide by EPA SW-846, chapter 7, modified), and shows no indication of explosivity.  
<sup>o</sup> negative for a soil means the absence of spontaneous combustion and the absence of flammability upon exposure to a naked flame.

DHS Certification No. 1644 *EH*  
Edward Hamilton, Lab Director

McCAMPBELL ANALYTICAL INC.

110 2nd Avenue South, #D7, Pacheco, CA 94553  
 Tele: 510-798-1620 Fax: 510-798-1622

Remco 2717 Goodrick Avenue Richmond, CA 94801	Client Project ID: Semco, 36th St.	Date Sampled: 08/21/95
		Date Received: 08/22/95
	Client Contact: Steve Humphrey	Date Extracted: 08/22/95
	Client P.O:	Date Analyzed: 08/22-08/23/95

**Gasoline Range (C6-C12) Volatile Hydrocarbons as Gasoline\*, with BTEX\***  
EPA methods 5030, modified 8015, and 8020 or 602, California RWOCB (SF Bay Region) method GCP113(5030)

Lab ID	Client ID	Matrix	TPH(g) <sup>+</sup>	Benzene	Toluene	Ethylbenzene	Xylenes	% Rec. Surrogate
55616	36	S	26.g	ND	ND	ND	0.091	94
Reporting Limit unless otherwise stated; ND means not detected above the reporting limit		W	50 ug/L	0.5	0.5	0.5	0.5	
		S	1.0 mg/kg	0.005	0.005	0.005	0.005	

\* water and vapor samples are reported in ug/L, soil samples in mg/kg, and all TCLP extracts in mg/L  
 # cluttered chromatogram; sample peak coelutes with surrogate peak  
 + The following descriptions of the TPH chromatogram are cursory in nature and McCampbell Analytical is not responsible for their interpretation: a) unmodified or weakly modified gasoline is significant; b) heavier gasoline range compounds are significant (aged gasoline?); c) lighter gasoline range compounds (the most mobile fraction) are significant; d) gasoline range compounds having broad chromatographic peaks are significant; biologically altered gasoline?; e) TPH pattern that does not appear to be derived from gasoline (?); f) one to a few isolated peaks present; g) strongly aged gasoline or diesel range compounds are significant; h) lighter than water immiscible sheet is present; i) liquid sample that contains greater than ~ 5 vol. % sediment; j) no recognizable pattern

*EH* Edward Hamilton, Lab Director

<b>McCAMPBELL ANALYTICAL INC.</b>	<b>110 2nd Avenue South, #D7, Pacheco, CA 94553</b> Tele: 510-798-1620 Fax: 510-798-1622
-----------------------------------	---

Semco 2717 Goodrick Avenue Richmond, CA 94801	Client Project ID: Semco, 36th St.	Date Sampled: 08/21/95
	Client Contact: Steve Humphrey	Date Received: 08/22/95
	Client P.O:	Date Extracted: 08/22/95
		Date Analyzed: 08/22/95

**Total Recoverable Petroleum Hydrocarbons as Oil & Grease (with Silica Gel Clean-up) by Scanning IR Spectrometry\***  
EPA method 418.1 or 9073; Standard Methods 5520 C&F

Lab ID	Client ID	Matrix	TRPH*
55616	36	S	1700
Reporting Limit unless otherwise stated; ND means not detected above the reporting limit	W	1.0 mg/L	
	S	10 mg/kg	

\* water samples are reported in mg/L and soils in mg/kg  
 # surrogate diluted out of range  
 + At the laboratory's discretion, one positive sample may be run by direct injection chromatography with FID detection. The following comments pertain to this GC result: a) gasoline-range compounds (C6-C12) are present; b) diesel range compounds (C10-C23) are present; c) oil-range compounds (> C18) are present; d) other patterned solvent (?); e) isolated peaks; f) GC compounds are absent or insignificant relative to TRPH inferring that complex biologically derived molecules (lipids?) are the source of IR absorption; h) a lighter than water immiscible sheen is present; i) liquid sample that contains greater than ~ 5 vol. % sediment.

*[Signature]* Edward Hamilton, Lab Director



**MCCAMPBELL ANALYTICAL**

110-2nd AVENUE, # D7

(510) 708-1620

PACBEKO, CA 94553

FAX (510) 708-1022

4710A202/110

**CHAIN OF CUSTODY - RECORD**

TURN AROUND TIME:

RUSH  24 HOUR  48 HOUR  5 DAY

REPORT TO: Steve H.

BILL TO: Remco

COMPANY: Remco

OWENS FINANCIAL

TELE:

FAX #:

PROJECT NUMBER:

PROJECT NAME: Gen

PROJECT LOCATION: 36th St

SAMPLER SIGNATURE:

SAMPLE ID	LOCATION	SAMPLING		# CONTAINERS	TYPE CONTAINERS
		DATE	TIME		
36		8/21	-	1	blue

Post-it brand fax transmittal memo 7671  
 To: Chuck  
 Co: Senco  
 Dept: Remco  
 From: Robert  
 Co: Remco  
 Phone: 415-572-9734  
 Fax:

ANALYSIS REQUEST		OTHER
<input checked="" type="checkbox"/>	TPH as Gasoline (ASTM D1328)	
<input checked="" type="checkbox"/>	TPH as Diesel (ASTM D1328)	
<input checked="" type="checkbox"/>	Total Petroleum Oil & Grease (EPA 817/5580-94)	
<input checked="" type="checkbox"/>	Total Petroleum Hydrocarbons (TPH)	
<input type="checkbox"/>	EPA 801/8010	
<input type="checkbox"/>	EPA 802/8020	
<input type="checkbox"/>	EPA 808/8080	
<input type="checkbox"/>	EPA 809/8090 - PCBs Only	
<input type="checkbox"/>	EPA 821/8210-8240	
<input type="checkbox"/>	EPA 825/8270	
<input type="checkbox"/>	CAN - 17 Metals	
<input type="checkbox"/>	EPA - Priority Pollutant Metals	
<input type="checkbox"/>	LCAP (7310/7421/2392/6910)	
<input type="checkbox"/>	ORGANIC LEAD	
<input type="checkbox"/>	PC1	
<input checked="" type="checkbox"/>	LEADS	

COMMENTS

55616

RELINQUISHED BY: [Signature]  
 DATE: 8/22/85  
 TIME: 10:10

RECEIVED BY: [Signature]  
 RECEIVED BY: [Signature]  
 RECEIVED BY LABORATORY:

REMARKS:

PRESERVATIVE  
 APPROPRIATE  
 CONTAINERS

ALAMEDA COUNTY HEALTH CARE SERVICES AGENCY  
 DEPARTMENT OF ENVIRONMENTAL HEALTH  
 ENVIRONMENTAL PROTECTION DIVISION  
 1131 HARBOR BAY PARKWAY, RM 250  
 ALAMEDA, CA 94502-6577

PHONE # 510/567-6700  
 FAX # 510/337-9335

*SUSAN L. HUGO*  
 Project Specialist

**ACCEPTED**

Underground Storage Tank Closure Permit Application  
 Alameda County Division of Hazardous Materials  
 80 Swan Way, Suite 200,  
 Oakland, CA 94621  
 Telephone: (510) 271-4320

These closure/removal plans have been received and found to be acceptable and essentially meet the requirements of State and Local Health Laws. Changes to your closure plans indicated by this Department are to assure compliance with State and Local Laws. The revised plan is now released for issuance of any required building permits for construction/destruction. A copy of the accepted plans must be on the job and available to all contractors and craftsmen involved with the removal. Any changes or additions to the plans, modifications, or corrections submitted to this Department within the 72-hour period must be approved by the Department to direct if such changes meet the requirements of State and Local Laws.

Notify this Department at least 72 hours prior to the following required inspections:

- Removal of Tank(s) and Piping
- Sampling
- Final Inspection

Issuance of a) permit to operate, b) permanent site closure is dependant on compliance with accepted plans and all applicable laws and regulations.

**\*THERE IS A FINANCIAL PENALTY FOR NOT OBTAINING THESE INSPECTIONS**

Contact Specialist:

*Susan L. Hugo*  
 8/18/95

**UNDERGROUND TANK CLOSURE PLAN**

**\* \* \* Complete according to attached instructions \* \* \***

1. Name of Business OWENS FINANCIAL GROUP, INC.  
 Business Owner or Contact Person (PRINT) SCOTT BARDE (510) 935-3840

2. Site Address 3623 ADELINE STREET  
 City EMERYVILLE Zip 94608 Phone -

3. Mailing Address OWENS FINANCIAL GROUP, INC., P.O. BOX 2308  
 City WALNUT CREEK Zip 94595 Phone (510) 935-3840

4. Property Owner OWENS MORTGAGE INVESTMENT FUND  
 Business Name (if applicable) N/A  
 Address P.O. BOX 2308  
 City, State WALNUT CREEK CA Zip 94595

5. Generator name under which tank will be manifested  
OWENS MORTGAGE INVESTMENT FUND

EPA ID# under which tank will be manifested C A C 0 0 0 9 3 5 4 0 0

6. Contractor SEMCO  
Address 1741 LESLIE STREET  
City SAN MATEO, CA 94402 Phone (415) 572-8033  
A,B,C-61/D-40  
License Type HAZ MAT ID# 449864

\*Effective January 1, 1992, Business and Professional Code Section 7058.7 requires prime contractors to also hold Hazardous Waste Certification issued by the State Contractors License Board.

7. Consultant (if applicable) N/A  
Address \_\_\_\_\_  
City, State \_\_\_\_\_ Phone \_\_\_\_\_

8. Main Contact Person for Investigation (if applicable)  
Name CHUCK KIPER Title VICE PRESIDENT  
Company SEMCO  
Phone (415) 572-8033

9. Number of underground tanks being closed with this plan 1  
Length of piping being removed under this plan UNKNOWN  
Total number of underground tanks at this facility (\*\*confirmed with owner or operator) 1

10. State Registered Hazardous Waste Transporters/Facilities (see instructions).

\*\* Underground storage tanks must be handled as hazardous waste \*\*

a) Product/Residual Sludge/Rinsate Transporter  
Name ALLIED PETROLEUM EPA I.D. No. CAL 000112314  
Hauler License No. 1168 License Exp. Date 4-30-96  
Address 1217 S. 7TH STREET  
City MODESTO State CA Zip 95351

b) Product/Residual Sludge/Rinsate Disposal Site  
Name ENVIROPUR WEST EPA ID# CAD 083166728  
Address 13331 WEST HIGHWAY 33  
City PATTERSON State CA Zip 95363

c) Tank and Piping Transporter

Name RICH HAMILTON TRUCKING EPA I.D. No. CAL 000112413  
Hauler License No. 2753 License Exp. Date 4-30-96  
Address 1217 S. 7TH STREET  
City MODESTO State CA Zip 95351

d) Tank and Piping Disposal Site

Name ERICKSON, INC. EPA I.D. No. CAD 009466392  
Address 255 PARR BLVD.  
City RICHMOND State CA Zip 94801

11. Sample Collector

Name CHUCK KIPER  
Company SEMCO  
Address 1741 LESLIE STREET  
City SAN MATEO State CA Zip 94402 Phone (415) 572-8033

12. Laboratory

Name NORTH STATE ENVIRONMENTAL  
Address 90 W. SOUTH SPRUCE AVENUE  
City SOUTH SAN FRANCISCO State CA Zip 94080  
State Certification No. 1735

13. Have tanks or pipes leaked in the past? Yes[ ] No[ ] Unknown[X]

If yes, describe. \_\_\_\_\_  
\_\_\_\_\_  
\_\_\_\_\_

14. Describe methods to be used for rendering tank(s) inert:

HIGH PRESSURE HOT WATER DETERGENT WASH, 20 LBS PER

1000 GALLONS DRY ICE

Before tanks are pumped out and inerted, all associated piping must be flushed out into the tanks. All accessible associated piping must then be removed. Inaccessible piping must be permanently plugged.

The Bay Area Air Quality Management District, 415/771-6000, along with local Fire and Building Departments, must also be contacted for tank removal permits. Fire departments typically require the use of a combustible gas indicator to verify tank inertness. It is the contractor's responsibility to bring a working combustible gas indicator on-site to verify that the tank is inert.

15. Tank History and Sampling Information \*\*\* (see instructions) \*\*\*

Tank		Material to be sampled (tank contents, soil, groundwater)	Location and Depth of Samples
Capacity	Use History include date last used (estimated)		
5000 GALLON	DIESEL UNKNOWN	SOIL/WATER IF ENCOUNTERED	2 FEET BELOW TANK IN NATIVE SOIL

One soil sample must be collected for every 20 linear feet of piping that is removed. A ground water sample must be collected if any ground water is present in the excavation.

**Excavated/Stockpiled Soil**

<p><b>Stockpiled Soil Volume (estimated)</b></p> <p>UNKNOWN UNTIL TANK IS REMOVED</p>	<p align="center"><b>Sampling Plan</b></p> <p>SOIL SAMPLES TAKEN FROM THE TANK EXCAVATION WILL BE COLLECTED, PLACED IN BRASS TUBES, SEALED WITH FOIL, TEFLON CAPS, SEALED WITH APPROVED TAPE, PLACED ON ICE, TRANSPORTED TO STATE CERTIFIED LAB UNDER CHAIN OF CUSTODY AND ANALYZED FOR CONSTITUENTS OF TANK.</p>
---	---

Stockpiled soil must be placed on bermed plastic and must be completely covered by plastic sheeting.

Will the excavated soil be returned to the excavation immediately after tank removal? [ ] yes [ x ] no [ ] unknown

If yes, explain reasoning \_\_\_\_\_

If unknown at this point in time, please be aware that excavated soil may not be returned to the excavation without prior approval from Alameda County. This means that the contractor, consultant, or responsible party must communicate with the Specialist IN ADVANCE of backfilling operations.

16. Chemical methods and associated detection limits to be used for analyzing samples:

The Tri-Regional Board recommended minimum verification analyses and practical quantitation reporting limits should be followed. See attached Table 2.

17. Submit Site Health and Safety Plan (See Instructions)

Contaminant Sought	EPA or Other Sample Preparation Method Number	EPA or Other Analysis Method Number	Method Detection Limit
<p>Diesel, <del>                    </del> <del>                    </del></p>	<p>TPH D BTX&amp;E TPH AND BTX&amp;E 8260.</p>	<p>GCFID (3550) 8020 or 8240</p> <p>TPH D BTX&amp;E</p>	<p>GCFID (3510) 602, 624 or 8260</p>

- 18. Submit Worker's Compensation Certificate copy  
Name of Insurer GOLDEN EAGLE INSURANCE COMPANY
- 19. Submit Plot Plan **\*\*\* (See Instructions) \*\*\***
- 20. Enclose Deposit (See Instructions)
- 21. Report any leaks or contamination to this office within 5 days of discovery.  
The written report shall be made on an Underground Storage Tank Unauthorized Leak/Contamination Site Report (ULR) form.
- 22. Submit a closure report to this office within 60 days of the tank removal. The report must contain all information listed in item 22 of the instructions.
- 23. Submit State (Underground Storage Tank Permit Application) Forms A and B (one B form for each UST to be removed) (mark box 8 for "tank removed" in the upper right hand corner)

I declare that to the best of my knowledge and belief that the statements and information provided above are correct and true.

I understand that information, in addition to that provided above, may be needed in order to obtain approval from the Environmental Protection Division and that no work is to begin on this project until this plan is approved.

I understand that any changes in design, materials or equipment will void this plan if prior approval is not obtained.

I understand that all work performed during this project will be done in compliance with all applicable OSHA (Occupational Safety and Health Administration) requirements concerning personnel health and safety. I understand that site and worker safety are solely the responsibility of the property owner or his agent and that this responsibility is not shared nor assumed by the County of Alameda.

Once I have received my stamped, accepted closure plan, I will contact the project Hazardous Materials Specialist at least three working days in advance of site work to schedule the required inspections.

CONTRACTOR INFORMATION

Name of Business SEMCO

Name of Individual CHUCK KIBER

Signature *Chuck Kiber* Date 8-15-95

PROPERTY OWNER OR MOST RECENT TANK OPERATOR (Circle one)

Name of Business OWENS MORTGAGE INVESTMENT FUNDS

Name of Individual BY: ~~Scott~~ SCOTT P WARDE, VP

Signature *Scott Warde* Date 8/15/95

ALAMEDA COUNTY, DEPARTMENT OF ENVIRONMENTAL HEALTH  
**Hazardous Materials Inspection Form**

1131 Harbor Bay Pkwy.  
 Suite 250  
 Alameda, CA 94502-6577  
 (510) 567-6700

II, III

\* Transfer to LOP  
 need ULR  
 white - env. health  
 yellow - facility  
 pink - files

Site ID # 5308 Site Name Owens Financial Today's Date 8/31/95

Site Address 3623 Adeline Street  
 City Emeryville Zip 94608 Phone \_\_\_\_\_

- II.A BUSINESS PLANS (Title 19)
- \_\_\_ 1. Immediate Reporting 2703
  - \_\_\_ 2. Bus. Plan Stds 25503(b)
  - \_\_\_ 3. RR Cars > 30 days 25503.7
  - \_\_\_ 4. Inventory Information 25504(a)
  - \_\_\_ 5. Inventory Complete 2730
  - \_\_\_ 6. Emergency Response 25504(b)
  - \_\_\_ 7. Training 25504(c)
  - \_\_\_ 8. Deficiency 25505(a)
  - \_\_\_ 9. Modification 25505(b)

- II.B ACUTELY HAZ MATS
- \_\_\_ 10. Registration Form Filed 25533(a)
  - \_\_\_ 11. Form Complete 25533(b)
  - \_\_\_ 12. RMPP Contents 25534(c)
  - \_\_\_ 13. Implement Sch. Req'd? (Y/N)
  - \_\_\_ 14. OnSite Conseq. Assess. 25524(c)
  - \_\_\_ 15. Probable Risk Assessment 25534(d)
  - \_\_\_ 16. Persons Responsible 25534(g)
  - \_\_\_ 17. Certification 25534(i)
  - \_\_\_ 18. Exemption Request? (Y/N)
  - \_\_\_ 19. Trade Secret Requested? 25538

- III. UNDERGROUND TANKS (Title 23)
- General
- \_\_\_ 1. Permit Application 25284 (H&S)
  - \_\_\_ 2. Pipeline Leak Detection 25292 (H&S)
  - \_\_\_ 3. Records Maintenance 2712
  - \_\_\_ 4. Release Report 2651
  - \_\_\_ 5. Closure Plans 2670

- Monitoring for Existing Tanks
- \_\_\_ 6. Method
  - 1) Monthly Test
  - 2) Daily Vadose  
Semi-annual groundwater  
One time soils
  - 3) Daily Vadose  
One time soils  
Annual tank test
  - 4) Monthly Gndwater  
One time soils
  - 5) Daily Inventory  
Annual tank testing  
Cont pipe leak det  
Vadose/gndwater mon.
  - 6) Daily Inventory  
Annual tank testing  
Cont pipe leak det
  - 7) Weekly Tank Gauge  
Annual tank testing
  - 8) Annual Tank Testing  
Daily Inventory
  - 9) Other \_\_\_\_\_

- \_\_\_ 7. Precs Tank Test 2643  
Date: \_\_\_\_\_
- \_\_\_ 8. Inventory Rec. 2644
- \_\_\_ 9. Soil Testing 2646
- \_\_\_ 10. Ground Water 2647

- New Tanks
- \_\_\_ 11. Monitor Plan 2632
  - \_\_\_ 12. Access. Secure 2634
  - \_\_\_ 13. Plans Submlt 2711  
Date: \_\_\_\_\_
  - \_\_\_ 14. As Built 2635  
Date: \_\_\_\_\_

MAX AMT stored > 500 lbs, 55 gal., 200 cft.?  
Inspection Categories:  
 \_\_\_ I. Haz. Mat/Waste GENERATOR/TRANSPORTER  
 \_\_\_ II. Business Plans, Acute Hazardous Materials  
 III. Underground Tanks Excavation - for tank disposal  
for tank manifest # 92863888 site.

\* Calif. Administration Code (CAC) or the Health & Safety Code (HS&C)

George Warren - Emeryville Fire Dept on site.

Comments:  
 1- 2,500 gal steel tank removed at the site  
inside the Bldg. Per Mr. Scott Burke  
of Owens Financial the site used to be a  
commercial laundry. The tank may have  
been used to store heating oil. The  
north end tank bottom had an opening  
(approx 3-4 inches in diameter) which appeared  
to be piping connection.  
LEL = 3% O2 = 8%

Strong HC odor; need to ventilate & circulate  
the air; monitor air for vapors; heavy soil  
at bottom; product saturated soil at the  
bottom of the excavation &  
piping associated with the tank must  
be removed/capped.

Stockpiled soil must be characterized for  
disposal; covered with visqueen  
Product saturated soil removed from the  
bottom of the excavation

Rev 8/88

II, III

Contact: \_\_\_\_\_

Title: \_\_\_\_\_

Signature: James Peterson

Inspector: SUSAN L. HUGO

Signature: Susan L. Hugo



ALAMEDA COUNTY, DEPARTMENT OF  
 ENVIRONMENTAL HEALTH  
 Hazardous Materials Inspection Form

white -env.health  
 yellow -facility  
 pink -files

II, III

Site ID # 5305 Site Name Owens Financial Today's Date 8/31/95

Site Address 3623 Adeline Street.

City Emeryville Zip 94608 Phone \_\_\_\_\_

MAX AMT stored > 500 lbs, 55 gal., 200 cft.?

**Inspection Categories:**

- I. Haz. Mat/Waste GENERATOR/TRANSPORTER
- II. Business Plans, Acute Hazardous Materials
- III. Underground Tanks

\* Calif. Administration Code (CAC) or the Health & Safety Code (HS&C)

**Comments:**

*On site for sampling; tank removed this morning.*  
*2 soil samples collected - one from each end of the tank.*  
*North end sample collected at approx 9 ft bgs -*  
*but end sample collected at approx 14 ft bgs.*  
*One bottom sample (middle) collected (on hold).*  
*Soil appeared to be tight clay.*

- II.A BUSINESS PLANS (Title 19)**
- 1. Immediate Reporting 2703
  - 2. Bus Plan Stds 25503(b)
  - 3. RR Cars > 30 days 25503.7
  - 4. Inventory Information 25504(a)
  - 5. Inventory Complete 2730
  - 6. Emergency Response 25504(b)
  - 7. Training 25504(c)
  - 8. Deficiency 25505(a)
  - 9. Modification 25505(b)

- II.B ACUTELY HAZ. MATLS**
- 10. Registration Form Filed 25533(a)
  - 11. Form Complete 25533(b)
  - 12. RMPP Contents 25534(c)
  - 13. Implement Sch. Req'd? (Y/N) \_\_\_\_\_
  - 14. OffSite Conseq. Assess. 25524(c)
  - 15. Probable Risk Assessment 25534(d)
  - 16. Persons Responsible 25534(g)
  - 17. Certification 25534(f)
  - 18. Exemption Request? (Y/N) \_\_\_\_\_
  - 19. Trade Secret Requested? 25538

- III. UNDERGROUND TANKS (Title 23)**
- General:
- 1. Permit Application 25284 (H&S)
  - 2. Pipeline Leak Detection 25292 (H&S)
  - 3. Records Maintenance 2712
  - 4. Release Report 2651
  - 5. Closure Plans 2670

- Monitoring for Existing Tanks
- 6. Method
    - 1) Monthly Test
    - 2) Daily Vadose  
Semi-annual groundwater  
One time soils
    - 3) Daily Vadose  
One time soils  
Annual tank test
    - 4) Monthly Gndwater  
One time soils
    - 5) Daily Inventory  
Annual tank testing  
Cont pipe leak det  
Vadose/gndwater mon.
    - 6) Daily Inventory  
Annual tank testing  
Cont pipe leak det
    - 7) Weekly Tank Gauge  
Annual tank testing
    - 8) Annual Tank Testing  
Daily Inventory
    - 9) Other \_\_\_\_\_
  - 7. Precls Tank Test 2643  
Date: \_\_\_\_\_
  - 8. Inventory Rec. 2644
  - 9. Soil Testing 2646
  - 10. Ground Water. 2647

- New Tanks
- 11. Monitor Plan 2632
  - 12. Access Secure 2634
  - 13. Plans Submit 2711  
Date: \_\_\_\_\_
  - 14. As Built 2635  
Date: \_\_\_\_\_

Rev 6/88

II, III

Contact: \_\_\_\_\_

Title: \_\_\_\_\_

Signature: James Cochran

Inspector: \_\_\_\_\_

Signature: Susan J. Hergo

white -env.health  
 yellow -facility  
 pink -files

ALAMEDA COUNTY, DEPARTMENT OF ENVIRONMENTAL HEALTH  
 Hazardous Materials Inspection Form

1131 Harbor Bay Pkwy.  
 Suite 250  
 Alameda, CA 94502-6577  
 (510) 567-6700

II, III

Site ID # 5305 Site Name Owens Financial Today's Date 9/5/95

II.A BUSINESS PLANS (Title 19)

- 1. Immediate Reporting 2703
- 2. Bus. Plan Stds. 25503(b)
- 3. RR Cars > 30 days 25503.7
- 4. Inventory Information 25504(a)
- 5. Inventory Complete 2730
- 6. Emergency Response 25504(b)
- 7. Training 25504(c)
- 8. Deficiency 25505(a)
- 9. Modification 25505(b)

Site Address 3623 Adeline Street  
 City Emeryville Zip 94608 Phone \_\_\_\_\_

MAX AMT stored > 500 lbs, 55 gal., 200 cft.?

Inspection Categories:

- I. Haz. Mat/Waste GENERATOR/TRANSPORTER
- II. Business Plans, Acute Hazardous Materials
- III. Underground Tanks

\* Calif. Administration Code (CAC) or the Health & Safety Code (HS&C)

II.B ACUTELY HAZ. MATLS

- 10. Registration Form Filed 25533(a)
- 11. Form Complete 25533(b)
- 12. RMPP Contents 25534(c)
- 13. Implement Sch. Req'd? (Y/N)
- 14. OffSite Conseq. Assess 25524(c)
- 15. Probable Risk Assessment 25534(d)
- 16. Persons Responsible 25534(g)
- 17. Certification 25534(f)
- 18. Exemption Request? (Y/N) 25536(b)
- 19. Trade Secret Requested? 25538

III. UNDERGROUND TANKS (Title 23)

- |  |   |
|--|---|
| General  | <input type="checkbox"/> 1. Permit Application 25284 (H&S)      |
|  | <input type="checkbox"/> 2. Pipeline Leak Detection 25292 (H&S) |
|  | <input type="checkbox"/> 3. Records Maintenance 2712            |
|  | <input type="checkbox"/> 4. Release Report 2651                 |
|  | <input type="checkbox"/> 5. Closure Plans 2670                  |
| Monitoring for Existing Tanks                    | <input type="checkbox"/> 6. Method                              |
|  | 1) Monthly Test   |
|  | 2) Daily Vadose   |
|  | Semi-annual groundwater   |
|  | One time soils  |
|  | 3) Daily Vadose   |
|  | One time soils  |
|  | Annual tank test  |
|  | 4) Monthly Gndwater   |
|  | One time soils  |
| 5) Daily Inventory                               |   |
| Annual tank testing                              |   |
| Cont pipe leak det                               |   |
| Vadose/gndwater mon.                             |   |
| 6) Daily Inventory                               |   |
| Annual tank testing                              |   |
| Cont pipe leak det                               |   |
| 7) Weekly Tank Gauge                             |   |
| Annual tank teting                               |   |
| 8) Annual Tank Testing                           |   |
| Daily Inventory                                  |   |
| 9) Other _____                                   |   |
| New Tanks  | <input type="checkbox"/> 7. Precls Tank Test 2643               |
|  | Date: _____   |
|  | <input type="checkbox"/> 8. Inventory Rec. 2644                 |
|  | <input type="checkbox"/> 9. Sol Testing 2646                    |
| <input type="checkbox"/> 10. Ground Water. 2647  |   |
| <input type="checkbox"/> 11. Monitor Plan 2632   |   |
| <input type="checkbox"/> 12. Access, Secure 2634 |   |
| <input type="checkbox"/> 13. Plans Submit 2711   |   |
| Date: _____                                      |   |
| <input type="checkbox"/> 14. As Built 2635       |   |
| Date: _____                                      |   |

Bottom - 9 ft  
 Cont 47 ft  
 West  
 underneath the pipes

Comments:  
 On site grc sampling:  
 Limited excavation  
 around the tank area.  
 4 soil samples collected:  
 east & west wall, 1 bottom sample  
 & one sample underneath the  
 piping. Analyze for TPH/diesel  
 & BTX.  
 All piping associated with the  
 tank must be removed or  
 properly abandoned.  
 Excavation pit must be  
 backfilled with clean fill.

Contact: \_\_\_\_\_

Title: \_\_\_\_\_

Signature: James Pittman

Inspector: SUSAN L. HUGO

Signature: Susan L. Hugo

II, III

92863888

IN CASE OF EMERGENCY OR SPILL, CALL THE NATIONAL RESPONSE CENTER 1-800-424-8802; WITHIN CALIFORNIA, CALL 1-800-852-7550

<b>UNIFORM HAZARDOUS WASTE MANIFEST</b>		1. Generator's US EPA ID No. <b>CA19010935410054366</b>		Manifest Document No. <b>1 of 1</b>		2. Page 1		Information in the shaded areas is not required by Federal law.			
3. Generator's Name and Mailing Address <b>OWENS FINANCIAL GROUP INC. P.O. BOX 2308 WALNUT CREEK, CA. 94595</b>				A. State Manifest Document Number <b>92863888</b>		B. State Generator's ID					
4. Generator's Phone <b>(510) 935-3840</b>				C. State Transporter's ID <b>6029142</b>		D. Transporter's Phone <b>(909) 578-9100</b>					
5. Transporter 1 Company Name <b>R.H.T.</b>				6. US EPA ID Number <b>KA1C101001112413</b>		E. State Transporter's ID					
7. Transporter 2 Company Name				8. US EPA ID Number		F. Transporter's Phone					
9. Designated Facility Name and Site Address <b>EPICKSON INC. 255 PARRIS BLVD. RICHMOND, CA - 94801</b>				10. US EPA ID Number <b>CA1901094663912</b>		G. State Facility ID <b>CA190094607221</b>					
11. US DOT Description (including Proper Shipping Name, Hazard Class, and ID Number)  a. <b>NON RCRA HAZ. WASTE WASTE EMPTY STORAGE TANK SOLID</b>				12. Containers		13. Total Quantity		14. Unit			
				No.		Type		Wt/Vol		EPA/Other	
						<b>0101 TIP</b>		<b>02500</b>		<b>P</b>	
Additional Description for Materials Listed Above <b>EMPTY STORAGE TANK HAS BEEN REWORKED WITH 100 LBS. OF INSULATION</b>						K. Handling Codes for Wastes Listed Above					
						a. <b>01</b>					
						b.					
						c.					
						d.					
15. Special Handling Instructions and Additional Information <b>Keep away from sources of ignition and always wear handhats.</b>											
16. GENERATOR'S CERTIFICATION: I hereby declare that the contents of the consignment are fully and accurately described above by proper shipping name and are classified, packed, marked, and labeled, and are in all respects in proper condition for transport by highway according to applicable federal, state and international laws.  If I am a large quantity generator, I certify that I have a program in place to reduce the volume and toxicity of waste generated to the degree I have determined to be economically practicable and that I have selected the practicable method of treatment, storage, or disposal currently available to me which minimizes the present and future threat to human health and the environment; OR, if I am a small quantity generator, I have made a good faith effort to minimize my waste generation and select the best waste management method that is available to me and that I can afford.											
Printed/Typed Name <b>SCOTT P BARDE VP</b>				Signature <i>[Signature]</i>		Month <b>08</b>		Day <b>31</b>		Year <b>1995</b>	
17. Transporter 1 Acknowledgement of Receipt of Materials Printed/Typed Name <b>BRENT BRAUN</b>				Signature <i>[Signature]</i>		Month <b>08</b>		Day <b>31</b>		Year <b>1995</b>	
18. Transporter 2 Acknowledgement of Receipt of Materials Printed/Typed Name				Signature		Month		Day		Year	
19. Discrepancy Indication Space											
20. Facility Owner or Operator Certification of receipt of hazardous materials covered by this manifest except as noted in Item 19. Printed/Typed Name <b>DAVID SATO</b>											
				Signature <i>[Signature]</i>		Month <b>08</b>		Day <b>31</b>		Year <b>1995</b>	

DO NOT WRITE BELOW THIS LINE.

Whites: DTSC SENDS THIS COPY TO DTSC WITHIN 30 DAYS  
 To: P.O. Box 3000, Sacramento, CA 95812

DAY OR NIGHT  
TELEPHONE  
(510) 235-1393

# CERTIFICATE CERTIFIED SERVICES COMPANY

255 Parr Boulevard • Richmond, California 94801

NO. 17965

CUSTOMER

SEMCO II  
JOB NO.

066537

FOR: ERICKSON, INC. TANK NO. 16454

LOCATION: RICHMOND DATE: 95/09/20 TIME: 14:49

TEST METHOD VISUAL GASTECH/1314 SMPN LAST PRODUCT HO

This is to certify that I have personally determined that this tank is in accordance with the American Petroleum Institute and have found the condition to be in accordance with its assigned designation. This certificate is based on conditions existing at the time the inspection herein set forth was completed and is issued subject to compliance with all qualifications and instructions.

TANK SIZE 2500 GALLON TANK CONDITION SAFE FOR FIRE

REMARKS: ~~OXYGEN 20.9% LOWER EXPLOSIVE LIMIT LESS THAN 0.1%~~  
ERICKSON, INC. HEREBY CERTIFIES THAT THE ABOVE NUMBERED TANK HAS BEEN  
~~CUT OPEN, PROCESSED, AND THEREFORE DESTROYED AT OUR PERMITTED HAZARDOUS~~  
~~WASTE FACILITY.~~  
~~ERICKSON, INC. HAS THE APPROPRIATE PERMITS FOR, AND HAS ACCEPTED THE TANK~~  
~~SHIPPED TO US FOR PROCESSING.~~

In the event of any physical or atmospheric changes affecting the gas-free conditions of the above tanks, or if in any doubt, immediately stop all hot work and contact the undersigned. This permit is valid for 24 hours if no physical or atmospheric changes occur.

## STANDARD SAFETY DESIGNATION

**SAFE FOR MEN:** Means that in the compartment or space so designated (a) The oxygen content of the atmosphere is at least 19.5 percent by volume; and that (b) Toxic materials in the atmosphere are within permissible concentrations; and (c) In the judgment of the Inspector, the residues are not capable of producing toxic materials under existing atmospheric conditions while maintained as directed on the Inspector's certificate.

**SAFE FOR FIRE:** Means that in the compartment so designated (a) The concentration of flammable materials in the atmosphere is below 10 percent of the lower explosive limit; and that (b) In the judgment of the Inspector, the residues are not capable of producing a higher concentration that permitted under existing atmospheric conditions in the presence of fire and while maintained as directed on the Inspector's certificate, and further, (c) All adjacent spaces have either been cleaned sufficiently to prevent the spread of fire, are satisfactorily inerted, or in the case of fuel tanks, have been treated as deemed necessary by the Inspector.

The undersigned representative acknowledges receipt of this certificate and understands the conditions and limitations under which it was issued.

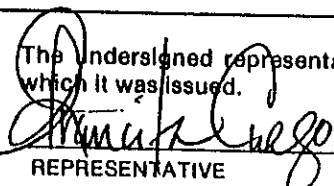
  
REPRESENTATIVE

TITLE

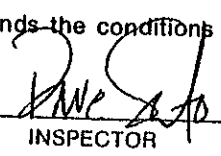
  
INSPECTOR

IN CASE OF EMERGENCY OR SPILL, CALL THE NATIONAL RESPONSE CENTER 1-800-424-8802; WITHIN CALIFORNIA, CALL 1-800-852-7550

<b>UNIFORM HAZARDOUS WASTE MANIFEST</b>		1. Generator's US EPA ID No. <b>CA16010109354100</b>		Manifest Document No. <b>413182A</b>		2. Page 1 of 1		Information in the shaded areas is not required by Federal law.									
3. Generator's Name and Mailing Address <b>OWENS MORTGAGE INVESTMENT FUND P.O. Box 2308 WAINUT CREEK, CA 94595</b>						A. State Manifest Document Number <b>95643829</b>											
4. Generator's Phone <b>(510) 935-3240</b>						B. State Generator's ID											
5. Transporter 1 Company Name <b>EVERGREEN ENVIRONMENTAL SERVICES</b>				6. US EPA ID Number <b>CA16010109354100</b>		C. State Transporter's ID <b>610571</b>		D. Transporter's Phone <b>(510) 795-4400</b>									
7. Transporter 2 Company Name						E. State Transporter's ID											
8. US EPA ID Number						F. Transporter's Phone											
9. Designated Facility Name and Site Address <b>EVERGREEN OIL, INC. NEWARK, CA 94630</b>						10. US EPA ID Number <b>CA16010109354100</b>		G. State Facility's ID <b>CA16010109354100</b>									
H. Facility's Phone <b>(510) 795-4400</b>																	
11. US DOT Description (including Proper Shipping Name, Hazard Class, and ID Number)  a. <b>OIL + WATER NON-FLAMMABLE HAZARDOUS WASTE, LIQUID</b>						12. Containers		13. Total Quantity		14. Unit Wt/Vol		I. Waste Number					
						No.		Type						State		EPA/Other	
						001		TT		22500		G		221		NONE	
														State		EPA/Other	
														State		EPA/Other	
J. Additional Descriptions for Materials Listed Above						K. Handling Codes for Wastes Listed Above											
a.						b.											
c.						d.											
15. Special Handling Instructions and Additional Information <b>IN EMERGENCY CALL 911 WEAR PROTECTIVE EQUIPMENT</b>						16. GENERATOR'S CERTIFICATION: I hereby declare that the contents of this consignment are fully and accurately described above by proper shipping name and are classified, packed, marked, and labeled, and are in all respects in proper condition for transport by highway according to applicable international and national government regulations.  If I am a large quantity generator, I certify that I have a program in place to reduce the volume and toxicity of waste generated to the degree I have determined to be economically practicable and that I have selected the practicable method of treatment, storage, or disposal currently available to me which minimizes the present and future threat to human health and the environment; OR, if I am a small quantity generator, I have made a good faith effort to minimize my waste generation and select the best waste management method that is available to me and that I can afford.											
Printed/Typed Name <b>SCOTT P ISACOFF</b>				Signature <i>[Signature]</i>		Month		Day		Year							
17. Transporter 1 Acknowledgement of Receipt of Materials				Printed/Typed Name <b>Lika Posten</b>		Signature <i>[Signature]</i>		Month		Day		Year					
18. Transporter 2 Acknowledgement of Receipt of Materials				Printed/Typed Name		Signature		Month		Day		Year					
19. Discrepancy Indication Space																	
20. Facility Owner or Operator Certification of receipt of hazardous materials covered by this manifest except as noted in Item 19.																	
Printed/Typed Name						Signature			Month			Day			Year		

DO NOT WRITE BELOW THIS LINE.

REMEDIAL ENVIRONMENTAL MARKETING, INC.

PH. (510) 237-5866  
2717 GOODRICK AVENUE  
RICHMOND, CA 94801

GEMCO

SEP - 9 1995

# Invoice

DATE	INVOICE #
------	-----------

9/5/95

2050

**BILL TO:**

SEMCO  
1741 Leslie St.  
San Mateo, CA 94402

**SHIP TO:**

F-142

P.O. NUMBER	TERMS	REP	SHIP	VIA	F.O.B.	PROJECT
-------------	-------	-----	------	-----	--------	---------

Net 15      SH      09/05/95      Truck      Walnut Creek

QUANTITY	ITEM CODE	DESCRIPTION	PRICE EACH	AMOUNT
----------	-----------	-------------	------------	--------

54.34	4001	Soil Treatment		
-------	------	----------------	--	--

**TOTAL**

REMCO SCALE LOG		8-31-95							
TRUCK NUMBER	TIME IN	GROSS WEIGHT	WEIGHT	NET WEIGHT	JOB NUM	TONS/LOAD	BILL OF LADING #		
21	1419	36,810	20,060	16,750	f142	8.38	96326		
930	1804	65,070	33,360	31,710	f142	15.86	96329		
0	0	0	0	0	0	0.00			
0	0	0	0	0	0	0.00			
0	0	0	0	0	0	0.00			
		101880	53420	48460	24.24				
TOTAL GROSS		TOTAL TARE	TOTAL NET WEIGHT	TOTAL TONS					

REMCO TRUCK NUMBER	SCALE IN	LOG GROSS WEIGHT	9-1-95 TARE WEIGHT	NET WEIGHT	JOB NUM	TONS/LOAD	BILL OF LADING #
21	1034	42,580	20,200	22,380	f142	11.19	96327
21	1322	39,830	20,200	19,630	f142	9.81	96328
21	1502	38,400	20,200	18,200	f142	9.10	96355
0	0	0	0	0	0	0.00	
0	0	0	0	0	0	0.00	
		120810	60600	60210	30.1		

TOTAL GROSS	TOTAL TARE	TOTAL NET WEIGHT	TOTAL TONS
-------------	------------	------------------	------------



**MATERIALS MANIFEST**

**GENERATOR** Querus Financial  
 Site Address 3623 Adeline, Emeryville Ca.  
 Mailing P.O. Box 2308 Walnut Creek, Ca. 94595  
 Phone: (510) 935-3840 Contact: Scott Bardo

**TRANSPORTER** Aemco  
 Address 1217 S. 7th St. Modesto, Ca 95351  
 Phone: (209) 524-9653 Contact: Ang Fleming

I hereby certify that the above named material was picked up at the generator site listed above.  
 Driver Name: James [unclear] Sr. Signature [Signature]  
 Truck No. Unit #21 Ship Date: 9-1-95  
 Time of Pick-Up: \_\_\_\_\_ Time of Delivery: \_\_\_\_\_

**Consultant/Owner** Aemco  
 Address 1217 S. 7th St. Modesto Ca. 95351  
 Phone: (209) 524-9653 Contact: Ang Fleming

I hereby certify that the above named material is consistent with the information presented in the Waste Characterization Form and Contaminated Soil Description Form, and has been properly described, classified and packaged, and is in proper condition for transport according to applicable regulation.  
 Name James [unclear] (owner) Date: 9-1-95

**Recycling Facility** REMEDIAL ENVIRONMENTAL MARKETING CO. INC.  
2717 GOODRICK AVENUE RICHMOND, CA 94801

RECEIVED BY: \_\_\_\_\_  
 DATE: 9-1-95  
 Control No: 1-142

A COPY OF THIS SHEET MUST ACCOMPANY EVERY LOAD, AND MUST BE SUBMITTED AT THE GATE FOR ENTRY. ALL LOADS MUST BE SCHEDULED AT LEAST 24 HOURS IN ADVANCE. DELIVERIES MUST BE SCHEDULED ON A DAILY BASIS. ANY UNSCHEDULED LOADS MAY BE REFUSED AT THE GATE.

**MATERIALS MANIFEST**

**GENERATOR**

*Owens Financial*

Site Address 3623 Adeline  
Mailing P.O. Box 2308 Walnut Creek, Ca. 94595  
Phone: (510) 935-3840 Contact: Scott Bards

**TRANSPORTER**

*Rich Hamilton Trucking*

Address 1336 Prairie Ave Modesto Ca 95350  
Phone: (209) 578-4150 Contact: Scott Meller

I hereby certify that the above named material was picked up at the generator site listed above.

Driver Name: BERT BRAUN Signature Bert Braun  
Truck No. 930 Ship Date: 8-31-95  
Time of Pick-Up: 4:30 pm Time of Delivery: \_\_\_\_\_

**Consultant/Owner**

*Senco*

Address 1217 S. 7th St. Modesto, Ca. 95351  
Phone: (209) 524-9653 Contact: Doug Flamming

I hereby certify that the above named material is consistent with the information presented in the Waste Characterization Form and Contaminated Soil Description Form, and has been properly described, classified and packaged, and is in proper condition for transport according to applicable regulation.

Name James Anderson (Senco) Date: 8-31-95

**Recycling Facility**

REMEDIAL ENVIRONMENTAL MARKETING CO. INC.  
2717 GOODRICK AVENUE RICHMOND, CA 94801

RECEIVED BY: \_\_\_\_\_  
DATE: \_\_\_\_\_ 8-31-95  
Control No: PS142

A COPY OF THIS SHEET MUST ACCOMPANY EVERY LOAD, AND MUST BE SUBMITTED AT THE GATE FOR ENTRY. ALL LOADS MUST BE SCHEDULED AT LEAST 24 HOURS IN ADVANCE. DELIVERIES MUST BE SCHEDULED ON A DAILY BASIS. ANY UNSCHEDULED LOADS MAY BE REFUSED AT THE GATE.

**MATERIALS MANIFEST**

**GENERATOR**

Site Address 3623 Cedraline  
Mailing COOK - Ca.  
Phone: ( ) \_\_\_\_\_ Contact: \_\_\_\_\_

**TRANSPORTER**

Address SEMCOR  
12750. 7th St. Modesto  
Phone: (409) 524-9653 Contact: \_\_\_\_\_

I hereby certify that the above named material was picked up at the generator site listed above.

Driver Name: X BRIDY CUNNINGHAM SR. Signature [Signature]  
Truck No. X 21 Ship Date: \_\_\_\_\_  
Time of Pick-Up: \_\_\_\_\_ Time of Delivery: \_\_\_\_\_

**Consultant/Owner**

Address SEMCOR  
1741 Healy St.  
San Mateo - Ca.  
Phone: ( ) 415-572-8033 Contact: CHUCK K.

I hereby certify that the above named material is consistent with the information presented in the Waste Characterization Form and Contaminated Soil Description Form, and has been properly described, classified and packaged, and is in proper condition for transport according to applicable regulation.

Name \_\_\_\_\_ Date: 8-31-95

**Recycling Facility**

REMEDIAL ENVIRONMENTAL MARKETING CO. INC.  
2717 GOODRICK AVENUE RICHMOND, CA 94801

RECEIVED BY: [Signature]  
DATE: 8-31-95  
Control No: F-142

A COPY OF THIS SHEET MUST ACCOMPANY EVERY LOAD, AND MUST BE SUBMITTED AT THE GATE FOR ENTRY. ALL LOADS MUST BE SCHEDULED AT LEAST 24 HOURS IN ADVANCE. DELIVERIES MUST BE SCHEDULED ON A DAILY BASIS. ANY UNSCHEDULED LOADS MAY BE REFUSED AT THE GATE.

## MATERIALS MANIFEST

**GENERATOR**

Owens Financial  
Site Address 3623 Adelino, Emeryville, Ca.  
Mailing P.O. Box 1307 Walnut Creek, Ca 94595  
Phone: (519) 935-8340 Contact: Bob Burke

**TRANSPORTER**

Aemco  
Address 1217 S. 7th St. Modesto, Ca. 95351  
Phone: (209) 524-9653 Contact: Doug

I hereby certify that the above named material was picked up at the generator site listed above.

Driver Name: SPADY Cunningham Signature [Signature]  
Truck No. 21 Ship Date: 9-1-95  
Time of Pick-Up: \_\_\_\_\_ Time of Delivery: \_\_\_\_\_

**Consultant/Owner**

Aemco  
Address 1217 S. 7th St. Modesto, Ca. 95351  
Phone: (209) 524-9653 Contact: Doug

I hereby certify that the above named material is consistent with the information presented in the Waste Characterization Form and Contaminated Soil Description Form, and has been properly described, classified and packaged, and is in proper condition for transport according to applicable regulation.

Name [Signature] Date: 9-1-95

**Recycling Facility**

REMEDIAL ENVIRONMENTAL MARKETING CO. INC.  
2717 GOODRICK AVENUE RICHMOND, CA 94801

RECEIVED BY: \_\_\_\_\_  
DATE: 9-1-95  
Control No: F-142

A COPY OF THIS SHEET MUST ACCOMPANY EVERY LOAD, AND MUST BE SUBMITTED AT THE GATE FOR ENTRY. ALL LOADS MUST BE SCHEDULED AT LEAST 24 HOURS IN ADVANCE. DELIVERIES MUST BE SCHEDULED ON A DAILY BASIS. ANY UNSCHEDULED LOADS MAY BE REFUSED AT THE GATE.

MATERIALS MANIFEST

GENERATOR

Brewery Financial

Site Address 3623 Oaklin Emeryville, Ca.
Mailing P.O. Box 2308 Walnut Creek, Ca. 94595
Phone (510) 935-3940 Contact: Scott Burke

TRANSPORTER

Semco

Address 1217 S. 7th St. Modesto, Ca. 95351
Phone (209) 524-9653 Contact: Doug

I hereby certify that the above named material was picked up at the generator site listed above.

Driver Name: BRADY Cunningham Signature [Signature]

Truck No. 7th St 21 Ship Date: 9-1-95

Time of Pick-Up: 9:30 Am Time of Delivery:

Consultant/Owner

Semco

Address 1217 S. 7th St. Modesto, Ca. 95351
Phone (209) 524-9653 Contact: Doug

I hereby certify that the above named material is consistent with the information presented in the Waste Characterization Form and Contaminated Soil Description Form, and has been properly described, classified and packaged, and is in proper condition for transport according to applicable regulation.

Name James [Signature] Date: 9-1-95

Recycling Facility

REMEDIAL ENVIRONMENTAL MARKETING CO. INC.
2717 GOODRICK AVENUE RICHMOND, CA 94801

RECEIVED BY: [Signature]
DATE: 9-1-95
Control No: F-1142

A COPY OF THIS SHEET MUST ACCOMPANY EVERY LOAD, AND MUST BE SUBMITTED AT THE GATE FOR ENTRY. ALL LOADS MUST BE SCHEDULED AT LEAST 24 HOURS IN ADVANCE. DELIVERIES MUST BE SCHEDULED ON A DAILY BASIS. ANY UNSCHEDULED LOADS MAY BE REFUSED AT THE GATE.