

# BLAINE TECH SERVICES

SCB  
P.O. BOX 5745  
SAN JOSE, CA 95150  
(408) 723-3974

July 8, 1985

4M Construction  
11855 Road 29  
Madera, CA 93637

Attention: Dave Mendrin

Re: Additional soil  
sampling

Texaco Station  
Marshall & Castro Valley Blvd.  
Castro Valley, CA

on  
June 2, 1985.

## SAMPLING REPORT

Sampling was performed in accordance with approved methodology at the locations shown in the accompanying site diagram. The lab numbers assigned to the samples are given on the site diagram. Samples were collected in appropriate containers, which were sealed, chilled and transported to the laboratory for analysis. Analytical services will be provided by IT Stoner Laboratories with a separate report and billing invoice referencing their lab numbers.

### Tanks

age -- unspecified  
type -- two 6,000 gallon gas  
two 4,000 gallon gas

reason for removal -- demolition of station/discontinuation of onsite storage.

*No samples were taken from pipeline trenches.*

### Analysis

Instructions were given to the laboratory to test the soil samples for volatile hydrocarbons due to gasoline.

*4/1/87  
SGA*

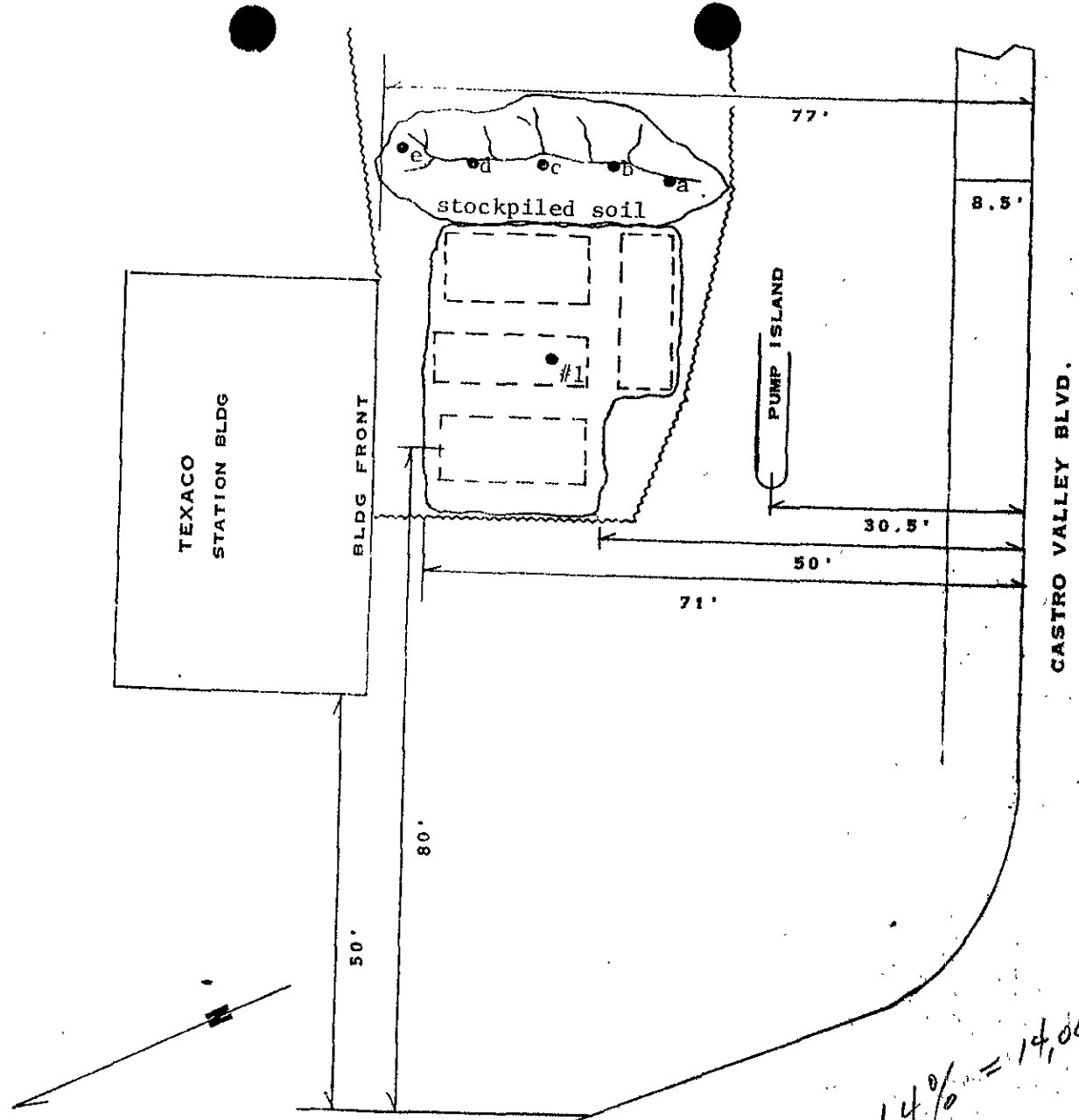

1.4% = 14,000 ppm

SOIL SAMPLES

#1 @ 13' below grade in pit center, G-1314 vapor reading = 100% LEL, IT Stoner Laboratories lab. no. 29915

#2 composite of five soil cores taken by augering 24" into the ridge of the stockpiled soil. G-1314 readings:

- a = 100 ppm vapor
- b = 75
- c = 100
- d = 100
- e = 250

IT Stoner Laboratories lab. no. 29916

SCALE 1/10" = 2'

MAP REF:

THOMAS BROS.  
Alameda County  
page 31 A-4

*Richard C. Blaine*  
Richard C. Blaine

Reportage

Submission to the Regional Water Quality Control Board and the County Health Department should include copies of both the sampling report and the IT Stoner Laboratories report. The property owner should attach a cover letter and submit all documents together in a package.

The following addresses have been listed here your convenience:

Water Quality Control Board  
San Francisco Bay Region  
1111 Jackson Street  
Room 6040  
Oakland, CA 94607  
ATTN: Hossain Kazemi

Alameda County Health  
Hazardous Materials Management  
Oakland, Ca 94612  
Attn: Edgar Howell

If I can be of any further assistance, please call me.

  
Richard C. Blaine

RCB/sjw



July 11, 1985

4-M Construction  
11855 Road 29  
Madera, CA 93637

ATTN: Dave Mendrin

Following are the results of our analysis for the presence of volatile hydrocarbons due to gasoline in two samples of soil received on July 2, 1985 from Blaine Tech Services.

The samples were examined using the purge and trap technique. Final detection was by gas chromatography using a flame ionization detector and a Carbopack B/3% SP-1500 column. This method allows for the detection of aliphatic hydrocarbons from C<sub>5</sub> through C<sub>10</sub> and aromatic hydrocarbons through substituted benzenes. Hydrocarbons C<sub>5</sub>-C<sub>7</sub>, benzene and toluene were calculated by comparing the sample chromatogram to a fresh gasoline standard. Hydrocarbons C<sub>8</sub>-C<sub>10</sub> ethyl benzene, xylenes and other substituted aromatics were calculated by comparing to a standard of gasoline which had been evaporated to 35% of its original weight. The results given below are the sum of hydrocarbons in these two ranges.

| <u>nd = none detected</u> |                                   | <u>Results</u>                            |
|---------------------------|-----------------------------------|---|
| <u>Lab. #</u>             | <u>Sample Identification</u>      | <u>Parts per Million (dry soil basis)</u> |
|                           |                                   | <u>Volatile Hydrocarbons</u>              |
|                           |                                   | <u>Due to Gasoline</u>                    |
|                           | BTS #85183B<br>4M @ Castro Valley |   |
| 29915                     | #1                                | 6,500.                                    |
| 29916                     | #2                                | nd  |
| Detection Limit           |                                   | 2.  |

*Patricia L. Murphy*  
Patricia L. Murphy

PLM/jd

Regional Office

IT Corporation • 397 Mathew Street • Santa Clara California 95050 • 408-727-4277